

SFMTA - TASC SUMMARY SHEET

PreStaff_Date: 12/6/2022 Requested_by: SFMTA Handled: Laura Stonehill (646-4320) Section Head : M. Sallaberry <i>MS</i>	<input type="checkbox"/> Public Hearing Consent <input checked="" type="checkbox"/> Public Hearing Regular <input type="checkbox"/> Informational / Other <small>PH - Regular</small>	No objections: _____ Item Held: _____ Other: _____
--------------------------------------------------------------------------------------------------------------------------------------------------------------	---------------------------------------------------------------------------------------------------------------------------------------------------------------------------------------------------------------------	-------------------------------------------------------------------------------

Location: Vallejo Street at Columbus Avenue

Subject: Bike Share Station

PROPOSAL / REQUEST:
ESTABLISH – NO STOPPING EXCEPT BICYCLES
ESTABLISH – BIKE SHARE STATION
Vallejo Street, north side, from 12 feet to 108 feet west of Columbus Avenue (Supervisor District 3)

Proposing a Bay Wheels bike share station in the parking lane on the north side of Vallejo, west of Columbus, adjacent to 654 Vallejo St.

Laura Stonehill, laura.stonehill@sfmta.com

BACKGROUND INFORMATION / COMMENTS

Stations with bicycles are 6 feet wide and 4 feet tall with a kiosk 7.8 feet tall and map panel at the western end of the station. Stations are solar powered via a panel system that extends vertically from the kiosk. No excavation is necessary.

- No bike facilities
- No Muni
- Station would replace four general metered parking stalls
- Lyft conducted outreach to the adjacent property. This station was shared with multiple neighborhood groups and the District 3 supervisor was notified of this location.

Grid C26-2
31 docks

HEARING NOTIFICATION AND PROCESSING NOTES:	ENVIRONMENTAL CLEARANCE BY: <input type="checkbox"/> SFMTA <input checked="" type="checkbox"/> Attached <input type="checkbox"/> Pending
---------------------------------------------------	----------------------------------------------------------------------------------------------------------------------------------------------------

CHECK IF PREPARING SEPARATE SFMTA BOARD CALENDAR ITEM FOR PROPOSAL:

Existing & Proposed Bike Share Stations

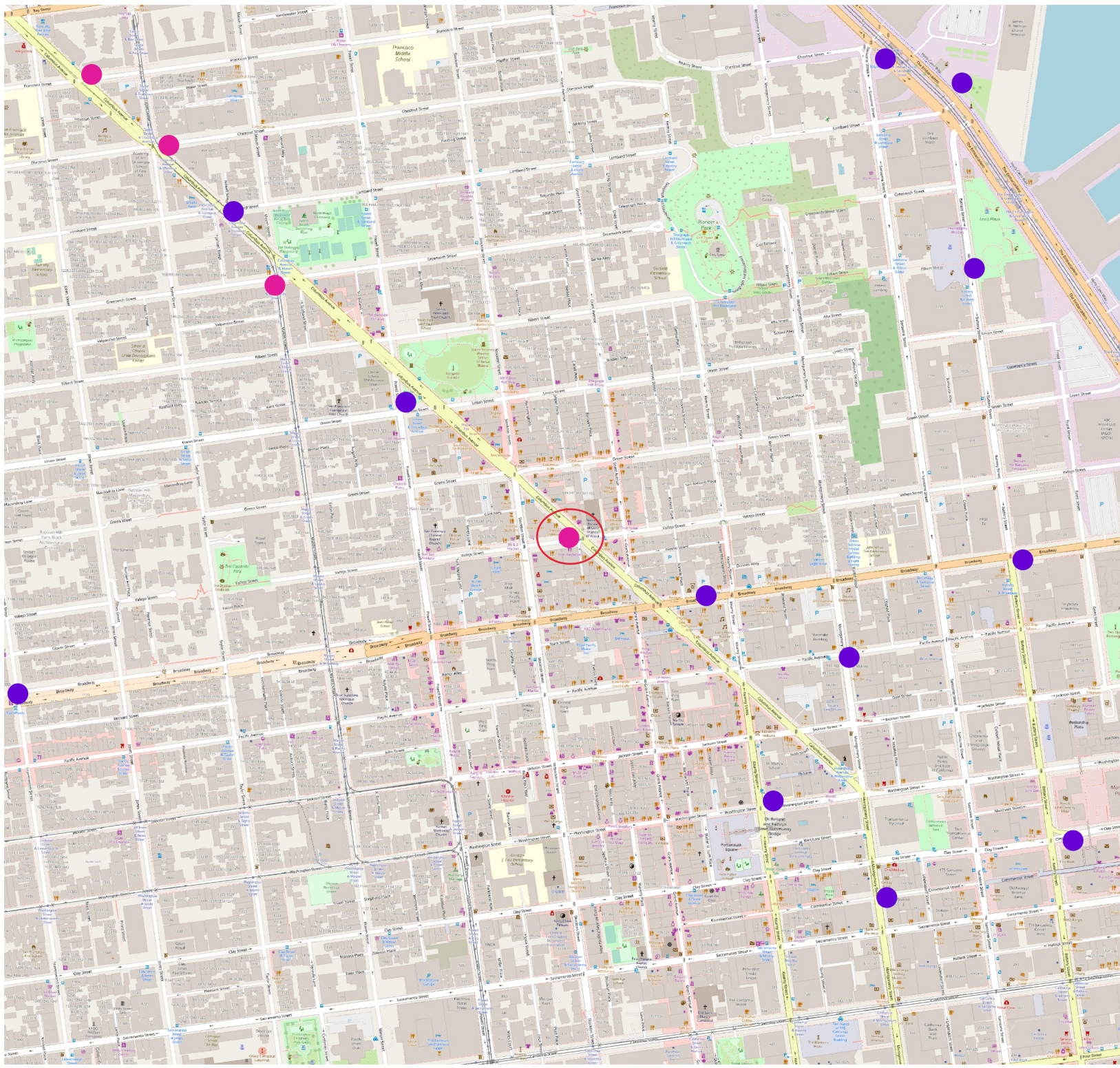

Bike Share Stations
Existing ●
Planned ●

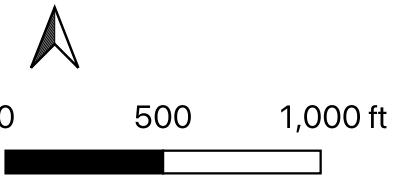

Data sources: OpenStreetsMap,
Lyft
Last Updated: 2022-10-26

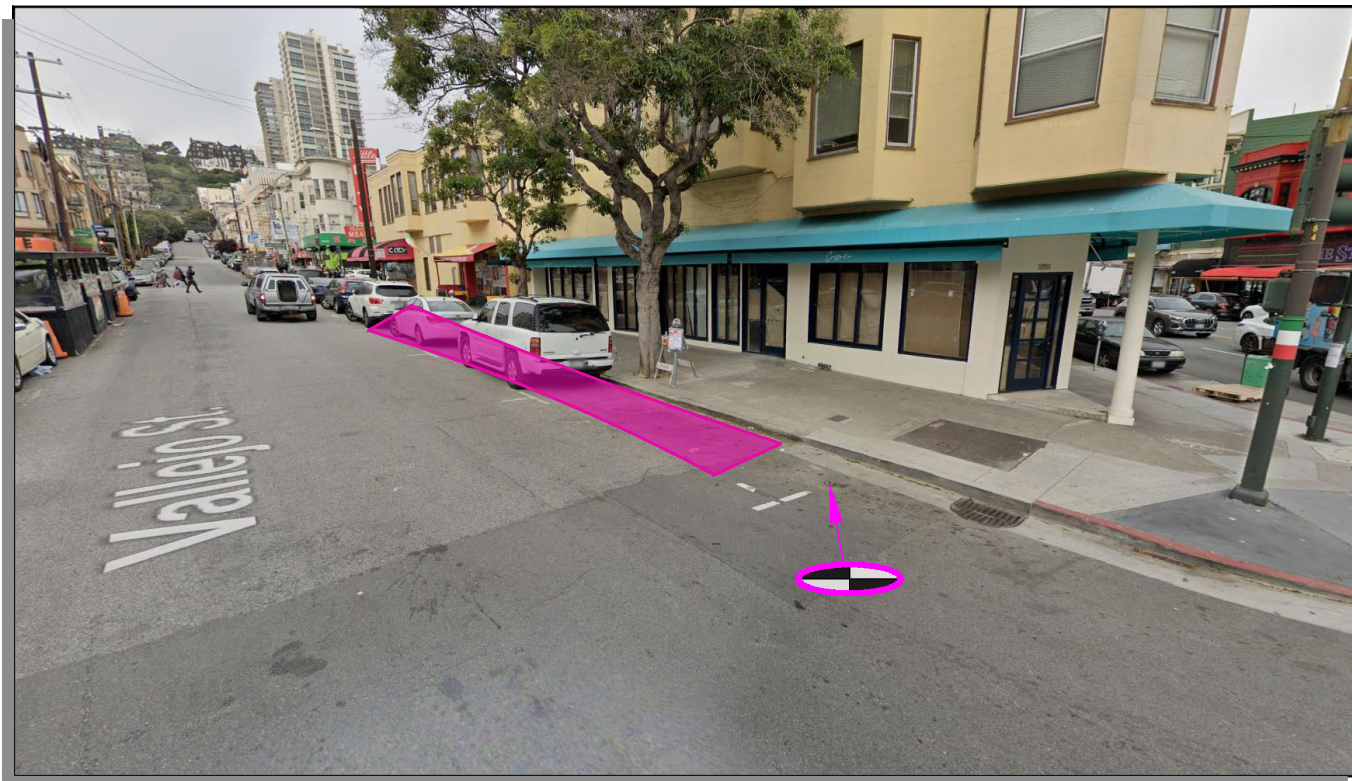

Stand Pipe
 Fire Hydrants (High Pressure)
 Fire Hydrants (Low Pressure)
 Street Light with Arm
 Street Light
 Utility Pole
 Signal Pole

Parking Meters
 Tree With Grate/Well
 Proposed Red Curb
 Proposed Blue Curb
 Proposed Yellow Curb
 Proposed Green Curb
 Proposed White Curb

PM
 R/C
 B/C
 Y/C
 G/C
 W/C

ABBREVIATIONS

BS = BUS SHELTER
 BR = BIKE RACK
 CC = TRAFFIC SIGNAL CONTROLLER CABINET
 DI = DRAINAGE INLET
 DW = DRIVEWAY
 LF = LINEAR FEET
 MB = MAIL BOX
 MH = MANHOLE
 NS = NEWSPAPER STAND
 PB = PULL BOX
 M/C = MOTORCYCLE

TC = TRASH CAN
 TYP. = TYPICAL
 UC = UTILITY CABINET
 V = UTILITY VALVE
 UV = UTILITY VAULT
 R/C = EXISTING RED CURB
 B/C = EXISTING BLUE CURB
 Y/C = EXISTING YELLOW CURB
 G/C = EXISTING GREEN CURB
 W/C = EXISTING WHITE CURB

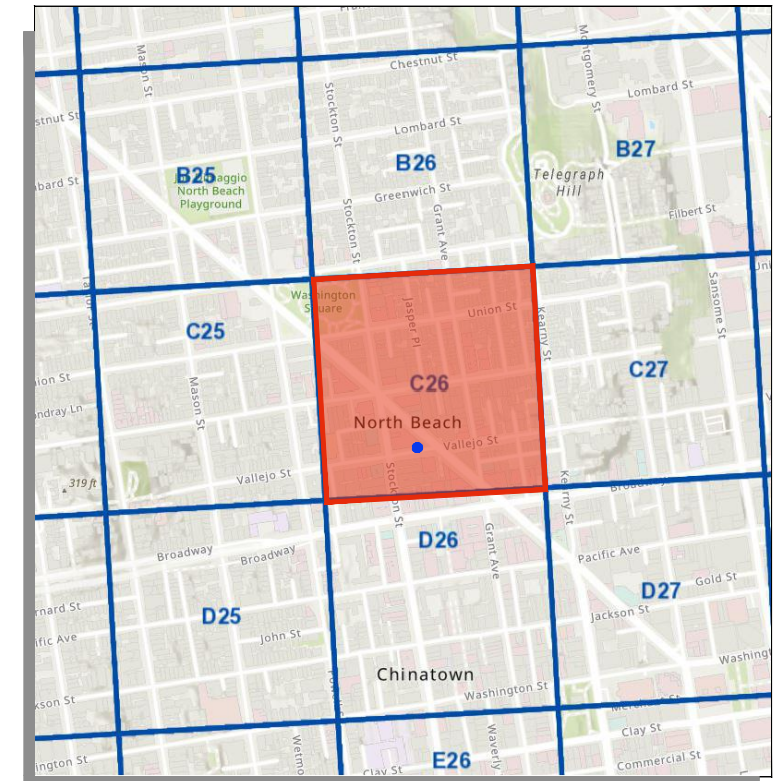

- SITE NOTES**
- ON-STREET SITE
 - ADJACENT TO 654 VALLEJO ST
 - METERED PARKING

☉ = PLAN REFERENCE POINT
SITE LOCATION
 NOT TO SCALE

VICINITY MAP
 NOT TO SCALE

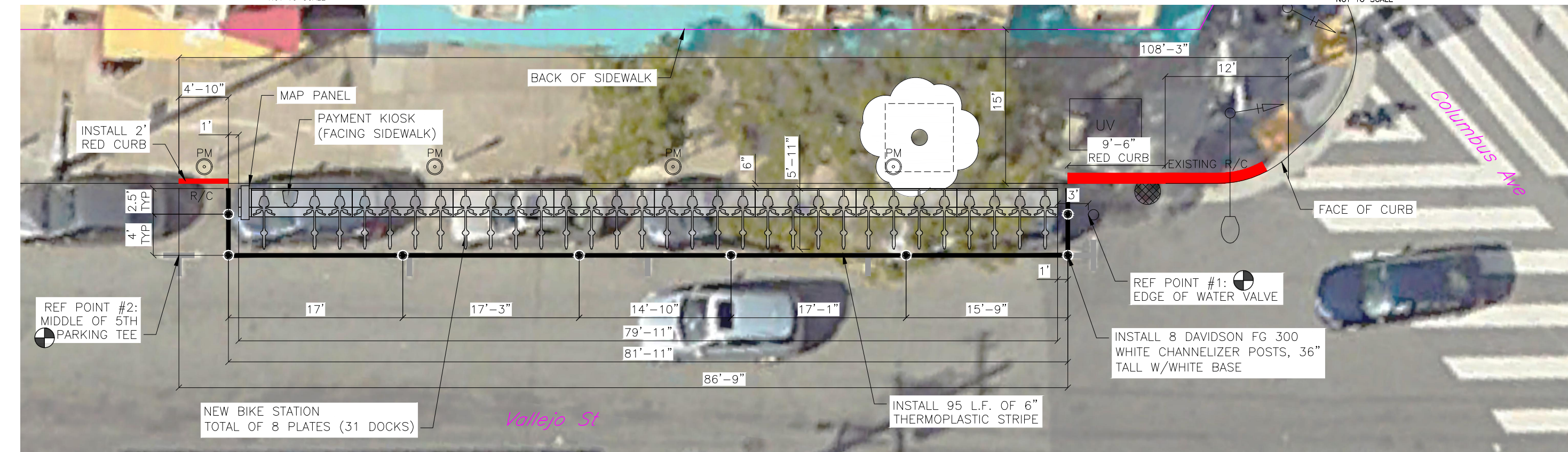

SITE PLAN
 5 0 5 10
 GIVEN DIMENSIONS TAKE PRECEDENCE OVER SCALED MEASUREMENTS

REVISIONS			
NO.	DATE	DESCRIPTION	BY



DRAWN BY: CMV
 DESIGNED BY: CMV
 CHECKED BY: CMV
 DATE: 10/20/2022
 PROJECT NO:

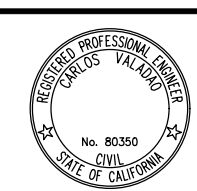

STATION TYPE:	Standard On-Street
STATION ID:	SF-C26-2
PLATES:	8
DOCKS:	31
KIOSKS:	1

Station Site and Plan
 SF-C26-2
 VALLEJO ST AT COLUMBUS AVE

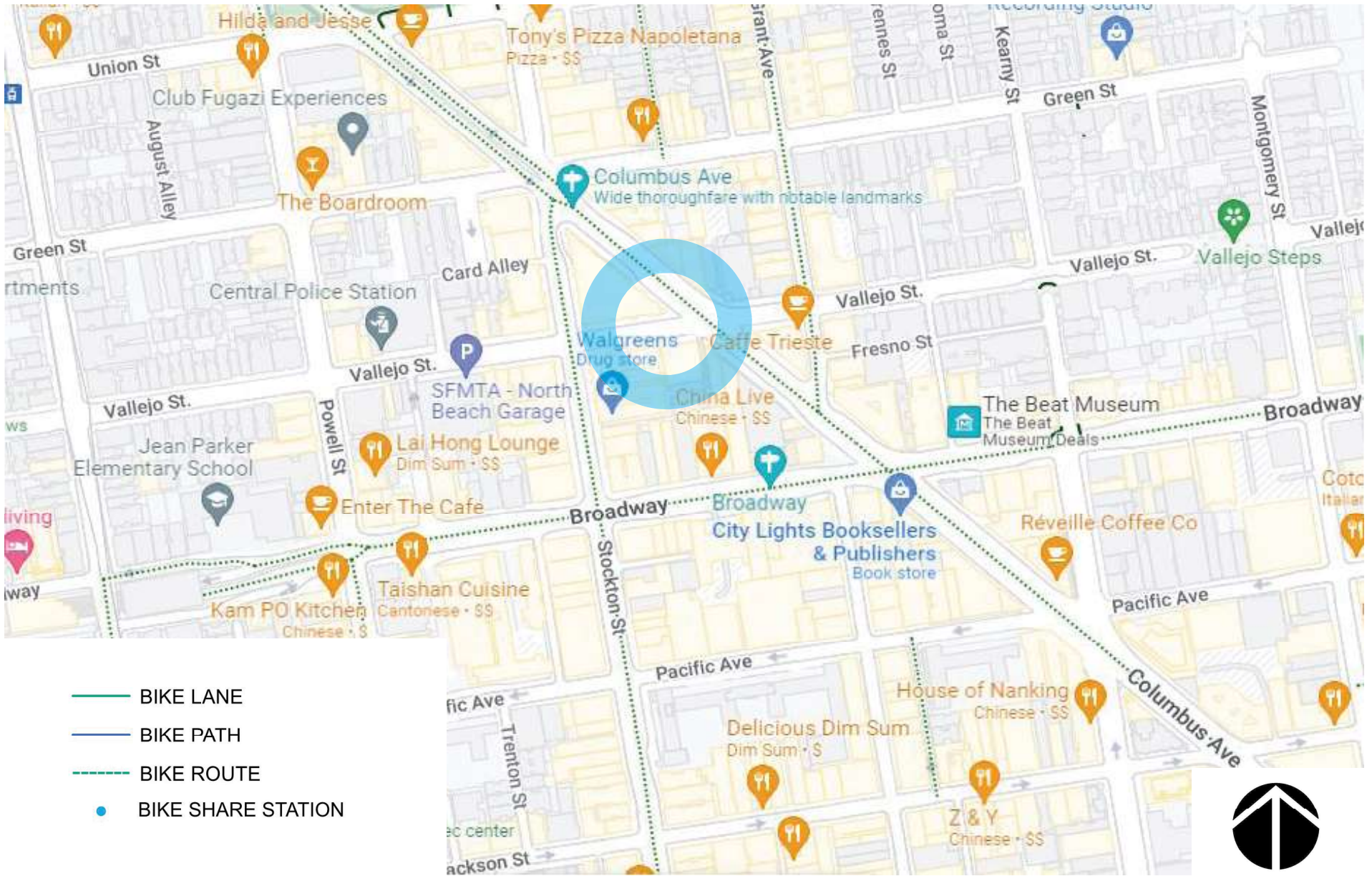

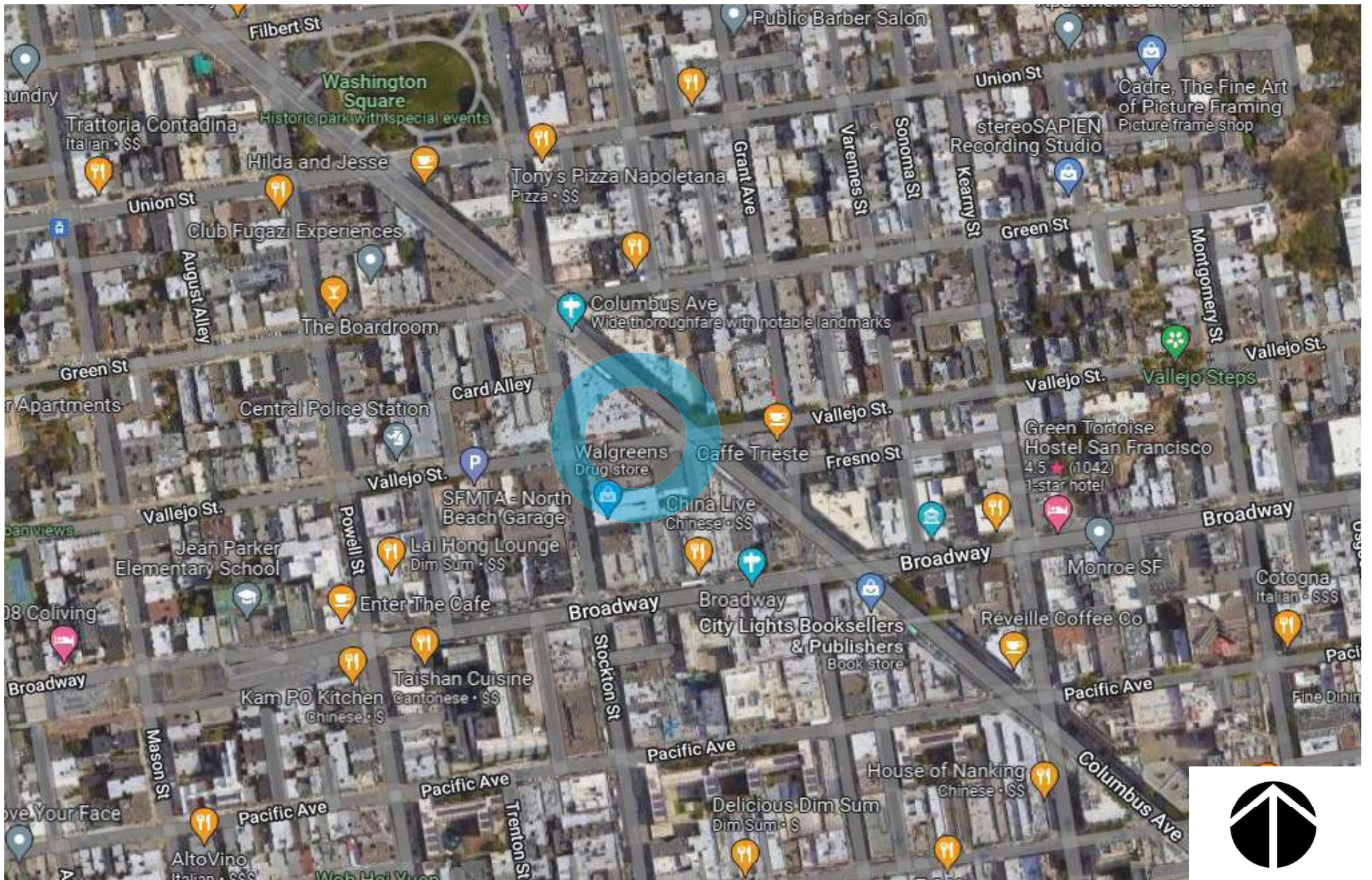

baywheels

Bay Wheels
Aerial Map

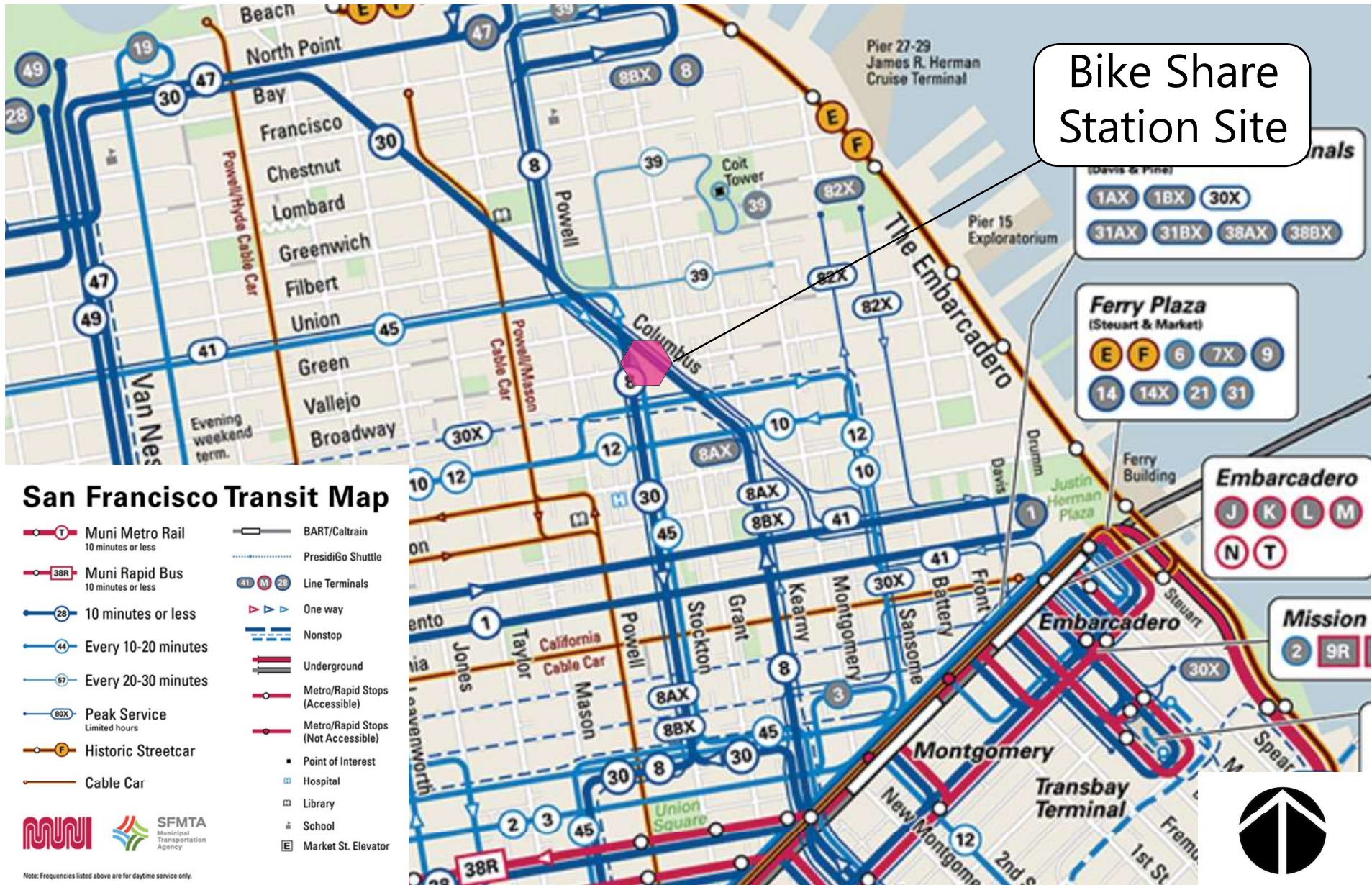

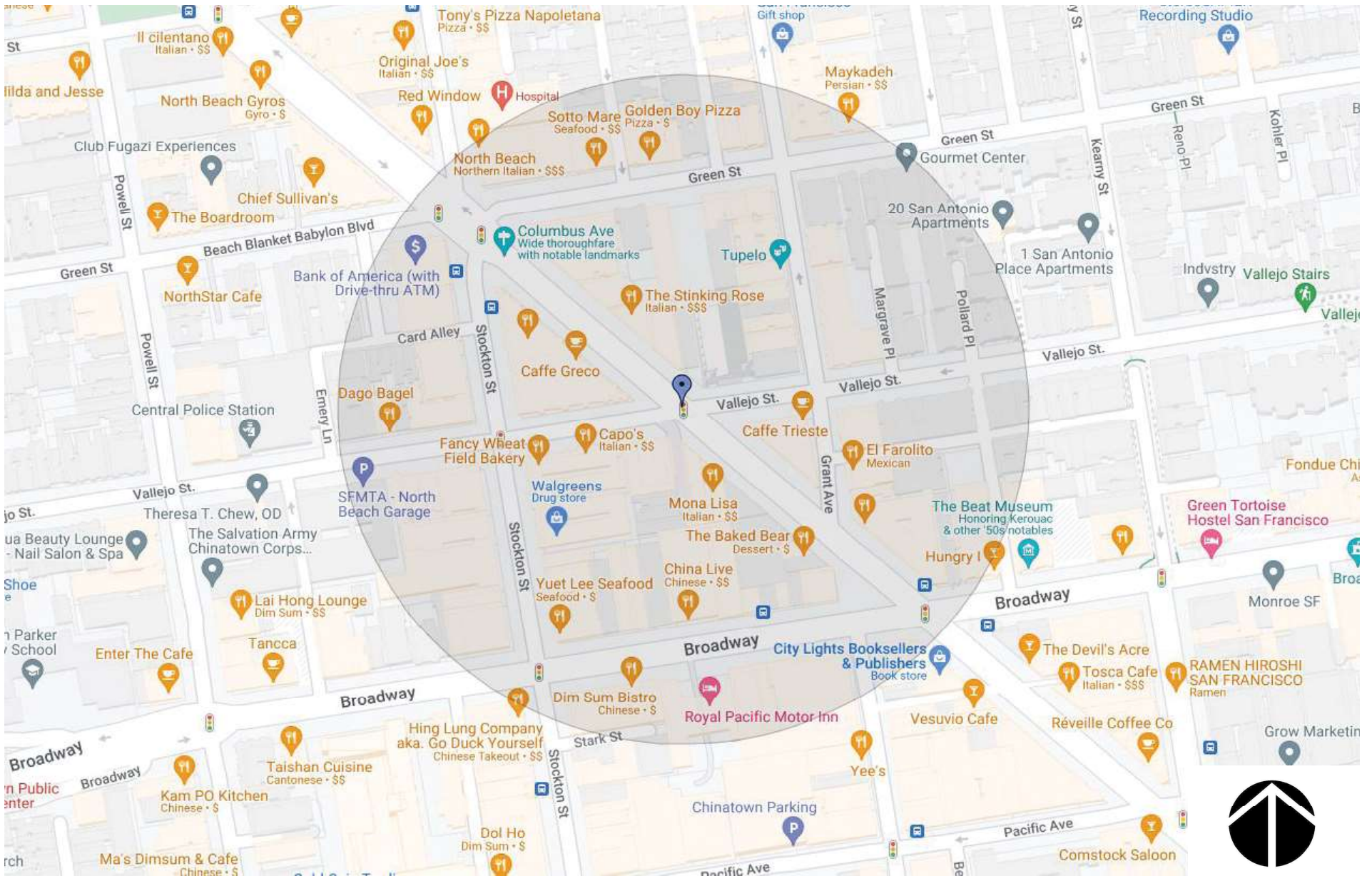

NORTH

EAST



SOUTH

WEST



baywheels

Bay Wheels
Photo Array

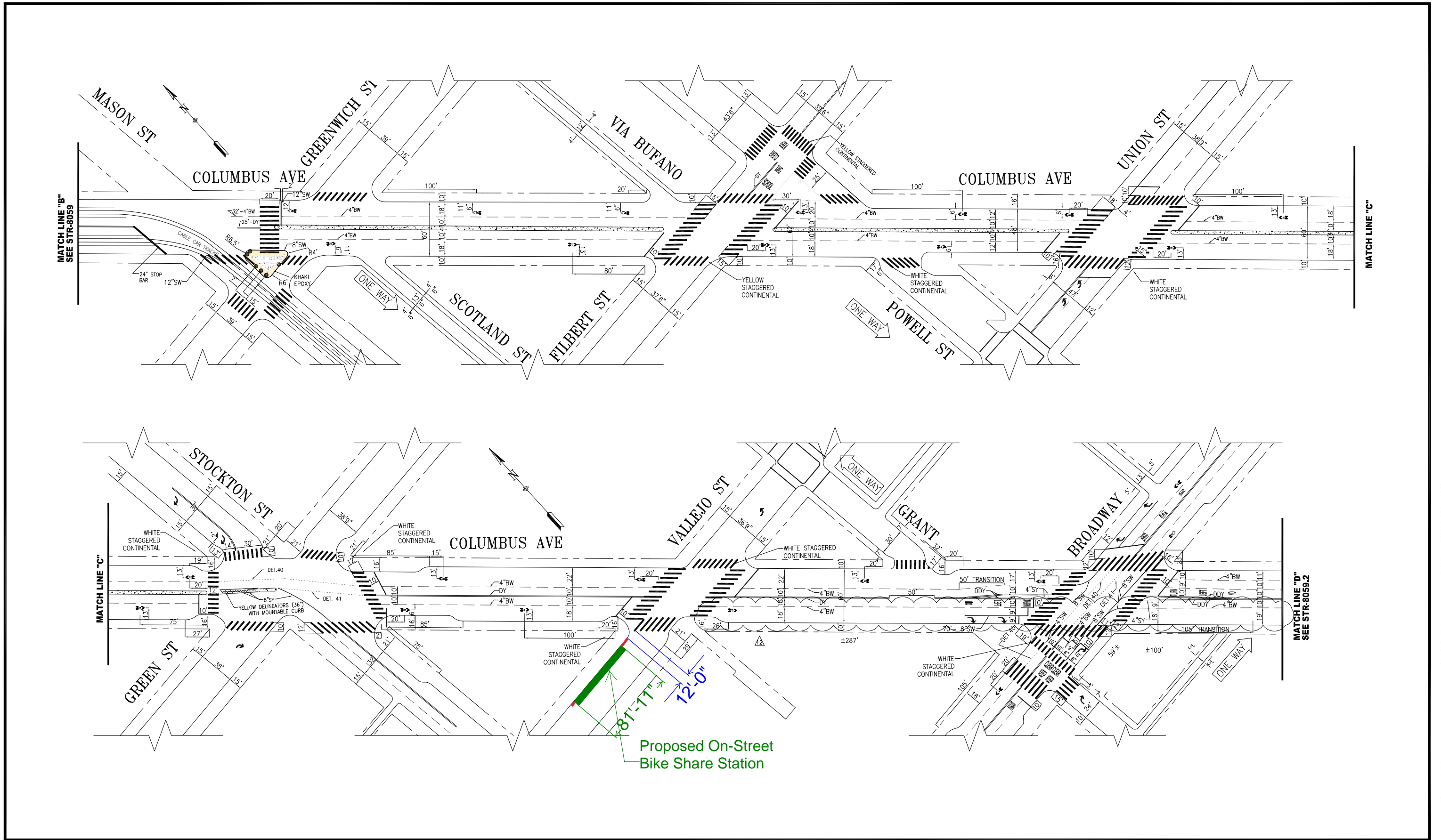

NO.	DATE	DESCRIPTION	BY	APP
1	01/11/19	REMOVED 8" BW FROM VALLEJO TO BROADWAY, REMOVED 4" BW FROM BROADWAY TO PACIFIC PSZ AT MASON/GREENWICH, PAVEMENT MARKINGS AT STOCKTON & VALLEJO, TRANSVERSE XWALKS AT VALLEJO/GRANT	A. CHUN A. LAM	E. TSUI C. WONG
2	06/03/19	ADDED YELLOW DELINEATORS WITH MOUNTABLE CURB AT STOCKTON	K. SHUE	M. VELASCO
3	04/08/19	ADDED WHITE STAGG. CONTI, ADV LL @ STOCKTON, VALLEJO, & BROADWAY; ADJ. SHARROWS FILBERT TO BROADWAY; ADJ. 8" BW ON SB COLUMBUS @ BROADWAY	S. LAM BY	D. VALLE-SCHWENK APP



APPROVED
BRIAN DUSSEAUT 06/04/14
 SENIOR ENGINEER

APPROVED
RICARDO OLEA 06/04/14
 CITY TRAFFIC ENGINEER

SCALE:
 1" = 50'
 SHEET/SHEETS:
 2 OF 3

CONTRACT NO.
 DRAWING NO.
STR-8059.1
 FILE NO.
 REV. NO.
 12

TRAFFIC STRIPING
 COLUMBUS STREET
 LOMBARD STREET TO BROADWAY STREET

EXTERNAL REFERENCES: XREFS
 FONTS USED: FONTS
 SCALE FACTOR: XX
 PLOT SCALE: 1"=1'
 ORIGIN: SECTION
 FILE NAME: BOC-STD2.DWG
 DATE: --/--

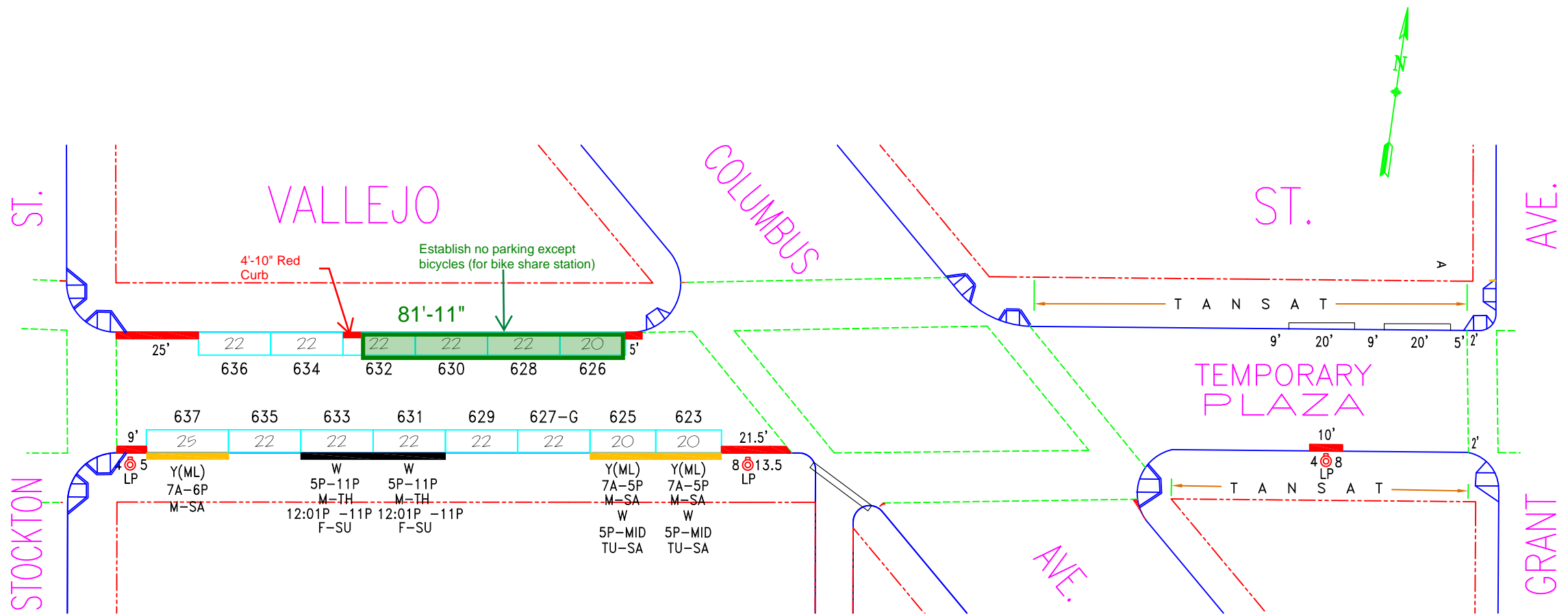

NO.	REVISION DESCRIPTION	BY	DATE	DIR/RES	5	6	7
					Extend RZ, Reloc. ML#623,625- S/S	JB	12/23/14 14-165
8	Daylighting:Est. RedZ,MOS#638- N/S	JB	7/2/22	6527	MOS#601-#612@Columbus&Grant,B/S	JB	9/14/15
					Est. PT-PLZ on ML#623,625 - S/S	JB	11/2/17 5839

SAN FRANCISCO MUNICIPAL TRANSPORTATION AGENCY
CITY AND COUNTY OF SAN FRANCISCO
 PARKING METER SPACES

SIDE	TOW-AWAY		METER CT.		GENERAL			LOADING		METERED SPACES						TOTAL	
	AM	PM	SS	MS	GMP	MC	TIMES	DAYS	ML	MTL	6-W	15 MIN	30 MIN	1 HR	2 HR		10 HR
ODD			8		5		9A-6P	M-SA	3				4		4		8
EVEN			6		6		9A-6P	M-SA							6		6

VALLEJO ST. (VJO, 705)
(600) BLOCK
 Meters #705-06XXY
GRANT AVE. TO STOCKTON ST.

SCALE: **1" = 40'** DATE: **10/9/12** BY: **JB**

AREA 3

SF-C26-2 Vallejo at Columbus Documentation of Outreach

Abutter Information:

- 405 Columbus Ave: Vacant.
-

Record of Meetings & Correspondence

- Sent a mailer with proposed station information to the following businesses and residences. One response received (Cole Hardware, attached below)

Resident	654 Vallejo	San Francisco	94133
Resident	401 Columbus	San Francisco	94133
Resident	656 Vallejo	San Francisco	94133
Palermo II Delicatessen	658 Vallejo	San Francisco	94133
Cole Hardware	627 Vallejo	San Francisco	94133
Resident	633 Vallejo	San Francisco	94133
Capo's Pizza	641 Vallejo	San Francisco	94133

Attachments

- [Email thread Cole Hardware](#)
- Email with MTA and Supervisor Peskin's office - [Email 1](#) and [Email 2](#)



Neal Patel <nealpatel@lyft.com>

Feedback on new proposed location for Bike Share Station - North Side of Vallejo St @ Columbus

Neal Patel <nealpatel@lyft.com>

Thu, Sep 22, 2022 at 10:55 AM

To: "Peskin, Aaron (BOS)" <aaron.peskin@sfgov.org>

Cc: Tina Rotolo <tina@colehardware.com>, "community@baywheels.com" <community@baywheels.com>, David Karp <david@colehardware.com>, Rick Karp <rick@colehardware.com>, "Ramos, Joel (MTA)" <Joel.Ramos@sfmta.com>, "Maguire, Tom (MTA)" <Tom.Maguire@sfmta.com>, "Leung, Adrian" <Adrian.Leung@sfmta.com>

Hi Tina - I'm glad our outreach flier got to you. We are collecting input from area residents on this proposed station and I appreciate you taking the time to submit your thoughts. I understand that parking loss is a concern for you and for many businesses in the area - Bay Wheels tries to minimize impacts to parking loss as much as possible. Bikeshare is an efficient use of curb space, however, and many of our stations in popular areas see dozens or more trips a day. Bikeshare serves locals and helps to bring more people to local shops as well.

I'm adding my SFMTA colleague Adrian as well. We are gathering input on this proposed location and I will let you know when we determine next steps.

Again, thanks again for responding to our flier - feel free to reach out to me directly if you have any questions.

Neal

On Thu, Sep 22, 2022 at 10:27 AM 'Peskin, Aaron (BOS)' via Bay Wheels Community <community@baywheels.com> wrote:

I agree with you and am adding the SFMTA to this thread.
Aaron

From: Tina Rotolo <tina@colehardware.com>

Sent: Thursday, September 22, 2022 9:54:31 AM

To: community@baywheels.com <community@baywheels.com>

Cc: Peskin, Aaron (BOS) <aaron.peskin@sfgov.org>; David Karp <david@colehardware.com>; Rick Karp <rick@colehardware.com>

Subject: Feedback on new proposed location for Bike Share Station - North Side of Vallejo St @ Columbus

This message is from outside the City email system. Do not open links or attachments from untrusted sources.

Respectfully, I am NOT in favor of this proposed location.

As the manager of a small locally owned business, taking away 3-4 parking spaces will make it even more difficult for my customers to park nearby for shopping at my business. I am located at 627 Vallejo St (Cole Hardware) and customers frequently comment that it is too difficult to find parking so they will just go elsewhere or shop at big box hardware stores that have a parking lot, like Lowes in the City or Home Depot in Colma.

This neighborhood already suffers from diminished parking spaces for retail customers who drive due to what seems like constant construction and road work AND the many parklets that have now become seemingly permanent so that small business restaurants can survive in our challenging times. With so many other small businesses driven out of the neighborhood in the past several years, residents who can't afford to live here moving away and the gross increase in crime/homelessness/aggressive shoplifting, small businesses who are trying to survive have enough hurdles. This would just add another.

Although I am in support of more green transportation options, I would think that putting this type of bicycle dock in an area that wouldn't have such a negative impact on an already trying parking situation might be more suitable. Perhaps just a few blocks away by Washington Square Park.

--

Tina Rotolo
Store Manager, North Beach & HR Team Member
Cole Hardware
627 Vallejo St.
San Francisco, CA 94133
415.432.2653
www.colehardware.com

Follow us!

[Instagram](#)

| [Facebook](#)

| [Twitter](#)



--

Neal Patel

Community Affairs Manager
Lyft Bikes and Scooters, SF Bay Area





Neal Patel <nealpatel@lyft.com>

D2, D3 Station Check In

Leung, Adrian <Adrian.Leung@sfmta.com> Fri, Jul 15, 2022 at 2:47 PM
To: Alexandria Fiorini <afiorini@lyft.com>, "Stonehill, Laura" <Laura.Stonehill@sfmta.com>
Cc: Bay Wheels Planning <planning@baywheels.com>, "(community@baywheels.com)" <community@baywheels.com>

+H\ \$OH[DQGU LD DQG RWKHU ([SDQVLRQHUV

5HSRUWLQJ EDFN IURP P\ PHHWLQJ ZLWK 6XS 3HVNLQ HDL
VFRRWKHUVKDUH KH VDLG KH IHOW FRPSOHWHO\ RSSRVLW
MRE DERXW NHHSLQJ ELNHV UHODWLYHO\ FRUUDOOGH :K
PHQWLRQHG KH OLNHV WKH LGHD RI PRUH VWDWLRQV EX
G\QDPLFV ZLWK WKH SXEOLF ZKHQ WU\LQJ WR SXVK IRU P
IRONV

8OWLPRUWHODLG KH ZDV ILQH ZLWK SURFHGHGLQJ ZLWK RXV
KH IHOW PRUH FRPIRUWDEOH ZLWK WKH SURSRVHG VLWHV
VRPH RI WKH VSRWV LQ 1RUWK %HDFK ZRXOG OLNHO\ EH
DV FRQFHUQHG DERXW XQIRXQG HG ELNH UHQWDO FRQFHU
RU 1RUWK 3RLQW

/HW V FKDW PRUH DERXW LW QH[W ZHHN
+DSS\)ULGD\

\$GULDQ /HXQJ
%LNHVKDUH %LNH 3DUNLQJ 3URJUDP 0DQDJHU

all pronouns welcome

From: Alexandria Fiorini <afiorini@lyft.com>
Sent: Tuesday, May 10, 2022 1:49 PM

[Quoted text hidden]

[Quoted text hidden]



Neal Patel <nealpatel@lyft.com>

D3 Bikeshare - data for citations and stations

Leung, Adrian <Adrian.Leung@sfmta.com>
To: "Angulo, Sunny (BOS)" <sunny.angulo@sfgov.org>
Cc: Neal Patel <nealpatel@lyft.com>

Wed, May 25, 2022 at 3:58 PM

Hello Sunny,

It's been awhile. I hope you're doing well. I'm reaching out with instructive data we've collected related to bikeshare usage in D3.

Since installing stations closer to the Fisherman's Wharf area, we've seen predictable benefits in people parking bikes at docks, reducing misparking instances. To be honest, this isn't surprising since it's cheaper to park at, or near, a station.

On the other hand, in areas without station coverage, we are still seeing misparking. Here's a heat map demonstrating how this looks. On the street, people see a misparked bike; they report it; then SFMTA investigates and issues a citation. But from a broader scope, you can see how citations tend to occur where we have gaps in the system.



With that in mind, we've been considering how to fill these gaps with new potential stations.

- [North Point/Columbus](#) - south side of North Point, east of Columbus, in the parking lane
- [North Pont/Taylor](#) - north side of North Point, east of Taylor, in the parking lane
- [Bay/Mason](#) - south side of Bay, west of Mason, in the parking lane
- [Chestnut/Columbus](#) - north side of Chestnut, east of Columbus, in the parking lane or [Francisco/Columbus](#)- north side of Francisco, east of Columbus, in the parking lane
- [Greenwich/Mason](#) - north side of Greenwich, west of Mason, in the parking lane
- [Vallejo/Columbus](#) - north side of Vallejo, west of Columbus, in the parking lane



Of course, the first step is to ask you and Sup Peskin how you feel about these, which is why we're reaching out. Next, we'd open up discussions with the Bike Rental Companies since some of these stations are close to their operations.

Finally, it's helpful to remember data shows demand already exists here. Bike trips already start and end in these areas without stations. The addition of stations would simply help organize the bikes better.

Adrian Leung

Bikeshare & Bike Parking Program Manager

415.646.2533

adrian.leung@sfmta.com

all pronouns welcome

San Francisco Municipal Transportation Agency

1 South Van Ness Avenue, 7th Floor

San Francisco, CA 94103





SAN FRANCISCO PLANNING DEPARTMENT

Notice of Exemption

1650 Mission St.
Suite 400
San Francisco,
CA 94103-2479

Reception:
415.558.6378

Fax:
415.558.6409

Planning
Information:
415.558.6377

DEC 22 2015
POSTED TO

Approval Date: December 18, 2015
Case No.: **2015-005492ENV, SFMTA Bay Area Bicycle Share Project**
Project Title: **Citywide in San Francisco, primarily within the public right-of-way**

Zoning: Not applicable, primarily in the public right of way
Block/Lot: Not applicable, primarily in the public right of way
Lot Size: Not applicable, primarily in the public right of way
Lead Agency: San Francisco Planning Department
Project Sponsor: Heath Maddox, San Francisco Municipal Transportation Agency
 415-701-4789
 heath.maddox@sfmta.com

Staff Contact: Debra Dwyer
 415-575-9031
 debra.dwyer@sfgov.org

2015-0600

**ENDORSED
FILED**
SAN FRANCISCO County Clerk

DEC 22, 2015

by: **FANNY WONG**
Deputy County Clerk

To: County Clerk, City and County of San Francisco
City Hall Room 168
1 Dr. Carlton B. Goodlett Place
San Francisco, CA 94102

Pursuant to the California Environmental Quality Act (CEQA), the Guidelines of the Secretary for Resources, and San Francisco requirements, this Notice of Exemption is transmitted to you for filing. At the end of the posting period, please return this Notice to the Staff Contact with a notation of the period it was posted.

Attached fee: \$60 filing fee

PROJECT DESCRIPTION:

The San Francisco Municipal Transportation Agency (SFMTA) proposes to implement a city-wide bicycle sharing system in San Francisco as part of the regional Bay Area Bicycle Share (BABS) system described in detail below. The current regional bicycle share system in San Francisco is a pilot project managed by the Bay Area Air Quality Management District (BAAQMD). The regional BABS system will transfer to the Metropolitan Transportation Commission (MTC) for program oversight at the end of 2015. As part of a BABS pilot project initiated on August 29, 2013, the system operator installed approximately 35 bicycle share stations with input from the SFMTA, comprising 350 bicycles within the public right-of-way, located generally in the northeast section of the City. The proposed project would maintain and upgrade the existing 35 pilot bicycle share stations, and expand the BABS system within San Francisco to comprise a total of approximately 450 stations and 4,500 bicycles across the City and County of San Francisco (San Francisco).

DETERMINATION:

The City and County of San Francisco decided to carry out or approve the project on December 18, 2015. The San Francisco Board of Supervisors (BOS) approved a coordination agreement with the Metropolitan Transportation Commission (MTC), other local partners in the East and South Bay, and the bicycle share operator to carry out the Bay Area Bicycle Share Program, which would be overseen in San Francisco by the San Francisco Municipal Transportation Agency (SFMTA) on December 8, 2015. The agreement was provided to Mayor Lee for his signature and becomes effective upon signing or when ten days have passed. A copy of documents related to this action may be examined at the San Francisco Board of Supervisors, City Hall, 1 Carlton B. Goodlett Place Room 244, San Francisco, CA, 94102 in File Number 151144.

- 1. An Exemption from Environmental Review has been prepared pursuant to the provisions of CEQA under:

- Ministerial (Sec. 21080(b)(1); 15268)
- Declared Emergency (Sec. 21080(b)(3); 15269(a))
- Emergency Project (Sec. 21080(b)(4); 15269(b)(c))
- Categorical Exemption, Class 3, Section 15303
- Statutory Exemption, State code number: _____
- Community Plan Exemption (Sec. 21083.3; 15183)

- 2. This project in its approved form has been determined to be exempt from environmental review because it would result in the installation of up to 450 bicycle sharing stations throughout San Francisco, primarily within the public right-of-way and on some parcels. The proposed individual stations are portable, modular, and would be solar and battery powered, and would thus not involve excavation or utility connections. The bicycle sharing station equipment is small in scale and massing relative to surrounding buildings or sites. Bicycle facilities and infrastructure are common sights within the urban environment. There would be no potential for significant environmental impacts at either a project or cumulative level. Therefore, the proposed project would be exempt from environmental review under Class 3.

John Rahaim
Planning Director

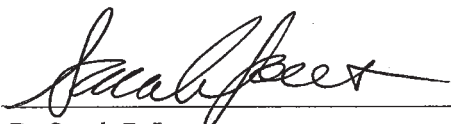
By Sarah B. Jones
Environmental Review Officer

December 22, 2015
Date

cc: Heath Maddox, SFMTA
Interested parties