

## SFMTA - TASC SUMMARY SHEET

<b>PreStaff_Date:</b> 8/12/2021 <b>Requested_by:</b> SFMTA <b>Handled:</b> Daniel Mackowski <span style="color: blue; font-size: small;">DNM</span> <b>Section Head :</b> CL <span style="color: blue; font-size: small;">MV for CL</span>	<input type="checkbox"/> <b>Public Hearing Consent</b> <input checked="" type="checkbox"/> <b>Public Hearing Regular</b> <input type="checkbox"/> <b>Informational / Other</b> <small>PH - Regular</small>	<b>No objections:</b> _____ <b>Item Held:</b> _____ <b>Other:</b> _____
---	---	---

**Location:** On Geary and O'Farrell streets, east of Van Ness Avenue

**Subject:** Parking Changes

**PROPOSAL / REQUEST:**  
 RESCIND – TOW-AWAY NO STOPPING 4 PM TO 6 PM  
 Geary Street, south side, from Van Ness Avenue to Polk Street (rescinds peak-hour travel lane)

ESTABLISH – PASSENGER LOADING ZONE, AT ALL TIMES  
 Geary Street, south side, from 15 feet to 59 feet east of Van Ness Avenue (for 1050 Van Ness operations)

ESTABLISH – GREEN METERED PARKING, 30-MINUTE TIME LIMIT, 9 AM TO 6 PM, MONDAY THROUGH SATURDAY  
 Geary Street, south side, from 59 feet to 81 feet east of Van Ness Avenue (establishes one short term parking space)

ESTABLISH – YELLOW 6-WHEEL COMMERCIAL METERED LOADING ZONE, 30-MINUTE TIME LIMIT, 7 AM TO 6 PM, MONDAY THROUGH SATURDAY  
 Geary Street, south side, from 81 feet to 125 feet east of Van Ness Avenue

RESCIND – TOW-AWAY NO STOPPING ANYTIME  
 ESTABLISH – TOW-AWAY NO STOPPING 7 AM TO 9 AM AND 4 PM TO 6 PM, MONDAY THROUGH FRIDAY

**BACKGROUND INFORMATION / COMMENTS**  
 Proposal to install parking and loading zones as part of treatments to facilitate vehicle turning movements onto reconfigured Van Ness Avenue.

<b>HEARING NOTIFICATION AND PROCESSING NOTES:</b>	<b>ENVIRONMENTAL CLEARANCE BY:</b> <input type="checkbox"/> SFMTA <input checked="" type="checkbox"/> Attached <input type="checkbox"/> Pending
---	--

On Geary and O'Farrell streets, east of Van Ness Avenue – Parking Changes

RESCIND – TOW-AWAY NO STOPPING 4 PM TO 6 PM

Geary Street, south side, from Van Ness Avenue to Polk Street (rescinds peak-hour travel lane)

ESTABLISH – PASSENGER LOADING ZONE, AT ALL TIMES

Geary Street, south side, from 15 feet to 59 feet east of Van Ness Avenue (for 1050 Van Ness operations)

ESTABLISH – GREEN METERED PARKING, 30-MINUTE TIME LIMIT, 9 AM TO 6 PM, MONDAY THROUGH SATURDAY

Geary Street, south side, from 59 feet to 81 feet east of Van Ness Avenue (establishes one short term parking space)

ESTABLISH – YELLOW 6-WHEEL COMMERCIAL METERED LOADING ZONE, 30-MINUTE TIME LIMIT, 7 AM TO 6 PM, MONDAY THROUGH SATURDAY

Geary Street, south side, from 81 feet to 125 feet east of Van Ness Avenue

RESCIND – TOW-AWAY NO STOPPING ANYTIME

ESTABLISH – TOW-AWAY NO STOPPING 7 AM TO 9 AM AND 4 PM TO 6 PM, MONDAY THROUGH FRIDAY

O'Farrell Street, north side, from Van Ness Avenue to 133 feet easterly (rescinds travel lane and establishes turn pocket to be consistent with rest of corridor)

ESTABLISH – YELLOW 6-WHEEL COMMERCIAL METERED LOADING ZONE, 30-MINUTE TIME LIMIT, 9 AM TO 4 PM, MONDAY THROUGH SATURDAY

O'Farrell Street, north side, from 1 feet to 67 feet east of Van Ness Avenue

ESTABLISH – GREEN METERED PARKING, 30-MINUTE TIME LIMIT, 9 AM TO 4 PM, MONDAY THROUGH SATURDAY

O'Farrell Street, north side, from 67 feet to 111 feet east of Van Ness Avenue (establishes two short term parking spaces)

ESTABLISH – YELLOW COMMERCIAL METERED LOADING ZONE, 30-MINUTE TIME LIMIT, 9 AM TO 4 PM, MONDAY THROUGH SATURDAY

O'Farrell Street, north side, from 111 feet to 133 feet east of Van Ness Avenue

(Supervisor District 6)

Daniel Mackowski, [daniel.mackowski@sfmta.com](mailto:daniel.mackowski@sfmta.com)

Proposal to install parking and loading zones as part of treatments to facilitate vehicle turning movements onto reconfigured Van Ness Avenue.

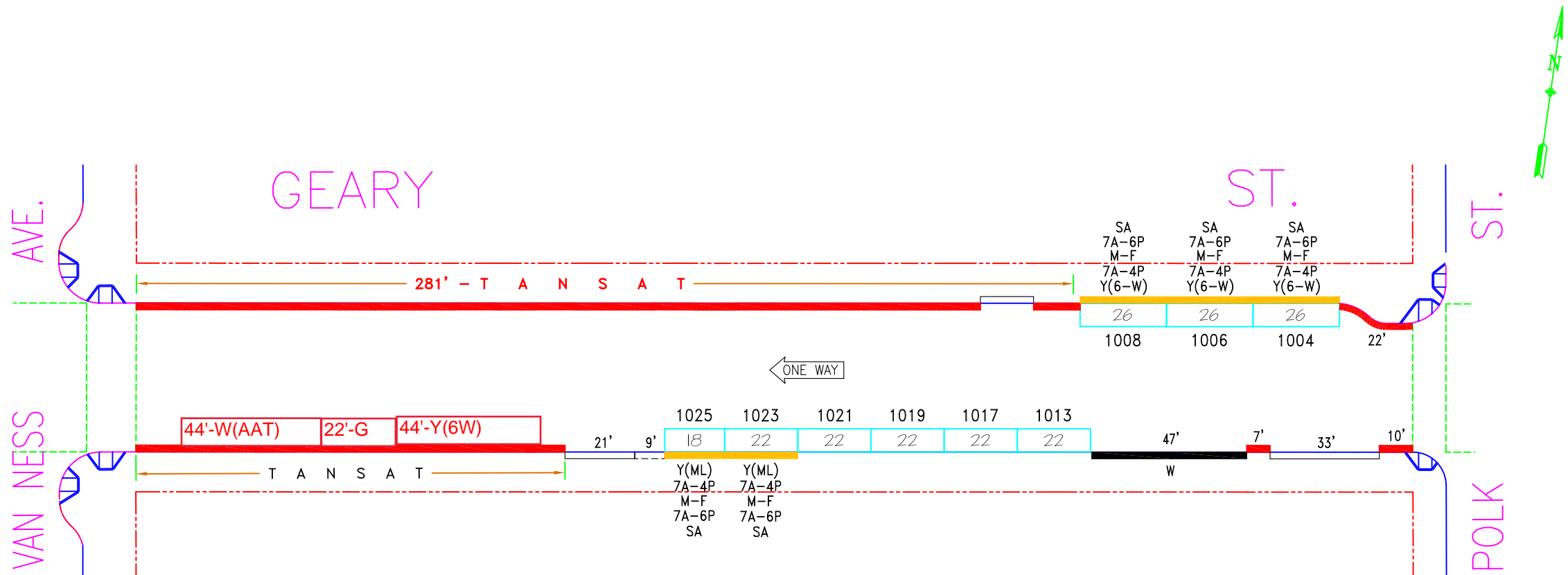

Update loading times to 6pm since Rescind TANS 4-6pm

NO.	REVISION DESCRIPTION	BY	DATE	DIR/RES	6	Est.6-W#1004,6,8(MOS6W#1010,32)N/S JB	12/5/18	5992
4	Est. Tanpat,MOS#1002,Est.6-W#1008	JB	3/20/15	15-034	7	Rescind ML#1023,25,Est.PLZ-AAT,S/S JB	8/2/19	6106
5	Est. Tansat, MOS#1031-1045 -S/S	JB	9/26/18	180821.118	8	RevokePLZ(AAT),restoreML#1023,25,S/S JB	5/14/21	6347

**SAN FRANCISCO MUNICIPAL TRANSPORTATION AGENCY**  
 CITY AND COUNTY OF SAN FRANCISCO  
 PARKING METER SPACES

SIDE	TOW-AWAY		METER CT.		GENERAL				LOADING		METERED SPACES							TOTAL
	AM	PM	SS	MS	GMP	MC	TIMES	DAYS	ML	MTL	6-W	15 MIN	30 MIN	1 HR	2 HR	10 HR		
ODD		<del>4P-6P</del>	6		4		9A-4P 9A-6P	M-F SA	2						4		6	
EVEN		4P-6P	3				9A-4P 9A-6P	M-F SA			3		3				3	

**GEARY ST. (GEA, 440)**  
**(1000) BLOCK**  
 Meters #440-10XXy  
**VAN NESS AVE. TO POLK ST.**

SCALE: 1" = 40'      DATE: 9/26/18      BY: JB

**AREA 3**

Revised: 05/14/21 13:03Z  
 Reference: 311\_255 (Operations/Management/Planning/Policy)

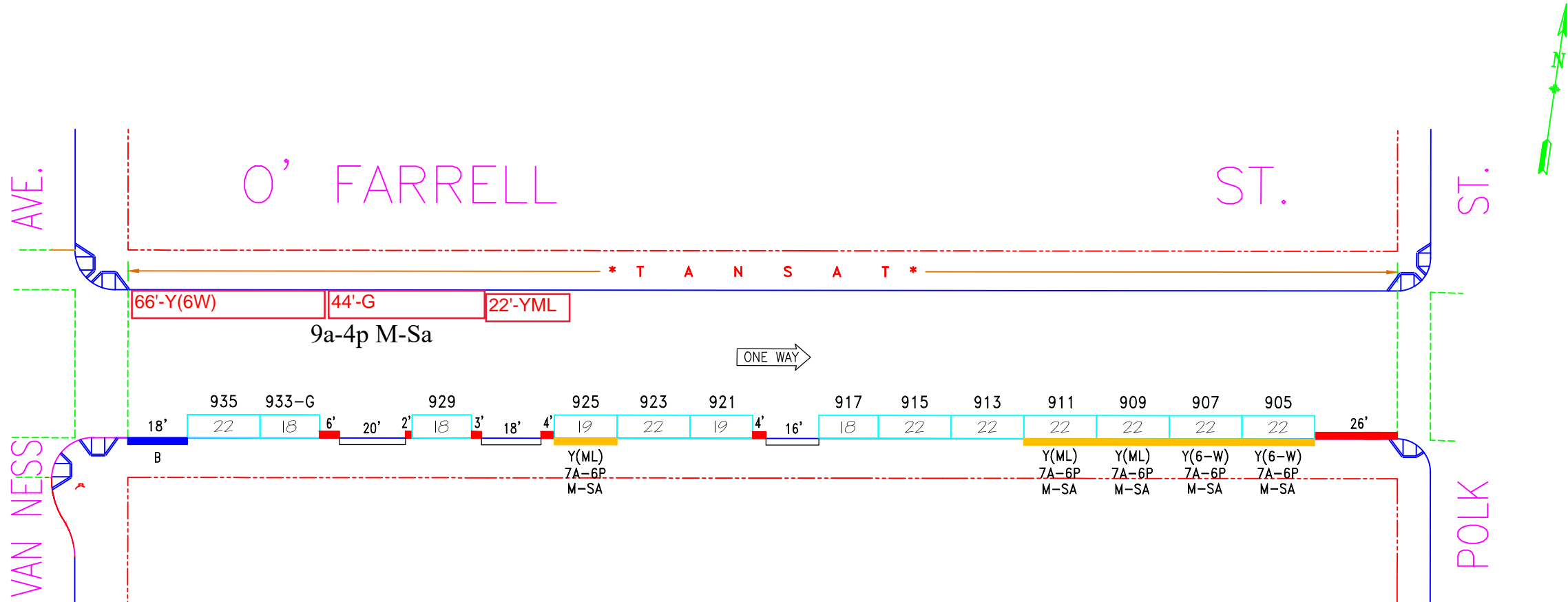

NO.	REVISION DESCRIPTION	BY	DATE	DIR/RES	3	RZ-MOS	6W#903(Est.6W#907,ML#911)	JB	6/2/20
1	Revoke 30min. green #911 & 913	JB	7/25/12	4067					
2	Establish Blue zone, MOS#937-S/S	JB	5/12/15	5382					

**SAN FRANCISCO MUNICIPAL TRANSPORTATION AGENCY**  
 CITY AND COUNTY OF SAN FRANCISCO  
 PARKING METER SPACES

SIDE	TOW-AWAY		METER CT.		GENERAL			LOADING		METERED SPACES							TOTAL
	AM	PM	SS	MS	GMP	MC	TIMES	DAYS	ML	MTL	6-W	15 MIN	30 MIN	1 HR	2 HR	10 HR	
ODD			13		8		9A-6P	M-SA	3		2		6		7		13
EVEN	7-9	4-6															

**O'FARRELL ST. (OFA, 593)**  
**(900) BLOCK**  
 Meters #593-09XXY  
**POLK ST. TO VAN NESS AVE.**

**AREA 3**

SCALE: 1" = 40'      DATE: 7/25/12      BY: JB



## Geary Street and O'farrell Street Road Diets Approaching Van Ness Avenue

The San Francisco Municipal Transportation Agency (SFMTA) proposes to modify the traffic striping on O'Farrell Street (Gough Street to Van Ness Avenue) and Geary Street (Polk Street to Van Ness Avenue) on segments approaching Van Ness Avenue. The goal of the project is to better facilitate the turning movements of large vehicles onto Van Ness Avenue (US101).

### Existing Conditions

The segment of Geary Street from Van Ness Avenue to Polk Street currently consists of a one-way westbound roadway with a right-turn lane, a bus and taxi through lane, a general traffic lane, and peak-hour tow-away travel lane. Vehicles travel uphill as they approach Van Ness Avenue, where traffic is controlled by a traffic signal. On Wednesday February 3, 2021, 345 through, 96 left-turning and 46 right-turning vehicles were counted during the PM peak hour.

The segment of O'Farrell Street from Gough Street to Polk Street currently consists of a one-way eastbound roadway with two lanes of general vehicle traffic, one bus/taxi lane that transitions to a right-turn pocket at Van Ness Avenue, and parallel parking on both sides of the Street. Vehicles travel downhill as they approach Van Ness Avenue, where traffic is controlled by a traffic signal. On Wednesday February 3, 2021, 246 through, 66 left-turning and 46 right-turning vehicles were counted during the AM peak hour. The Muni 38 Geary bus operates along both streets and has a bus stop on the nearside of the O'Farrell intersection, at the southwest corner, and the farside of the Geary intersection, at the northwest corner. These intersections are adjacent to the Uptown Tenderloin Historic District, listed on the National Register of Historic Places.

### Proposed Project

The scope of work would include the installation of new roadway traffic striping and signage to eliminate the left-most vehicle lanes such that the remaining general vehicle lanes carry both through and left-turn vehicle movements. This would reduce the number of lanes that general through vehicles can use on each street. Left turn-only lanes would be added on O'Farrell Street approaching Franklin Street, and on Geary Street approaching Polk Street.

Lane reduction would not affect Muni operations because buses would continue to have their own restricted transit lanes. Transit lanes would be enforced by the San Francisco Police Department and automated cameras would continue to be fixed on the front of Muni buses.

This work would not involve any excavation or physical construction beyond striping and signage changes.

**Approval Action:**

Issuance of signed Work Order

Categorically Exempt pursuant to CEQA Guidelines Section(s) 15301	
<i>Forrest Chamberlain</i>	3/10/2021
	Date
San Francisco Municipal Transportation Agency	
<i>Lauren Bihl</i>	3/10/2021
	Date
San Francisco Planning Department	

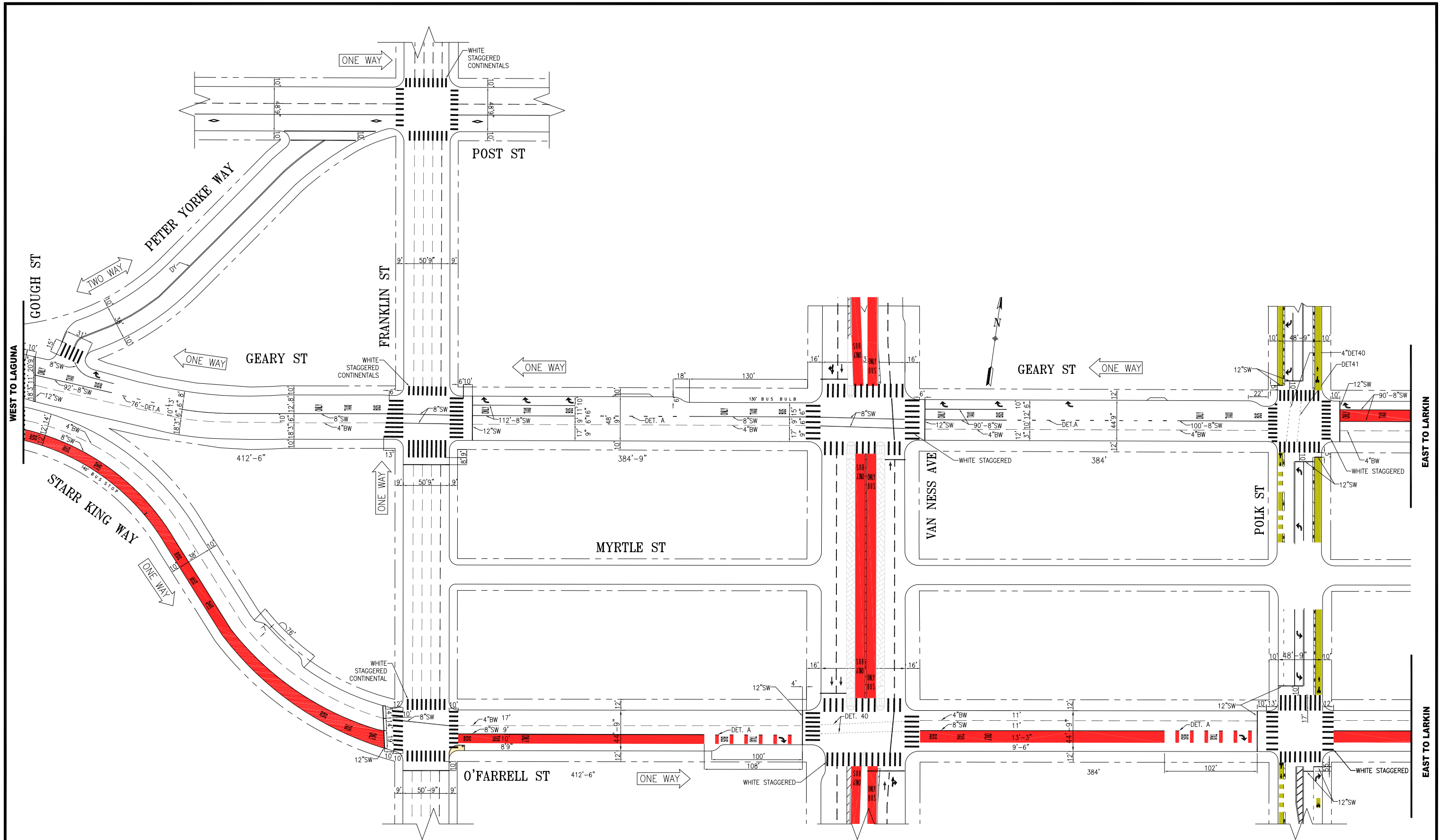

NO.	DATE	DESCRIPTION	BY	APP
TABLE OF REVISIONS				
CHECK WITH TRACING TO SEE IF YOU HAVE LATEST REVISION				



DRAWN:	D. MACKOWSKI	DATE:	01/15/21
CHECKED:		DATE:	

APPROVED	SCALE:
SENIOR ENGINEER	1" = 50'
CITY TRAFFIC ENGINEER	SHEET/SHEETS:
	1 OF 1

CURRENT TRAFFIC STRIPING DESIGN

GEARY AND O'FARRELL STREETS  
GOUGH STREET TO POLK STREET

CONTRACT NO.	
DRAWING NO.	STR-EXIST
FILE NO.	
REV. NO.	0

FILE NAME: ---  
DATE: ---

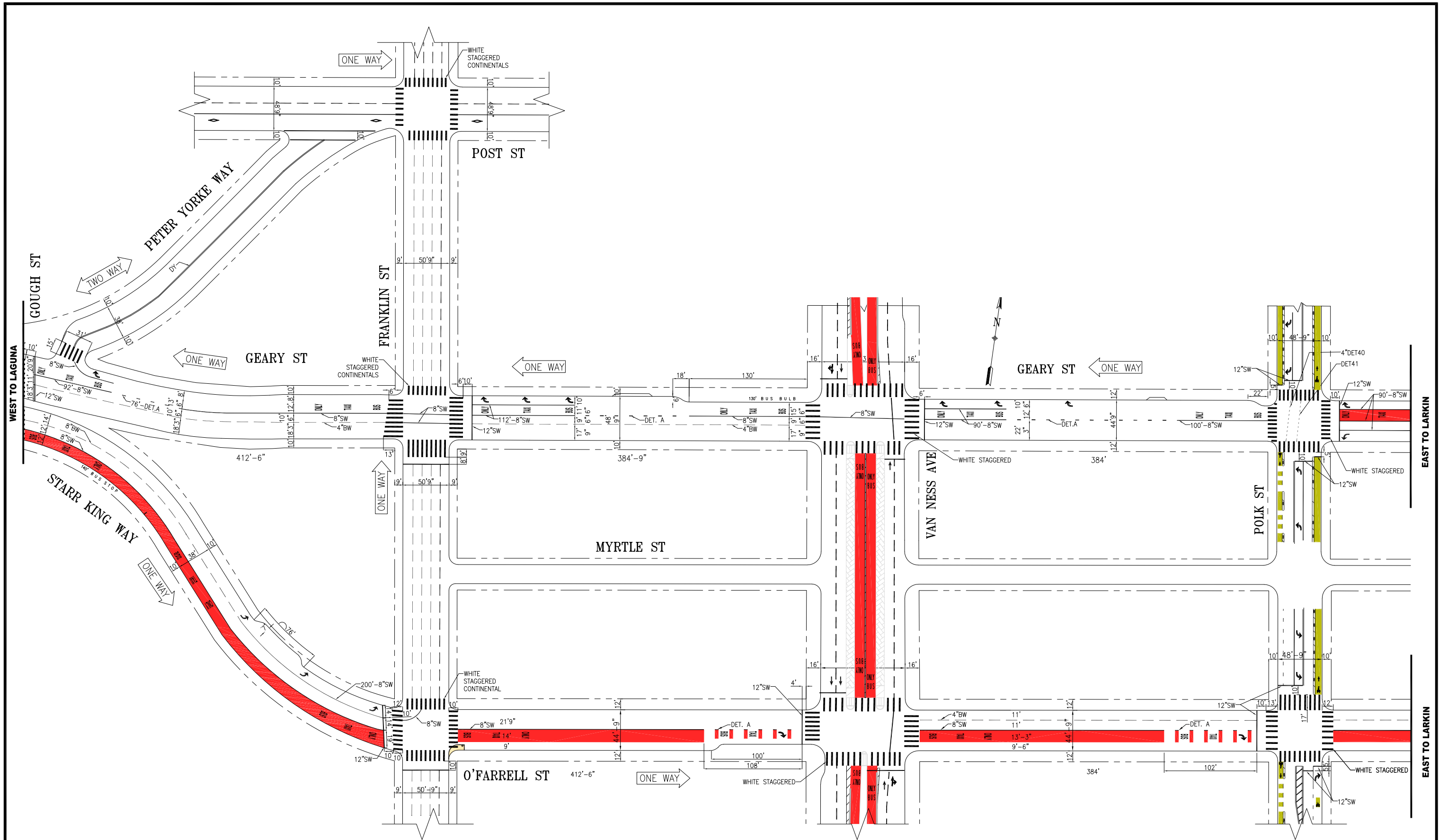

NO.	DATE	DESCRIPTION	BY	APP
TABLE OF REVISIONS				
CHECK WITH TRACING TO SEE IF YOU HAVE LATEST REVISION				



APPROVED	SCALE:
SENIOR ENGINEER	1" = 50'
CITY TRAFFIC ENGINEER	SHEET/SHEETS:
	1 OF 1

DRAWN:	DATE:
D. MACKOWSKI	01/15/21
CHECKED:	DATE:

APPROVED		SCALE:
SENIOR ENGINEER	DATE:	1" = 50'
CITY TRAFFIC ENGINEER	DATE:	SHEET/SHEETS:
		1 OF 1

**PROPOSED TRAFFIC STRIPING DESIGN**  
**GEARY AND O'FARRELL STREETS**  
**GOUGH STREET TO POLK STREET**

CONTRACT NO.
DRAWING NO.
STR-PROP'D
FILE NO.
REV. NO.
0

FILE NAME: / DATE: /



GEARY ST

6' LIMIT LINE (TYP)

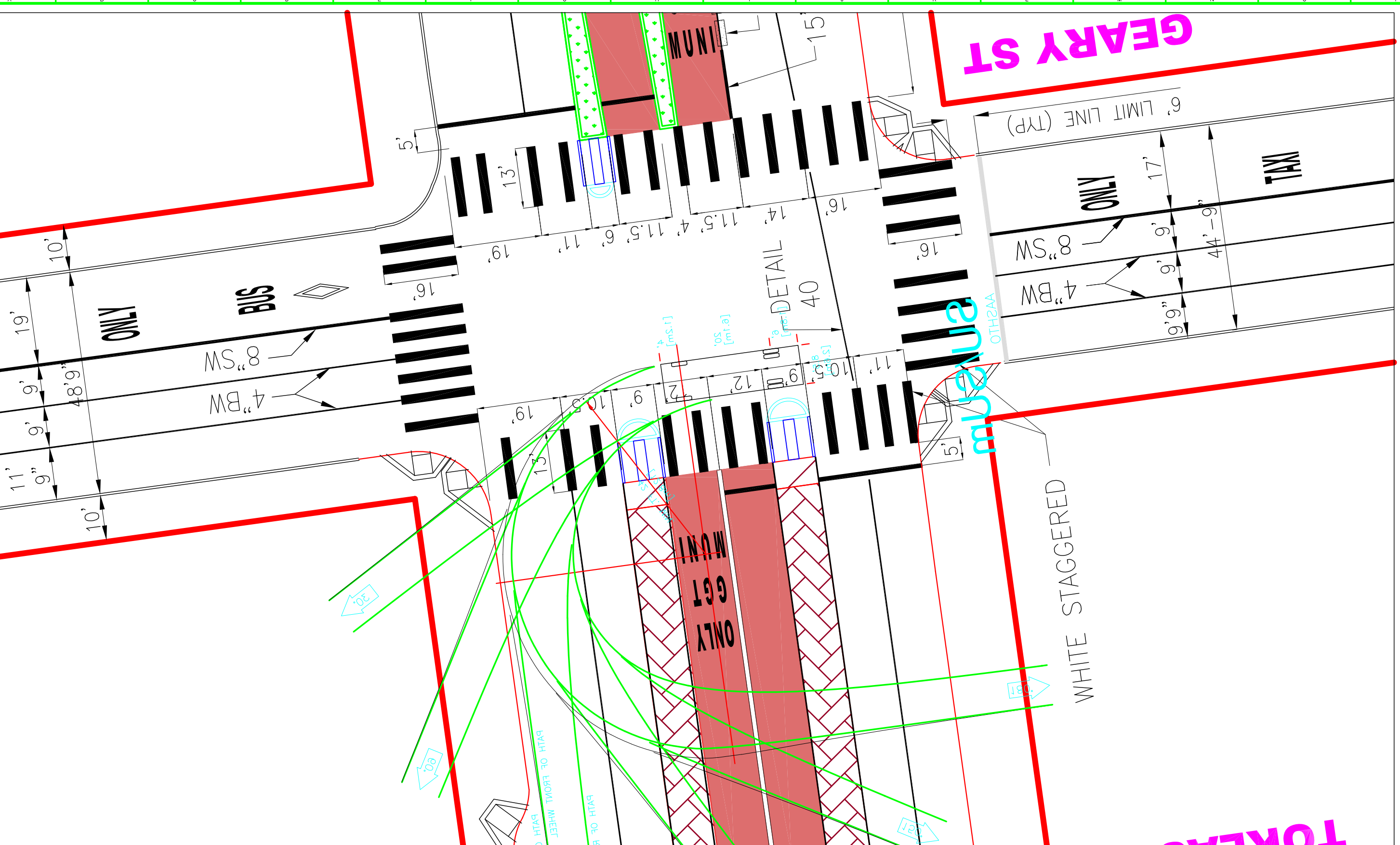

ONLY

BUS

TAXI

DETAIL

van ness

WHITE STAGGERED

TKLACK



SAN FRANCISCO MUNICIPAL TRANSPORTATION AGENCY  
 TRANSPORTATION ENGINEERING  
 CITY AND COUNTY OF SAN FRANCISCO

DESIGNED: DATE: 9/2020  
 DRAWN: DATE: 9/2020  
 CHECKED: DATE: 9/2020

APPROVED  
 SECTION ENGINEER  
 CITY TRAFFIC ENGINEER

SCALE:  
 AS SHOWN  
 SHEET OF SHEETS  
 XX OF XX

SPECIFICATION NO.  
 DRAWING NO.  
 FILE NO.  
 REV. NO.  
 VNBRT TURNING TEMPLATE  
 GEARY AND VAN NESS

NO.	DATE	DESCRIPTION	BY	APP.

TABLE OF REVISIONS  
 CHECK WITH TRACING TO SEE IF YOU HAVE LATEST REVISION

REFERENCE INFORMATION  
 & FILE NO. OF SURVEYS

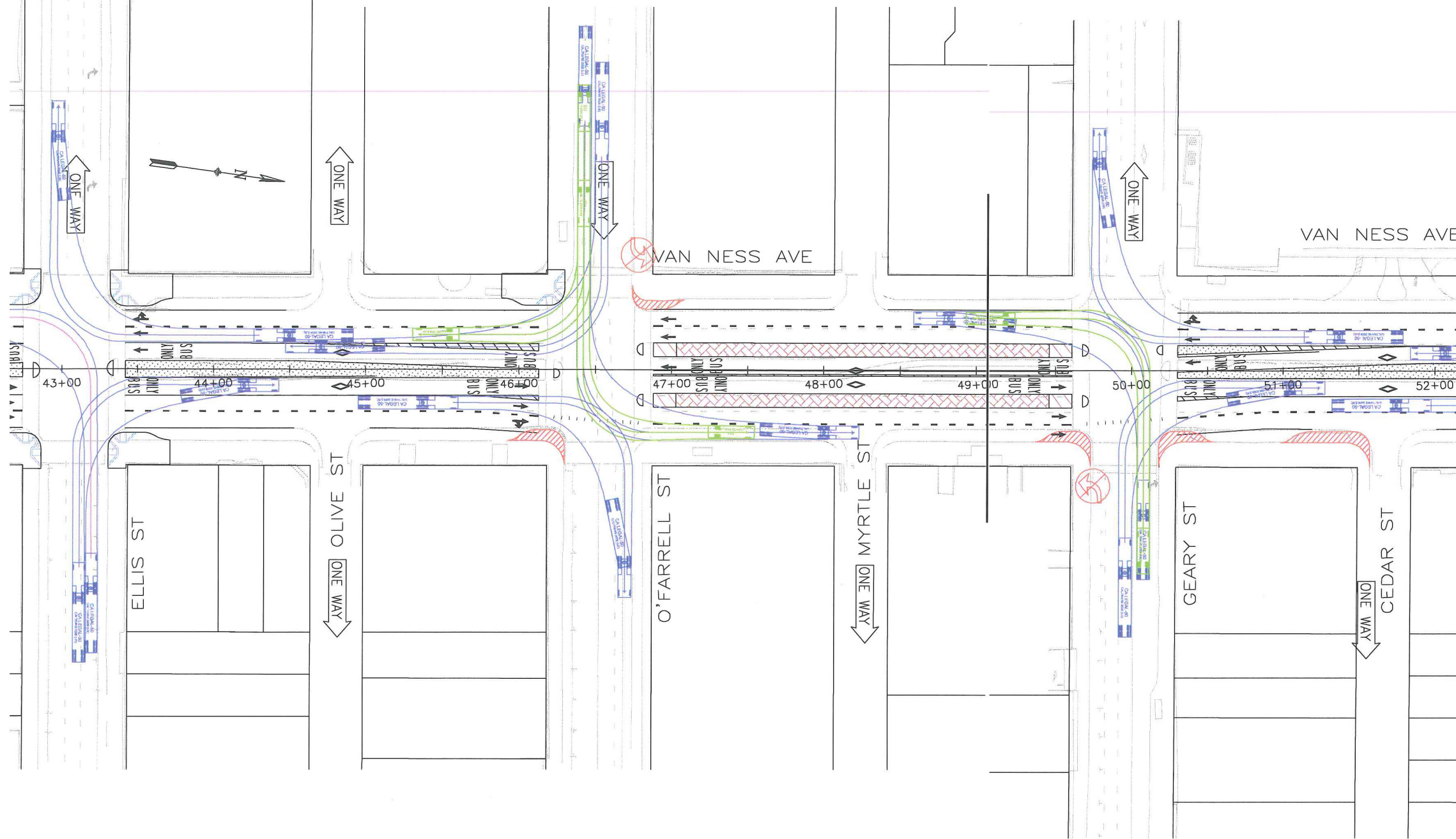
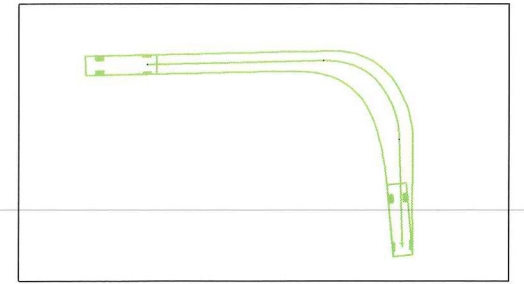
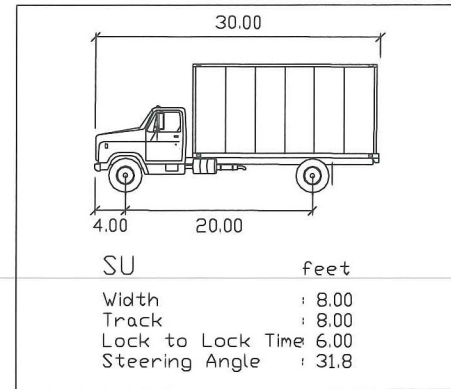
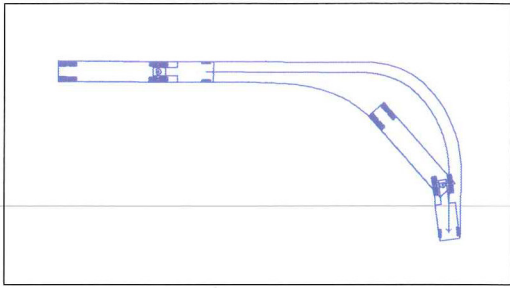
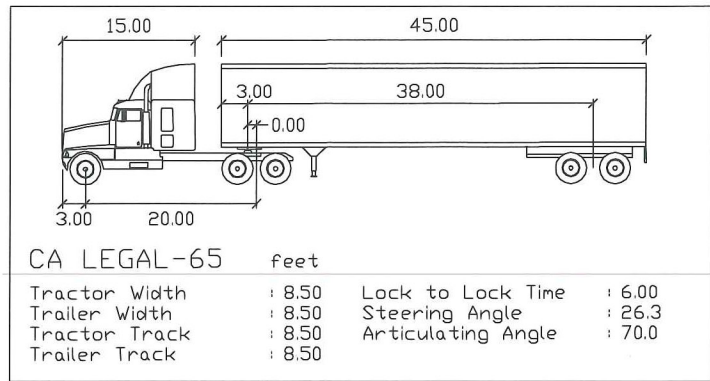

Sheets 4 & 5 compiled

## TRUCK TURNS-4-5

May 06, 2013 - 11:24am R:\646904 - Van Ness\Studies\Truck Turning Analysis\904-CV-TRUCK TURN EXHIBIT.dwg

TABLE OF REVISIONS		
NO.	DATE	DESCRIPTION
E	04/01/13	
D	11/30/12	
C	10/3/12	
B	5/22/09	
A	12/11/06	

CHECK WITH TRACING TO SEE IF YOU HAVE LATEST REVISION

REFERENCE INFORMATION & FILE NO. OF SURVEYS	
SUPERCEDES STR-5458.2 REV "4"	

CU: 04XXX  
EA: 3A270

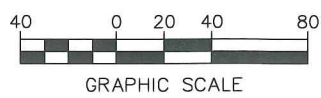

DESIGNED: DATE:	EK 05/13	APPROVED	SCALE:
DRAWN: DATE:	EK 05/13	SECTION ENGINEER DATE:	1"=80'
CHECKED: DATE:	KF 05/13		SHEET OF SHEETS
		DEP. DIRECTOR AND DATE:	4 OF 9
		CITY TRAFFIC ENGINEER	

**Van Ness Avenue  
Bus Rapid Transit Study**

**LPA Alternative: Center Lane BRT with Right Side Boarding/Single Median and Limited Left Turns**

CONTRACT NO.	
DRAWING NO.	A4-4
FILE NO.	
REV. NO.	E

T:\I.E.\_FILES\Construction Section\PERSONNEL\PPY temp\VAN\_NESS\_BRT\100% STRIP & final base updated 6-10-15.cdw\ CPT6401 18--T13.dwg aveng3 Mon Aug 03,2015 -- 4:07 pm

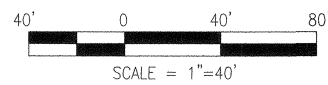
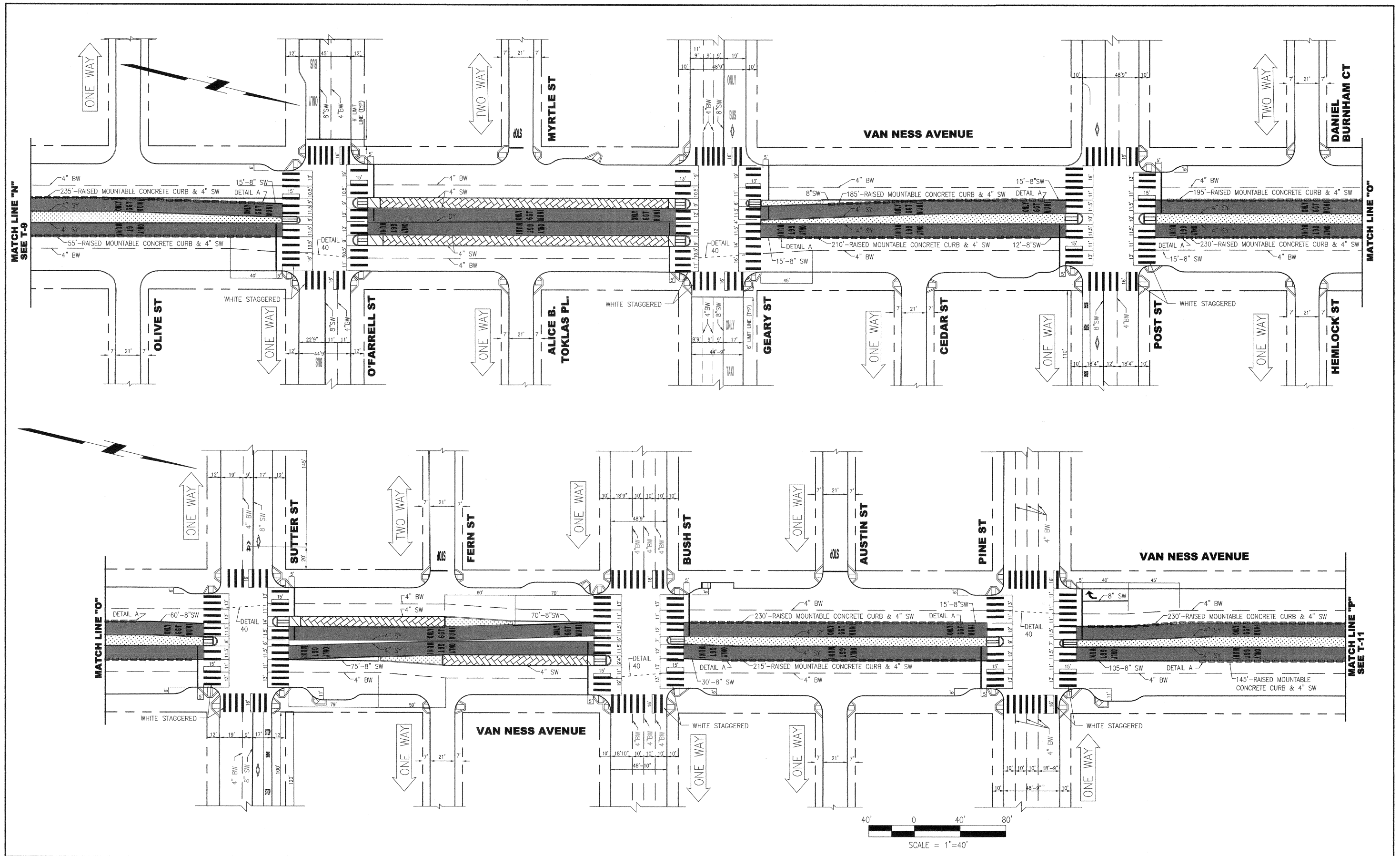

NO.	DATE	DESCRIPTION	REVISED	CHECKED	APPROVED
REVISIONS					

DESIGNED *Km...* 07-31-15  
 DRAWN *Alamy* 7/31/15  
 CHECKED  
 REVIEWED  
 RECOMMENDED  
 APPROVED  
 DATE

REGISTERED PROFESSIONAL ENGINEER  
 CYNTHIA HU  
 No. TR 2340  
 Exp.  
 TRAFFIC  
 STATE OF CALIFORNIA

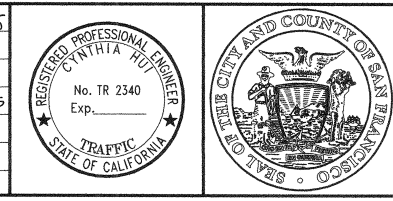

CITY AND COUNTY OF SAN FRANCISCO  
**MUNICIPAL TRANSPORTATION AGENCY**  
 APPROVED  
 for the DIRECTOR OF TRANSPORTATION

MUNI BUS RAPID TRANSIT SYSTEM  
**VAN NESS CORRIDOR TRANSIT IMPROVEMENT PROJECT**  
 FINAL TRAFFIC STRIPING PLAN  
 VAN NESS AVE FROM OLIVE ST TO PINE ST

1289	
T-10	REVISION
T-13	0

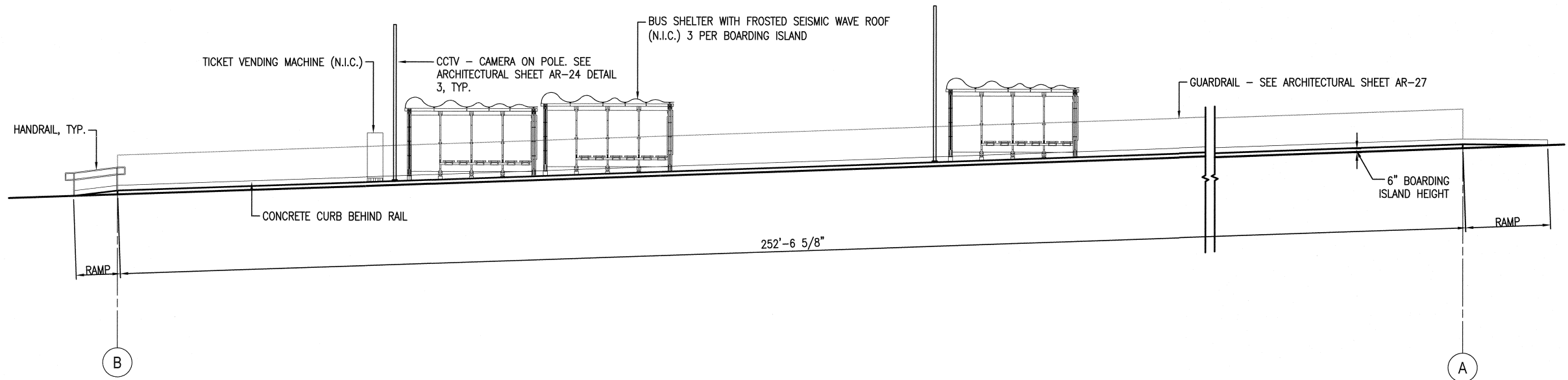

**1 WEST ELEVATION AT O'FARRELL ST. (NORTHBOUND)**  
SCALE: 1/8" = 1'-0"

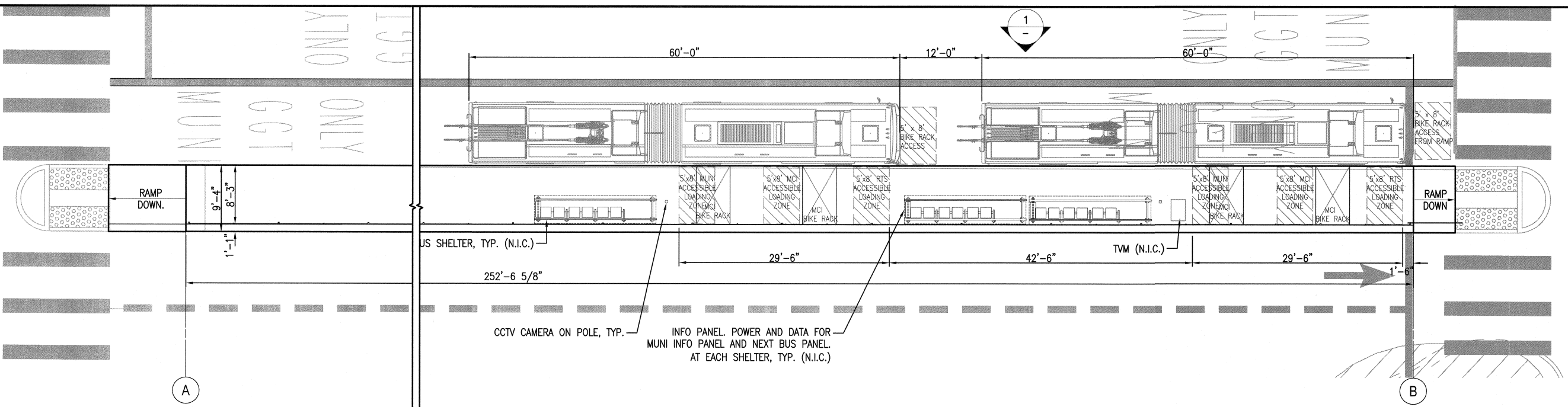

**2 BOARDING ISLAND PLAN AT O'FARRELL ST. (NORTHBOUND)**  
SCALE: 1/8" = 1'-0"

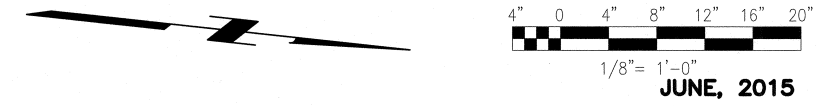

N:\21061-MTA BRT VAN NESS AVENUE\CAD\100% Deliverables\AR-07 O'Farrell Station.dwg babuyygh Wed Jun 24 2015 4:04 pm

NO.	DATE	DESCRIPTION	REVISED	CHECKED	APPROVED
REVISIONS					

BUILDING DESIGN AND CONSTRUCTION  
DEPARTMENT OF PUBLIC WORKS  
CITY AND COUNTY OF SAN FRANCISCO  
30 Van Ness Avenue Suite 4100  
San Francisco, CA (415) 557-4700  
94102-9028 Fax (415) 557-4701

DESIGNED	PTG
DRAWN	SR
CHECKED	KZ
REVIEWED	PTG
RECOMMENDED	
APPROVED	
DATE	

CITY AND COUNTY OF SAN FRANCISCO  
**MUNICIPAL TRANSPORTATION AGENCY**  
  
APPROVED  
  
for the DIRECTOR OF TRANSPORTATION

MUNI BUS RAPID TRANSIT SYSTEM  
**VAN NESS CORRIDOR TRANSIT IMPROVEMENT PROJECT**  
  
BOARDING ISLAND PLAN AT O'FARRELL ST.  
NORTHBOUND

1289	REVISION
CL-28884	0
AR-07	
AR-30	

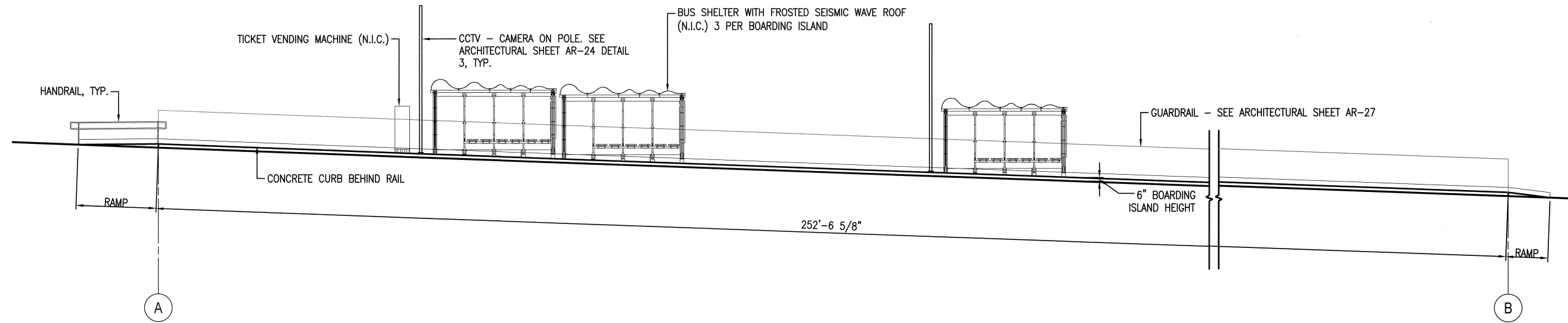

**1 EAST ELEVATION AT O'FARREL ST. (SOUTHBOUND)**  
SCALE: 1/8" = 1'-0"

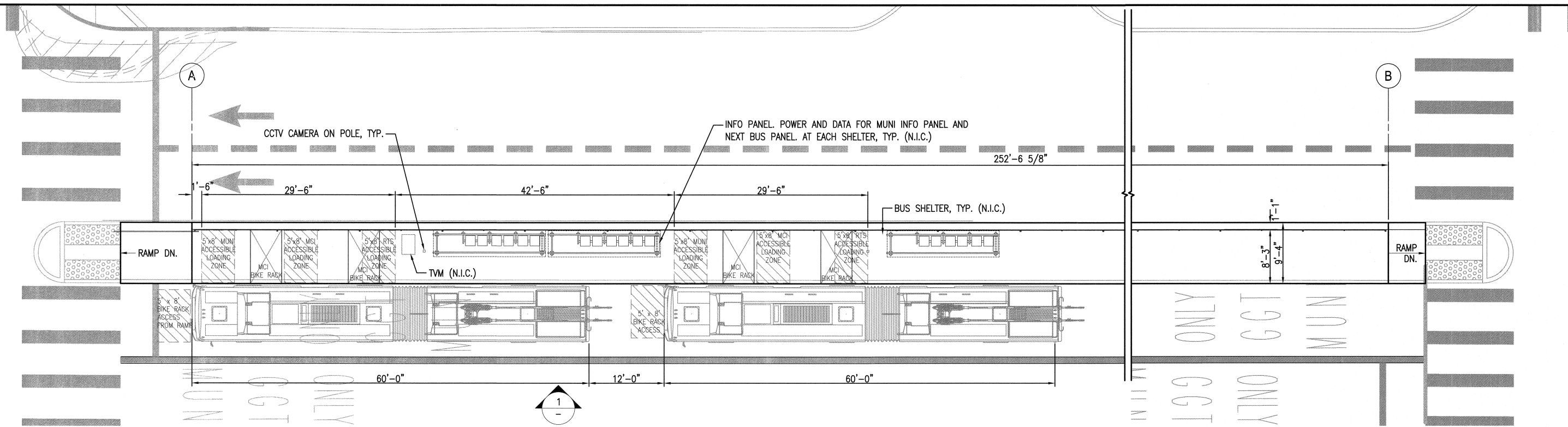

**2 BOARDING ISLAND PLAN AT O'FARREL ST. (SOUTHBOUND)**  
SCALE: 1/8" = 1'-0"

N:\21061-MTA BRT VAN NESS AVENUE\CAD\100% Deliverables\AR-08 O'Farrel Station.dwg aabuyyogh Wed Jun 24 2015 4:03 pm

NO.	DATE	DESCRIPTION	REVISED	CHECKED	APPROVED
REVISIONS					

BUILDING DESIGN AND CONSTRUCTION  
DEPARTMENT OF PUBLIC WORKS  
CITY AND COUNTY OF SAN FRANCISCO  
30 Van Ness Avenue  
San Francisco, CA 94102-4028  
Suite 4100  
(415) 557-4700  
Fax (415) 557-4701

DESIGNED	ptg
DRAWN	SR
CHECKED	KZ
REVIEWED	ptg
RECOMMENDED	
APPROVED	
DATE	

LICENSED ARCHITECT  
WILL W. HANCOCK  
NO. C - 18253  
REN. 11/2015  
STATE OF CALIFORNIA

CITY AND COUNTY OF SAN FRANCISCO  
**MUNICIPAL TRANSPORTATION AGENCY**  
APPROVED  
for the DIRECTOR OF TRANSPORTATION

MUNI BUS RAPID TRANSIT SYSTEM  
**VAN NESS CORRIDOR TRANSIT IMPROVEMENT PROJECT**  
BOARDING ISLAND PLAN AT O'FARREL ST.  
SOUTHBOUND

1289	REVISION
CL-28885	0
AR-08	
AR-30	

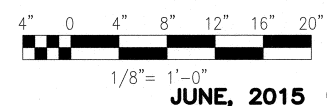

JUNE, 2015

I:\T\_E\_FILES\SF\Projects\Van Ness BRT\Signal Design\CADD\GP18-401ETBS - 100% Revised - CMGC Copy.dwg kkrong Thu Nov 19, 2015 - 12:52 pm  
 BORDER REVISED 11/17/05

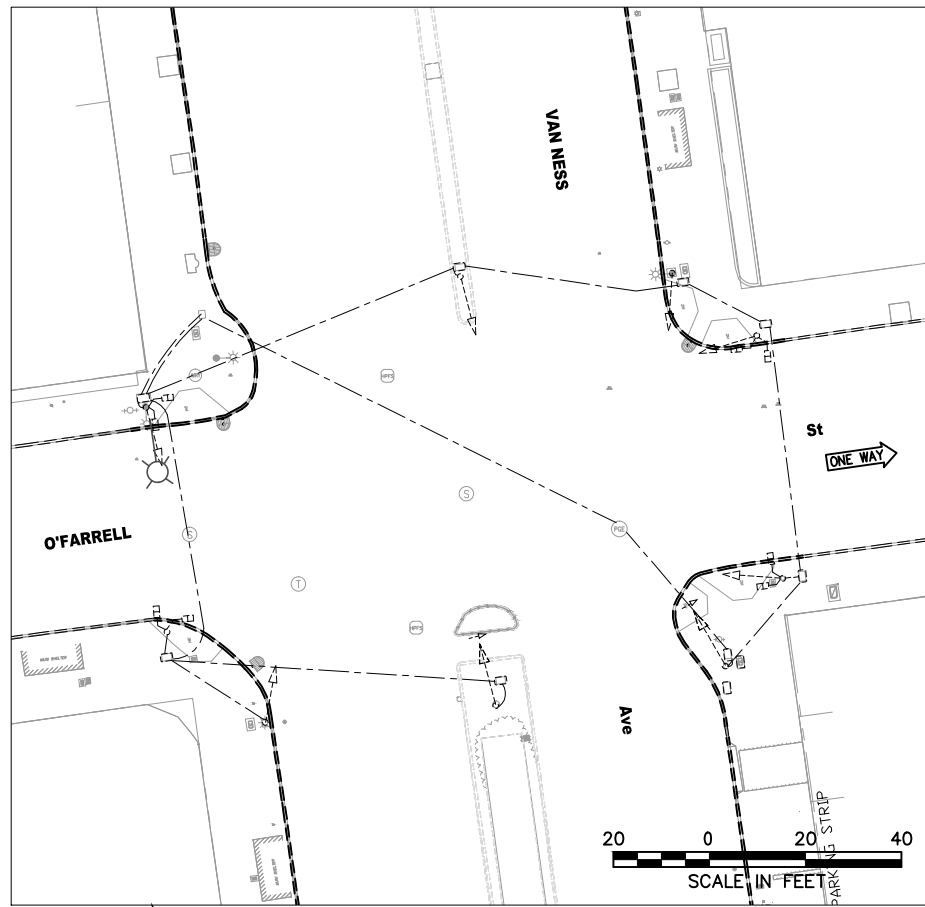

**EXISTING EQUIPMENT**

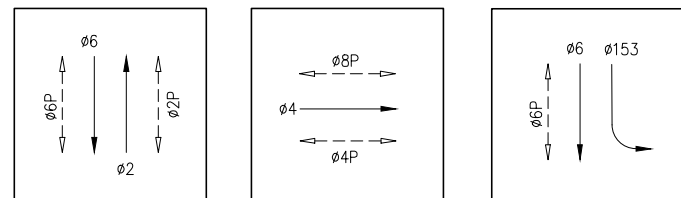

**PHASE DIAGRAM**

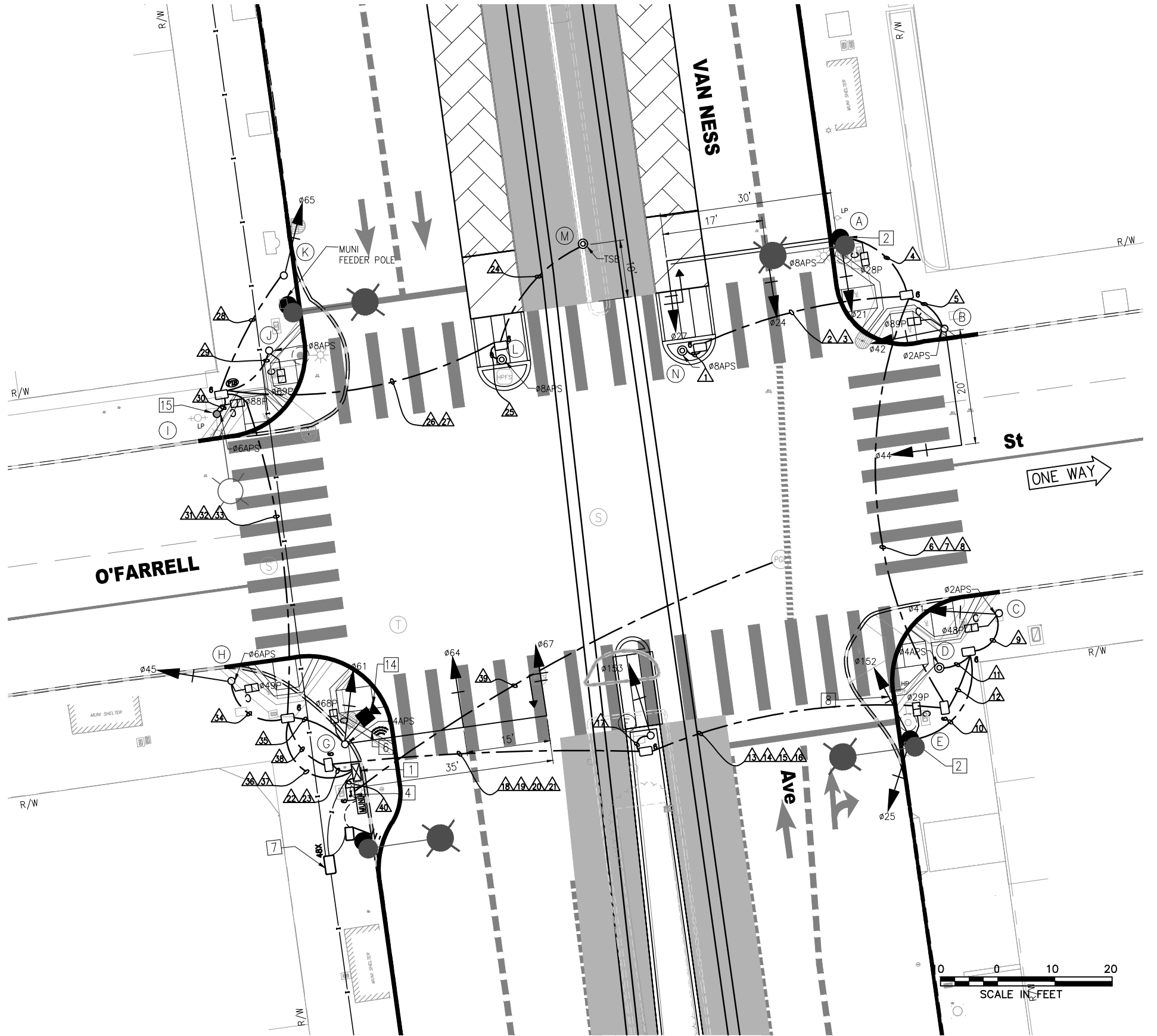

NO.	DATE	DESCRIPTION	REVISED	CHECKED	APPROVED

DESIGNED	
DRAWN	
CHECKED	
REVIEWED	
RECOMMENDED	
APPROVED	
DATE	



CITY AND COUNTY OF SAN FRANCISCO  
**MUNICIPAL TRANSPORTATION AGENCY**  
 APPROVED  
 for the DIRECTOR OF TRANSPORTATION

MUNI BUS RAPID TRANSIT SYSTEM		1289
VAN NESS CORRIDOR TRANSIT IMPROVEMENT PROJECT		
O'FARRELL STREET TRAFFIC SIGNAL WORK		ET-111.0
		REVISION
		ET-204

I:\T\_E\_FILES\SF\Projects\Van Ness BRT\Signal Design\CADD\GP18-01ETBS - 100% Revised - CMGC Copying.kwg Thu Nov 19, 2015 - 12:52 pm  
 BORDER REVISED 11/17/05

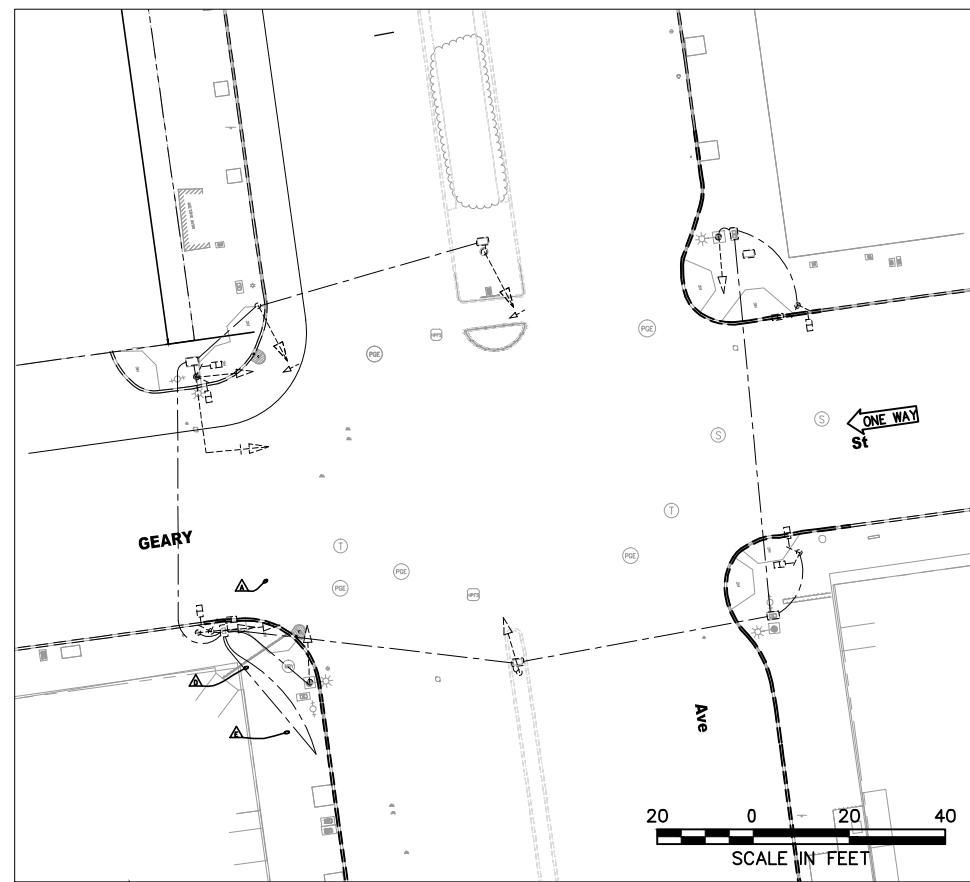

**EXISTING EQUIPMENT**

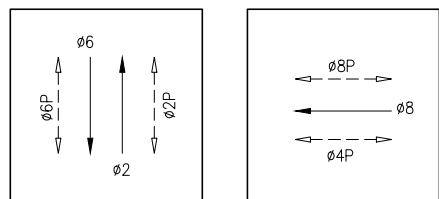
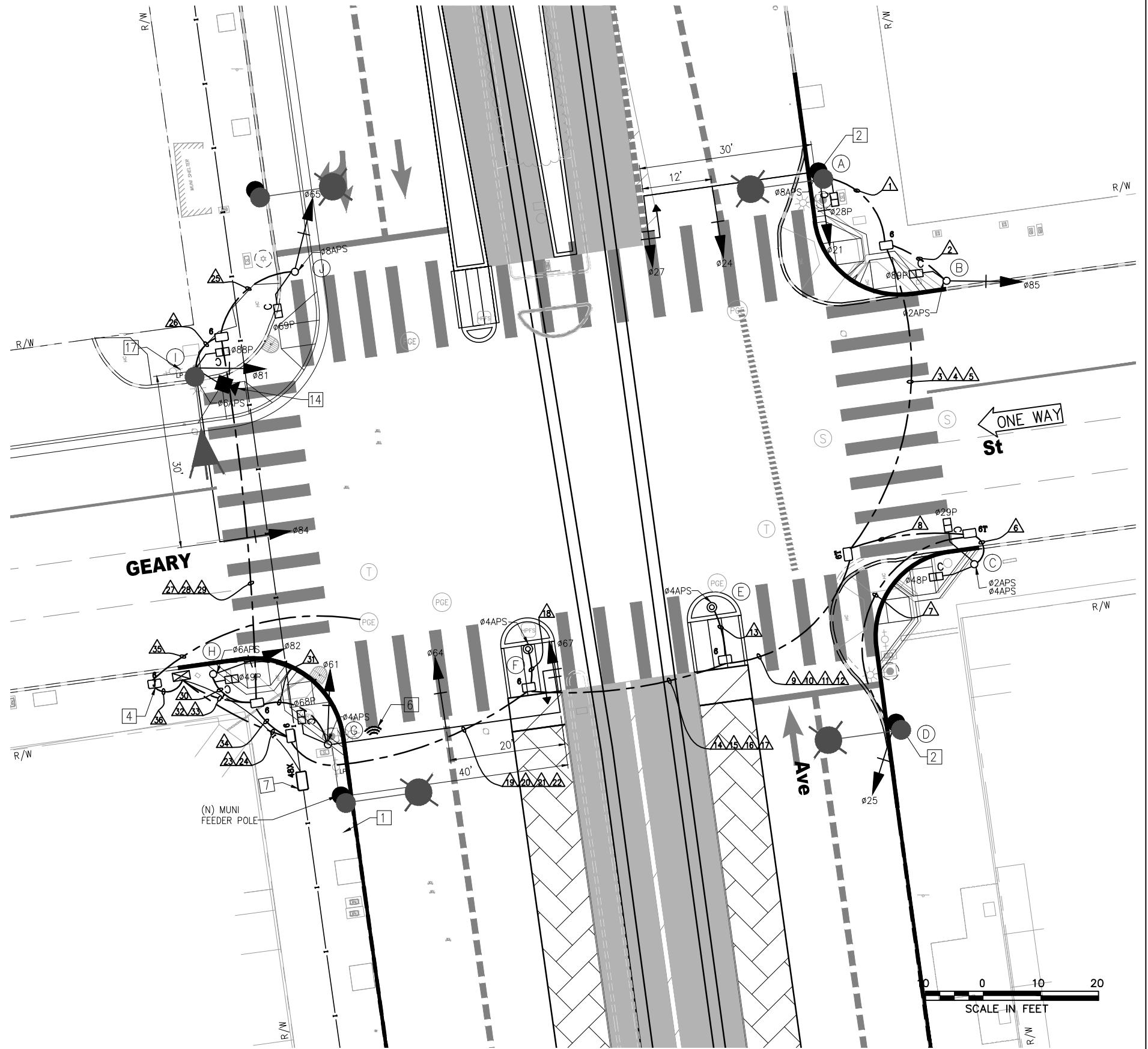

**PHASE DIAGRAM**

NO.	DATE	DESCRIPTION	REVISED	CHECKED	APPROVED
1	11/16/15	SE CORNER CONDUIT/PULLBOX REVISED			

DESIGNED	
DRAWN	
CHECKED	
REVIEWED	
RECOMMENDED	
APPROVED	
DATE	



CITY AND COUNTY OF SAN FRANCISCO  
**MUNICIPAL TRANSPORTATION AGENCY**  
 APPROVED  
 for the DIRECTOR OF TRANSPORTATION

MUNI BUS RAPID TRANSIT SYSTEM VAN NESS CORRIDOR TRANSIT IMPROVEMENT PROJECT		1289
<b>GEARY STREET TRAFFIC SIGNAL WORK</b>		ET-112.0 ET-204