

SFMTA - TASC SUMMARY SHEET

PreStaff_Date: n/a Requested_by: SFMTA Handled: Hester Yu KK Section Head : CL BT for CL	<input type="checkbox"/> Public Hearing Consent <input type="checkbox"/> Public Hearing Regular <input checked="" type="checkbox"/> Informational / Other <small>No TASC - PH Only</small>	No objections: _____ Item Held: _____ Other: _____
---	--	---

Location: Topeka Avenue and Apollo Street

Subject: Red Zone

PROPOSAL / REQUEST:

ESTABLISH – RED ZONE

Topeka Avenue, west side, from Apollo Street to 20 feet northerly
 Apollo Street, south side, from Topeka Avenue west property line to 25 feet easterly (25 feet of red curb around the southwest corner)

Proposal to install red curbs to improve Muni operations for the 54 Felton

Hester Yu, hester.yu@sfmta.com

(Supervisor District 10)

BACKGROUND INFORMATION / COMMENTS

The 54 Felton runs in both directions on Topeka Avenue with a 20-minute frequency. If two buses meet at Topeka Ave and Apollo St, there is not enough clear space for the buses to navigate around or pass each other. The situation also applies for large vehicles. The red zones will create a clearance space for southbound vehicles

Topeka Ave street width: 30 feet with parking on both sides.

Collision History (past 5 years)

- 0 traffic collisions
- 4 transit collisions

HEARING NOTIFICATION AND PROCESSING NOTES:

ENVIRONMENTAL CLEARANCE BY:

SFMTA Attached Pending

CHECK IF PREPARING SEPARATE SFMTA BOARD CALENDAR ITEM FOR PROPOSAL:



Map

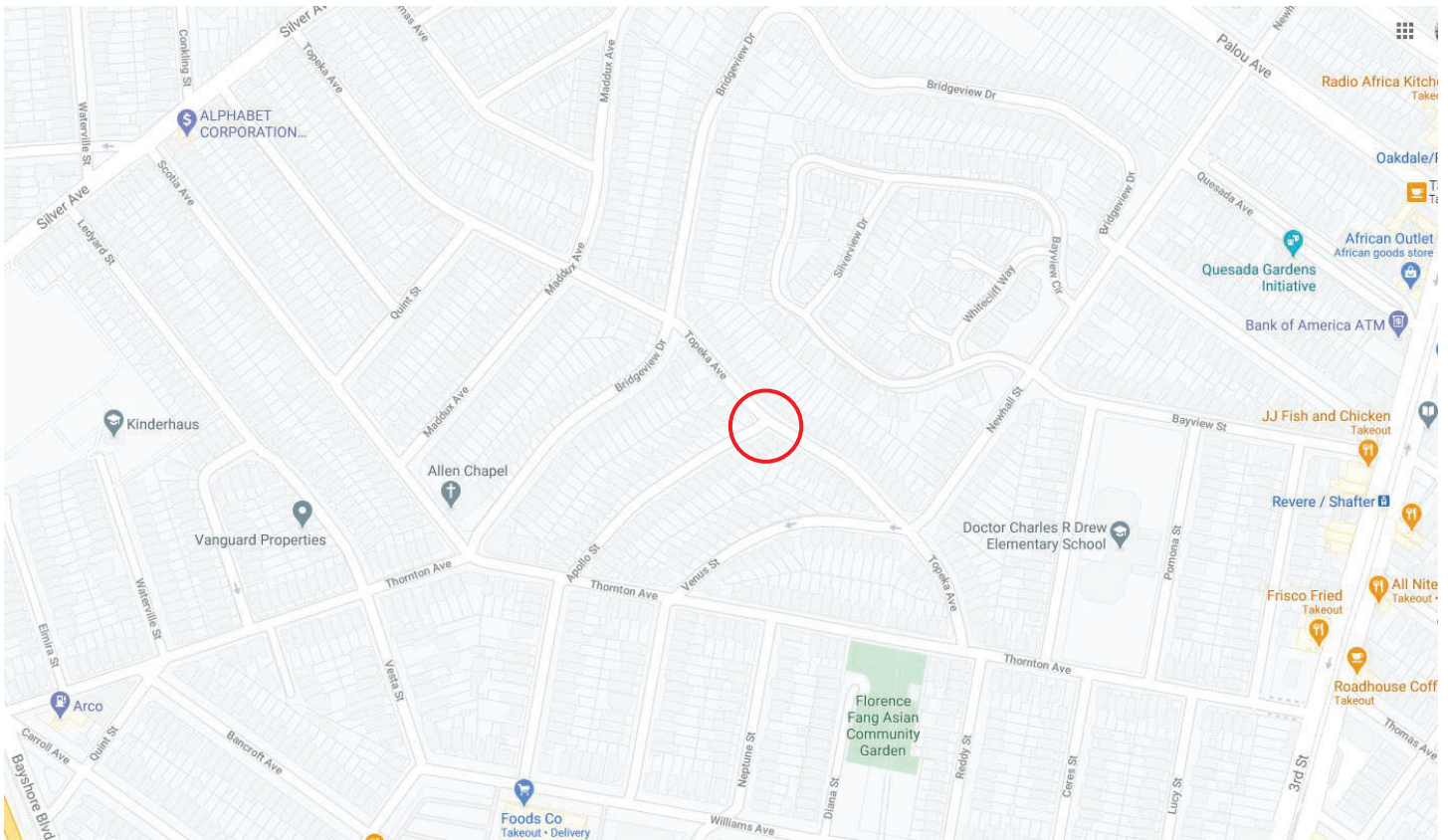

Muni Map

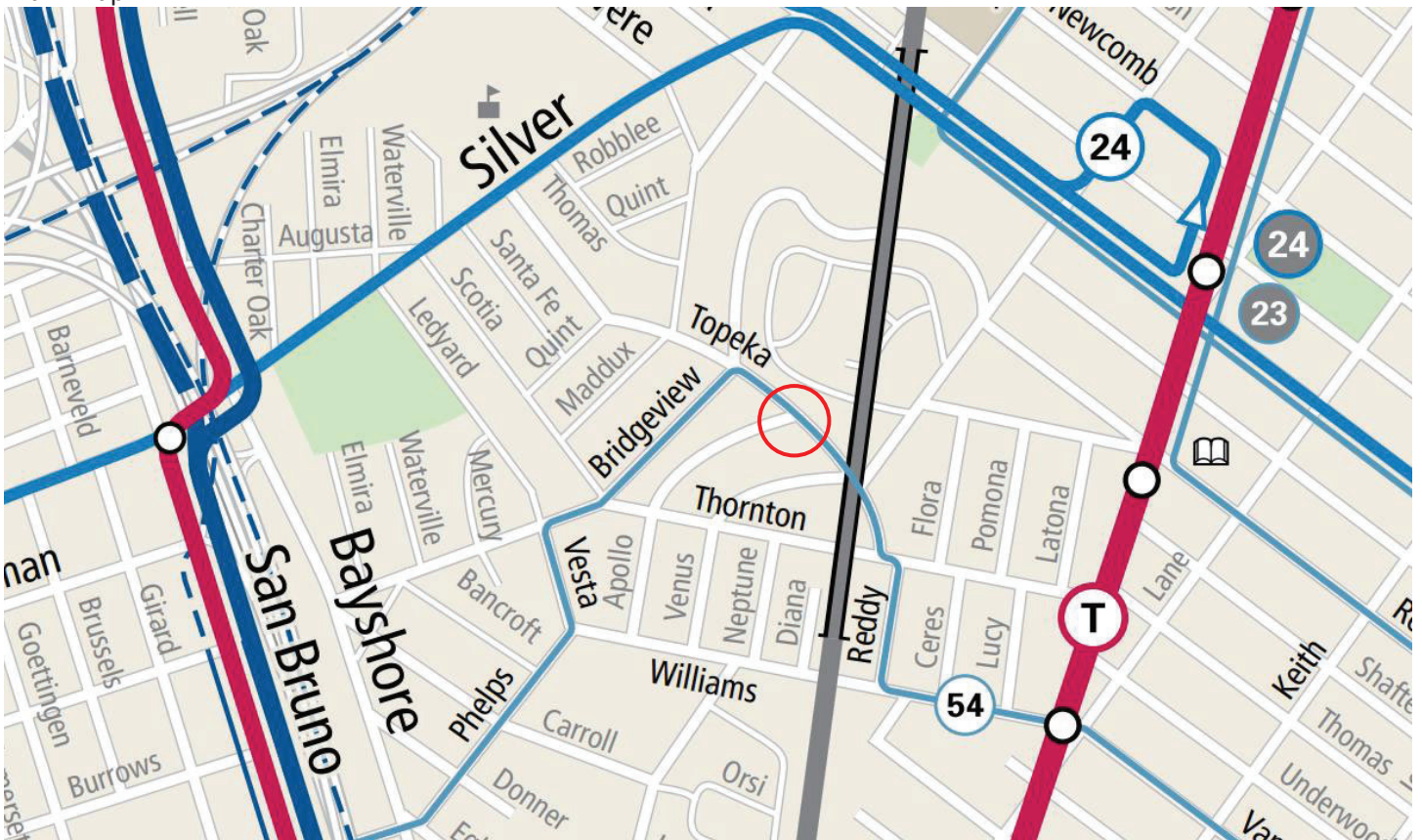

Topeka Ave and Apollo St – facing south on Topeka
- Cars are often parked around the corners



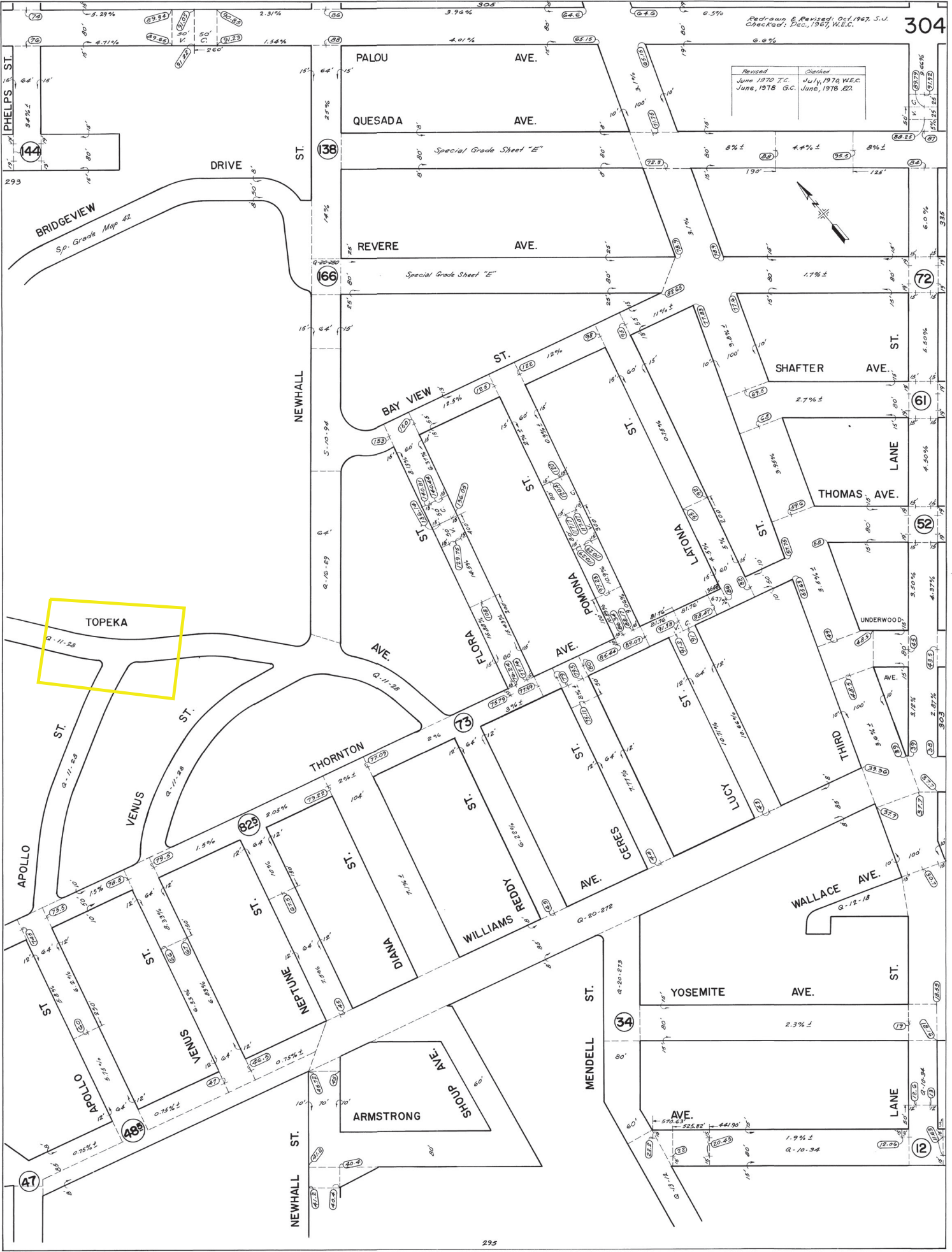

Redrawn & Revised: Oct. 1967, S.U.
 Checked: Dec. 1967, W.E.C.

Revised	Checked
June, 1970 T.C.	July, 1970, W.E.C.
June, 1978 G.C.	June, 1978 G.C.

304

TOPEKA

TransBASE Internal Dashboard

Geographic Extent: 20533000: APOLLO ST at TOPEKA AVE
Spatial Intersect: SFMTA Intersection Related (<=20ft or <=150ft if Rear End)
Data Range: 07/01/2015 to 06/30/2020
Pull Date: 10/28/2020

Geographic Extent



COLLISION HISTORY SUMMARY (past 5 years)

- 0 traffic collisions
- 4 transit collisions

TransBASE Internal Dashboard

Geographic Extent: 20533000: APOLLO ST at TOPEKA AVE

Spatial Intersect: SFMTA Intersection Related (<=20ft or <=150ft if Rear End)

Data Range: 07/01/2015 to 06/30/2020

Pull Date: 10/28/2020

Collision/Party/Victim Table

Showing 0 to 0 of 0 entries

Count of Fatal Collisions: 0

Count of Non-Fatal Injury Collisions: 0

Total Count of Fatal/Non-Fatal Injury Collisions: 0

Case ID	Collision Date	Collision Time	Day of Week	Primary Road	Secondary Road	Distance	Direction	Party 1 Type	Party 1 Direction of Travel	Party 1 Movement Preceding Crash	Party 2 Type	Party 2 Direction of Travel	Party 2 Movement Preceding Crash	Vehicle Code Violation	Highest Degree of Injury	Type of Collision	Motor Vehicle Involved With	Weather	Lighting
None																			

TransBASE Internal Dashboard

Geographic Extent: 20533000: APOLLO ST at TOPEKA AVE

Spatial Intersect: SFMTA Intersection Related (<=20ft or <=150ft if Rear End)

Data Range: 07/01/2015 to 06/30/2020

Pull Date: 10/28/2020

Metadata Information

Collision Filters

Database Source: TransBASESF.org

Database Pull Date: 10/28/2020

Collision Level: Injury Collisions

Boundary: 20533000: APOLLO ST at TOPEKA AVE

Collision Dates: 07/01/2015 to 06/30/2020

Collision Month Filter(s): No Restrictions

Collision Distance: Any Distance

Collision Severity Filter(s): No Restrictions

Primary Collision Factor Filter(s): No Restrictions

Collision Type Filter(s): No Restrictions

Intersection/ Midblock: SFMTA Intersection Related (<=20ft or <=150ft if Rear End)

Party Filters

Party Involved Type: No Restrictions

Party Involved Gender: No Restrictions

Party Involved at Fault: No Restrictions

Party Involved Age: No Restriction

Party Involved Sobriety: No Restrictions

Party Involved Condition: No Restrictions

Party Involved Direction of Travel: No Restrictions

Party Involved Safety Equipment 1: No Restrictions

Party Involved Safety Equipment 2: No Restrictions

Party Involved Insurance: No Restrictions

Party Involved Other Associated Factors : No Restrictions

Party Involved Movement Preceding Collision: No Restrictions

Party Involved Vehicle Type: No Restrictions

Party Involved Race: No Restrictions

Party Involved Special Info: No Restrictions

Victim Filters

Victim Involved Role: No Restrictions

Victim Involved Degree of Injury: No Restrictions

Victim Involved Age: No Restriction

Victim Involved Seating Position: No Restrictions

Victim Involved Safety Equipment: No Restrictions

Victim Involved Ejected: No Restrictions

Environmental Filters

Nearest Traffic Control: No Restriction

Intersecting Speed Limit: No Restriction

Intersecting Network: No Restriction

Intersecting Street Class: No Restriction

Weather Description: No Restrictions

Lighting Description: No Restrictions