

# BAYVIEW COMMUNITY BASED TRANSPORTATION PLAN



## WHAT WE HEARD FROM YOU

**1500 RESIDENTS, 5 WORKSHOPS, 8 COMMUNITY EVENTS, 6 MEETINGS**

The Bayview CBTP spent all summer and fall talking with Bayview residents about what's most important to them. Below are our priorities for transportation improvements.

### YOUR PRIORITIES

1. Safer to walk places
2. Better transit service
3. Safety on transit
4. Less traffic
5. New transit routes
6. Better sidewalks
7. Easier to park
8. More travel options
9. Safer to bike places
10. Better bike routes

### YOUR STREET ISSUES

1. T-Third switchbacks/service
2. More bus shelters
3. More street lighting
4. More NextBus displays
5. Traffic calming/speeding cars
6. Sidewalk quality
7. Safer crosswalks
8. Parking restrictions near 3rd
9. Safe bike routes to rest of SF
10. Sidewalk gaps

### PRIORITY STREETS

1. 3rd Street
2. Evans Ave/Hunters Point Blvd
3. Hudson Ave
4. Oakdale Ave
5. Phelps St
6. Carroll Ave
7. Jennings Ave
8. Silver Ave
9. Quesada Ave
10. Williams Ave

## WHAT IMPROVEMENTS DOES THE BAYVIEW CBTP INCLUDE?

### RAPID IMPLEMENTATION

Quick fixes for problem spots in the community before the plan is adopted.

### 5-YEAR INVESTMENT PLAN

Infrastructure addressing the Bayview's most pressing needs over the next 5 years.

### BETTER TRANSIT ACCESS

Community-based programs and services to make sure transit meets your needs.

## OUR PROMISE TO THE BAYVIEW COMMUNITY

### ACCOUNTABILITY

An equitable investment plan that creates real results within 5 years of adoption.

### PRESERVING THE COMMUNITY'S VOICE

A plan centered on the lived experience and aspirations of the Bayview community.

### TRUST & TRANSPARENCY

Outreach, communication, and decision-making that is inclusive and equitable.

### ONE AGENCY, CONNECTED

A plan where recommendations are tied to real commitments and direct actions.

## HOW LONG WILL THE BAYVIEW CBTP TAKE?

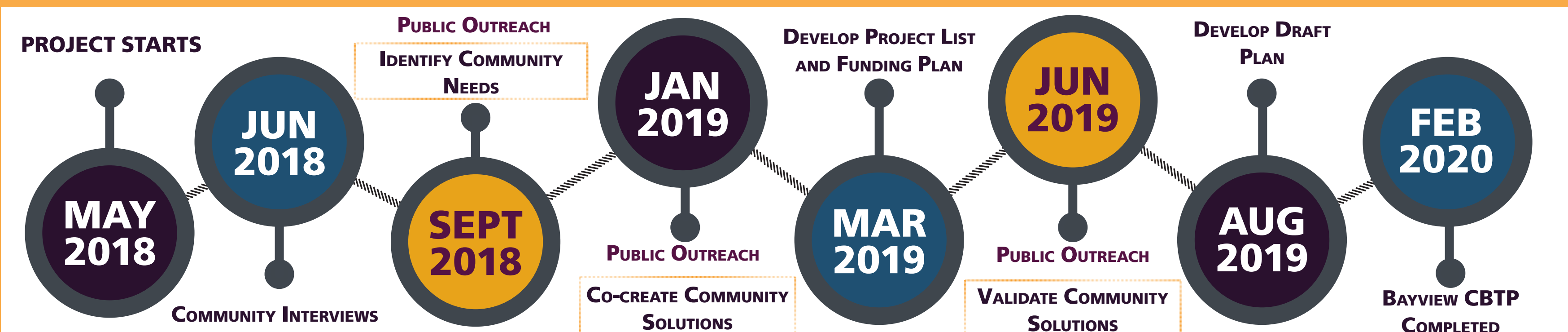

## BAYVIEW CORRIDORS





# BAYVIEW COMMUNITY BASED TRANSPORTATION PLAN



## WHAT ELSE IS HAPPENING FOR TRANSPORTATION IN THE BAYVIEW?

### Palou Avenue Streetscape Improvement Project

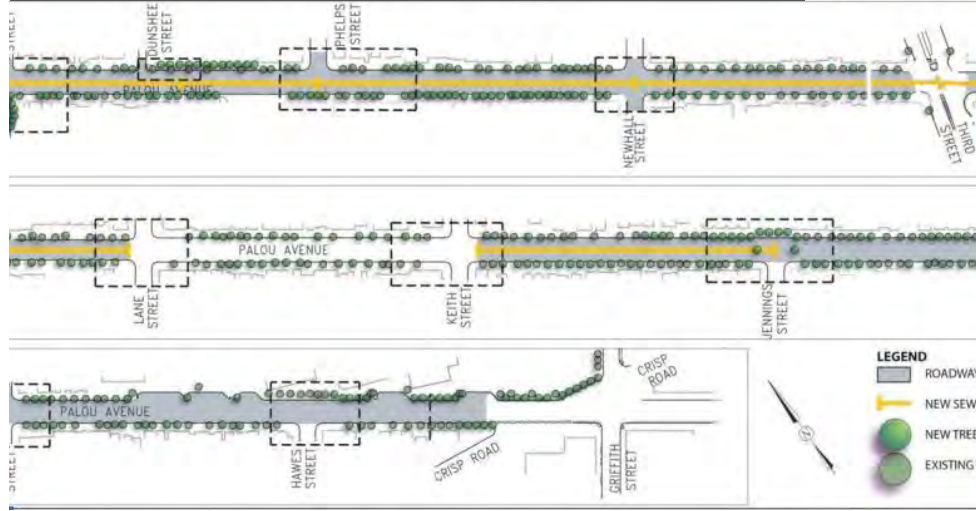

**Extent:** Barneveld Ave to Crisp Rd  
**Schedule:** Start construction late 2019, complete early 2022  
**Details:** Repaving, new street trees, improved pedestrian lighting, new bus shelters, new curb ramps, median islands, bulb-outs, and reconfigure intersection at Silver/Quint  
**Learn More:** <http://sfpublicworks.org/palou>

### Evans Ave Sewer and Pavement Renovation



**Extent:** Cesar Chavez St to Hunters Point Blvd  
**Schedule:** Construction complete Spring 2019  
**Details:** Repaving, replace sewer lines, install new curb ramps, intersection improvements, new crosswalks  
**Learn More:** <https://www.sfpublicworks.org/evans>

### Quint Connector Road

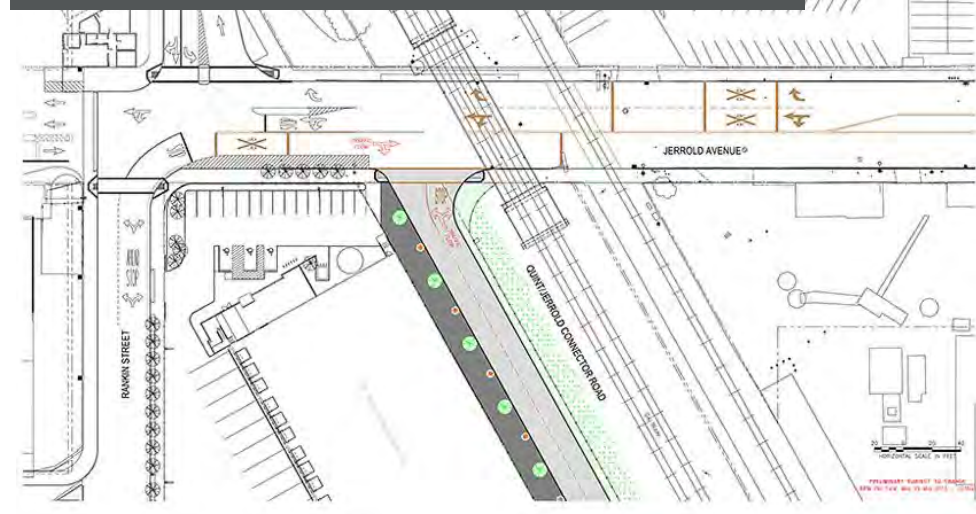

**Extent:** Oakdale Ave to Jerrold Ave  
**Schedule:** Under design; construction could start winter 2020, pending negotiations  
**Details:** Build new connector road alongside Caltrain where Quint St was closed off  
**Learn More:** <https://www.sfcta.org/quint>

### Jerrold Ave Streetscape



**Extent:** Phelps St to Caltrain underpass  
**Schedule:** Start construction late 2019, complete early 2025  
**Details:** Enhanced sidewalks, lighting and landscaping (part of relocation of solids handling facility at Southeast Treatment Plant)  
**Learn More:** <https://www.sfwater.org/digesters>

### SF Wholesale Produce Market



**Extent:** Jerrold Ave, Rankin St to Toland St  
**Schedule:** TBD  
**Details:** Close Jerrold Ave within the SF Whole Produce Market. Rebuild Innes Ave & Kirkwood Ave as alternate routes  
**Learn More:** <https://oewd.org/wholesale-produce-market-expansion>

# HOW DO WE IMPROVE TRANSPORTATION IN THE BAYVIEW?

The SFMTA has a broad “toolkit” of investments to improve transportation for people walking, riding a bike, riding on transit, or driving. What investment do you like the most? Where do you want us to build it?



**Painted Safety Zones**

Painted safety zones reduce the speed of turning cars and increase visibility of people crossing the street.



**Continental Crosswalks**

Continental crosswalks help to make drivers more aware of people crossing the street.



**Raised Crosswalks**

A raised crosswalk is raised to the level of the sidewalk to slow down vehicles. Examples are found on Hudson Ave and on Whitney Young Circle.



**Accessible Curb Ramps**

Accessible curb ramps help people with disabilities move from the sidewalk to a roadway, and vice versa, safely.



**Rapid Flashing Beacons**

Rapid flashing beacons provide a visual warning to drivers when someone is crossing the street.



**Pedestrian Median Island**

Median islands provide protected space in the street help people cross safely. They can also help to calm traffic by narrowing the roadway.



**Pedestrian Lighting**

Lighting improves safety, visibility and accessibility. Pedestrian lighting is lower to the ground, illuminating the sidewalk.



**Pedestrian Bulb**

A pedestrian bulb is an extension of the sidewalk at an intersection. They increase pedestrian visibility and safety when crossing the street.



**Lane Shifting/Chicanes**

Chicanes shift position of the travel lane in the roadway to slow down vehicles. An example is on Newcomb Ave at Phelps St.



**Speed Cushions**

Speed cushions are meant to lower vehicle speeds on local streets.



**Bus Bulbs & Shelters**

Bus bulbs extend the sidewalk to make enough room for a bus shelter. They can speed up bus routes because the bus loads in-lane



**Traffic Circles**

Traffic circles lower speeds at minor intersection crossings and can include landscaping. Examples are found on Hudson St and Whitney Young Circle.



**Bike Routes/Neighborways**

Bike routes are on low-traffic streets with no separated area for bike travel. They work well other traffic calming.



**Bike Parking & Corrals**

Bike racks are installed on the sidewalk and can hold 2 bicycles. A corral is on-street and can hold up to 12-14 bicycles.



**Bike Lanes & Cycle Tracks**

Green paint, paint buffers, or physical separation all help make people on bikes more safe and visible. Examples are found on Cargo Way.

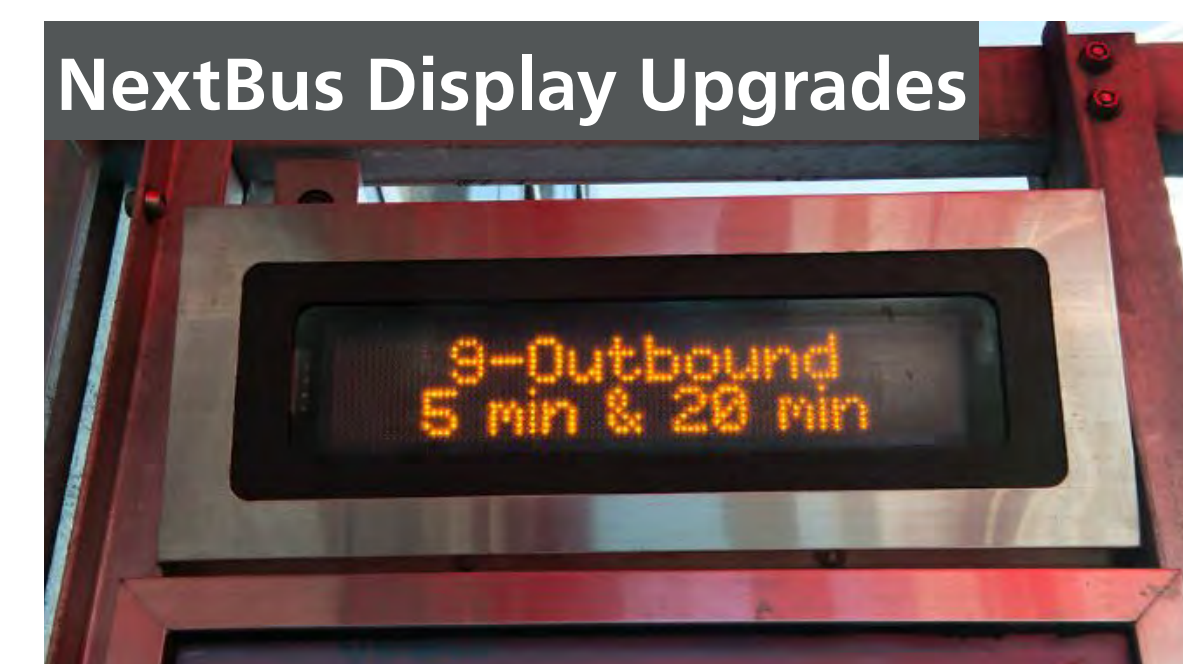

**NextBus Display Upgrades**

SFMTA will soon upgrade our NextBus display system, including solar-powered displays that can be used in more locations.



# BAYVIEW COMMUNITY BASED TRANSPORTATION PLAN



## PRIORITIZING INVESTMENT FOR VULNERABLE RESIDENTS:

Different vulnerable populations in the Bayview face different types of transportation challenges on a daily basis.

We want to utilize the principles of Mobility Justice to center the lived experience of Bayview's most vulnerable residents in solutions that meet their needs.

You can learn more about Mobility Justice at: <http://www.untokening.org/>

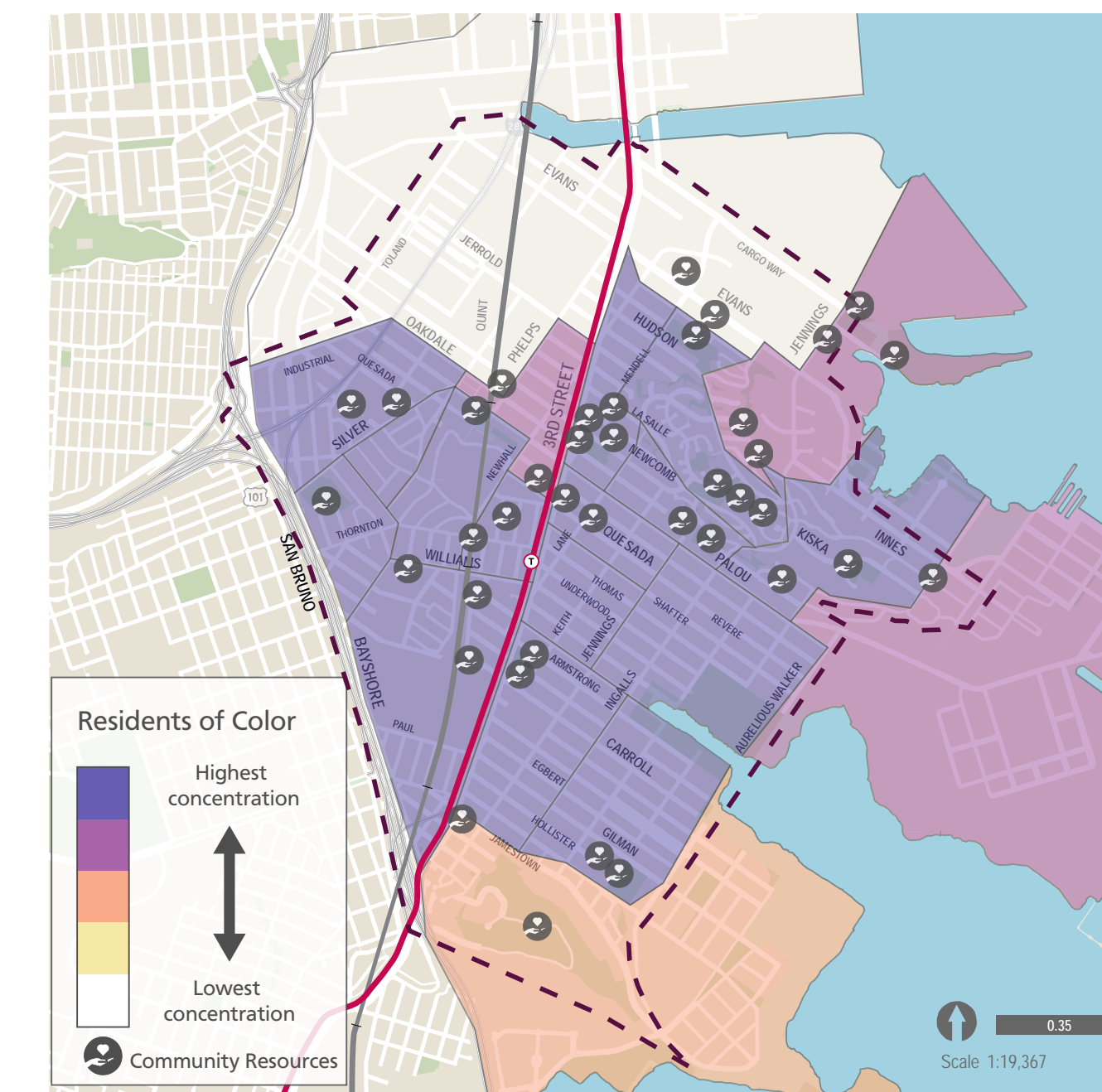

### Concentration of Vulnerable Residents:

The map below shows the concentration of Bayview residents most vulnerable to transportation challenges, a combination of the other maps on this board.

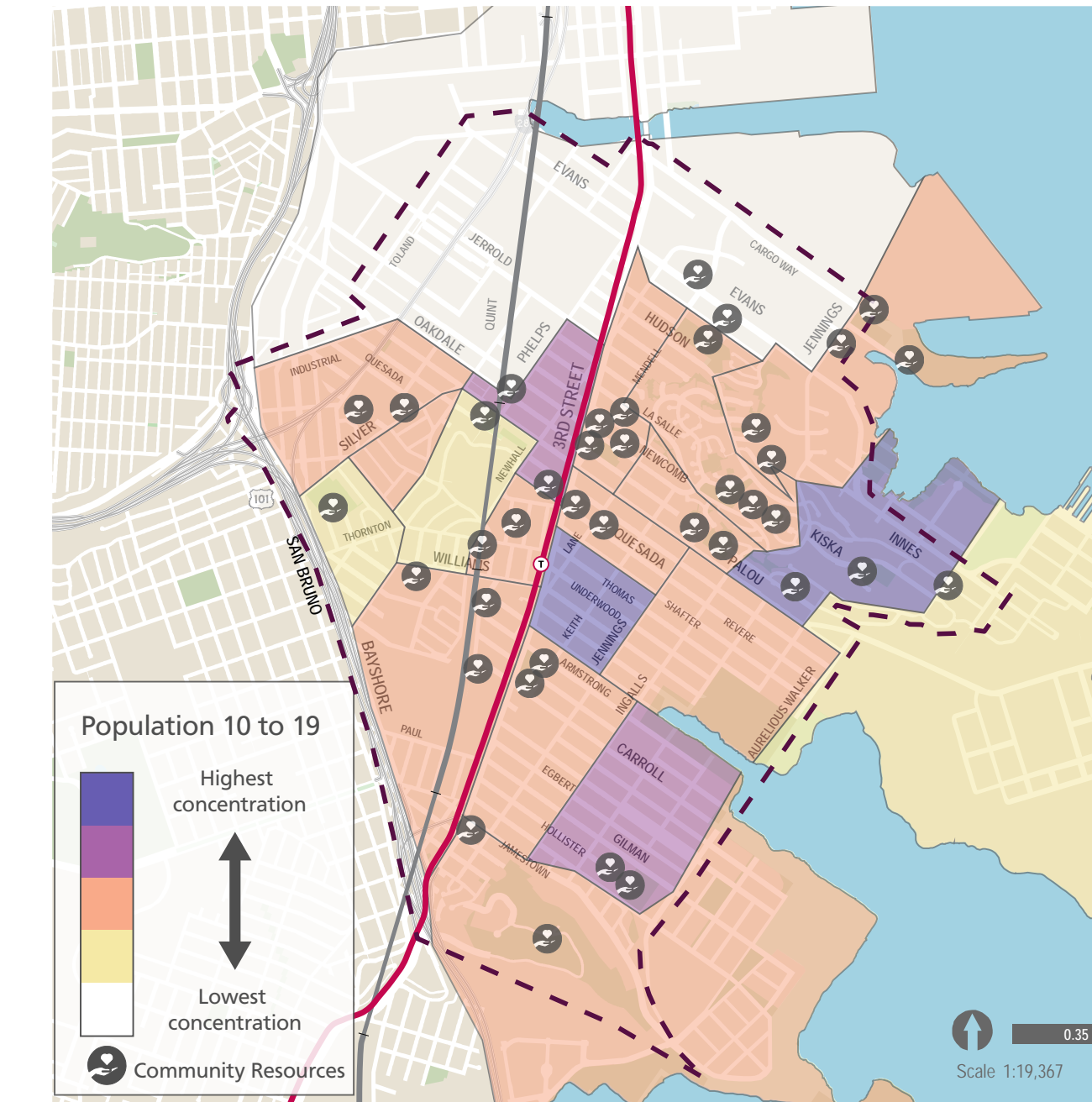

### How will your feedback be used?

When developing & prioritizing projects, we will measure the benefit to vulnerable residents. This will decide:

- Where we prioritize transportation investments in the Bayview
  - What types of transportation investments we prioritize
  - The order of implementation for transportation projects



# BAYVIEW COMMUNITY BASED TRANSPORTATION PLAN



## HOW WOULD YOU SPEND \$600,000 ON TRANSPORTATION IMPROVEMENTS?

**Participatory budgeting** is a democratic process where community members come together to come up with ideas, develop them into proposals, and vote on where the money will go.

The SFMTA received a Lifeline Transportation Grant from the Metropolitan Transportation Commission (MTC) to **improve transit and access to transit** for low-income residents in the Bayview. Projects will be developed and funded through a Participatory Budgeting process.

## Community Ideas to Improve Transit & Access to Transit

In the fall of 2018, we gathered over **300 ideas from community members** for how we can improve transit or access to transit in the Bayview.

Our partners at the Metropolitan Transportation Commission (MTC) and the San Francisco County Transportation Authority (SFCTA) screened these ideas for funding eligibility. After their review, we now have **11 types of projects eligible for funding**. Now we need Project Champions to turn these ideas into real proposals!

## 11 TYPES OF PROJECTS - PROJECT CHAMPIONS NEEDED!

### Increase MUNI Service



Greater bus frequency, more weekend service, or more buses at night are all eligible for funding.

### New MUNI Service



Funding could bring new bus lines, like the Southeast Muni Expansion, to the Bayview years earlier than planned.

### Improve Bus Stops



Adding new bus shelters, improving street lighting around transit, installing new trash cans or installing new NextBus signs are all eligible for funding.

### Community Shuttles



Community shuttles available to the public at-large, serving key community destinations & providing access to transit.

### Transit Ambassadors



Additional Transit Ambassadors, staffing key transit lines to improve rider safety, are eligible for funding.

### Free Transit Passes



Free transit passes for low-income community members, including youth, seniors, or residents with disabilities are eligible for funding.

### Education Programs



Marketing, incentives, and education campaigns for connecting residents with transit, especially monolingual communities.

### Paratransit & Taxi



Increased service for paratransit, Van Gogh or Shop-a-Round shuttles are eligible for funding, as well as taxi vouchers for Bayview residents.

### Community Surveys



Community-based organizations can be funded to do transit surveys with residents.

### Crossing Guards



Establish new crossing guards at locations near transit stops or extend the working hours of current crossing guard positions.

### Routes to Transit



Better sidewalks, bike routes, crosswalks and safer intersections near transit are all eligible for funding.

### PARTICIPATORY BUDGETING SCHEDULE

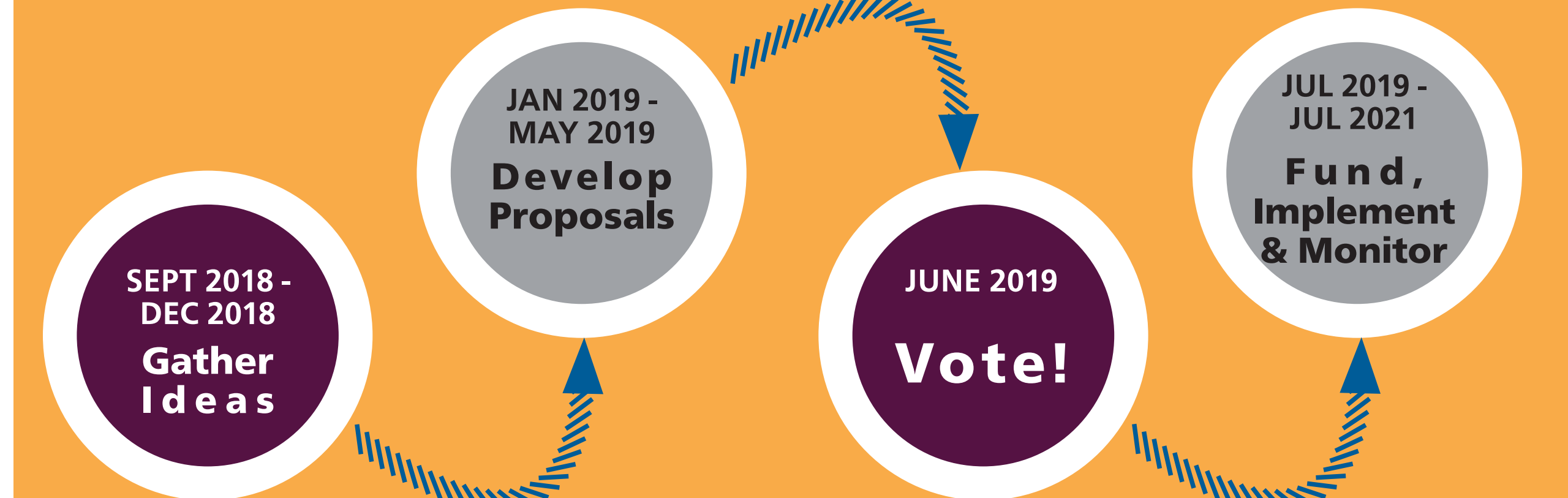

**SHARE YOUR IDEAS FOR A PROPOSAL OR BECOME A PROJECT CHAMPION TODAY!**







# Priority Corridor: 3rd Street



# BAYVIEW COMMUNITY BASED TRANSPORTATION PLAN

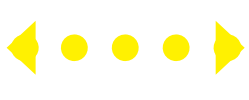

## Legend

-  Signalized Intersection
-  Marked Crosswalk
-  Bus stops (23, 24, 44)
-  T-Third Platforms
-  Bike Lane

## Share your comments!

Where should we fix something?  
What's missing on this street?  
Where do you feel unsafe?  
Where do you want to cross the  
street?







# Priority Corridor: Evans Ave Hunters Point Blvd Innes Ave

# BAYVIEW COMMUNITY BASED TRANSPORTATION PLAN

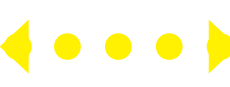

**Legend**

-  Signalized Intersection
-  Marked Crosswalk
-  19 Polk Bus Stop
-  Bike Lane

**Share your comments!**

Where should we fix something?  
 What's missing on this street?  
 Where do you feel unsafe?  
 Where do you want to cross the street?



# Priority Corridor: Oakdale Ave

# BAYVIEW COMMUNITY BASED TRANSPORTATION PLAN



## Legend



Signalized Intersection

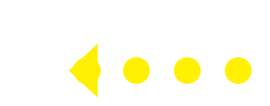

Marked Crosswalk



Bus stops (23, 24, 44)



Bike Lane

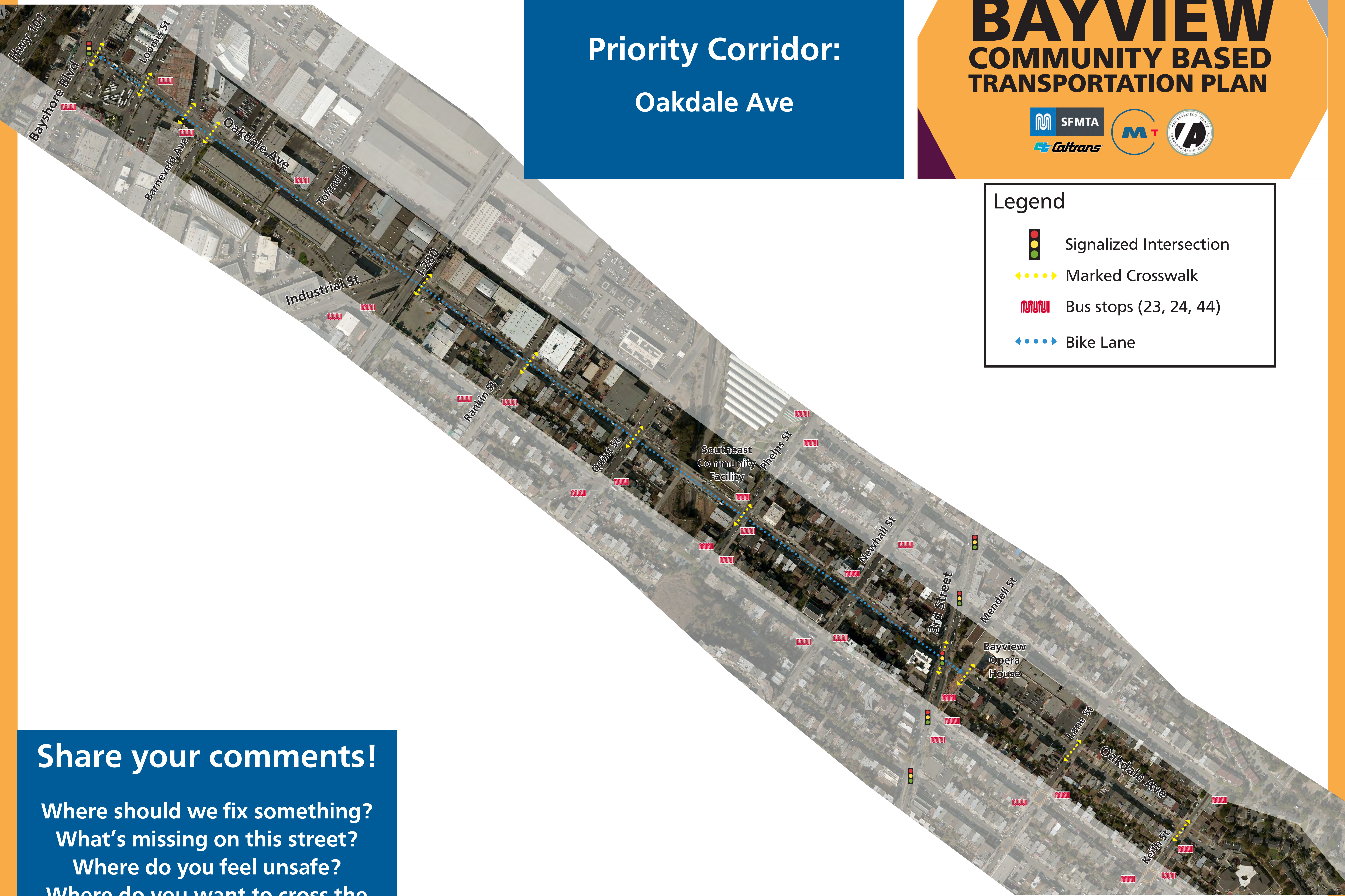

## Share your comments!

- Where should we fix something?
- What's missing on this street?
- Where do you feel unsafe?
- Where do you want to cross the street?



# Priority Corridor: Williams Ave

# BAYVIEW COMMUNITY BASED TRANSPORTATION PLAN



## Legend



Signalized Intersection

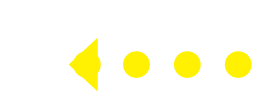

Marked Crosswalk



Bus stops (54)



## Share your comments!

- Where should we fix something?
- What's missing on this street?
- Where do you feel unsafe?
- Where do you want to cross the street?