



SFMTA

April 4, 2025

Engineering Public Hearing

<https://sfmta.com/enghearing>

Conference Line: 1-415-523-2709

Conference ID: 836 632 456#

Please sign up to speak at [SFMTA.com/ENGSpeakerCard](https://sfmta.com/ENGSpeakerCard)

Proposed Street Changes

How does a proposed street change get approved?

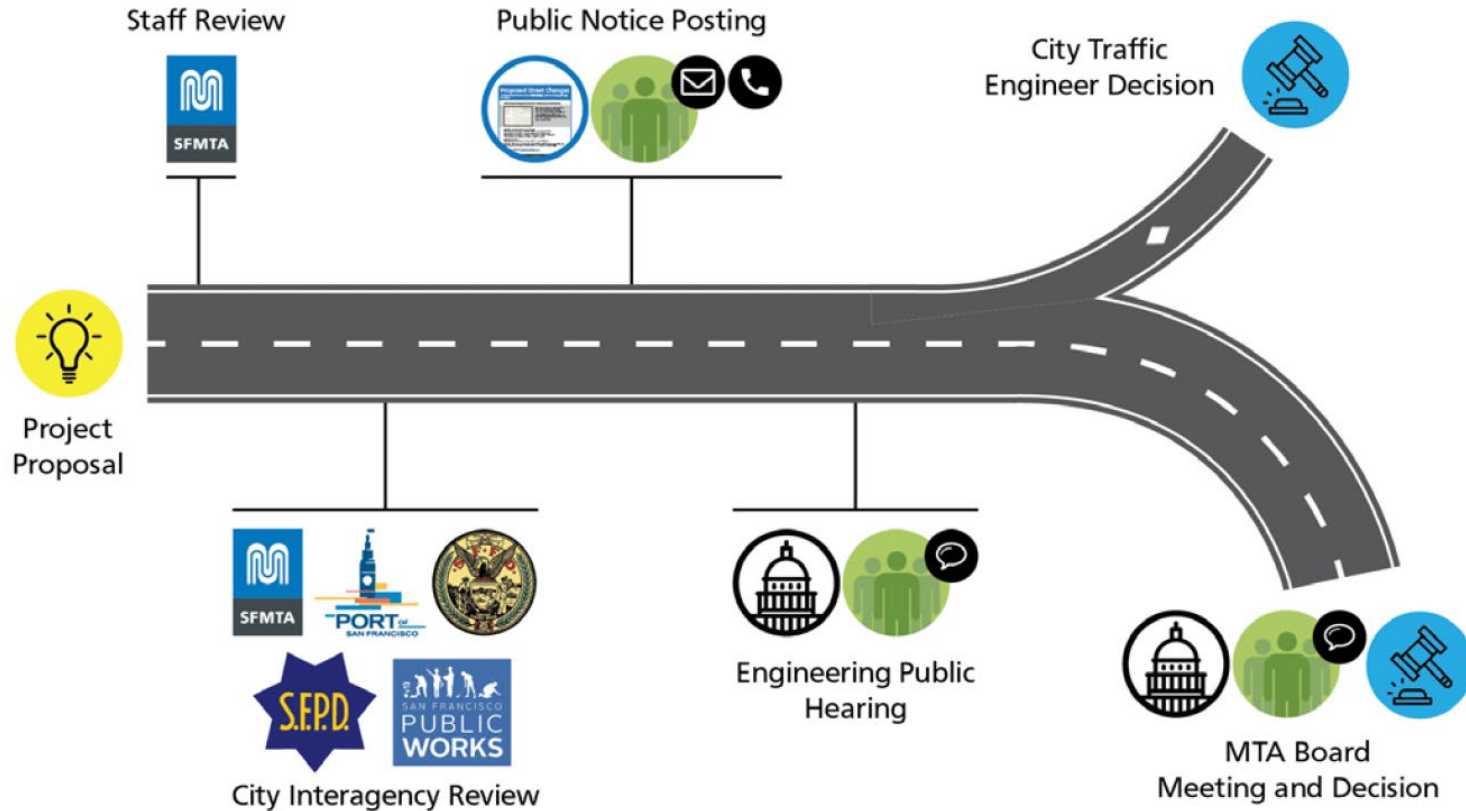

<https://www.sfmta.com/committees/engineering-public-hearings>

Public Hearing Decision Posting

Results will be posted by 5 PM next Friday

<https://sfmta.com/engineering>

Select Meeting
from List of Past
Meetings

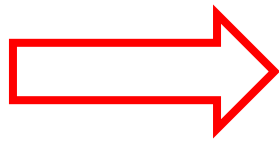

Past Meetings & Events for this Committee

Jan
17

Engineering Public Hearing Meeting,
January 17, 2025

The Streets Division of the San Francisco
Municipal Transportation Agency will
hold an online public...

Dec
6

Engineering Public Hearing Meeting,
December 6, 2024

The Streets Division of the San Francisco
Municipal Transportation Agency will
hold an online public...

Nov
8

Engineering Public Hearing Meeting,
November 8, 2024

The Streets Division of the San Francisco
Municipal Transportation Agency will
hold an online public...

[View All Past Meetings & Events →](#)



SFMTA

April 4, 2025

Engineering Public Hearing

<https://sfmta.com/enghearing>

Conference Line: 1-415-523-2709

Conference ID: 836 632 456#

Please sign up to speak at [SFMTA.com/ENGSpeakerCard](https://sfmta.com/ENGSpeakerCard)

GENERAL PUBLIC COMMENT

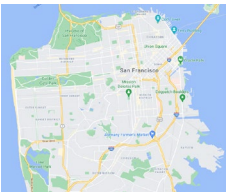

Conference Line: **1-415-523-2709** (conference ID: 836 632 456#)
To comment on an item, press *5 to raise hand and *6 to unmute when prompted.

1. RESCIND – YELLOW METERED ZONE, COMMERCIAL LOADING, 8 AM TO 6 PM, MONDAY THROUGH SATURDAY

Chenery Street, north side, from Diamond Street to 21 feet easterly (removes yellow zone for daylighting)
 (Supervisor District 8) (Approvable by the City Traffic Engineer) Alvin Lam, alvin.lam@sfmta.com

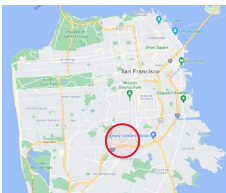
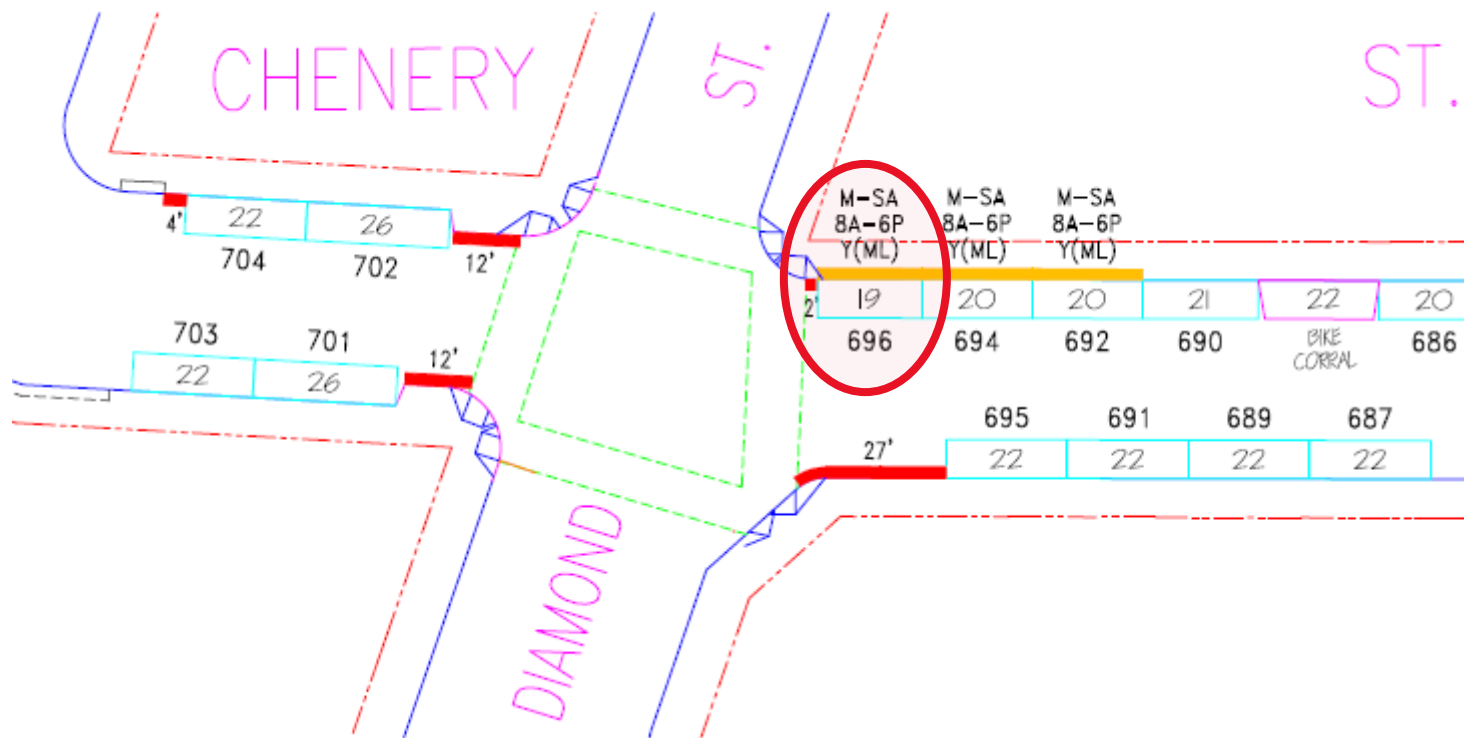

Conference Line: **1-415-523-2709** (conference ID: 836 632 456#)

To comment on an item, press *5 to raise hand and *6 to unmute when prompted.

**2. RESCIND – 30 MPH SPEED LIMIT
ESTABLISH – 25 MPH SPEED LIMIT**

Market Street between Douglass Street and Castro Street (Supervisor District 8) (Requires approval by the SFMTA Board) Alvin Lam, alvin.lam@sfmta.com

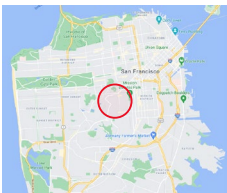
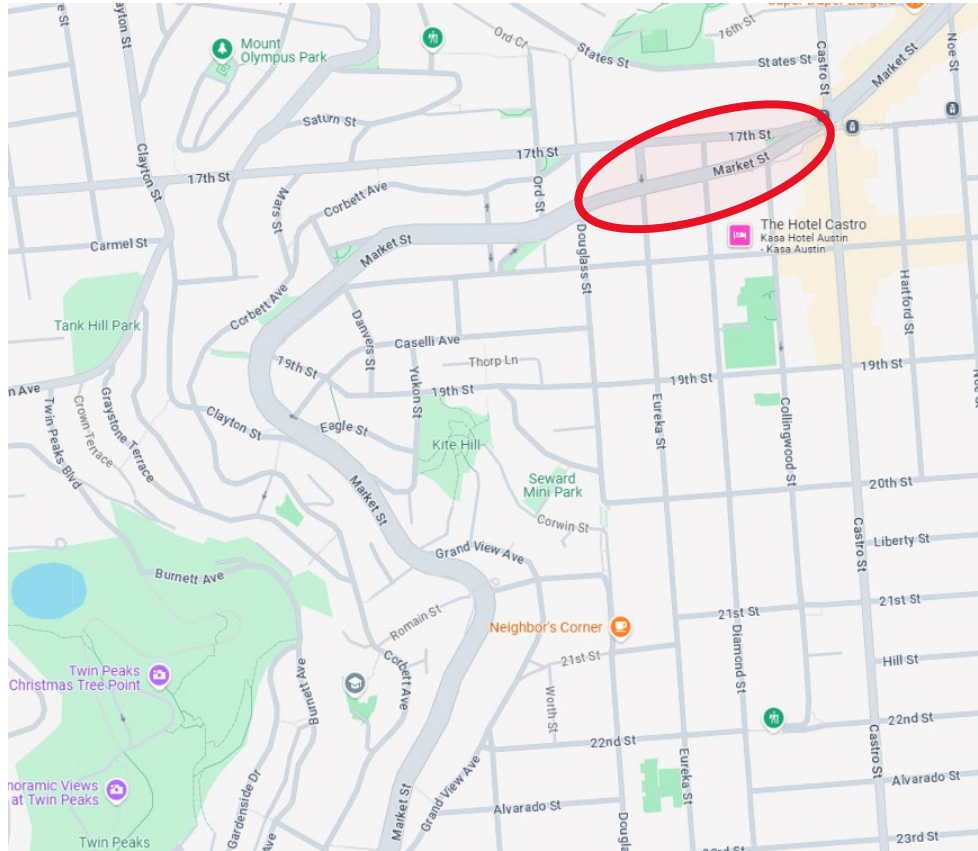

Conference Line: **1-415-523-2709** (conference ID: 836 632 456#)

To comment on an item, press *5 to raise hand and *6 to unmute when prompted.

3. ESTABLISH – STOP SIGNS

Evans Avenue, eastbound and westbound, at Newhall Street (Supervisor District 10) (Approvable by the City Traffic Engineer) Juan Hernandez, juan.hernandez@sfmta.com

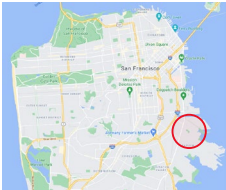
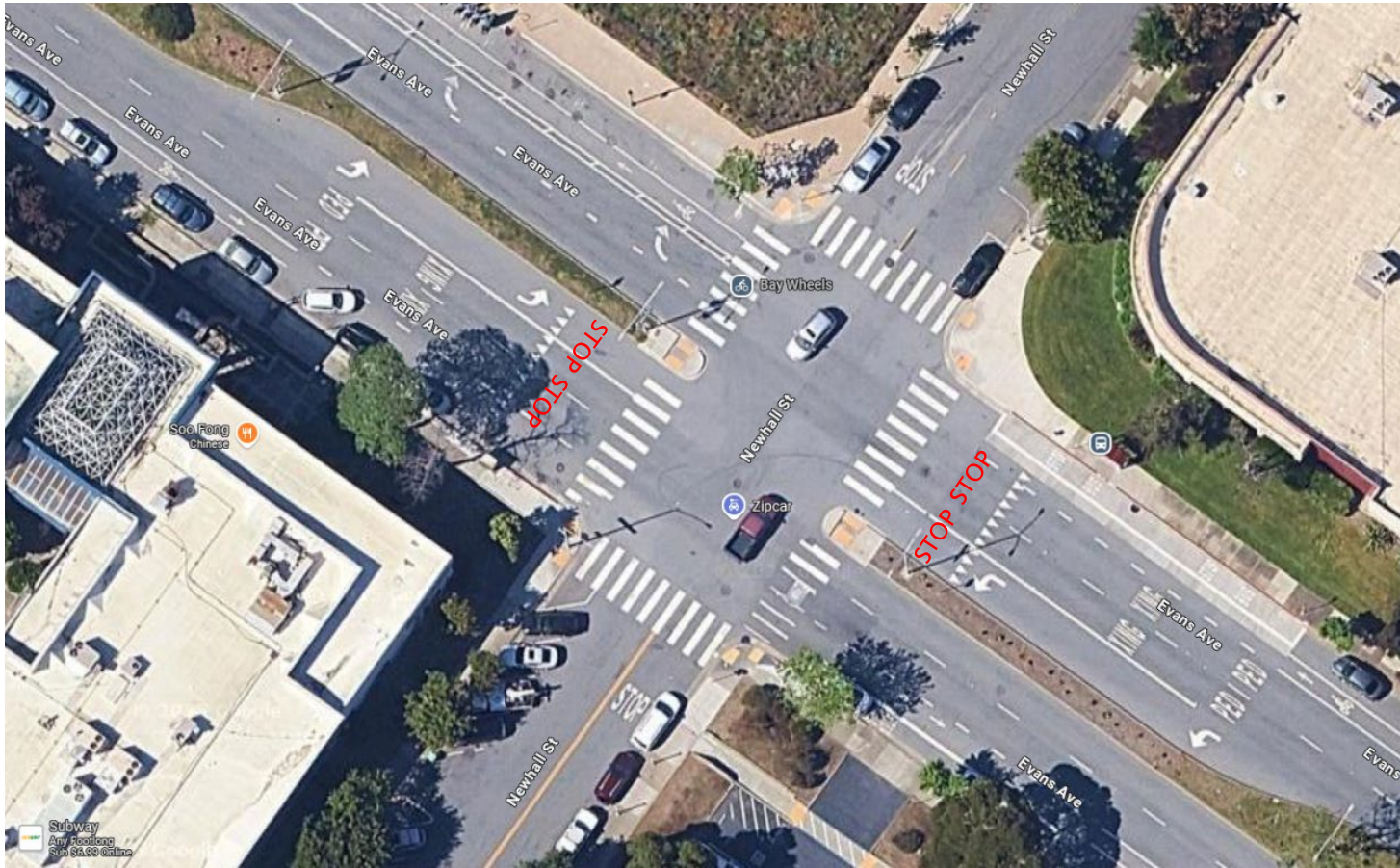

Conference Line: **1-415-523-2709** (conference ID: 836 632 456#)

To comment on an item, press *5 to raise hand and *6 to unmute when prompted.

4. ESTABLISH – BUS ZONE

Lombard Street, north side, from 71 feet to 100 feet east of Lyon Street (Supervisor District 2) (Requires approval by the SFMTA Board) Michael Tamin, michael.tamin@sfmta.com

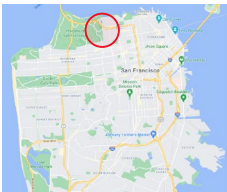

Conference Line: **1-415-523-2709** (conference ID: 836 632 456#)

To comment on an item, press *5 to raise hand and *6 to unmute when prompted.

5. ESTABLISH – NO PARKING ANY TIME

Judah Street, north side, from 37th Avenue to 20 feet westerly (Supervisor District 4) (Requires approval by the SFMTA Board) Audrey Hollman, audrey.hollman@sfmta.com

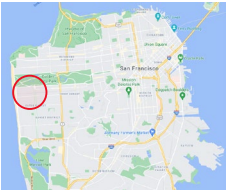

Conference Line: **1-415-523-2709** (conference ID: 836 632 456#)

To comment on an item, press *5 to raise hand and *6 to unmute when prompted.

6(a). RESCIND – PASSENGER LOADING ZONE, 7AM to 9AM, 3:30PM to 5:00PM, SCHOOL DAYS
Sanchez Street, east side, from 64 feet to 91 feet north of 17th Street (27-foot zone)

6(b). ESTABLISH – TOW-AWAY NO PARKING, PART-TIME PASSENGER LOADING ZONE, 7AM TO 8:30AM, 12PM TO 2:30PM,
SCHOOL DAYS
Sanchez Street, east side, from 67 feet to 214 feet north of 17th Street (147-foot zone)
(Supervisor District 8) (Approvable by the City Traffic Engineer) Andre Wright, andre.wright@sfmta.com

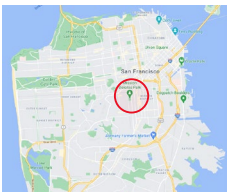

Conference Line: **1-415-523-2709** (conference ID: 836 632 456#)
To comment on an item, press *5 to raise hand and *6 to unmute when prompted.

7(a). RESCIND – BUS STOP, NO STOPPING, 7:30AM-4:30PM, SCHOOL DAYS
41st Avenue, east side, from 10 feet to 110 feet south of Ortega Street (100-foot zone)

7(b). ESTABLISH – TOW-AWAY NO STOPPING, PART-TIME SCHOOL BUS LOADING, 7:30AM-4:30PM, SCHOOL DAYS
41st Avenue, east side, from 10 feet to 170 feet south of Ortega Street (160-foot zone)
(Supervisor District 4) (Approvable by the City Traffic Engineer) Andre Wright, andre.wright@sfmta.com

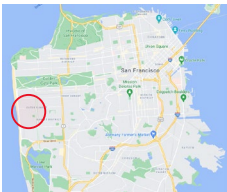

Conference Line: **1-415-523-2709** (conference ID: 836 632 456#)

To comment on an item, press *5 to raise hand and *6 to unmute when prompted.

8(a). RESCIND – GREEN METERED ZONE, 15-MINUTE TIME LIMIT, 9 AM TO 6 PM, MONDAY THROUGH SATURDAY

7th Avenue, east side, from Irving Street to 20 feet southerly

8(b). ESTABLISH – GREEN METERED ZONE, 15-MINUTE TIME LIMIT, 9 AM TO 6 PM, MONDAY THROUGH SATURDAY

7th Avenue, east side, from 17 feet to 37 feet south of Irving Street (relocates green meter 1302-Q to 1304 for 17 feet of daylighting)

(Supervisor District 7) (Approvable by the City Traffic Engineer) Alvin Lam, alvin.lam@sfmta.com

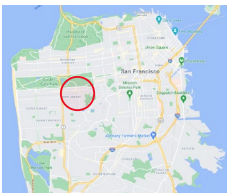
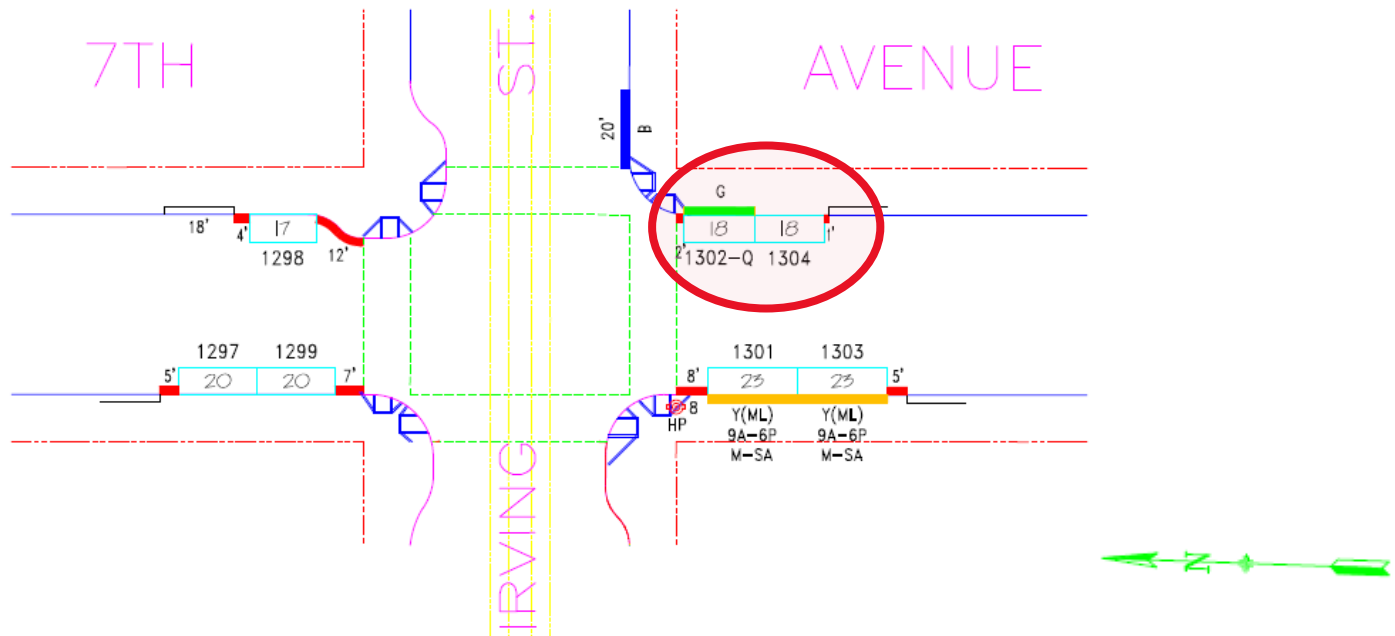

Conference Line: **1-415-523-2709** (conference ID: 836 632 456#)

To comment on an item, press *5 to raise hand and *6 to unmute when prompted.

9(a). RESCIND – GREEN METERED ZONE, 15-MINUTE TIME LIMIT, 9 AM TO 6 PM, MONDAY THROUGH SATURDAY

Bluxome Street, south side, from 9 feet to 18 feet west of 4th Street

9(b). ESTABLISH – GREEN METERED ZONE, 15-MINUTE TIME LIMIT, 9 AM TO 6 PM, MONDAY THROUGH SATURDAY

Bluxome Street, south side, from 27 feet to 36 feet west of 4th Street (relocates green meter for daylighting)

(Supervisor District 6) (Approvable by the City Traffic Engineer) Alvin Lam, alvin.lam@sfmta.com

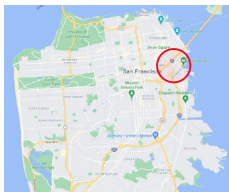
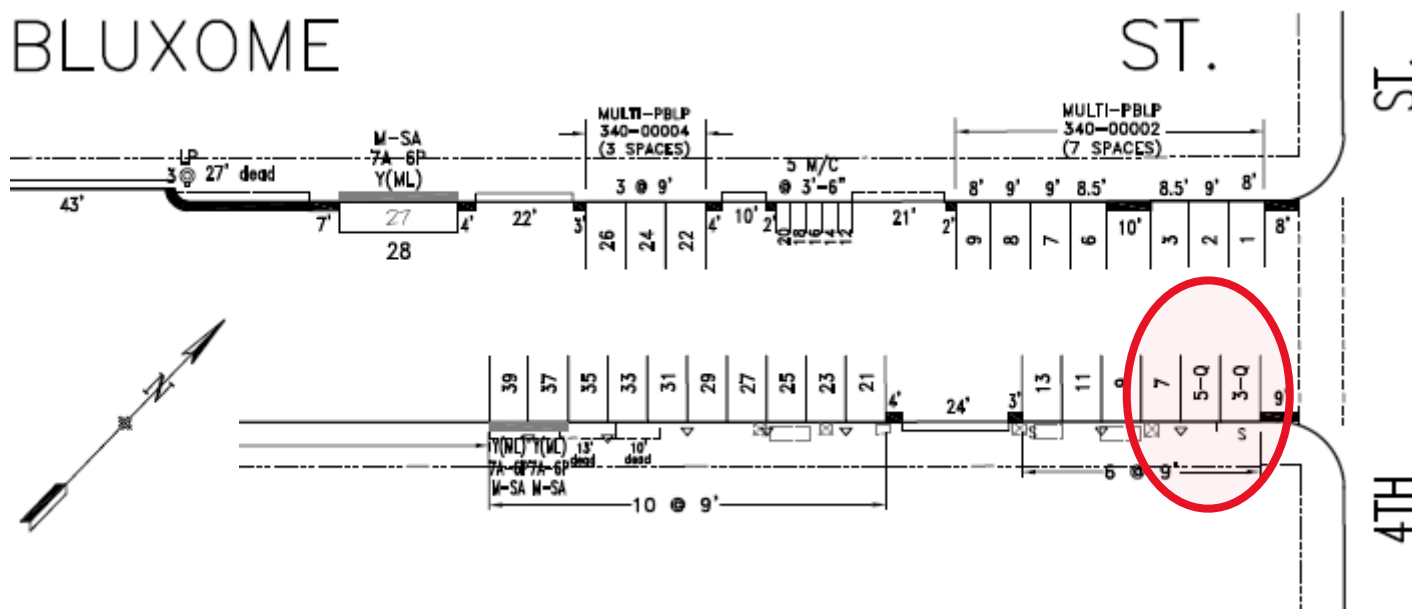

Conference Line: **1-415-523-2709** (conference ID: 836 632 456#)

To comment on an item, press *5 to raise hand and *6 to unmute when prompted.

10(a). RESCIND – YELLOW METERED ZONE, COMMERCIAL LOADING, 8 AM TO 12 NOON, MONDAY THROUGH FRIDAY

Clement Street, south side, from 10th Avenue to 22 feet westerly

10(b). ESTABLISH – YELLOW METERED ZONE, COMMERCIAL LOADING, 8 AM TO 12 NOON, MONDAY THROUGH FRIDAY

Clement Street, south side, from 18 feet to 43 feet west of 10th Avenue (relocates yellow metered zone 901 to 903 for 18 feet of daylighting)

(Supervisor District 1) (Approvable by the City Traffic Engineer) Alvin Lam, alvin.lam@sfmta.com

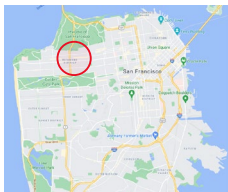
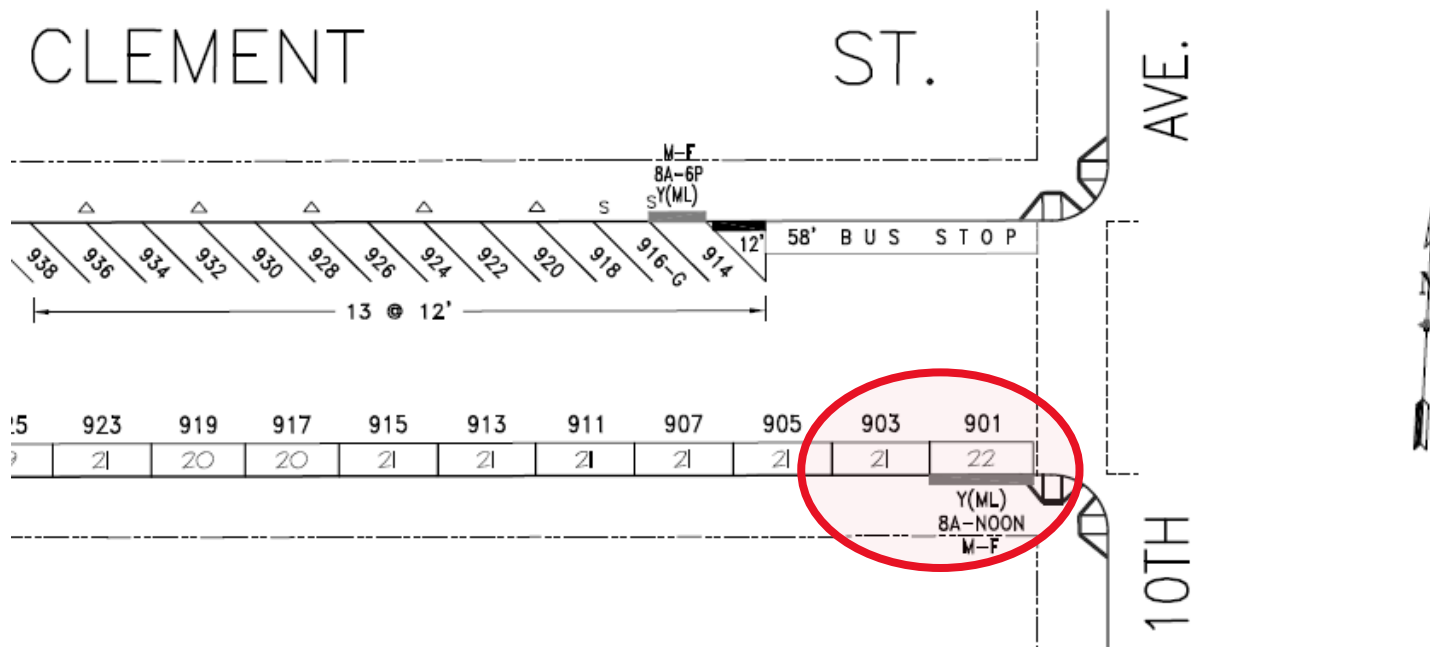

Conference Line: **1-415-523-2709** (conference ID: 836 632 456#)

To comment on an item, press *5 to raise hand and *6 to unmute when prompted.

11(a). RESCIND – TOW-AWAY, NO PARKING AT ANY TIME

ESTABLISH – GENERAL METERED PARKING, NO TIME LIMIT, 9 AM TO 10 PM, MONDAY THROUGH SATURDAY

Owens Street, west side, between Nelson Rising Lane and Gene Friend Way

11(b). ESTABLISH – BLUE ZONE, ACCESSIBLE PARKING, AT ALL TIMES

Owens Street, west side, from 15 feet to 40 feet south of Nelson Rising Lane (25-foot zone)

11(c). ESTABLISH – RED ZONE

A. Owens Street, west side, from Nelson Rising Lane to 15 feet southerly (15-foot zone)

B. Owens Street, west side, from 180 feet to 190 feet south of Nelson Rising Lane (10-foot zone)

C. Owens Street, west side, from Gene Friend Way to 10 feet northerly (10-foot zone)

11(d). ESTABLISH – GENERAL LOADING ZONE, 5 MINUTE TIME LIMIT, 7 AM TO 7 PM, MONDAY THROUGH FRIDAY

Owens Street, west side, from 40 feet to 160 feet south of Nelson Rising Lane (120-foot zone)

Owens Street, west side, from 10 feet to 170 feet north of Gene Friend Way (160-foot zone)

(Supervisor District 6) (Requires approval by the SFMTA Board) Adrienne Mau, Adrienne.Mau@sfmta.com

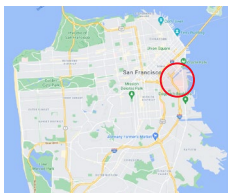

Conference Line: **1-415-523-2709** (conference ID: 836 632 456#)

To comment on an item, press *5 to raise hand and *6 to unmute when prompted.

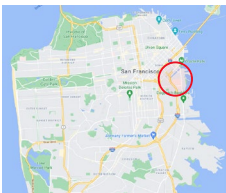
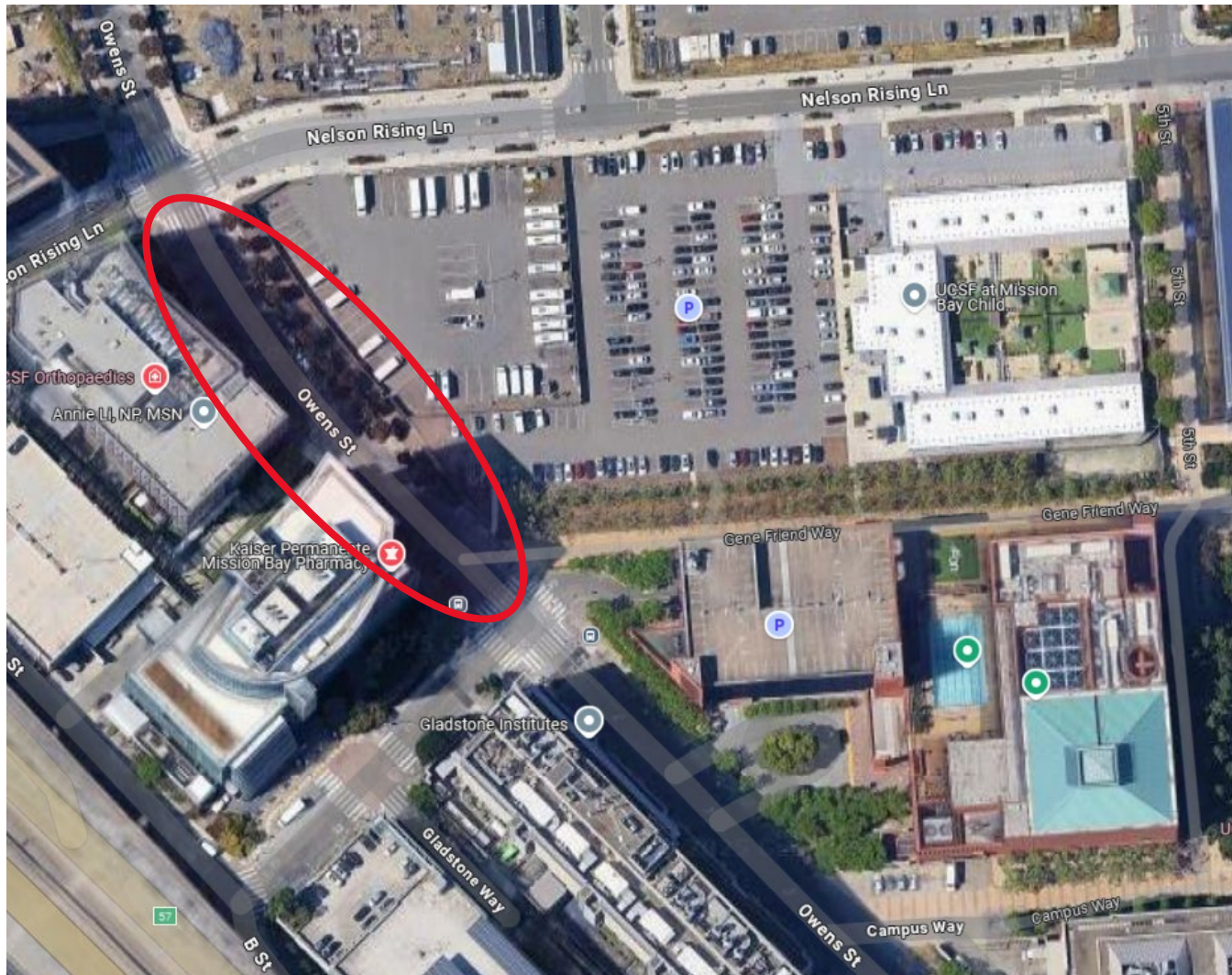

Conference Line: **1-415-523-2709** (conference ID: 836 632 456#)

To comment on an item, press *5 to raise hand and *6 to unmute when prompted.

12(a). RESCIND – PART-TIME PASSENGER LOADING ZONE, 6 PM – 1 AM, DAILY
RESCIND – PART-TIME YELLOW METERED ZONE, COMMERCIAL LOADING, 7 AM – NOON, MONDAY THROUGH FRIDAY
Grant Avenue, east side, from Vallejo Street to 18 feet southerly

12(b). ESTABLISH – PART-TIME PASSENGER LOADING ZONE, 6 PM – 1 AM, DAILY
Grant Avenue, east side, from 20 feet to 40 feet south of Vallejo Street (removes yellow zone, relocates white zone, and lengthens resulting dual-use zone, for daylighting)

12(c). RESCIND – YELLOW METERED ZONE, COMMERCIAL LOADING, 7 AM TO 2 PM, MONDAY THROUGH SATURDAY
Washington Street, south side, from 2 feet to 24 feet east of Grant Avenue

12(d). ESTABLISH – WHITE ZONE, PASSENGER LOADING, 7 AM TO 6 PM, MONDAY THROUGH SATURDAY
Washington Street, south side, from 13 feet to 24 feet east of Grant Avenue (removes yellow meter 743 for 13' of daylighting and lengthens passenger loading zone)

12(e). RESCIND – YELLOW METERED ZONE, COMMERCIAL LOADING, 7 AM TO 6 PM, MONDAY THROUGH SATURDAY
Commercial Street, south side, from Grant Avenue to 18 feet easterly

12(f). ESTABLISH – YELLOW METERED ZONE, COMMERCIAL LOADING, 7 AM TO 6 PM, MONDAY THROUGH SATURDAY
Commercial Street, south side, from 15 feet to 59 feet east of Grant Avenue (relocates yellow meter 743 to general meter 739 for 15' of daylighting; each yellow zone to be 22 feet in length)

12(g). RESCIND – YELLOW METERED ZONE, 6-WHEEL COMMERCIAL LOADING, 7 AM TO 4 PM, MONDAY THROUGH FRIDAY
Sutter Street, south side, from Grant Avenue to 19 feet easterly (removes yellow meter 239 for 15' of daylighting and increases adjacent yellow meter lengths)

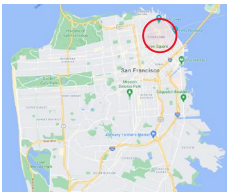

Conference Line: **1-415-523-2709** (conference ID: 836 632 456#)

To comment on an item, press *5 to raise hand and *6 to unmute when prompted.

12(h). RESCIND - RESCIND – TOW-AWAY, NO STOPPING, PART-TIME SCHOOL BUS LOADING ZONE, 7 AM TO 6 PM, MONDAY THROUGH FRIDAY

Green Street, south side, from Embarcadero to 18 feet westerly (shortens white zone for daylighting)

12(i). RESCIND – YELLOW METERED ZONE, COMMERCIAL LOADING, 7 AM TO 4 PM, MONDAY THROUGH FRIDAY

Grant Avenue, west side, from Geary Street to 21 feet southerly (removes yellow meter for daylighting)

12(j). RESCIND – BLUE ZONE

Union Street, south side, from Battery Street to 9 feet westerly

12(k). RESCIND – METERED MOTORCYCLE PARKING, 9 AM TO 6 PM, MONDAY THROUGH SATURDAY

ESTABLISH – BLUE ZONE

Battery Street, east side, from Union Street to 21 feet southerly (relocates blue zone for 9 feet of daylighting)

12(l). ESTABLISH – METERED MOTORCYCLE PARKING, 9 AM TO 6 PM, MONDAY THROUGH SATURDAY

Battery Street, east side, from 45 feet to 70 feet south of Union Street (relocates motorcycle spaces to metered space 1032)

(Supervisor District 3) (Approvable by the City Traffic Engineer) Alvin Lam, alvin.lam@sfmta.com

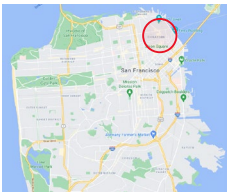

Conference Line: **1-415-523-2709** (conference ID: 836 632 456#)

To comment on an item, press *5 to raise hand and *6 to unmute when prompted.

12(a). RESCIND – PART-TIME PASSENGER LOADING ZONE, 6 PM – 1 AM, DAILY
RESCIND – PART-TIME YELLOW METERED ZONE, COMMERCIAL LOADING, 7 AM – NOON, MONDAY THROUGH FRIDAY
 Grant Avenue, east side, from Vallejo Street to 18 feet southerly

12(b). ESTABLISH – PART-TIME PASSENGER LOADING ZONE, 6 PM – 1 AM, DAILY
 Grant Avenue, east side, from 20 feet to 40 feet south of Vallejo Street (removes yellow zone, relocates white zone, and lengthens resulting dual-use zone, for daylighting)

12(c). RESCIND – YELLOW METERED ZONE, COMMERCIAL LOADING, 7 AM TO 2 PM, MONDAY THROUGH SATURDAY
 Washington Street, south side, from 2 feet to 24 feet east of Grant Avenue

12(d). ESTABLISH – WHITE ZONE, PASSENGER LOADING, 7 AM TO 6 PM, MONDAY THROUGH SATURDAY
 Washington Street, south side, from 13 feet to 24 feet east of Grant Avenue (removes yellow meter 743 for 13' of daylighting and lengthens passenger loading zone)

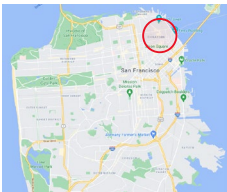
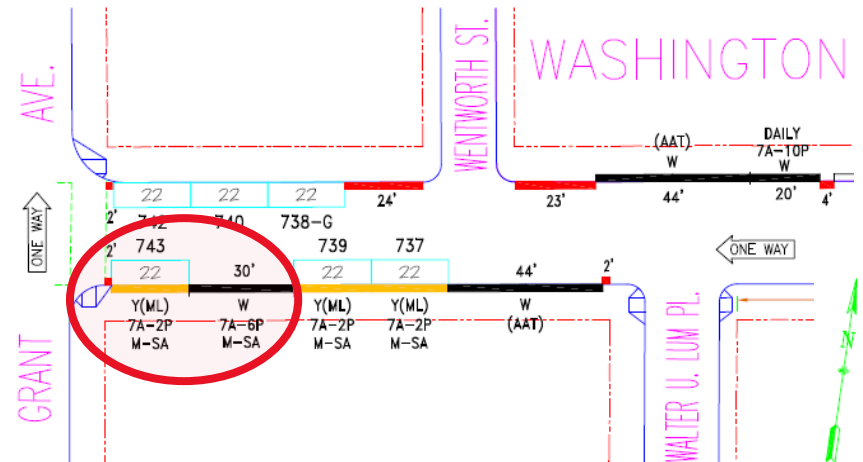
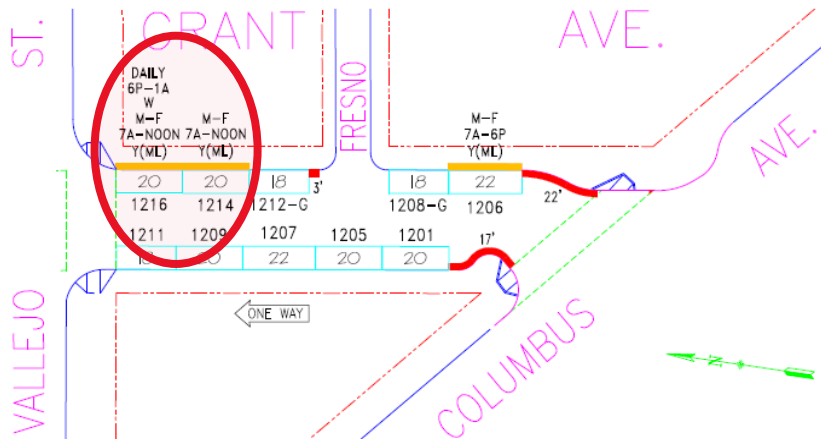

Conference Line: **1-415-523-2709** (conference ID: 836 632 456#)
 To comment on an item, press *5 to raise hand and *6 to unmute when prompted.

12(e). RESCIND – YELLOW METERED ZONE, COMMERCIAL LOADING, 7 AM TO 6 PM, MONDAY THROUGH SATURDAY
 Commercial Street, south side, from Grant Avenue to 18 feet easterly

12(f). ESTABLISH – YELLOW METERED ZONE, COMMERCIAL LOADING, 7 AM TO 6 PM, MONDAY THROUGH SATURDAY
 Commercial Street, south side, from 15 feet to 59 feet east of Grant Avenue (relocates yellow meter 743 to general meter 739 for 15' of daylighting; each yellow zone to be 22 feet in length)

12(g). RESCIND – YELLOW METERED ZONE, 6-WHEEL COMMERCIAL LOADING, 7 AM TO 4 PM, MONDAY THROUGH FRIDAY
 Sutter Street, south side, from Grant Avenue to 19 feet easterly (removes yellow meter 239 for 15' of daylighting and increases adjacent yellow meter lengths)

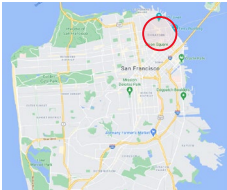
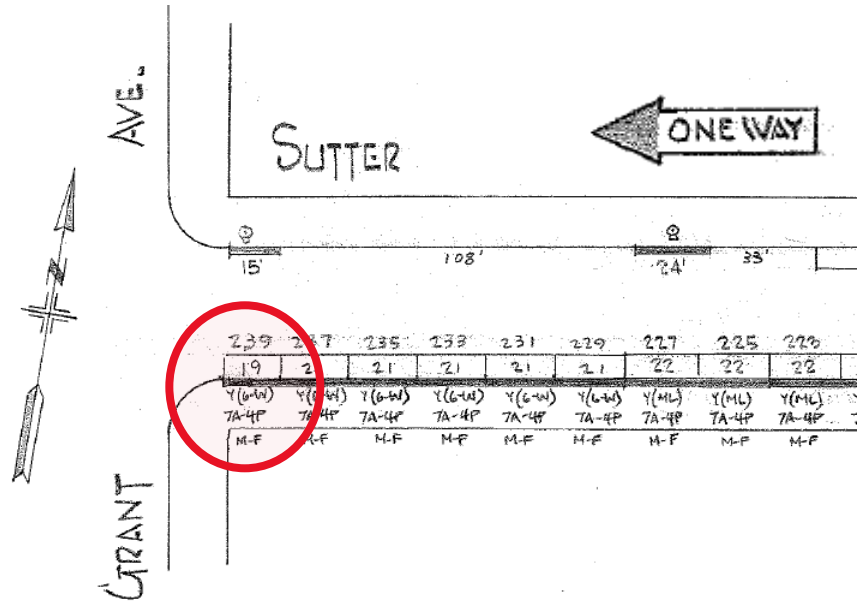
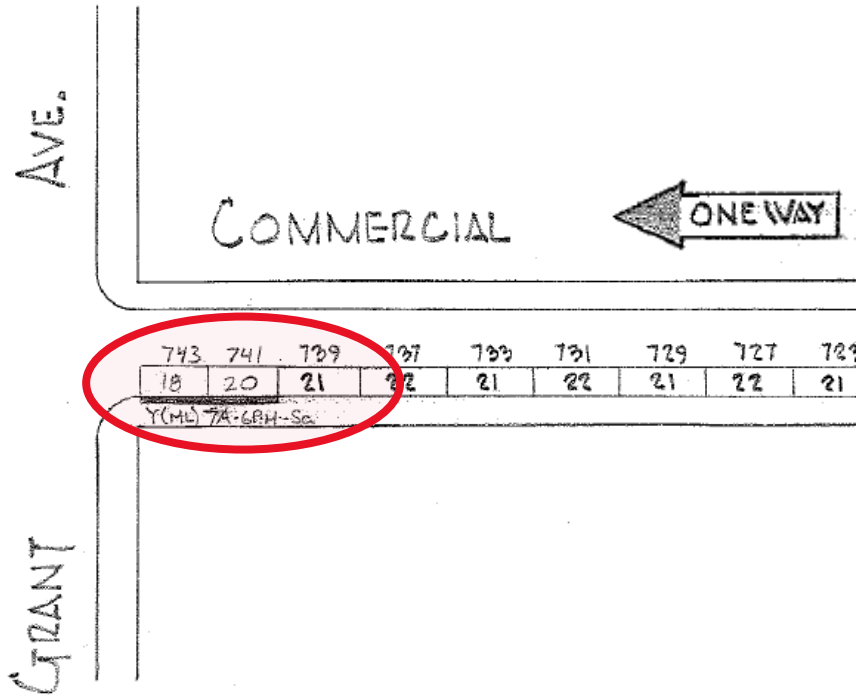

Conference Line: **1-415-523-2709** (conference ID: 836 632 456#)
 To comment on an item, press *5 to raise hand and *6 to unmute when prompted.

12(h). RESCIND - RESCIND – TOW-AWAY, NO STOPPING, PART-TIME SCHOOL BUS LOADING ZONE, 7 AM TO 6 PM, MONDAY THROUGH FRIDAY

Green Street, south side, from Embarcadero to 18 feet westerly (shortens white zone for daylighting)

12(i). RESCIND – YELLOW METERED ZONE, COMMERCIAL LOADING, 7 AM TO 4 PM, MONDAY THROUGH FRIDAY

Grant Avenue, west side, from Geary Street to 21 feet southerly (removes yellow meter for daylighting)

ITEM 12(i) WITHDRAWN

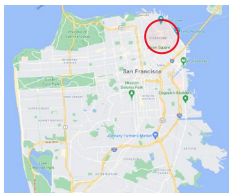
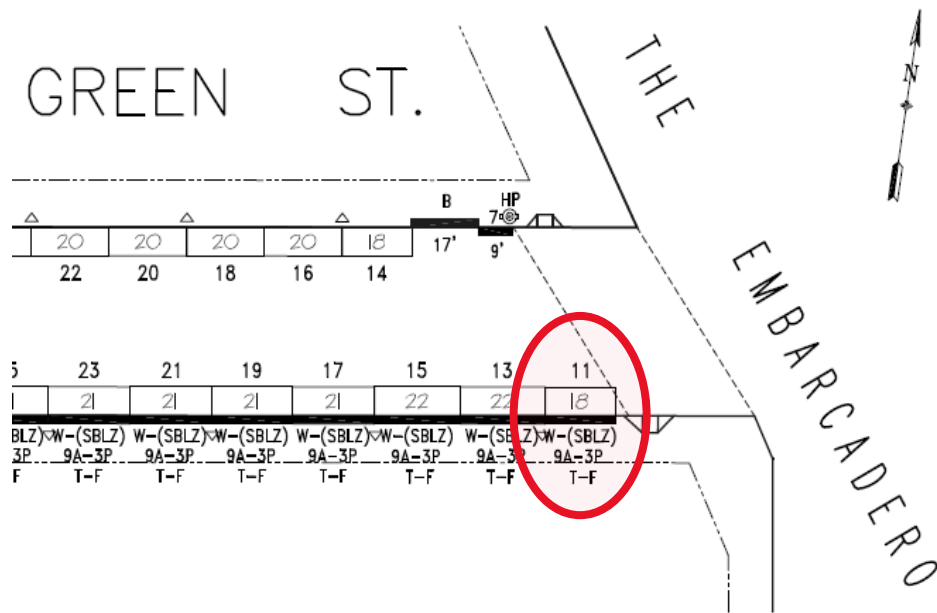

Conference Line: **1-415-523-2709** (conference ID: 836 632 456#)

To comment on an item, press *5 to raise hand and *6 to unmute when prompted.

12(j). RESCIND – BLUE ZONE

Union Street, south side, from Battery Street to 9 feet westerly

12(k). RESCIND – METERED MOTORCYCLE PARKING, 9 AM TO 6 PM, MONDAY THROUGH SATURDAY

ESTABLISH – BLUE ZONE

Battery Street, east side, from Union Street to 21 feet southerly (relocates blue zone for 9 feet of daylighting)

12(l). ESTABLISH – METERED MOTORCYCLE PARKING, 9 AM TO 6 PM, MONDAY THROUGH SATURDAY

Battery Street, east side, from 45 feet to 70 feet south of Union Street (relocates motorcycle spaces to metered space 1032)

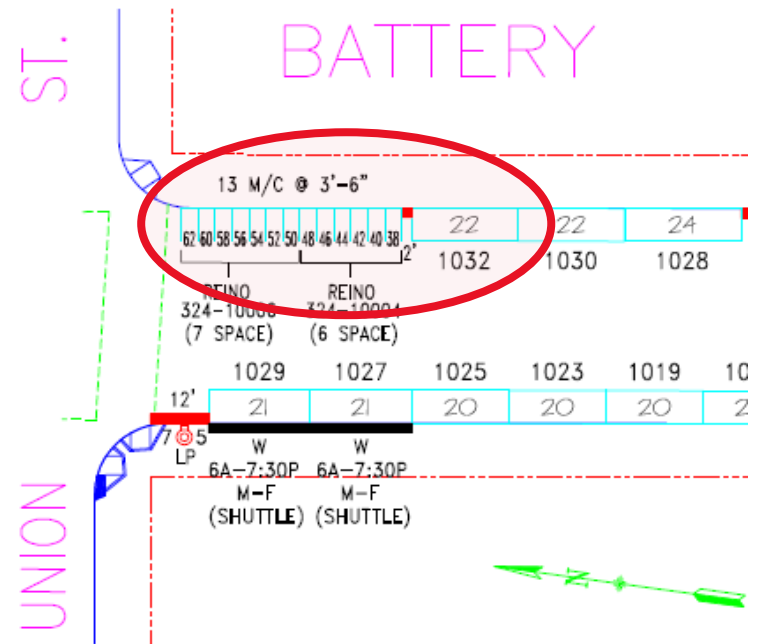
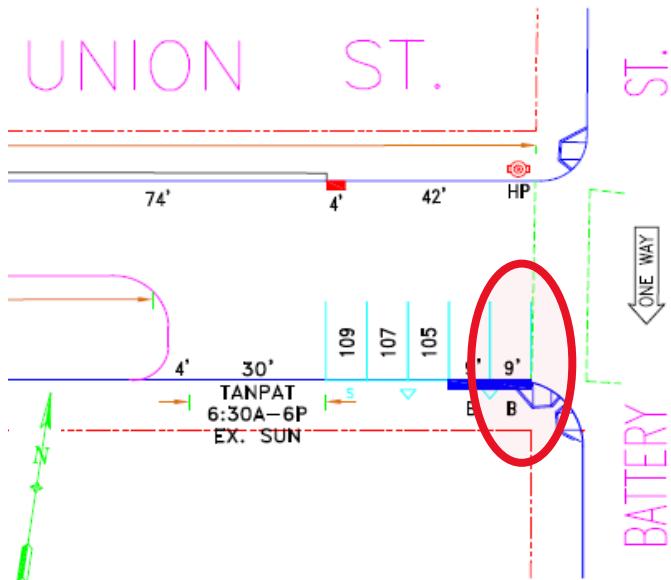

Conference Line: **1-415-523-2709** (conference ID: 836 632 456#)

To comment on an item, press *5 to raise hand and *6 to unmute when prompted.

13(a). RESCIND – BLUE ZONE

Jefferson Street, south side, from Hyde Street to 15 feet westerly

13(b). RESCIND – METERED MOTORCYCLE PARKING, 9 AM TO 6 PM, SUNDAY THROUGH SATURDAY

ESTABLISH – BLUE ZONE

Jefferson Street, north side, from Hyde Street to 23 feet westerly (relocates blue zone to existing motorcycle spaces for daylighting)

13(c). ESTABLISH – METERED MOTORCYCLE PARKING, 9 AM TO 6 PM, SUNDAY THROUGH SATURDAY

Jefferson Street, north side, from 23 feet to 45 feet west of Hyde Street (relocates motorcycle spaces to meter 516 location)

13(d). RESCIND – TOW-AWAY, NO PARKING, PASSENGER LOADING, 5-MINUTE TIME LIMIT, AT ALL TIMES

North Point, north side, from 5 to 15 feet east of Polk Street (shortens white zone for daylighting)

13(e). RESCIND – YELLOW METERED ZONE, COMMERCIAL LOADING, 7 AM TO 6 PM, MONDAY THROUGH SATURDAY

Ellis Street, south side, from Franklin Street to 18 feet easterly (removes yellow meter 943 for daylighting)

13(f). RESCIND – GREEN METERED ZONE, 15-MINUTE TIME LIMIT, 9 AM TO 6 PM, MONDAY THROUGH SATURDAY

Pierce Street, west side, from Chestnut Street to 18 feet northerly (removes green meter 3301-G for daylighting)

13(g). RESCIND – GREEN METERED ZONE, 15-MINUTE TIME LIMIT, 9 AM TO 6 PM, MONDAY THROUGH SATURDAY

Octavia Street, west side, from Union Street to 22 feet northerly (removes green meter 2801-G for daylighting)

13(h). RESCIND – GREEN METERED ZONE, 15-MINUTE TIME LIMIT, 9 AM TO 6 PM, MONDAY THROUGH SATURDAY

Parker Avenue, east side, from 6 feet to 16 feet south of Geary Boulevard (removes green meter 202-G for daylighting)

(Supervisor District 2) (Approvable by the City Traffic Engineer) Alvin Lam, alvin.lam@sfmta.com

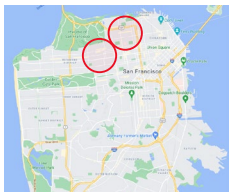

Conference Line: **1-415-523-2709** (conference ID: 836 632 456#)

To comment on an item, press *5 to raise hand and *6 to unmute when prompted.

13(a). RESCIND – BLUE ZONE

Jefferson Street, south side, from Hyde Street to 15 feet westerly

13(b). RESCIND – METERED MOTORCYCLE PARKING, 9 AM TO 6 PM, SUNDAY THROUGH SATURDAY

ESTABLISH – BLUE ZONE

Jefferson Street, north side, from Hyde Street to 23 feet westerly (relocates blue zone to existing motorcycle spaces for daylighting)

13(c). ESTABLISH – METERED MOTORCYCLE PARKING, 9 AM TO 6 PM, SUNDAY THROUGH SATURDAY

Jefferson Street, north side, from 23 feet to 45 feet west of Hyde Street (relocates motorcycle spaces to meter 516 location)

13(d). RESCIND – TOW-AWAY, NO PARKING, PASSENGER LOADING, 5-MINUTE TIME LIMIT, AT ALL TIMES

North Point, north side, from 5 to 15 feet east of Polk Street (shortens white zone for daylighting)

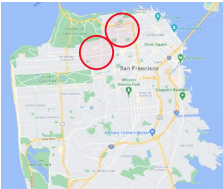
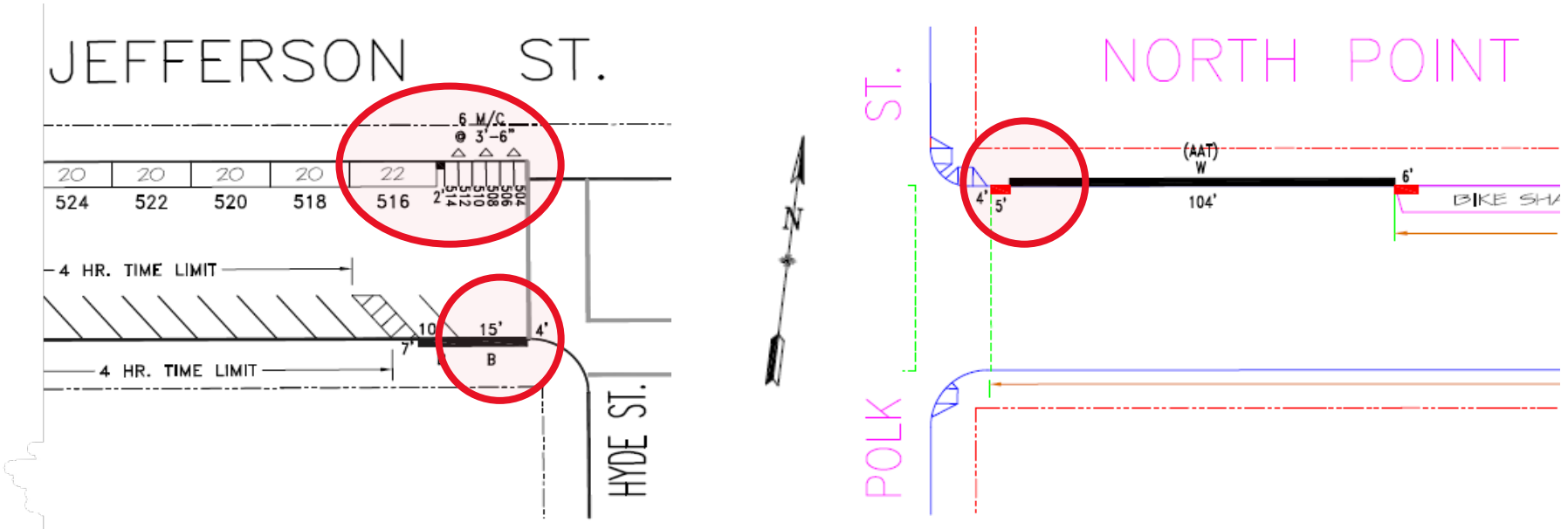

Conference Line: **1-415-523-2709** (conference ID: 836 632 456#)
To comment on an item, press *5 to raise hand and *6 to unmute when prompted.

13(e). RESCIND – YELLOW METERED ZONE, COMMERCIAL LOADING, 7 AM TO 6 PM, MONDAY THROUGH SATURDAY
 Ellis Street, south side, from Franklin Street to 18 feet easterly (removes yellow meter 943 for daylighting)

13(f). RESCIND – GREEN METERED ZONE, 15-MINUTE TIME LIMIT, 9 AM TO 6 PM, MONDAY THROUGH SATURDAY
 Pierce Street, west side, from Chestnut Street to 18 feet northerly (removes green meter 3301-G for daylighting)

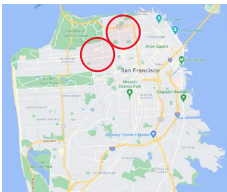
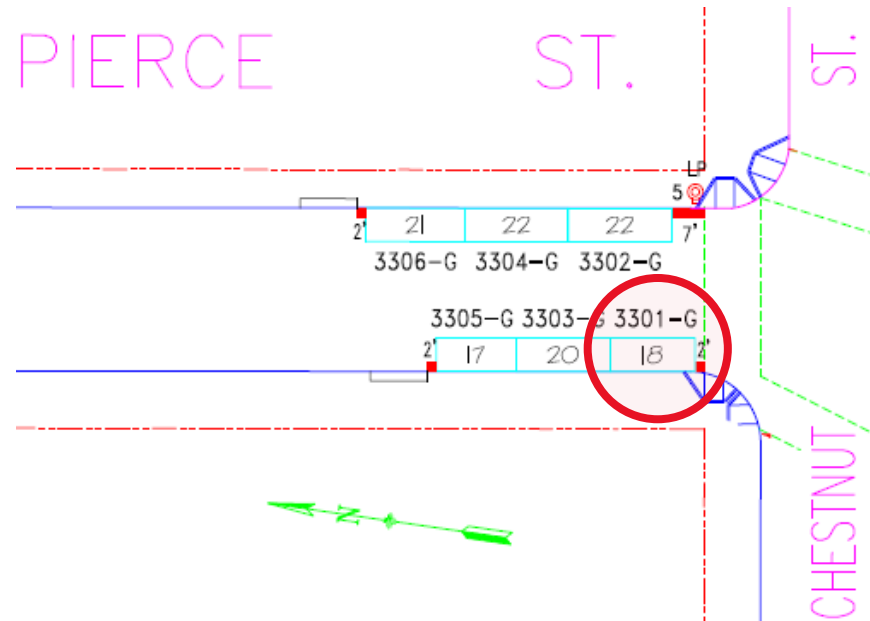
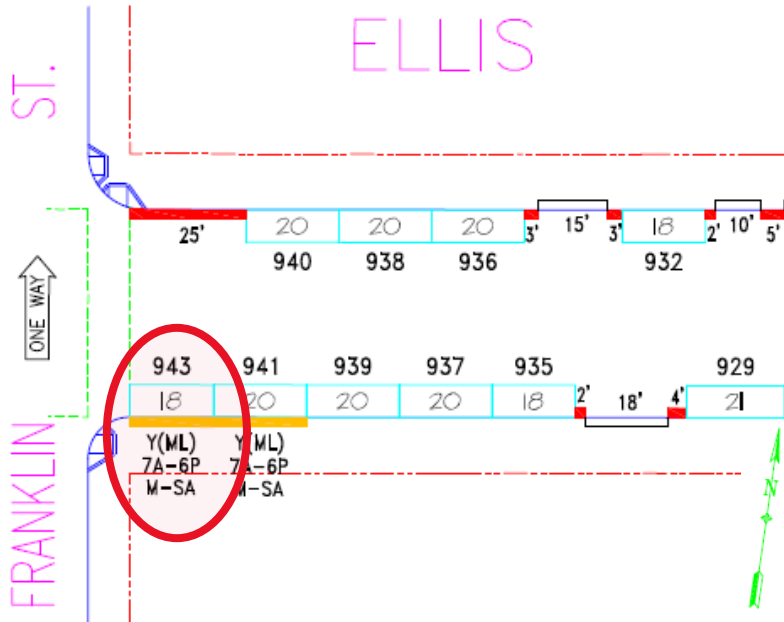

Conference Line: **1-415-523-2709** (conference ID: 836 632 456#)
 To comment on an item, press *5 to raise hand and *6 to unmute when prompted.

13(g). RESCIND – GREEN METERED ZONE, 15-MINUTE TIME LIMIT, 9 AM TO 6 PM, MONDAY THROUGH SATURDAY
Octavia Street, west side, from Union Street to 22 feet northerly (removes green meter 2801-G for daylighting)

13(h). RESCIND – GREEN METERED ZONE, 15-MINUTE TIME LIMIT, 9 AM TO 6 PM, MONDAY THROUGH SATURDAY
Parker Avenue, east side, from 6 feet to 16 feet south of Geary Boulevard (removes green meter 202-G for daylighting)

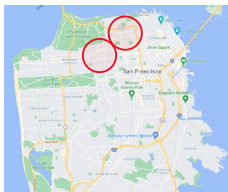
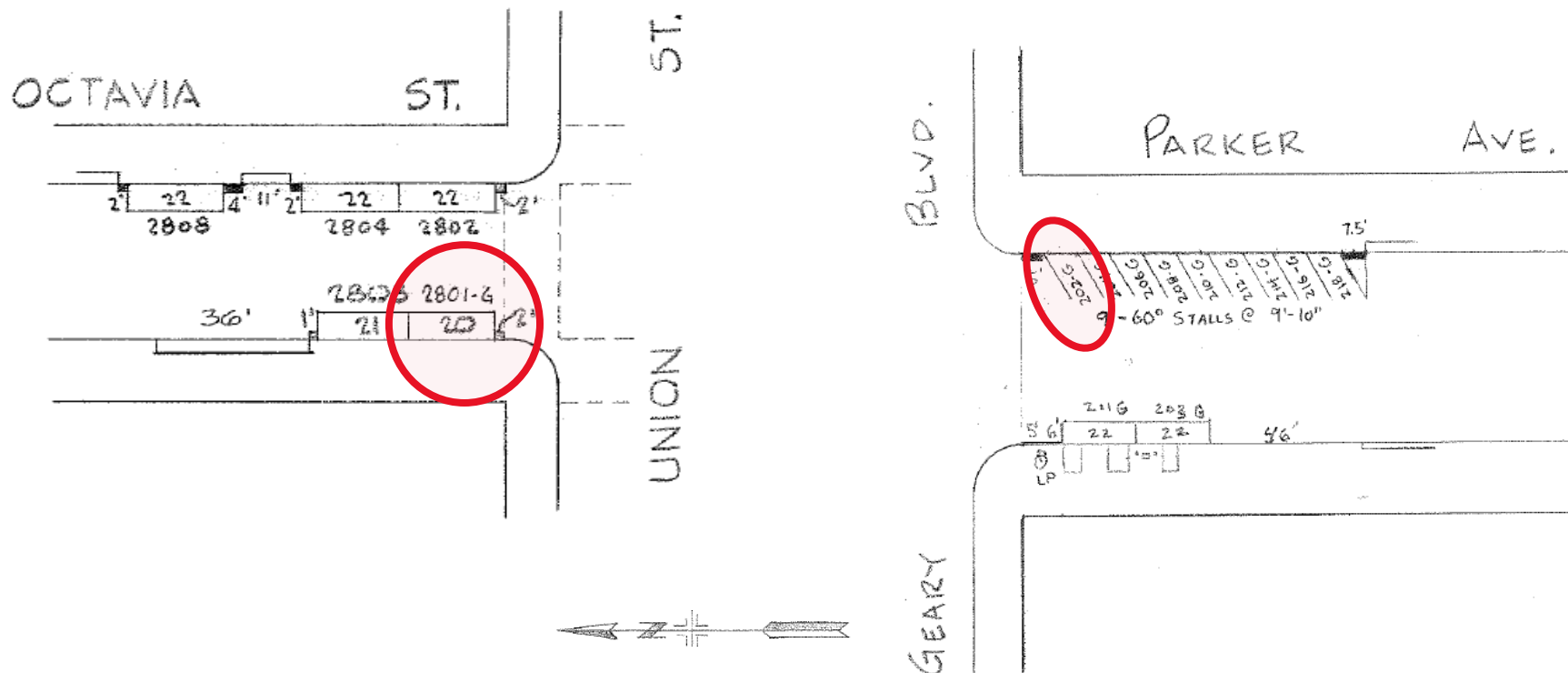

Conference Line: **1-415-523-2709** (conference ID: 836 632 456#)

To comment on an item, press *5 to raise hand and *6 to unmute when prompted.



<https://www.sfmta.com/getting-around/bike/bike-share>

A screenshot of a Google search page. The Google logo is centered at the top. Below it is a search bar containing the text "sfmta.com/bikeshare" and a microphone icon on the right. A red arrow points from the search bar to the text "Shortcut!". The entire search bar area is enclosed in a blue rectangular border.

Quick Links

[Overview](#) | [Equity](#) | [Bikeshare's Purpose](#) | [System Planning and Station Siting](#) | [Bay Area Bike Share Pilot](#) | [Stationless Bikeshare](#) | [Bikeshare Data](#)

**14. ESTABLISH – NO STOPPING, EXCEPT BICYCLES
ESTABLISH – BIKE SHARE STATION**

Kearny Street, west side, from 12 feet to 100 feet north of Bush Street (Supervisor District 3) (Approvable by the City Traffic Engineer) bikeshare@sfmta.com

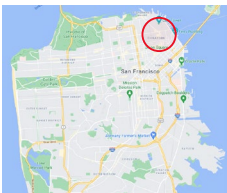
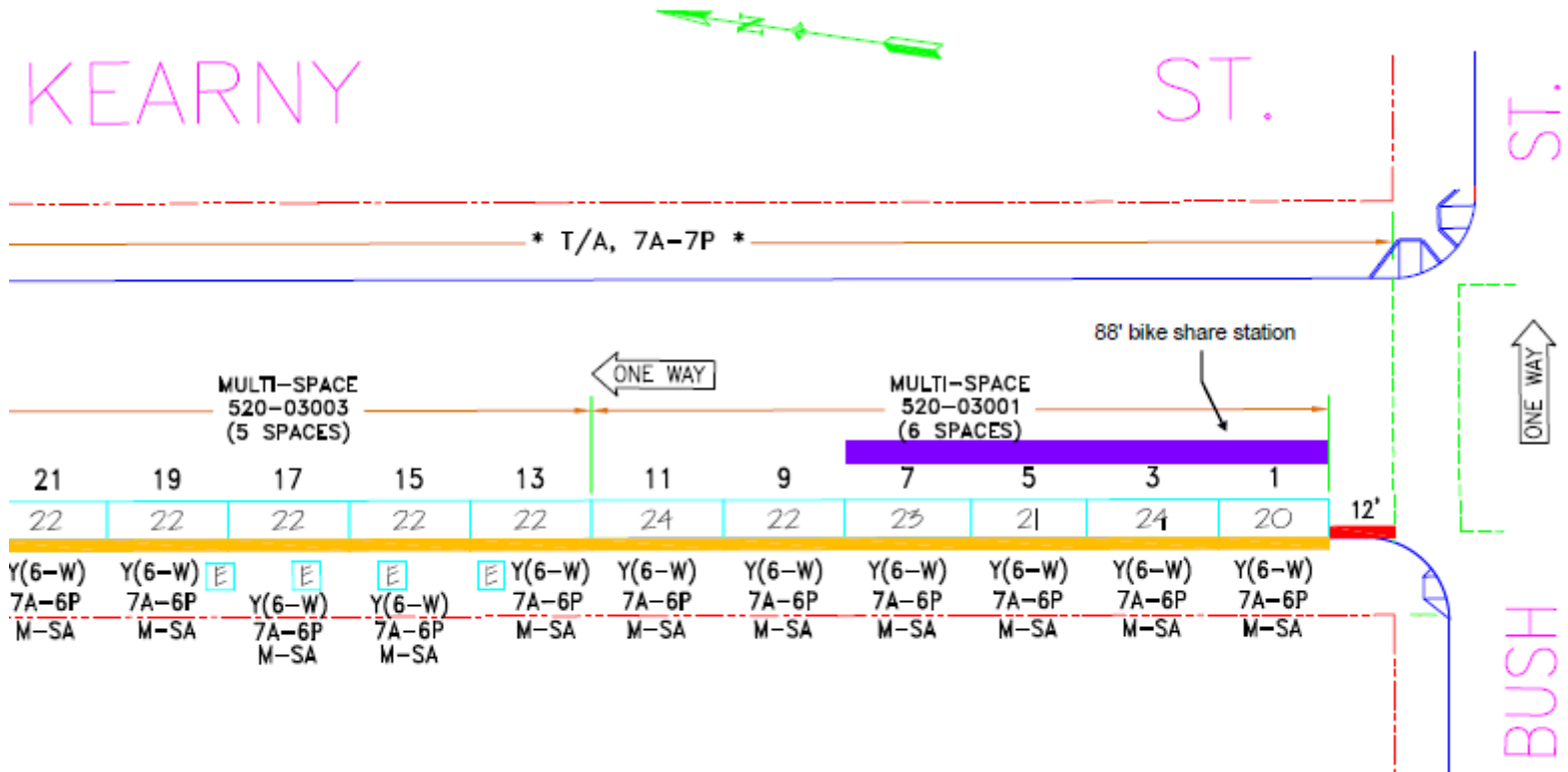

Conference Line: **1-415-523-2709** (conference ID: 836 632 456#)

To comment on an item, press *5 to raise hand and *6 to unmute when prompted.

**15. ESTABLISH – NO STOPPING, EXCEPT BICYCLES
ESTABLISH – BIKE SHARE STATION**

**Sutter Street, south side, from 34 feet to 128 feet east of Montgomery Street (Supervisor District 3)
(Approvable by the City Traffic Engineer) bikeshare@sfmta.com**

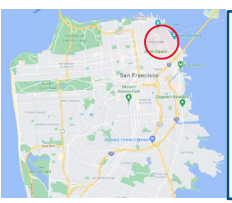
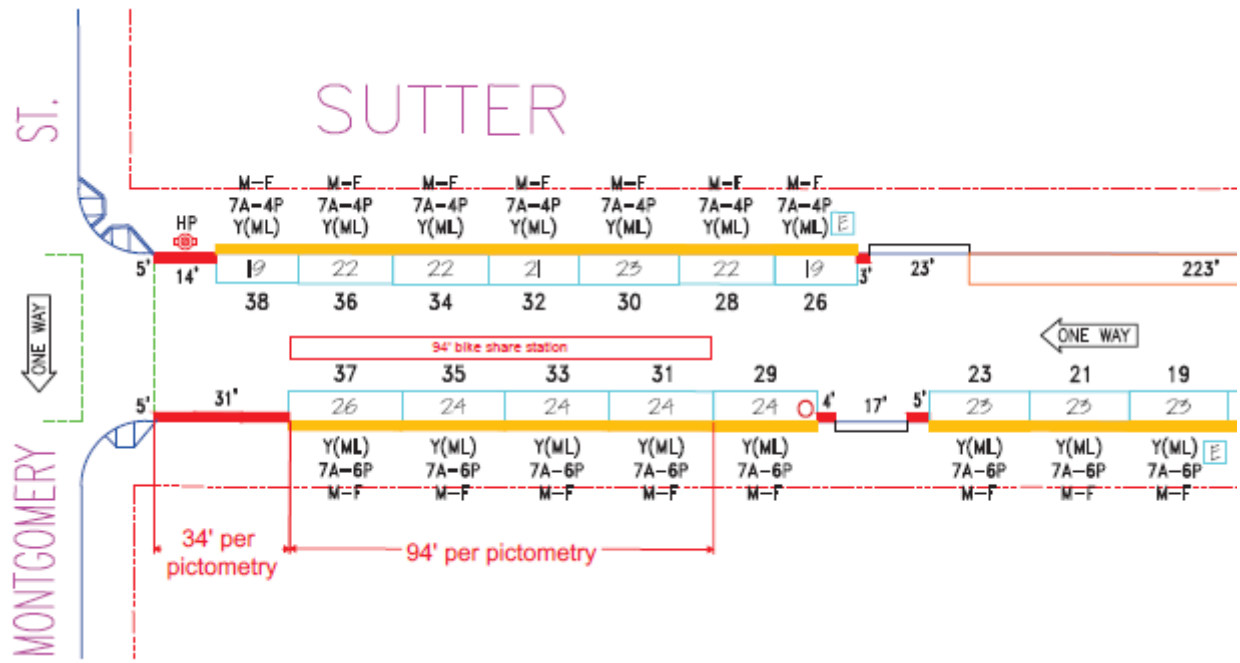

Conference Line: **1-415-523-2709** (conference ID: 836 632 456#)
To comment on an item, press *5 to raise hand and *6 to unmute when prompted.

PUBLIC COMMENT

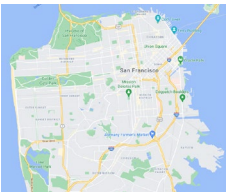

Conference Line: **1-415-523-2709** (conference ID: 836 632 456#)
To comment on an item, press *5 to raise hand and *6 to unmute when prompted.

Public Hearing Decision Posting

Results will be posted by 5 PM next Friday

<https://sfmta.com/engineering>

Select Meeting
from List of Past
Meetings

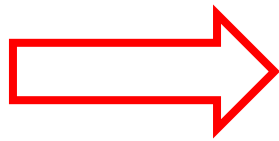

Past Meetings & Events for this Committee

Jan
17

Engineering Public Hearing Meeting,
January 17, 2025

The Streets Division of the San Francisco
Municipal Transportation Agency will
hold an online public...

Dec
6

Engineering Public Hearing Meeting,
December 6, 2024

The Streets Division of the San Francisco
Municipal Transportation Agency will
hold an online public...

Nov
8

Engineering Public Hearing Meeting,
November 8, 2024

The Streets Division of the San Francisco
Municipal Transportation Agency will
hold an online public...

[View All Past Meetings & Events →](#)



SFMTA

Next Engineering Public Hearing April 18, 2025

<https://sfmta.com/enghearing>

Conference Line: 1-415-523-2709

Conference ID: 836 632 456#