

SFMTA - TASC SUMMARY SHEET

PreStaff_Date: 8/13/2024 Requested_by: SFMTA Handled: Edgar Orozco Section Head : CL/MV	<input type="checkbox"/> Public Hearing Consent <input checked="" type="checkbox"/> Public Hearing Regular <input type="checkbox"/> Informational / Other <small>PH - Regular</small>	No objections: _____ Item Held: _____ Other: _____
Location: Church Street between 30th Street and Clipper Street		
Subject: J Church Stop Optimization & Stop Sign Installation		
PROPOSAL / REQUEST: Please see next page for legislative details.		
BACKGROUND INFORMATION / COMMENTS *As part of the J Church Muni Forward Project, this proposal seeks to optimize four existing rail stops on Church Street between 30th and Clipper Streets, as well as to add an all-way STOP sign at 28th and Church. *By consolidating the four existing transit stops into three stops, Muni will be able to reduce travel times and schedule variability along the corridor. Additionally, the optimized stops are more evenly distributed in the neighborhood. *Based on the most recently available five years of Transbase collision data (June 2019-May 2024), there were seven reported collisions at 28th and Church. Additionally, the project team was made aware of another collision that occurred at the intersection on August 6, 2024 (although not yet available in Transbase). *The project team has been in contact with the district supervisor regarding this proposal.		
HEARING NOTIFICATION AND PROCESSING NOTES:	ENVIRONMENTAL CLEARANCE BY: <input checked="" type="checkbox"/> SFMTA <input type="checkbox"/> Attached <input type="checkbox"/> Pending	
CHECK IF PREPARING SEPARATE SFMTA BOARD CALENDAR ITEM FOR PROPOSAL: <input type="checkbox"/>		

ESTABLISH - STOP SIGN

Church Street, northbound and southbound, at 28th Street

ESTABLISH - RED ZONE

Church Street, west side, from 28th Street to 20 feet northerly

ESTABLISH - TRANSIT STOP

Church Street, northbound and southbound, at 26th Street

Church Street, northbound and southbound, at 28th Street

RESCIND - TRANSIT STOP

Church Street, northbound and southbound, at Clipper Street

Church Street, northbound and southbound, at 27th Street

(Supervisor District 8)

Proposal to optimize J-Church stops on Church St. between 30th and Clipper Streets as well as to implement an all-way STOP at Church St. and 28th St.

Edgar Orozco (edgar.orozco@sfmta.com)

Legend

○ Existing transit stop

● Proposed new transit stop location

● Proposed all-way STOP sign

● Proposed transit stop removal

Church St

24th St

Jersey

25th St

Clipper

STOP RELOCATED

26th St

Cesar Chavez

27th St

Duncan

STOP RELOCATED

28th St

NEW STOP

Valley

29th St



Close-Up View of Project Area

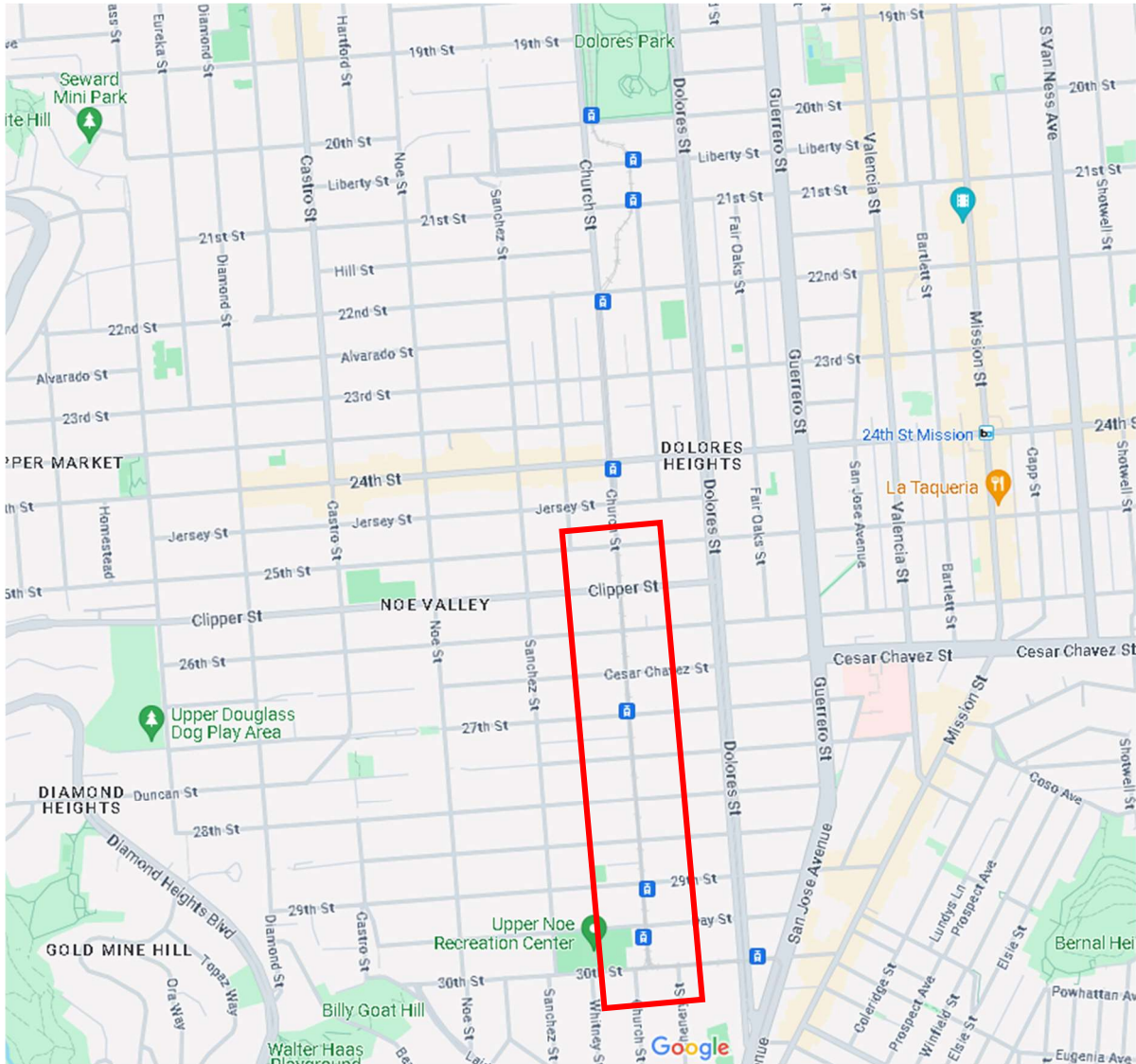

Project Area within Transit Map

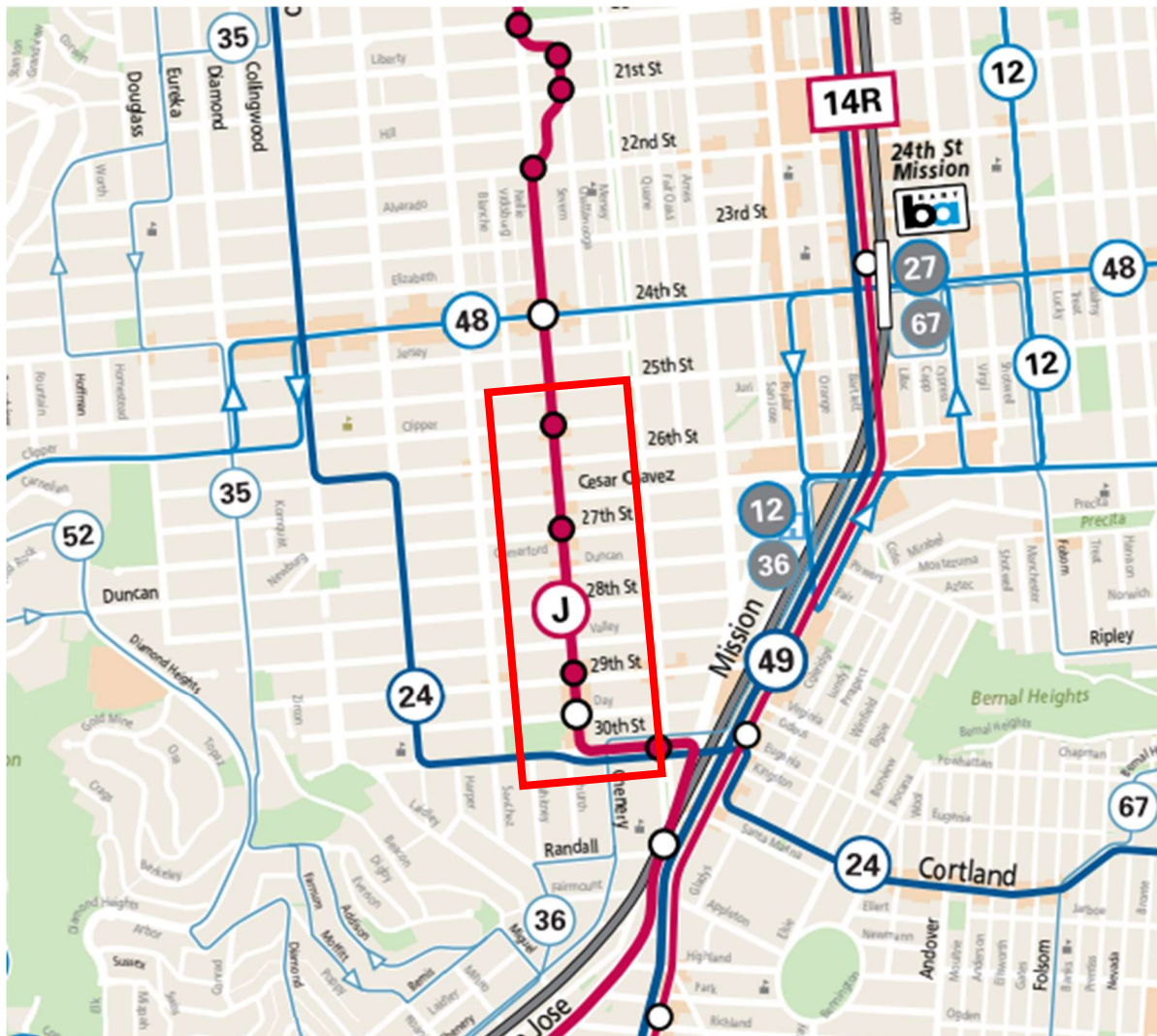

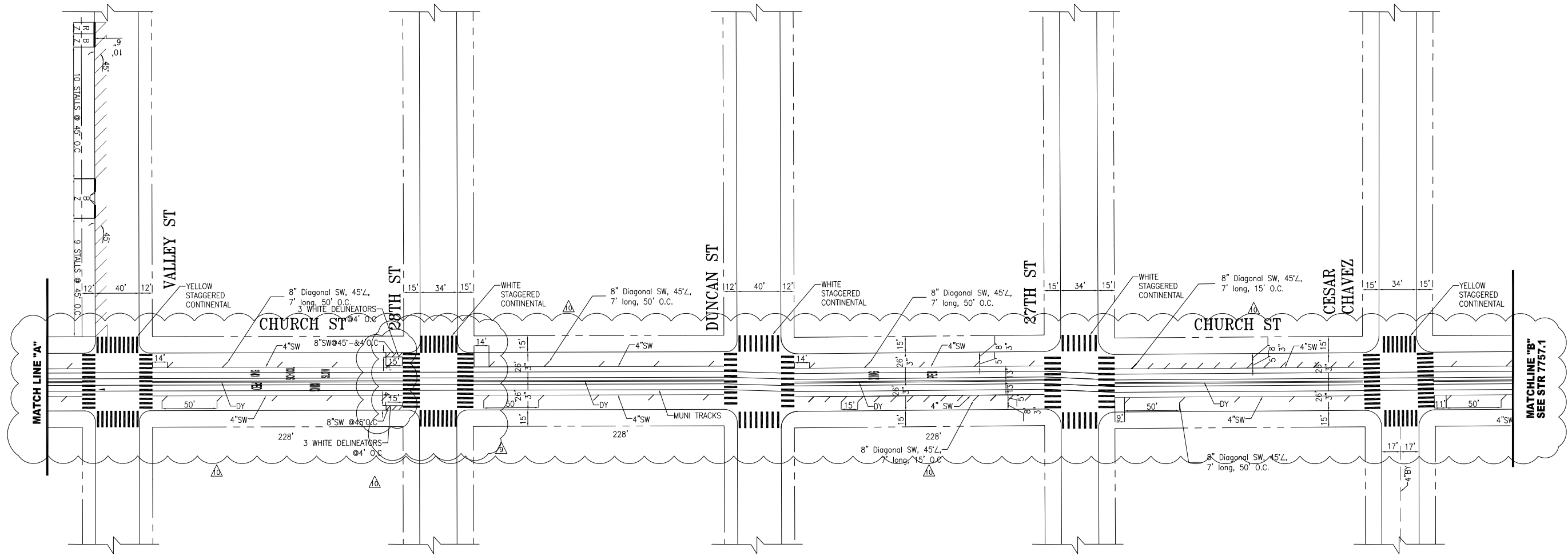
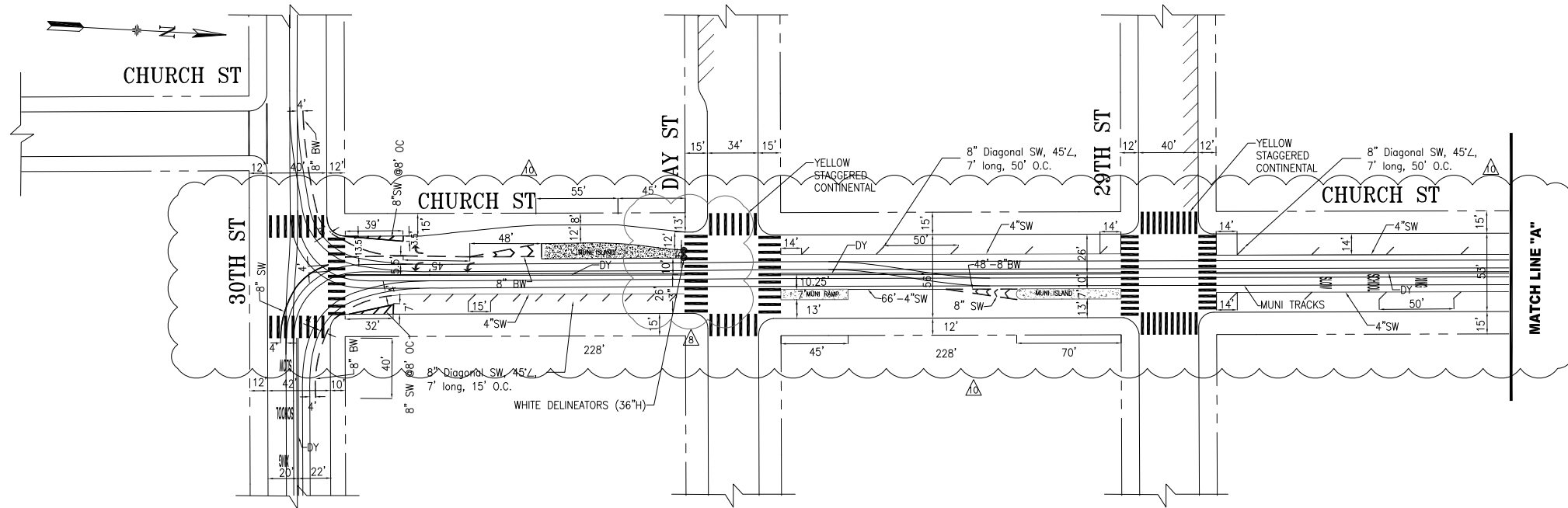

NO.	DATE	DESCRIPTION	BY	APP
Δ	XX/XX/XX	DAY-22ND: ADDED 50'-8"SW HATCHING; 30TH-DAY: ADDED 15'-8"SW HATCHING; ADDED CONTIS @ DUNCAN, 27TH, 26TH, 25TH	E OROZCO	M VELASCO
Δ	XX/XX/XX	ADDED HATCHED SAFETY ZONE AT SW&SE CORNER @ 28th ST	A CHUN	E TSUI
Δ	06/24/22	PER FIELD: CONTIS @ 30TH	A CHUN	E TSUI
Δ	XX/XX/XX	INSTALLED WHITE STAGGERED CONTIS AT 28TH ST	A CHUN	E TSUI
Δ	XX/XX/XX	ADDED DELINEATORS ON SB BOARDING ISLAND @ DAY ST	E OROZCO	C WONG

TABLE OF REVISIONS
CHECK WITH TRACING TO SEE IF YOU HAVE LATEST REVISION



SUPERCEDES STR-5916.1 CH 3		APPROVED DANIEL ARELLANO 01/09/08 SENIOR ENGINEER		SCALE: 1"=50'
DRAWN: D YEUNG	DATE: 12/19/07	DATE: 01/10/08	CITY TRAFFIC ENGINEER	SHEET/SHEETS: 1 OF 3
CHECKED: R JINDAL	DATE: 12/19/07			

CONTRACT NO.	TRAFFIC STRIPING
DRAWING NO. STR-7757.0	CHURCH STREET 30TH ST TO 26TH ST
FILE NO.	
REV. NO. 10	

EXTERNAL REFERENCES:
FONTS USED:
SCALE FACTOR:
PLOT SCALE:
FILE NAME:
DATE:
ORIGIN: OPERATIONS

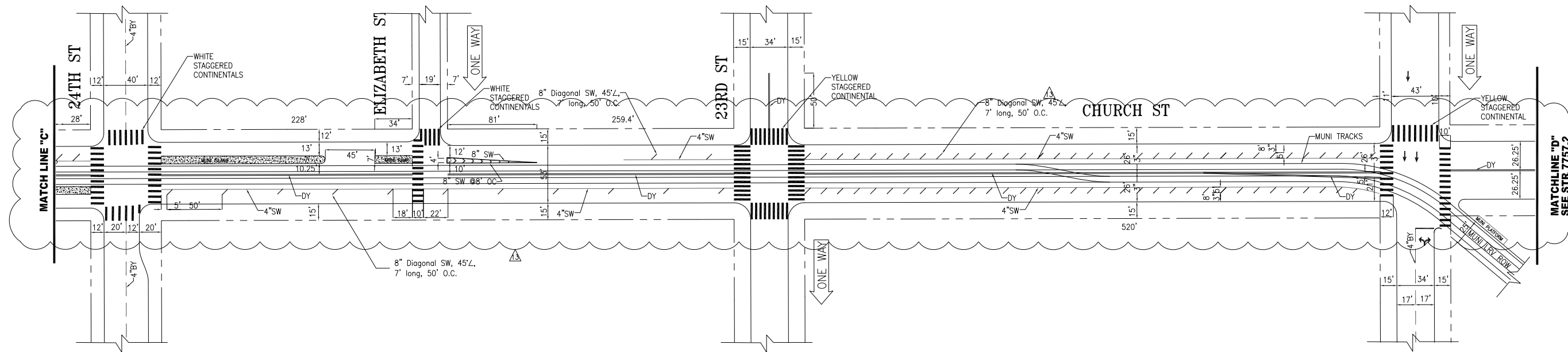
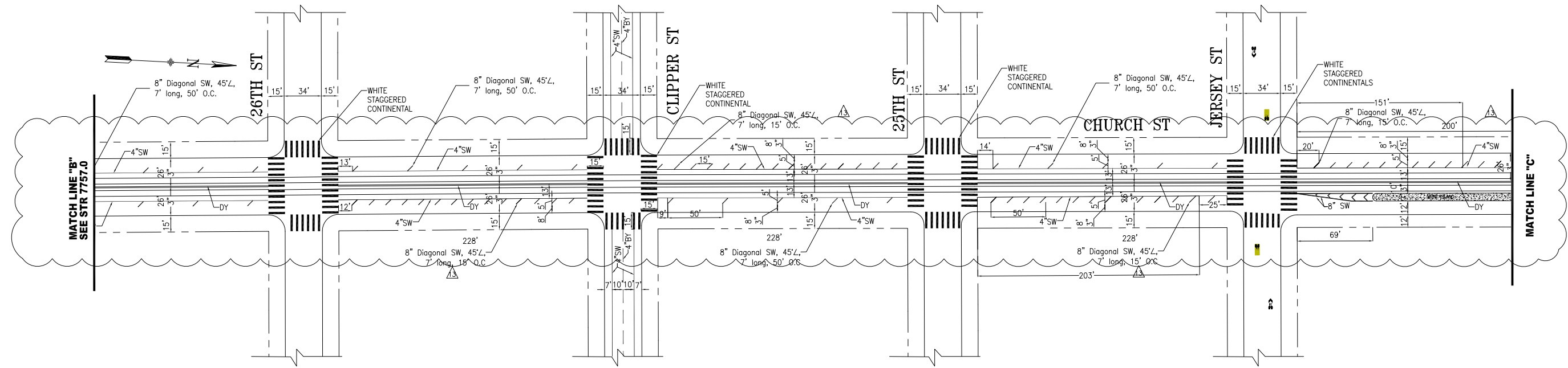

NO.	DATE	DESCRIPTION	BY	APP
13	XX/XX/XX	DAY-22ND: ADDED 50'-8"SW HATCHING; 30TH-DAY: ADDED 15'-8"SW HATCHING; ADDED CONTIS @ DUNCAN, 27TH, 26TH, 25TH	E OROZCO	M VELASCO
12	05/16/22	UPDATED N/S XWALKS @ CLIPPER TO CONTIS	A CHUN	E TSUI
11	07/31/20	UPDATED E/W XWALKS @ CLIPPER TO CONTIS	K L WOO	D V-SCHWENK
10	06/27/17	ADDED WHITE STAG CONTIS, UPDATE TO FIELD CONDS @ JERSEY	E CHEN	B WOO
9	03/10/15	UPGRADE WEST XWALK TO YELLOW STAGGERED CONTI @ 22ND	M D LEE	B WOO

TABLE OF REVISIONS
CHECK WITH TRACING TO SEE IF YOU HAVE LATEST REVISION



SFMTA



SUPERCEDES STR-5916 CH 4		APPROVED DANIEL ARELLANO 01/09/08 SENIOR ENGINEER		SCALE: 1" = 50'
DRAWN: D.YEUNG	DATE: 12/19/07	DATE: 12/19/07	DATE: 01/10/08	SHEET/SHEETS: 2 OF 3
CHECKED: R.JINDAL	DATE: 12/19/07	DATE: 12/19/07	DATE: 01/10/08	

TRAFFIC STRIPING	
CHURCH STREET	
26TH STREET TO 22ND STREET	

CONTRACT NO.	
DRAWING NO.	STR-7757.1
FILE NO.	
REV. NO.	13

FILE NAME:
DATE: --/--/--

Geographic Extent: Custom Boundary
Spatial Intersect: No Restriction (Only within Boundary)
Data Range: 06/01/2019 to 05/31/2024
Pull Date: 7/25/2024

Geographic Extent

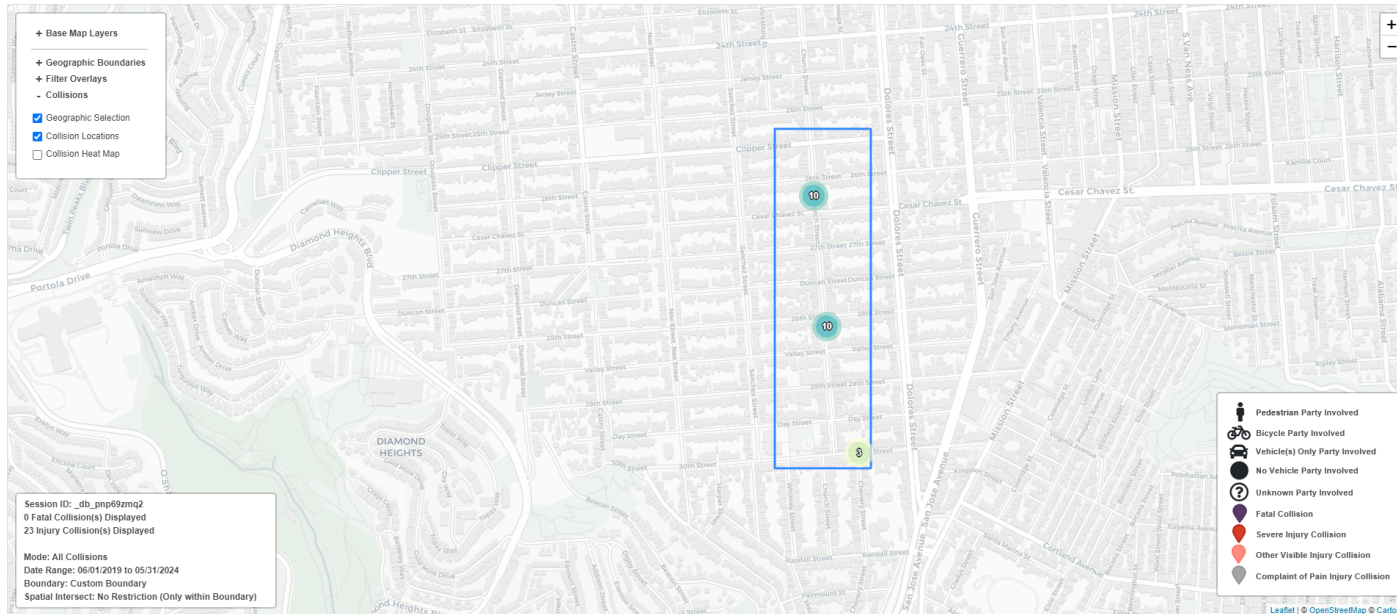

TransBASE Internal Dashboard

Geographic Extent: Custom Boundary

Spatial Intersect: No Restriction (Only within Boundary)

Data Range: 06/01/2019 to 05/31/2024

Pull Date: 7/25/2024

Collision/Party/Victim Table

Showing 1 to 23 of 23 entries

Count of Fatal Collisions: 0

Count of Non-Fatal Injury Collisions: 23

Total Count of Fatal/Non-Fatal Injury Collisions: 23

Case ID	Collision Date	Collision Time	Day of Week	Primary Road	Secondary Road	Distance	Direction	Party 1 Type	Party 1 Direction of Travel	Party 1 Movement Preceding Crash	Party 2 Type	Party 2 Direction of Travel	Party 2 Movement Preceding Crash	Vehicle Code Violation	Highest Degree of Injury	Type of Collision	Motor Vehicle Involved With	Hit and Run	Road Surface	Road Condition	Lighting
240287735	05/07/2024	16:05	Tuesday	CHURCH ST	VALLEY ST	0	Not Stated	Driver	South	Making Left Turn	Driver	North	Proceeding Straight	CVC 21801(a)	Injury (Complaint of Pain)	Broadside	Other Motor Vehicle	Felony	Dry	No Unusual Condition/ Not Stated	Daylight
240229981	04/12/2024	14:45	Friday	CLIPPER ST	CHURCH ST	0	Not Stated	Driver	West	Proceeding Straight	Pedestrian	North	Proceeding Straight	CVC 21950(a)	Injury (Complaint of Pain)	Vehicle/ Pedestrian	Pedestrian	No	Dry	No Unusual Condition/ Not Stated	Daylight
240011142	01/05/2024	15:25	Friday	CLIPPER ST	CHURCH ST	0	Not Stated	Driver	South	Making Right Turn	Driver	East	Proceeding Straight	CVC 22450(a)	Injury (Complaint of Pain)	Broadside	Other Motor Vehicle	No	Dry	No Unusual Condition/ Not Stated	Daylight
230861286	12/08/2023	10:26	Friday	CHURCH ST	CESAR CHAVEZ ST	0	Not Stated	Bicyclist	North	Proceeding Straight	Driver	East	Making Left Turn	CVC 22450(a)	Injury (Other Visible)	Broadside	Bicycle	No	Dry	No Unusual Condition/ Not Stated	Daylight
230840832	11/29/2023	11:10	Wednesday	CHURCH ST	VALLEY ST	0	Not Stated	Driver	East	Proceeding Straight	Driver	North	Proceeding Straight	CVC 22450(a)	Injury (Complaint of Pain)	Broadside	Other Motor Vehicle	No	Dry	No Unusual Condition/ Not Stated	Daylight
230563341	08/10/2023	08:50	Thursday	30TH ST	CHENERY ST	0	Not Stated	Driver	East	Making Right Turn	Driver	East	Proceeding Straight	CVC 22450(a)	Injury (Other Visible)	Broadside	Other Motor Vehicle	No	Dry	No Unusual Condition/ Not Stated	Daylight
230082686	02/03/2023	16:21	Friday	CESAR CHAVEZ ST	CHURCH ST	188	West	Bicyclist	East	Proceeding Straight				CVC 22350	Injury (Other Visible)	Overtaken	Non-Collision	No	Dry	No Unusual Condition/ Not Stated	Daylight
220310867	05/12/2022	15:08	Thursday	CHURCH ST	28TH ST	0	Not Stated	Driver	West	Proceeding Straight	Driver	South	Proceeding Straight	CVC 21800(a)	Injury (Complaint of Pain)	Broadside	Other Motor Vehicle	No	Not Stated	No Unusual Condition/ Not Stated	Daylight

TransBASE Internal Dashboard

Geographic Extent: Custom Boundary

Spatial Intersect: No Restriction (Only within Boundary)

Data Range: 06/01/2019 to 05/31/2024

Pull Date: 7/25/2024

Case ID	Collision Date	Collision Time	Day of Week	Primary Road	Secondary Road	Distance	Direction	Party 1 Type	Party 1 Direction of Travel	Party 1 Movement Preceding Crash	Party 2 Type	Party 2 Direction of Travel	Party 2 Movement Preceding Crash	Vehicle Code Violation	Highest Degree of Injury	Type of Collision	Motor Vehicle Involved With	Hit and Run	Road Surface	Road Condition	Lighting
220224973	04/06/2022	11:15	Wednesday	CHURCH ST	VALLEY ST	0	Not Stated	Driver	East	Proceeding Straight	Driver	North	Proceeding Straight	CVC 21802(a)	Injury (Complaint of Pain)	Broadside	Other Motor Vehicle	No	Dry	No Unusual Condition/ Not Stated	Daylight
220220830	04/04/2022	20:24	Monday	CHURCH ST	28TH ST	0	Not Stated	Driver	South	Proceeding Straight	Pedestrian	West	Proceeding Straight	CVC 21950(a)	Injury (Complaint of Pain)	Vehicle/ Pedestrian	Pedestrian	No	Dry	No Unusual Condition/ Not Stated	Dark - Street Lights
220080684	02/05/2022	09:45	Saturday	CHURCH ST	28TH ST	0	Not Stated	Driver	South	Making Left Turn	Driver	Not Stated	Proceeding Straight	CVC 21801(a)	Injury (Complaint of Pain)	Head-On	Other Motor Vehicle	No	Dry	No Unusual Condition/ Not Stated	Daylight
210511586	08/11/2021	16:34	Wednesday	CHURCH ST	28TH ST	0	Not Stated	Driver	West	Stopped	Driver	South	Proceeding Straight	CVC 21800(a)	Injury (Complaint of Pain)	Broadside	Other Motor Vehicle	No	Dry	No Unusual Condition/ Not Stated	Daylight
210450906	07/16/2021	22:44	Friday	CHURCH ST	26TH ST	0	Not Stated	Driver	South	Proceeding Straight	Driver	West	Proceeding Straight	CVC 22450(a)	Injury (Complaint of Pain)	Broadside	Other Motor Vehicle	No	Dry	No Unusual Condition/ Not Stated	Dark - Street Lights
210308515	05/19/2021	17:37	Wednesday	CHURCH ST	27TH ST	22	South	Pedestrian	East	Making Left Turn	Driver	South	Crossed Into Opposing Lane	CVC 21954(a)	Injury (Complaint of Pain)	Vehicle/ Pedestrian	Pedestrian	No	Dry	No Unusual Condition/ Not Stated	Daylight
200648525	10/27/2020	13:49	Tuesday	CHURCH ST	CESAR CHAVEZ ST	0	Not Stated	Driver	South	Proceeding Straight	Pedestrian	East	Proceeding Straight	CVC 21950(a)	Injury (Complaint of Pain)	Vehicle/ Pedestrian	Pedestrian	No	Dry	No Unusual Condition/ Not Stated	Daylight
200633162	10/20/2020	14:25	Tuesday	CHURCH ST	27TH ST	0	Not Stated	Driver	South	Entering Traffic	Driver	South	Proceeding Straight	CVC 21804(a)	Injury (Other Visible)	Broadside	Other Motor Vehicle	No	Dry	No Unusual Condition/ Not Stated	Daylight
200613095	10/11/2020	13:35	Sunday	30TH ST	CHENERY ST	0	Not Stated	Driver	North	Making Left Turn	Driver	East	Proceeding Straight	CVC 21802(a)	Injury (Complaint of Pain)	Broadside	Other Motor Vehicle	No	Dry	No Unusual Condition/ Not Stated	Daylight
200542842	09/09/2020	11:10	Wednesday	CHURCH ST	CESAR CHAVEZ ST	0	Not Stated	Driver	West	Proceeding Straight	Driver	North	Proceeding Straight	CVC 22450(a)	Injury (Complaint of Pain)	Broadside	Other Motor Vehicle	No	Dry	No Unusual Condition/ Not Stated	Dusk - Dawn

TransBASE Internal Dashboard

Geographic Extent: Custom Boundary

Spatial Intersect: No Restriction (Only within Boundary)

Data Range: 06/01/2019 to 05/31/2024

Pull Date: 7/25/2024

Case ID	Collision Date	Collision Time	Day of Week	Primary Road	Secondary Road	Distance	Direction	Party 1 Type	Party 1 Direction of Travel	Party 1 Movement Preceding Crash	Party 2 Type	Party 2 Direction of Travel	Party 2 Movement Preceding Crash	Vehicle Code Violation	Highest Degree of Injury	Type of Collision	Motor Vehicle Involved With	Hit and Run	Road Surface	Road Condition	Lighting
200530580	09/03/2020	12:35	Thursday	28TH ST	CHURCH ST	161	East	Driver	West	Other	Driver	East	Proceeding Straight	CVC 21751	Injury (Other Visible)	Head-On	Motor Vehicle on Other Roadway	No	Dry	No Unusual Condition/ Not Stated	Daylight
200083943	02/03/2020	09:10	Monday	CHURCH ST	28TH ST	0	Not Stated	Driver	West	Proceeding Straight	Driver	South	Proceeding Straight	CVC 21804(a)	Injury (Complaint of Pain)	Broadside	Other Motor Vehicle	No	Dry	No Unusual Condition/ Not Stated	Daylight
190767265	10/11/2019	18:13	Friday	CLIPPER ST	CHURCH ST	20	East	Driver	West	Backing	Pedestrian	East	Stopped	CVC 22106	Injury (Other Visible)	Vehicle/ Pedestrian	Pedestrian	No	Dry	No Unusual Condition/ Not Stated	Daylight
190712549	09/23/2019	12:32	Monday	CHURCH ST	28TH ST	0	Not Stated	Driver	West	Proceeding Straight	Driver	South	Proceeding Straight	CVC 21803(a)	Injury (Complaint of Pain)	Head-On	Other Motor Vehicle	No	Dry	No Unusual Condition/ Not Stated	Daylight
190691501	09/16/2019	12:42	Monday	30TH ST	CHENERY ST	0	Not Stated	Driver	West	Proceeding Straight	Driver	South	Making Left Turn	CVC 22350	Injury (Complaint of Pain)	Other	Non-Collision	No	Dry	No Unusual Condition/ Not Stated	Daylight

Transit Collisions

2018-2022

Date of Incident	Charge 1	Time of Incident	Location On (from InteleX)	Location At (from InteleX)	Description of Location	Weather	Lighting	Description of Environmental Conditions	Collision with	Line Number	Vehicle Action	Collision Type	Day of the Week	Mode	Was an Injury Involved	Description of Incident	Property Damage	Type of Vehicle Involved	MTA Damage	How many other vehicle(s) were involved?	How Many Pedestrians were Involved
3/15/22	Non-Preventable	8:00 AM	CHURCH ST	28TH ST	GREEN/MME	Cloudy	Daylight		MV - Van	N		Right Sideswipe	Tuesday	Rail	No	LRV Operator ID: 3671 could not have reasonably prevented this incident. The onboard video showed that the operator assessed the traffic situation before he cautiously proceeded to pass the double-parked School Bus-van. After the front area of the LRV Tra					
3/12/20	Non-Preventable	09:17:00 AM	30TH ST	CHURCH ST	inbound/nearside	Clear	Daylight	traffic/light road/dry	Auto/Van	E Embarcadero	Standing/Stopped	Back	Thursday	Rail	No	Stoped at 30 & Church a van made contact to rear of the car . Call central and inspector came	Yes	LRV	Minor	0	0
8/13/19	Preventable	08:33:00 AM	CHURCH ST	DUNCAN ST	outbound				Auto/Van	J Church	Going Straight	Right Sideswipe	Tuesday	Rail	No		Yes	LRV	Moderate	1	0
5/27/19	Non-Preventable	08:18:00 AM	CHURCH ST	DAY ST	midblock	Cloudy	Daylight	traffic/light road/dry	Auto/Van	J Church	Going Straight	Right Sideswipe	Monday	Rail	No	where car on right side made a illegal U-turn in front of the train . No injury and supervisor at the scene take picture and statement	Yes	LRV	Minor	1	0
4/9/19	Preventable	08:00:00 AM	CHURCH ST	VALLEY ST	inbound				Auto/Van	J Church	Going Straight	Back	Tuesday	Rail	No		No	LRV		1	0
3/16/19	Non-Preventable	08:00:00 AM	CHURCH ST	DUNCAN ST	inbound far side	Clear	Daylight	traffic; light road; dry	Auto/Van	F Market and Wharves	Going Straight	Left Sideswipe	Saturday	Rail	No	this automobile in Duncan didn't stop at stop sign and made contact with the left side of the train. I call CC. Inspector respon.	Yes	PCC	Minor	1	0
1/26/19	Preventable	08:22:00 PM	30TH ST	CHURCH ST	westbound				Truck	Another MUNI		Left Sideswipe	Saturday	Rail	No		Yes	Other	Minor	1	0
1/26/19	Non-Preventable	08:55:00 PM	30TH ST	CHURCH ST	westbound				Truck	F Market and Wharves	Going Straight	Front	Saturday	Rail	No		Yes	PCC	Minor	1	0
11/23/18	Preventable	02:10:00 PM	CHURCH ST	28TH ST	outbound	Fog/Mist	Daylight	traffic; medium road; wet	Auto/Van	J Church	Going Straight	Left Sideswipe	Friday	Rail	No	I was in the intersection and a driver ran a stop sign and hit the train on the left side.	Yes	LRV	Minor	1	0

2016 Ridership Data

ROUTE DESCRIPTION	STOP LOCATION	TOTAL			Total
		ON	OFF	LOAD	
J-Church [INBOUND]	30th St & Dolores St	249	101	1270.32	350
J-Church [INBOUND]	Church St & 30th St	351	39	1582.72	390
J-Church [INBOUND]	Church St & 29th St	356	27	1911.76	383
J-Church [INBOUND]	Church St & 27th St	426	37	2301.22	463
J-Church [INBOUND]	Church St & Clipper St	286	50	2537.24	335
J-Church [INBOUND]	Church St & 24th St	687	201	3022.94	888
					2810

ROUTE DESCRIPTION	STOP LOCATION	TOTAL			Total
		ON	OFF	LOAD	
J-Church [OUTBOUND]	Church St & 24th St	186	808	1894.63	993
J-Church [OUTBOUND]	Church St & Clipper St	66	234	1726.60	301
J-Church [OUTBOUND]	Church St & 27th St	54	312	1468.79	366
J-Church [OUTBOUND]	Church St & Day St	88	471	1085.99	558
J-Church [OUTBOUND]	Church St & 30th St	22	78	1030.56	100
J-Church [OUTBOUND]	30th St & Dolores St	50	150	930.74	200
					2519

2024 Ridership Data

ROUTE DESCRIPTION	STOP LOCATION	TOTAL			Total	% Change	
		ON	OFF	LOAD			
J Church	INBOUND	30th St & Dolores St	68	28	397	96	-73%
J Church	INBOUND	Church St & 30th St	87	16	468	103	-74%
J Church	INBOUND	Church St & 29th St	170	9	627	179	-53%
J Church	INBOUND	Church St & 27th St	192	16	802	208	-55%
J Church	INBOUND	Church St & Clipper St	108	14	895	122	-64%
J Church	INBOUND	Church St & 24th St	370	92	1,172	462	-48%
					1170	-58%	

ROUTE DESCRIPTION	STOP LOCATION	TOTAL			Total	% Change	
		ON	OFF	LOAD			
J Church	OUTBOUND	Church St & 24th St	70	420	878	490	-51%
J Church	OUTBOUND	Church St & Clipper St	18	98	798	116	-61%
J Church	OUTBOUND	Church St & 27th St	15	175	639	190	-48%
J Church	OUTBOUND	Church St & Day St	25	214	451	239	-57%
J Church	OUTBOUND	Church St & 30th St	see Church St & Day and 30th & Dolores				N/A
J Church	OUTBOUND	30th St & Dolores St	26	96	380	122	-39%
					1157	-54%	

Avg. Daily IB J Line Boardings:	2,929
--	--------------

Avg. Daily OB J Line Boardings:	1,174
--	--------------

Avg. Daily IB J Line Disembarkments:	1,398
---	--------------

Avg. Daily OB J Line Boardings Disembarkments:	2,810
---	--------------

Number of Inbound J Line Stops:	20
--	-----------

Number of Outbound J Line Stops:	19
---	-----------

Inbound Data

STOP LOCATION	TOTAL			Total
	ON	OFF	LOAD	
30th St & Dolores St	68	28	397	96
Church St & 30th St	87	16	468	103
Church St & 29th St	170	9	627	179
Church St & 27th St	192	16	802	208
Church St & Clipper St	108	14	895	122
Church St & 24th St	370	92	1,172	462
				1170

Outbound Data

STOP LOCATION	TOTAL			Total
	ON	OFF	LOAD	
Church St & 24th St	70	420	878	490
Church St & Clipper St	18	98	798	116
Church St & 27th St	15	175	639	190
Church St & Day St	25	214	451	239
30th St & Dolores St	26	96	380	122
				1157

Stop Location	Rank (IB Total Activity)	% IB Total Activity	Rank (IB Board)	% IB Boardings	Rank (IB Disembarkments)	% IB Disembarkments
30th St & Dolores St	14	2.22%	15	2.32%	8	2.00%
Church St & 30th St	12	2.38%	13	2.97%	13	1.14%
Church St & 29th St	8	4.14%	7	5.80%	17	0.64%
Church St & 27th St	7	4.81%	6	6.56%	12	1.14%
Church St & Clipper St	11	2.82%	10	3.69%	15	1.00%
Church St & 24th St	3	10.68%	2	12.63%	6	6.58%

Stop Location	Rank (OB Total Activity)	% OB Total Activity	Rank (OB Board)	% OB Boardings	Rank (OB Disembarkments)	% OB Disembarkments
Church St & 24th St	3	12.30%	6	5.96%	1	14.95%
Church St & Clipper St	11	2.91%	12	1.53%	10	3.49%
Church St & 27th St	8	4.77%	13	1.28%	7	6.23%
Church St & Day St	6	6.00%	8	2.13%	5	7.62%
30th St & Dolores St	10	3.06%	7	2.21%	11	3.42%

all data is from 2024 and excludes all stops/riders in Market Street Subway

Current Stops

Inbound Stop Name	Blocks to Next IB Stop	Distance to Next IB Stop
30th St & Dolores St	1	720 feet
Church St & 30th St	1	500 feet
Church St & 29th St	4	1180 feet
Church St & 27th St	3	870 feet
Church St & Clipper St	3	865 feet
Church St & 24th St		

Outbound Stop Name	Blocks to Next OB Stop	Distance to Next OB Stop
Church St & 24th St	3	900 feet
Church St & Clipper St	3	880 feet
Church St & 27th St	5	1,600 feet
Church St & Day St	2	780 feet
30th St & Dolores St		

Proposed Stops

Inbound Stop Name	Blocks to Next IB Stop	Distance to Next IB Stop
30th St & Dolores St	1	720 feet
Church St & 30th St	4	1,140 feet
Church St & 28th St	4	1,175 feet
Church St & 26th St	4	1,150 feet
Church St & 24th St		

Outbound Stop Name	Blocks to Next OB Stop	Distance to Next OB Stop
Church St & 24th St	4	1,165 feet
Church St & 26th St	4	1,175 feet
Church St & 28th St	3	1,025 feet
Church St & Day St	2	780 feet
30th St & Dolores St		

Changes

Distance Changed
0 feet
640 feet
-5 feet
280 feet

Distance Changed
265 feet
295 feet
-575 feet
0 feet

Intersection: Church St. & 28th St. Request No.: N/A

Date: 07/21/2022 Day: Thursday Time: 11:45-11:55am By: PS Weather: Cloudy

Southbound		Northbound		Eastbound	Westbound	Pedestrians Crossing
2	18	LT 17	THRU 1	RT 2	LT 1	
				THRU 3	THRU 4	
				RT 2	LT 2	
Total: 20		Total: 18		Total: 5	Total: 7	Total: 26
ADT: 4560				ADT: 1440		

Field Notes:

Legend:

- RC = Red Curb
- YC = Yellow Curb
- R1 = Stop Sign
- PP = Parallel Parking
- AP = Angled Parking
- BS = Bus Stop
- NP = No Parking Allowed
- CR = Curb Ramp
- R1-2 = Yield Sign
- CW = Crosswalk
- +O+ = Fire Hydrant
- DW = Driveway
- Painted Curb
- Grade (Average)
- STOP Sign

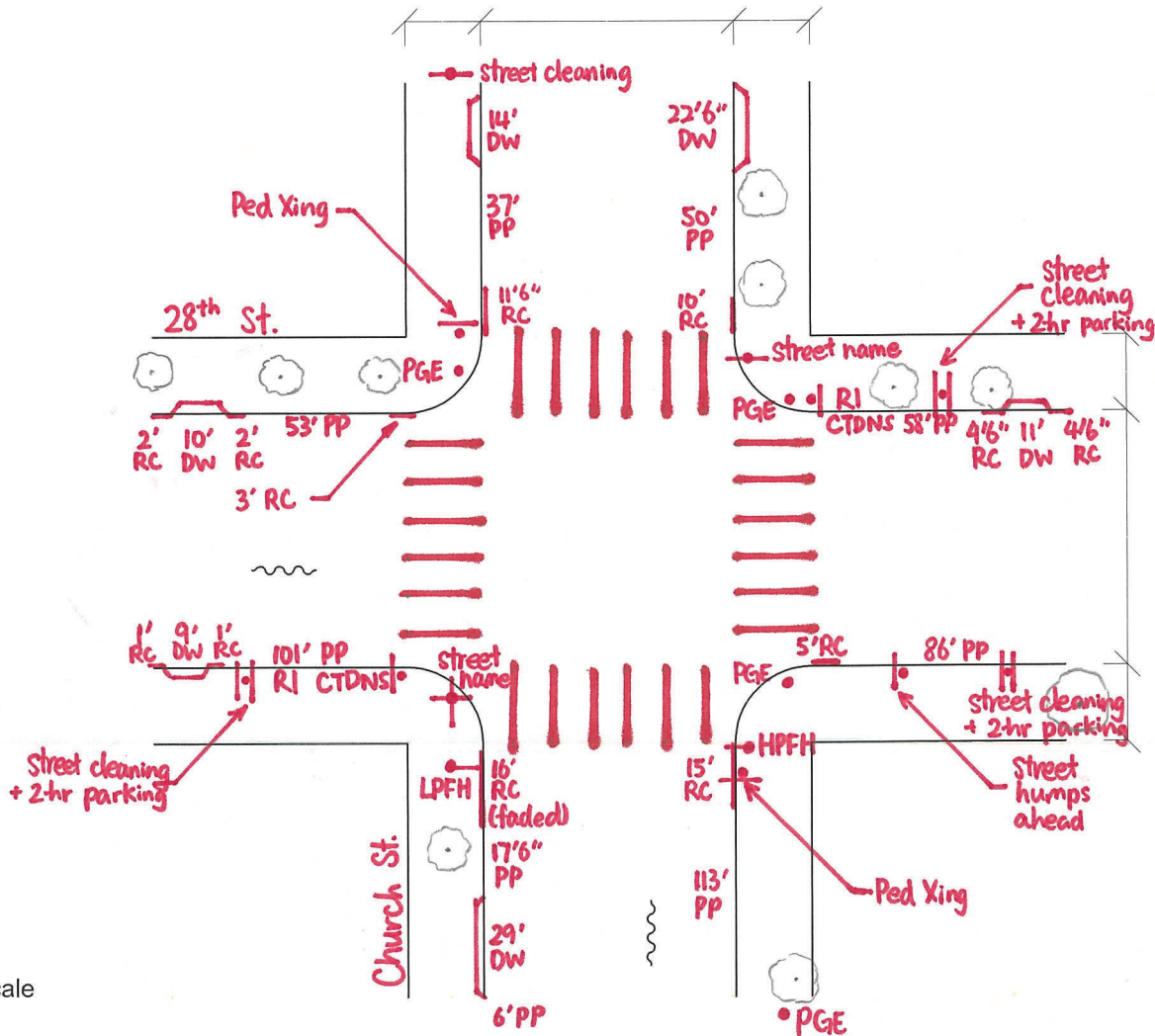
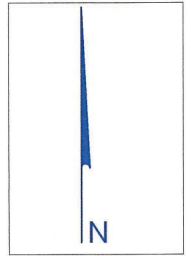

Not to Scale

SFMTA TRAFFIC ENGINEERING STOP SIGN CHECKLIST

STREET A: _____ **BY:** _____

STREET B: _____

REQUESTED STREET(S) TO BE STOPPED: _____

DATE OF FIELD OBSERVATIONS: _____

1. PREVIOUS CORRESPONDENCE

· Number of related letters within last five years: _____

2. TRAFFIC VOLUMES

· Previous 24-hour machine traffic counts? Yes No

· Street A ten minute ADT estimate (10 min. off-peak volume x 6 x 20): _____

· Street B ten minute ADT estimate (10 min. off-peak volume x 6 x 20): _____

· Time of ten minute count: _____

3. INTERSECTION COLLISIONS

· Five-year intersection reported collision total: Total _____ Rate _____

· Five-year intersection collisions correctable by STOP: Total _____ Injury _____

· Three or more injury correctable collisions in a 12 month period? Yes No

(“Correctable” includes right-angle, right turn, left turn, and pedestrian collisions)

4. FIELD CONDITIONS

· Sketch of intersection with street widths, striping, grades, parking, obstructions, etc.

· Check for adequate stopping sight distances

· Check condition of striping, STOP pavement markings, STOP signs, red curbs, etc.

5. AREA CONDITIONS

· Attach map with approaching traffic controls or STOP sign patterns

· Speed limit of street to be stopped: _____ MPH

· Area type: Residential Commercial Industrial

· Is the street to be stopped a designated major or minor arterial? Yes No

· Does the street to be stopped carry a bus or rail transit route? Yes No

If Yes, affected transit route(s): _____

6. PEDESTRIANS

· Estimated 10 minute pedestrian volume crossing street to be stopped: _____

· Check for adequate traffic gaps for pedestrians to cross

· Check for potential pedestrian traffic generators in the area

· Five-year intersection collisions involving pedestrians Total _____

7. SCHOOLS

· Is the intersection a designated school crossing (yellow crosswalk)? Yes No

If Yes, Name _____ Type _____

8. ALTERNATIVES TO STOP SIGNS

· Check for possible red curbs, tall vehicle restrictions, additional signs, etc.

· If the street to be stopped is a major traffic street, consider traffic signals review

STOP SIGN INSTALLATION FIELD CHECKLIST (If recommended only)

· Will tree trimming be necessary for new STOP sign visibility? Yes No

· Will “STOP Ahead” signs be necessary for new STOP signs? Yes No

· Any parking and height restrictions that should be modified? Yes No

· “SLOW SCHOOL XING” markings or warning signs to be removed? Yes No

NOTE: Every intersection is unique. This list is not intended to take the place of independent observation and analysis. (Form Revised 3/2009)

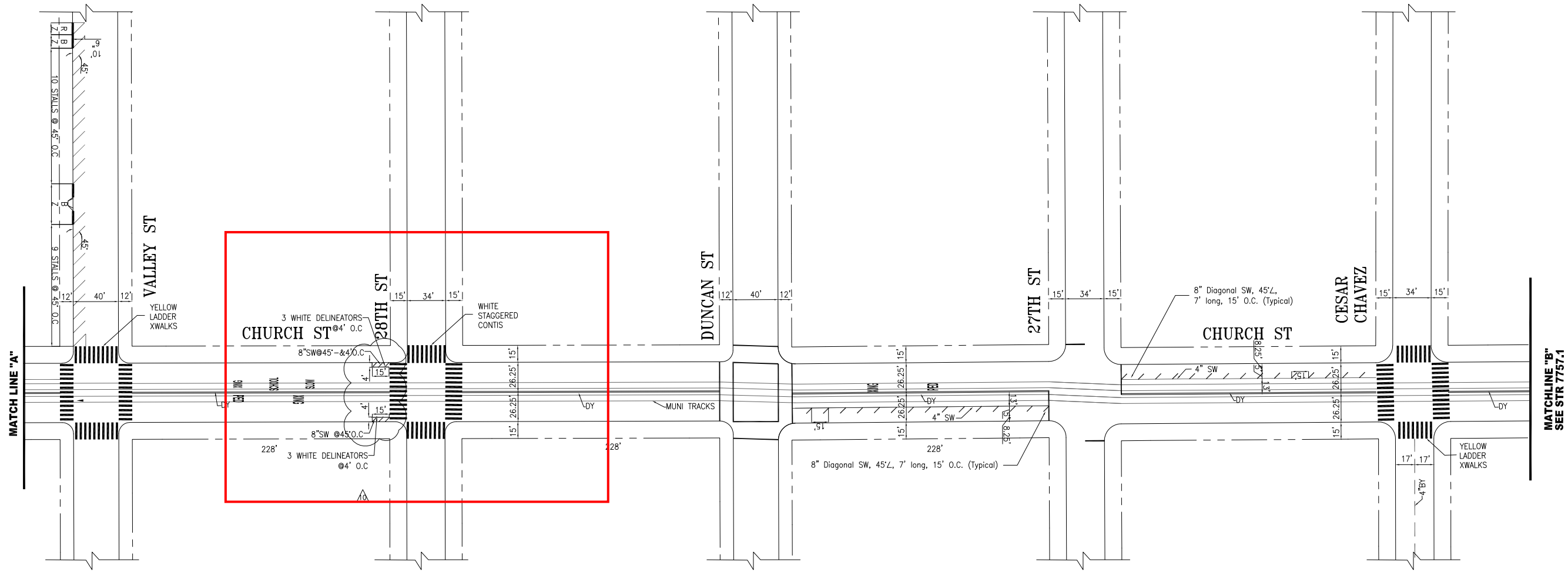
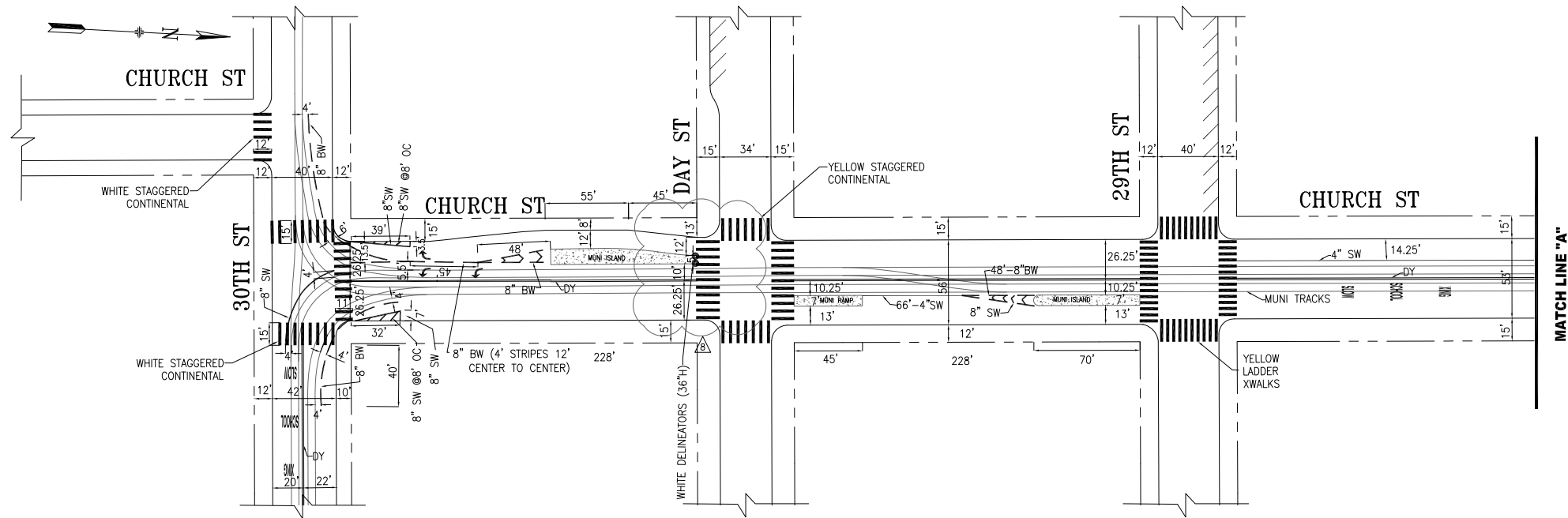

NO.	DATE	DESCRIPTION	BY	APP
1	xx/xx/xx	ADDED HATCHED SAFETY ZONE AT SW&SE CORNER @ 30th ST	A CHUN	E TSUI
2	06/24/22	PER FIELD: CONTIS @ 30TH	A CHUN	E TSUI
3	05/16/22	INSTALLED WHITE STAGGERED CONTIS AT 28TH ST	A CHUN	E TSUI
4	xx/xx/xx	ADDED DELINEATORS ON SB BOARDING ISLAND @ DAY ST	E OROZCO	C WONG
5	01/24/18	INSTALLED YELLOW STAGGERED CONTIS AT DAY ST	A WRIGHT	B WOO
6	*****	PER FIELD CONDITION: ADDED STALL MARKINGS AT VALLEY	T ABDALLAH	T FOLKS

TABLE OF REVISIONS
CHECK WITH TRACING TO SEE IF YOU HAVE LATEST REVISION



SUPERCEDES
STR-5916.1 CH 3

DRAWN: D.Y. DATE: 12/19/07
CHECKED: R.J. DATE: 12/19/07

APPROVED
DANIEL ARELLANO 2008
SENIOR ENGINEER
DATE:
JACK L. FLECK 2008
CITY TRAFFIC ENGINEER
DATE:

SCALE:
1"=50'
SHEET/SHEETS:
1 OF 3

TRAFFIC STRIPING
CHURCH STREET
30TH ST TO 18TH ST

CONTRACT NO.
DRAWING NO.
STR-7757.0
FILE NO.
REV. NO.
11

EXTERNAL REFERENCES:
FONTS USED:
SCALE FACTOR:
PLOT SCALE:
FILE NAME:
DATE:
T:_e_files\01_rec\dwgs\str-xxxx-ORIGIN-OPERATIONS

TransBASE Internal Dashboard

Geographic Extent: 21906000: 28TH ST at CHURCH ST
Spatial Intersect: SFMTA Intersection Related (<=20ft or <=150ft if Rear End)
Data Range: 04/01/2017 to 03/31/2022
Pull Date: 6/6/2022

Geographic Extent



TransBASE Internal Dashboard

Geographic Extent: 21906000: 28TH ST at CHURCH ST
 Spatial Intersect: SFMTA Intersection Related (<=20ft or <=150ft if Rear End)
 Data Range: 04/01/2017 to 03/31/2022
 Pull Date: 6/6/2022

Collision/Party/Victim Table Showing 1 to 4 of 4 entries

Count of Fatal Collisions: 0
 Count of Non-Fatal Injury Collisions: 4
 Total Count of Fatal/Non-Fatal Injury Collisions: 4

Case ID	Collision Date	Collision Time	Day of Week	Primary Road	Secondary Road	Distance	Direction	Party 1 Type	Party 1 Direction of Travel	Party 1 Movement Preceding Crash	Party 2 Type	Party 2 Direction of Travel	Party 2 Movement Preceding Crash	Vehicle Code Violation	Highest Degree of Injury	Type of Collision	Motor Vehicle Involved With	Weather	Road Condition	Lighting
1 220080684	02/05/2022	09:45	Saturday	CHURCH ST	28TH ST	0	Not Stated	Driver	South	Making Left Turn	Driver	Not Stated	Proceeding Straight	CVC 21801(a)	Injury (Complaint of Pain)	Head-On	Other Motor Vehicle	Clear	No Unusual Condition/Not Stated	Daylight
2 210511586	08/11/2021	16:34	Wednesday	CHURCH ST	28TH ST	0	Not Stated	Driver	West	Stopped	Driver	South	Proceeding Straight	CVC 21800(a)	Injury (Complaint of Pain)	Broadside	Other Motor Vehicle	Clear	No Unusual Condition/Not Stated	Daylight
3 200083943	02/03/2020	09:10	Monday	CHURCH ST	28TH ST	0	Not Stated	Driver	West	Proceeding Straight	Driver	South	Proceeding Straight	CVC 21804(a)	Injury (Complaint of Pain)	Broadside	Other Motor Vehicle	Clear	No Unusual Condition/Not Stated	Daylight
4 190712549	09/23/2019	12:32	Monday	CHURCH ST	28TH ST	0	Not Stated	Driver	West	Proceeding Straight	Driver	South	Proceeding Straight	CVC 21803(a)	Injury (Complaint of Pain)	Head-On	Other Motor Vehicle	Clear	No Unusual Condition/Not Stated	Daylight

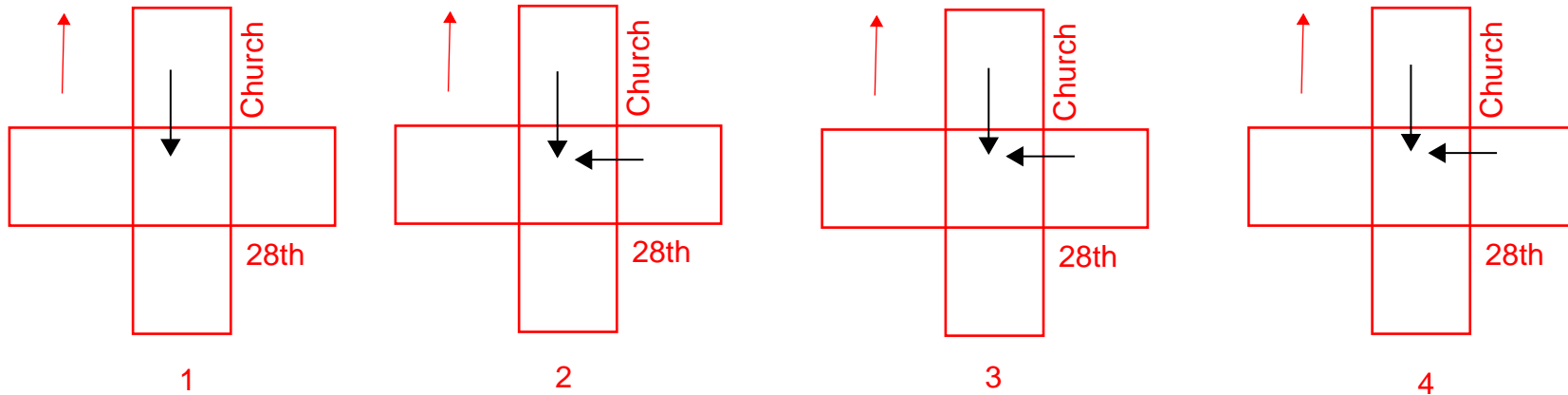

direction of 2nd vehicle is unknown

Intersection	Date	Line	Mode Upd ARB Charge	At Street	Collision Type	Collision With (Operator)	Direction	IE_DESC	Incident Number	Injury InvolMTA Vehicle Action	On Street	Safety Analysis	Time		
5 28th St & Church St	1/18/2017	J Church	LRV	Unavoidable	28th St	Right Sideswipe	outbound GrdCross-Yes	Run#49 Line: J Church , direction outbound, Location: on Church Street at 28th Street, Wetaher; Cloudy and rain. White cargo van entering intersection on Church Street at 28th Street illegally and dangerously . I pressed my emergency brakes , Vehicle#1461 skid 3-5 feet contact was made	FY17-04173	No	Going Straight	Church St	FY17-04173 DETERMINATION: NON-PREVENTABLE - LRV vs. Van (van unsafely sped into intersection, and made contact with LRV). RUN 49//1461(B). Location: 08 Church and 28th Streets, Date: 1/18/17, Time: 10:15 a.m., Operator: Alfredo Diaz, ID: 3452, TSS: Paul Lee, Property Damage: LRV - minor, non-disabling damage to couple housing; Van - minor damage to right rear of van, Injury: None reported. PRIMARY CAUSE: Driver of van unsafely entered intersection, cut in front of LRV and made contact. CONTRIBUTORY CAUSE: N/A. My determination was based on the operator's report, and the supervisor's statement (Onboard Video was unavailable). Operator Diaz stated in his report that while traveling southbound on Church Street, he approached and entered the intersection of 28th Street at approximately 20 mph. He saw a van at the 28th Street stop sign stopped and then sped out into the intersection in front of his LRV. Operator Diaz immediately applied his brakes but was not able to stop short of making contact. In the supervisor's report, Party 2 - driver of the van told Supervisor Eric Williams that he did stop at the stop sign and then began to enter the intersection. Operator Diaz could not have avoided the collision.	10:15 AM	
6 28th St & Church St	11/23/2018	J Church	LRV	Avoidable	28th St	Left Sideswipe	Auto/Van	outbound	I was in the intersection and a driver ran a stop sign and hit the train on the left side.	FY19-02242	No	Going Straight	Church St	AVOIDABLE Collision. OP ID 4414, failed to travel at a safe speed for conditions. Operator failed to reduce speed for intersections. Operator did not Scan(get the big picture). Operator did not take any emergency braking action.	2:10 PM

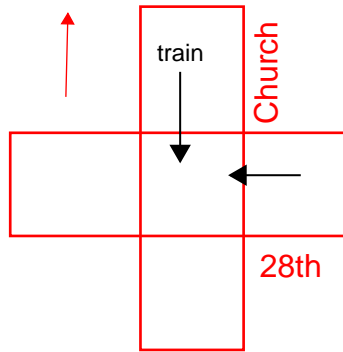
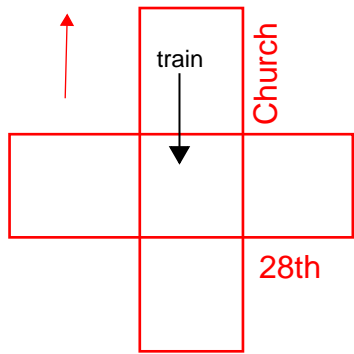

direction of 2nd vehicle is unknown

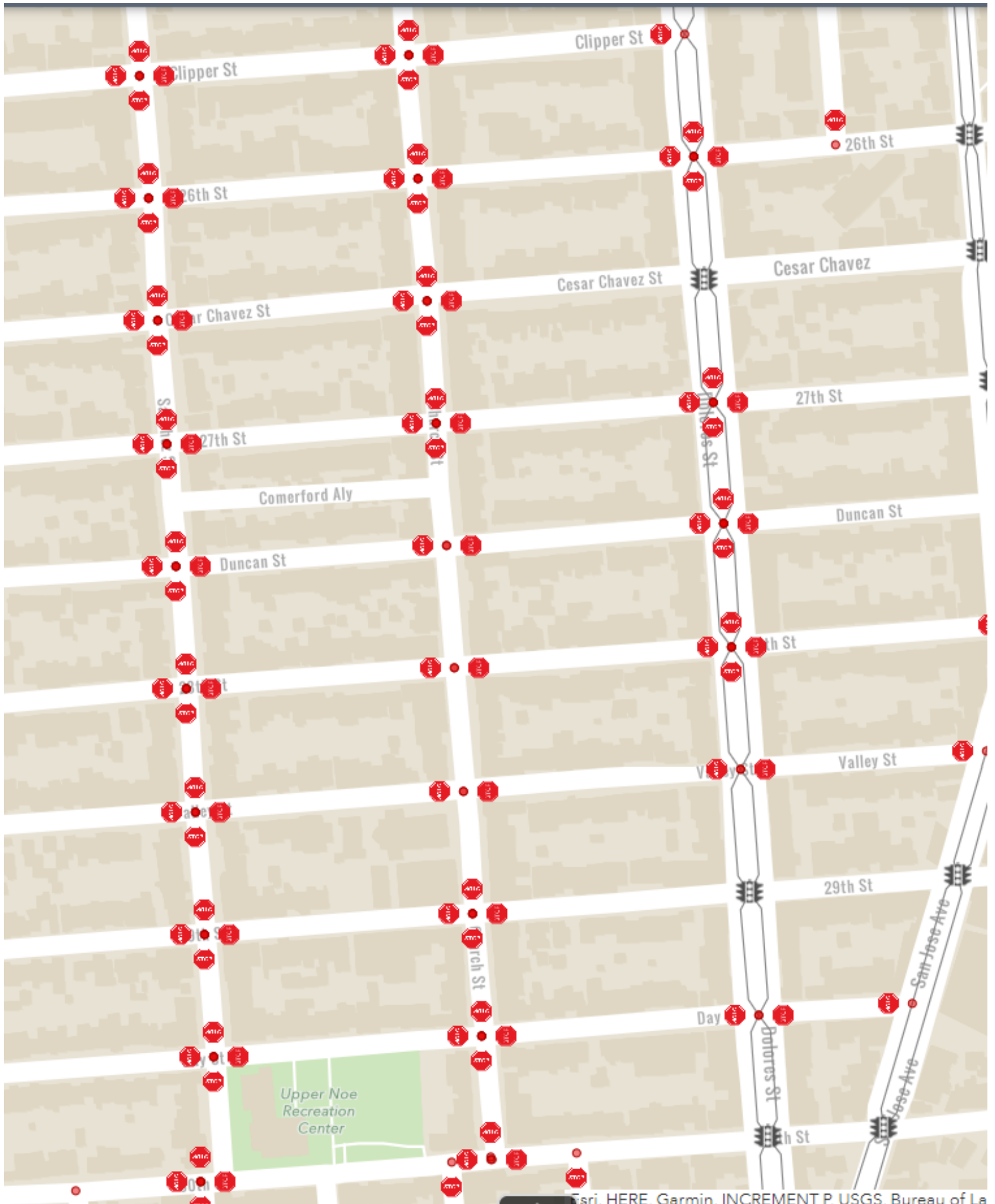



Church St, approaching 28th St – looking south



28th St, approaching Church St – looking east



28th St, approaching Church St – looking north



28th St, approaching Church St – looking south



28th St, approaching Church St - looking north (inching forward)



28th St, approaching Church St - looking south (inching forward)



Church St, approaching 28th St – looking north



28th St, approaching Church St – looking west



28th St, approaching Church St – looking south



28th St, approaching Church St – looking north



28th St, approaching Church St, looking south (inching forward)



28th St, approaching Church St, looking north (inching forward)