

SFMTA - TASC SUMMARY SHEET

PreStaff_Date: 10/17/23 Requested_by: SFMTA Handled: Jason Hyde <i>LS</i> Section Head : M. Sallaberry <i>MS</i>	<input type="checkbox"/> Public Hearing Consent <input checked="" type="checkbox"/> Public Hearing Regular <input type="checkbox"/> Informational / Other <small>PH - Regular</small>	No objections: _____ Item Held: _____ Other: _____
Location: Balboa Street at 6th Avenue		
Subject: On Street Bicycle Parking		
PROPOSAL / REQUEST: ESTABLISH—NO PARKING ANYTIME, EXCEPT BICYCLES Balboa Street, south side, from 92 feet to 113 feet west of 6th Avenue (removes General Metered Parking Space #511). (Supervisor District 1) This proposal would establish an on-street bicycle corral in an existing general metered parking space at 521 Balboa Street. Jason Hyde, Jason.Hyde@sfmta.com		
BACKGROUND INFORMATION / COMMENTS This proposal establishes a bike corral on the south side of Balboa Street replacing General Metered Parking Space #511 at the request of adjacent business.		
HEARING NOTIFICATION AND PROCESSING NOTES:	ENVIRONMENTAL CLEARANCE BY: <input checked="" type="checkbox"/> SFMTA <input type="checkbox"/> Attached <input type="checkbox"/> Pending	
CHECK IF PREPARING SEPARATE SFMTA BOARD CALENDAR ITEM FOR PROPOSAL: <input type="checkbox"/>		

TASC PACKET – Bike Corral

521 Balboa Street





Strawberry Hill Gallery
And Philosophy Club
Temporarily closed

Emperor Palace
Restaurant
\$10 Off First
Order Use Give10

Tekka Japanese
Japanese • \$\$

Yuubi Japanese
Restaurant
\$10 Off First
Order Use Give10

21 foot bike corral

Balboa St

Balboa St

boa Clean-X-Press

6th Ave

7th A

521 Balboa St, south side, 92 feet to 113 feet west of 6th Avenue

previous business (balboa preschool) closed and replaced by new business (scenic routes) who is requesting corral





5 RACKS
@ 3' 0.C.

8" SW

DELINEATOR

WHEEL STOP

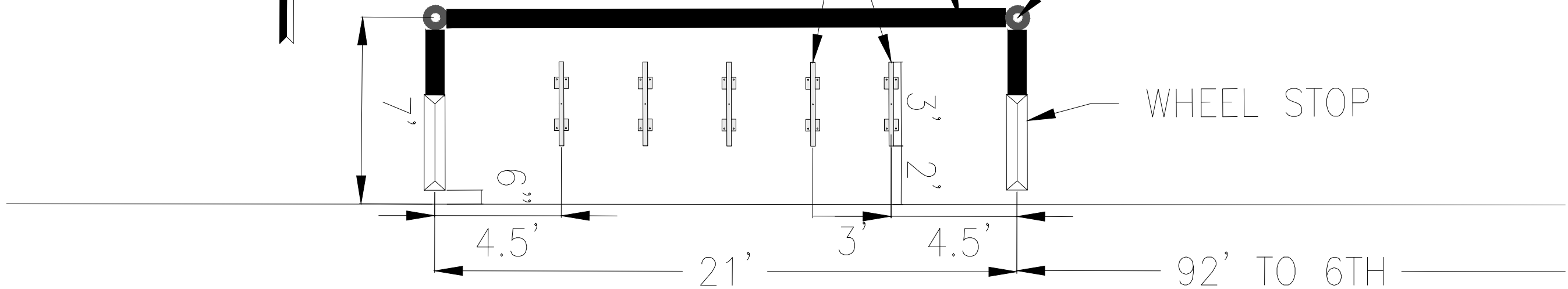

BALBOA ST
(MID BLOCK BETWEEN 7TH AND 6TH AVE)



SFMTA



		APPROVED		SCALE:		CONTRACT NO.
DRAWN:	DATE:	SENIOR ENGINEER	DATE:			DRAWING NO.
CHECKED:	DATE:	CITY TRAFFIC ENGINEER	DATE:	SHEET/SHEETS:		FILE NO.
						REV. NO.

T:\T E Files\livableStreets\Bicycle Programs\Bicycle Planning\Bicycle Parking Program\Corridor SE Locations\Legislation\2023 T&S Files\5212\Balboa St (Scenic Routes)\CAD\ Balboa St - 89.4 (Great Highway to Frishton Ave)\2020-04-08.dwg - Akeemo Wod

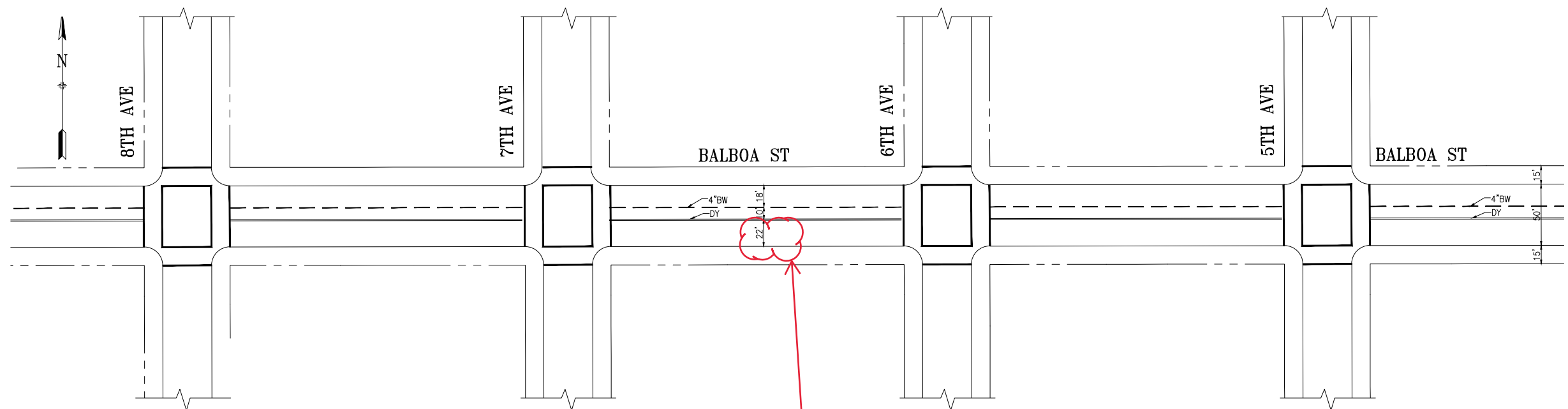

21 foot bike corral 113
 to 134 feet west of 6th
 ave

NO.	DATE	DESCRIPTION	BY	APP.
TABLE OF REVISIONS CHECK WITH TRACING TO SEE IF YOU HAVE LATEST REVISION				



SAN FRANCISCO MUNICIPAL TRANSPORTATION AGENCY
 CITY AND COUNTY OF SAN FRANCISCO

DRAWN:	DATE:	CHECKED:	DATE:
--------	-------	----------	-------

APPROVED	
SENIOR ENGINEER	DATE:
CITY TRAFFIC ENGINEER	DATE:

SCALE:	1" = 50'
SHEET OF SHEETS	

TRAFFIC STRIPING
BALBOA ST

CONTRACT NO.
DRAWING NO. DRAFT
FILE NO.
REV. NO.

EXTERNAL REFERENCES: XREFS
 FONTS USED: FONTS
 SCALE FACTOR: XX
 PLOT SCALE: 1=1
 ORIGIN: SECTION
 FILE NAME: --/--/--
 DATE: --/--

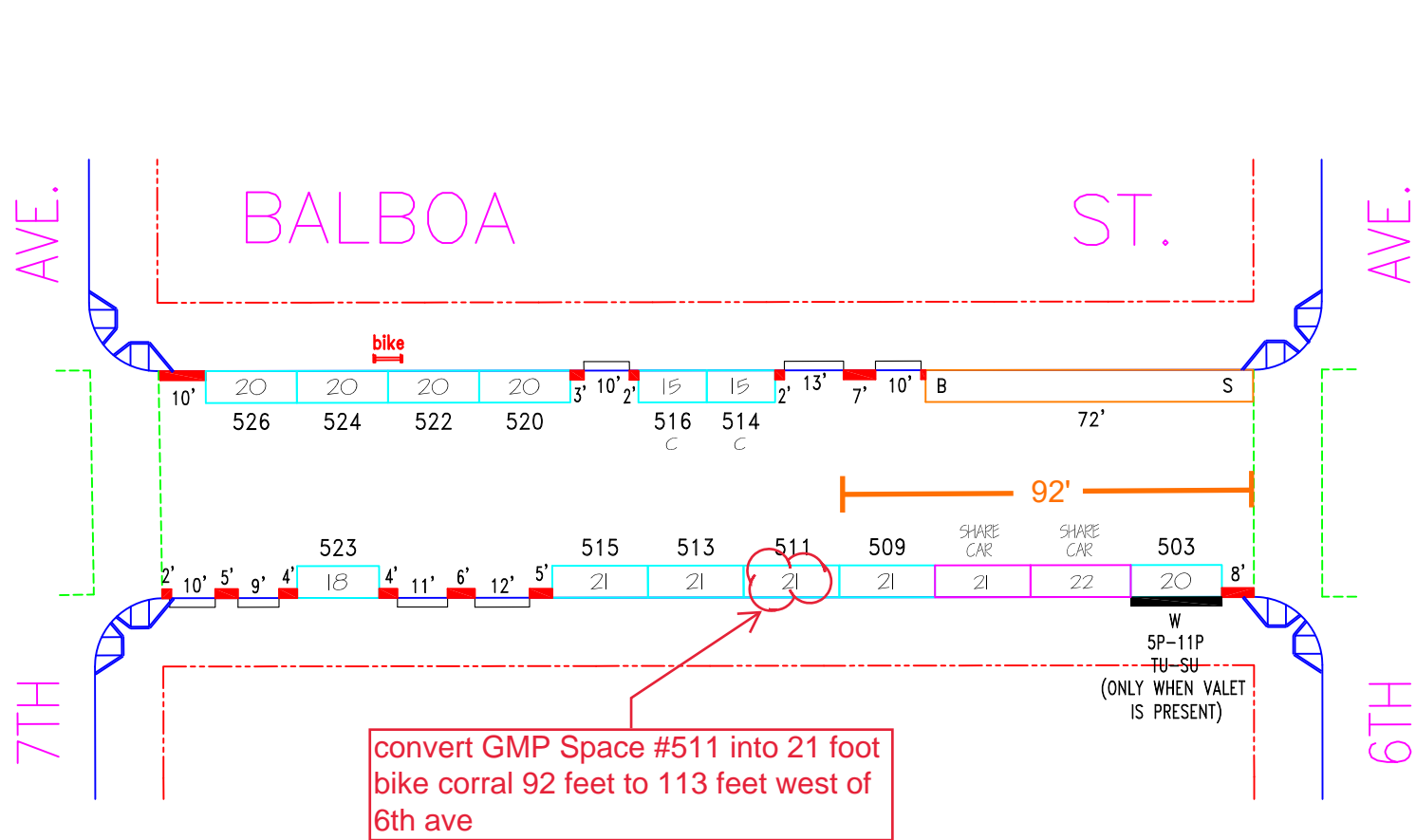

C - COMPACT CAR

NO.	REVISION DESCRIPTION	BY	DATE	DIR/RES	3	Est. PT-PLZ #503	DY	6/1/12	4055
1	Install (14) meters #503 thru #526	JB	2/17/10	10-002	4	MOS#505, #507 for Car Share-S/S	JB	9/30/14	14-129
2	Revoke PT-PLZ #503	DY	10-6-11	3971					



SAN FRANCISCO MUNICIPAL TRANSPORTATION AGENCY
CITY AND COUNTY OF SAN FRANCISCO
 PARKING METER SPACES

SIDE	TOW-AWAY		METER CT.		GENERAL				LOADING		METERED SPACES						TOTAL
	AM	PM	SS	MS	GMP	MC	TIMES	DAYS	ML	MTL	6-W	15 MIN	30 MIN	1 HR	2 HR	10 HR	
ODD			6		6		9A-6P	M-SA							6		6
EVEN			6		6		9A-6P	M-SA							6		6

BALBOA ST. (BAL, 321)
(500) BLOCK
 Meters # 321-05XXY
 6TH AVE. TO 7TH AVE.

SCALE: **1"=40'** DATE: **2/17/10** BY: **JB**

AREA 3

Date: 02/17/10 11:02 AM
 User: jbruce
 Path: C:\GIS\Projects\Balboa\Map_Series\Balboa_Series.aprx