

SFMTA - TASC SUMMARY SHEET

PreStaff_Date: 8/12/2021 Requested_by: SFMTA Handled: Victoria Chong <i>WL</i> Section Head : MS <i>MS</i>	<input type="checkbox"/> Public Hearing Consent <input checked="" type="checkbox"/> Public Hearing Regular <input type="checkbox"/> Informational / Other <small>PH - Consent</small>	No objections: _____ Item Held: _____ Other: _____
---	---	---

Location: Valencia Street between 16th Street and 25th Street

Subject: Red Zones and Bike Corrals

PROPOSAL / REQUEST:

ESTABLISH - RED ZONE

- Valencia Street, west side, from 20th Street to 21 feet northerly (removes one yellow metered space)
- Valencia Street, east side, from 20th Street to 20 feet southerly (removes one yellow metered space)
- Valencia Street, west side, from 3 feet to 23 feet north of 22nd Street (removes one green metered space)
- 17th Street, north side, from 12 feet to 20 feet easterly (extends existing zone 8 feet)
- 18th Street, south side, from 10 feet to 20 feet west of Valencia Street (extends existing zone 10 feet)
- 22nd Street, south side, from 6 feet to 24 feet west of Valencia Street (removes one green metered space)
- 23rd Street, south side, from Valencia Street to 20 feet westerly (relocates existing yellow zone)
- 25th Street, north side, from 7 feet to 10 feet east of Valencia Street (extends existing zone 3 feet)

ESTABLISH - NO PARKING ANYTIME EXCEPT BICYCLES (BIKE CORRAL)

- Valencia Street, west side, from 10 feet to 30 feet north of 19th Street (removes one general metered space)
- Valencia Street, east side, from 10 feet to 24 feet south of 21st Street
- 25th Street, north side, from 10 feet to 29 feet east of Valencia Street (removes one general metered space)

ESTABLISH – COMMERCIAL LOADING ZONE 8AM TO 6PM, MONDAY THROUGH FRIDAY

- 23rd Street, south side, from 20 feet to 40 feet west of Valencia Street

BACKGROUND INFORMATION / COMMENTS

The proposal includes installing daylighting at intersection approaches on Valencia Street and cross streets in order to improve intersection visibility and safety. Valencia Street is on the city's high-injury network. Additional bike corrals are also being proposed as part of this effort.

No Muni impacts.

HEARING NOTIFICATION AND PROCESSING NOTES:

ENVIRONMENTAL CLEARANCE BY:

- SFMTA
 Attached
 Pending

ESTABLISH - RED ZONE

Valencia Street, west side, from 20th Street to 21 feet northerly (removes one yellow metered space)

Valencia Street, east side, from 20th Street to 20 feet southerly (removes one yellow metered space)

Valencia Street, west side, from 3 feet to 23 feet north of 22nd Street (removes one green metered space)

17th Street, north side, from 12 feet to 20 feet easterly (extends existing zone 8 feet)

18th Street, south side, from 10 feet to 20 feet west of Valencia Street (extends existing zone 10 feet)

22nd Street, south side, from 6 feet to 24 feet west of Valencia Street (removes one green metered space)

23rd Street, south side, from Valencia Street to 20 feet westerly (relocates existing yellow zone)

25th Street, north side, from 7 feet to 10 feet east of Valencia Street (extends existing zone 3 feet)

ESTABLISH - NO PARKING ANYTIME EXCEPT BICYCLES (BIKE CORRAL)

Valencia Street, west side, from 10 feet to 30 feet north of 19th Street (removes one general metered space)

Valencia Street, east side, from 10 feet to 24 feet south of 21st Street

25th Street, north side, from 10 feet to 29 feet east of Valencia Street (removes one general metered space)

ESTABLISH – COMMERCIAL LOADING ZONE 8AM TO 6PM, MONDAY THROUGH FRIDAY

23rd Street, south side, from 20 feet to 40 feet west of Valencia Street

ESTABLISH – GREEN METERS, 30-MINUTE PARKING LIMIT, 9AM TO 6PM, MONDAY THROUGH SATURDAY

Valencia Street, west side, from 43 feet to 63 feet north of 22nd Street (removes one general metered space)

RESCIND – GENERAL METERED PARKING

Valencia Street, west side, from 10 feet to 30 feet north of 19th Street (removes parking meter #770)

25th Street, north side, from 7 feet to 30 feet east of Valencia Street (removes parking meter #3449)

RESCIND – COMMERCIAL METERED LOADING ZONE 8AM TO 6PM, MONDAY THROUGH SATURDAY

Valencia Street, west side, from 20th Street to 21 feet northerly (removes parking meter #858)
17th Street, north side, from 12 feet to 20 feet easterly

RESCIND – COMMERCIAL METERED LOADING ZONE 7AM TO 6PM, MONDAY THROUGH FRIDAY

Valencia Street, east side, from 20th Street to 20 feet southerly (removes parking meter #901)

RESCIND – COMMERCIAL LOADING ZONE 8AM TO 6PM, MONDAY THROUGH FRIDAY
23rd Street, south side, from Valencia Street to 20 feet westerly

RESCIND – GREEN METERED PARKING

Valencia Street, west side, from 3 feet to 23 feet north of 22nd Street (removes parking meter 1058-G)

22nd Street, south side, from 6 feet to 24 feet west of Valencia Street (removes parking meter 3301-G)

RESCIND – YELLOW ZONE, COMMERCIAL LOADING, 30-MINUTE TIME LIMIT, 8AM TO 11PM, DAILY
18th Street, south side, from 10 feet to 20 feet west of Valencia Street

(Supervisor Districts 8 and 9)

The proposal includes installing daylighting at intersection approaches on Valencia Street and cross streets in order to improve intersection visibility and safety. Valencia Street is on the city's high-injury network. Additional bike corrals are also being proposed as part of this effort

Victoria Chong, victoria.chong@sfmta.com

Valencia Street daylighting boundaries

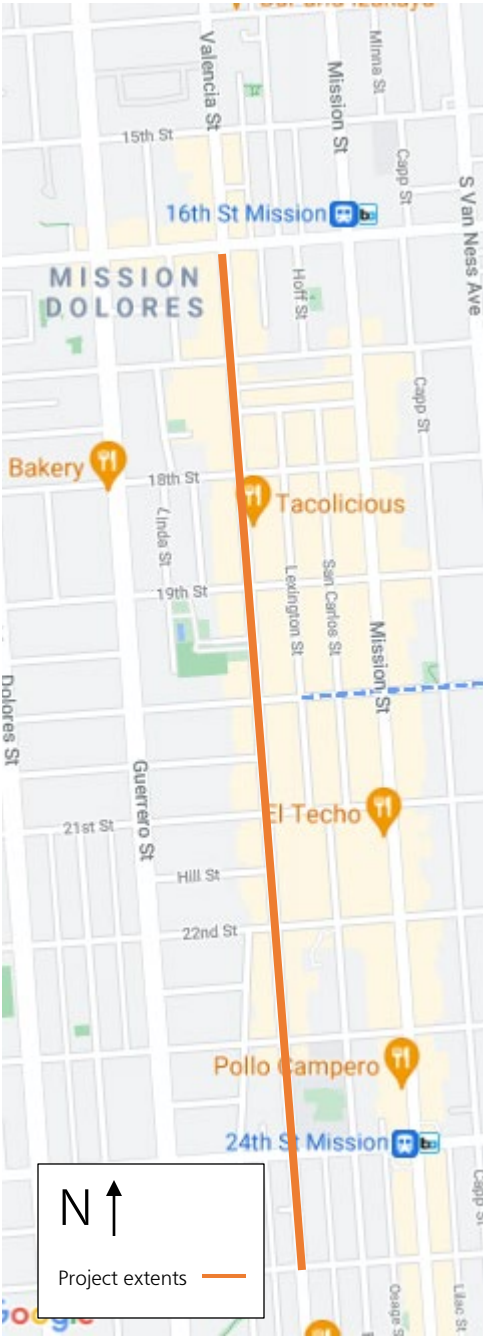

Nearby Muni Routes



Bike network



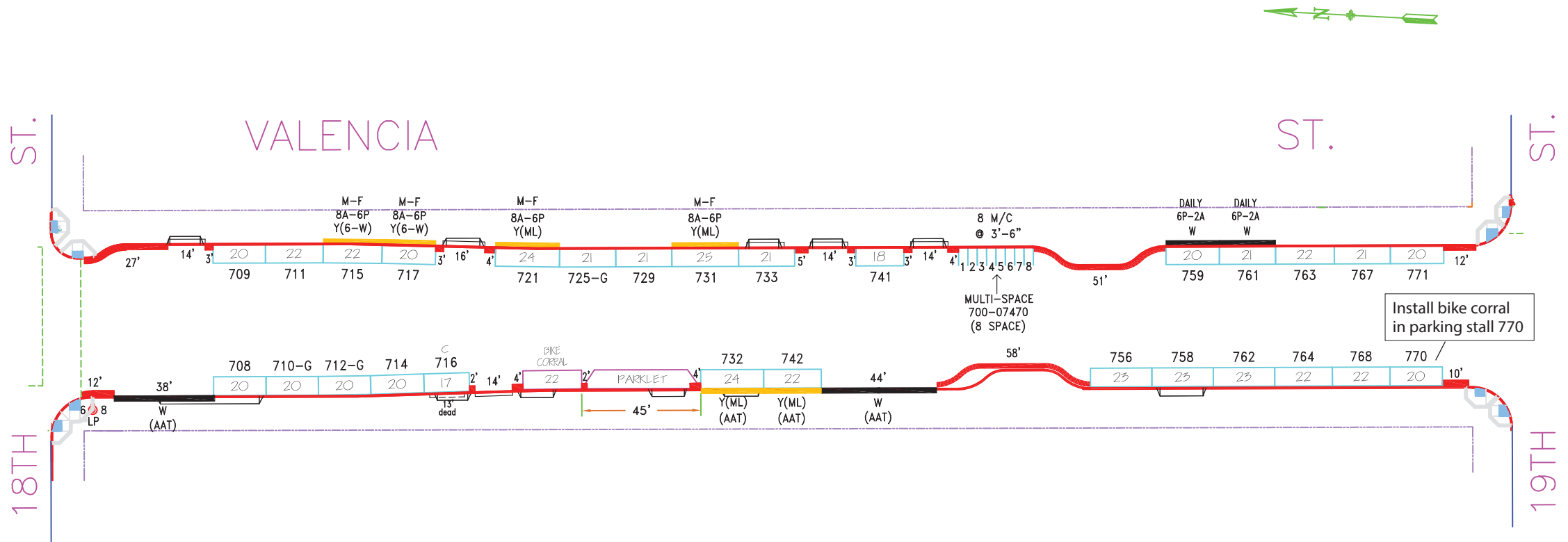

C - COMPACT CAR



NO.	REVISION DESCRIPTION	BY	DATE	DIR/RES	10	11	12
					Re-install #758 on raised curb-W/S	JB	1/19/19
8	Parklet-MOS#728,30,revk.PLZ#730,32	JB	7/22/15	5351	Est.PLZ,MOS#744,48,Est.ML#732,42-W/S	JB	7/17/19 6094
9	Revoke PT-PLZ for Valet-#704,W/S	JB	4/15/16	5554	Est.PLZ,MOS#704,6,Est.ML-AAT#732,42	JB	10/14/19 6132



SAN FRANCISCO MUNICIPAL TRANSPORTATION AGENCY
CITY AND COUNTY OF SAN FRANCISCO
 PARKING METER SPACES

SIDE	TOW-AWAY		METER CT.		GENERAL			LOADING			METERED SPACES							
	AM	PM	SS	MS	GMP	MC	TIMES	DAYS	ML	MTL	6-W	15 MIN	30 MIN	1 HR	2 HR	10 HR	4 HR	TOTAL
ODD			15	1	11	8	9A-6P	M-SA	2		2		5			8	10	23
EVEN			13		11		9A-6P	M-SA	2				4				9	13

VALENCIA ST. (VAL, 700)
(700) BLOCK
 Meters #700-07XXY
18TH ST. TO 19TH ST.

SCALE: **1" = 50'** DATE: **9/09/09** BY: **JB**

AREA
3

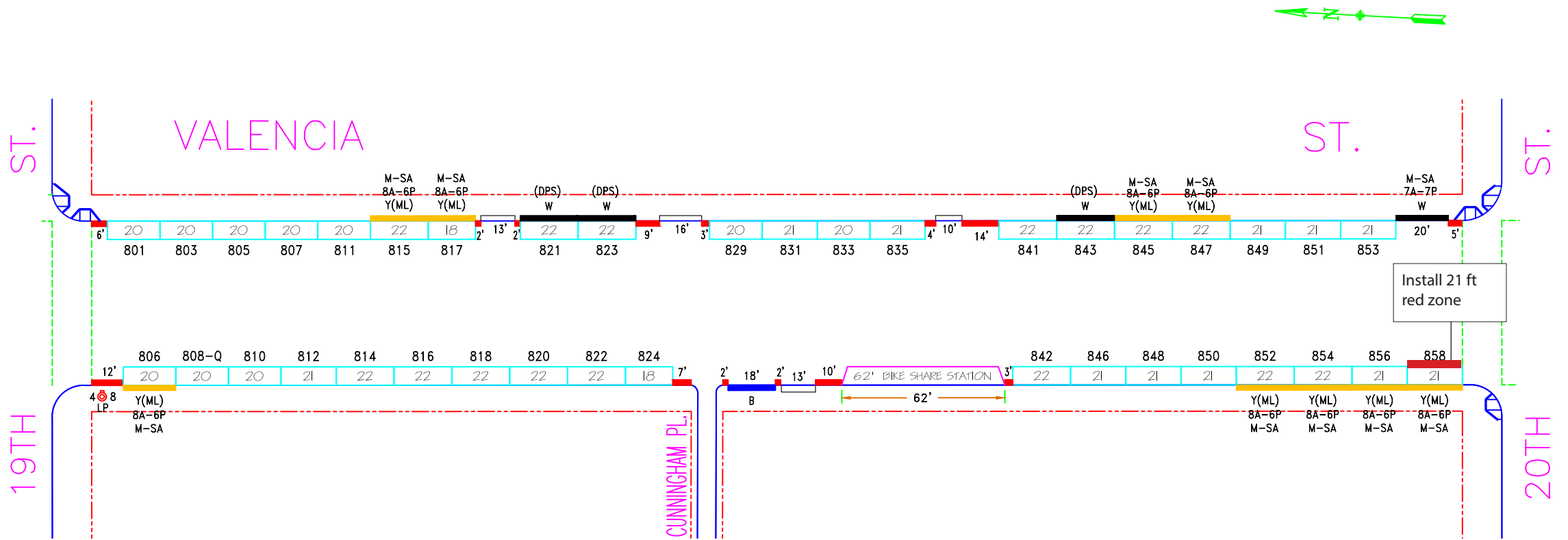

C - COMPACT CAR

NO.	REVISION DESCRIPTION	BY	DATE	DIR/RES													
6	Establish Blue zone, MOS#830-W/S	JB	1/9/16	16-151													
7	Est. Bike Station, MOS#836,38,40-W/S	JB	8/8/17	5687													



SAN FRANCISCO MUNICIPAL TRANSPORTATION AGENCY
 CITY AND COUNTY OF SAN FRANCISCO
 PARKING METER SPACES

SIDE	TOW-AWAY		METER CT.		GENERAL			LOADING			METERED SPACES						TOTAL
	AM	PM	SS	MS	GMP	MC	TIMES	DAYS	ML	MTL	6-W	15 MIN	30 MIN	1 HR	2 HR	10 HR	
ODD			20		16		9A-6P	M-SA	4				4		16		20
EVEN			18		13		9A-6P	M-SA	5			1	5		12		18

VALENCIA ST. (VAL, 700)
(800) BLOCK
 Meters #700-08XXY
19TH ST. TO 20TH ST.

SCALE: **1" = 50'** DATE: **3/24/10** BY: **JB**

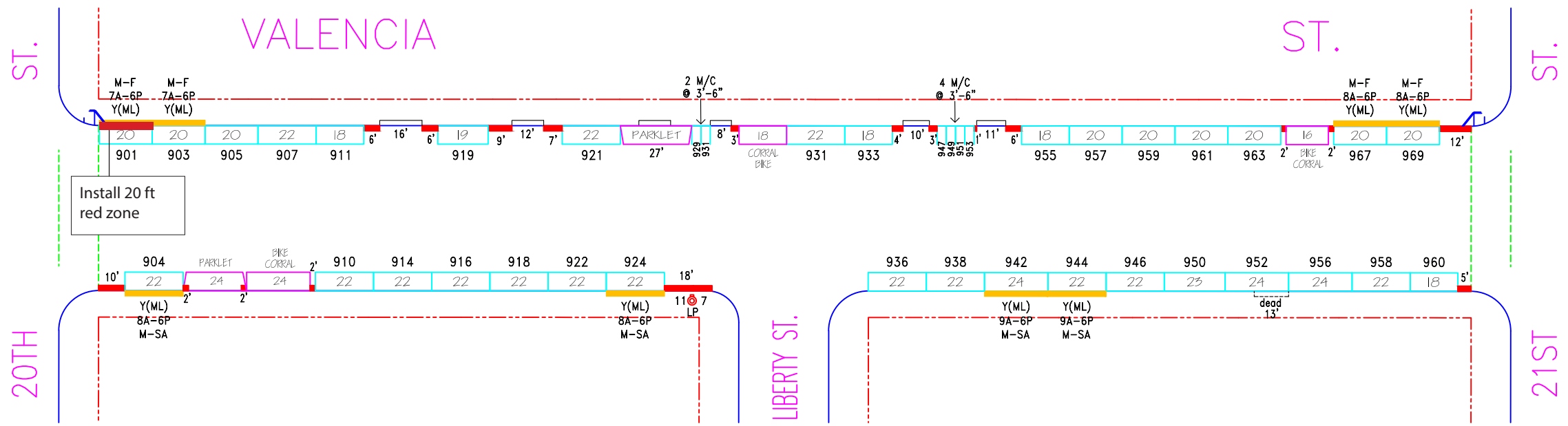
AREA
3



NO.	REVISION DESCRIPTION	BY	DATE	DIR/RES													
6	MOS#906, Install. #910 (Reloc. Parklet) W/S	JB	4/5/17														
7	PerField: Renumber #929 thru #969 - E/S	JB	10/9/17														



SAN FRANCISCO MUNICIPAL TRANSPORTATION AGENCY
CITY AND COUNTY OF SAN FRANCISCO
 PARKING METER SPACES

SIDE	TOW-AWAY		METER CT.		GENERAL				LOADING		METERED SPACES							TOTAL
	AM	PM	SS	MS	GMP	MC	TIMES	DAYS	ML	MTL	6-W	15 MIN	30 MIN	1 HR	2 HR	10 HR		
ODD			22		12	6	9A-6P	M-SA	4				4		12	6	22	
EVEN			17		13		9A-6P	M-SA	4				4		13		17	

VALENCIA ST. (VAL, 700)
(900) BLOCK
 Meters #700-09XXY
20TH ST. TO 21ST ST.

SCALE: **1" = 50'** DATE: **6/21/10** BY: **JB**

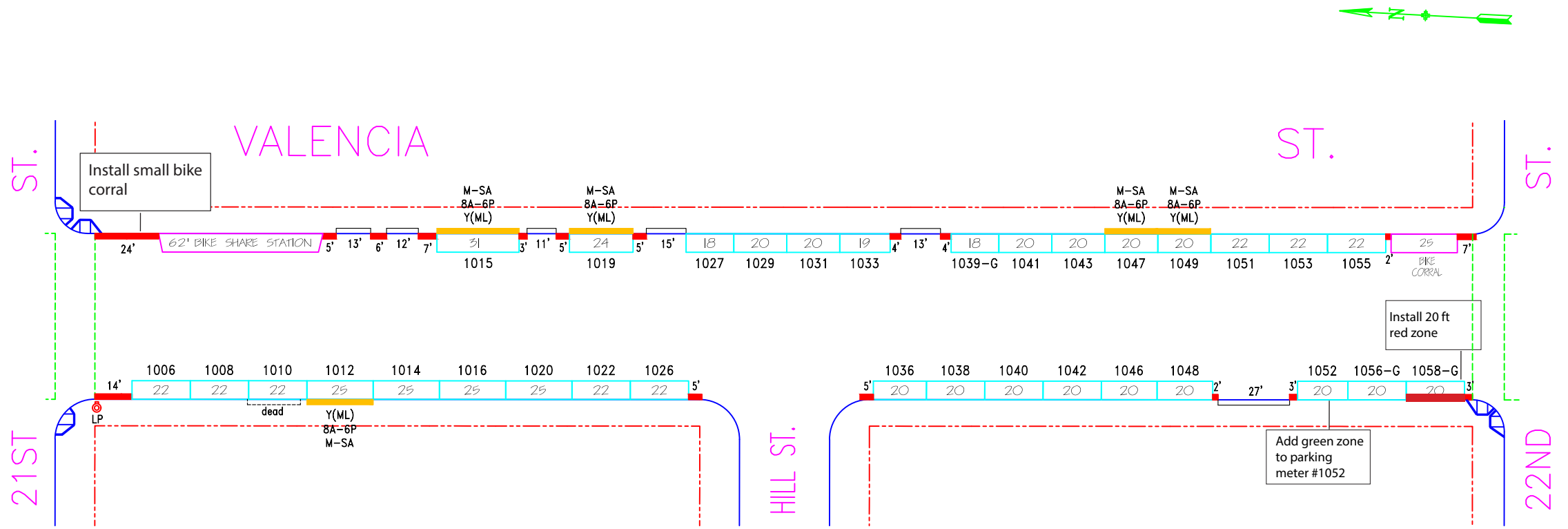
AREA
3



NO.	REVISION DESCRIPTION	BY	DATE	DIR/RES													
1	Install#1006,1008,1010,1055-BS del.	JB	3/30/10														
2	Est. Bike Station,MOS#1001-09, E/S	JB	8/7/17	5781													



SAN FRANCISCO MUNICIPAL TRANSPORTATION AGENCY
CITY AND COUNTY OF SAN FRANCISCO
 PARKING METER SPACES

SIDE	TOW-AWAY		METER CT.		GENERAL				LOADING			METERED SPACES						TOTAL
	AM	PM	SS	MS	GMP	MC	TIMES	DAYS	ML	MTL	6-W	15 MIN	30 MIN	1 HR	2 HR	10 HR		
ODD			14		10		9A-6P	M-SA	4				5		9		14	
EVEN			18		17		9A-6P	M-SA	1				3		15		18	

VALENCIA ST. (VAL, 700)
(1000) BLOCK
 Meters #700-10XXY

21ST ST. TO 22ND ST.

SCALE: 1"=50' DATE: 6/21/10 BY: JB

AREA 3

Proposed daylighting 18th Street, south side, from 10 feet to 20 feet west of Valencia Street (extends existing zone 10 feet)

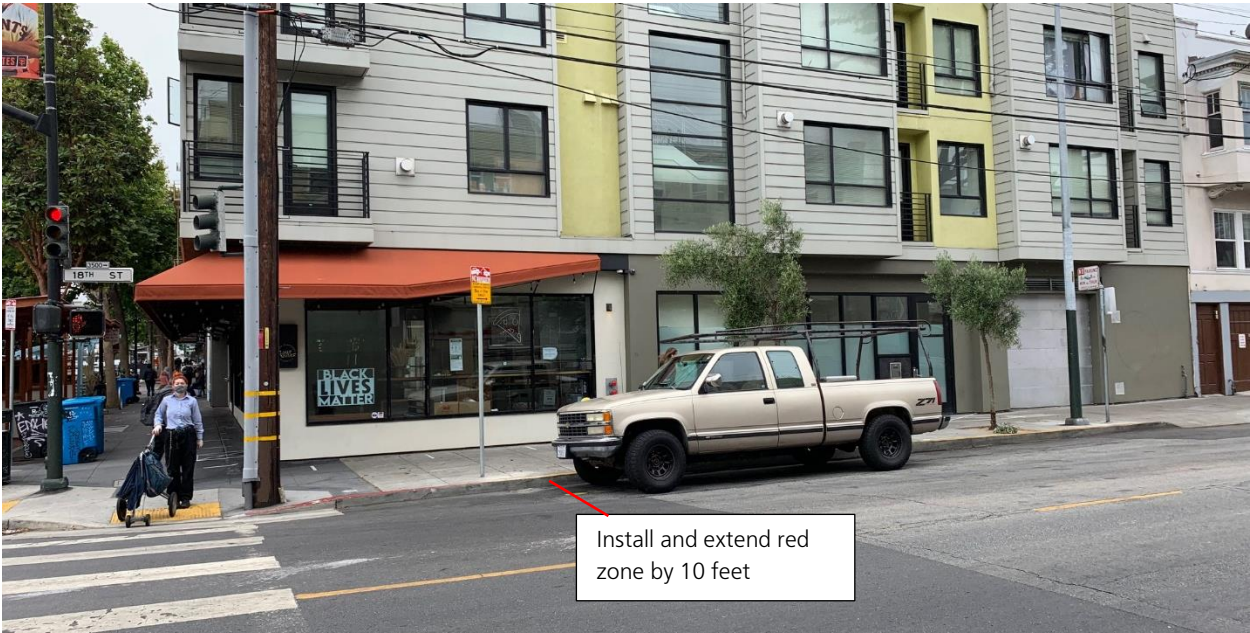

Install and extend red zone by 10 feet

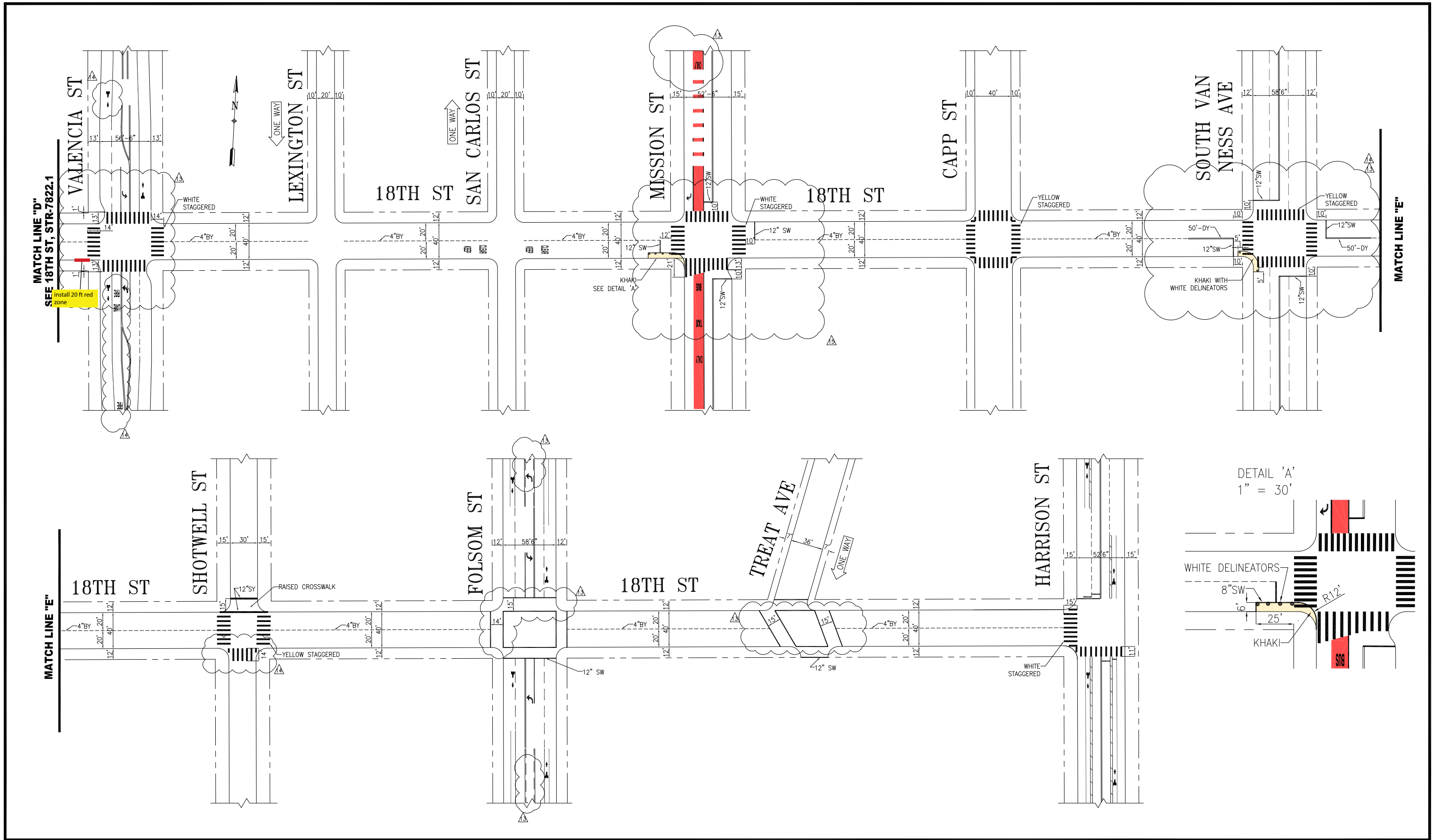

NO.	DATE	DESCRIPTION	BY	APP
TABLE OF REVISIONS CHECK WITH TRACING TO SEE IF YOU HAVE LATEST REVISION				



SUPERSEDES STR-4757 REV22		APPROVED THOMAS P FOLKS 03/08/10		SCALE: 1" = 50'
DRAWN: T. ABDALLAH	DATE: 02/2010	SENIOR ENGINEER	DATE:	SHEET/SHEETS:
CHECKED: M. VELASCO	DATE: 02/2010	JACK L. FLECK 03/11/10	CITY TRAFFIC ENGINEER	

TRAFFIC STRIPING
18TH STREET
VALENCIA STREET TO HARRISON STREET

CONTRACT NO.
DRAWING NO. STR-7822.2
FILE NO.
REV. NO. 15

FILE NAME:
DATE: --/--/---

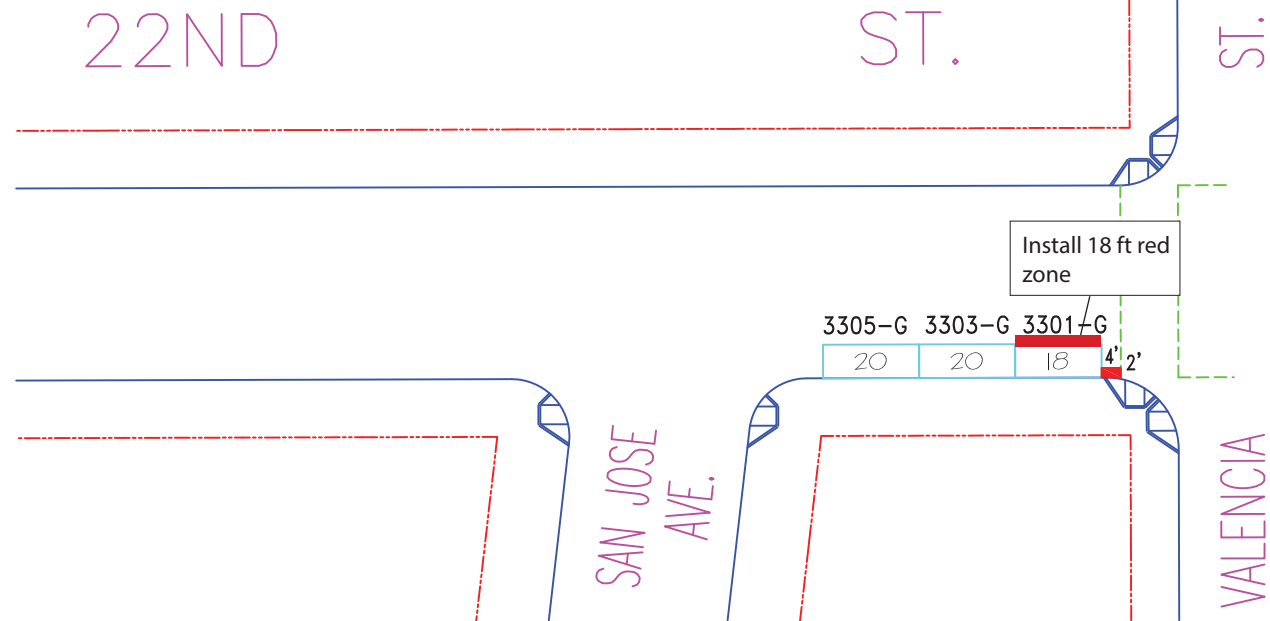

NO.	REVISION DESCRIPTION	BY	DATE	DIR/RES													
1	Establish Green #3301,3303,3305	JB	3/29/13	12-141													



SAN FRANCISCO MUNICIPAL TRANSPORTATION AGENCY
 CITY AND COUNTY OF SAN FRANCISCO
 PARKING METER SPACES

SIDE	TOW-AWAY		METER CT.		GENERAL				LOADING			METERED SPACES						TOTAL
	AM	PM	SS	MS	GMP	MC	TIMES	DAYS	ML	MTL	6-W	15 MIN	30 MIN	1 HR	2 HR	10 HR		
ODD			3		3		9A-6P	M-SA					3					3
EVEN																		

22ND ST. (22S, 222)
(3300) BLOCK
 Meters #222-33XXY
OFF VALENCIA ST.

SCALE: 1"=40' DATE: 3/29/13 BY: JB

AREA
3

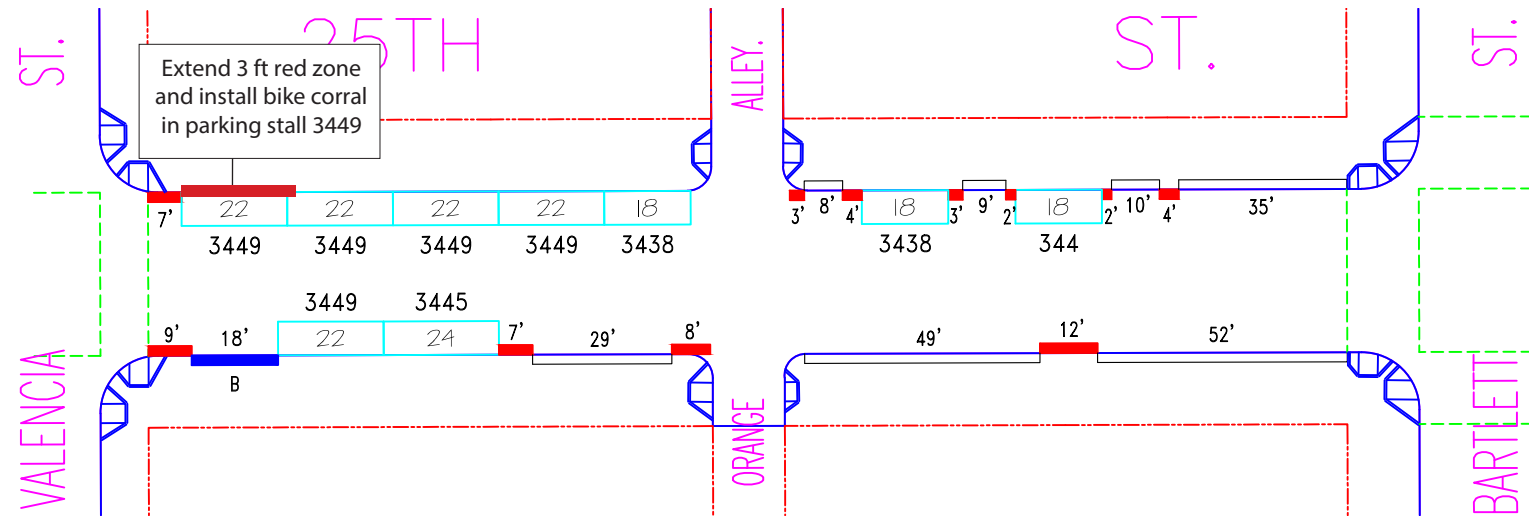
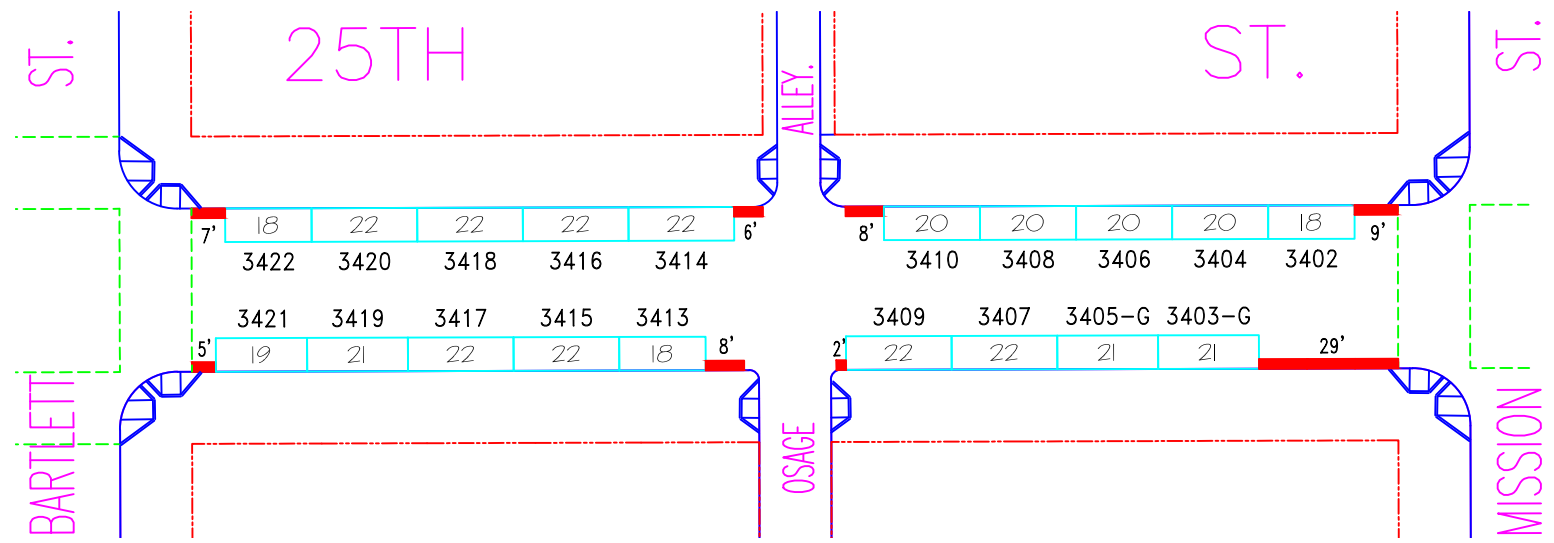

NO.	REVISION DESCRIPTION	BY	DATE	DIR/RES
2	Est. TANS,MOS#3401-G,(#3405 to G)	JB	7/6/15	15-085
3	Establish Blue zone, MOS#3451-S/S	JB	11/2/17	71003.122



SAN FRANCISCO MUNICIPAL TRANSPORTATION AGENCY
CITY AND COUNTY OF SAN FRANCISCO
 PARKING METER SPACES

SIDE	TOW-AWAY		METER CT.		GENERAL			LOADING		METERED SPACES							TOTAL
	AM	PM	SS	MS	GMP	MC	TIMES	DAYS	ML	MTL	6-W	15 MIN	30 MIN	1 HR	2 HR	10 HR	
ODD			11		11		9A-6P	M-SA				2			9		11
EVEN			17		17		9A-6P	M-SA							17		17

25TH ST. (25S, 225)
(3400) BLOCK
 Meters #225-34XXY

MISSION ST. TO VALENCIA ST.

SCALE: **1"=40'** DATE: **7/6/15** BY: **JB**

AREA 3