

# PUBLIC HEARING

## FOR PROPOSED PARKING & TRAFFIC CHANGES

Pursuant to SFMTA Order No. 5234 adopted February 26, 2014 the San Francisco Municipal Transportation Agency will hold a public hearing to solicit public input on the following proposed changes. The hearing will be held as follows:

**Date/Time:** Friday, March 14, 2014 at 10:00 am  
**Location:** Room 416 (Hearing Room 4), City Hall, San Francisco  
(located on Van Ness Avenue between McAllister and Grove Streets)

SFMTA is holding a public hearing to consider improvements intended to improve transit performance and pedestrian safety. These proposals would be constructed in 2015 in conjunction with the upcoming repaving of Irving Street. SFMTA proposes to:

- Relocate the existing transit stops at 9<sup>th</sup> Avenue and Irving Street to be on the opposite side of the intersection
- Consolidate the existing stops at 4<sup>th</sup> and 7<sup>th</sup> Avenues to a new combined stop between 5<sup>th</sup> and 6<sup>th</sup> Avenue
- Widen the sidewalk at the new transit stops to provide direct boarding of the first-car of N Judah trains and to create additional space for transit shelters, landscaping, seating, bicycle racks and other amenities.
- Install a traffic signal at 4<sup>th</sup> Avenue, and make adjustments to parking to accommodate these proposals.

These proposals would reduce travel times and improve reliability for the N Judah's 40,000+ daily customers, saving about 1.5 minutes in each direction while resulting in a net reduction of 14 parking spaces.

For more information please visit the project website at [www.sfmta.com/irving](http://www.sfmta.com/irving) or contact Dustin White at 415-701-4603 or [dustin.white@sfmta.com](mailto:dustin.white@sfmta.com).



### **RESCIND – FLAG STOP**

Irving Street, north side, east of 4<sup>th</sup> Avenue  
Irving Street, south side, west of 4<sup>th</sup> Avenue  
Irving Street, north side, east of 7<sup>th</sup> Avenue  
Irving Street, south side, west of 7<sup>th</sup> Avenue  
Irving Street, north side, east of 9<sup>th</sup> Avenue  
9<sup>th</sup> Avenue, east side, south of Irving Street

### **ESTABLISH – SIDEWALK WIDENING AND TOW-AWAY NO STOPPING ANYTIME**

Arguello Boulevard, west side, from 20 feet to 27 feet north of Irving Street (5-foot sidewalk

widening, removes one 90-degree parking space)  
Irving Street, north side, from 3<sup>rd</sup> Avenue to 20 feet easterly (6-foot pedestrian bulb, no parking impacts)  
Irving Street, north side, from 4<sup>th</sup> Avenue to 20 feet westerly (6-foot pedestrian bulb, no parking impacts)  
Irving Street, north side, from 7<sup>th</sup> Avenue to 20 feet westerly (6-foot pedestrian bulb, reduces the length of two metered parking spaces by 2 feet each)

### **ESTABLISH – SIDEWALK WIDENING AND TOW-AWAY NO STOPPING ANYTIME**

Irving Street, north side, from 6<sup>th</sup> Avenue to 96 feet easterly (14.5-foot transit bulb, removes three parking spaces)  
Irving Street, south side, from 5<sup>th</sup> Avenue to 96 feet westerly (14.5-foot transit bulb, removes three parking spaces)  
Irving Street, south side, from 8<sup>th</sup> Avenue to 104 feet westerly (17.5-foot transit bulb, removes two general metered parking spaces at meters #703 and #705, removes two 30-minute metered green parking spaces at meters #707-G and #709-G)  
9<sup>th</sup> Avenue, west side, from 100 feet to 230 feet south of Irving Street (12.5-foot transit bulb, removes three general metered parking spaces at meters #1315, #1317 and #1325, removes one yellow metered loading zone at meter #1313)

### **ESTABLISH – SIDEWALK WIDENING**

Irving Street, north side, from 96 feet east of 6<sup>th</sup> Avenue to 5<sup>th</sup> Avenue (6-foot sidewalk widening, no parking impacts)  
Irving Street, south side, from 96 feet west of 5<sup>th</sup> Avenue to 6<sup>th</sup> Avenue (6-foot sidewalk widening, no parking impacts)

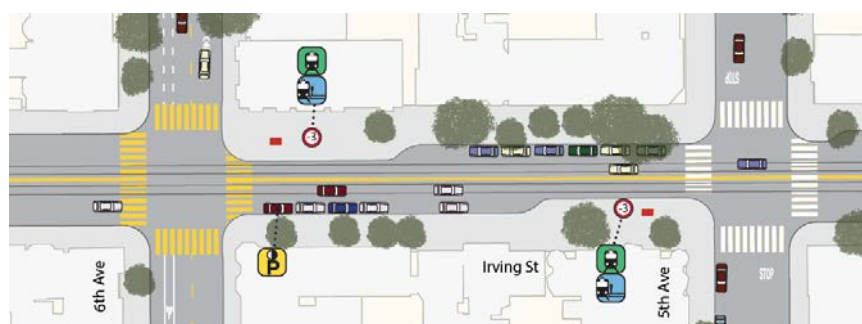

### **ESTABLISH – FLAG STOP**

Irving Street, north side, east of 6<sup>th</sup> Avenue (at new transit bulb)  
Irving Street, south side, west of 5<sup>th</sup> Avenue (at new transit bulb)  
Irving Street, south side, west of 8<sup>th</sup> Avenue (at new transit bulb)  
9<sup>th</sup> Avenue, west side, south of Irving Street (at new transit bulb)

### **ESTABLISH – TRAFFIC SIGNAL**

4<sup>th</sup> Avenue at Irving Street (replaces all-way STOP)

### **ESTABLISH – NO PARKING ANYTIME EXCEPT BICYCLES**

Irving Street, south side, from 2 feet to 26 feet east of 9<sup>th</sup> Avenue (24-foot zone, removes one general metered parking space at meter #723)  
9<sup>th</sup> Avenue, east side, from 2 feet to 33 feet south of Irving Street (31-foot zone, no parking impacts)

### **ESTABLISH – YELLOW METERED LOADING ZONE, 8AM TO 6PM, MONDAY THROUGH SATURDAY**

9<sup>th</sup> Avenue, west side, from 75 feet to 100 feet south of Irving Street (25-foot metered yellow loading zone, extends one metered yellow loading zone at meter #1311)

### **ESTABLISH – GENERAL METERED PARKING**

9<sup>th</sup> Avenue, east side, from 33 feet to 73 feet south of Irving Street (adds two parking spaces)  
Irving Street, south side, from 26 feet to 92 feet east of 9<sup>th</sup> Avenue (modifies dimensions of general metered parking spaces at meters #717, #719 and #721)

### **ESTABLISH – 30-MINUTE METERED GREEN ZONE, 9AM TO 6PM, MONDAY THROUGH SATURDAY**

8<sup>th</sup> Avenue, west side, from Irving Street to 21 feet southerly (converts one general metered parking space at meter #1301)  
Irving Street, south side, from 92 feet to 114 feet east of 9<sup>th</sup> Avenue (converts one general metered parking space at meter #715)

### **ESTABLISH – PART-TIME PASSENGER LOADING ZONE, 3 PM TO 7 PM, MONDAY THROUGH THURSDAY, 9 AM TO 12 PM SATURDAY**

Irving Street, south side, from 6<sup>th</sup> Avenue to 20 feet easterly