



Frida Kahlo Way Quick-Build Project

February 2024

FOR MORE INFORMATION

 visit: [SFMTA.com/FridaQB](https://www.sfmta.com/FridaQB)

CONTACT US

 email: FridaQB@SFMTA.com

Conceptual Design Package

This document summarizes the conceptual design proposed by SFMTA staff for which comments will be heard at the February 16th, 2024 meeting. The document contains the following exhibits:

Exhibit 1: Overview map showing the key project elements.

Exhibit 2: Illustrated plan view of the proposed design, with graphics providing further detail for key project elements. Zoom in on the document to view in greater detail.

Exhibit 3: Detailed striping drawings showing both existing and proposed conditions.

Exhibit 4: Summary of curb management changes detailing exact changes to vehicle parking supply and other curb uses.



Frida Kahlo Way Quick-Build Project

Project Overview Map

DRAFT February 2024



Legend:

- Two-way protected bikeway (see reverse for cross-section)
- Key bike connection
- 43 Masonic route
- Existing bike route
- 43 Masonic stop: no change
- 43 Masonic stop: relocate
- 43 Masonic stop: remove

Illustrated Plan

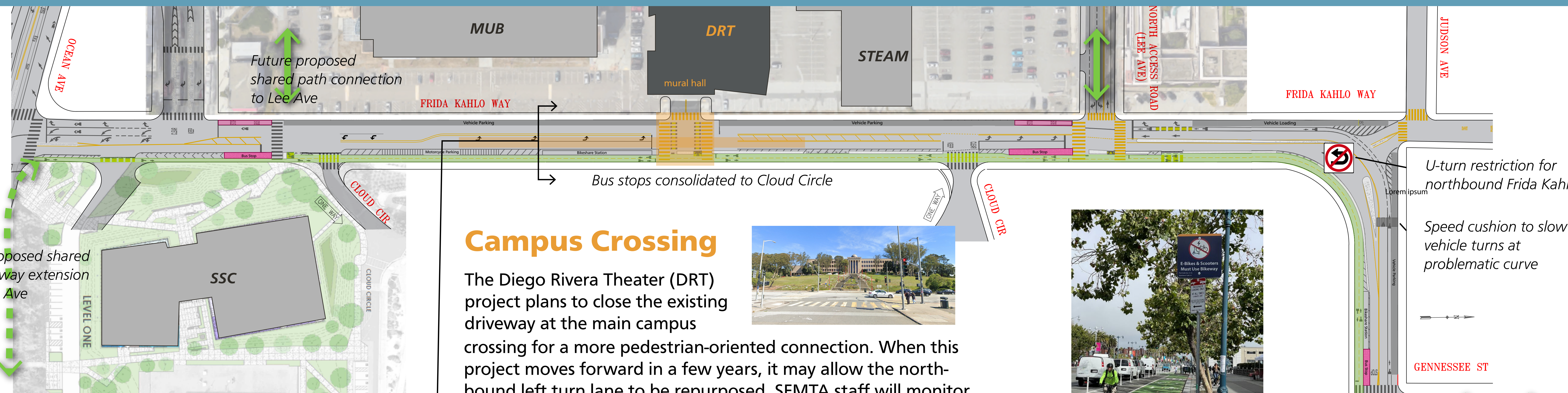

Transit Stops

The project proposes bus boarding islands for the inbound 43 Masonic stops at Cloud Circle (South), Cloud Circle (North) at Lee Ave, and Genessee Street. The project would also consolidate (remove) the existing bus stops at campus crossing, which has substantially lower ridership than the adjacent stops.



Example of a bus boarding island with protected bikeway in the SOMA neighborhood. Boarding islands allow for level, in-lane dropoffs and pickups and shorter crossing distances.

Campus Crossing

The Diego Rivera Theater (DRT) project plans to close the existing driveway at the main campus crossing for a more pedestrian-oriented connection. When this project moves forward in a few years, it may allow the northbound left turn lane to be repurposed. SFMTA staff will monitor opportunities to revisit on-street parking and loading configurations along Frida Kahlo Way.

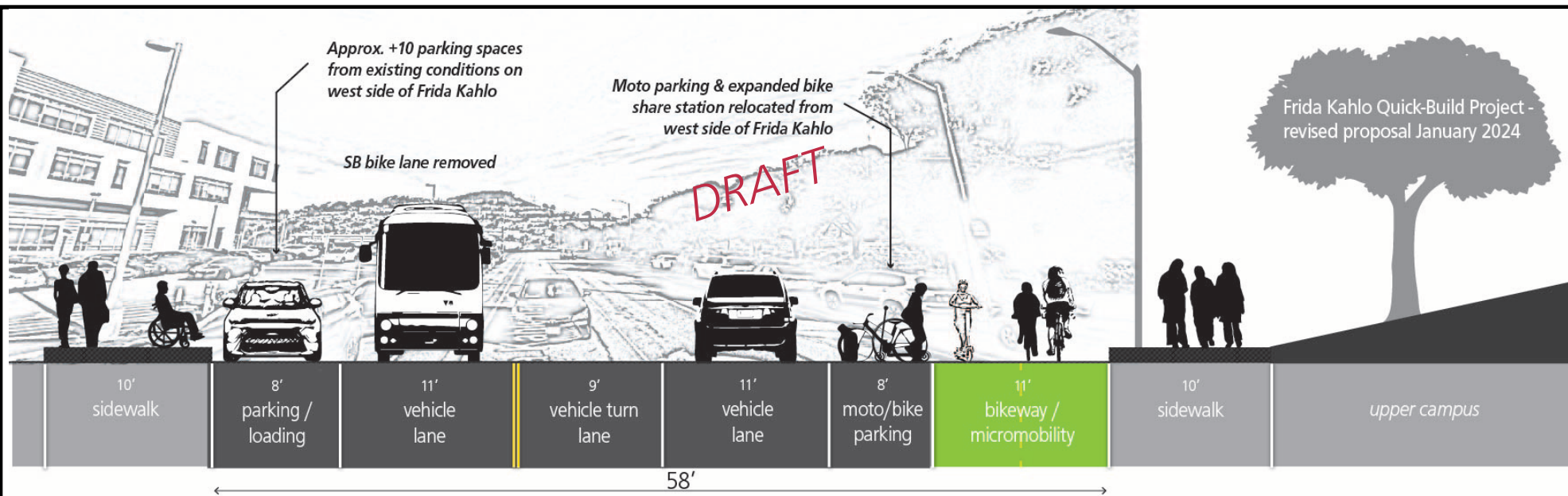

Cross-section looking north between Cloud Cir. (South) and main steps.



Example of a parking-protected bikeway on The Embarcadero with painted pedestrian access aisle

Two-way Protected Bikeway

on the east side of Frida Kahlo Way and the south side of Judson Avenue. The proposed bikeway increases safety for people using bikes, scooters, power wheelchairs, and other active transportation modes; connects to bikeways on Ocean Avenue, Lee Avenue/North Access Road, and Genessee Street; and is designed to support emergency vehicle access. On Judson Ave, the bikeway will be protected by a combination of 'floating' parking and concrete islands at intersections.

EXISTING

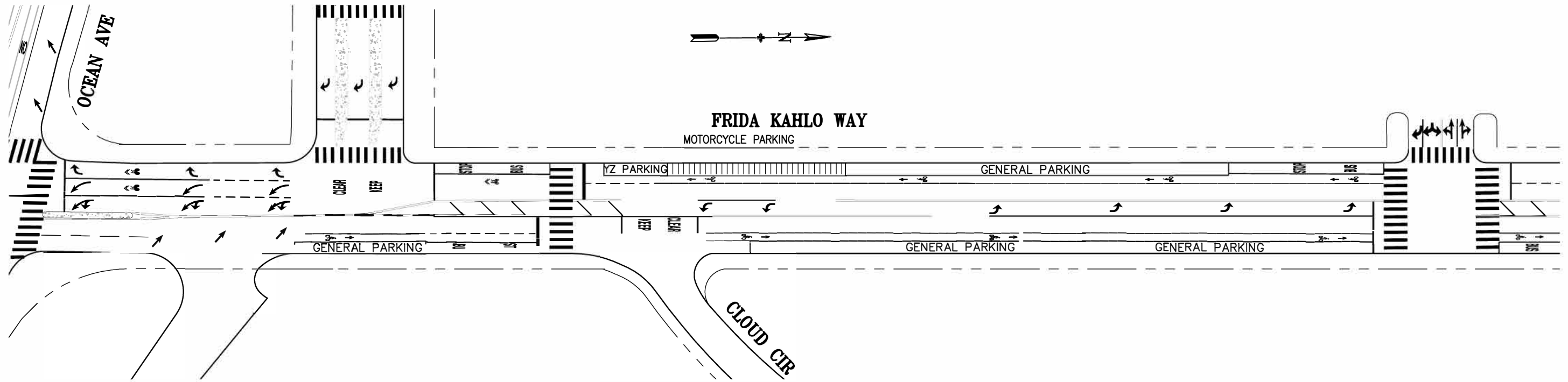

PROPOSED
DRAFT

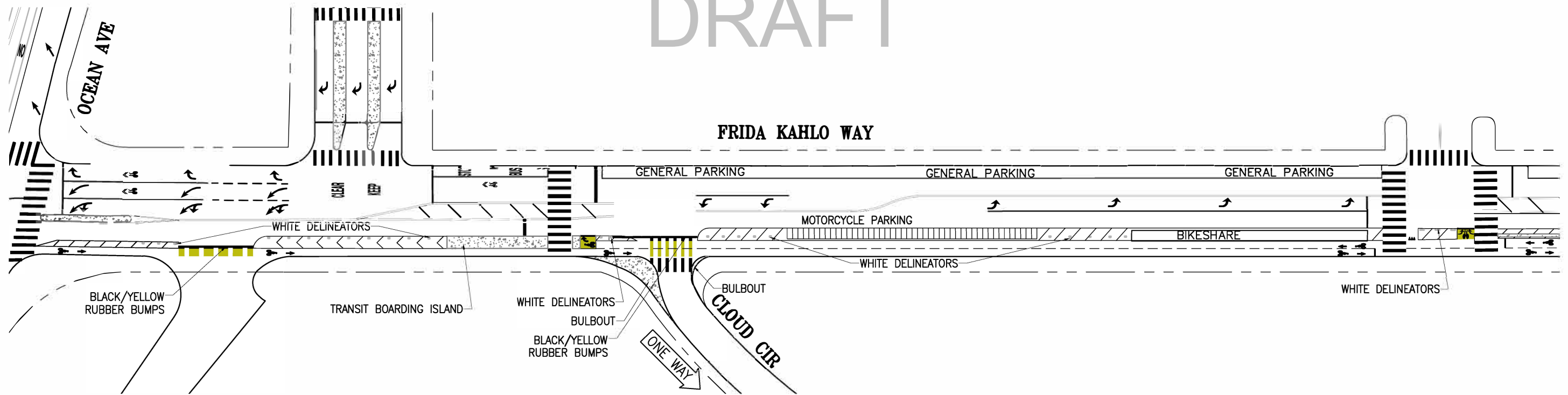

NO.	DATE	DESCRIPTION	BY	APP
TABLE OF REVISIONS				
CHECK WITH TRACING TO SEE IF YOU HAVE LATEST REVISION				



DRAWN:	DATE:	SENIOR ENGINEER	DATE:
X.XXXXXXXXXXXXXXX	MM/DD/YY		
CHECKED:	DATE:	CITY TRAFFIC ENGINEER	DATE:
X.XXXXXXXXXXXXXXX	MM/DD/YY		

APPROVED	SCALE:
	1" = 50'
	SHEET/SHEETS:
	XX OF XX

FRIDA KAHLO QB

DRAFT CONCEPTUAL DESIGN
CITY COLLEGE TERMINAL TO MAIN STEPS

CONTRACT NO.	XXXXX
DRAWING NO.	DWGNO
FILE NO.	
REV. NO.	XXXXX
	XX

FILE NAME: ---/---/---
DATE: ---/---/---

EXISTING

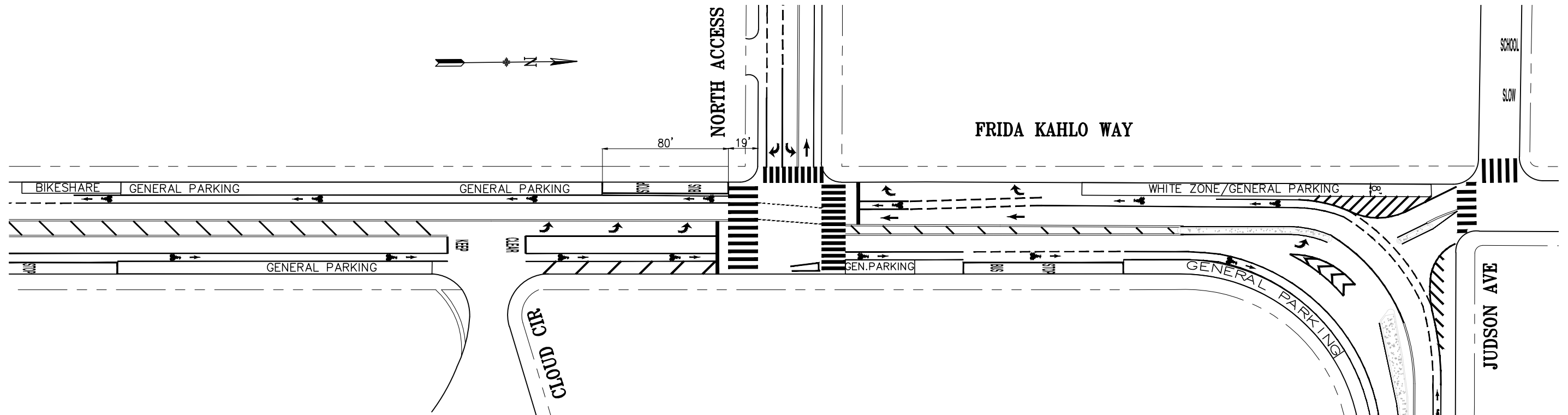

PROPOSED
DRAFT

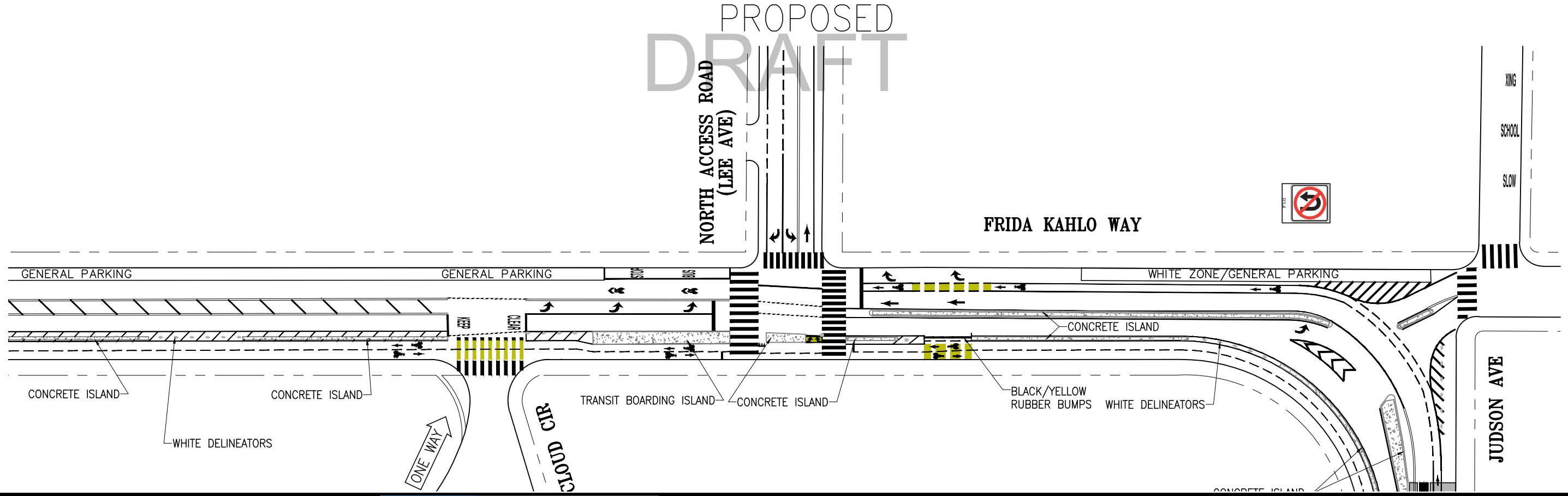

NO.	DATE	DESCRIPTION	BY	APP
TABLE OF REVISIONS				
CHECK WITH TRACING TO SEE IF YOU HAVE LATEST REVISION				



DRAWN:	DATE:	SENIOR ENGINEER	DATE:
X.XXXXXXXXXXXXXX	MM/DD/YY		
CHECKED:	DATE:	CITY TRAFFIC ENGINEER	DATE:
X.XXXXXXXXXXXXXX	MM/DD/YY		

APPROVED	SCALE:
	1" = 50'
SHEET/SHEETS:	XX OF XX

FRIDA KAHLO QB
DRAFT CONCEPTUAL DESIGN
CLOUD CIRCLE NORTH TO JUDSON AVE

CONTRACT NO.	XXXXX
DRAWING NO.	DWGNO
FILE NO.	XXXXX
REV. NO.	XX

FILE NAME:
DATE: --/--/---

EXISTING

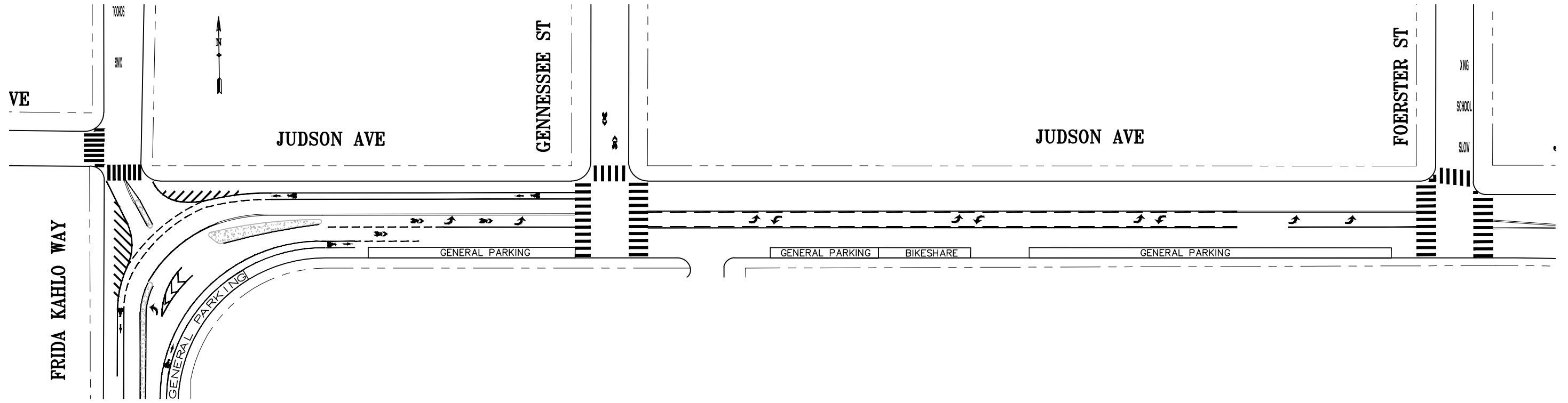

PROPOSED
DRAFT

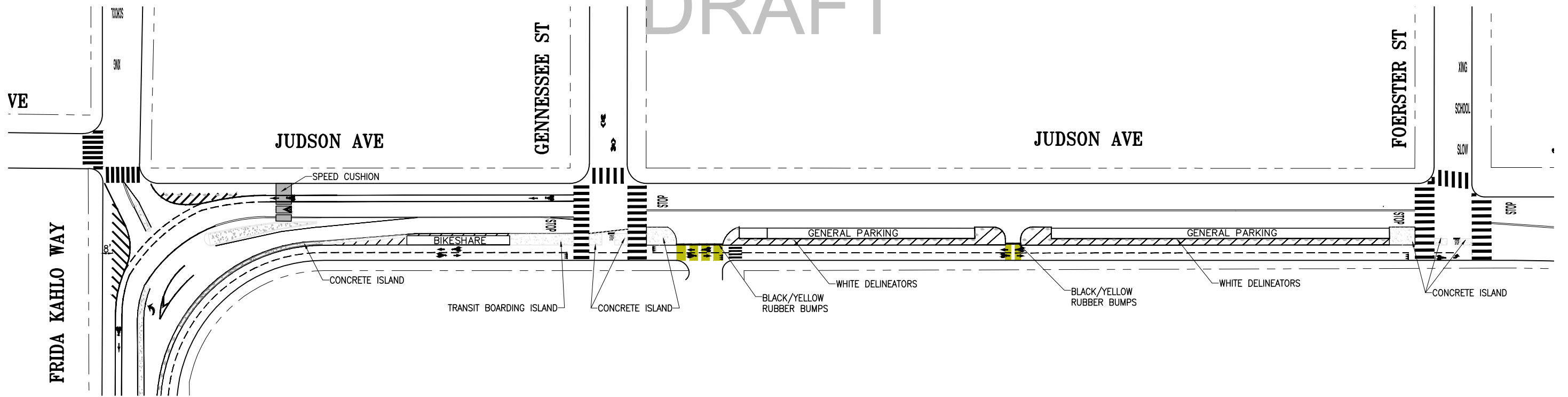

NO.	DATE	DESCRIPTION	BY	APP
TABLE OF REVISIONS				
CHECK WITH TRACING TO SEE IF YOU HAVE LATEST REVISION				



DRAWN:	DATE:	SENIOR ENGINEER	DATE:
X.XXXXXXXXXXXXXX	MM/DD/YY		
CHECKED:	DATE:	CITY TRAFFIC ENGINEER	DATE:
X.XXXXXXXXXXXXXX	MM/DD/YY		

APPROVED	

SCALE:
1" = 50'
SHEET/SHEETS:
XX OF XX

FRIDA KAHLO QB

DRAFT CONCEPTUAL DESIGN
JUDSON AVE
FRIDA KAHLO WAY TO FOERSTER ST

CONTRACT NO.	XXXXX
DRAWING NO.	DWGNO
FILE NO.	XXXXX
REV. NO.	XX

FILE NAME: ---/---/---
DATE: ---/---/---

Summary of Curb Management Changes

This table summarizes the proposed changes to vehicle and motorcycle parking and bikeshare on Frida Kahlo Way between Ocean Avenue and Judson Avenue and on Judson Avenue (south side only) between Frida Kahlo Way and Foerster Avenue.

	General Vehicle Parking*	Blue ADA Parking Zones*	White Passenger Loading Zones*	Yellow Commercial Loading Zones*	Motorcycle Parking	Bikeshare Stations**
Existing	1973 feet (99 spaces)	22 feet (1 space)	240 feet (12 spaces)	41 feet (2 spaces)	55 spaces	133 feet (53 docks)
Proposed (Jan 2024)	1329 feet (66 spaces)	22 feet (1 space)	240 feet (12 spaces)	0 feet	46 spaces	232 feet (93 docks)
Change from Existing	-33 spaces	No Change	No Change	-2 spaces	-9 spaces	+40 docks
Change from Dec 2023 Design	+13 spaces	No Change	No Change	No Change	+14 spaces	No change

* Because parking stalls on Frida Kahlo Way are not marked or metered, the exact number of spaces is approximate.

** Two bikeshare stations are proposed. Final dimensions of the stations are TBD (no impact on general parking spaces).