

K train stop

Boarding island upgrades
at San Leandro Ave

No left turn
at San Leandro Ave (eastbound)

Transit lanes
along Ocean Ave

Parking changes
at San Fernando Ave

Curb changes - no parking
at San Fernando Ave

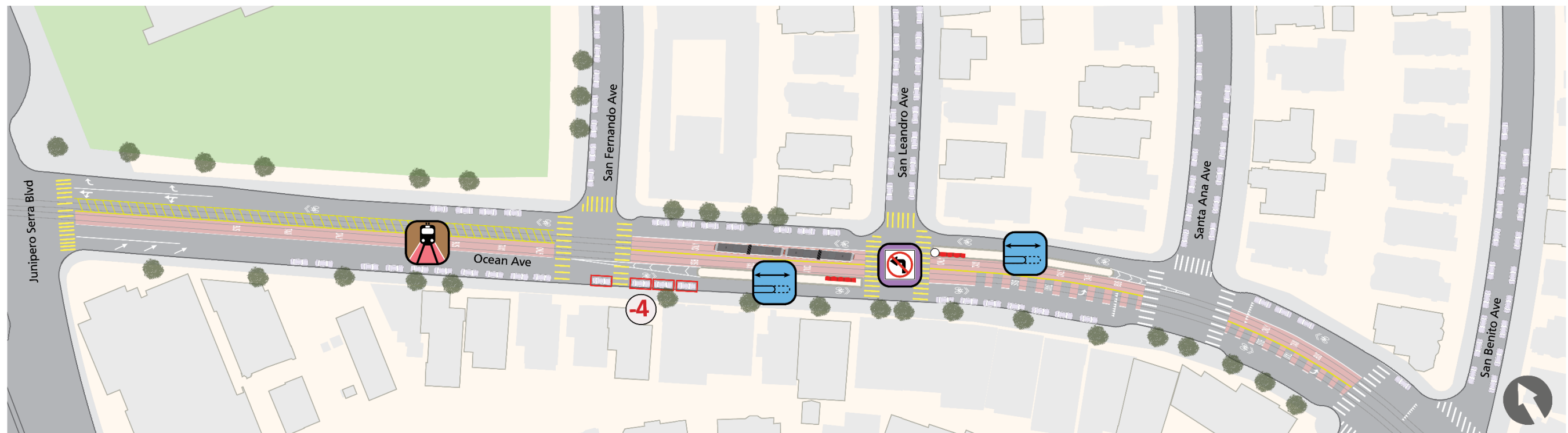

← West to Junipero Serra Blvd

East to Balboa Park →



○ K train stop

⊖3 Parking changes
at Aptos Ave and Cerritos Ave

⊘ No left turn
at Westgate Dr (eastbound)

⊘ Left turn signal
at Cerritos Ave (westbound)

⊘ Rapid flashing beacon
at San Benito Ave

⊘ Boarding island upgrades
at Aptos Ave

⊘ Pedestrian bulb
at San Benito Ave, Westgate Dr, and Cerritos Ave









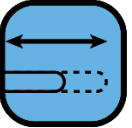

⊘ Transit lanes
along Ocean Ave

⊘ Stop removal
at Cerritos Ave and Westgate Dr

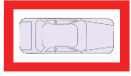
⊘ Curb changes - no parking
at Aptos Ave and Cerritos Ave

← West to Junipero Serra Blvd

→ East to Balboa Park

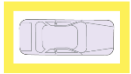
-  K train stop
-  Rapid flashing beacon at Manor Dr
-  Boarding island upgrades at Victoria St
-  No left turn at Lakewood Ave (eastbound)
-  Curb changes - no parking at Victoria St and Fairfield Way
-  Curb changes - general loading at Keystone Way
-  Transit lanes along Ocean Ave
-  Pedestrian bulb at Manor Dr
-  Right turn only from Lakewood Ave (southbound)
-  Parking changes at Victoria St and Fairfield Way
-  Curb changes - commercial loading at Keystone Way

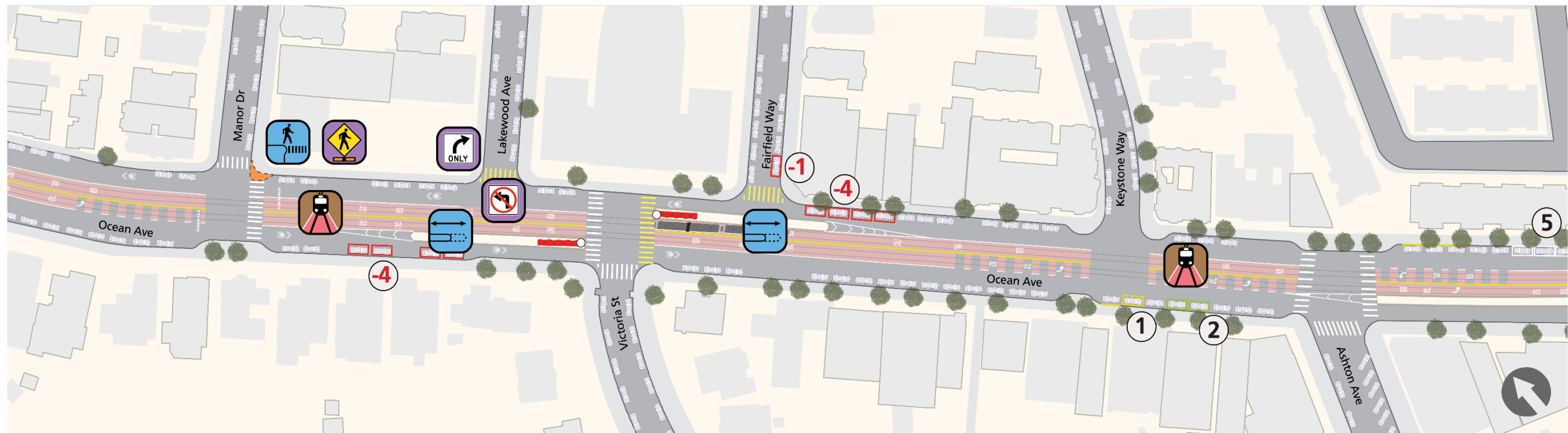

← West to Junipero Serra Blvd

East to Balboa Park →

- K train stop (accessible)
- K train stop
- No left turn at Jules Ave (westbound) and Miramar Ave (westbound)
- Transit lanes along Ocean Ave
- Boarding island upgrades at Miramar Ave
- Right turn only from Granada Ave (southbound)
- Parking changes at Dorado Terr and Miramar Ave
- Curb changes - no parking at Capitol Ave and Granada Ave
- Curb changes - disabled parking at Capitol Ave
- Curb changes - passenger loading at Dorado Terr and Miramar Ave
- Curb changes - commercial loading at Dorado Terr, Capitol Ave, and Miramar Ave

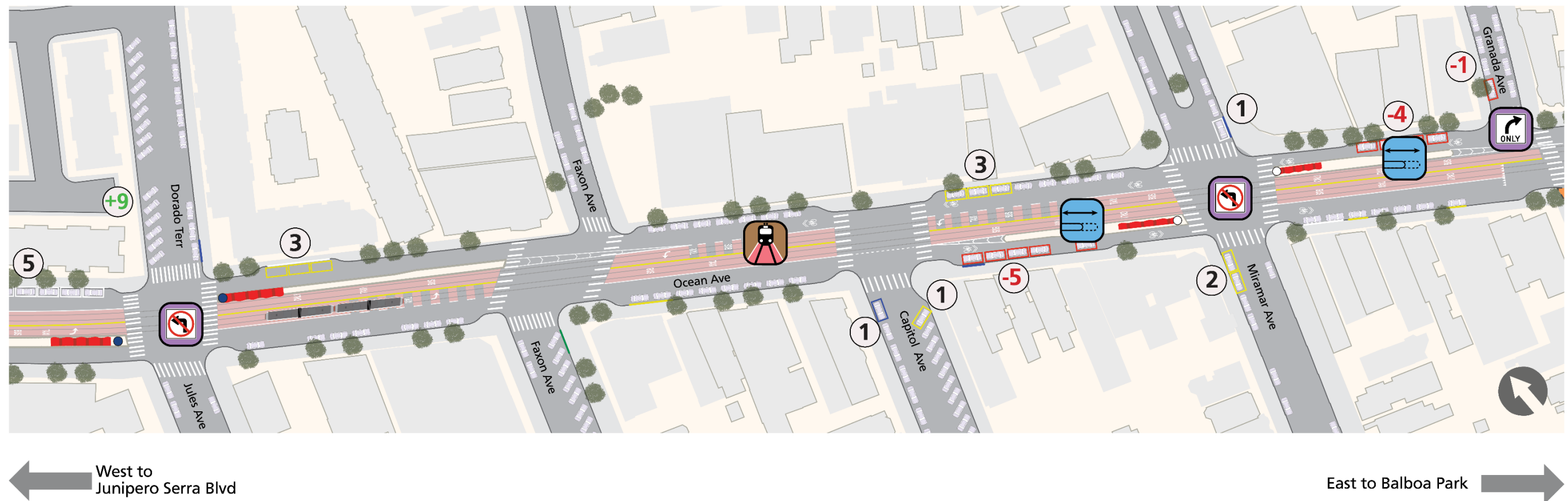

-  K train stop (accessible)
-  Pedestrian bulb at Granada Ave and Plymouth Ave
-  No left turn at Plymouth Ave (eastbound) and Brighton Ave (westbound)
-  Parking changes at Plymouth Ave
-  Rapid flashing beacon at Granada Ave
-  Right turn only from Granada Ave (northbound) and Plymouth Ave (southbound)
-  Stop sign at Plymouth Ave (southbound)
-  Left turn signal at Plymouth Ave (westbound) and Brighton Ave (eastbound)
-  Curb changes - no parking at Plymouth Ave

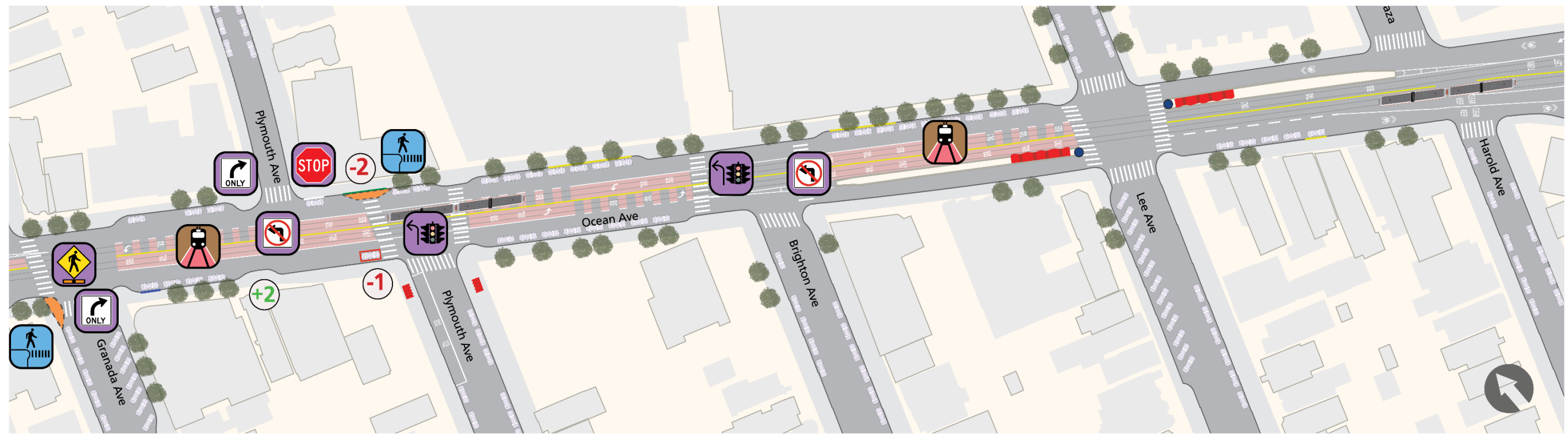

← West to Junipero Serra Blvd

East to Balboa Park →