

**PROGRESS PRINT -  
NOT FOR  
CONSTRUCTION**

- GENERAL NOTES:**
1. THE CONTRACTOR SHALL USE THIS DRAWING TO PREPARE TRAFFIC CONTROL PLANS.
  2. THE CONTRACTOR SHALL VERIFY ALL MEASUREMENTS IN THE FIELD.
  3. ALL CROSSWALKS & STOP LINES SHALL BE 12" WIDE & WHITE IN COLOR UNLESS NOTED OTHERWISE.

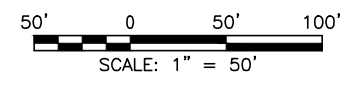

NO.	DATE	DESCRIPTION	BY	APP.
TABLE OF REVISIONS				
CHECK WITH TRACING TO SEE IF YOU HAVE LATEST REVISION				



**SAN FRANCISCO MUNICIPAL TRANSPORTATION AGENCY**  
CITY AND COUNTY OF SAN FRANCISCO

DRAWN: DATE:		APPROVED	
4/2016		SENIOR ENGINEER DATE:	
CHECKED: DATE:		CITY TRAFFIC ENGINEER DATE:	
4/2016			

SCALE:  
1" = 50'  
SHEET OF SHEETS

**PALOU AVENUE COMPLETE STREET  
IMPROVEMENTS PROJECT**  
  
**FINAL TRAFFIC STRIPING**  
**PALOU AVE, BARNEVELD AVE TO DUNSHEE ST**

CONTRACT NO. 2291J
DRAWING NO. T-5
FILE NO.
REV. NO. 0

\\ntanas\redirect\frables\Desktop\TEMP\DOCS\AUGUST 8 WHILE T DRIVE GETS MORE SPACE\2291\_Palou T4 to T6\_Rev FR.dwg frables Thu Aug 11, 2016 8:17 pm

EXTERNAL REFERENCES: XREFS  
FONTS USED: FONTS  
SCALE FACTOR: XX  
PLOT SCALE: 1" = 50'

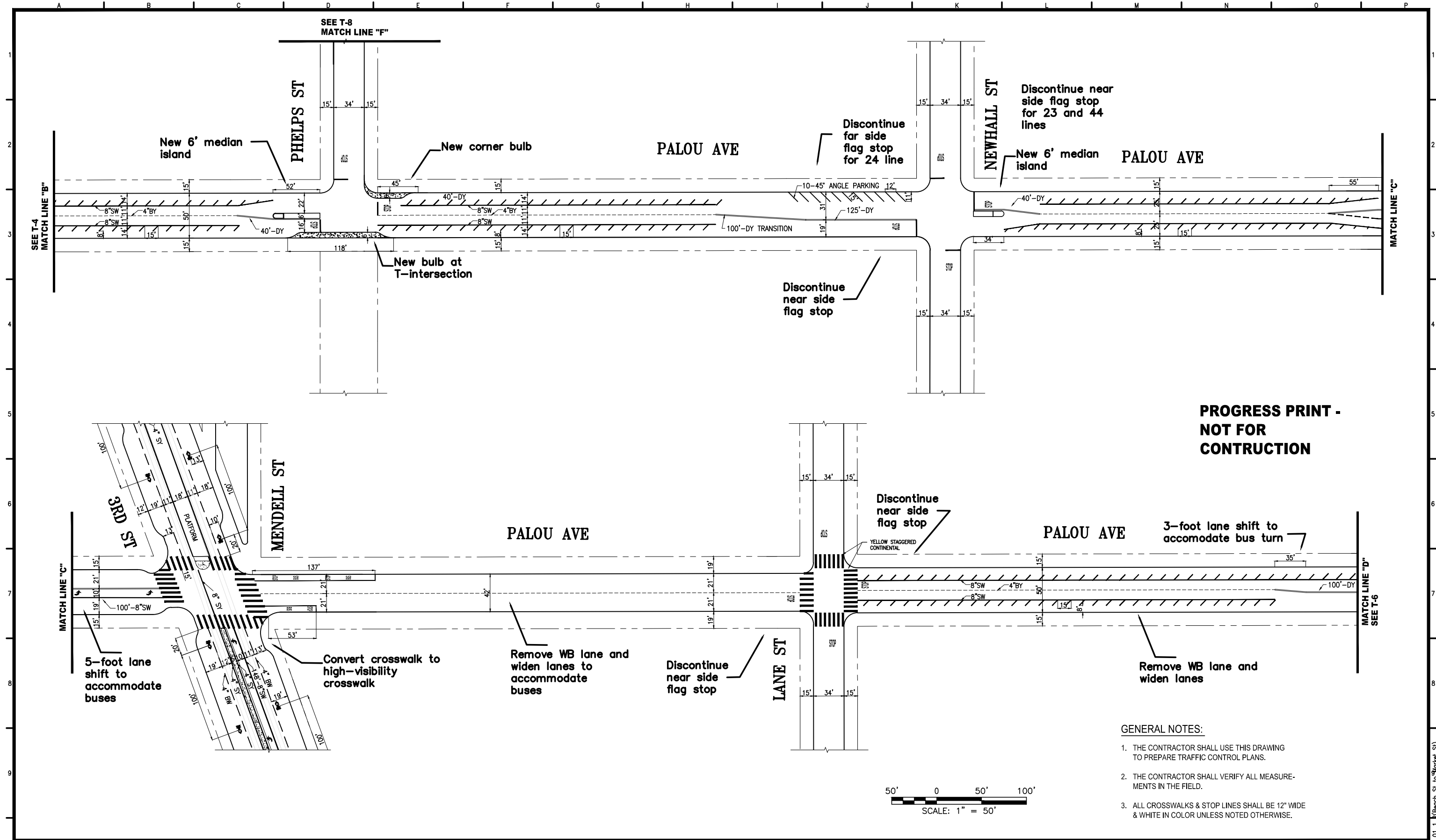

**PROGRESS PRINT -  
NOT FOR  
CONSTRUCTION**

**GENERAL NOTES:**

1. THE CONTRACTOR SHALL USE THIS DRAWING TO PREPARE TRAFFIC CONTROL PLANS.
2. THE CONTRACTOR SHALL VERIFY ALL MEASUREMENTS IN THE FIELD.
3. ALL CROSSWALKS & STOP LINES SHALL BE 12" WIDE & WHITE IN COLOR UNLESS NOTED OTHERWISE.

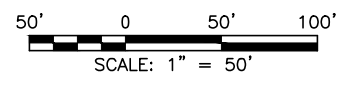

NO.	DATE	DESCRIPTION	BY	APP.
TABLE OF REVISIONS				
CHECK WITH TRACING TO SEE IF YOU HAVE LATEST REVISION				



**SAN FRANCISCO MUNICIPAL TRANSPORTATION AGENCY**  
CITY AND COUNTY OF SAN FRANCISCO

DRAWN: DATE: 6/2016		APPROVED: SENIOR ENGINEER DATE: 6/2016	
CHECKED: DATE: 6/2016		CITY TRAFFIC ENGINEER DATE:	

SCALE:  
1" = 50'  
SHEET OF SHEETS

**PALOU AVENUE COMPLETE STREET  
IMPROVEMENTS PROJECT**  
  
**FINAL TRAFFIC STRIPING  
PALOU AVE, PHELPS ST TO LANE ST**

CONTRACT NO. 2291J
DRAWING NO. T-6
FILE NO.
REV. NO. 0

FILE NAME: Polk\_SLSR-7609\_01\_1.dwg (Sheet: ST) ORIGIN: SECTION  
 SCALE FACTOR: XX PLOT SCALE: 1"=1'  
 EXTERNAL REFERENCES: XREFS FONTS USED: FONTS

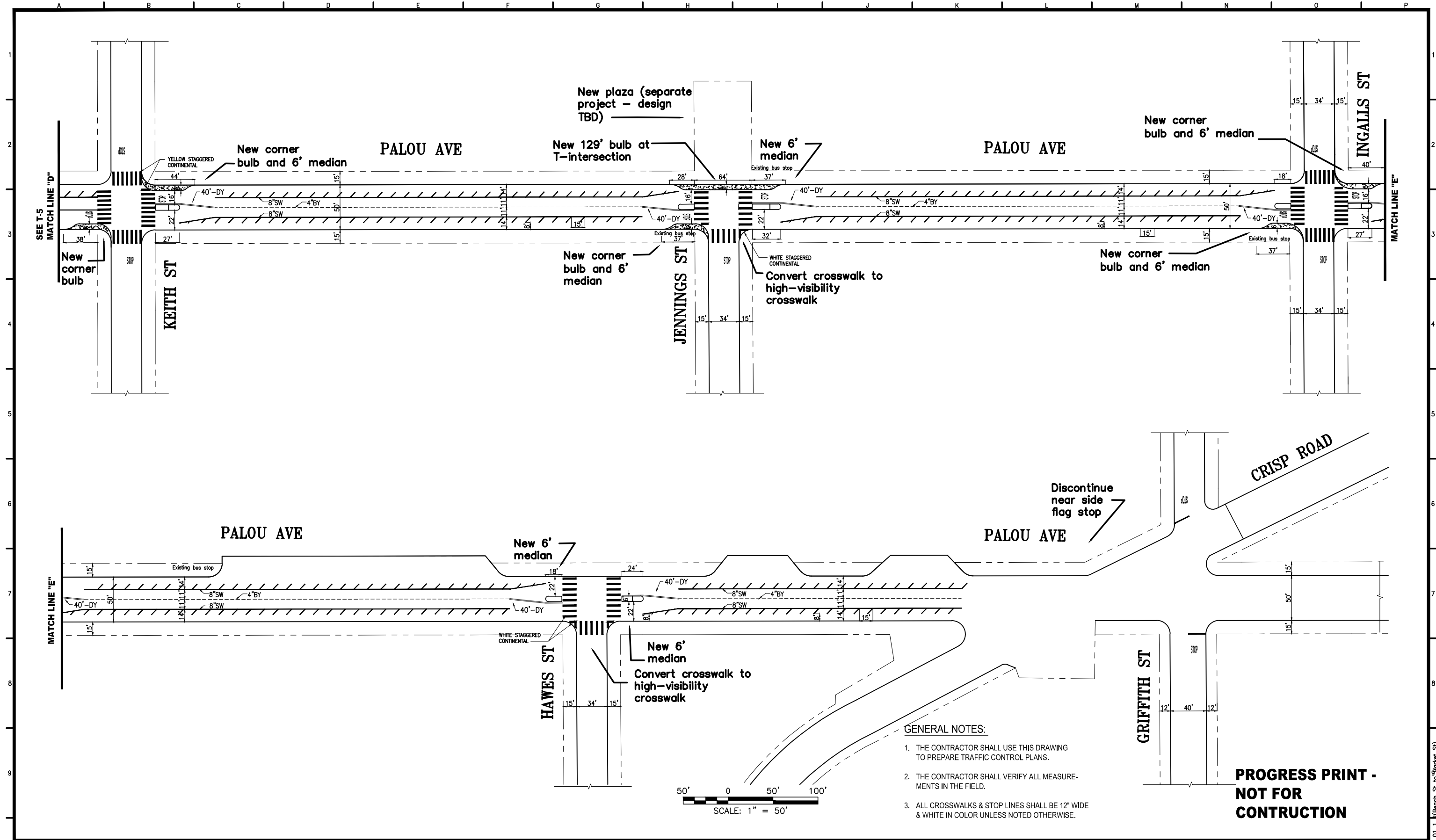

- GENERAL NOTES:**
1. THE CONTRACTOR SHALL USE THIS DRAWING TO PREPARE TRAFFIC CONTROL PLANS.
  2. THE CONTRACTOR SHALL VERIFY ALL MEASUREMENTS IN THE FIELD.
  3. ALL CROSSWALKS & STOP LINES SHALL BE 12" WIDE & WHITE IN COLOR UNLESS NOTED OTHERWISE.

**PROGRESS PRINT - NOT FOR CONSTRUCTION**

NO.	DATE	DESCRIPTION	BY	APP.
TABLE OF REVISIONS				
CHECK WITH TRACING TO SEE IF YOU HAVE LATEST REVISION				



**SAN FRANCISCO MUNICIPAL TRANSPORTATION AGENCY**  
CITY AND COUNTY OF SAN FRANCISCO

DRAWN: DATE: 6/2016		APPROVED: SENIOR ENGINEER DATE: 6/2016	
CHECKED: DATE: 6/2016		CITY TRAFFIC ENGINEER DATE:	

SCALE: 1" = 50'  
SHEET OF SHEETS

**PALOU AVENUE COMPLETE STREET IMPROVEMENTS PROJECT**  
**FINAL TRAFFIC STRIPING**  
**PALOU AVE, KEITH ST TO GRIFFITH ST**

CONTRACT NO. 2291J
DRAWING NO. T-7
FILE NO.
REV. NO. 0

EXTERNAL REFERENCES: XREFS  
 FONTS USED: FONTS  
 SCALE FACTOR: XX  
 PLOT SCALE: 1"=1'  
 FILE NAME: Polk\_SL-STR-7609-01-1.dwg (Sheet: ST)  
 ORIGIN: SECTION  
 DATE: