

## SFMTA - TASC SUMMARY SHEET

<b>TASC</b> <b>Date:</b> 7/8/2021 <b>Requested_by:</b> DPW <b>Handled:</b> Amy Chun <b>Section Head :</b> ET <span style="float: right;">ET</span>	<input checked="" type="checkbox"/> <b>Public Hearing Consent</b> <input type="checkbox"/> <b>Public Hearing Regular</b> <input type="checkbox"/> <b>Informational / Other</b> <small>PH - Consent</small>	<b>No objections:</b> _____ <b>Item Held:</b> _____ <b>Other:</b> _____
---	---	---

**Location:** Treat Avenue at Harrison Street between 16th Street and 17th Street

**Subject:** Traffic Circulation Reversal

**PROPOSAL / REQUEST:**

ESTABLISH – ONE-WAY STREET  
 Treat Avenue, northbound, from 17th Street to Harrison Street (reverses this existing one-way street)

ESTABLISH – RIGHT TURN ONLY  
 Treat Avenue, eastbound, at Harrison Street (between 16th Street and 17th Street)

RESCIND – STOP SIGN  
 Treat Avenue, southbound, at 17th Street (removes existing stop)

ESTABLISH – STOP SIGN  
 Treat Avenue, eastbound, at Harrison Street (between 16th Street and 17th Street)

Proposal to reverse one-way regulation, relocate STOP signs, and restrict Treat Avenue left turns at the request of Public Works for the Treat Plaza Project.

(Supervisor District 9)

Amy Chun. amy.chun@sfmta.com

**BACKGROUND INFORMATION / COMMENTS**

As part of the Groundplay program – a multi-agency program that builds temporary installations that turn underused public spaces into community places – Public Works is requesting to reverse the one-way traffic circulation of Treat Avenue between 17th Street and Harrison Street. This proposal is in response to solicited public feedback and neighborhood support on the proposed project, as well as cut-through traffic concerns on southbound Treat Avenue.

As part of Muni Forward, SFMTA began piloting street geometry changes at both the southwest and northeast corners of Harrison Street and 16th Street. Additionally, Groundplay, in partnership with the local community stakeholder and Friends of Treat Plaza, is developing a temporary installation to test the community's vision for the space. This temporary installation will test ideas of how the space could look and function before it transitions into a permanent plaza. SF Public Works will lead the permanent plaza implementation.

No Muni.

No impacts to parking.

5 related broadside collisions in 5-year period at two-way STOP intersection of 17th Street and Treat Avenue.

**HEARING NOTIFICATION AND PROCESSING NOTES:**

**ENVIRONMENTAL CLEARANCE BY:**

SFMTA  Attached  Pending

ESTABLISH – ONE-WAY STREET

Treat Avenue, northbound, from 17th Street to Harrison Street (reverses this existing one-way street)

ESTABLISH – RIGHT TURN ONLY

Treat Avenue, eastbound, at Harrison Street (between 16th Street and 17th Street)

RESCIND – STOP SIGN

Treat Avenue, southbound, at 17<sup>th</sup> Street (removes existing stop)

ESTABLISH – STOP SIGN

Treat Avenue, eastbound, at Harrison Street (between 16<sup>th</sup> Street and 17<sup>th</sup> Street)

Proposal to reverse one-way regulation, relocate STOP signs, and restrict Treat Avenue left turns at the request of Public Works for the Treat Plaza Project.

(Supervisor District 9)

Amy Chun, amy.chun@sfmta.com

As part of the Groundplay program – a multi-agency program that builds temporary installations that turn underused public spaces into community places – Public Works is requesting to reverse the one-way traffic circulation of Treat Avenue between 17th Street and Harrison Street. This proposal is in response to solicited public feedback and neighborhood support on the proposed project, as well as cut-through traffic concerns on southbound Treat Avenue.

As part of Muni Forward, SFMTA began piloting street geometry changes at both the southwest and northeast corners of Harrison Street and 16th Street. Additionally, Groundplay, in partnership with the local community stakeholder and Friends of Treat Plaza, is developing a temporary installation to test the community's vision for the space. This temporary installation will test ideas of how the space could look and function before it transitions into a permanent plaza. SF Public Works will lead the permanent plaza implementation.

No Muni.

No impacts to parking.

5 related broadside collisions in 5-year period at two-way STOP intersection of 17<sup>th</sup> Street and Treat Avenue.

CITY AND COUNTY OF SAN FRANCISCO  
MUNICIPAL TRANSPORTATION AGENCY  
**TRAFFIC ENGINEERING**  
CITIZEN REQUEST CORRESPONDENCE



<b>Request No.</b>	20-1579	<b>Section</b>	OPS
<b>TSC No.</b>		<b>Staff Assigned</b>	AChun
<b>Director's No.</b>		<b>Due Date</b>	
<b>Mayor's No.</b>		<b>Neighborhood</b>	
<b>Requested Date</b>	5/19/2020	<b>School Name</b>	
<b>Received Date</b>	5/19/2020	<b>Organization</b>	

<b>Firm</b>	Public Works
<b>Requested By</b>	
<b>Address</b>	
<b>City/State/Zip</b>	San Francisco, CA
<b>Letter Subject</b>	One-Way Street Change

Subject Location	Work Description
Treat Avenue at 16th Street and 17th Street	

Additional Correspondence		Legislation	Action	Date
From/To	Date			
		TASC		
		Public Hearing		
		SFMTA Board		
		Board Committee		
		Board of Sups		
		Mayor's		
		Res/Ord No.		

Comment
Recommend traffic circulation reversal  AChun   2021_0618

Notes:  
Not included in correspondences since this was a meeting:  
Ops is taking care of legislation, STOP related items  
Traffic Routing will take care of xwalk

Didnt include formal letter since I'm in ongoing correspondence with requester. Please let me know if this moves forward so I can update the DPW folks  
-AChun

**From:** [Folks, Tom](#)  
**To:** [de la Fuente, Nicole](#)  
**Subject:** FW: Traffic circulation reversal process - Treat Plaza  
**Date:** Tuesday, May 19, 2020 4:45:24 PM  
**Attachments:** [image001.png](#)  
[image005.png](#)

---

Hi Nicole—can you log in this request for a one-way street change for Ops?

---

**From:** Folks, Tom  
**Sent:** Tuesday, May 19, 2020 4:44 PM  
**To:** Disbrow, Anastasia (DPW) <Anastasia.Disbrow@sfdpw.org>; Sheeter, Daniel <Daniel.Sheeter@sfmta.com>; De Alva, María (CPC) <maria.dealva@sfgov.org>; Olea, Ricardo <Ricardo.Olea@sfmta.com>; Parks, Jamie <Jamie.Parks@sfmta.com>  
**Cc:** Woo, Michelle (DPW) <Michelle.Woo@sfdpw.org>  
**Subject:** RE: Traffic circulation reversal process - Treat Plaza

Hi Anya,

We don't want to waste anyone's time with a petition if you're confident that the majority of people on that block are going to support the change.

One of our traffic engineers will do an evaluation about the change to make sure there aren't any other unanticipated problems and also to develop a plan for the changing of the signs and striping. The proposal will then have to go through TASC review, a public hearing, and the SFMTA Board for final approval. The timeline would be something on the order of three to four months.

Thomas Folks  
Senior Engineer  
Sustainable Streets Division



Office 415.701.4688

San Francisco Municipal Transportation Agency  
1 South Van Ness Avenue, 7th floor  
San Francisco, CA 94103



---

**From:** Disbrow, Anastastia (DPW) <[Anastastia.Disbrow@sfdpw.org](mailto:Anastastia.Disbrow@sfdpw.org)>  
**Sent:** Tuesday, May 19, 2020 4:33 PM  
**To:** Folks, Tom <[Tom.Folks@sfmta.com](mailto:Tom.Folks@sfmta.com)>; Sheeter, Daniel <[Daniel.Sheeter@sfmta.com](mailto:Daniel.Sheeter@sfmta.com)>; De Alva, María (CPC) <[maria.dealva@sfgov.org](mailto:maria.dealva@sfgov.org)>; Olea, Ricardo <[Ricardo.Olea@sfmta.com](mailto:Ricardo.Olea@sfmta.com)>; Parks, Jamie <[Jamie.Parks@sfmta.com](mailto:Jamie.Parks@sfmta.com)>  
**Cc:** Woo, Michelle (DPW) <[Michelle.Woo@sfdpw.org](mailto:Michelle.Woo@sfdpw.org)>  
**Subject:** RE: Traffic circulation reversal process - Treat Plaza

EXT

Hi Thomas,

Yes, I'm confident that a majority of the stakeholders would support his decision. Of all the requests from the community this was one they were most vocal about.

I'm not familiar with the legislation process- Would PW PM staff be responsible for collecting signatures for the petition? Would a separate community meeting need to be held to discuss this change?

If you can share a little bit on next steps that would be great.

Thanks for your help,  
Anya

Anastastia Disbrow  
Assistant Project Manager

Project Management & Construction | San Francisco Public Works | City and County of San Francisco  
30 Van Ness Avenue, 5th Floor | San Francisco, CA 94102 | (415) 558-4005 | [sfpublicworks.org](http://sfpublicworks.org) ·  
[twitter.com/sfpublicworks](https://twitter.com/sfpublicworks)

I am moving June 19, 2020! My new number will be: (628) 271-2477.  
My current number will cease working on the above date.

---

**From:** Folks, Tom <[Tom.Folks@sfmta.com](mailto:Tom.Folks@sfmta.com)>  
**Sent:** Tuesday, May 19, 2020 3:50 PM  
**To:** Disbrow, Anastastia (DPW) <[Anastastia.Disbrow@sfdpw.org](mailto:Anastastia.Disbrow@sfdpw.org)>; Sheeter, Daniel (MTA) <[Daniel.Sheeter@sfmta.com](mailto:Daniel.Sheeter@sfmta.com)>; De Alva, María (CPC) <[maria.dealva@sfgov.org](mailto:maria.dealva@sfgov.org)>; Olea, Ricardo (MTA) <[Ricardo.Olea@sfmta.com](mailto:Ricardo.Olea@sfmta.com)>; Parks, Jamie (MTA) <[Jamie.Parks@sfmta.com](mailto:Jamie.Parks@sfmta.com)>  
**Cc:** Woo, Michelle (DPW) <[Michelle.Woo@sfdpw.org](mailto:Michelle.Woo@sfdpw.org)>  
**Subject:** RE: Traffic circulation reversal process - Treat Plaza

Hi Anya,

Normally we want to see a petition signed by at least 50% of the adjacent businesses and residents. Are you confident that the one-way reversal is supported by the majority of the stakeholders on the street itself? When we have the public hearing and the SFMTA Board processes the legislation, we like to have some background information to explain why the change is being recommended, especially to any stakeholders who may not have participated in any of the previous public meetings.

Thomas Folks  
Senior Engineer  
Sustainable Streets Division



Office 415.701.4688

San Francisco Municipal Transportation Agency  
1 South Van Ness Avenue, 7th floor  
San Francisco, CA 94103



---

**From:** Disbrow, Anastasia (DPW) <[Anastasia.Disbrow@sfdpw.org](mailto:Anastasia.Disbrow@sfdpw.org)>

**Sent:** Tuesday, May 19, 2020 3:37 PM

**To:** Sheeter, Daniel <[Daniel.Sheeter@sfmta.com](mailto:Daniel.Sheeter@sfmta.com)>; De Alva, María (CPC) <[maria.dealva@sfgov.org](mailto:maria.dealva@sfgov.org)>; Olea, Ricardo <[Ricardo.Olea@sfmta.com](mailto:Ricardo.Olea@sfmta.com)>; Parks, Jamie <[Jamie.Parks@sfmta.com](mailto:Jamie.Parks@sfmta.com)>

**Cc:** Folks, Tom <[Tom.Folks@sfmta.com](mailto:Tom.Folks@sfmta.com)>; Woo, Michelle (DPW) <[Michelle.Woo@sfdpw.org](mailto:Michelle.Woo@sfdpw.org)>

**Subject:** RE: Traffic circulation reversal process - Treat Plaza

EXT

Hi Daniel,

What type of documentation would you need?

The project has held many community outreach meetings over the years and all that attended were in support of the traffic change. I can share meeting minutes to support this proposal.

Thank you,

Anya

Anastastia Disbrow  
Assistant Project Manager

Project Management & Construction | San Francisco Public Works | City and County of San Francisco  
30 Van Ness Avenue, 5th Floor | San Francisco, CA 94102 | (415) 558-4005 | [sfpublicworks.org](http://sfpublicworks.org) ·  
[twitter.com/sfpublicworks](https://twitter.com/sfpublicworks)

I am moving June 19, 2020! My new number will be: (628) 271-2477.  
My current number will cease working on the above date.

---

**From:** Sheeter, Daniel <[Daniel.Sheeter@sfmta.com](mailto:Daniel.Sheeter@sfmta.com)>  
**Sent:** Monday, May 18, 2020 10:19 AM  
**To:** De Alva, María (CPC) <[maria.dealva@sfgov.org](mailto:maria.dealva@sfgov.org)>; Olea, Ricardo (MTA) <[Ricardo.Olea@sfmta.com](mailto:Ricardo.Olea@sfmta.com)>; Parks, Jamie (MTA) <[Jamie.Parks@sfmta.com](mailto:Jamie.Parks@sfmta.com)>  
**Cc:** Disbrow, Anastastia (DPW) <[Anastastia.Disbrow@sfdpw.org](mailto:Anastastia.Disbrow@sfdpw.org)>; Folks, Tom (MTA) <[Tom.Folks@sfmta.com](mailto:Tom.Folks@sfmta.com)>; Woo, Michelle (DPW) <[Michelle.Woo@sfdpw.org](mailto:Michelle.Woo@sfdpw.org)>  
**Subject:** RE: Traffic circulation reversal process - Treat Plaza

Adding Michelle to the thread.

---

**From:** Sheeter, Daniel  
**Sent:** Thursday, May 14, 2020 3:12 PM  
**To:** De Alva, María (CPC) <[maria.dealva@sfgov.org](mailto:maria.dealva@sfgov.org)>; Olea, Ricardo <[Ricardo.Olea@sfmta.com](mailto:Ricardo.Olea@sfmta.com)>; Parks, Jamie <[Jamie.Parks@sfmta.com](mailto:Jamie.Parks@sfmta.com)>  
**Cc:** Disbrow, Anastastia (DPW) <[Anastastia.Disbrow@sfdpw.org](mailto:Anastastia.Disbrow@sfdpw.org)>; Folks, Tom <[Tom.Folks@sfmta.com](mailto:Tom.Folks@sfmta.com)>  
**Subject:** RE: Traffic circulation reversal process - Treat Plaza

Hi Maria,

Is there documentation of the community process and support for the proposal? We typically ask for at least 50% support by the adjacent frontages on the block before legislating a circulation change.

Thanks,  
Daniel

---

**From:** De Alva, María (CPC) <[maria.dealva@sfgov.org](mailto:maria.dealva@sfgov.org)>  
**Sent:** Thursday, April 23, 2020 12:10 PM  
**To:** Sheeter, Daniel <[Daniel.Sheeter@sfmta.com](mailto:Daniel.Sheeter@sfmta.com)>; Shahamiri, James

<[James.Shahamiri@sfmta.com](mailto:James.Shahamiri@sfmta.com)>; Olea, Ricardo <[Ricardo.Olea@sfmta.com](mailto:Ricardo.Olea@sfmta.com)>; Parks, Jamie <[Jamie.Parks@sfmta.com](mailto:Jamie.Parks@sfmta.com)>

**Cc:** Disbrow, Anastasia (DPW) <[Anastasia.Disbrow@sfdpw.org](mailto:Anastasia.Disbrow@sfdpw.org)>

**Subject:** Re: Traffic circulation reversal process - Treat Plaza

Hi everyone,

I hope you're all doing well during these times. I wanted to follow up on this email from a while back. Who would be the right contact at SFMTA to work with on the traffic circulation reversal for Treat Ave? See email thread for background.

Thanks again and take care.

Best,  
María De Alva

City Design, Citywide Planning Division  
[Groundplay Program](#) | [Parklet Program](#)  
San Francisco Planning Department  
1650 Mission Street, Suite 400 San Francisco, CA 94103  
Direct: 415.575.8729 | [www.sfplanning.org](http://www.sfplanning.org)  
San Francisco Property Information Map

The Planning Department is open for business during the Shelter in Place Order. Most of our staff are working from home and we're [available by e-mail](#). Our [Public Portal](#), where you can file new applications, and our [Property Information Map](#) are available 24/7. The Planning Commission is convening remotely and [the public is encouraged to participate](#). The Board of Appeals and Board of Supervisors are [accepting appeals](#) via e-mail despite office closures. All of our in-person services at 1650 and 1660 Mission Street are suspended until further notice. [Click here for more information.](#)

---

**From:** "Sheeter, Daniel" <[Daniel.Sheeter@sfmta.com](mailto:Daniel.Sheeter@sfmta.com)>

**Date:** Monday, February 24, 2020 at 1:35 PM

**To:** "Shahamiri, James (MTA)" <[James.Shahamiri@sfmta.com](mailto:James.Shahamiri@sfmta.com)>, "Olea, Ricardo (MTA)" <[Ricardo.Olea@sfmta.com](mailto:Ricardo.Olea@sfmta.com)>, "Parks, Jamie (MTA)" <[Jamie.Parks@sfmta.com](mailto:Jamie.Parks@sfmta.com)>

**Cc:** "De Alva, María (CPC)" <[maria.dealva@sfgov.org](mailto:maria.dealva@sfgov.org)>

**Subject:** Re: Traffic circulation reversal process - Treat Plaza

This message is from outside the City email system. Do not open links or attachments from untrusted sources.

Sorry, Maria De Alva, Planning Dept project manager, is now copied.

Thanks,  
Daniel

---

**From:** Sheeter, Daniel

**Sent:** Thursday, February 20, 2020 3:14 PM

**To:** Shahamiri, James <[James.Shahamiri@sfmta.com](mailto:James.Shahamiri@sfmta.com)>; Olea, Ricardo <[Ricardo.Olea@sfmta.com](mailto:Ricardo.Olea@sfmta.com)>;



Parks, Jamie <[Jamie.Parks@sfmta.com](mailto:Jamie.Parks@sfmta.com)>

**Cc:** Maria Vyas <[m.vyas@fehrandpeers.com](mailto:m.vyas@fehrandpeers.com)>

**Subject:** FW: Traffic circulation reversal process - Treat Plaza

Hi All,

Planning Dept reached out to me to initiate converting Treat Ave between 16<sup>th</sup> and 17<sup>th</sup> to one-way northbound in coordination with the Treat Plaza project. Cathal was the lead on this a few years back. Was there SSD involvement then? Planning/Public Works are hoping to have someone from MTA assigned to help finalize the curb geometry and take the circulation change through legislation.

The project manager María Vyas is copied.

Thanks,  
Daniel

---

**From:** De Alva, María (CPC) <[maria.dealva@sfgov.org](mailto:maria.dealva@sfgov.org)>

**Sent:** Wednesday, February 19, 2020 6:13 PM

**To:** Sheeter, Daniel <[Daniel.Sheeter@sfmta.com](mailto:Daniel.Sheeter@sfmta.com)>

**Subject:** Traffic circulation reversal process - Treat Plaza

Hi Daniel,

I was hoping you could point me in the right direction. A few years back we were working with Cathal Hennesy on the 16<sup>th</sup> St project, but focusing on a proposal for a plaza at Treat Ave and 16<sup>th</sup>.

One of the outcomes of that community process was that there was a strong desire from the community to reverse traffic circulation on Treat Ave for the block of 16<sup>th</sup> to 17<sup>th</sup> Streets, due to the dangerous ped and bike conflict that the current circulation disposes. We had begun the process back then but the project was halted.

Now Public Works has allocated funding to implement the plaza, and that includes formalizing the pedestrian crossing too. **Would you be able to connect me to someone at MTA that could help us and the community initiate this process?**

Public Works and Planning can assist with schematics and run any turn templates as needed, we would just need someone at MTA to review and guide us through the process.

I appreciate your help! I'm attaching some documents for context.

Best,

**María De Alva**  
City Design, Citywide Planning Division

[Groundplay Program](#) | [Parklet Program](#)

San Francisco Planning Department  
1650 Mission Street, Suite 400 San Francisco, CA 94103  
Direct: 415.575.8729 | [www.sfplanning.org](http://www.sfplanning.org)  
[San Francisco Property Information Map](#)

This message is from outside of the SFMTA email system. Please review the email carefully before responding, clicking links, or opening attachments.

This message is from outside of the SFMTA email system. Please review the email carefully before responding, clicking links, or opening attachments.

## Chun, Amy

---

**From:** Woo, Michelle (DPW) <Michelle.Woo@sfdpw.org>  
**Sent:** Tuesday, June 8, 2021 4:51 PM  
**To:** Sheeter, Daniel; De Alva, María (CPC); Disbrow, Anastastia (DPW); Olea, Ricardo; Parks, Jamie; Tsui, Eddie  
**Cc:** Chun, Amy  
**Subject:** RE: Traffic circulation reversal process - Treat Plaza

EXT

Thanks Daniel –

We just had a check-in with Amy. CC'ing her here. I think she's on it.

Thank you,  
Michelle

---

**From:** Sheeter, Daniel <Daniel.Sheeter@sfmta.com>  
**Sent:** Tuesday, June 8, 2021 4:41 PM  
**To:** De Alva, María (CPC) <maria.dealva@sfgov.org>; Disbrow, Anastastia (DPW) <Anastastia.Disbrow@sfdpw.org>; Olea, Ricardo (MTA) <Ricardo.Olea@sfmta.com>; Parks, Jamie (MTA) <Jamie.Parks@sfmta.com>; Tsui, Eddie (MTA) <Eddie.Tsui@sfmta.com>  
**Cc:** Woo, Michelle (DPW) <Michelle.Woo@sfdpw.org>  
**Subject:** RE: Traffic circulation reversal process - Treat Plaza

Hi Maria,

Looping in Eddie Tsui who is now acting for Tom.

Thanks,  
Daniel

---

**From:** De Alva, María (CPC) <[maria.dealva@sfgov.org](mailto:maria.dealva@sfgov.org)>  
**Sent:** Thursday, April 15, 2021 11:22 AM  
**To:** Folks, Tom <[Tom.Folks@sfmta.com](mailto:Tom.Folks@sfmta.com)>; Disbrow, Anastastia (DPW) <[Anastastia.Disbrow@sfdpw.org](mailto:Anastastia.Disbrow@sfdpw.org)>; Sheeter, Daniel <[Daniel.Sheeter@sfmta.com](mailto:Daniel.Sheeter@sfmta.com)>; Olea, Ricardo <[Ricardo.Olea@sfmta.com](mailto:Ricardo.Olea@sfmta.com)>; Parks, Jamie <[Jamie.Parks@sfmta.com](mailto:Jamie.Parks@sfmta.com)>  
**Cc:** Woo, Michelle (DPW) <[Michelle.Woo@sfdpw.org](mailto:Michelle.Woo@sfdpw.org)>  
**Subject:** RE: Traffic circulation reversal process - Treat Plaza

Hi Tom,

I hope you're doing well. I failed to follow up on this item (that's almost a year old!). Would you mind providing the team with an update? Michelle & team are getting ready to begin construction in May and wanted to know if the traffic circulation reversal was initiated and where it stands? Last temperature check we did with the community we heard support for this change, and also hearing from the cycling community who uses the lane on Harrison, who might not necessarily live or work on the block in question.

Thank you,  
María De Alva

Public Realm Coordinator  
City Design, Citywide Planning Division  
[Groundplay Program](#) | [Parklet Program](#) | [Shared Spaces Program](#)

San Francisco Planning Department  
49 South Van Ness Avenue, Suite 1400, San Francisco, CA 94103  
Direct: 628.652.7453 | [sfplanning.org](http://sfplanning.org)  
San Francisco Property Information Map

Due to COVID-19, San Francisco Planning is not providing any in-person services, but we are operating remotely. Our staff are available [by e-mail](#), and the Planning and Historic Preservation Commissions are convening remotely. The public is [encouraged to participate](#). Find more information on our services [here](#).

---

**From:** Folks, Tom <[Tom.Folks@sfmta.com](mailto:Tom.Folks@sfmta.com)>  
**Sent:** Tuesday, May 19, 2020 4:44 PM  
**To:** Disbrow, Anastastia (DPW) <[Anastastia.Disbrow@sfdpw.org](mailto:Anastastia.Disbrow@sfdpw.org)>; Sheeter, Daniel (MTA) <[Daniel.Sheeter@sfmta.com](mailto:Daniel.Sheeter@sfmta.com)>; De Alva, María (CPC) <[maria.dealva@sfgov.org](mailto:maria.dealva@sfgov.org)>; Olea, Ricardo (MTA) <[Ricardo.Olea@sfmta.com](mailto:Ricardo.Olea@sfmta.com)>; Parks, Jamie (MTA) <[Jamie.Parks@sfmta.com](mailto:Jamie.Parks@sfmta.com)>  
**Cc:** Woo, Michelle (DPW) <[Michelle.Woo@sfdpw.org](mailto:Michelle.Woo@sfdpw.org)>  
**Subject:** RE: Traffic circulation reversal process - Treat Plaza

Hi Anya,

We don't want to waste anyone's time with a petition if you're confident that the majority of people on that block are going to support the change.

One of our traffic engineers will do an evaluation about the change to make sure there aren't any other unanticipated problems and also to develop a plan for the changing of the signs and striping. The proposal will then have to go through TASC review, a public hearing, and the SFMTA Board for final approval. The timeline would be something on the order of three to four months.

**Thomas Folks**  
Senior Engineer  
Sustainable Streets Division



Office 415.701.4688

San Francisco Municipal Transportation Agency  
1 South Van Ness Avenue, 7th floor  
San Francisco, CA 94103



---

**From:** Disbrow, Anastastia (DPW) <[Anastastia.Disbrow@sfdpw.org](mailto:Anastastia.Disbrow@sfdpw.org)>  
**Sent:** Tuesday, May 19, 2020 4:33 PM  
**To:** Folks, Tom <[Tom.Folks@sfmta.com](mailto:Tom.Folks@sfmta.com)>; Sheeter, Daniel <[Daniel.Sheeter@sfmta.com](mailto:Daniel.Sheeter@sfmta.com)>; De Alva, María (CPC) <[maria.dealva@sfgov.org](mailto:maria.dealva@sfgov.org)>; Olea, Ricardo <[Ricardo.Olea@sfmta.com](mailto:Ricardo.Olea@sfmta.com)>; Parks, Jamie <[Jamie.Parks@sfmta.com](mailto:Jamie.Parks@sfmta.com)>  
**Cc:** Woo, Michelle (DPW) <[Michelle.Woo@sfdpw.org](mailto:Michelle.Woo@sfdpw.org)>  
**Subject:** RE: Traffic circulation reversal process - Treat Plaza

EXT

Hi Thomas,

Yes, I'm confident that a majority of the stakeholders would support his decision. Of all the requests from the community this was one they were most vocal about.

I'm not familiar with the legislation process- Would PW PM staff be responsible for collecting signatures for the petition? Would a separate community meeting need to be held to discuss this change?

If you can share a little bit on next steps that would be great.

Thanks for your help,  
Anya



**Anastastia Disbrow**  
Assistant Project Manager

Project Management & Construction | San Francisco Public Works | City and County of San Francisco  
30 Van Ness Avenue, 5th Floor | San Francisco, CA 94102 | (415) 558-4005 | [sfpublicworks.org](http://sfpublicworks.org)

[twitter.com/sfpublicworks](https://twitter.com/sfpublicworks)

*I am moving June 19, 2020! My new number will be: (628) 271-2477.  
My current number will cease working on the above date.*

---

**From:** Folks, Tom <[Tom.Folks@sfmta.com](mailto:Tom.Folks@sfmta.com)>  
**Sent:** Tuesday, May 19, 2020 3:50 PM  
**To:** Disbrow, Anastastia (DPW) <[Anastastia.Disbrow@sfdpw.org](mailto:Anastastia.Disbrow@sfdpw.org)>; Sheeter, Daniel (MTA) <[Daniel.Sheeter@sfmta.com](mailto:Daniel.Sheeter@sfmta.com)>; De Alva, María (CPC) <[maria.dealva@sfgov.org](mailto:maria.dealva@sfgov.org)>; Olea, Ricardo (MTA) <[Ricardo.Olea@sfmta.com](mailto:Ricardo.Olea@sfmta.com)>; Parks, Jamie (MTA) <[Jamie.Parks@sfmta.com](mailto:Jamie.Parks@sfmta.com)>  
**Cc:** Woo, Michelle (DPW) <[Michelle.Woo@sfdpw.org](mailto:Michelle.Woo@sfdpw.org)>  
**Subject:** RE: Traffic circulation reversal process - Treat Plaza

Hi Anya,

Normally we want to see a petition signed by at least 50% of the adjacent businesses and residents. Are you confident that the one-way reversal is supported by the majority of the stakeholders on the street itself? When we have the public hearing and the SFMTA Board processes the legislation, we like to have some background information to explain why the change is being recommended, especially to any stakeholders who may not have participated in any of the previous public meetings.

**Thomas Folks**  
Senior Engineer  
Sustainable Streets Division



Office 415.701.4688

San Francisco Municipal Transportation Agency  
1 South Van Ness Avenue, 7th floor  
San Francisco, CA 94103



---

**From:** Disbrow, Anastastia (DPW) <[Anastastia.Disbrow@sfdpw.org](mailto:Anastastia.Disbrow@sfdpw.org)>  
**Sent:** Tuesday, May 19, 2020 3:37 PM  
**To:** Sheeter, Daniel <[Daniel.Sheeter@sfmta.com](mailto:Daniel.Sheeter@sfmta.com)>; De Alva, María (CPC) <[maria.dealva@sfgov.org](mailto:maria.dealva@sfgov.org)>; Olea, Ricardo <[Ricardo.Olea@sfmta.com](mailto:Ricardo.Olea@sfmta.com)>; Parks, Jamie <[Jamie.Parks@sfmta.com](mailto:Jamie.Parks@sfmta.com)>  
**Cc:** Folks, Tom <[Tom.Folks@sfmta.com](mailto:Tom.Folks@sfmta.com)>; Woo, Michelle (DPW) <[Michelle.Woo@sfdpw.org](mailto:Michelle.Woo@sfdpw.org)>  
**Subject:** RE: Traffic circulation reversal process - Treat Plaza

EXT

Hi Daniel,

What type of documentation would you need?

The project has held many community outreach meetings over the years and all that attended were in support of the traffic change. I can share meeting minutes to support this proposal.

Thank you,  
Anya



**Anastastia Disbrow**  
Assistant Project Manager

Project Management & Construction | San Francisco Public Works | City and County of San Francisco  
30 Van Ness Avenue, 5th Floor | San Francisco, CA 94102 | (415) 558-4005 | [sfpublicworks.org](http://sfpublicworks.org)

[twitter.com/sfpublicworks](https://twitter.com/sfpublicworks)

*I am moving June 19, 2020! My new number will be: (628) 271-2477.  
My current number will cease working on the above date.*

---

**From:** Sheeter, Daniel <[Daniel.Sheeter@sfmta.com](mailto:Daniel.Sheeter@sfmta.com)>

**Sent:** Monday, May 18, 2020 10:19 AM

**To:** De Alva, María (CPC) <[maria.dealva@sfgov.org](mailto:maria.dealva@sfgov.org)>; Olea, Ricardo (MTA) <[Ricardo.Olea@sfmta.com](mailto:Ricardo.Olea@sfmta.com)>; Parks, Jamie (MTA) <[Jamie.Parks@sfmta.com](mailto:Jamie.Parks@sfmta.com)>

**Cc:** Disbrow, Anastasia (DPW) <[Anastastia.Disbrow@sfdpw.org](mailto:Anastastia.Disbrow@sfdpw.org)>; Folks, Tom (MTA) <[Tom.Folks@sfmta.com](mailto:Tom.Folks@sfmta.com)>; Woo, Michelle (DPW) <[Michelle.Woo@sfdpw.org](mailto:Michelle.Woo@sfdpw.org)>

**Subject:** RE: Traffic circulation reversal process - Treat Plaza

Adding Michelle to the thread.

---

**From:** Sheeter, Daniel

**Sent:** Thursday, May 14, 2020 3:12 PM

**To:** De Alva, María (CPC) <[maria.dealva@sfgov.org](mailto:maria.dealva@sfgov.org)>; Olea, Ricardo <[Ricardo.Olea@sfmta.com](mailto:Ricardo.Olea@sfmta.com)>; Parks, Jamie <[Jamie.Parks@sfmta.com](mailto:Jamie.Parks@sfmta.com)>

**Cc:** Disbrow, Anastasia (DPW) <[Anastastia.Disbrow@sfdpw.org](mailto:Anastastia.Disbrow@sfdpw.org)>; Folks, Tom <[Tom.Folks@sfmta.com](mailto:Tom.Folks@sfmta.com)>

**Subject:** RE: Traffic circulation reversal process - Treat Plaza

Hi Maria,

Is there documentation of the community process and support for the proposal? We typically ask for at least 50% support by the adjacent frontages on the block before legislating a circulation change.

Thanks,  
Daniel

---

**From:** De Alva, María (CPC) <[maria.dealva@sfgov.org](mailto:maria.dealva@sfgov.org)>

**Sent:** Thursday, April 23, 2020 12:10 PM

**To:** Sheeter, Daniel <[Daniel.Sheeter@sfmta.com](mailto:Daniel.Sheeter@sfmta.com)>; Shahamiri, James <[James.Shahamiri@sfmta.com](mailto:James.Shahamiri@sfmta.com)>; Olea, Ricardo <[Ricardo.Olea@sfmta.com](mailto:Ricardo.Olea@sfmta.com)>; Parks, Jamie <[Jamie.Parks@sfmta.com](mailto:Jamie.Parks@sfmta.com)>

**Cc:** Disbrow, Anastasia (DPW) <[Anastastia.Disbrow@sfdpw.org](mailto:Anastastia.Disbrow@sfdpw.org)>

**Subject:** Re: Traffic circulation reversal process - Treat Plaza

Hi everyone,

I hope you're all doing well during these times. I wanted to follow up on this email from a while back. Who would be the right contact at SFMTA to work with on the traffic circulation reversal for Treat Ave? See email thread for background.

Thanks again and take care.

Best,  
María De Alva

City Design, Citywide Planning Division  
[Groundplay Program](#) | [Parklet Program](#)  
San Francisco Planning Department  
1650 Mission Street, Suite 400 San Francisco, CA 94103  
Direct: 415.575.8729 | [www.sfplanning.org](http://www.sfplanning.org)  
San Francisco Property Information Map

The Planning Department is open for business during the Shelter in Place Order. Most of our staff are working from home and we're [available by e-mail](#). Our [Public Portal](#), where you can file new applications, and our [Property Information Map](#) are available 24/7. The Planning Commission is convening remotely and [the public is encouraged to participate](#). The Board of Appeals and Board of Supervisors are [accepting appeals](#) via e-mail despite office closures. All of our in-person services at 1650 and 1660 Mission Street are suspended until further notice. [Click here for more information](#).

---

**From:** "Sheeter, Daniel" <[Daniel.Sheeter@sfmta.com](mailto:Daniel.Sheeter@sfmta.com)>  
**Date:** Monday, February 24, 2020 at 1:35 PM  
**To:** "Shahamiri, James (MTA)" <[James.Shahamiri@sfmta.com](mailto:James.Shahamiri@sfmta.com)>, "Olea, Ricardo (MTA)" <[Ricardo.Olea@sfmta.com](mailto:Ricardo.Olea@sfmta.com)>, "Parks, Jamie (MTA)" <[Jamie.Parks@sfmta.com](mailto:Jamie.Parks@sfmta.com)>  
**Cc:** "De Alva, María (CPC)" <[maria.dealva@sfgov.org](mailto:maria.dealva@sfgov.org)>  
**Subject:** Re: Traffic circulation reversal process - Treat Plaza

This message is from outside the City email system. Do not open links or attachments from untrusted sources.

Sorry, Maria De Alva, Planning Dept project manager, is now copied.

Thanks,  
Daniel

---

**From:** Sheeter, Daniel  
**Sent:** Thursday, February 20, 2020 3:14 PM  
**To:** Shahamiri, James <[James.Shahamiri@sfmta.com](mailto:James.Shahamiri@sfmta.com)>; Olea, Ricardo <[Ricardo.Olea@sfmta.com](mailto:Ricardo.Olea@sfmta.com)>; Parks, Jamie <[Jamie.Parks@sfmta.com](mailto:Jamie.Parks@sfmta.com)>  
**Cc:** Maria Vyas <[m.vyas@fehrandpeers.com](mailto:m.vyas@fehrandpeers.com)>  
**Subject:** FW: Traffic circulation reversal process - Treat Plaza

Hi All,

Planning Dept reached out to me to initiate converting Treat Ave between 16<sup>th</sup> and 17<sup>th</sup> to one-way northbound in coordination with the Treat Plaza project. Cathal was the lead on this a few years back. Was there SSD involvement then? Planning/Public Works are hoping to have someone from MTA assigned to help finalize the curb geometry and take the circulation change through legislation.

The project manager María Vyas is copied.

Thanks,  
Daniel

---

**From:** De Alva, María (CPC) <[maria.dealva@sfgov.org](mailto:maria.dealva@sfgov.org)>  
**Sent:** Wednesday, February 19, 2020 6:13 PM  
**To:** Sheeter, Daniel <[Daniel.Sheeter@sfmta.com](mailto:Daniel.Sheeter@sfmta.com)>  
**Subject:** Traffic circulation reversal process - Treat Plaza

Hi Daniel,

I was hoping you could point me in the right direction. A few years back we were working with Cathal Hennesy on the 16<sup>th</sup> St project, but focusing on a proposal for a plaza at Treat Ave and 16<sup>th</sup>.



One of the outcomes of that community process was that there was a strong desire from the community to reverse traffic circulation on Treat Ave for the block of 16<sup>th</sup> to 17<sup>th</sup> Streets, due to the dangerous ped and bike conflict that the current circulation disposes. We had begun the process back then but the project was halted.

Now Public Works has allocated funding to implement the plaza, and that includes formalizing the pedestrian crossing too. **Would you be able to connect me to someone at MTA that could help us and the community initiate this process?**

Public Works and Planning can assist with schematics and run any turn templates as needed, we would just need someone at MTA to review and guide us through the process.

I appreciate your help! I'm attaching some documents for context.

Best,  
**María De Alva**  
City Design, Citywide Planning Division

[Groundplay Program](#) | [Parklet Program](#)

San Francisco Planning Department  
1650 Mission Street, Suite 400 San Francisco, CA 94103  
Direct: 415.575.8729 | [www.sfplanning.org](http://www.sfplanning.org)  
[San Francisco Property Information Map](#)

This message is from outside of the SFMTA email system. Please review the email carefully before responding, clicking links, or opening attachments.

This message is from outside of the SFMTA email system. Please review the email carefully before responding, clicking links, or opening attachments.

This message is from outside of the SFMTA email system. Please review the email carefully before responding, clicking links, or opening attachments.

T:\T\_E\_FILES\Operations\PERSONNEL\AChun\1\_Request Logs\Logs\20-1579 - Treat Ave @ 16th St & 17th St\1\_Autoturn\T-2\_AC\_fixed dimensions.dwg oahun Tue Jun 22, 2021 - 2:38 pm

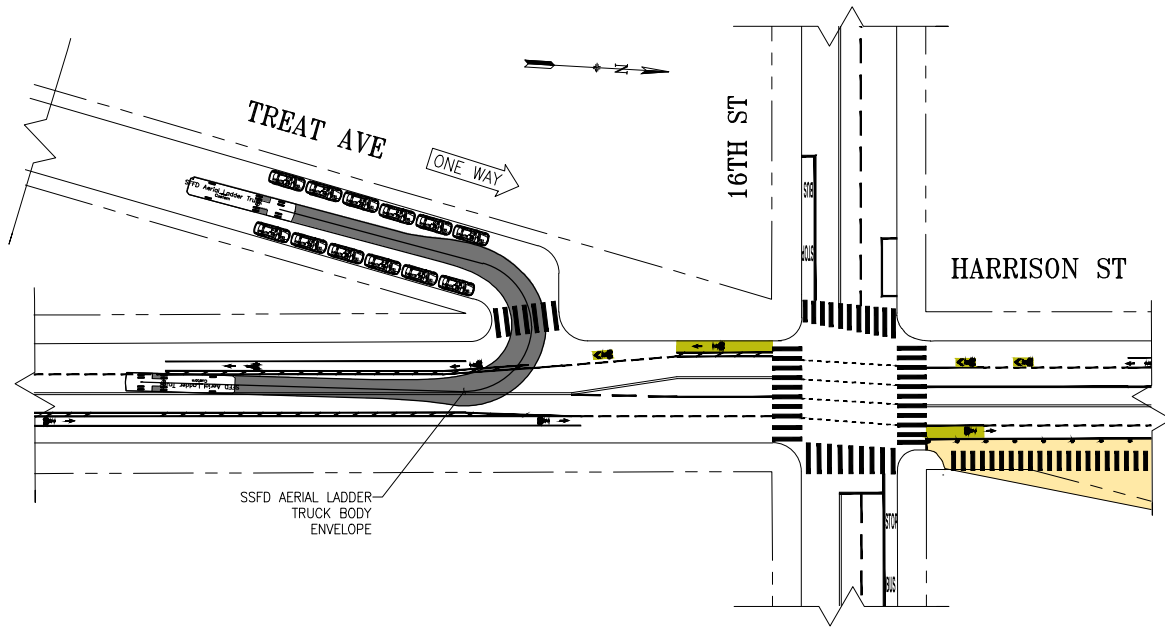

**PROPOSED:**  
NB TREAT AVE TO SB HARRISON  
ST WITH AERIAL LADDER TRUCK

DETAIL SCALE 1

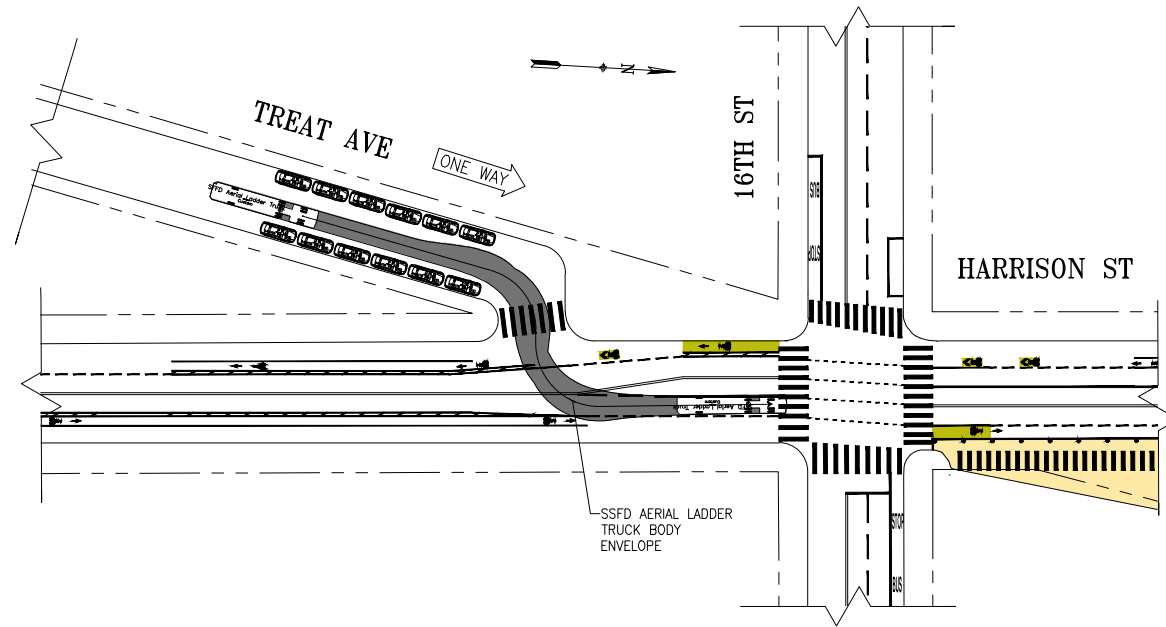

**PROPOSED:**  
NB TREAT AVE TO NB HARRISON  
ST WITH AERIAL LADDER TRUCK

DETAIL SCALE 3

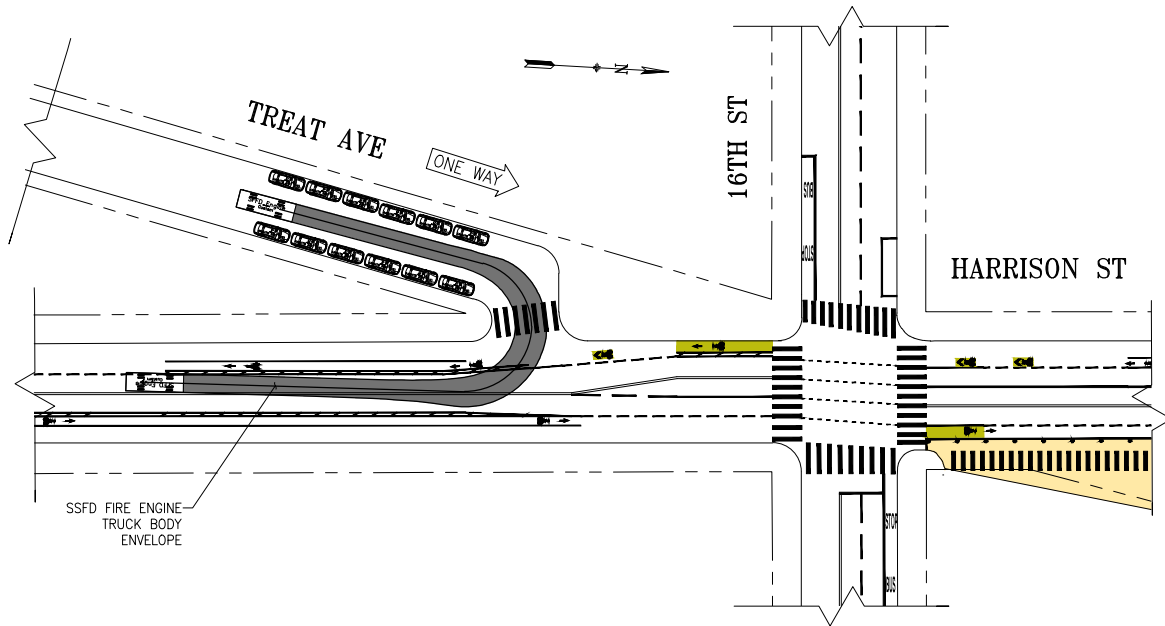

**PROPOSED:**  
NB TREAT AVE TO SB HARRISON  
ST WITH ENGINE TRUCK

DETAIL SCALE 2

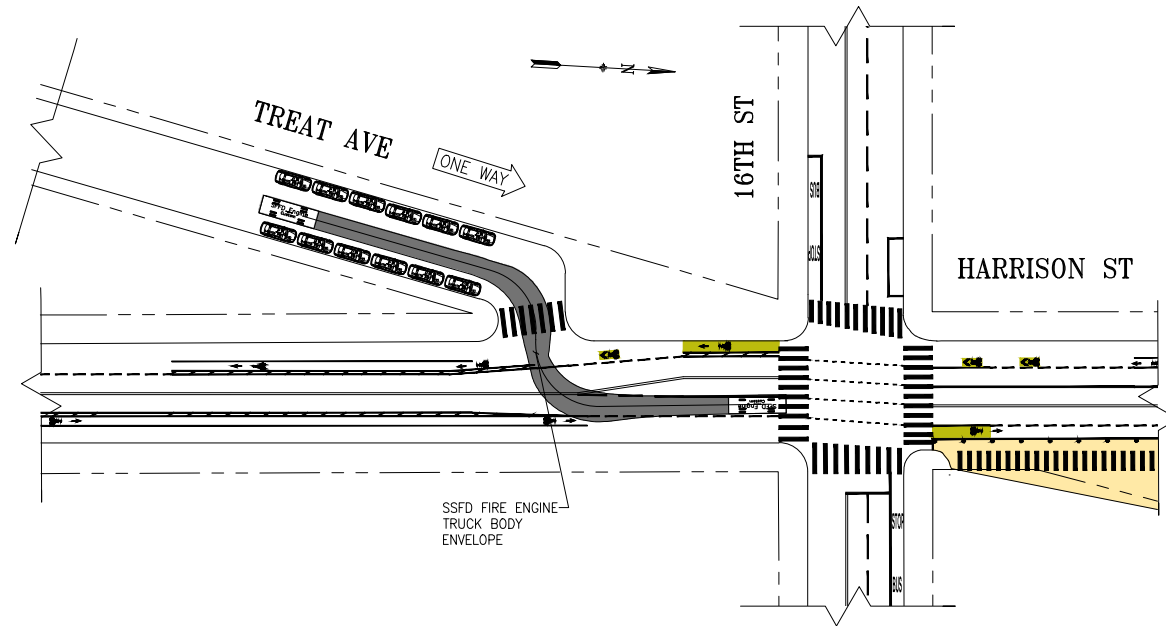

**PROPOSED:**  
NB TREAT AVE TO SB HARRISON  
ST WITH ENGINE TRUCK

DETAIL SCALE 4

NOT FOR CONSTRUCTION  
FOR ILLUSTRATION PURPOSES  
ONLY

NO.	DATE	DESCRIPTION	BY	APP
TABLE OF REVISIONS				
CHECK WITH TRACING TO SEE IF YOU HAVE LATEST REVISION				



DRAWN: A. CHUN	DATE: 06/11/21
CHECKED:	DATE:

APPROVED	SCALE: 1" = 50'
SENIOR ENGINEER	SHEET/SHEETS:
CITY TRAFFIC ENGINEER	

TREAT PLAZA IMPROVEMENTS

CONTRACT NO.
DRAWING NO.
FILE NO.
REV. NO.

FILE NAME:  
DATE:

# TransBASE Internal Dashboard

Geographic Extent: TREAT AVE from 16TH ST/HARRISON ST to 17TH ST (0.21 miles/1090.71 feet)

Spatial Intersect: No Restriction (SFMTA 20ft/150ft Buffer)

Data Range: 04/01/2015 to 03/31/2021

Pull Date: 6/11/2021

## Geographic Extent



# TransBASE Internal Dashboard

Geographic Extent: TREAT AVE from 16TH ST/HARRISON ST to 17TH ST (0.21 miles/1090.71 feet)

Spatial Intersect: No Restriction (SFMTA 20ft/150ft Buffer)

Data Range: 04/01/2015 to 03/31/2021

Pull Date: 6/11/2021

## Collision/Party/Victim Table

Showing 1 to 19 of 19 entries

Count of Fatal Collisions: 1

Count of Non-Fatal Injury Collisions: 18

Total Count of Fatal/Non-Fatal Injury Collisions: 19

Case ID	Collision Date	Collision Time	Day of Week	Primary Road	Secondary Road	Distance	Direction	Party 1 Type	Party 1 Direction of Travel	Party 1 Movement Preceding Crash	Party 2 Type	Party 2 Direction of Travel	Party 2 Movement Preceding Crash	Vehicle Code Violation	Highest Degree of Injury	Type of Collision	Motor Vehicle Involved With	Weather	Lighting
200355297	06/12/2020	18:25	Friday	16TH ST	HARRISON ST	0	Not Stated	Bicyclist	South	Proceeding Straight	Driver	West	Proceeding Straight	CVC 21453(a)	Injury (Severe)	Broadside	Bicycle	Clear	Daylight
200220888	04/03/2020	07:06	Friday	HARRISON ST	16TH ST	0	Not Stated	Bicyclist	West	Making Left Turn	Driver	West	Making Right Turn	CVC 21800(a)	Injury (Other Visible)	Head-On	Bicycle	Clear	Daylight
200015275	01/06/2020	21:49	Monday	HARRISON ST	16TH ST	0	Not Stated	Driver	North	Slowing/Stopping	Bicyclist	East	Proceeding Straight	CVC Unknown	Injury (Complaint of Pain)	Sideswipe	Bicycle	Clear	Dark - Street Lights
190431868	06/15/2019	21:39	Saturday	HARRISON ST	16TH ST	34	North	Driver	South	Proceeding Straight	Driver	South	Stopped	CVC 22350	Injury (Severe)	Rear End	Other Motor Vehicle	Clear	Dark - Street Lights
180881176	11/20/2018	14:05	Tuesday	16TH ST	HARRISON ST	0	Not Stated	Driver	West	Proceeding Straight	Driver	West	Stopped In Road	CVC 21703	Injury (Complaint of Pain)	Rear End	Other Motor Vehicle	Clear	Daylight
180090872	02/03/2018	10:30	Saturday	HARRISON ST	16TH ST	0	Not Stated	Driver	South	Making Left Turn	Bicyclist	North	Proceeding Straight	CVC 21801(a)	Injury (Complaint of Pain)	Broadside	Bicycle	Clear	Daylight
170961813	11/27/2017	10:35	Monday	16TH ST	HARRISON ST	0	Not Stated	Driver	South	Making Left Turn	Bicyclist	North	Proceeding Straight	CVC 21801(a)	Injury (Complaint of Pain)	Broadside	Bicycle	Clear	Daylight
170914533	11/09/2017	11:08	Thursday	HARRISON ST	16TH ST	10	West	Driver	North	Proceeding Straight	Driver	South	Making Left Turn	CVC 21804(a)	Injury (Complaint of Pain)	Broadside	Other Motor Vehicle	Clear	Daylight
170034341	01/13/2017	15:20	Friday	17TH ST	TREAT AVE	0	Not Stated	Driver	South	Making Left Turn	Driver	South	Making Left Turn	CVC 21750	Injury (Complaint of Pain)	Rear End	Other Motor Vehicle	Clear	Daylight
160880063	10/29/2016	01:37	Saturday	16TH ST	HARRISON ST	0	Not Stated	Driver	West	Ran Off Road				CVC 22350	Injury (Severe)	Hit Object	Fixed Object	Other	Dark - Street Lights
160836254	10/13/2016	19:05	Thursday	HARRISON ST	16TH ST	133	South	Driver	North	Proceeding Straight	Driver	North	Slowing/Stopping	CVC 21703	Injury (Complaint of Pain)	Rear End	Other Motor Vehicle	Clear	Dark - Street Lights
160570195	07/12/2016	18:45	Tuesday	HARRISON ST	16TH ST	5	North	Driver	South	Making Right Turn	Bicyclist	South	Proceeding Straight	CVC 22107	Injury (Other Visible)	Sideswipe	Bicycle	Clear	Daylight
160413852	05/20/2016	00:01	Friday	16TH ST	HARRISON ST	0	Not Stated	Driver	West	Proceeding Straight				CVC Unknown	Fatal	Head-On	Other Motor Vehicle	Clear	Daylight

# TransBASE Internal Dashboard

Geographic Extent: TREAT AVE from 16TH ST/HARRISON ST to 17TH ST (0.21 miles/1090.71 feet)

Spatial Intersect: No Restriction (SFMTA 20ft/150ft Buffer)

Data Range: 04/01/2015 to 03/31/2021

Pull Date: 6/11/2021

Case ID	Collision Date	Collision Time	Day of Week	Primary Road	Secondary Road	Distance	Direction	Party 1 Type	Party 1 Direction of Travel	Party 1 Movement Preceding Crash	Party 2 Type	Party 2 Direction of Travel	Party 2 Movement Preceding Crash	Vehicle Code Violation	Highest Degree of Injury	Type of Collision	Motor Vehicle Involved With	Weather	Lighting
160093012	02/01/2016	11:08	Monday	16TH ST	HARRISON ST	0	Not Stated	Driver	East	Making Left Turn	Pedestrian	North	Traveling Wrong Way	CVC 21950(a)	Injury (Complaint of Pain)	Vehicle/ Pedestrian	Pedestrian	Clear	Daylight
151120337	12/29/2015	15:33	Tuesday	17TH ST	TREAT AVE	0	Not Stated	Driver	South	Stopped In Road	Driver	East	Proceeding Straight	CVC 21802(a)	Injury (Complaint of Pain)	Broadside	Other Motor Vehicle	Clear	Daylight
151088224	12/17/2015	13:39	Thursday	TREAT AVE	17TH ST	0	Not Stated	Driver	South	Proceeding Straight	Driver	East	Proceeding Straight	CVC 21802(a)	Injury (Complaint of Pain)	Broadside	Other Motor Vehicle	Clear	Daylight
150787435	09/08/2015	07:25	Tuesday	17TH ST	TREAT AVE	0	Not Stated	Pedestrian	South	Proceeding Straight	Driver	East	Proceeding Straight	CVC 21954(a)	Injury (Other Visible)	Vehicle/ Pedestrian	Pedestrian	Clear	Daylight
150750670	08/27/2015	13:05	Thursday	HARRISON ST	16TH ST	0	Not Stated	Driver	North	Making Left Turn	Driver	South	Proceeding Straight	CVC 21801(a)	Injury (Complaint of Pain)	Head-On	Other Motor Vehicle	Clear	Daylight
150723473	08/19/2015	10:08	Wednesday	17TH ST	TREAT AVE	0	Not Stated	Bicyclist	East	Making Left Turn	Driver	East	Proceeding Straight	CVC 22107	Injury (Complaint of Pain)	Sideswipe	Bicycle	Clear	Daylight

AChun

## Notes:

- 200355297: Collision on Harrison St @ 16th St, Vehicle #1 travelling SB against red light and collided with V#2 travelling NB making right turn onto WB 16th
- 200220888: Collision on Harrison St @ 16th St, Vehicle #1 (bike) travelling NB collided with V#2 travelling SB making right turn on WB 16th
- 200015275: Collision on Harrison St @ 16th St, Vehicle #1 travelling NB collided with bicycle #1 travelling NB, both stopped at stop light
- 190431868: Collision on Harrison @ 16th St, Motorcycle #1 travelling SB on Harrison St made contact with rear-end of Vehicle #1 at stop light
- 180881176: Collision on 16th St @ Harrison St, Vehicle #2 stopped at WB stoplight was rear-ended by Vehicle #1
- 180090872: Collision on Harrison St and 16th St, Vehicle #1 on SB Harrison making left-turn onto EB 16th St struck bicyclist #1 heading NB in east-side x-walk
- 170961813: Collision on Harrison St and 16th St, Vehicle #1 on SB Harrison making left-turn onto EB 16th St struck bicyclist #1 heading NB in east-side x-walk
- 170914533: Collision on 16th St @ Harrison St, Vehicle#1 on SB Harrison St attempting to make left turn onto EB 16th Street was struck by Vehicle #2 heading NB on Harrison St
- 170034341: Collision on 17th St @ **Treat Ave**, Vehicle #1 SB on Treat St, in attempt to head WB on 17th St contacted Vehicle #2 also heading WB
- 160880063: Collision on 16th St @ Harrison St, Vehicle#1 drove into bus shelter, light pole, hydrant, Muni stop pole and signal light
- 160836254: Collision on Harrison St @ 16th St, Vehicle #1 rear ended Vehicle #2 which then rear ended Vehicle #3'
- 160570195: Collision on Harrison St @ 16th St, Vehicle #1 and bicycle #1 both facing SB, Vehicle #1 heading WB on 16th St contacted Bicyclist #1 heading SB
- 160413852: Collision on 16th St @ Harrison St, Vehicle #1 EB on 16th St attempting to make left turn onto NB Harrison St was struck by Motorbike #1 heading WB on 16th St
- 160093012: Collision on 16th St @ Harrison St, Vehicle facing SB making left tun onto EB 16th St struck pedestrian heading NB in east x-walk
- 151120337: Collision on 17th St @ **Treat Ave**, Vehicle #1 SB on Treat St, in attempt to head EB on 17th St contacted Vehicle #2 also heading EB
- 151088224: Collision on 17th St @ **Treat Ave**, Vehicle #1 SB on Treat St, in attempt to head EB on 17th St contacted Vehicle #2 also heading EB
- 150787435: Collision on 17th St @ **Treat Ave**, Pedestrian on Scooter heading SB on west side of intersection (not in xwalk) was contacted by Vehicle #2 heading EB on 17th St
- 150750670: Collision on 16th St @ Harrison St, Vehicle #1 heading NB making left turn onto WB 16th St contacted Motorcycle heading SB on Harrison St
- 150723473: Collision on 17th St @ **Treat Ave**, Bicyclist heading EB on 17th St decided to turn left and head NB on Treat Ave, contacted Vehicle heading EB on 17th St

# TransBASE Internal Dashboard

Geographic Extent: TREAT AVE from 16TH ST/HARRISON ST to 17TH ST (0.21 miles/1090.71 feet)

Spatial Intersect: No Restriction (SFMTA 20ft/150ft Buffer)

Data Range: 04/01/2015 to 03/31/2021

Pull Date: 6/11/2021

## Metadata Information

### Collision Filters

Database Source: TransBASESF.org  
Database Pull Date: 6/11/2021  
Collision Level: Injury Collisions  
Boundary: TREAT AVE from 16TH ST/HARRISON ST to 17TH ST  
(0.21 miles/1090.71 feet)  
Collision Dates: 04/01/2015 to 03/31/2021  
Collision Month Filter(s): No Restrictions  
Collision Distance: Any Distance  
Collision Severity Filter(s): No Restrictions  
Primary Collision Factor Filter(s): No Restrictions  
Collision Type Filter(s): No Restrictions  
Intersection/Midblock: No Restriction (SFMTA 20ft/150ft Buffer)

### Party Filters

Party Involved Type: No Restrictions  
Party Involved Gender: No Restrictions  
Party Involved at Fault: No Restrictions  
Party Involved Age: No Restriction  
Party Involved Sobriety: No Restrictions  
Party Involved Condition: No Restrictions  
Party Involved Direction of Travel: No Restrictions  
Party Involved Safety Equipment 1: No Restrictions  
Party Involved Safety Equipment 2: No Restrictions  
Party Involved Insurance: No Restrictions  
Party Involved Other Associated Factors : No Restrictions  
Party Involved Movement Preceding Collision: No Restrictions  
Party Involved Vehicle Type: No Restrictions  
Party Involved Race: No Restrictions  
Party Involved Special Info: No Restrictions

### Victim Filters

Victim Involved Role: No Restrictions  
Victim Involved Degree of Injury: No Restrictions  
Victim Involved Age: No Restriction  
Victim Involved Seating Position: No Restrictions  
Victim Involved Safety Equipment: No Restrictions  
Victim Involved Ejected: No Restrictions

### Environmental Filters

Nearest Traffic Control: No Restriction  
Intersecting Speed Limit: No Restriction  
Intersecting Network: No Restriction  
Intersecting Street Class: No Restriction  
Weather Description: No Restrictions  
Lighting Description: No Restrictions



# TREAT PLAZA

## COMMUNITY MEETING

FEBRUARY 12, 2020

# MEETING GROUND RULES

- Please turn your cell phones to silent.
- Only one speaker at a time. Please raise your hand and we'll call upon you.
- Comments are limited to 1-2 minutes so that everyone has a chance to speak.
- Questions will be taken at the end of our presentation.
- Please don't host "side bar" conversations during the presentation so that you don't disrupt the meeting for other attendees.
- Please respect everyone's ideas.

TREAT PLAZA



# AGENDA

- WELCOME + INTRODUCTION
- PROJECT BACKGROUND
- COMMUNITY OUTREACH PROCESS
- PLAZA DESIGN
- PROJECT UPDATES
- MAINTENANCE & PROGRAMMING

## TREAT PLAZA

# PROJECT BACKGROUND

- OUTREACH PROCESS BY PLANNING, PUBLIC WORKS AND SFMTA
- ORIGINAL PLAN CONSISTED OF TWO PLAZAS
- PUC PROJECT IN DESIGN IN LIMITS OF NORTH PLAZA,  
CONSTRUCTION AS SOON AS SUMMER 2021
- AHSC GRANT FUNDED AWARDED IN 2018
- DETAILED DESIGN IN 2019/2020
- CONSTRUCTION SUMMER 2020

TREAT PLAZA



## PEDESTRIAN SAFETY

- NEW CROSSWALK ACROSS TREAT
- SHORTEN CROSSING DISTANCES ACROSS HARRISON STREET AND TREAT AVE
- NEW PEDESTRIAN LIGHTING

## BICYCLE SAFETY

- EXISTING STRIPING CONFIGURATION TO REMAIN

## VEHICLE SAFETY

- CLEARLY DEFINED TURN INTO TREAT AVE
- PLAZA AND CROSSWALK TO SLOW TURNING CARS

## TREAT PLAZA



# PLAZA DESIGN

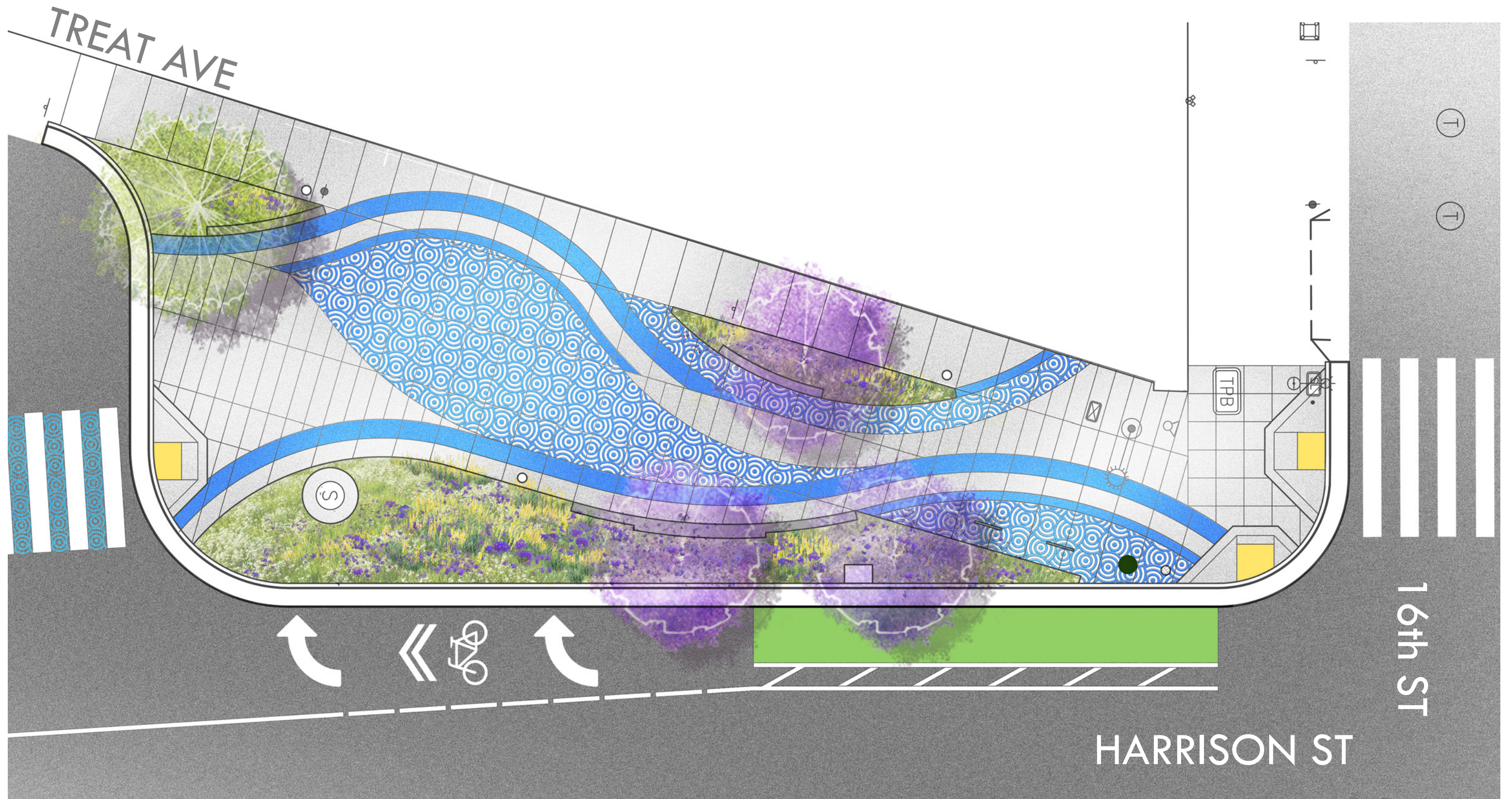

## TREAT PLAZA

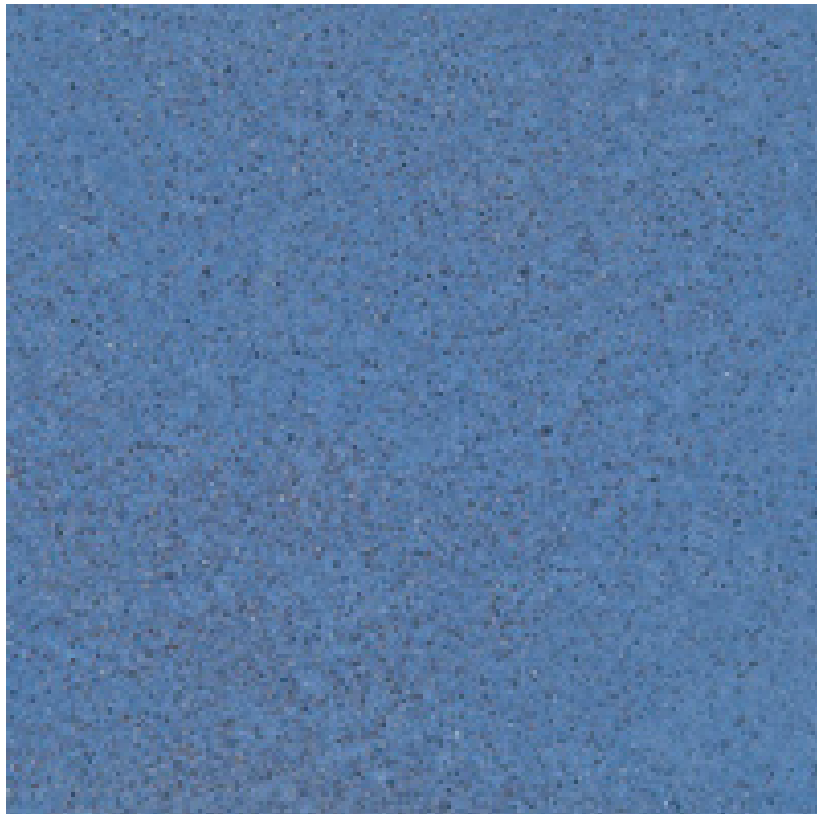

CONCRETE COLOR HARDENER BY EMERCHROME



BIKE RACKS



LIGHTING: HI-GLO BY LANDSCAPE FORMS

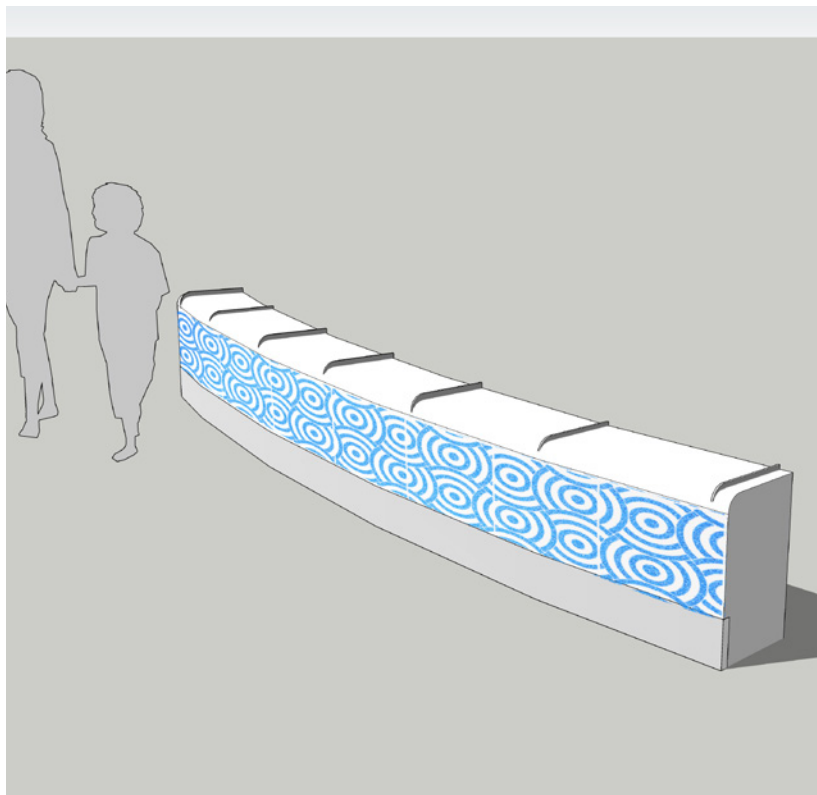

SEATWALLS WITH STAINLESS STEEL ACCENTS AND DECORATIVE PATTERN

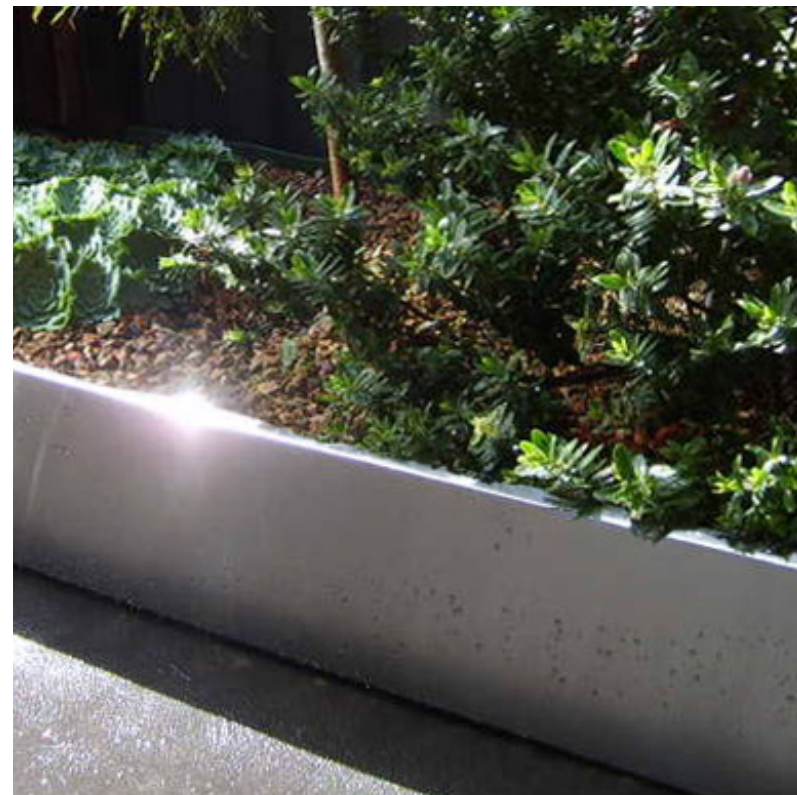

STAINLESS STEEL PLANTER EDGING



WASTE RECEPTACLE

# TREAT PLAZA

# TREES



*Jacaranda mimosifolia*

**Jacaranda**



*Agonis Flexuosa*  
*'Variegata'*

**Variegated  
Peppermint Willow**

# UNDERSTORY



*Hesperaloe parviflora 'Yellow'*  
**Yellow Hesperaloe**



*Limonium perezii*  
**Sea Lavender**



*Sesleria autumnalis*  
**Autumn Moor Grass**



*Lomandra longifolia 'Platinum Beauty'*  
**Lomandra**

# TREAT PLAZA



# TREAT PLAZA



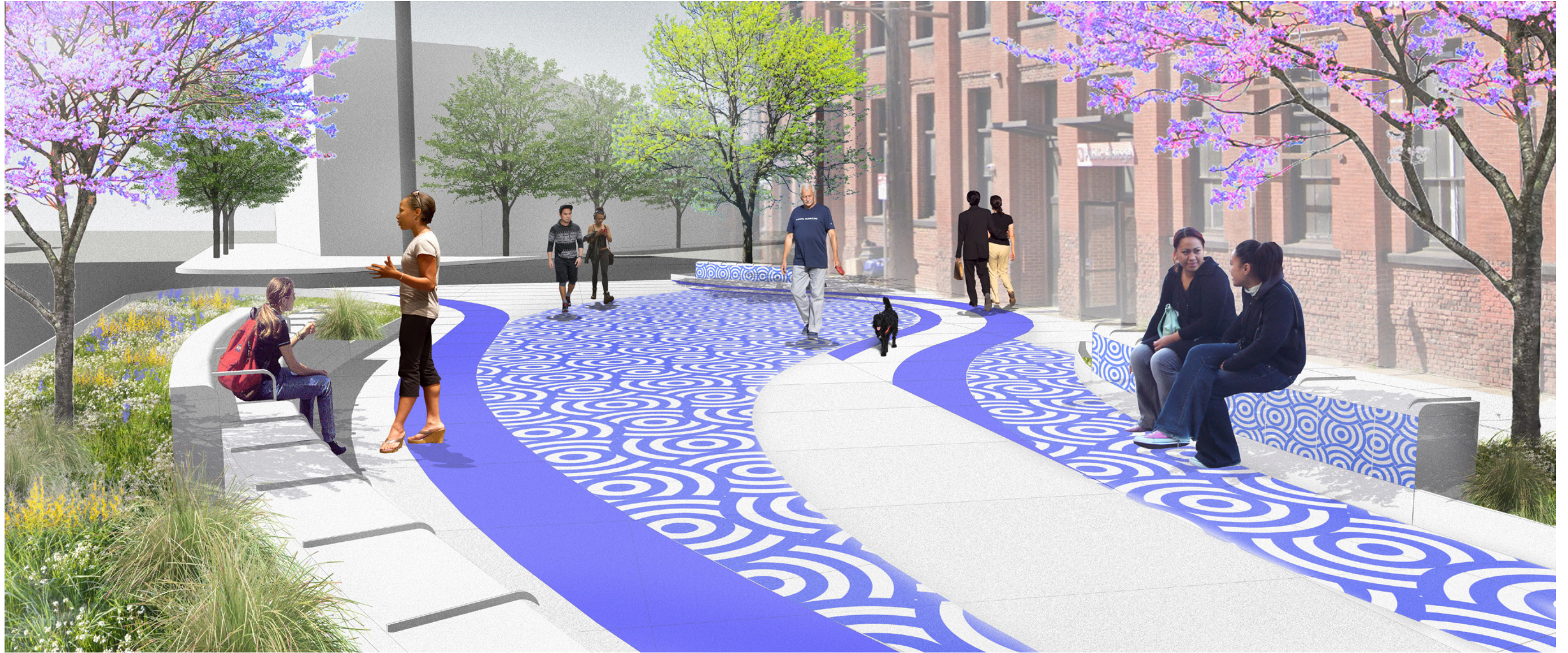

# TREAT PLAZA

# PROJECT UPDATES

- COMPLETION OF CONSTRUCTION DOCUMENTS
- CONSTRUCTION SUMMER 2020,  
ANTICIPATED DURATION: 4 MONTHS

TREAT PLAZA

# MAINTENANCE AND PROGRAMMING

- CONTRACTOR TO MAINTAIN FOR 3 YEARS AFTER CONSTRUCTION
- BUREAU OF URBAN FORESTRY TO MAINTAIN PLANTING
- BUREAU OF STREET ENVIRONMENTAL SERVICE TO PERFORM ROUTINE CLEANING
- PUBLIC USE OF PLAZA, CONTACT BUREAU OF STREET USE AND MAPPING
- REPORT DEBRIS AND AND SCHEDULE PICKUP TIME

<https://sf311.org/services/street-or-sidewalk-cleaning>

TREAT PLAZA

# CONTACT

Erika Heineken, Project Manager  
San Francisco Public Works  
[erika.heineken@sfdpw.org](mailto:erika.heineken@sfdpw.org)

John Dennis, Landscape Architect  
San Francisco Public Works  
[john.dennis@sfdpw.org](mailto:john.dennis@sfdpw.org)

Maria De Alva  
San Francisco Planning Department  
[maria.dealva@sfgov.org](mailto:maria.dealva@sfgov.org)

TREAT PLAZA

THANK YOU!

QUESTIONS & COMMENTS

TREAT PLAZA

# TRAFFIC REFERSAL PROPOSAL - TREAT AVE (BETWEEN 16TH & 17TH)

DRAFT 03/02/2017

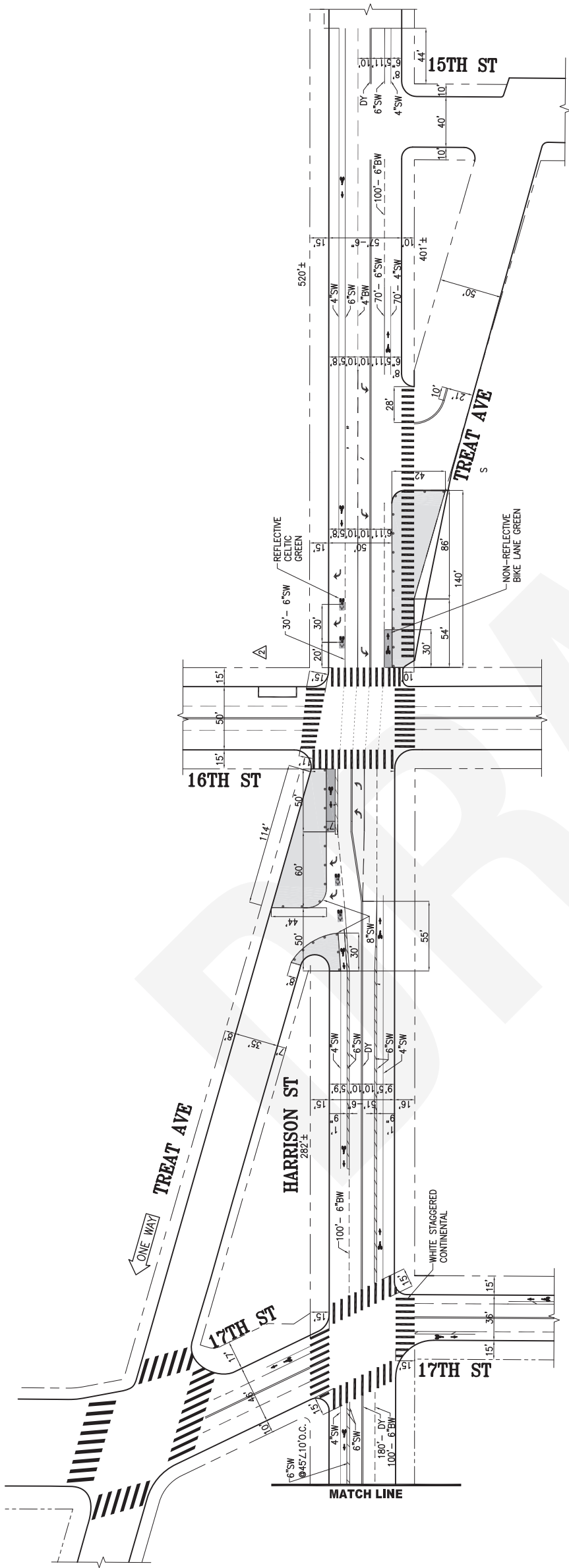

EXISTING

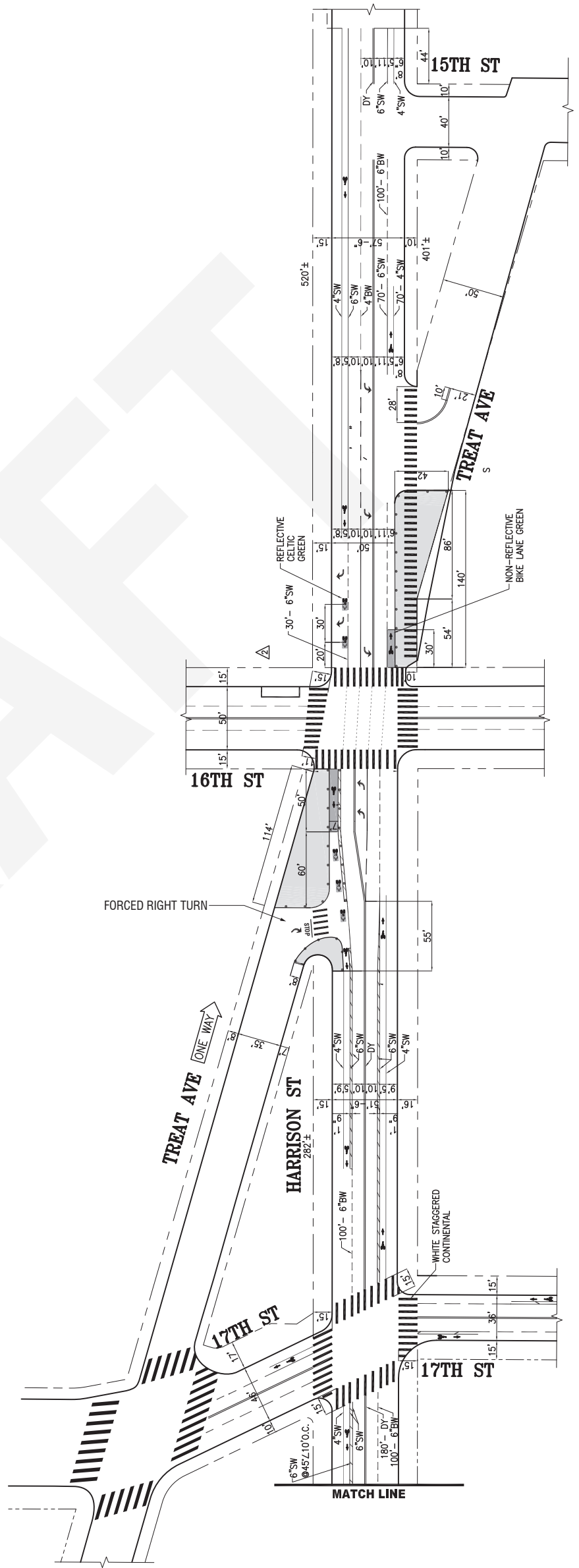

PROPOSED

03.06.2017

SCALE: 1" = 50'

EXISTING : PROPOSED 1/2

TREAT AVENUE TEMPORARY PLAZA  
 (Treat Avenue, 16th St & Harrison St intersection)  
 TRAFFIC REVERSAL PROPOSAL  
 (Not a traffic striping diagram)

María De Alva - Project Manager

Maria.DeAlva@sfgov.org

415.575.8729



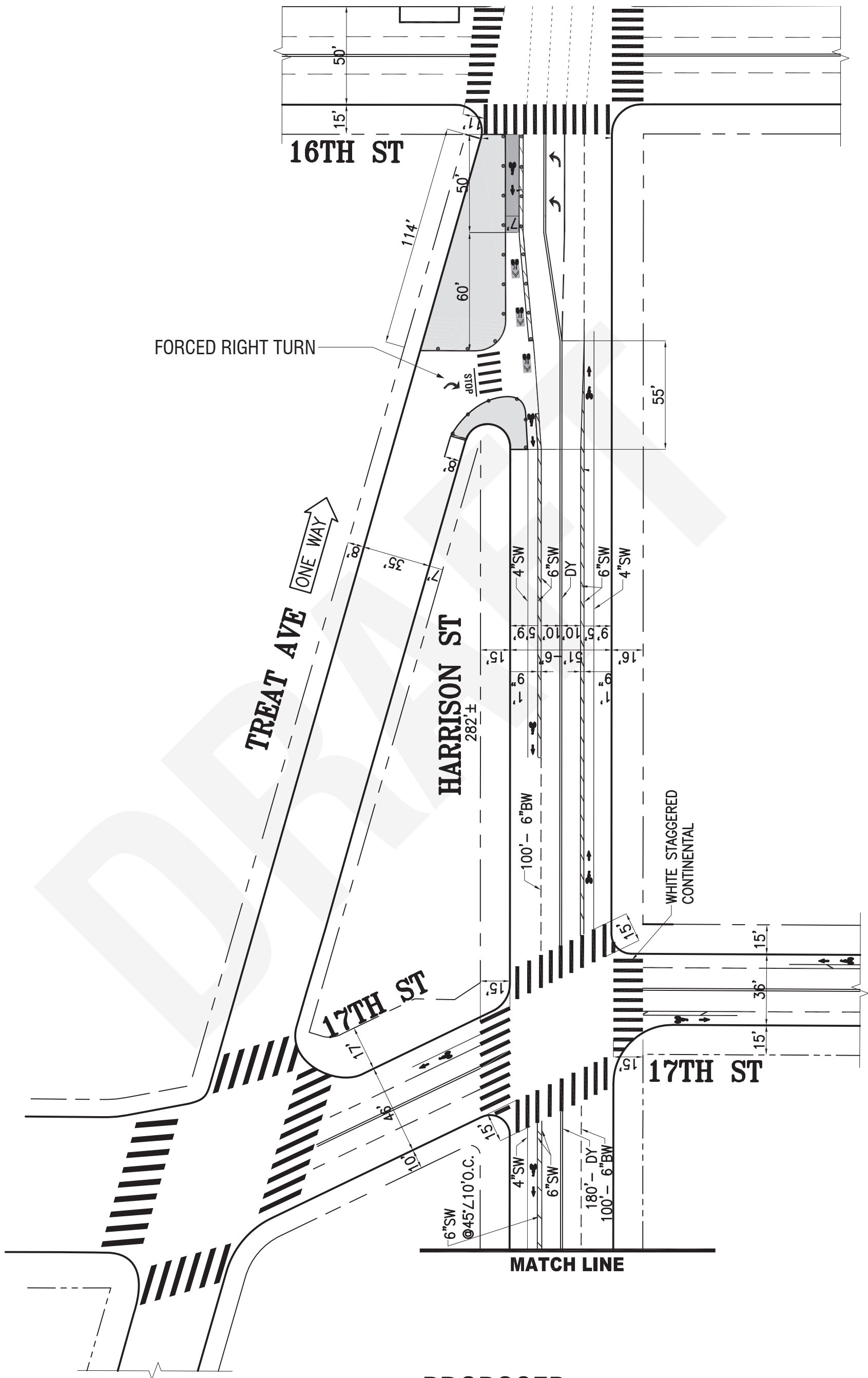

**PROPOSED**

03.06.2017

DETAIL 2/2

TREAT AVENUE TEMPORARY PLAZA  
 (Treat Avenue, 16th St & Harrison St intersection)  
 TRAFFIC REVERSAL PROPOSAL  
 (Not a traffic striping diagram)

María De Alva - Project Manager

Maria.DeAlva@sfgov.org

415.575.8729



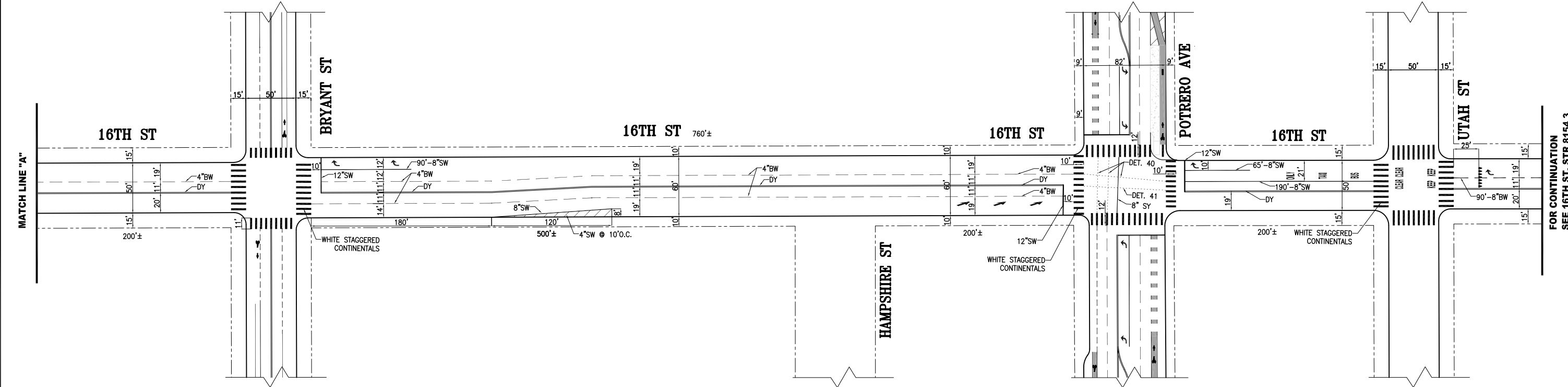
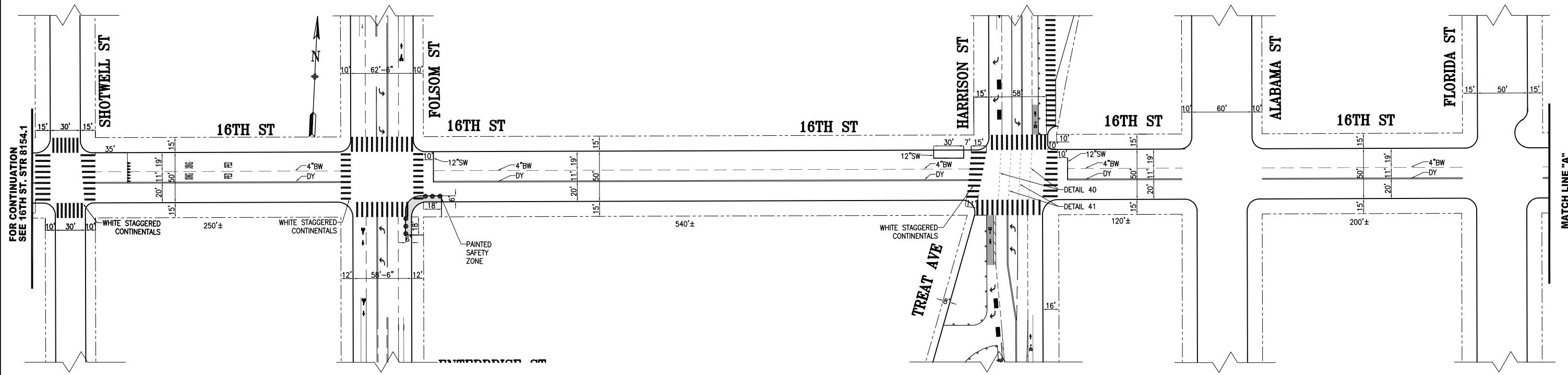

NO.	DATE	DESCRIPTION	BY	APP
6	03/01/18	UPDATED POTRERO LANES	H. YU	M. VELASCO
5	05/07/18	ADDED KEEP CLEAR PAVEMENT MARKINGS @ UTAH FOR WB DIRECTION	E. OROZCO	M. VELASCO
4	02/15/18	ADDED WBRT POCKET, GUIDELINES, & BUS TAXI RT ONLY @ POTRERO	K. SHUE	M. VELASCO
3	XX/XX/17	BIKE LANE INSTALLATION @ BRYANT ST	J. WONG	W. TABAJONDA
2	03/24/17	SHIFTED LANE LINES & ADDED ADVANCE LIMIT LINES	D. ALABA	M. VELASCO
1	12/15/16	ADDED BIKE CORRAL ON 16TH @ HARRISON	D. ALABA	C. LIU

TABLE OF REVISIONS  
CHECK WITH TRACING TO SEE IF YOU HAVE LATEST REVISION



SUPERSEDES:	STR-4074.2 REV27
DRAWN:	D. ALABA
CHECKED:	C. LIU
DATE:	03/12/2016

APPROVED	CHERYL LIU 05/04/16
DATE:	05/04/16
SENIOR ENGINEER	
DATE:	
APPROVED	R. OLEA 05/04/16
DATE:	05/04/16
CITY TRAFFIC ENGINEER	

SCALE:  
1" = 50'

SHEET/SHEETS:  
3 OF 5

TRAFFIC STRIPING

16TH STREET  
SOUTH VAN NESS AVENUE TO POTRERO AVENUE

CONTRACT NO.	
DRAWING NO.	STR-8154.2
FILE NO.	
REV. NO.	6

FILE NAME:  
DATE: --/--/---



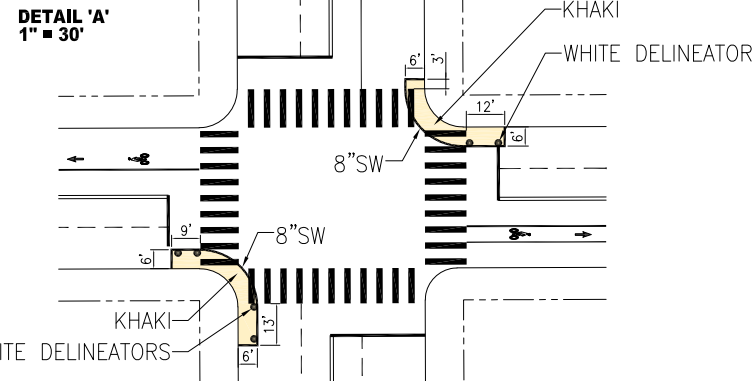
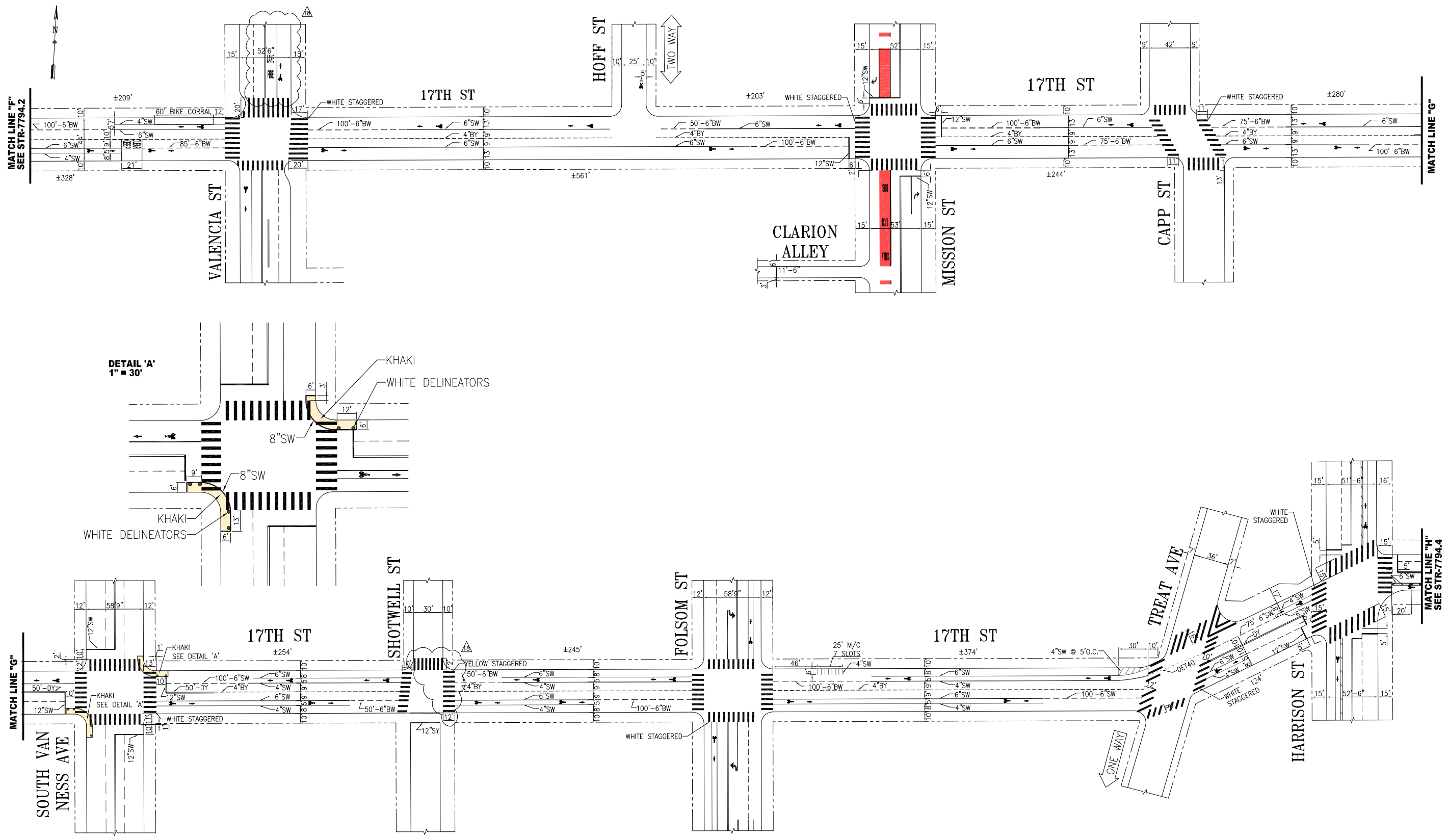

NO.	DATE	DESCRIPTION	BY	APP
1	08/05/20	ADDED FIRE LANE MESSAGE AT VALENCIA; PER FIELD: BIKE LANE STRIPING ON VALENCIA WALK DIMS @ SHOTWELL	W.LEE	K.E.LEUNG
2	02/24/20	ADDED ADV. LIMIT LINES AND DY @ SOUTH VAN NESS; PER FIELD: BIKE STENCIL ON VALENCIA & FOLSOM; DY ON VALENCIA; SHARROW ON HOFF; PAVEMENT MESSAGE & ALLEY @ MISSION; CONTI DIMS ON CAPP; 6" BW DIM @ SHOTWELL; M/C PARKING @ FOLSOM	A.KIM	M.SALLABERRY
3	03/04/20	MODIFIED BIKE LANE & ADDED "KEEP CLEAR" (W) OF VALENCIA	T.ABDALLAH	B.WOO
4	03/04/20	ADDED 5 FT LIMIT LINES AT HARRISON.	S.ARIAS	L.VENTURA



APPROVED		SCALE:
THOMAS P FOLKS 10/09		1" = 50'
SENIOR ENGINEER		
DATE: 10/09		
DRAWN: J.SMITH/T.ABDALLAH 2/2009		SHEET/SHEETS:
DATE: 2/2009		4 OF 6
CHECKED: M.VELASCO		
DATE: 2/2009		
APPROVED: JACK L FLECK 10/09		
CITY TRAFFIC ENGINEER		
DATE: 10/09		

CONTRACT NO.	TRAFFIC STRIPING
DRAWING NO.	STR-7794.3
FILE NO.	
REV. NO.	18

FILE NAME: ---  
DATE: ---

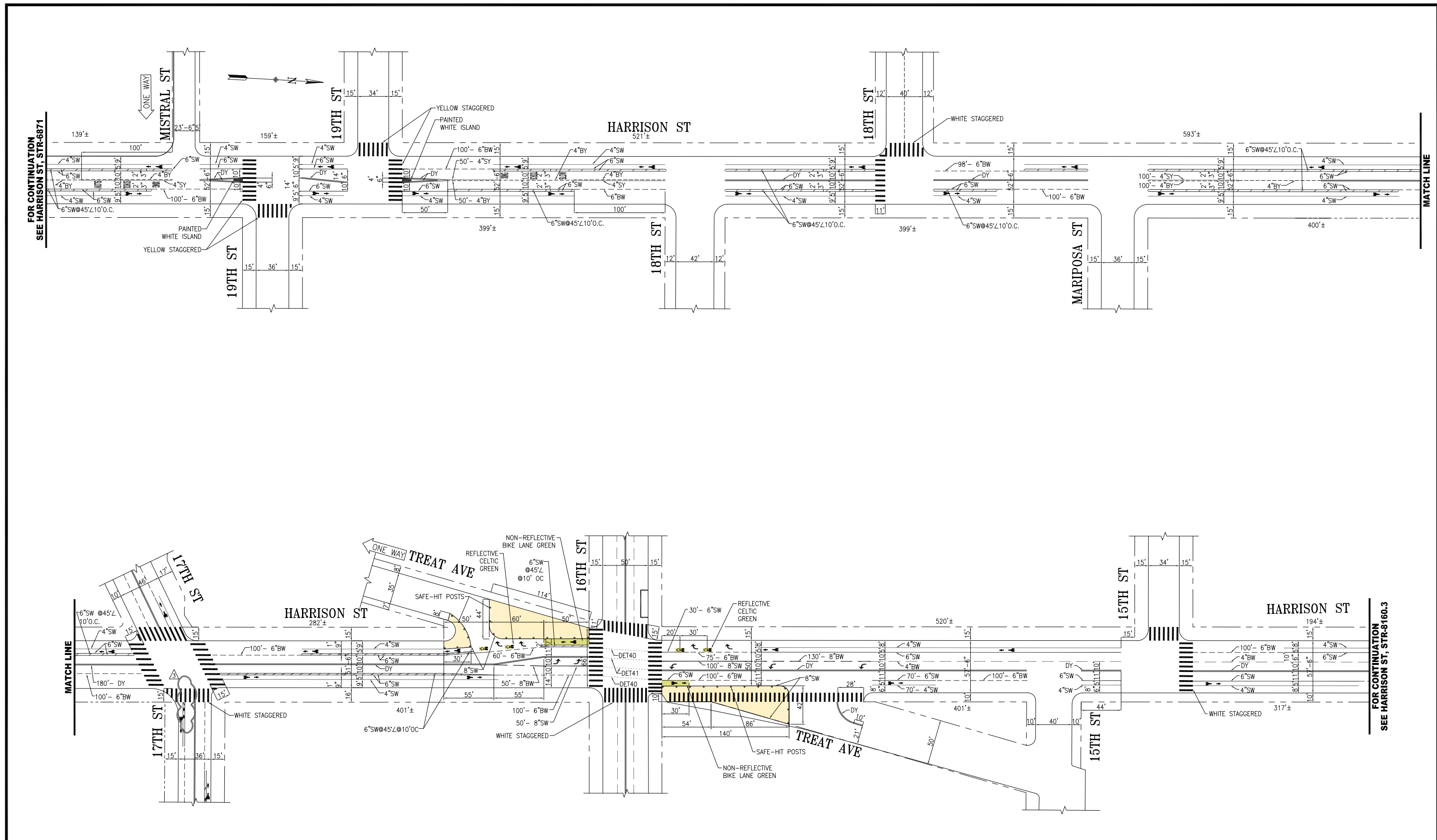

NO.	DATE	DESCRIPTION	BY	APP
1	11/18/16	ADDED DELINEATORS WITH CURB AT 17TH ST	S.SHARIATI	M.SALLABERRY
2	11/18/16	AS PER FIELD CONDITION - ADDED BIKE CORRAL ON 16TH ST @ HARRISON	D.ALABA	M.VELASCO
3	07/21/16	ADDED BUFFERED BIKE LANES BTWN 17TH-22ND STS.	A.UY	M.SALLABERRY
4	04/06/16	REMOVED SB LANE, ADDED BUFFERED BIKE LANE BTWN 16TH-17TH STS. ADDED PAINTED SAFETY ZONES @ 16TH ST & TREAT AVE. PER FIELD ADDED PERPENDICULAR PARKING @ 15TH ST.	A.UY	G.DE LEON



SUPERSEDES: STR-6870 REV13		APPROVED <b>MIKE SALLABERRY</b> 05/10/16 SENIOR ENGINEER	
DRAWN: D.MENDOZA	DATE: 04/25/16	DATE: 05/10/16	DATE: 05/10/16
CHECKED: G.DE LEON	DATE: 04/25/16	CITY TRAFFIC ENGINEER	DATE:

SCALE: 1" = 50'	SHEET/SHEETS:
--------------------	---------------

CONTRACT NO.  
DRAWING NO.  
**STR-8160.2**  
FILE NO.  
REV. NO.  
**3**

**TRAFFIC STRIPING**  
**HARRISON STREET**  
**20TH STREET TO 15TH STREET**

FILE NAME:  
DATE: --/--/---