

SFMTA - TASC SUMMARY SHEET

<p>PreStaff_Date: 3/30/2021</p> <p>Requested_by: SFMTA</p> <p>Handled: Edgar Orozco <i>K K</i></p> <p>Section Head : Cheryl Liu <i>MW for CL</i></p>	<p><input type="checkbox"/> Public Hearing Consent</p> <p><input checked="" type="checkbox"/> Public Hearing Regular</p> <p><input type="checkbox"/> Informational / Other PH - Regular</p>	<p>No objections: _____</p> <p>Item Held: _____</p> <p>Other: _____</p>
<p>Location: San Bruno Avenue and Arleta Avenue</p>		
<p>Subject: Tow-Away, No Stopping Anytime</p>		
<p>PROPOSAL / REQUEST: ESTABLISH - TOW-AWAY, NO STOPPING ANYTIME San Bruno Avenue, north side, from Arleta Avenue to 110 feet easterly (Supervisor District 10)</p> <p>Proposal to restrict stopping and parking across six consecutive driveways in a multi-unit building to provide a taper needed for turn clearance.</p> <p>Edgar Orozco (edgar.orozco@sfmta.com)</p>		
<p>BACKGROUND INFORMATION / COMMENTS</p> <p>*The clearance is needed for vehicles, including Muni buses, making a right turn onto San Bruno Ave. from Bayshore Blvd.</p> <p>*A double yellow taper is preferred over the existing KEEP CLEAR markings given the existing signal timing properties</p> <p>*San Bruno Ave. at Arleta Ave. is a part of San Francisco's Bike Network</p> <p>*This proposal removes a 17 foot long unmetered parking space</p> <p>*This segment is a part of Muni routes 8,8BX,9,9R,56,91</p> <p>*In the most recent five years of available collision data, there have been no collisions associated with a right turn onto San Bruno Ave. from Bayshore Blvd.</p>		
<p>HEARING NOTIFICATION AND PROCESSING NOTES:</p>	<p>ENVIRONMENTAL CLEARANCE BY:</p> <p><input checked="" type="checkbox"/> SFMTA <input type="checkbox"/> Attached <input type="checkbox"/> Pending</p>	

Existing Striping

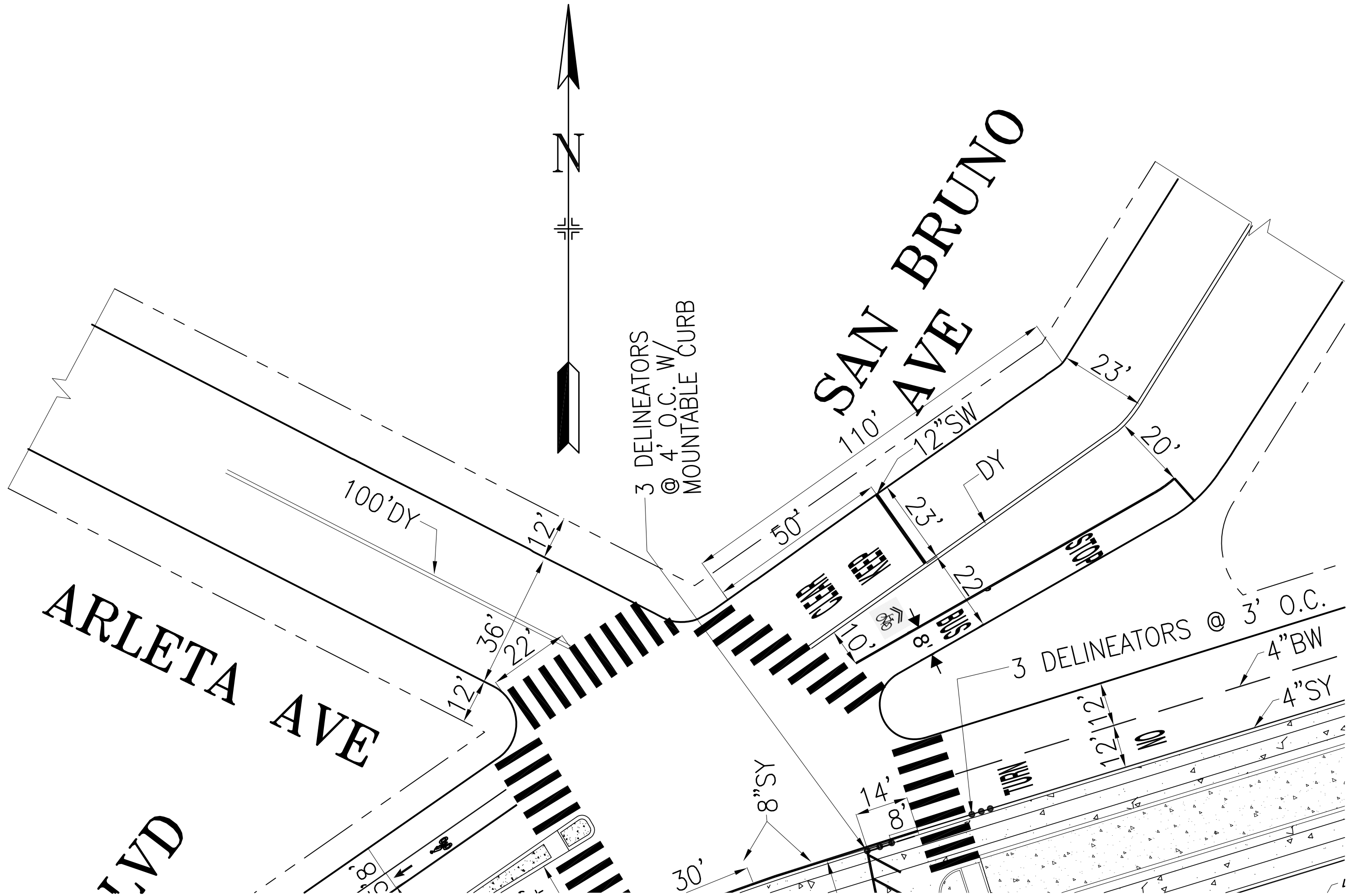

Proposed Striping

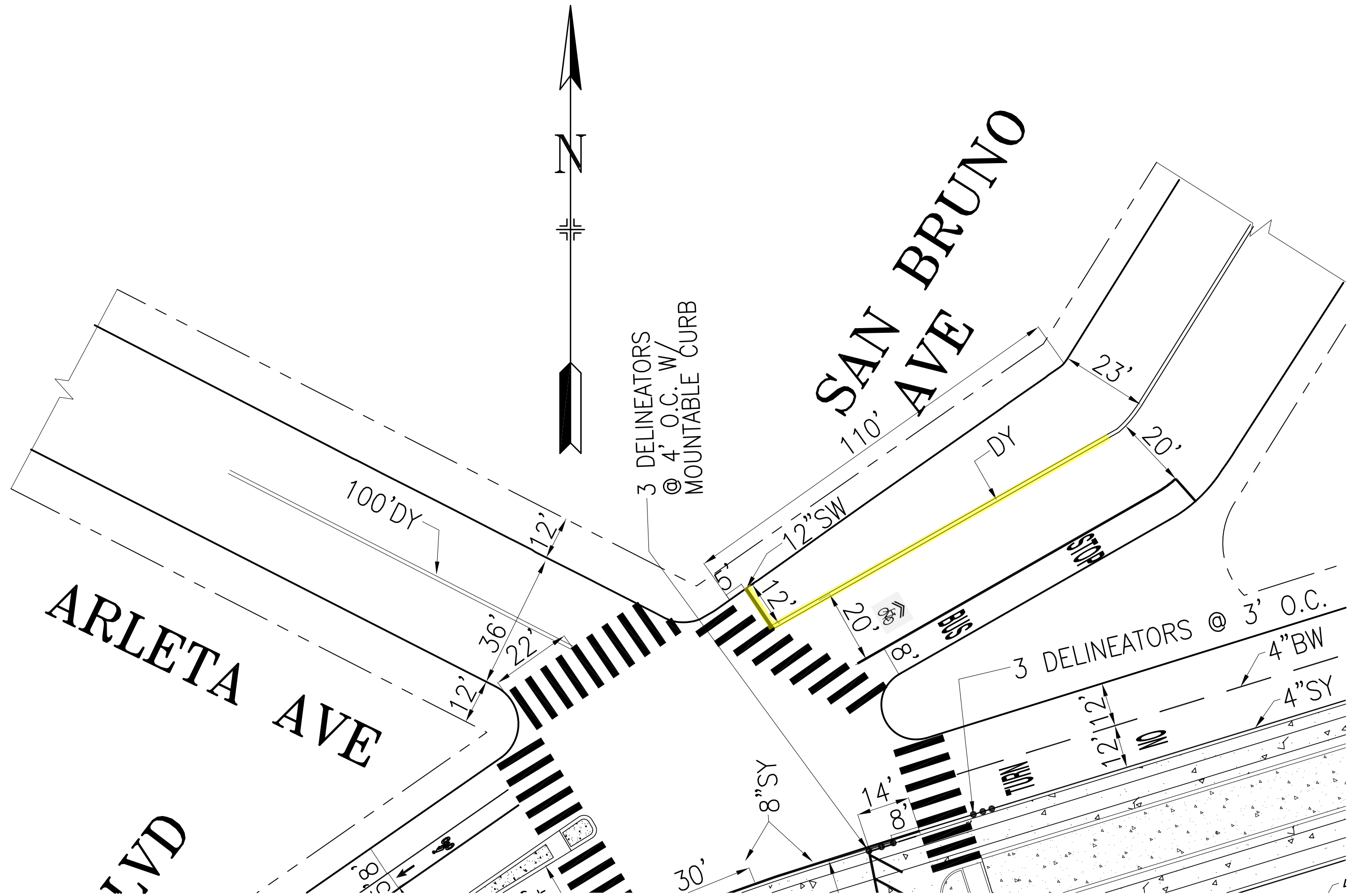

**60' Muni Bus
Right Turn onto San Bruno Ave.**

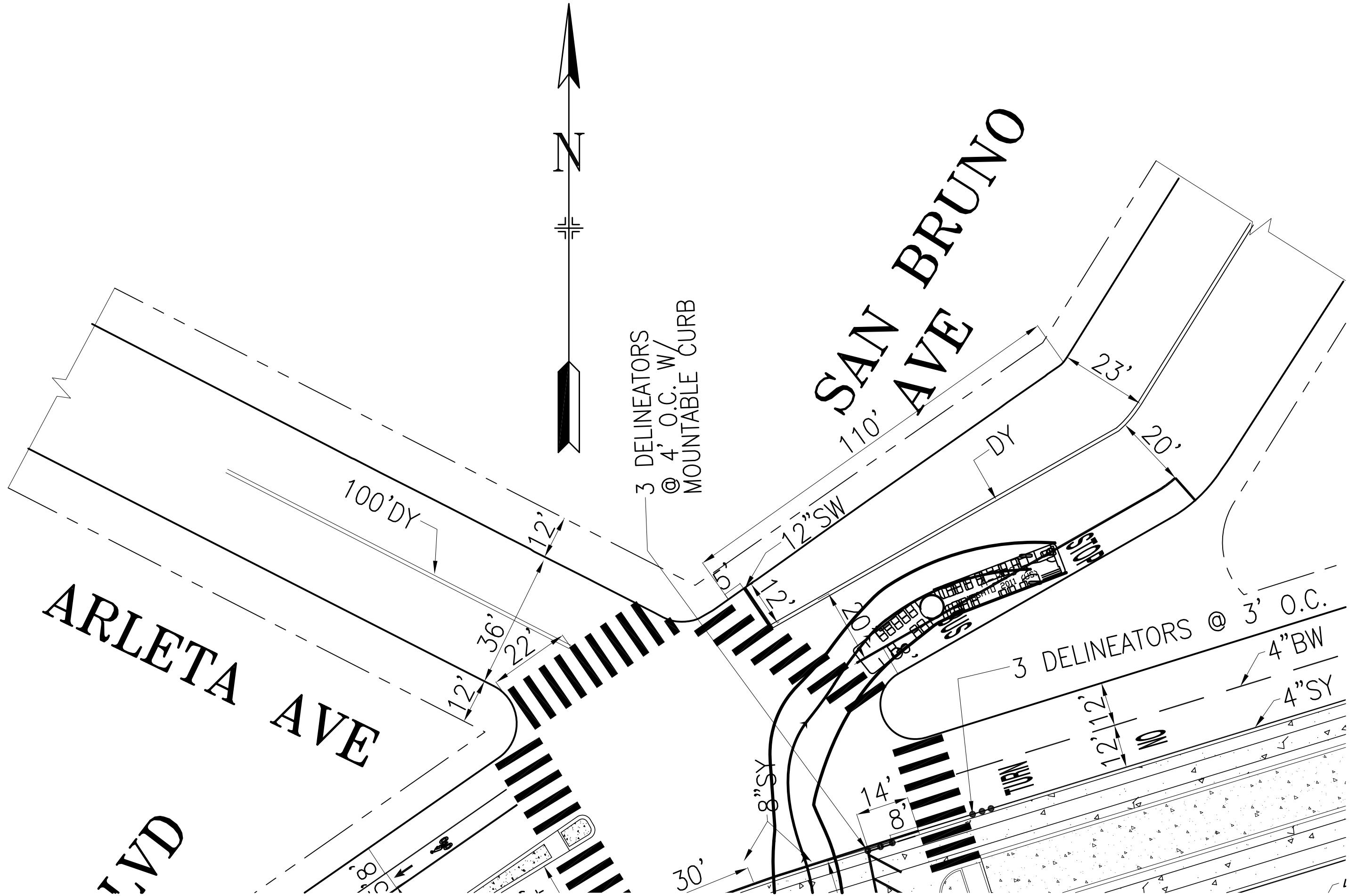

Passenger Vehicle
Right Turn onto San Bruno Ave.

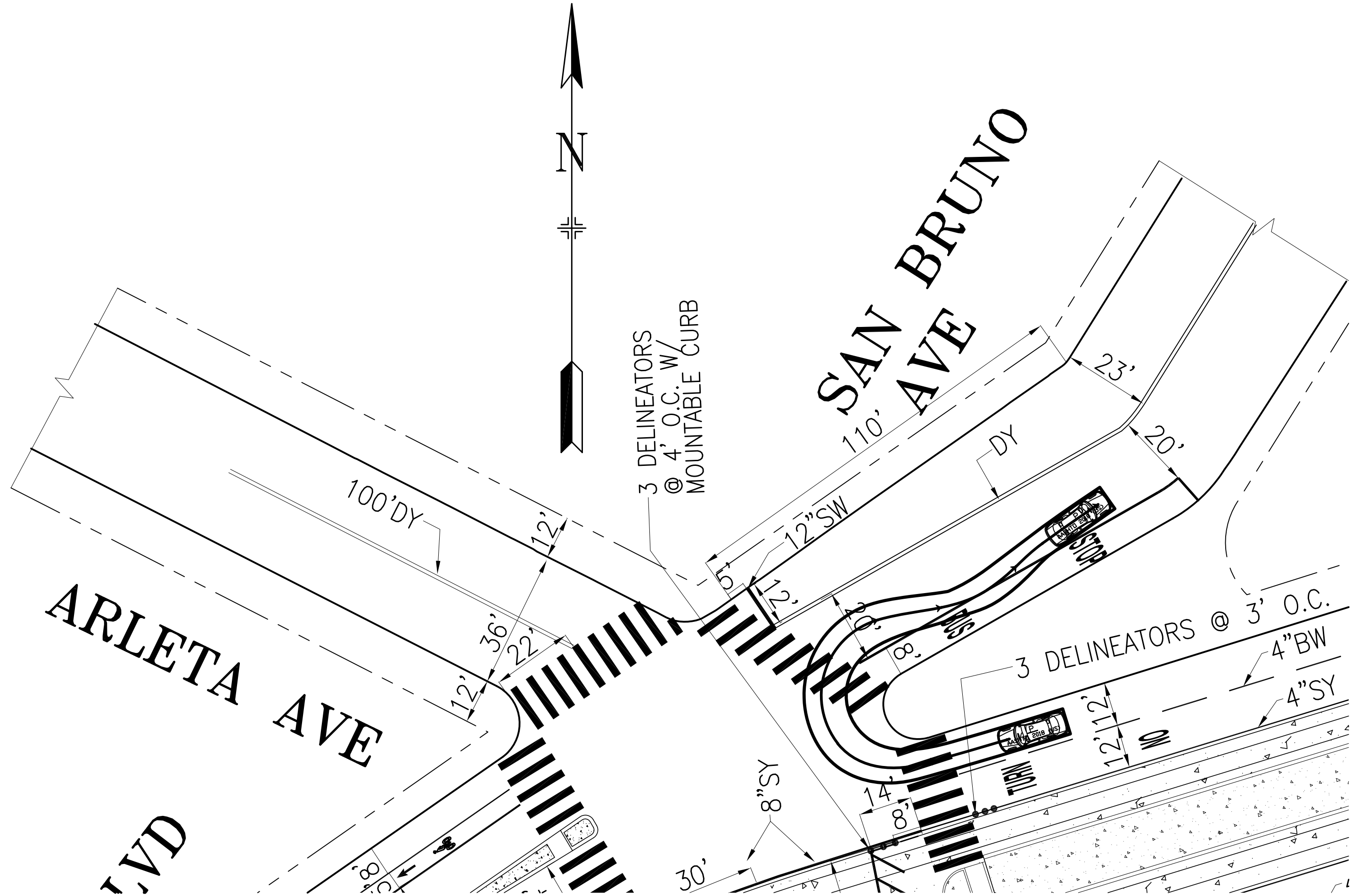



Multi Unit Building

Arleta Ave.

110' TANSAT (proposed)

17' legal parking

car parked
on cut curb

San Bruno Ave.





Arleta Ave.

San Bruno Ave.





Arleta Ave.



110' TANSAT (proposed)



San Bruno Ave.



Existing Timing Card (1/2)

Arleta, Bayshore, San Bruno	DESCRIPTION: Program dual entry for phases 4P, 7P & 8P. Update custom transitions. Update TSP settings: priority/recovery min greens and reservice inhibit. Update preemption settings.		
CHANGE: 38	NOTES: No Local TSP for 8x	Page 1 of 10	
CNN #: 20298000	PHASE	STREET	EmerFlash
ENGINEER: Edward Tang	2	Bayshore NB	R
Revision date: 11/10/2020	3	San Bruno SB	R
Programmed by: DG	4	Arleta EB	R
Installed by: DG-DD	5	Bayshore NBLT	R
09:05	6	Bayshore SB	R
Date Completed: 12-23-20	13T	MUNI	F--
	15T	"Train Coming"	Dark
		Controller:	2070
		Cabinet:	MSF
		Oper. Date:	1/10/1952
		System:	Third St.
		Master:	TBC-GPS

Actuation
 Transit Priority
 Preemption

Steady Demand Sequence

X = YES -- = NO	S	M	T	W	T	F	S	CYCLE	SPLIT	OFFSET	FLASH
06:00 to 10:00	--	X	X	X	X	X	--	2	1	2	--
15:00 to 18:30	--	X	X	X	X	X	--	3	1	3	--
21:00 to 06:00	X	X	X	X	X	X	X	FREE			--
ALL OTHER TIMES	X	X	X	X	X	X	X	1	1	1	--

STREET	PHASE	1	2	3	4	5	6	7	8	9	10	11	12	13	14	15	16
Bayshore NB	2	G				Y		R									
San Bruno SB	3	R		FR				R									
Arleta EB	4	R										G		Y	R		
Bayshore NBLT	5	G	Y	R													
Bayshore SB	6	R		G				Y		R							
Peds Xing Bayshore SS	4P	RH										↑	FRH		RH		
Peds Xing Arleta WS	6P	RH		↑	FRH				RH								
Peds Xing San Bruno NS	7P	RH										↑	FRH		RH		
Peds Xing Bayshore NS	8P	RH										↑	FRH		RH		
Muni T2&6 (LRV 2&6)	13T	--		F				--									
"Train Coming"	15T	OFF		ON if train				OFF									

ws3.0																

CSO	CYCLE (seconds)	OFFSET (seconds)	SIGNAL INTERVALS (seconds)															
			1	2	3	4	5	6	7	8	9	10	11	12	13	14	15	16
111	100.0	34	14.0	4.0	2.0	4.0	20.0	9.0	3.0	3.0	1.5	1.5	4.5	1.0	14.0	11.0	4.0	3.5
212	110.0	23	14.0	4.0	2.0	4.0	30.0	9.0	3.0	3.0	1.5	1.5	4.5	1.0	14.0	11.0	4.0	3.5
313	110.0	15	14.0	4.0	2.0	4.0	30.0	9.0	3.0	3.0	1.5	1.5	4.5	1.0	14.0	11.0	4.0	3.5

Arleta, Bayshore, San Bruno

CHANGE 38

Existing Timing Card (2/2)

PAGE 2: BASE TIMING, ACTUATION, COORDINATION SETTINGS

Arleta, Bayshore, San Bruno

PHASE DIAGRAM

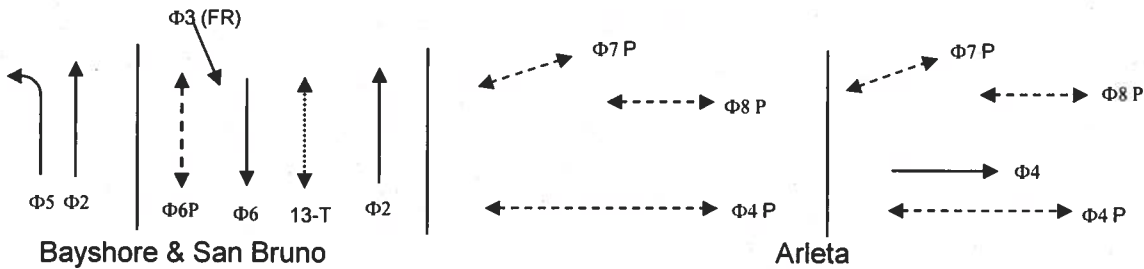

Are there conflicting protected left turn phases? n/a

BASE TIMINGS:

Phase	1	2	3	4	5	6	7P	8P	13T
Movement		NB	SET	EB	NBLT	SB	NSP	NSP	MUNI
Absolute Min Green (whole #)		12	10	11	9	12	--	--	10
Early Walk		--	--	4.5	--	--	4.5	4.5	--
Yellow		4.5	4.5	4.0	4.0	4.5	4.0	4.0	6.0
Red Clearance		1.5	1.5	3.5	2.0	1.5	3.5	3.5	3.0
Absolute Min Walk (whole #)		--	--	4	--	4	4	4	--
FRH (whole #)		--	--	26	--	12	11	25	--

ACTUATION: ** if Actuation setting vary by plan, use special comments.

Phase	1	2	3	4	5	6	7P	8P	13T
Vehicle Detection Type		NONE	NONE	wireless	wireless	NONE	--	--	Vetag
Ped Detection Type		--	--	PPB	--	NONE	PPB	PPB	--
Vehicle Recall (Max, Min, Soft or None)		MAX	MAX	NONE	NONE	MAX	--	--	MAX
Absolute Min Green (same as above)		12	10	11	9	12	--	--	10
Vehicle Extension (seconds)		--	--	3	2	--	--	--	--
Max Green (only used for FREE)		60	40	27	14	40	--	--	36
Pedestrian Recall (Yes or No)		--	--	NO	--	YES	NO	NO	--
Ped Recycle (Yes or No)		--	--	YES	--	YES	YES	YES	--
"WALK EXPAND" (Yes or No)		--	--	YES	--	YES	YES	YES	--

COORDINATION (phase splits = Max G + Y + R Clearance)

Phase	Cycle length	1	2	3	4	5	6	7P	8P	13T	Onset (from page 1)
Dial 1 Splits	100		62	42	38	20	42	38	38	42	34
Min Transition	94		56	36	38	20	36	38	38	36	
Max Transition	126		75	50	51	25	50	51	51	50	
Dial 2 Splits	110		72	52	38	20	52	38	38	52	23
Min Transition	104		66	46	38	20	46	38	38	46	
Max Transition	139		87	60	52	27	60	52	52	60	
Dial 3 Splits	110		72	52	38	20	52	38	38	52	15
Min Transition	104		66	46	38	20	46	38	38	46	
Max Transition	139		87	60	52	27	60	52	52	60	
Coordinated Phases			X				X				

Special Comments

startup all-red = 6 seconds
Ped Push Buttons in Median

Arleta, Bayshore, San Bruno

Change

Muni Map

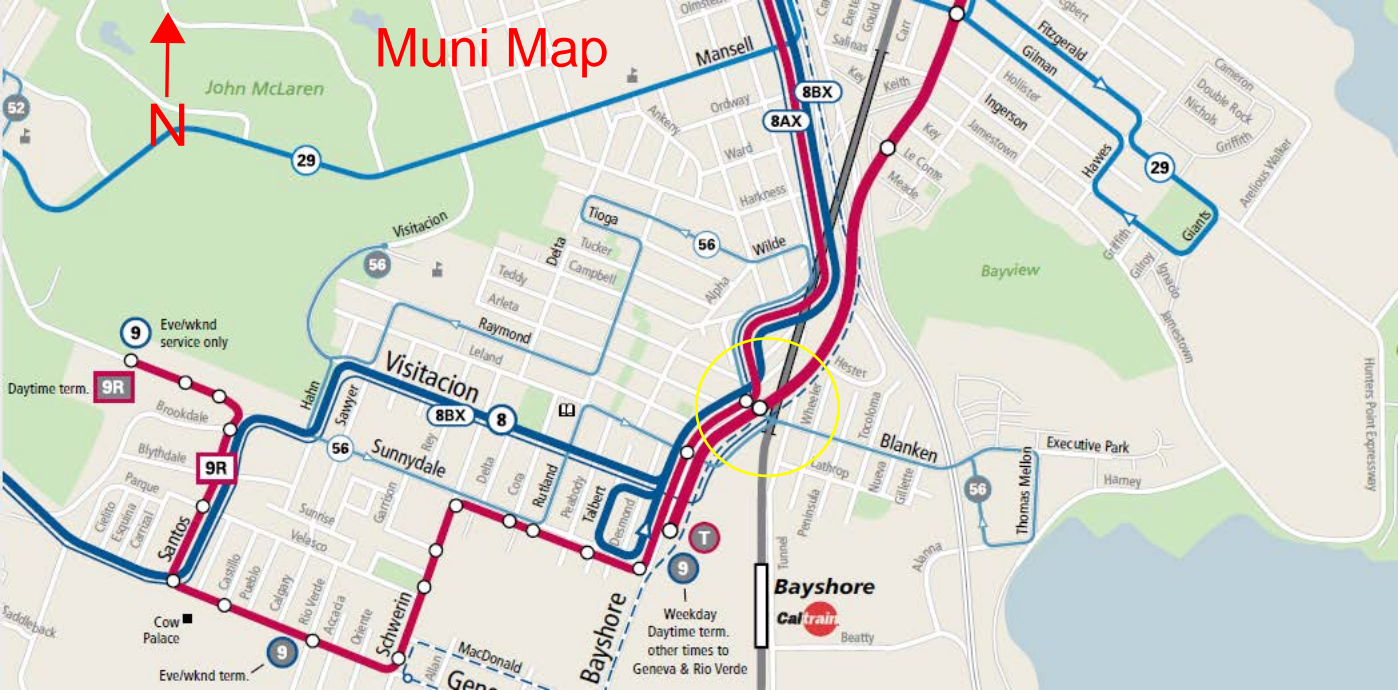

5-Year Transit Collisions

Intersection	Date	Incident Type	Line	ARB Charge	Collision Type	Direction	IE_DESC	Time
Arleta Ave & Bay Shore Blvd	1/4/2016	Collision	8 AX Bayshore A Express	Avoidable	Right Sideswipe	inbound/nearside	At 7:29am on Mon Jan 4, 2016 I was in the left turn lane on Bayshore at Arleta. I was the 1st vehicle at the stoplight in my lane. The green arrow came on, +1 started forward. a black BMW in the lane next to me veered slightly into my lane & clipped her left side mirror on the right corner of my bus I secured the coach and wait and asked her (the driver) if she was injured & did she need an ambulance or doctor. She said she was fine, + I returned to the coach + called central control. While I was putting out the emergency triangles + photographs the scene, she said that her neck hurt + she needed an ambulance engine co 44 responded + dealt with both women in the BMW. The police asked her to pull her car to the right side of the road. SFPD officer R Lewis, star 411 gave me the case #160008124.	7:29 AM
Arleta Ave & Bay Shore Blvd	7/22/2020	Collision	9 San Bruno	Avoidable		outbound/farside	Pulled into terminal at Bayshore & Leland , operator driving 8 bus line informed me that my right side bumper was off and laying at the Bayshore & Arleta bus stop , No contact made with anything . I have no clue of how the bumper be detached. I was advised to wait for inspector .	4:37 PM
Arleta Ave & Bay Shore Blvd	12/11/2017	Collision	8 Bayshore	Avoidable	Left Sideswipe	inbound/midblock	I was inbound on Bayshore & Arleta at the light waiting to turn left onto San Bruno Ave when a truck pulled along my right side and the driver was yelling profanity language out his window and allegedly claiming there was contact made to his trucks . I opened my front doors and told him to pull over when the light turned green he went straight on Bayshore towards the freeway and I turned left onto San Bruno Ave. . I tied up the coach and contacted TMC , Insp. Chavez unit 5T67B Star#924 arrived and interviewed me, no injuries	4:35 PM
Arleta Ave & Bay Shore Blvd	12/13/2018	Collision	9 San Bruno	Avoidable		inbound	Inbound Bayshore Arleta cross street as I'm merging over left, car comes straight doesn't stop as I see we are about to play chicken , I slow down, car continues to come fulfill the lane ends up clipping side of bus. Notified TMC, as I'm talking to tmc, car leaves. TMC ordered to pull coach in, inspector were not called out.	8:28 PM

Geographic Extent: 20298000: ARLETA AVE at SAN BRUNO AVE
Spatial Intersect: SFMTA Intersection Related (<=20ft or <=150ft if Rear End)
Data Range: 01/01/2016 to 12/31/2020
Pull Date: 3/25/2021

Geographic Extent

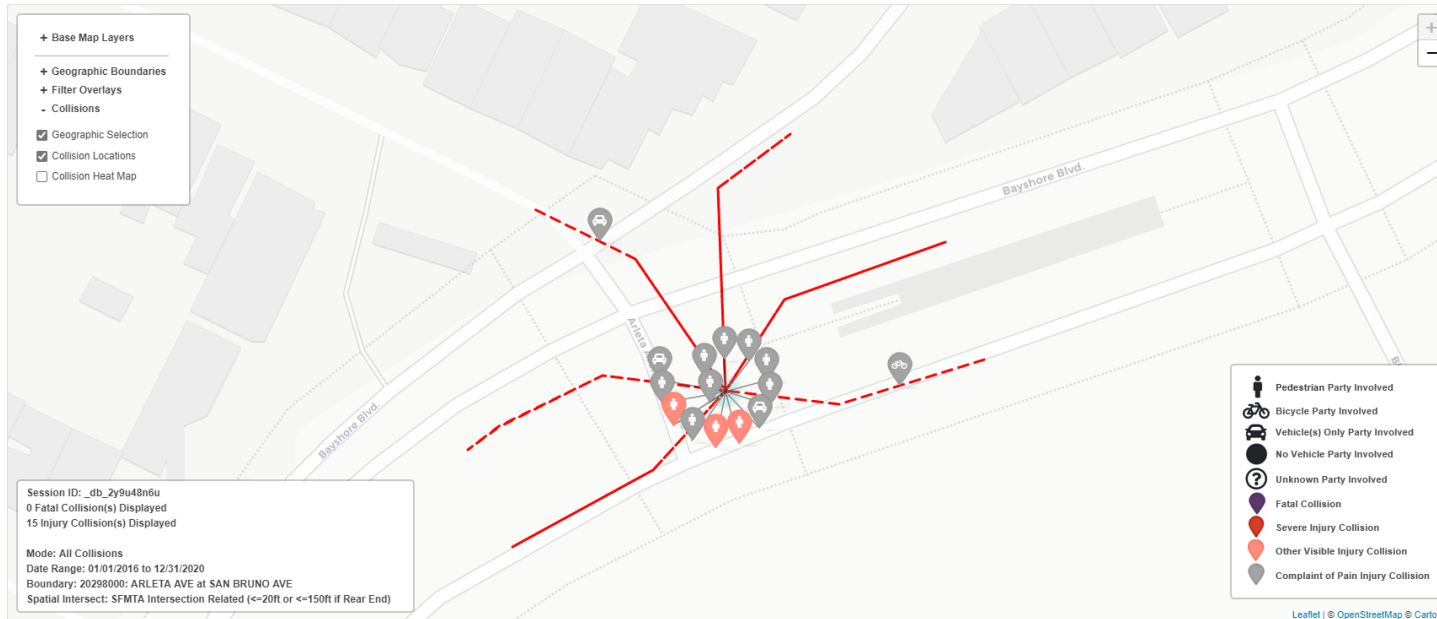

Geographic Extent: 20298000: ARLETA AVE at SAN BRUNO AVE
 Spatial Intersect: SFMTA Intersection Related (<=20ft or <=150ft if Rear End)
 Data Range: 01/01/2016 to 12/31/2020
 Pull Date: 3/25/2021

Collision/Party/Victim Table
 Showing 1 to 15 of 15 entries

Count of Fatal Collisions: 0
 Count of Non-Fatal Injury Collisions: 15
 Total Count of Fatal/Non-Fatal Injury Collisions: 15

Case ID	Collision Date	Collision Time	Day of Week	Primary Road	Secondary Road	Distance	Direction	Party 1 Type	Party 1 Direction of Travel	Party 1 Movement Preceding Crash	Party 2 Type	Party 2 Direction of Travel	Party 2 Movement Preceding Crash	Vehicle Code Violation	Highest Degree of Injury	Type of Collision	Motor Vehicle Involved With	Weather	Lighting
200375790	06/23/2020	01:52	Tuesday	BAY SHORE BLVD	ARLETA AVE	0	Not Stated	Driver	North	Proceeding Straight				CVC 21658(a)	Injury (Complaint of Pain)	Hit Object	Fixed Object	Clear	Dark - Street Lights
200025177	01/10/2020	18:00	Friday	SAN BRUNO AVE	ARLETA AVE	0	Not Stated	Driver	South	Other	Pedestrian	East	Proceeding Straight	CVC 21453(a)	Injury (Complaint of Pain)	Vehicle/ Pedestrian	Not Stated	Clear	Dark - Street Lights
190843906	11/07/2019	15:07	Thursday	BAY SHORE BLVD	ARLETA AVE	0	Not Stated	Driver	East	Passing Other Vehicle	Pedestrian	North	Other	CVC 21453(a)	Injury (Other Visible)	Vehicle/ Pedestrian	Pedestrian	Clear	Daylight
180792216	10/18/2018	20:36	Thursday	BAY SHORE BLVD	ARLETA AVE	0	Not Stated	Pedestrian	West	Proceeding Straight	Driver	North	Making Left Turn	CVC 21456(c)	Injury (Complaint of Pain)	Vehicle/ Pedestrian	Pedestrian	Clear	Daylight
180319133	04/30/2018	07:55	Monday	BAY SHORE BLVD	ARLETA AVE	0	Not Stated	Driver	North	Making Left Turn	Pedestrian	East	Proceeding Straight	CVC 21950(a)	Injury (Other Visible)	Vehicle/ Pedestrian	Pedestrian	Clear	Daylight
171016437	12/16/2017	15:39	Saturday	BAY SHORE BLVD	ARLETA AVE	0	Not Stated	Pedestrian	East	Entering Traffic	Driver	South	Stopped In Road	CVC 21456(b)	Injury (Other Visible)	Vehicle/ Pedestrian	Pedestrian	Clear	Daylight
170621534	07/31/2017	11:25	Monday	BAY SHORE BLVD	BLANKEN AVE	36	South	Bicyclist	North	Proceeding Straight	Driver	North	Stopped In Road	CVC 21703	Injury (Complaint of Pain)	Rear End	Other Motor Vehicle	Clear	Daylight
170556828	07/09/2017	12:45	Sunday	ARLETA AVE	SAN BRUNO AVE	92	West	Driver	East	Proceeding Straight	Driver	East	Stopped In Road	CVC 22350	Injury (Complaint of Pain)	Rear End	Other Motor Vehicle	Clear	Daylight
170352773	04/30/2017	01:41	Sunday	BAY SHORE BLVD	ARLETA AVE	0	Not Stated	Driver	South	Proceeding Straight	Driver	East	Proceeding Straight	CVC 21453(a)	Injury (Complaint of Pain)	Broadside	Other Motor Vehicle	Clear	Dark - Street Lights
170342376	04/26/2017	15:13	Wednesday	ARLETA AVE	BAY SHORE BLVD	0	Not Stated	Driver	South	Making Left Turn	Pedestrian	South	Other	CVC Unknown	Injury (Complaint of Pain)	Not Stated	Pedestrian	Clear	Daylight
170308102	04/15/2017	00:54	Saturday	BAY SHORE BLVD	ARLETA AVE	0	Not Stated	Driver	South	Proceeding Straight	Pedestrian	West	Proceeding Straight	CVC Unknown	Injury (Complaint of Pain)	Sideswipe	Pedestrian	Clear	Dark - Street Lights
170174652	03/02/2017	12:09	Thursday	BAY SHORE BLVD	SAN BRUNO AVE (N)	0	Not Stated	Driver	South	Entering Traffic	Pedestrian	Not Stated	Proceeding Straight	CVC 21804(a)	Injury (Complaint of Pain)	Vehicle/ Pedestrian	Pedestrian	Clear	Daylight
170149796	02/21/2017	19:13	Tuesday	SAN BRUNO AVE	ARLETA AVE	0	Not Stated	Driver	South	Slowing/ Stopping	Pedestrian	West	Proceeding Straight	CVC 21453(a)	Injury (Complaint of Pain)	Vehicle/ Pedestrian	Pedestrian	Clear	Dark - Street Lights

Geographic Extent: 20298000: ARLETA AVE at SAN BRUNO AVE
 Spatial Intersect: SFMTA Intersection Related (<=20ft or <=150ft if Rear End)
 Data Range: 01/01/2016 to 12/31/2020
 Pull Date: 3/25/2021

Case ID	Collision Date	Collision Time	Day of Week	Primary Road	Secondary Road	Distance	Direction	Party 1 Type	Party 1 Direction of Travel	Party 1 Movement Preceding Crash	Party 2 Type	Party 2 Direction of Travel	Party 2 Movement Preceding Crash	Vehicle Code Violation	Highest Degree of Injury	Type of Collision	Motor Vehicle Involved With	Weather	Lighting
160765512	09/21/2016	04:03	Wednesday	BAY SHORE BLVD	SAN BRUNO AVE	6	East	Driver	North	Stopped In Road	Pedestrian	West	Proceeding Straight	CVC 21954(b)	Injury (Complaint of Pain)	Vehicle/ Pedestrian	Pedestrian	Clear	Dark - Street Lights
160564900	07/13/2016	04:49	Wednesday	BAY SHORE BLVD	ARLETA AVE	0	Not Stated	Pedestrian	South	Entering Traffic	Driver	East	Proceeding Straight	CVC 21955	Injury (Complaint of Pain)	Vehicle/ Pedestrian	Pedestrian	Clear	Dark - Street Lights