



The Mayor's Office of
Housing and
Community
Development

**Balboa Park Station
CAC Meeting**

August 25, 2015

Mayor's Office of Housing & Community Development (MOHCD)

Mission: To coordinate the City's housing policy & provide financing for the development, rehabilitation, & purchase of affordable housing in San Francisco; AND to strengthen the social, physical, & economic infrastructure of San Francisco's low-income neighborhoods & communities in need.

Policy Goals:

- ✓ Mayor Lee's Housing Production Goal - 30,000 units by 2020
- ✓ Transition Age Youth Housing Goal - 400 units
- ✓ 10 year Plan to End Chronic Homelessness - 3,000 units by 2014

1100 Ocean

Opened July 29th



1100 Ocean

Open Now!



Fully Leased!



Facts:

- ✓ Close proximity to transit, schools & amenities
- ✓ Ground floor neighborhood-serving commercial potential
- ✓ 22,000 square feet of open space w/ species selected for carbon sequestration properties with Department of Urban Forestry
- ✓ Indoor Air Quality Mitigations (Article 38) + Green Buffer
- ✓ Request for proposals: Late 2015/Early 2016

Site constraints:

- 85-foot building height limit on corner, 45-foot on San Jose
- BART Zone of Influence (52.5 foot setback from tunnel)
- Zoned NCT-Neighborhood Commercial Transit

Program Potential:

Population: Families? Transition-Age Youth (TAY)? Seniors?

Capacity: 100 family housing units

Intersection of Geneva and Ocean

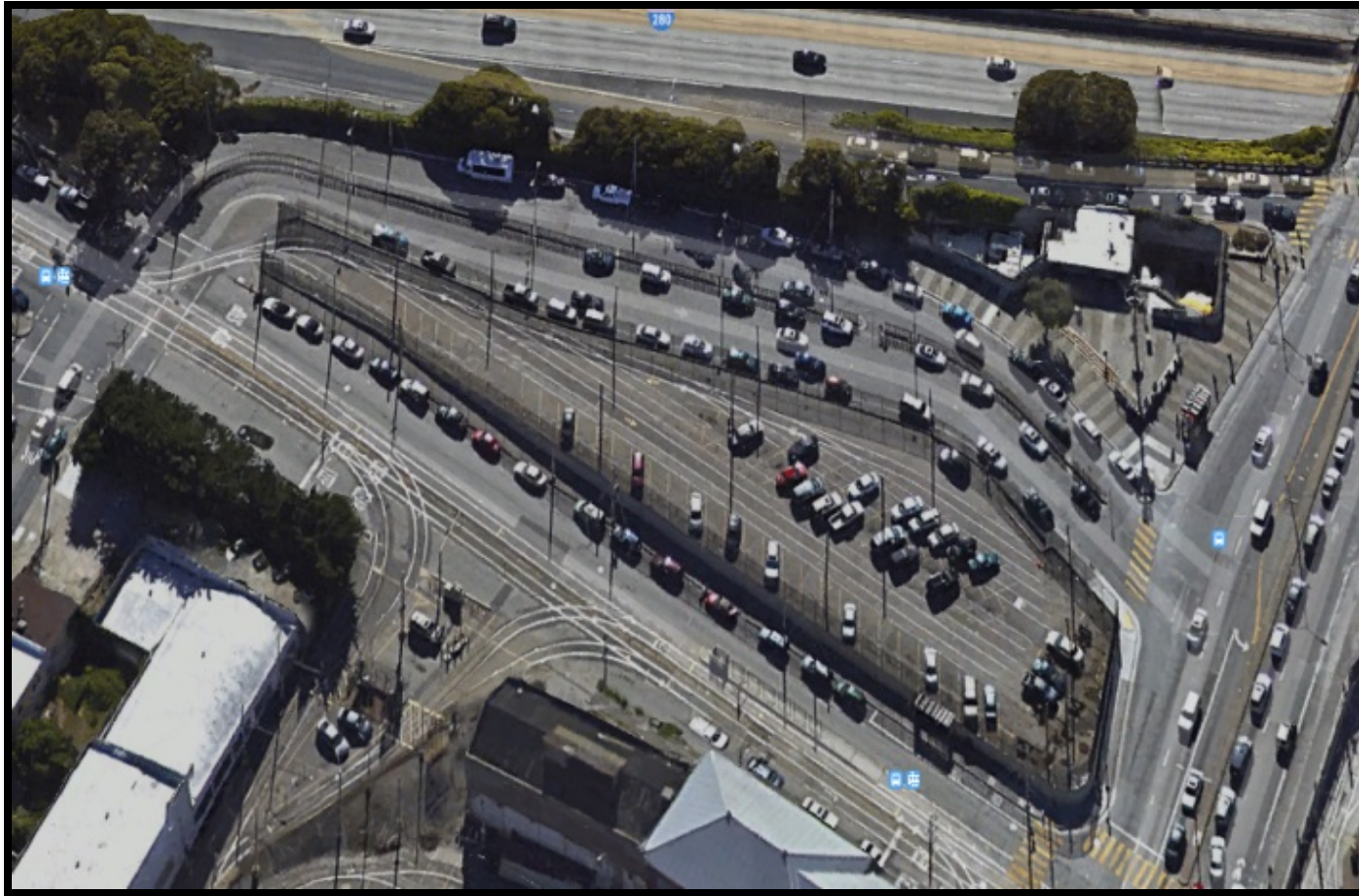

Draft Site Diagram

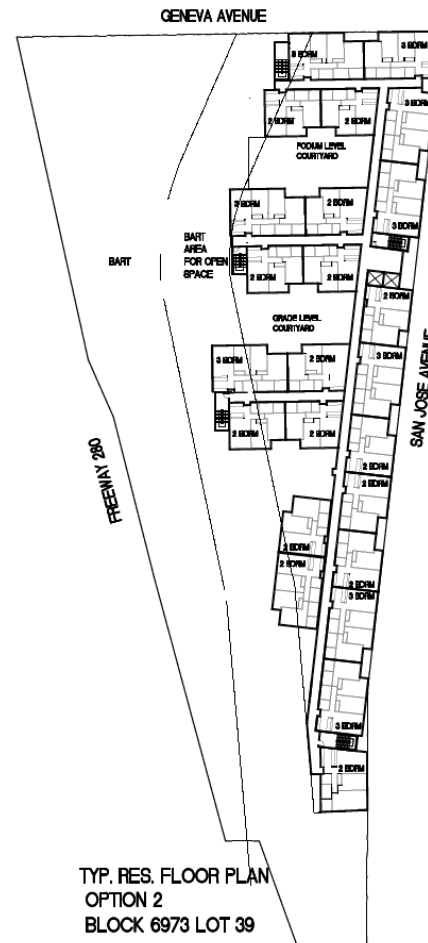
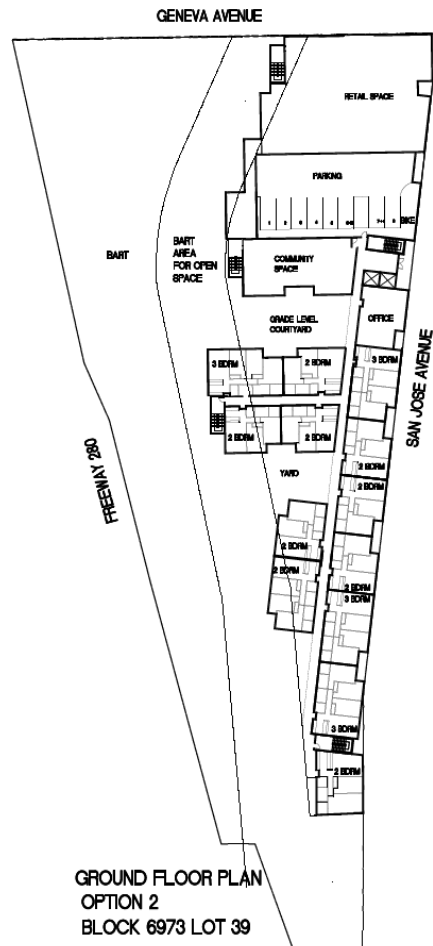

BALBOA PARK UPPER YARD- SFMTA SITE w/ BART

for Mayor's Office of Housing, Draft: 03-15-2013

OPTION 2 FLOOR PLANS

Asian Neighborhood Design

1245 Howard Street
San Francisco, CA 94103
(415) 575-0423 (415) 575-0424 Fax



Schedule Update

- Complete Lease Negotiations with BART – Fall 2015
- Complete Land Transaction with SFMTA – Winter 2015
- Solicit Community input for Developer RFP – Winter 2015
- Select Development Team – Early 2016
- 1st Community Design Charrette – Early 2016

QUESTIONS?