



SFMTA



N Judah Terminal Safety Improvements and Lower Great Highway Parking Changes

SFMTA Board of Directors

January 16, 2024

N Judah Terminal - Existing Conditions

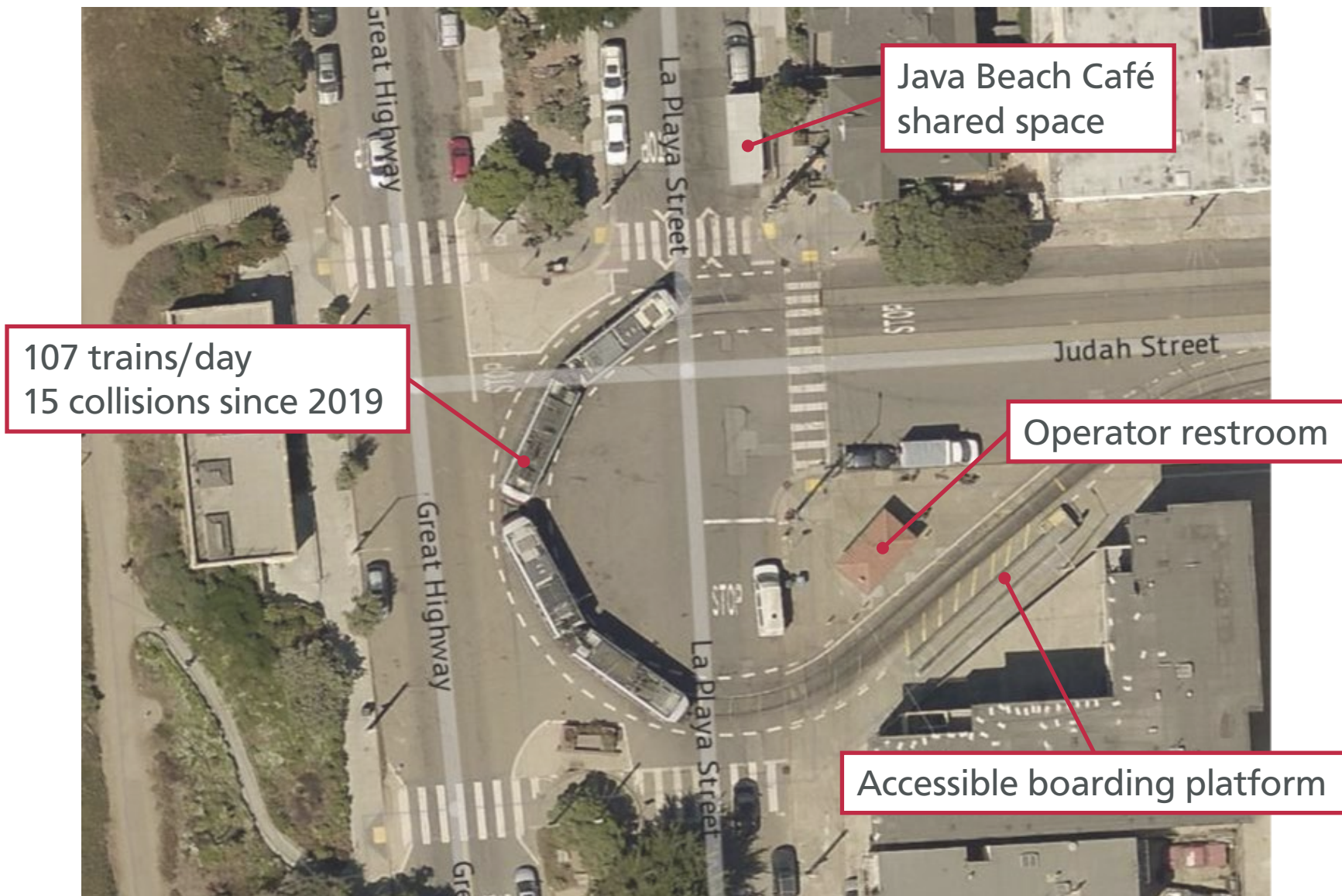

View North on La Playa at Judah



View South on La Playa at Judah



Limited space for two-way traffic

Crossing La Playa – North Crosswalk



Crossing La Playa – South Crosswalk



Limited visibility of southbound traffic

Summary of Proposed Changes

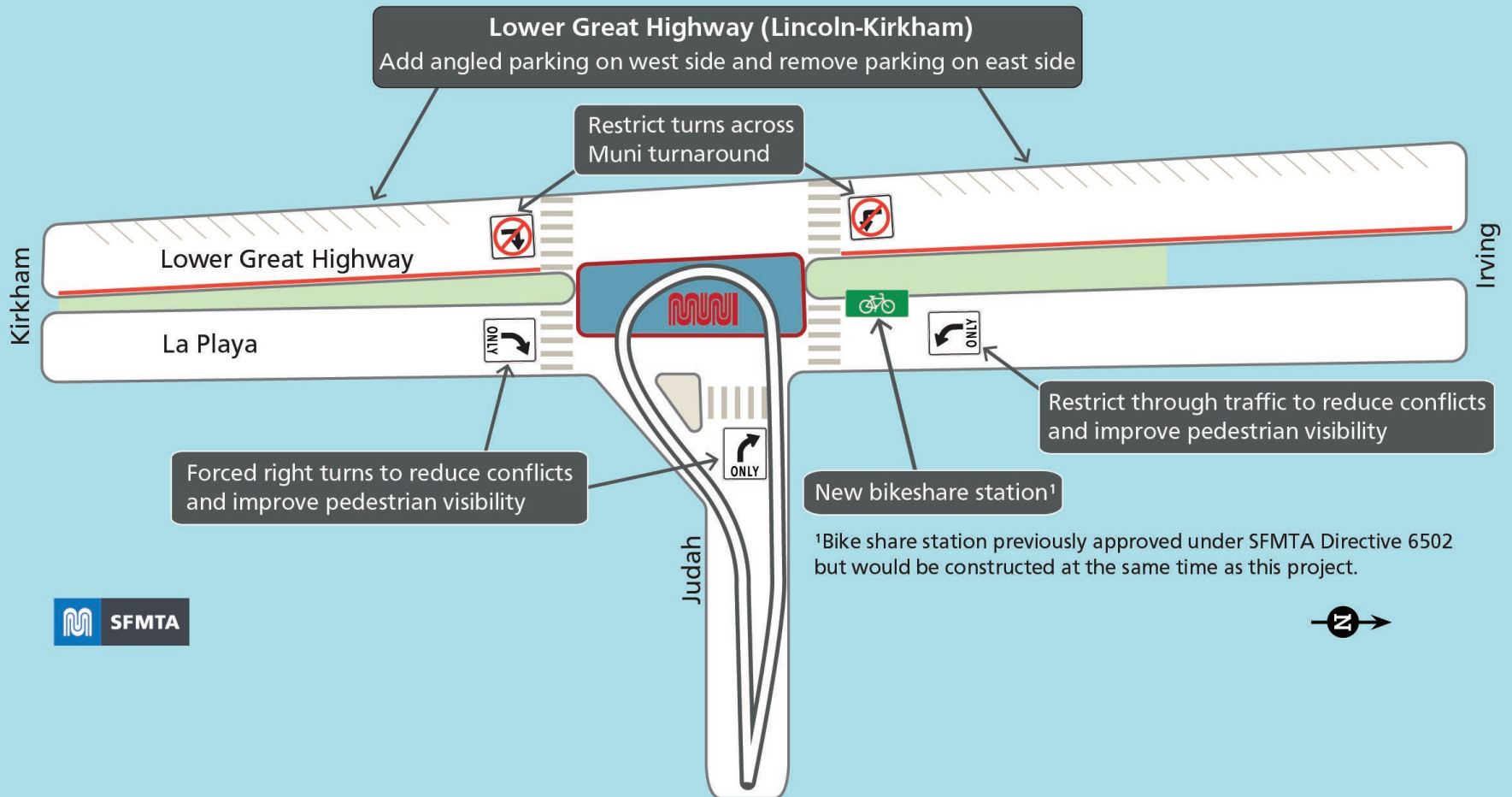

Proposed Intersection Design Details

Vertical delineators around terminal restrict motor vehicle access to/from Lower Great Highway

Angled parking on Lower Great Highway

Bikeshare

Turn restrictions to reduce conflicts and improve pedestrian visibility

Existing Java Beach Café shared space

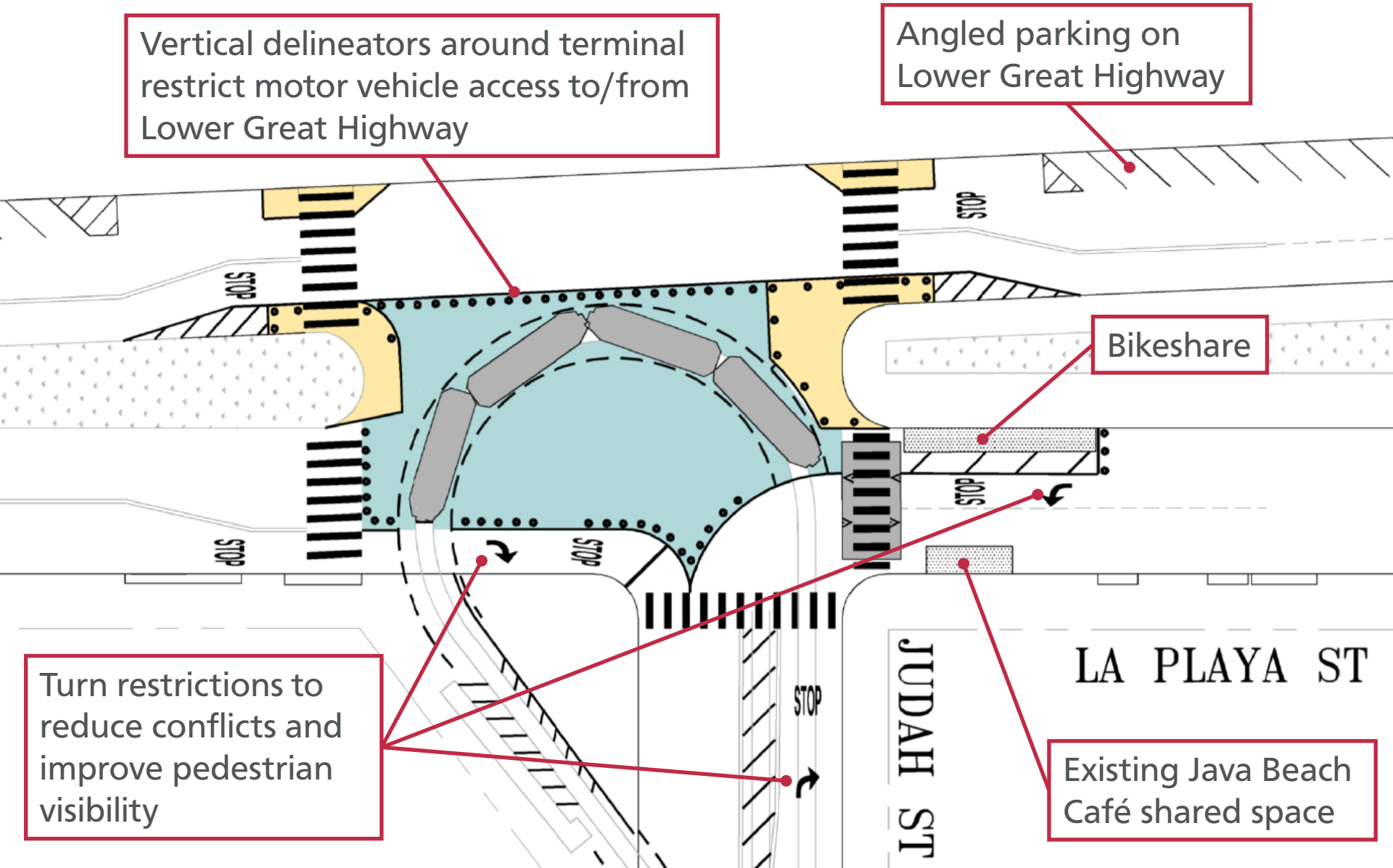

Stakeholder Engagement

Process

- January 2023 onsite review with CPUC
- June 2023 open house
- November 2023 public hearing

Feedback

- Strong interest in pedestrian safety
- Concerns with traffic circulation impacts
- Requests for angled parking on LGH



Improving Safety at the N Judah Turnaround

The SFMTA is planning changes to the N Judah Turnaround at the intersection of Judah and La Playa to address a history of collisions. In addition to preventing vehicles from traveling through the Muni turnaround, the SFMTA is proposing to restrict some vehicle movements to reduce conflicts between vehicles and pedestrians. On-street parking may be added by converting parallel parking to angled parking. A bikeshare station will also be installed on Lower Great Highway at Judah.

There will be no impact to the N Judah stops due to these modifications. You will catch the train from your usual stop.

Questions? TellMuni@SFMTA.com or 415.646.4784 or join us for a Community Open House to learn more at:
Thursday, June 29, 2023. 4–6 PM.
Meet at Judah and La Playa streets.

Judah 和 Lower Great Highway 正在發生一些變化，以便讓大家都更安全，不過巴士站將不會有任何改變。歡迎在 6 月 29 日的開放日，下午 4 點至 6 點來現場瞭解更多詳情。

Upper Great Highway
Lower Great Highway
La Playa
Judah
ONE WAY
1400 Block of La Playa: Options to maintain two-way local traffic or convert to one-way with angled parking
1300 Block of La Playa: Convert to one-way with angled parking along La Playa Park
New bikeshare station
Prevent vehicles from traveling through Muni turnaround

Lower Great Highway – Existing Conditions



Lower Great Highway - Parking Summary

Proposed Parking Changes between Lincoln and Irving

	Existing (parallel both sides)	Proposed (angled on west side only)	Change
Spaces	150	130	-20

Existing

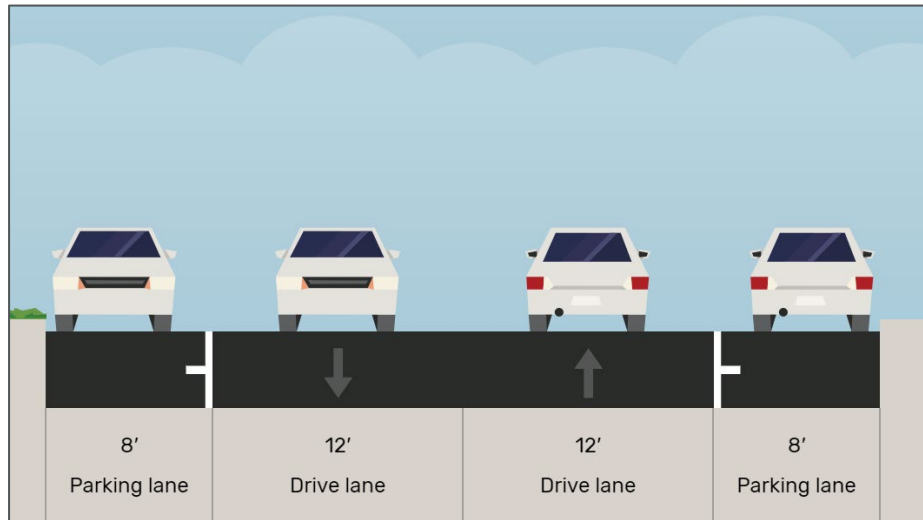

Proposed

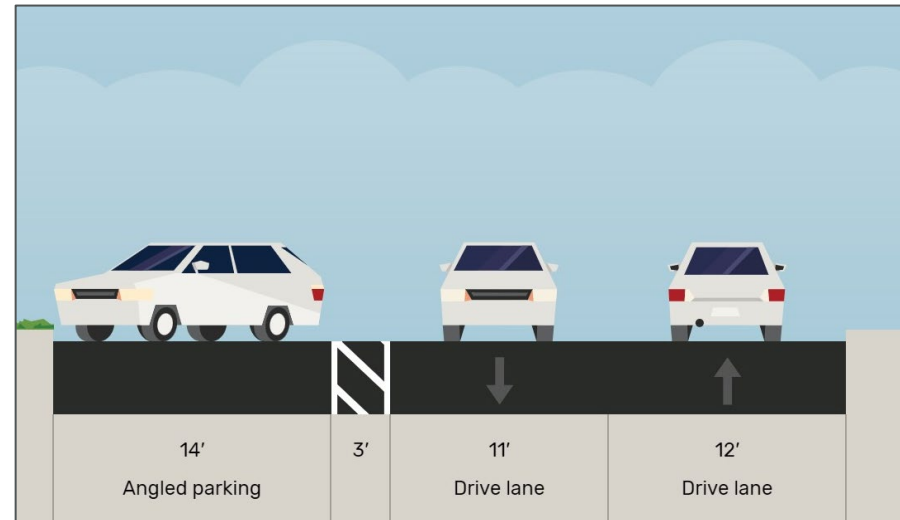

Next Steps

- CPUC approval
- Implement quick-build improvements ~March 2024
- Gather feedback and iterate design changes
- 6-month evaluation



Thank You!



Appendix

Design Presented at June 2023 Open House

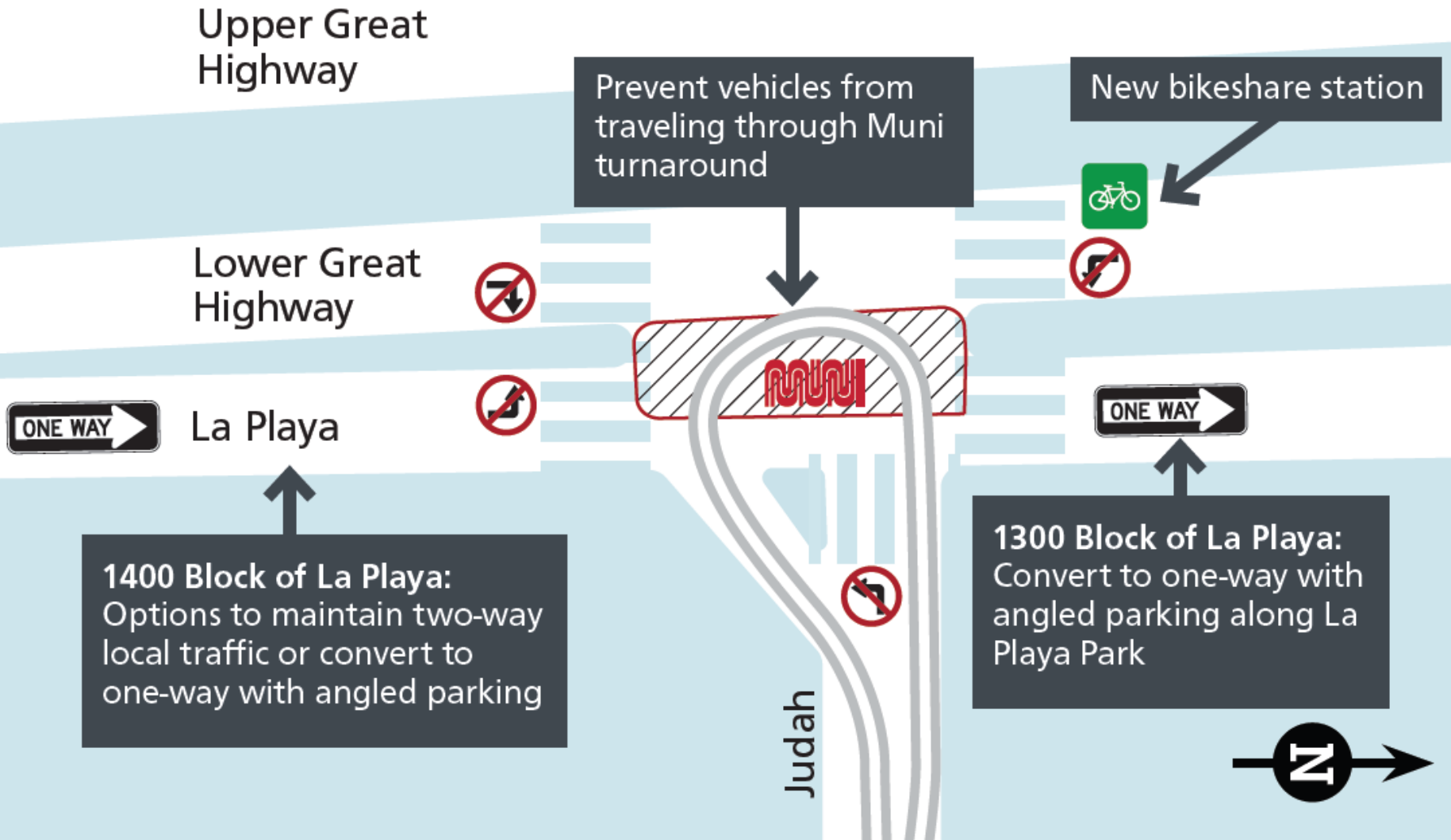

Design Presented at November 2023 Public Hearing

