

## SFMTA - TASC SUMMARY SHEET

<p><b>PreStaff_Date:</b> 1/31/2023</p> <p><b>Requested_by:</b> SFPW</p> <p><b>Handled:</b> Mike Sallaberry</p> <p><b>Section Head :</b> M Sallaberry <i>MS</i></p>	<p><input type="checkbox"/> <b>Public Hearing Consent</b></p> <p><input checked="" type="checkbox"/> <b>Public Hearing Regular</b></p> <p><input type="checkbox"/> <b>Informational / Other</b> <small>PH - Regular</small></p>	<p><b>No objections:</b> _____</p> <p><b>Item Held:</b> _____</p> <p><b>Other:</b> _____</p>
<p><b>Location:</b> Clementina Street, Main Street to Beale Street</p>		
<p><b>Subject:</b> New Alley</p>		
<p><b>PROPOSAL / REQUEST:</b> ESTABLISH - ALLEY Clementina Street between Main Street and Beale Street</p> <p>ESTABLISH - RAISED CROSSWALKS Clementina Street at Beale Street (east crosswalk) Clementina Street, midblock Clemetina Street at Main Street (west crosswalk)</p>		
<p><b>BACKGROUND INFORMATION / COMMENTS</b></p> <p>This proposal is part of the development of Block 3 bounded by Main, Beale, Clementina, and Tehama in the Transit Center District where a new park will be built. This section of Clementina will be built as part of the Transbay Park project as part of a partnership between Public Works, Rec and Park, OCII, and SFMTA.</p> <p>(Supervisor District 6)</p> <p>Mike Sallaberry mike.sallaberry@sfmta.com</p>		
<p><b>HEARING NOTIFICATION AND PROCESSING NOTES:</b></p>	<p><b>ENVIRONMENTAL CLEARANCE BY:</b> <input checked="" type="checkbox"/> SFMTA   <input type="checkbox"/> Attached   <input type="checkbox"/> Pending</p>	
<p><b>CHECK IF PREPARING SEPARATE SFMTA BOARD CALENDAR ITEM FOR PROPOSAL:</b>   <input type="checkbox"/></p>		



Ron Alameida - City Architect  
Jennifer Cooper - Bureau Manager  
49 South Van Ness, San Francisco, CA 94103  
Phone (628) 271-2862

Project \_\_\_\_\_

**Transbay Block 3 Park  
and Streetscape**

250 Main Street

Consultant \_\_\_\_\_

	BUREAU OF ENGINEERING CITY & COUNTY OF SAN FRANCISCO SAN FRANCISCO PUBLIC WORKS 49 SOUTH VAN NESS AVENUE, 8TH FLOOR SAN FRANCISCO, CA 94103	
	DESIGNED BY: JM	DATE: 12/2022
	DRAWN BY: JM	DATE: 12/2022
CHECKED BY:	APPROVED	
SECTION MANAGER:	DATE:	
DEPUTY BUREAU MANAGER:	DATE:	
ACTING BUREAU MANAGER:	DATE:	

Bureau Mgr. \_\_\_\_\_  
Section Mgr. \_\_\_\_\_

**100% DESIGN DEVELOPMENT** 12/16/2022  
**REVISION 1** ISSUE DATE

No.	Date	Revisions

Proj. L.Arch. \_\_\_\_\_  
Designed \_\_\_\_\_  
Drawn \_\_\_\_\_  
Checked \_\_\_\_\_



Drawing Title \_\_\_\_\_

**LEGEND AND ABBREVIATIONS**

Sheet No. **RG1**

Scale: NTS

Project No. \_\_\_\_\_

**LEGEND**

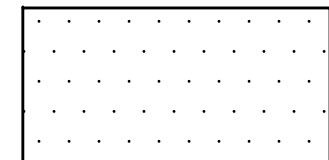

APPROXIMATE AREA TO BE COLD PLANED 2-INCH FULL DEPTH OF CUT AND RESTORED WITH 2-INCH THICK MINIMUM OF ACWS. EXACT LOCATION AND DIMENSIONS TO BE DETERMINED BY THE CITY REPRESENTATIVE IN THE FIELD

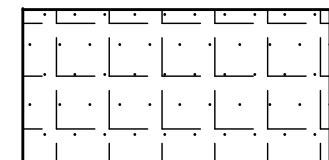

APPROXIMATE AREA TO BE RECONSTRUCTED WITH 2-INCH THICK MINIMUM OF ACWS ON 10-INCH THICK CONCRETE BASE. EXACT LOCATION AND DIMENSIONS TO BE DETERMINED BY THE CITY REPRESENTATIVE IN THE FIELD



APPROXIMATE AREA TO BE RECONSTRUCTED WITH INTEGRAL COLORED SIDEWALK CONCRETE ACCENT BAND (REFER TO L-DWGS FOR ADDITIONAL DETAILS)

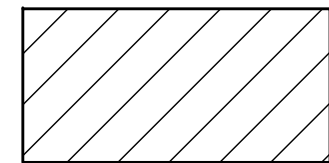

APPROXIMATE AREA TO BE RECONSTRUCTED WITH 8-INCH THICK PARKING STRIP OR GUTTER

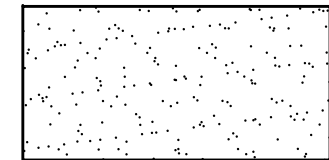

APPROXIMATE AREA TO BE RECONSTRUCTED WITH 10-INCH THICK MINIMUM OF CONCRETE PAVEMENT (REFER TO L-DWGS FOR ADDITIONAL DETAILS)

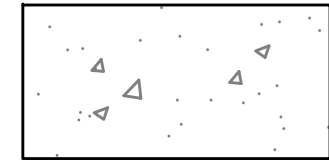

APPROXIMATE AREA OF 3-1/2-INCH THICK CONCRETE SIDEWALK TO BE RECONSTRUCTED WITH REINFORCEMENT AT ENTRANT CORNERS PER SF PUBLIC WORKS STANDARD PLAN 96,608 REV. 1

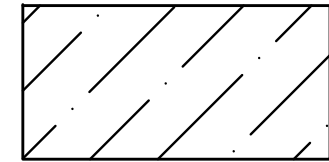

APPROXIMATE AREA TO BE RECONSTRUCTED WITH INTEGRAL COLORED CONCRETE PAVEMENT BAND (REFER TO L-DWGS FOR ADDITIONAL DETAILS)

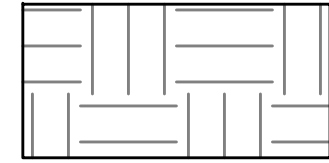

APPROXIMATE AREA TO BE RECONSTRUCTED WITH SAN FRANCISCO FIRE DEPARTMENT RATED SIDEWALK WITH INTEGRAL COLORED SIDEWALK PAVEMENT BANDS (REFER TO L-DWGS FOR ADDITIONAL DETAILS)

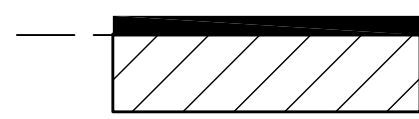

CONSTRUCT COMBINED 6-INCH WIDE CONCRETE CURB AND 2-FOOT WIDE CONCRETE GUTTER



CONSTRUCT 6-INCH WIDE CONCRETE CURB

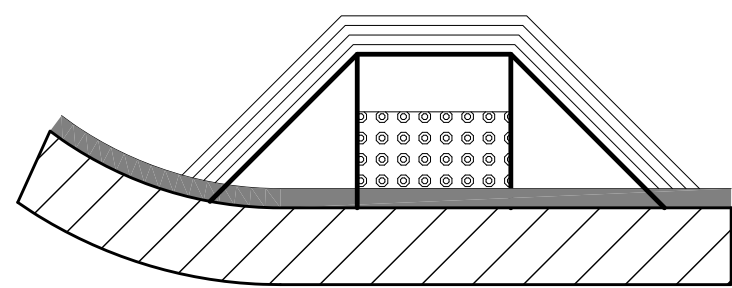

CONCRETE CURB RAMP TO BE CONSTRUCTED WITH 12-INCH WIDE GROOVED BORDERS (WARNING BANDS) AND CONCRETE DETECTABLE SURFACE TILES (TRUNCATED DOMES) PER SF PUBLIC WORKS ACCESSIBLE STREET CROSSING STANDARD PLANS 102,854 THRU 102,864

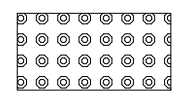

CONCRETE DETECTABLE SURFACE TILES FOR RAISED CROSSWALKS

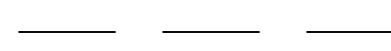

EXISTING CURB/GUTTER/PARKING STRIP/ISLAND

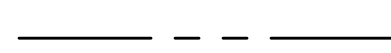

APPROXIMATE LOCATION OF PROPERTY LINE

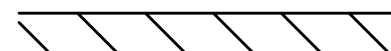

CONFORM LINE



MATCH LINE



SCOPE OF WORK DETAILS

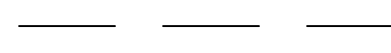

CUT SHEETS

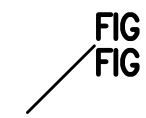

TOP OF CURB OR SIDEWALK OR PAVEMENT ELEVATION  
FLOW LINE/GUTTER OR CATCH BASIN ELEVATION



APPROXIMATE DIMENSIONS, IN FEET, OF CONCRETE BASE RECONSTRUCTION



SECTION/DETAIL IDENTIFICATION  
DRAWING NO.



BENCH MARK



(N) CATCH BASIN



(E) CATCH BASIN TO REMAIN

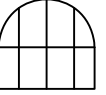

(E) CATCH BASIN TO BE ABANDONED

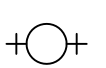

FIRE HYDRANT



FIRE HYDRANT VALVE



GAS VALVE

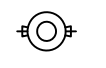

HPFS HYDRANT

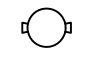

HPFS VALVE



MUNI GUY POLE



PARKING METER



(N) PEDESTRIAN LIGHT POLE



SEWER CLEAN OUT

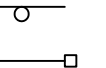

SIGN POLE(S)



(N) STREET LIGHT BOX

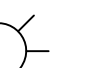

(E) STREET LIGHT POLE

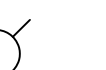

(N) STREET LIGHT POLE

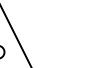

SURVEY CONTROL POINT



TRAFFIC SIGNAL



TREE



UNKNOWN VALVE



WATER VALVE

**ABBREVIATIONS**

AB	ASSESSOR'S BLOCK
AC	ASPHALT CONCRETE
ACWS	ASPHALT CONCRETE WEARING SURFACE
AWSS	AUXILIARY WATER SUPPLY SYSTEM
BC	CURVE BEGINNING
BLDG	BUILDING
BLHP	BUREAU OF LIGHT, HEAT AND POWER
BOT	BOTTOM
BRK	GRADE BREAK
BSW	BACK OF SIDEWALK
BVC	VERTICAL TANGENT-CURVE INTERSECT
C	CURB
CB	CATCH BASIN
CL	CENTER LINE
CO	SANITARY SEWER CLEANOUT/VENT
COMM	COMMUNICATIONS
CONC	CONCRETE
CR	CURB RAMP
C1	CURVE 1, ETC
DT	DEPARTMENT OF TECHNOLOGY
DWG	DRAWING
DWY	DRIVEWAY
(E), EX	EXISTING
EA	EACH
EC	CURVE END
EL, ELEV	ELEVATION
ENT	ENTRANCE
EQ	EQUAL
EVC	VERTICAL CURVE-TANGENT INTERSECT
FA	FIRE ALARM POLE
FH	FIRE HYDRANT
FIG	FIGURE
FL	FLOW LINE
G	GUTTER
GB	GRADE BREAK
GR	GRATE
GV	GAS VALVE
HYD	HYDRANT
HP	HIGH POINT
HPFH	HIGH PRESSURE FIRE HYDRANT
HPFS	HIGH PRESSURE FIRE SERVICE
IRV	IRRIGATION VALVE
LB	LINE BEGINNING

LE	LINE END
LPFH	LOW PRESSURE HIGH HYDRANT
L1	LINE 1, ETC
MAX	MAXIMUM
MIN	MINIMUM
MFN	METROMEDIA FIBER OPTIC CABLE NETWORK
MH	MANHOLE
MTR	METER
MON	MONUMENT
(N)	NEW
N/A	NOT APPLICABLE
NO.	NUMBER
NIC	NOT IN CONTRACT
NTS	NOT TO SCALE
OCS	OVERHEAD CONTACT SYSTEM
OG	OUTSIDE GUTTER
PB	PULL BOX
PC	PROPERTY CORNER
PCC	POINT OF HORIZONTAL COMPOUND CURVE/ COMPOUND CURVE-CURVE INTERSECT
PI	POINT OF INTERSECTION/ TANGENT-TANGENT INTERSECT
PL	PROPERTY LINE
POC	POINT OF CURVATURE/ TANGENT-CURVE INTERSECT
PRC	POINT OF HORIZONTAL REVERSE CURVE/ REVERSE CURVE-CURVE INTERSECT
PT	POINT OF TANGENCY/ CURVE-TANGENT INTERSECT
PVI	POINT OF VERTICAL INTERSECTION
REF PT	REFERENCE POINT
REV	REVISION
ROW	RIGHT-OF-WAY
S, SW	SEWER
SWLK	SIDEWALK
SL	STREET LIGHTING
STA	STATION
TS	TRAFFIC SIGNAL
TYP	TYPICAL
UNK	UNKNOWN
USPS	UNITED STATES POSTAL SERVICE
UTIL	UTILITY
WM	WATER METER
WV	WATER VALVE



## GENERAL NOTES

1. THE CONTRACTOR IS RESPONSIBLE FOR CHECKING ALL CONTRACT DOCUMENTS AND FIELD CONDITIONS, AND FOR CONFIRMING THAT THE WORK IS BUILDABLE AS SHOWN BEFORE PROCEEDING WITH THE WORK. THE CONTRACTOR IS RESPONSIBLE FOR OBTAINING CLARIFICATION FROM THE CITY BEFORE PROCEEDING WITH THE WORK IN QUESTION OR RELATED WORK. WRITTEN DIMENSIONS SHALL GOVERN. THE CONTRACTOR SHALL VERIFY ALL DIMENSIONS PRIOR TO PROCEEDING WITH THE WORK.
2. THE CONTRACTOR SHALL VERIFY EXISTING FACILITIES IN THE FIELD, WHETHER OR NOT THEY ARE SHOWN ON THE DRAWINGS.
3. THE CONTRACTOR IS RESPONSIBLE FOR WORKING AROUND AND PROTECTING ALL EXISTING FACILITIES ADJACENT TO THE WORK AREA. THESE FACILITIES INCLUDE, BUT ARE NOT LIMITED TO, THE FOLLOWING: CABLE CAR TRACKS, TREES, LANDSCAPING, HYDRANTS AND UTILITY POLES.
4. THE CONTRACTOR IS RESPONSIBLE FOR COORDINATING ALL WORK UNDER THIS CONTRACT TO AVOID REDUNDANCY BETWEEN PAVING/CURB RAMP WORK AND SEWER AND/OR WATER WORK OR OTHER UTILITY REQUIRED TRENCH RESTORATION.
5. CONFORM LINE SHALL BE FIVE (5) FEET BEYOND THE EXTENDED PROPERTY LINE UNLESS OTHERWISE INDICATED ON THE DRAWINGS OR AS DIRECTED BY THE CITY REPRESENTATIVE.
6. THE THICKNESS OF THE NEW ASPHALT CONCRETE WEARING SURFACE (ACWS) SHALL BE TWO (2) INCHES MINIMUM UNLESS OTHERWISE INDICATED ON THE DRAWINGS OR AS DIRECTED BY THE CITY REPRESENTATIVE.
7. CURB GRADE SHALL BE SIX (6) INCHES ABOVE THE ADJACENT PAVEMENT GRADE OR GUTTER GRADE UNLESS OTHERWISE INDICATED ON THE DRAWINGS OR AS DIRECTED BY THE CITY REPRESENTATIVE.
8. WHEN EXISTING AND NEW ELEVATIONS ARE GIVEN FOR THE SAME POINT, THE CONTRACTOR SHALL CONSTRUCT TO NEW ELEVATIONS. UNLESS OTHERWISE DIRECTED BY THE CITY REPRESENTATIVE, THE EXISTING ELEVATIONS ARE FOR INFORMATION ONLY.
9. STANDARD DETAILS AND INFORMATION SHALL BE USED FOR ALL APPLICABLE CASES UNLESS OTHERWISE INDICATED.
10. CROSS SECTION CALL-OUTS ARE SHOWN ONLY ONCE ON THE DRAWINGS AND ARE TYPICAL FOR SIMILAR CONDITIONS UNLESS OTHERWISE INDICATED.
11. EXISTING CATCHBASIN GRADE SHALL BE ADJUSTED IN THE FIELD TO CONFORM TO NEW GUTTER GRADE.
12. NEW GUTTER AND/OR PARKING STRIP SHALL CONFORM TO EXISTING PAVEMENT UNLESS OTHERWISE INDICATED.
13. THE LIMITS OF SIDEWALK RECONSTRUCTION SHOWN ON THE DRAWINGS ARE APPROXIMATE. THE CONTRACTOR SHALL SAWCUT TO THE NEAREST FLAG/JOINT AND MATCH THE EXISTING SCORE PATTERN UNLESS OTHERWISE INDICATED ON THE DRAWINGS OR AS DIRECTED BY THE CITY REPRESENTATIVE.
14. ALL UTILITY VAULTS AND PULL BOXES WITHIN THE SIDEWALK RECONSTRUCTION AREA SHALL BE ADJUSTED TO THE NEW GRADE.
15. FOR ALL TRAFFIC SIGNAL PULL BOXES THAT ARE ROTATED, RELOCATED OR ADJUSTED, THE CONTRACTOR SHALL CONTACT MTA TRAFFIC SIGNAL SHOP NILESH RAM AT LEAST THREE (3) DAYS PRIOR TO SETTING THE PULL BOX AT THE NEW LOCATION AND/OR GRADE. ALL WORK SHALL MEET REQUIREMENTS OF SFDPW STANDARD PLAN 87,201
16. THE 12-INCH WIDE GROOVED BORDERS (WARNING BANDS) ON CURB RAMPS SHALL NOT BE PART OF THE SLOPED RAMP AND WING SURFACES UNLESS OTHERWISE INDICATED.
17. CURB RAMPS WITH GRADE BREAKS SHALL HAVE A BACK OF CURB (BOC) ELEVATION OF 0.01 FEET HIGHER THAN THE SPECIFIED FACE OF CURB (FOC) ELEVATION. CURB RAMPS WITHOUT GRADE BREAKS SHALL HAVE A MAXIMUM BACK OF CURB (BOC) ELEVATION OF 0.04 FEET HIGHER THAN THE FACE OF CURB (FOC) ELEVATION.
18. ELEVATIONS SHOWN ON CURB RAMP DETAILS ARE MEASURED IN FEET AND ARE RELATIVE TO A LOCAL REFERENCE POINT (TOP OF FIRE HYDRANT IN MOST CASES) UNLESS OTHERWISE INDICATED.
19. ASPHALT CONCRETE PATCHING AROUND NEW GUTTERS AND/OR PARKING STRIPS AT CURB RETURNS SHALL BE CONSIDERED AS INCIDENTAL WORK TO THE CURB RAMP BID ITEM.
20. CONCRETE BASE WORK SHOWN ON CURB RAMP DETAILS MAY OVERLAP WITH THE SAME WORK SHOWN ON PAVEMENT PLANS. THE CONTRACTOR SHALL COORDINATE OVERALL PAVING WORK TO AVOID PERFORMING DUPLICATE WORK.

21. ANY POLES OR VERTICAL ELEMENTS INSTALLED OR RELOCATED NEAR FIRE HYDRANTS SHALL ADHERE TO THE FOLLOWING MINIMUM CLEARANCES: THE MINIMUM CLEARANCE BETWEEN A POLE OR VERTICAL ELEMENT TO A HIGH PRESSURE HYDRANT IS FIVE (5) FEET. THE MINIMUM CLEARANCE BETWEEN A POLE OR VERTICAL ELEMENT TO A LOW PRESSURE HYDRANT IS FIVE (5) FEET.
22. ALL CITY MONUMENTS MUST BE PROTECTED PER STATE LAND SURVEYORS ACT. CALL THE COUNTY SURVEYOR AT (628)271-2132 TO REPORT ANY MONUMENTS IN DANGER OF DISTURBANCE, DESTRUCTION OR REMOVAL.
23. CONTRACTOR SHALL AVOID DAMAGING AND PROTECT IN PLACE EXISTING GRANITE CURBS. CONTRACTOR SHALL NOTIFY CITY REPRESENTATIVE OF ANY GRANITE CURB NOT IDENTIFIED ON THE PLANS TO BE RESET OR SALVAGED THAT IS IN CONFLICT WITH PROPOSED WORK.
24. EXISTING GRANITE CURB SHALL ONLY BE REPLACED WITH CONCRETE CURB ON CURVED RETURNS AND AS PART OF CURB RAMP CONSTRUCTION. EXISTING GRANITE CURB IN GOOD CONDITION SHALL BE RESET TO NEW GRADE. IF EXISTING GRANITE CURB IS DAMAGED, CONTRACTOR SHALL NOTIFY CITY REPRESENTATIVE.
25. IN THE EVENT COBBLESTONES ARE ENCOUNTERED AND TO BE REMOVED IN ANY STREET UNDER CONSTRUCTION, THE CONTRACTOR SHALL REMOVE THEM FROM THE PROJECT SITE AS CITY PROPERTY. SALVAGE, HAULING AND DELIVERY OF EXISTING COBBLESTONES TO THE DESIGNATED AREAS, FROM THE PROJECT SITE, SHALL BE DONE AS INCIDENTAL WORK.
26. IN THE EVENT GROUNDWATER WELLS ARE ENCOUNTERED IN ANY STREET UNDER CONSTRUCTION, THE CONTRACTOR SHALL BE RESPONSIBLE FOR GROUNDWATER WELL PRESERVATION (OR DESTRUCTION, IF DESTRUCTION IS CALLED FOR). FOR PRESERVATION, THE CONTRACTOR SHALL EXERCISE CARE IN WORKING AROUND GROUNDWATER WELLS TO PREVENT DAMAGE.
27. AT THE COMPLETION OF WORK, THE CONTRACTOR SHALL REMOVE ALL MARKS, STAINS AND BLEMISHES RESULTING FROM CONSTRUCTION OPERATIONS THROUGHOUT THE CONTRACT.
28. THE CONTRACTOR SHALL PREVENT CONSTRUCTION MATERIAL, PAVEMENT, CONCRETE, EARTH, PAINTS, THINNER, SOLVENTS, AND OTHER DEBRIS OR TOXIC MATERIAL FROM ENTERING A SEWER OR SEWER STRUCTURE INCLUDING SURFACE FLOW COLLECTION SYSTEM, SUCH AS CATCHBASINS AND CULVERTS.
29. THE CONTRACTOR IS RESPONSIBLE FOR CONTACTING PUBLIC AND PRIVATE UTILITIES FOR UTILITY ADJUSTMENT AND/OR RELOCATION. THE FOLLOWING ARE CONTACT PHONE NUMBERS:

BLHP	STREET LIGHTS		(415) 227-8506	Streetlights@sfgov.org
DPW	NEWS RACKS	NAHEL SIMON	(628) 271-2098	
	STREET TREES (URBAN FORESTRY)		(415) 641-2676	
DT	FIRE ALARM	JOSHUA UUSITALO	(415) 517-2360	Joshua.Uusitalo@sfgov.org
MTA	MUNI OVERHEAD LINES	JOHN ORKES	(415) 554-9227	
		CLIFFORD SMETHURST	(415) 554-9220	
	TRAFFIC SIGNAL SHOP	NILESH RAM	(415) 401-3704	Nilesh.Ram@sfmta.com
	TRAFFIC SIGNAL EMERGENCY NO.		(415) 401-3700	
	BUS SHELTERS	GAIL STEIN	(415) 646-2308	
SFPUC	SEWER REPAIR		(415) 695-2096	
SFPUC	SEWER REPAIR		(415) 695-2096	
SFWD	BUSINESS HOURS REPAIRS		(415) 550-4965	
	NON-BUSINESS HOURS REPAIRS		(415) 550-4911	
	IDENTIFY LINES		(415) 550-4925	
AT&T		LYNN SCHUSSEL	(650) 991-5630	LS4524@att.com
		MARIA TORRES	(650) 216-2196	MT1276@att.com
		CAROL MITCHELL		CM1463@att.com
COMCAST		JEFF CASTANEDA	(415) 377-1921	Jeff_Castaneda@cable.comcast.com
		DEREK NIPPE	(415) 503-4505	
PG&E	SERVICE PLANNING	DANA SOUZA	(415) 757-8485	D2GV@pge.com
	CONSTRUCTION	BILL RUSSO	(415) 695-3330	
CLEAR CHANNEL (BUS SHELTERS)		NICHOLAS FAGUNDES	(925) 518-7042	NicholasFagundes.ncs@comcast.net
		ASHLEY KIRCHNER	(510) 446-7259	AshleyKirchner.ncs@comcast.net
		MARGEUX CASILLAS		MargeauxCasillas@clearchannel.com
ZAYO/ABOVENET (MFN FACILITIES)		ALLEN LEHEW	(415) 265-3189	Allen.Lehew@zayo.com
WAVE (ASTOUND)		KEN HAWKINS	(925) 332-7806	khawkins@wavebroadband.com
USPS	MAILBOXES		(415) 550-5248	



Ron Alameida - City Architect  
Jennifer Cooper - Bureau Manager  
49 South Van Ness, San Francisco, CA 94103  
Phone (628) 271-2862

Project \_\_\_\_\_

### Transbay Block 3 Park and Streetscape

250 Main Street

Consultant \_\_\_\_\_

	BUREAU OF ENGINEERING CITY & COUNTY OF SAN FRANCISCO SAN FRANCISCO PUBLIC WORKS 49 SOUTH VAN NESS AVENUE, 8TH FLOOR SAN FRANCISCO, CA 94103	
	DESIGNED BY: JM	DATE: 12/2022
DRAWN BY: JM	DATE: 12/2022	
CHECKED BY:		
APPROVED		
SECTION MANAGER:		DATE:
DEPUTY BUREAU MANAGER:		DATE:
ACTING BUREAU MANAGER:		DATE:

Bureau Mgr. \_\_\_\_\_  
Section Mgr. \_\_\_\_\_

100% DESIGN DEVELOPMENT 12/16/2022  
REVISION 1 ISSUE DATE

No.	Date	Revisions

Proj. L.Arch. \_\_\_\_\_  
Designed \_\_\_\_\_  
Drawn \_\_\_\_\_  
Checked \_\_\_\_\_



Drawing Title \_\_\_\_\_

## GENERAL NOTES

Sheet No. RG2

Scale: NTS  
Project No. \_\_\_\_\_

Project No.





Ron Alameida - City Architect  
Jennifer Cooper - Bureau Manager  
49 South Van Ness, San Francisco, CA 94103  
Phone (628) 271-2862

Project \_\_\_\_\_

**Transbay Block 3 Park  
and Streetscape**

250 Main Street

Consultant \_\_\_\_\_

	BUREAU OF ENGINEERING CITY & COUNTY OF SAN FRANCISCO SAN FRANCISCO PUBLIC WORKS 49 SOUTH VAN NESS AVENUE, 8TH FLOOR SAN FRANCISCO, CA 94103	
	DESIGNED BY: JM	DATE: 12/2022
DRAWN BY: JM	DATE: 12/2022	
CHECKED BY:		
APPROVED		
SECTION MANAGER:		DATE:
DEPUTY BUREAU MANAGER:		DATE:
ACTING BUREAU MANAGER:		DATE:

Bureau Mgr. \_\_\_\_\_  
Section Mgr. \_\_\_\_\_

100% DESIGN DEVELOPMENT 12/16/2022  
REVISION 1 ISSUE DATE

No.	Date	Revisions

Proj. L.Arch. \_\_\_\_\_  
Designed \_\_\_\_\_  
Drawn \_\_\_\_\_  
Checked \_\_\_\_\_

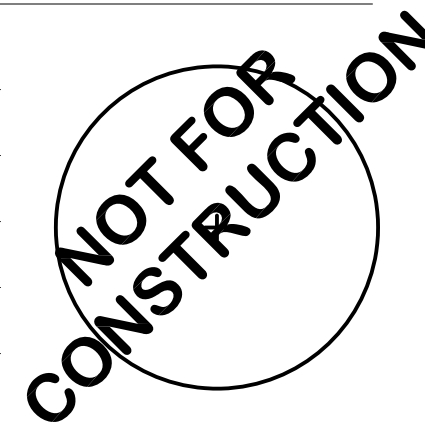

Drawing Title \_\_\_\_\_

**PROJECT CONTROL DATA**

Sheet No. **PC1**

Scale: NTS

Project No. \_\_\_\_\_

**BASIS OF SURVEY:**  
(PROJECT DATUMS, REFERENCE SYSTEMS & PROJECTION)

**DATUM:** NORTH AMERICAN DATUM OF 1983: NAD83 (2011) 2010.00 EPOCH

**REFERENCE NETWORK:** "CCSF-2013 HPN" (HIGH PRECISION NETWORK PER RECORD OF SURVEY #8080)

**PROJECTION:**

THE PLANE COORDINATES ARE BASED ON A LOCAL GRID COORDINATE SYSTEM KNOWN AS THE CITY & COUNTY OF SAN FRANCISCO 2013 COORDINATE SYSTEM (CCSF-CS13). THE CCSF-CS13 IS A LOW DISTORTION TRANSVERSE MERCATOR PROJECTION. WITHIN THE CITY, THE COMBINED GRID FACTOR IS GENERALLY LESS THAN 1/100,000. THE ORIGIN AND CENTRAL MERIDIAN LOCATED NEAR THE CENTER OF THE CITY. SEE RECORD OF SURVEY #8080 RECORDED IN BOOK EE OF SURVEY MAPS, PAGE 147-157, IN THE CITY AND COUNTY RECORDER FOR THE CITY AND COUNTY OF SAN FRANCISCO AND THE CCSF PW WEB SITE (<http://SFPUBLICWORKS.ORG/CCSF-GEODETIC-NETWORK>) FOR PROJECTION PARAMETERS.

**HORIZONTAL CONTROL:**

THE HORIZONTAL DATUM WAS RECOVERED BASED ON HPN CCSF-CS13, HPND CCSF-CS13 SURVEY POINTS/MONUMENTS AND CCSF-CS13 SURVEY CONTROL POINTS LISTED IN THE SURVEY CONTROL TABLE SHOWN HEREON AND OR DESCRIBED ON THE CCSF PW WEB SITE (<http://SFPUBLICWORKS.ORG/CCSF-GEODETIC-NETWORK>).

**VERTICAL DATUM:** "CCSF 2013 NAVD88 VERTICAL DATUM" (SF-VD13)

**REFERENCE NETWORK:** "CCSF 2013 HIGH PRECISION LEVELING NETWORK"

**VERTICAL CONTROL:**

THE VERTICAL DATUM WAS RECOVERED BASED ON HPN, CCSF-VD13, HPND CCSF-VD13, CCSF-VD13 SURVEY POINTS/MONUMENTS/BENCHMARKS AND CCSF-VD13 SURVEY CONTROL POINTS LISTED IN THE SURVEY CONTROL TABLE SHOWN HEREON AND OR DESCRIBED ON THE CCSF PW WEB SITE (<http://SFPUBLICWORKS.ORG/CCSF-GEODETIC-NETWORK>).

**GENERAL NOTES:**

(1) ALL DISTANCES WITHIN THE DRAWING ARE BASED UPON THE US SURVEY FOOT AND DECIMALS THEREOF AND ARE GROUND DISTANCES.

(2) ABOVE GROUND EVIDENCE OF UTILITIES WAS FIELD LOCATED AND IS SHOWN ON THIS SHEET. SUBSURFACE UTILITY INFORMATION WAS NOT PROVIDED. VERIFICATION OF THIS INFORMATION SHOULD BE CONSIDERED MANDATORY IF TO BE USED FOR DESIGN PURPOSES.

(3) ALL CITY MONUMENTS SHOWN HEREON MUST BE PROTECTED PER STATE LAND SURVEYOR ACT AND CITY & COUNTY STANDARDS SPECIFICATIONS SECTION 107.09. PLEASE CALL SURVEYS AT (415) 554-5827 TO REPORT ANY MONUMENTS IN DANGER OF DESTRUCTION OR REMOVAL.

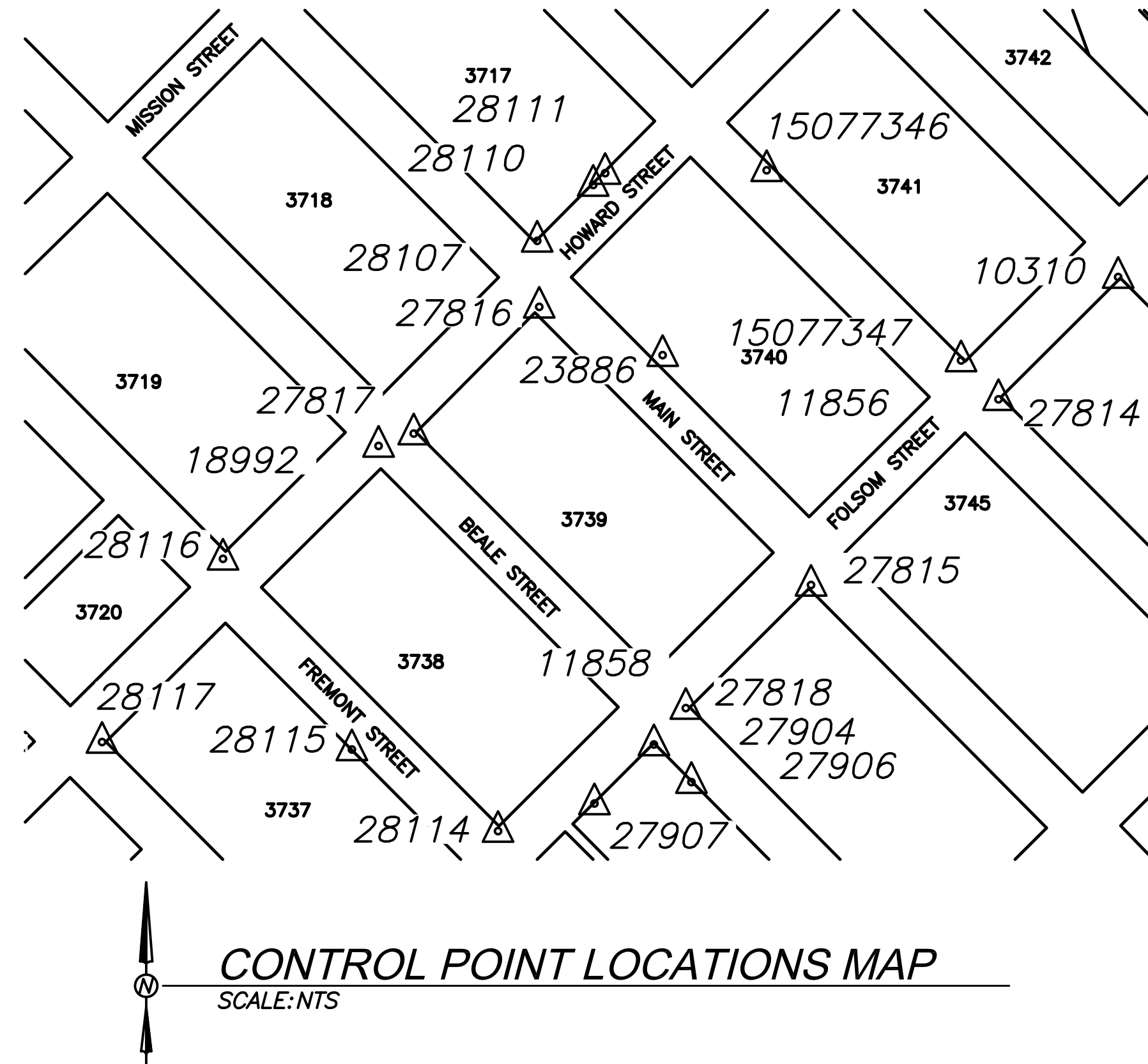

**CONTROL POINT LOCATIONS MAP**  
SCALE: NTS

SURVEY CONTROL POINTS TABLE				
POINT #	NORTHING	EASTING	ELEVATION	DESCRIPTION
265	93807.110	175022.780	10.048	FND MONUMENT GEODETIC ANCHOR SCREW & WASH TRAV
266	94274.940	174576.140	9.076	FND MONUMENT GEODETIC ANCHOR SCREW & WASH TRAV
10310	93537.478	174787.238	11.362	FND MONUMENT GEODETIC BRASS DISK TRAV
11856	93387.483	174534.565	11.300	FND MONUMENT GEODETIC ANCHOR SCREW & WASH SIDESHOT
11858	92882.632	174030.024	21.839	FND MONUMENT GEODETIC ANCHOR SCREW & WASH SIDESHOT
11859	92581.315	173832.641	31.421	FND MONUMENT GEODETIC ANCHOR SCREW & WASH SIDESHOT
11860	92328.515	173578.891	41.917	FND MONUMENT GEODETIC ANCHOR SCREW & WASH SIDESHOT
11861	91992.763	173241.289	50.353	FND MONUMENT GEODETIC ANCHOR SCREW & WASH TRAV
11862	91636.921	172882.085	54.014	FND MONUMENT GEODETIC ANCHOR SCREW & WASH TRAV
18992	93262.200	173581.304	12.572	FND MONUMENT BOUNDARY LPBT IN WELL SIDESHOT
18993	92755.624	173070.874	19.091	FND MONUMENT BOUNDARY LPBT IN WELL SIDESHOT
23870	91681.587	172927.045	53.673	FND MONUMENT BOUNDARY BRASS DISK SIDESHOT
23873	92324.487	173569.668	42.004	FND MONUMENT BOUNDARY BRASS DISK TRAV
23886	93422.003	174006.065	13.187	FND MONUMENT BOUNDARY BRASS DISK SIDESHOT
23888	92581.394	173825.340	31.334	FND MONUMENT BOUNDARY BRASS DISK TRAV

SURVEY CONTROL POINTS TABLE				
POINT #	NORTHING	EASTING	ELEVATION	DESCRIPTION
27367	94199.833	172646.053	12.077	FOUND MAG & WASHER STAMPED "CCSF REF MON DO NOT DISTURB" IN BRICK
27814	93338.256	174592.018	11.409	SET MONUMENT BNDRY REF MAG NAIL & WASH TRAV
27815	93035.994	174284.856	16.840	SET MONUMENT BNDRY REF MAG NAIL & WASH TRAV
27816	93486.261	173837.634	11.205	SET MONUMENT BNDRY REF MAG NAIL & WASH TRAV
27817	93282.694	173636.921	13.132	SET MONUMENT BNDRY REF MAG NAIL & WASH TRAV
27818	92835.315	174080.589	21.660	SET MONUMENT BNDRY REF MAG NAIL & WASH TRAV
27904	92775.595	174030.295	22.385	FND MONUMENT BOUNDARY BLDG CUT 2FACE
27906	92714.314	174091.339	22.306	FND MONUMENT BOUNDARY BLDG CUT 2FACE
27907	92679.456	173933.300	27.247	FND MONUMENT BOUNDARY BLDG CUT 2FACE
28107	93596.460	173839.915	12.755	FND MONUMENT BOUNDARY BLDG CUT SIDESHOT
28110	93687.447	173931.213	12.610	FND MONUMENT BOUNDARY BLDG CUT 2FACE
28111	93706.825	173950.712	12.934	FND MONUMENT BOUNDARY BLDG CUT 2FACE
28114	92634.552	173776.103	31.685	SET MONUMENT BNDRY REF MAG NAIL & WASH TRAV
28115	92767.499	173537.728	24.103	SET MONUMENT BNDRY REF MAG NAIL & WASH TRAV
28116	93078.227	173327.597	15.368	SET MONUMENT BNDRY REF MAG NAIL & WASH TRAV





Ron Alameida - City Architect  
Jennifer Cooper - Bureau Manager  
49 South Van Ness, San Francisco, CA 94103  
Phone (628) 271-2862

Project \_\_\_\_\_

**Transbay Block 3 Park and Streetscape**

250 Main Street

Consultant \_\_\_\_\_

	BUREAU OF ENGINEERING CITY & COUNTY OF SAN FRANCISCO SAN FRANCISCO PUBLIC WORKS 49 SOUTH VAN NESS AVENUE, 8TH FLOOR SAN FRANCISCO, CA 94103	
	DESIGNED BY: JM	DATE: 12/2022
	DRAWN BY: JM	DATE: 12/2022
CHECKED BY:	APPROVED	
SECTION MANAGER:	DATE:	
DEPUTY BUREAU MANAGER:	DATE:	
ACTING BUREAU MANAGER:	DATE:	

Bureau Mgr. \_\_\_\_\_  
Section Mgr. \_\_\_\_\_

100% DESIGN DEVELOPMENT 12/16/2022  
REVISION 1 ISSUE DATE

No.	Date	Revisions

Proj. L.Arch. \_\_\_\_\_  
Designed \_\_\_\_\_  
Drawn \_\_\_\_\_  
Checked \_\_\_\_\_



Drawing Title \_\_\_\_\_

PROJECT CONTROL DATA

Sheet No. **PC2**

Scale: 1" = 40'-0"

Project No. \_\_\_\_\_

Project No. \_\_\_\_\_

Drawing name: V:\10891\_Transbay\_Park\2\_Design\Working\_Drawings\ESH\Current\Control Line-Park.dwg Plotted on: Dec 14, 2022 - 7:31am

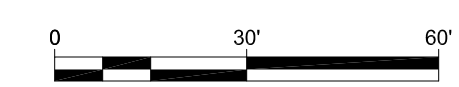
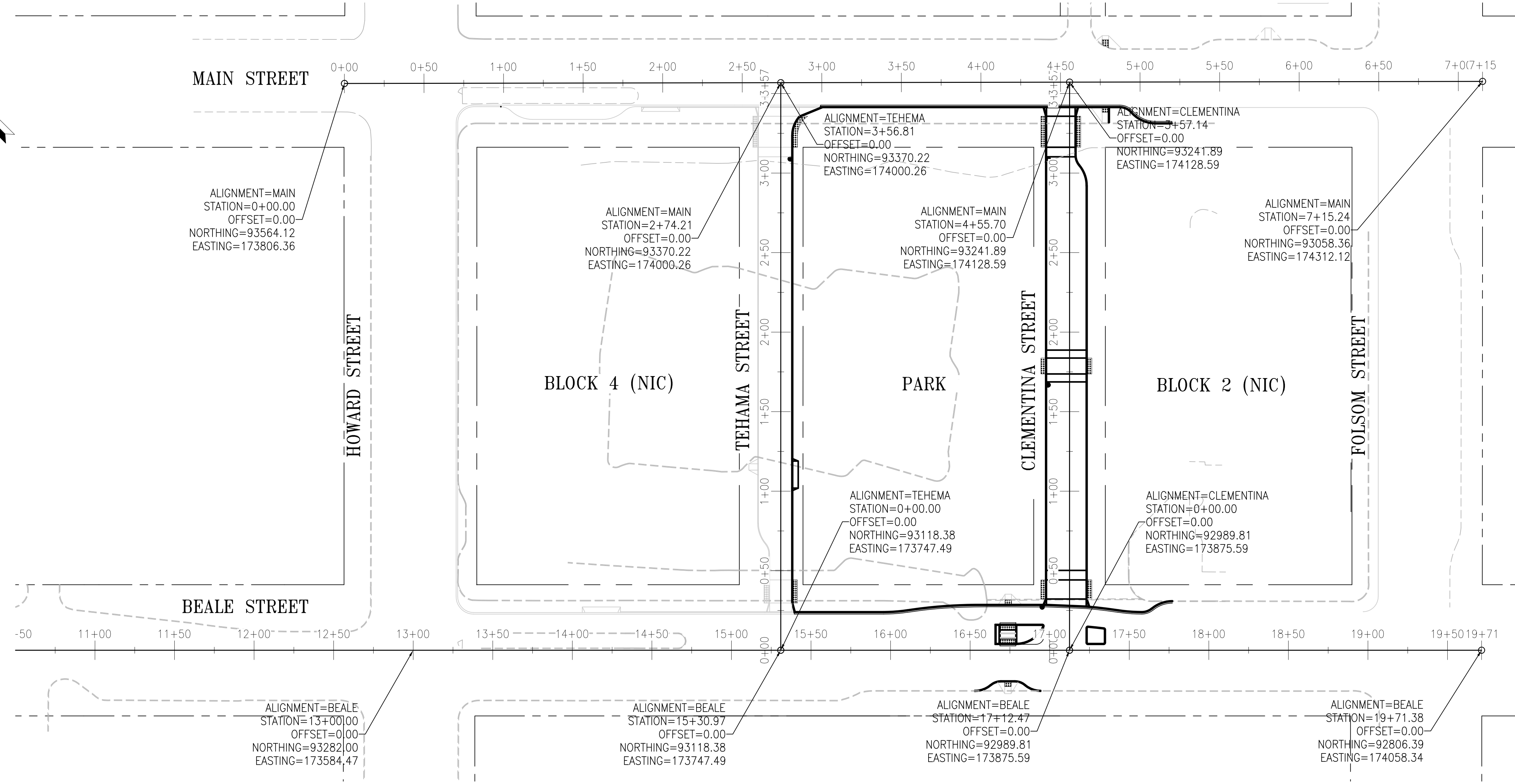
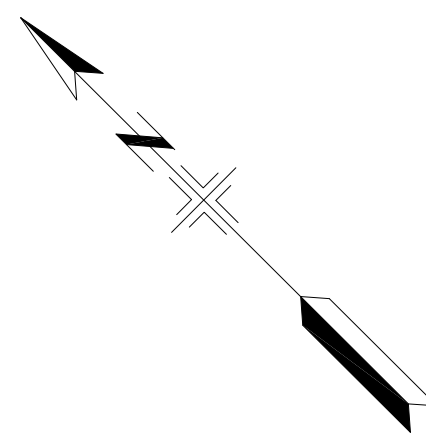





Ron Alameida - City Architect  
Jennifer Cooper - Bureau Manager  
49 South Van Ness, San Francisco, CA 94103  
Phone (628) 271-2862

Project

Transbay Block 3 Park and Streetscape

250 Main Street

Consultant

	BUREAU OF ENGINEERING CITY & COUNTY OF SAN FRANCISCO SAN FRANCISCO PUBLIC WORKS 49 SOUTH VAN NESS AVENUE, 8TH FLOOR SAN FRANCISCO, CA 94103	
	DESIGNED BY: JM	DATE: 12/2022
	DRAWN BY: JM	DATE: 12/2022
	CHECKED BY:	
APPROVED		
SECTION MANAGER:	DATE:	
DEPUTY BUREAU MANAGER:	DATE:	
ACTING BUREAU MANAGER:	DATE:	

Bureau Mgr.  
Section Mgr.

100% DESIGN DEVELOPMENT 12/16/2022  
REVISION 1 ISSUE DATE

No.	Date	Revisions

Proj. L.Arch.  
Designed  
Drawn  
Checked

Drawing Title

LAYOUT PLAN

Sheet No. **R1**

Scale: 1" = 20'-0"

Project No.

Project No.

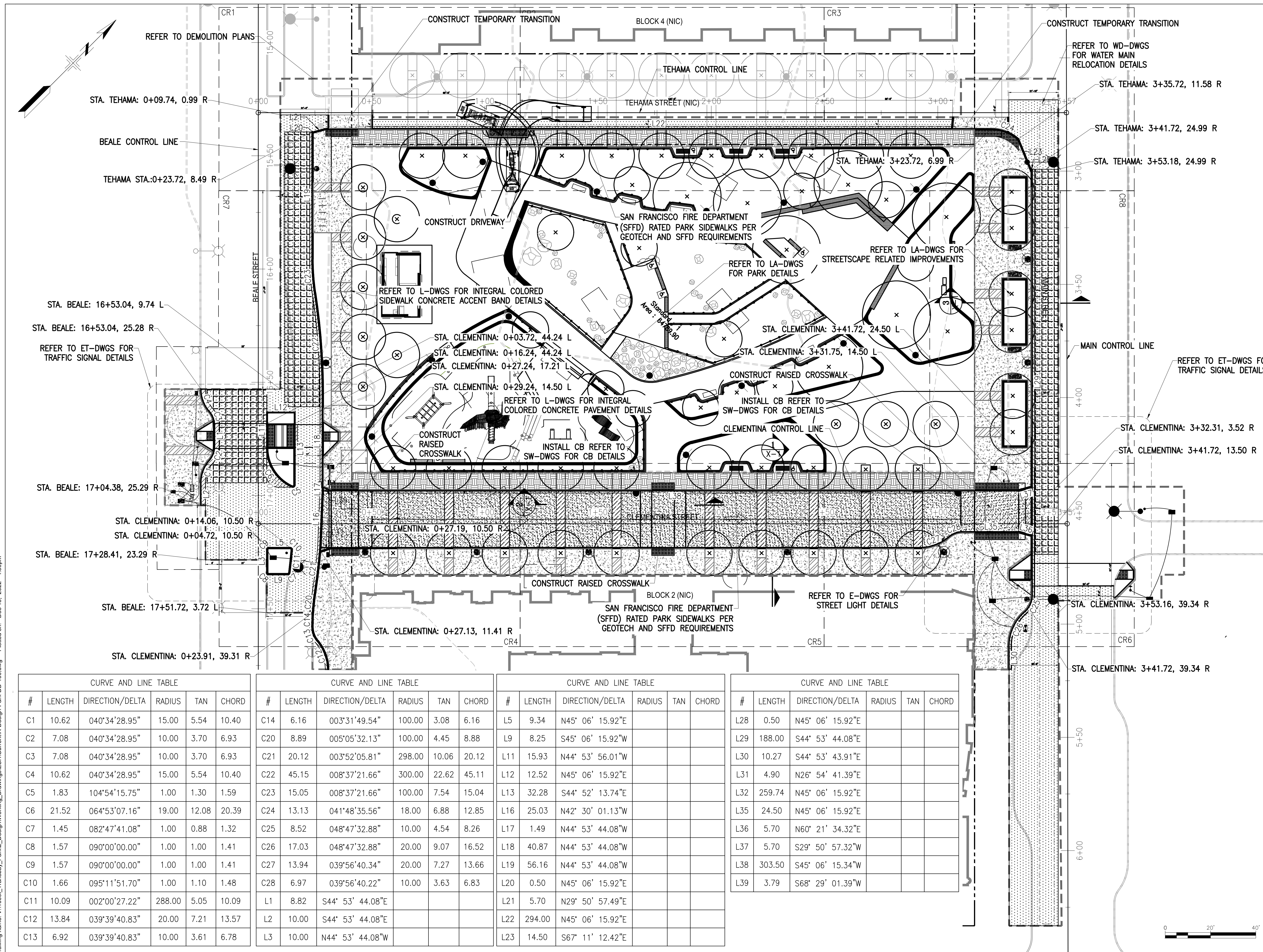

Drawing name: V:\10991\_Transbay\_Park\2\_Design\Working\_Drawings\ESH\CurrentR-Design-Park-DD-100.dwg Plotted on: Dec 15, 2022 - 4:50pm

#	LENGTH	DIRECTION/DELTA	RADIUS	TAN	CHORD
C1	10.62	040°34'28.95"	15.00	5.54	10.40
C2	7.08	040°34'28.95"	10.00	3.70	6.93
C3	7.08	040°34'28.95"	10.00	3.70	6.93
C4	10.62	040°34'28.95"	15.00	5.54	10.40
C5	1.83	104°54'15.75"	1.00	1.30	1.59
C6	21.52	064°53'07.16"	19.00	12.08	20.39
C7	1.45	082°47'41.08"	1.00	0.88	1.32
C8	1.57	090°00'00.00"	1.00	1.00	1.41
C9	1.57	090°00'00.00"	1.00	1.00	1.41
C10	1.66	095°11'51.70"	1.00	1.10	1.48
C11	10.09	002°00'27.22"	288.00	5.05	10.09
C12	13.84	039°39'40.83"	20.00	7.21	13.57
C13	6.92	039°39'40.83"	10.00	3.61	6.78

#	LENGTH	DIRECTION/DELTA	RADIUS	TAN	CHORD
C14	6.16	003°31'49.54"	100.00	3.08	6.16
C20	8.89	005°05'32.13"	100.00	4.45	8.88
C21	20.12	003°52'05.81"	298.00	10.06	20.12
C22	45.15	008°37'21.66"	300.00	22.62	45.11
C23	15.05	008°37'21.66"	100.00	7.54	15.04
C24	13.13	041°48'35.56"	18.00	6.88	12.85
C25	8.52	048°47'32.88"	10.00	4.54	8.26
C26	17.03	048°47'32.88"	20.00	9.07	16.52
C27	13.94	039°56'40.34"	20.00	7.27	13.66
C28	6.97	039°56'40.22"	10.00	3.63	6.83
L1	8.82	S44° 53' 44.08"E			
L2	10.00	S44° 53' 44.08"E			
L3	10.00	N44° 53' 44.08"W			

#	LENGTH	DIRECTION/DELTA	RADIUS	TAN	CHORD
L5	9.34	N45° 06' 15.92"E			
L9	8.25	S45° 06' 15.92"W			
L11	15.93	N44° 53' 56.01"W			
L12	12.52	N45° 06' 15.92"E			
L13	32.28	S44° 52' 13.74"E			
L16	25.03	N42° 30' 01.13"W			
L17	1.49	N44° 53' 44.08"W			
L18	40.87	N44° 53' 44.08"W			
L19	56.16	N44° 53' 44.08"W			
L20	0.50	N45° 06' 15.92"E			
L21	5.70	N29° 50' 57.49"E			
L22	294.00	N45° 06' 15.92"E			
L23	14.50	S67° 11' 12.42"E			

#	LENGTH	DIRECTION/DELTA	RADIUS	TAN	CHORD
L28	0.50	N45° 06' 15.92"E			
L29	188.00	S44° 53' 44.08"E			
L30	10.27	S44° 53' 43.91"E			
L31	4.90	N26° 54' 41.39"E			
L32	259.74	N45° 06' 15.92"E			
L35	24.50	N45° 06' 15.92"E			
L36	5.70	N60° 21' 34.32"E			
L37	5.70	S29° 50' 57.32"W			
L38	303.50	S45° 06' 15.34"W			
L39	3.79	S68° 29' 01.39"W			



Original Sheet Size: 22"x34"

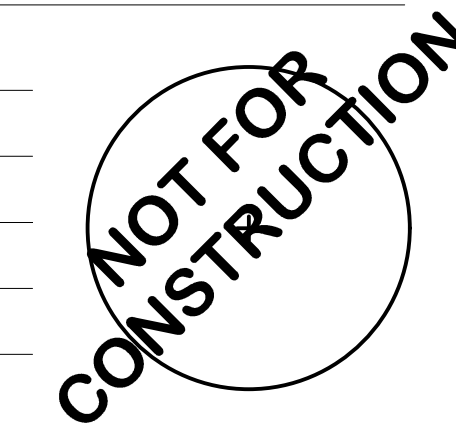





Ron Alameida - City Architect  
Jennifer Cooper - Bureau Manager  
49 South Van Ness, San Francisco, CA 94103  
Phone (628) 271-2862

Project

Transbay Block 3 Park  
and Streetscape

250 Main Street

Consultant

	BUREAU OF ENGINEERING CITY & COUNTY OF SAN FRANCISCO SAN FRANCISCO PUBLIC WORKS 49 SOUTH VAN NESS AVENUE, 8TH FLOOR SAN FRANCISCO, CA 94103	
	DESIGNED BY: JM	DATE: 12/2022
	DRAWN BY: JM	DATE: 12/2022
CHECKED BY:	APPROVED:	
SECTION MANAGER:	DATE:	
DEPUTY BUREAU MANAGER:	DATE:	
ACTING BUREAU MANAGER:	DATE:	

Bureau Mgr.  
Section Mgr.

100% DESIGN DEVELOPMENT 12/16/2022  
REVISION 1 ISSUE DATE

No.	Date	Revisions

Proj. L.Arch.  
Designed  
Drawn  
Checked



Drawing Title

TEHAMA STREET  
GRADING PLAN

Sheet No. CR1

Scale: 1" = 5'-0"

Project No.

Project No.

Drawing name: V:\10991\_Transbay\_Park\2\_Design\Working\_Drawings\ESH\Current\R-Design-Park-DD-100.dwg Plotted on: Dec 15, 2022 - 3:45pm

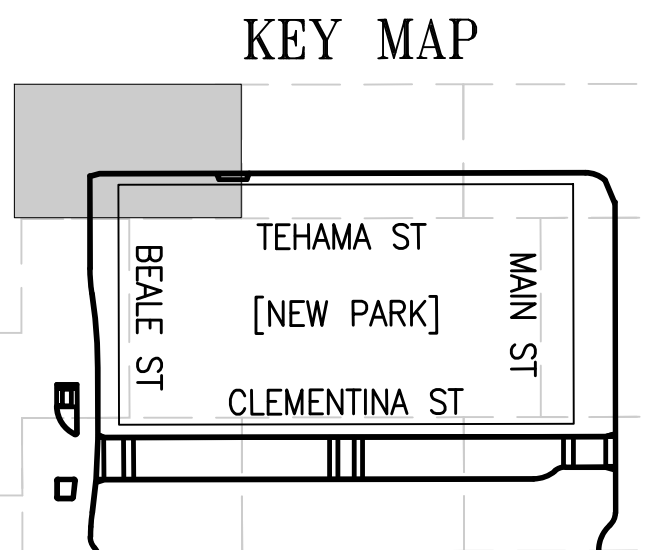
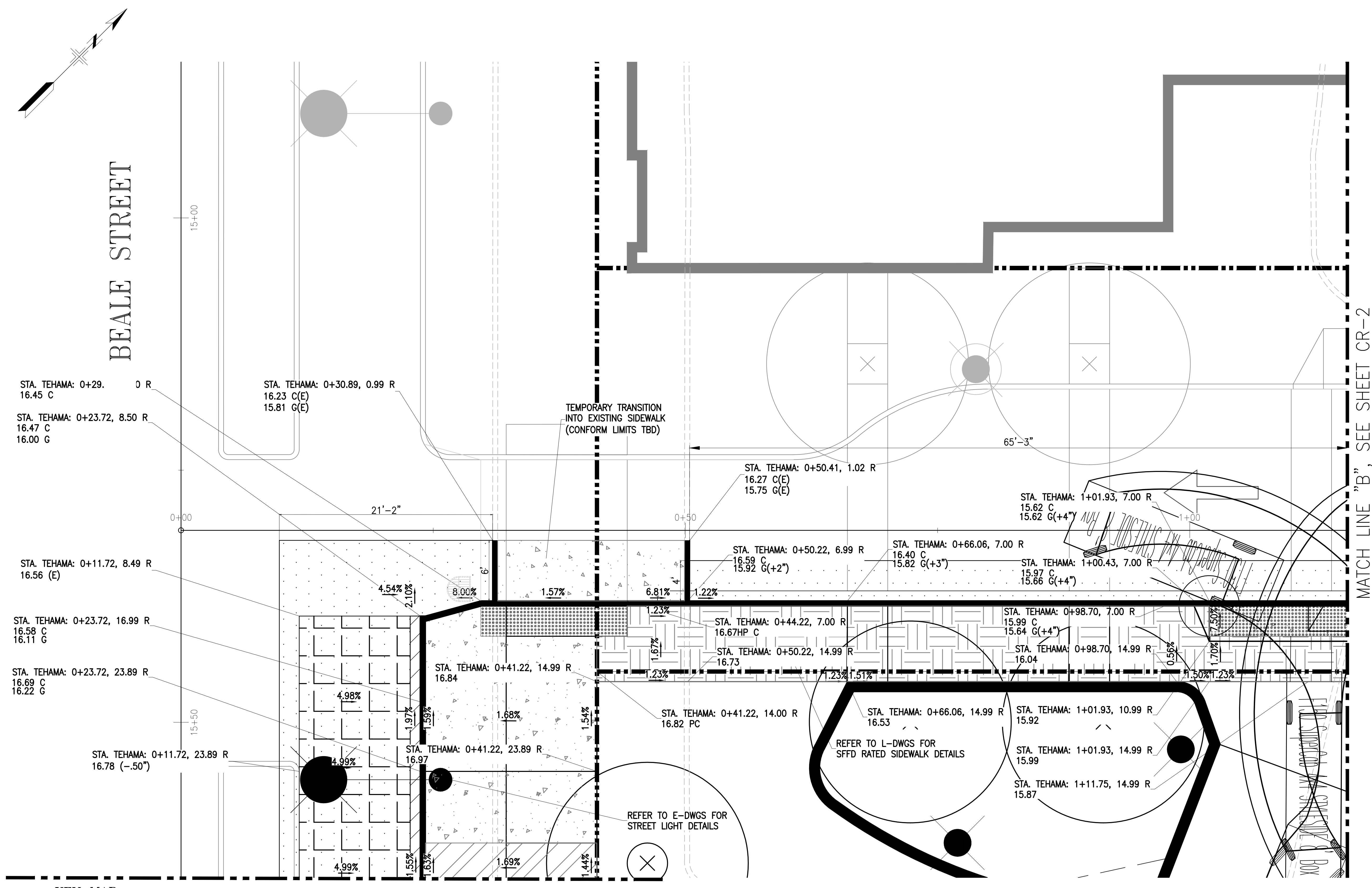

Original Sheet Size: 22"x34"



Ron Alameida - City Architect  
Jennifer Cooper - Bureau Manager  
49 South Van Ness, San Francisco, CA 94103  
Phone (628) 271-2862

Project \_\_\_\_\_

Transbay Block 3 Park  
and Streetscape

250 Main Street

Consultant \_\_\_\_\_

	BUREAU OF ENGINEERING CITY & COUNTY OF SAN FRANCISCO SAN FRANCISCO PUBLIC WORKS 49 SOUTH VAN NESS AVENUE, 8TH FLOOR SAN FRANCISCO, CA 94103	
	DESIGNED BY: JM	DATE: 12/2022
	DRAWN BY: JM	DATE: 12/2022
CHECKED BY: _____		
APPROVED _____		
SECTION MANAGER: _____	DATE: _____	
DEPUTY BUREAU MANAGER: _____	DATE: _____	
ACTING BUREAU MANAGER: _____	DATE: _____	

Bureau Mgr. \_\_\_\_\_  
Section Mgr. \_\_\_\_\_

100% DESIGN DEVELOPMENT 12/16/2022  
REVISION 1 ISSUE DATE

No.	Date	Revisions

Proj. L.Arch. \_\_\_\_\_  
Designed \_\_\_\_\_  
Drawn \_\_\_\_\_  
Checked \_\_\_\_\_



Drawing Title \_\_\_\_\_

TEHAMA STREET  
GRADING PLAN

Sheet No. **CR2**

Scale: 1" = 5'-0"

Project No. \_\_\_\_\_

Project No. \_\_\_\_\_

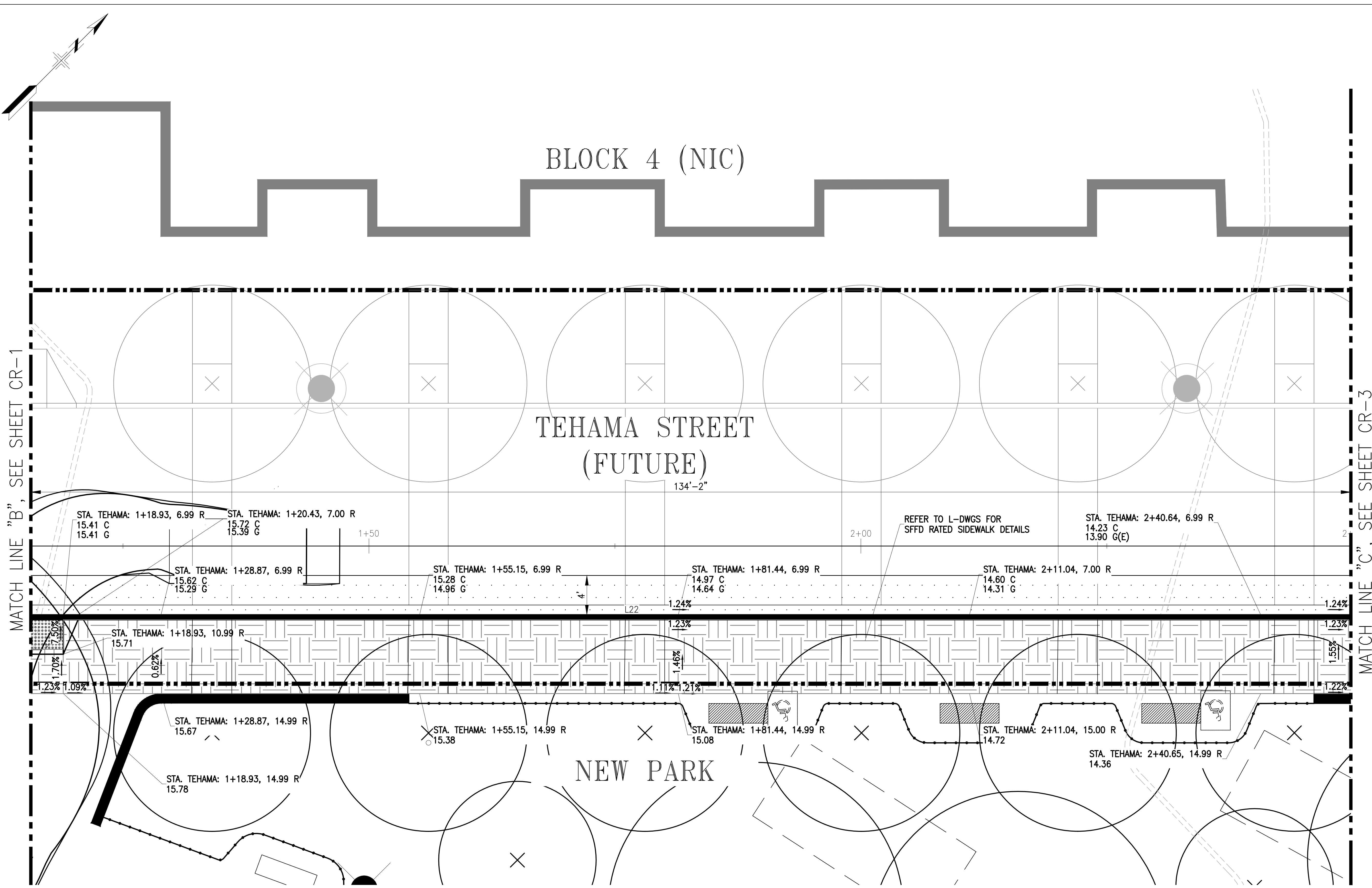

MATCH LINE "B", SEE SHEET CR-1

MATCH LINE "C", SEE SHEET CR-3

KEY MAP

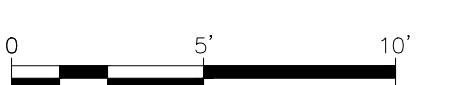
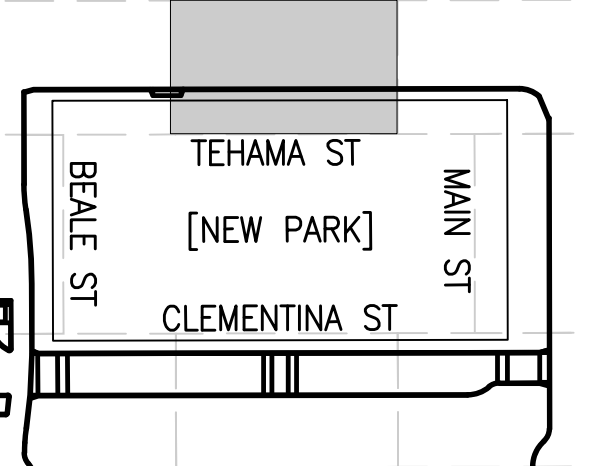

Original Sheet Size: 22"x34"









Ron Alameida - City Architect  
Jennifer Cooper - Bureau Manager  
49 South Van Ness, San Francisco, CA 94103  
Phone (628) 271-2862

Project

Transbay Block 3 Park  
and Streetscape

250 Main Street

Consultant

	BUREAU OF ENGINEERING CITY & COUNTY OF SAN FRANCISCO SAN FRANCISCO PUBLIC WORKS 49 SOUTH VAN NESS AVENUE, 8TH FLOOR SAN FRANCISCO, CA 94103	
	DESIGNED BY: JM	DATE: 12/2022
	DRAWN BY: JM	DATE: 12/2022
CHECKED BY:	APPROVED:	
SECTION MANAGER:	DATE:	
DEPUTY BUREAU MANAGER:	DATE:	
ACTING BUREAU MANAGER:	DATE:	

Bureau Mgr. \_\_\_\_\_  
Section Mgr. \_\_\_\_\_

100% DESIGN DEVELOPMENT 12/16/2022  
REVISION 1 ISSUE DATE

No.	Date	Revisions

Proj. L.Arch. \_\_\_\_\_  
Designed \_\_\_\_\_  
Drawn \_\_\_\_\_  
Checked \_\_\_\_\_



Drawing Title

CLEMENTINA STREET  
GRADING PLAN

Sheet No. **CR4**

Scale: 1" = 5'-0"

Project No. \_\_\_\_\_

Project No.

# NEW PARK

# CLEMENTINA STREET

# BLOCK 2 (NIC)

MATCH LINE "E", SEE SHEET CR-7

MATCH LINE "F", SEE SHEET CR-5

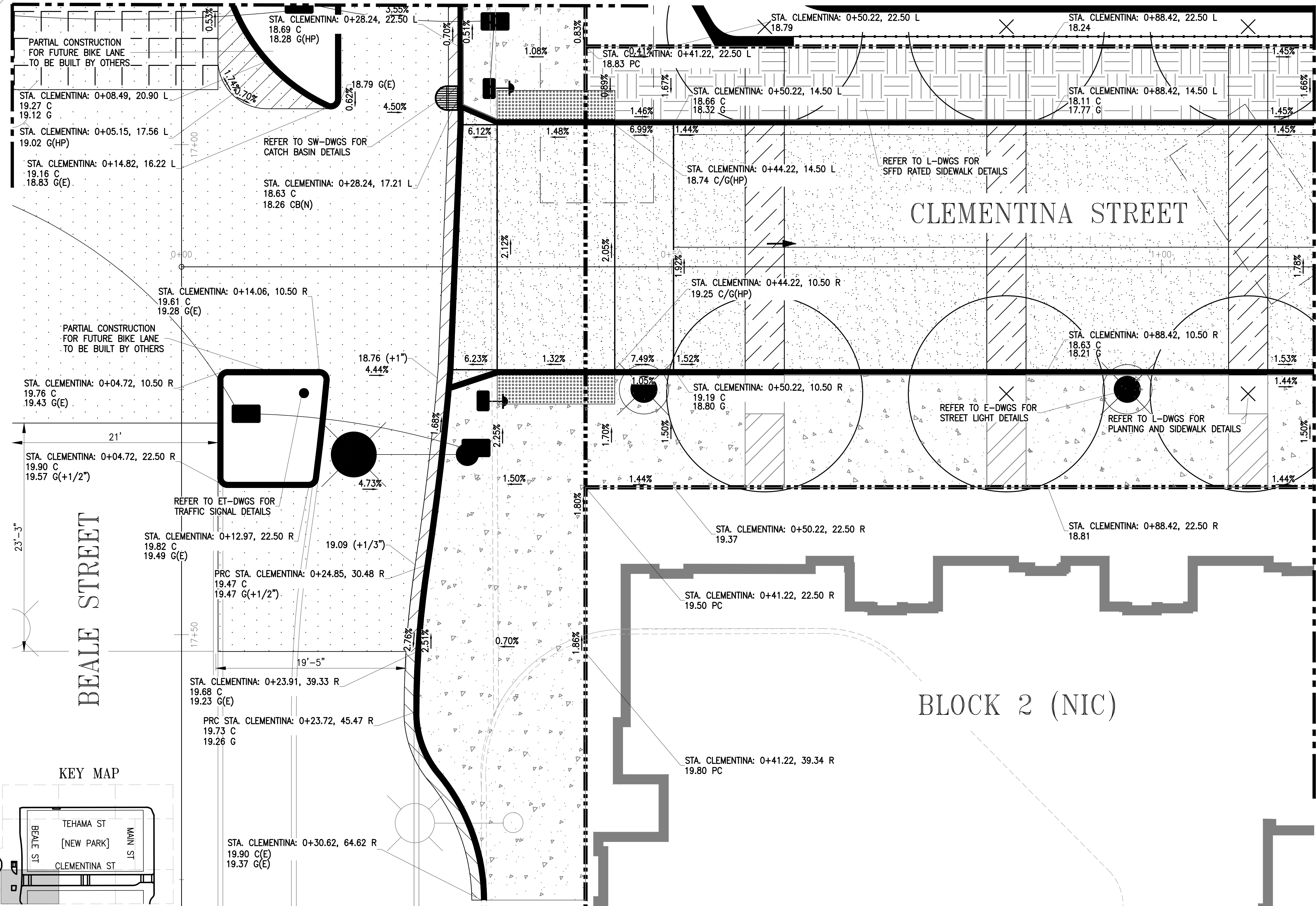

Drawing name: V:\10991\_Transbay\_Park\2\_Design\Working\_Drawings\ESH\Current\R-Design\Park-DD-100.dwg Plotted on: Dec 15, 2022 - 3:56pm





Ron Alameida - City Architect  
Jennifer Cooper - Bureau Manager  
49 South Van Ness, San Francisco, CA 94103  
Phone (628) 271-2862

Project

Transbay Block 3 Park  
and Streetscape

250 Main Street

Consultant

	BUREAU OF ENGINEERING CITY & COUNTY OF SAN FRANCISCO SAN FRANCISCO PUBLIC WORKS 49 SOUTH VAN NESS AVENUE, 8TH FLOOR SAN FRANCISCO, CA 94103	
	DESIGNED BY:	JM 12/2022
	DRAWN BY:	JM 12/2022
	CHECKED BY:	
APPROVED		
SECTION MANAGER:	DATE:	
DEPUTY BUREAU MANAGER:	DATE:	
ACTING BUREAU MANAGER:	DATE:	

Bureau Mgr. \_\_\_\_\_  
Section Mgr. \_\_\_\_\_  
100% DESIGN DEVELOPMENT 12/16/2022  
REVISION 1 ISSUE DATE

No.	Date	Revisions

Proj. L.Arch. \_\_\_\_\_  
Designed \_\_\_\_\_  
Drawn \_\_\_\_\_  
Checked \_\_\_\_\_

Drawing Title

CLEMENTINA STREET  
GRADING PLAN

Sheet No. **CR5**

Scale: 1" = 5'-0"

Project No. \_\_\_\_\_



# NEW PARK

# CLEMENTINA STREET

# BLOCK 2 (NIC)

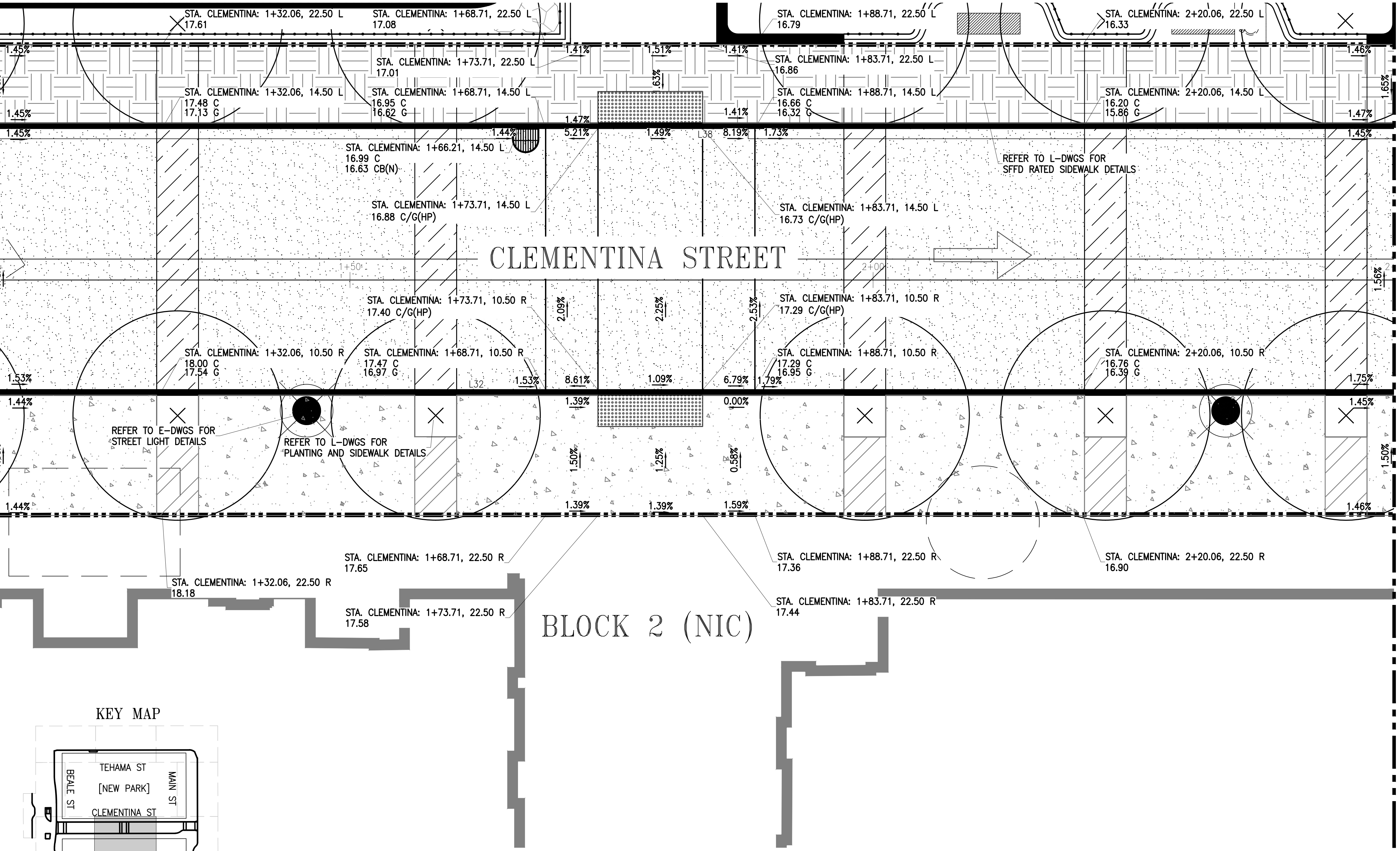

### KEY MAP

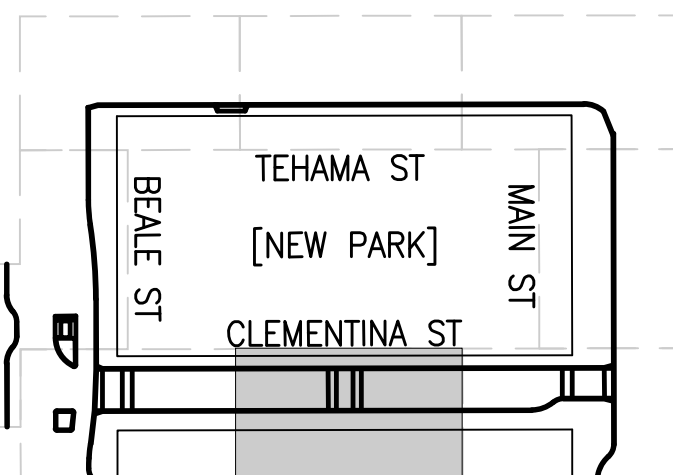

Drawing name: V:\10991\_Transbay\_Park\2\_Design\Working\_Drawings\ESH\Current\R-Design-Park-DD-100.dwg Plotted on: Dec 15, 2022 - 3:57pm

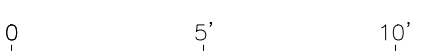

Original Sheet Size: 22"x34"









Ron Alameida - City Architect  
Jennifer Cooper - Bureau Manager  
49 South Van Ness, San Francisco, CA 94103  
Phone (628) 271-2862

Project

Transbay Block 3 Park  
and Streetscape

250 Main Street

Consultant

BUREAU OF ENGINEERING CITY & COUNTY OF SAN FRANCISCO SAN FRANCISCO PUBLIC WORKS 49 SOUTH VAN NESS AVENUE, 8TH FLOOR SAN FRANCISCO, CA 94103	
DESIGNED BY:	JM 12/2022
DRAWN BY:	JM 12/2022
CHECKED BY:	
APPROVED	
SECTION MANAGER:	DATE:
DEPUTY BUREAU MANAGER:	DATE:
ACTING BUREAU MANAGER:	DATE:

Bureau Mgr.  
Section Mgr.

100% DESIGN DEVELOPMENT 12/16/2022  
REVISION 1 ISSUE DATE

No.	Date	Revisions

Proj. L.Arch.  
Designed  
Drawn  
Checked

Drawing Title

BEALE STREET  
GRADING PLAN

Sheet No. **CR7**

Scale: 1" = 5'-0"

Project No.

Project No.

KEY MAP

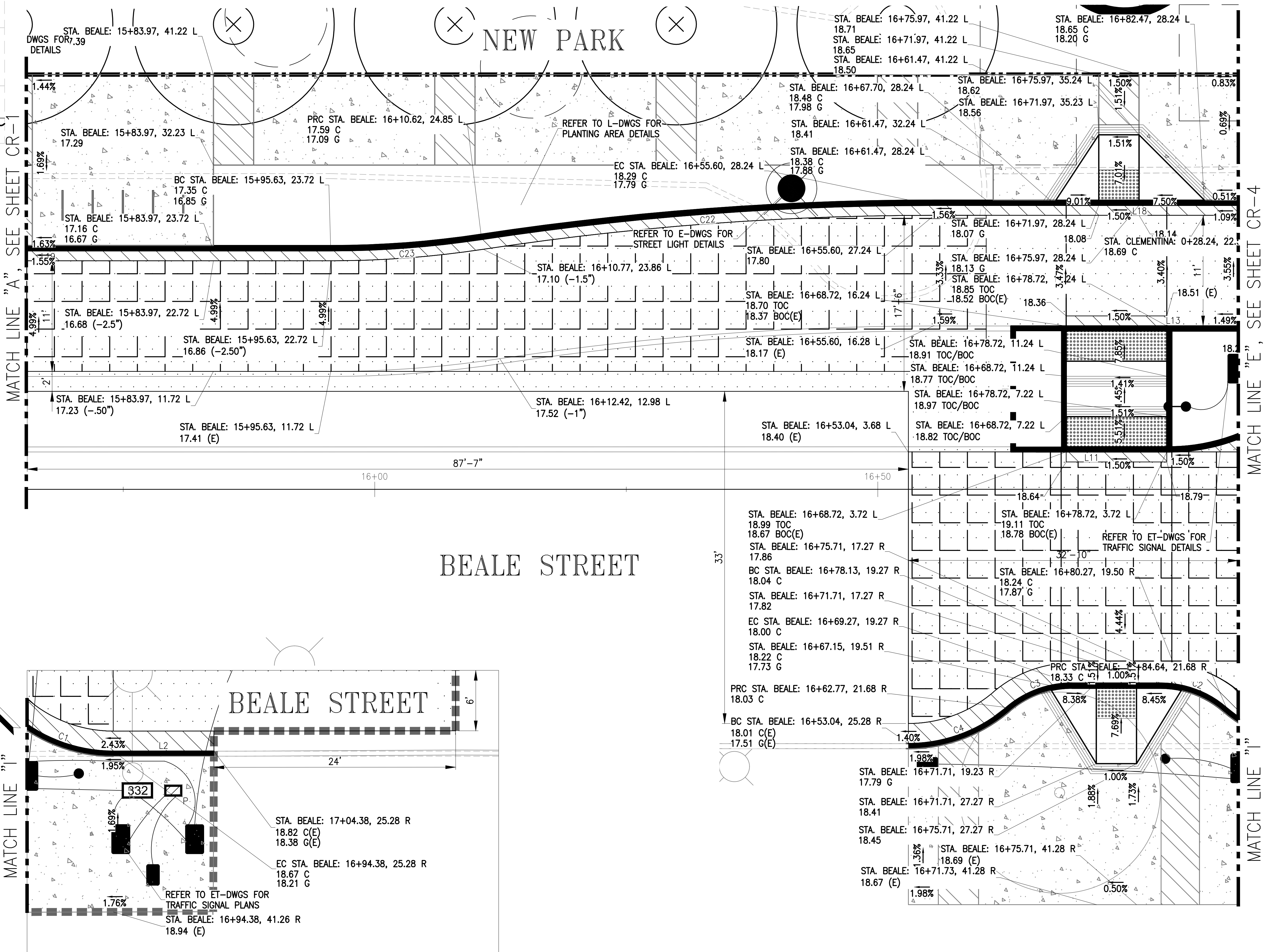
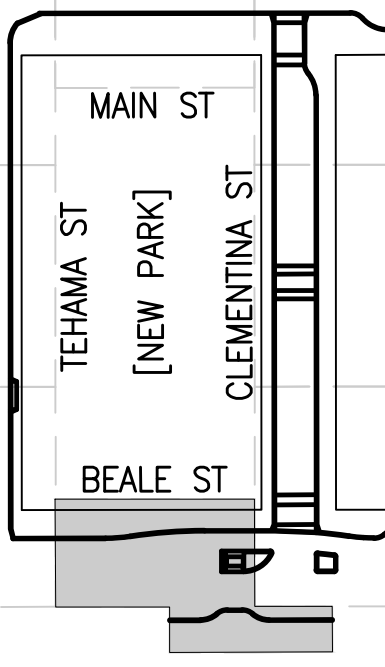

MATCH LINE "A", SEE SHEET CR-1

MATCH LINE "E", SEE SHEET CR-4

Drawing name: V:\10991\_Transbay\_Park\2\_Design\Working\_Drawings\ESH\Current\Design-Park-DD-100.dwg Plotted on: Dec 15, 2022 - 4:01 pm







Ron Alameida - City Architect  
Jennifer Cooper - Bureau Manager  
49 South Van Ness, San Francisco, CA 94103  
Phone (628) 271-2862

Project \_\_\_\_\_

Transbay Block 3 Park  
and Streetscape

250 Main Street

Consultant \_\_\_\_\_

	BUREAU OF ENGINEERING CITY & COUNTY OF SAN FRANCISCO SAN FRANCISCO PUBLIC WORKS 49 SOUTH VAN NESS AVENUE, 8TH FLOOR SAN FRANCISCO, CA 94103	
	DESIGNED BY: JM	DATE: 12/2022
	DRAWN BY: JM	DATE: 12/2022
CHECKED BY:	APPROVED:	
SECTION MANAGER:	DATE:	
DEPUTY BUREAU MANAGER:	DATE:	
ACTING BUREAU MANAGER:	DATE:	

Bureau Mgr. \_\_\_\_\_  
Section Mgr. \_\_\_\_\_

100% DESIGN DEVELOPMENT 12/16/2022  
REVISION 1 ISSUE DATE

No.	Date	Revisions

Proj. L.Arch. \_\_\_\_\_  
Designed \_\_\_\_\_  
Drawn \_\_\_\_\_  
Checked \_\_\_\_\_



Drawing Title \_\_\_\_\_

MAIN STREET  
GRADING PLAN

Sheet No. \_\_\_\_\_

CR8

Scale: 1" = 5'-0"

Project No. \_\_\_\_\_

Project No. \_\_\_\_\_

KEY MAP

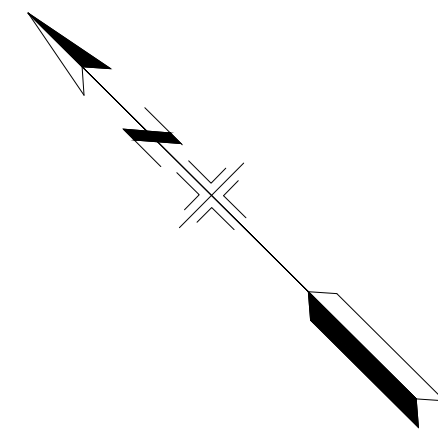
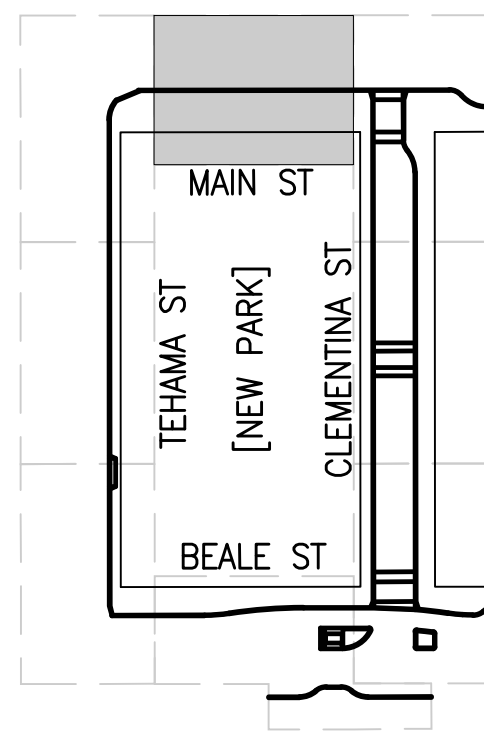

MAIN STREET

STA. MAIN: 15+88.90, 353.25 L  
13.56 (E)      STA. MAIN: 16+33.94, 353.34 L  
14.03 (E)      STA. MAIN: 16+79.05, 353.42 L  
14.46 (E)      STA. MAIN: 16+79.05, 342.72 L  
14.53 (E)

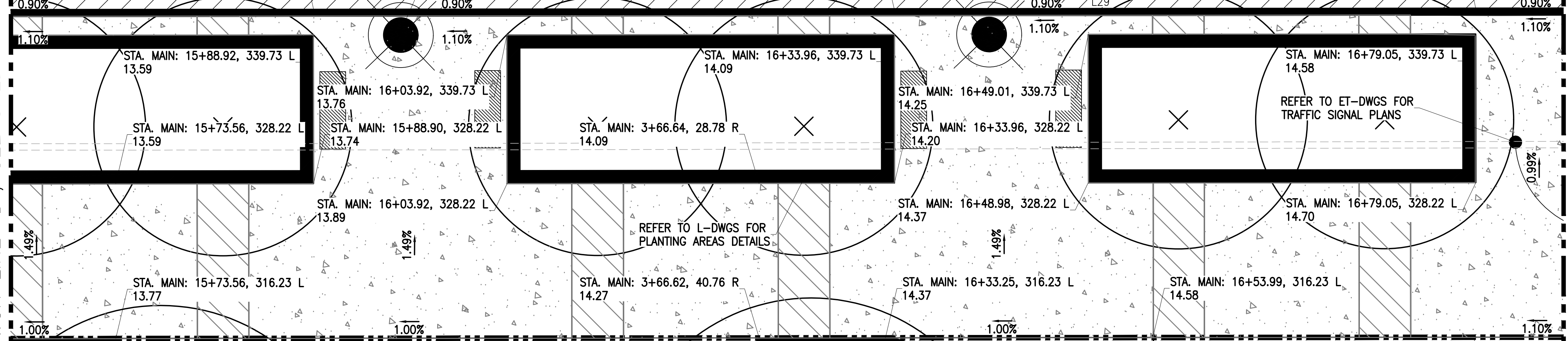
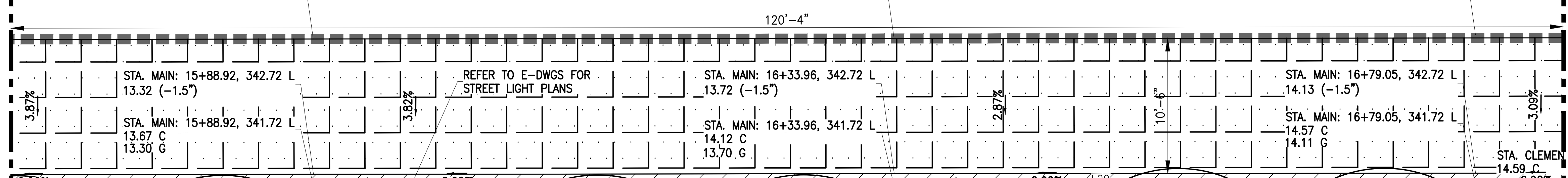

NEW PARK

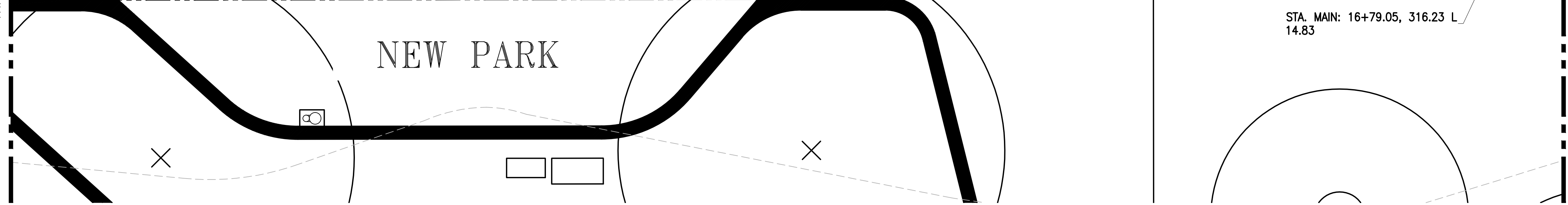

Drawing name: V:\10991\_Transbay\_Park\2\_Design\Working\_Drawings\ESH\Current\R-Design-Park-DD-100.dwg Plotted on: Dec 15, 2022 - 4:02pm



Original Sheet Size: 22"x34"





Ron Alameida - City Architect  
Jennifer Cooper - Bureau Manager  
49 South Van Ness, San Francisco, CA 94103  
Phone (628) 271-2862

Project

Transbay Block 3 Park  
and Streetscape

250 Main Street

Consultant

	BUREAU OF ENGINEERING CITY & COUNTY OF SAN FRANCISCO SAN FRANCISCO PUBLIC WORKS 49 SOUTH VAN NESS AVENUE, 8TH FLOOR SAN FRANCISCO, CA 94103	
	DESIGNED BY: JM	DATE: 12/2022
	DRAWN BY: JM	DATE: 12/2022
	CHECKED BY:	
APPROVED		
SECTION MANAGER:	DATE:	
DEPUTY BUREAU MANAGER:	DATE:	
ACTING BUREAU MANAGER:	DATE:	

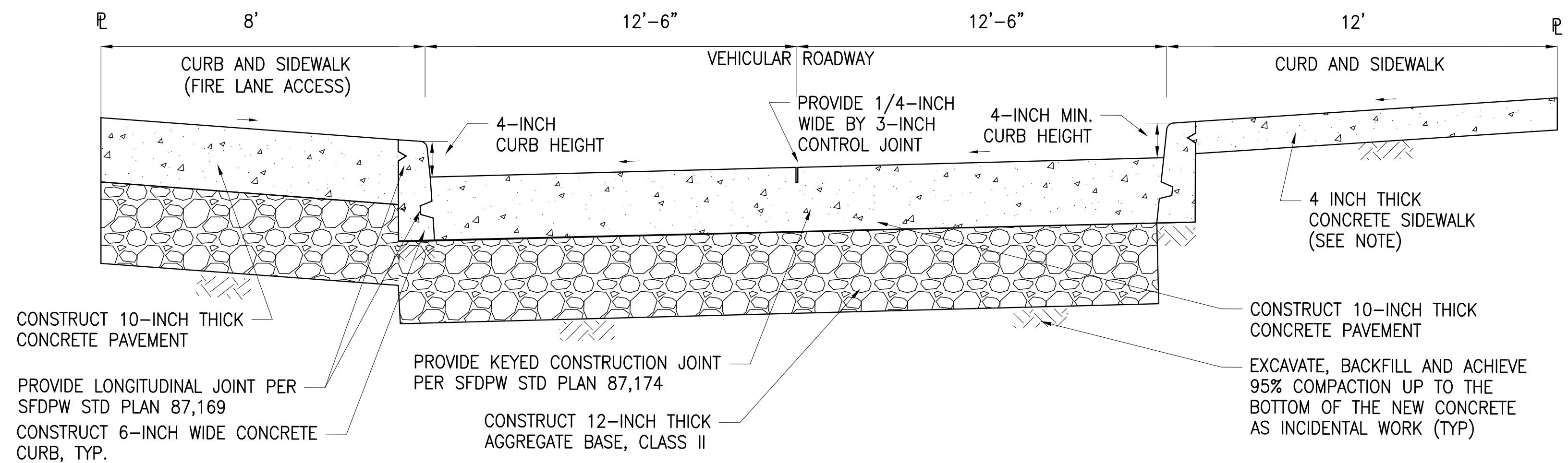

**SECTION 1**  
CLEMENTINA STREET SFFD FIRE RATED SIDEWALK AND ROADWAY DETAILS  
NOT TO SCALE

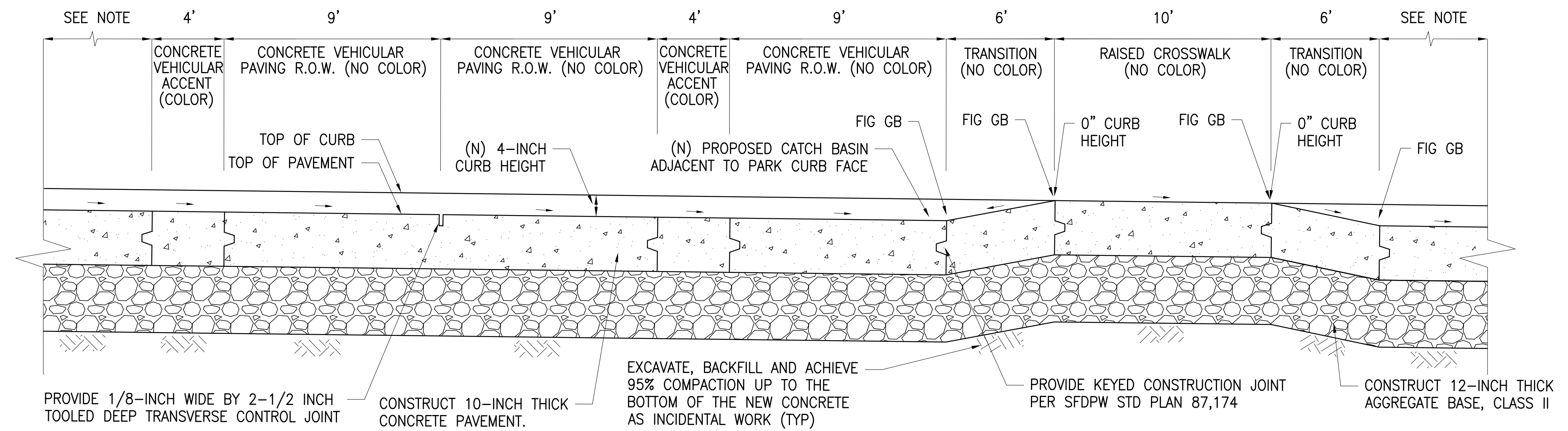

**SECTION 2**  
CLEMENTINA STREET RAISED CROSSWALK DETAILS  
NOT TO SCALE

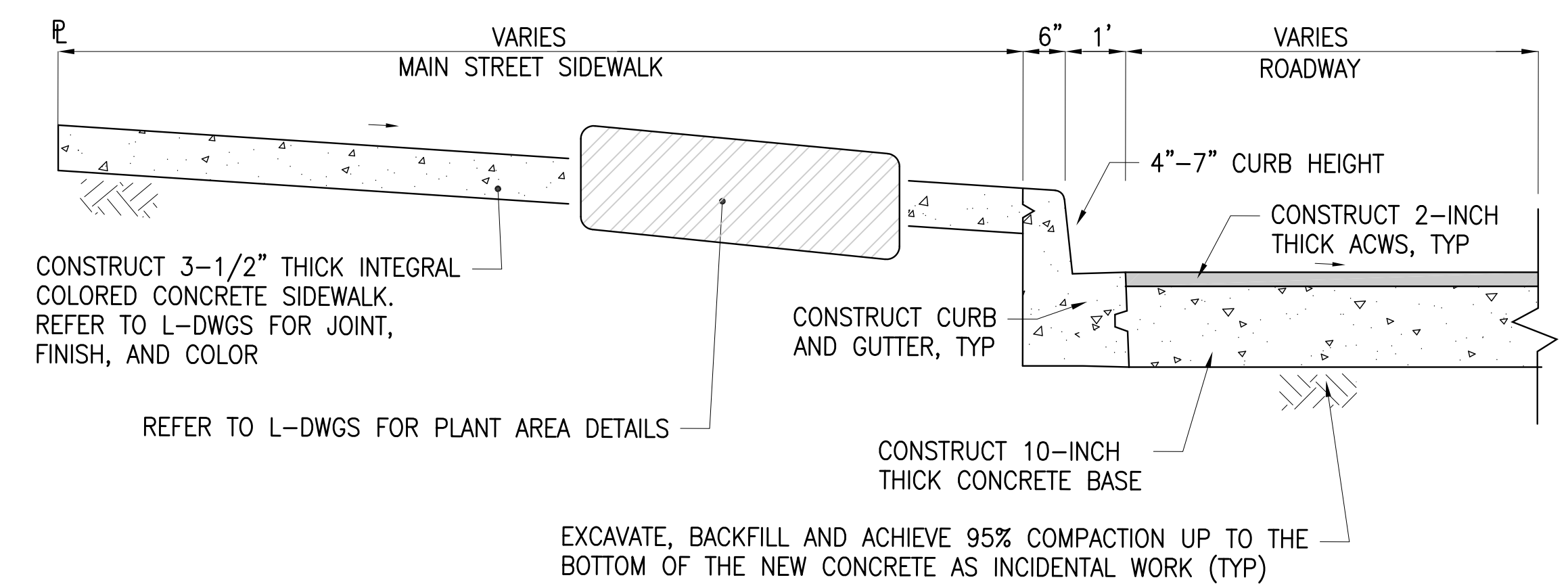

**SECTION 3**  
MAIN STREET SIDEWALK AND ROADWAY DETAILS  
NOT TO SCALE

NOTE: REFER TO L-5.0 PAVING PLAN, L-9.0 CONSTRUCTION DETAILS AND R-1 LAYOUT PLAN FOR ADDITIONAL ROADWAY AND SIDEWALK DETAILS

Bureau Mgr. \_\_\_\_\_  
Section Mgr. \_\_\_\_\_

100% DESIGN DEVELOPMENT 12/16/2022  
REVISION 1 ISSUE DATE

No.	Date	Revisions

Proj. L.Arch. \_\_\_\_\_  
Designed \_\_\_\_\_  
Drawn \_\_\_\_\_  
Checked \_\_\_\_\_

Drawing Title \_\_\_\_\_

CROSS SECTION

Sheet No. **X-1**

Scale: NTS  
Project No. \_\_\_\_\_

Project No. \_\_\_\_\_



Drawing name: V:\10991\_Transbay\_Park\2\_Design\Working\_Drawings\ES\H\Current\IR-Sections-Park.dwg Plotted on: Dec 15, 2022 - 4:43pm