

SFMTA - TASC SUMMARY SHEET

PreStaff_Date: 2/25/2022 Requested_by: SFMTA Handled: Elliot Goodrich Section Head : MS <i>MS</i>	<input type="checkbox"/> Public Hearing Consent <input checked="" type="checkbox"/> Public Hearing Regular <input type="checkbox"/> Informational / Other	No objections: _____ Item Held: _____ Other: _____
--	--	---

Location: Turk Boulevard at Roselyn Terrace and Kittredge Terrace

Subject: RRFB and Crosswalk Closure

PROPOSAL / REQUEST:

ESTABLISH - Rectangular Rapid Flashing Beacon
Turk Blvd at Roselyn Terrace, west leg

ESTABLISH - Crosswalk Closure
Turk Blvd at Roselyn Terrace, east side

ESTABLISH - Crosswalk Closure
Turk Blvd at Kittredge Terrace, west side

(Supervisor District 1)

Elliot Goodrich, elliot.goodrich@sfmta.com

BACKGROUND INFORMATION / COMMENTS

This project will consolidate pedestrian crossings of Turk Blvd at Kittredge Terrace and Roselyn Terrace, adjacent to the University of San Francisco campus. At Kittredge Terrace, the project will close the existing west side crosswalk, which is oriented at an extreme skew and serves no unique destinations to the east leg. At Roselyn Terrace, the project will close the existing east side crosswalk which serves no unique destinations to the west leg and enhance the west side crosswalk with a Rectangular Rapid Flashing Beacon (RRFB) and associated signage.

Turk Blvd has Class II bikeways. Speed limit 30mph.

Within the past five years, there was one collision within the project area, between a vehicle and a pedestrian in the crosswalk at Roselyn Terrace.

31 Balboa Muni Route serves Turk Blvd. There is a concurrent project to re-locate the existing north side bus stop at Roselyn Terrace to the far side of the Roselyn Terrace crosswalk that will be enhanced with an RRFB.

HEARING NOTIFICATION AND PROCESSING NOTES:

ENVIRONMENTAL CLEARANCE BY:

SFMTA Attached Pending

CHECK IF PREPARING SEPARATE SFMTA BOARD CALENDAR ITEM FOR PROPOSAL:

Turk Blvd / Roselyn Terrace and Kittredge Terrace Crosswalk Consolidation

February 2022

This project will consolidate pedestrian crossings of Turk Street by removing crosswalks at Kittredge Terrace and Roselyn Terrace and adding an RRFB at Roselyn Terrace.

LEGEND

 Citywide High-Injury Network

 Project locations

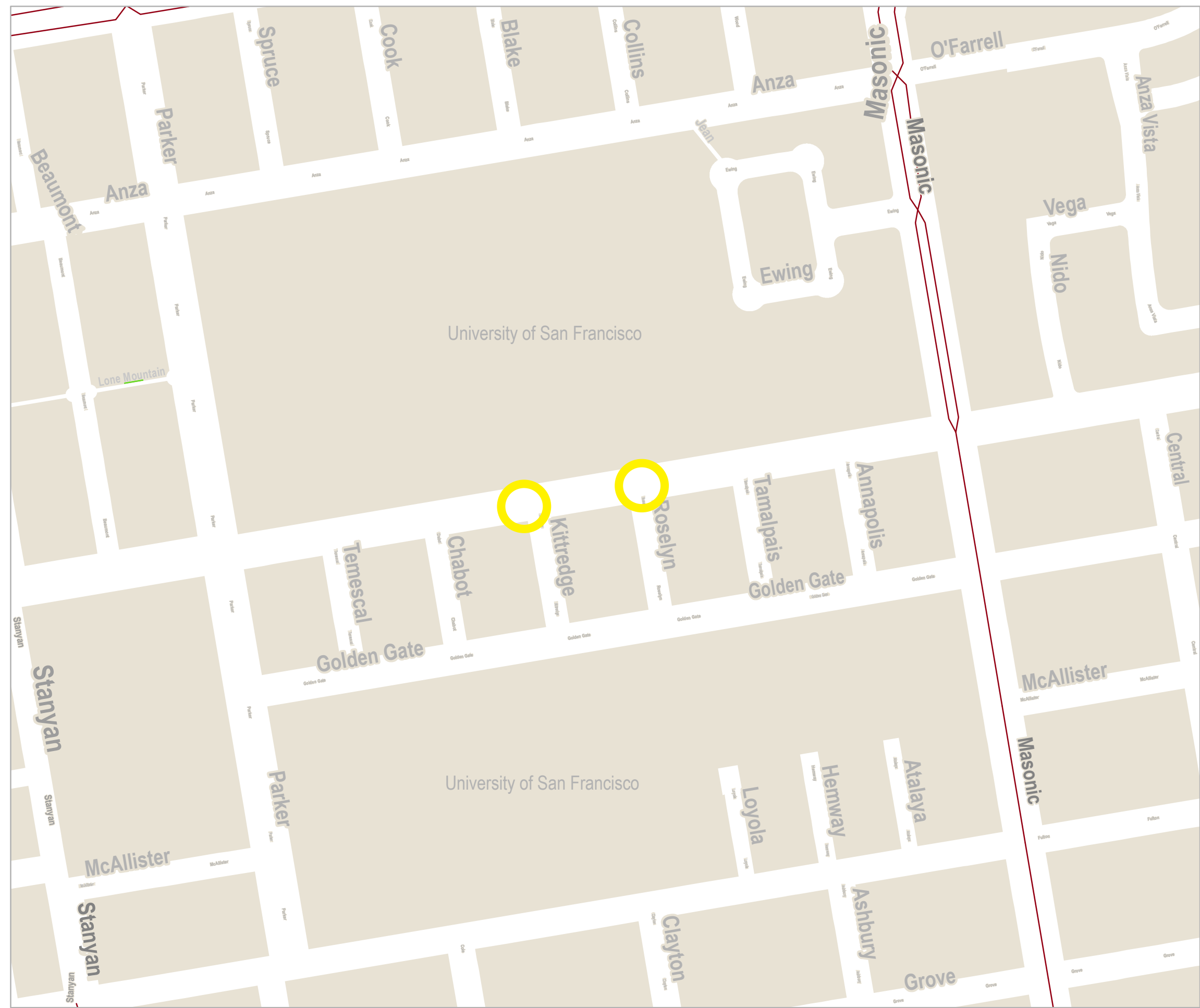

 0.055 miles

Scale 1:3,000

Date Saved: 2/14/2022

For reference contact: elliott.goodrich@sfmta.com

By downloading this map, you are agreeing to the following disclaimer: "The City and County of San Francisco ("City") provides the following data as a public record and no rights of any kind are granted to any person by the City's provision of this data. The City and County of San Francisco ("City") makes no representation regarding and does not guarantee or otherwise warrant the accuracy or completeness of this data. Anyone who uses this data for any purpose whatsoever does so entirely at their own risk. The City shall not be liable or otherwise responsible for any loss, harm, claim or action of any kind from any person arising from the use of this data. By accessing this data, the person accessing it acknowledges that she or he has read and does so under the condition that she or he agrees to the contents and terms of this disclaimer."



Existing and Proposed Striping Turk Boulevard at Roselyn Terrace and Kittredge Terrace

EXISTING STRIPING

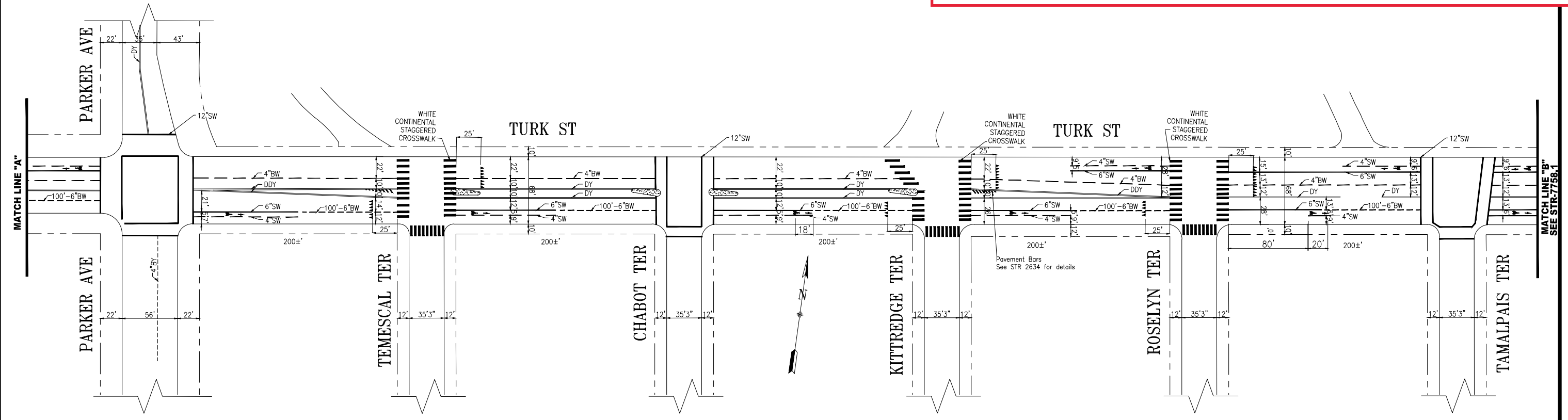

PROPOSED STRIPING

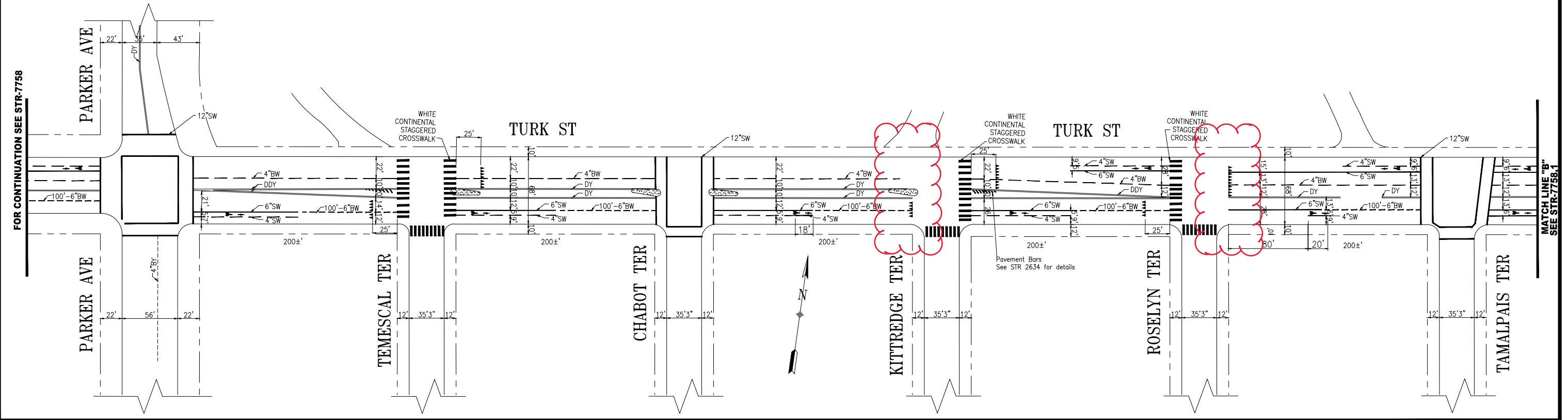

NO.	DATE	DESCRIPTION	BY	APP
TABLE OF REVISIONS				
CHECK WITH TRACING TO SEE IF YOU HAVE LATEST REVISION				



SUPERCEDES STR-7508		APPROVED		SCALE:	
DRAWN:	DATE:	SENIOR ENGINEER	DATE:	1" = 50'	
A. MATHEWS	02/2022			SHEET/SHEETS:	
CHECKED:	DATE:	CITY TRAFFIC ENGINEER	DATE:		
M. SALLABERRY	02/2022				

EXISTING AND PROPOSED TRAFFIC STRIPING
DRAFT FOR PLANNING PURPOSES ONLY

TURK STREET
PARKER AVENUE TO TAMALPAIS TERRACE

CONTRACT NO.
DRAWING NO.
FILE NO.
REV. NO.

FILE NAME: ---
DATE: ---



RRFB infrastructure will be installed on existing Muni poles. No underground excavation is necessary for this work.

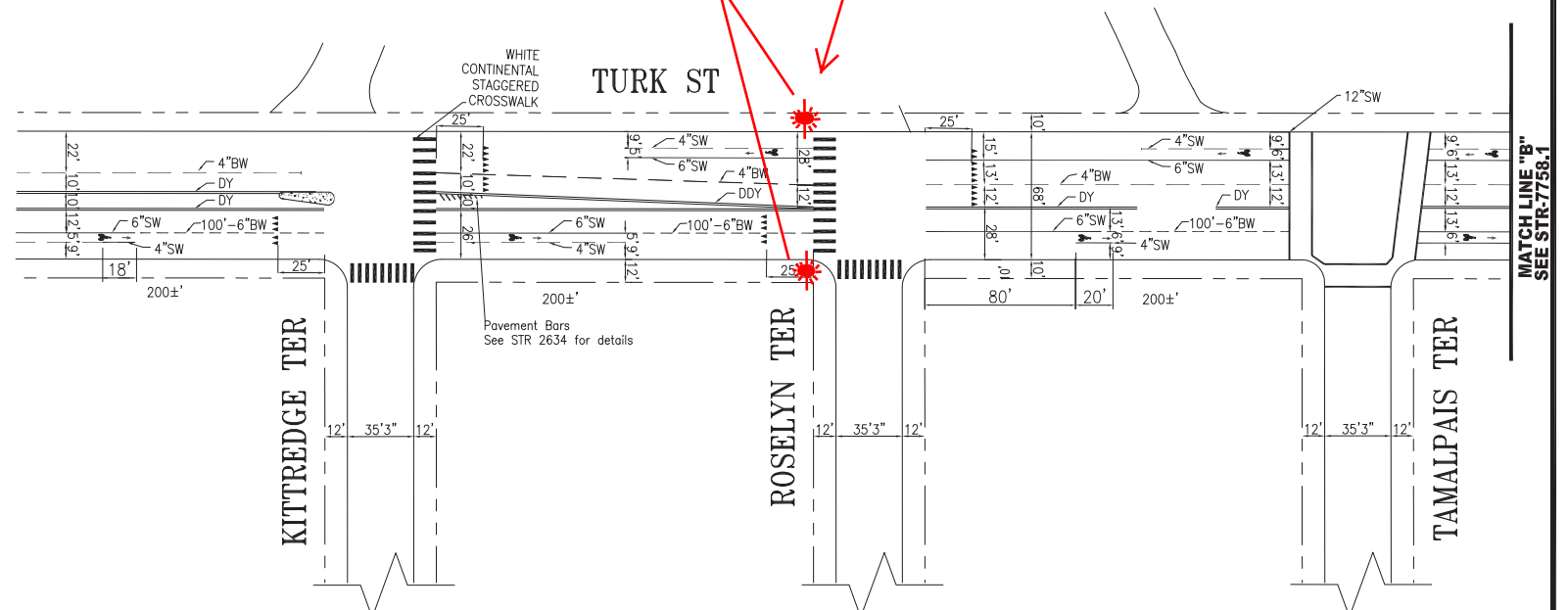

SCALE:
1" = 50'
SHEET/SHEETS:
1 OF 5

RECTANGULAR RAPID FLASHING BEACON (RRFB)
TURK STREET AND ROSELYN TERRACE

CONTRACT NO.
DRAWING NO. STR-7758
FILE NO.
REV. NO. 7

FILE NAME:
DATE: --/--/---

Turk Blvd / Roseyn Terrace and Kittredge Terrace Crosswalk Consolidation Aerial Photo





Turk Blvd / Roselyn Terrace and Kittredge Terrace Crosswalk Consolidation

February 2022

Bikeway network in the project vicinity.

LEGEND

-  Separated Bikeway
-  Bike Lane
-  Neighborway
-  Bike Route
-  Bike Path
-  Project locations

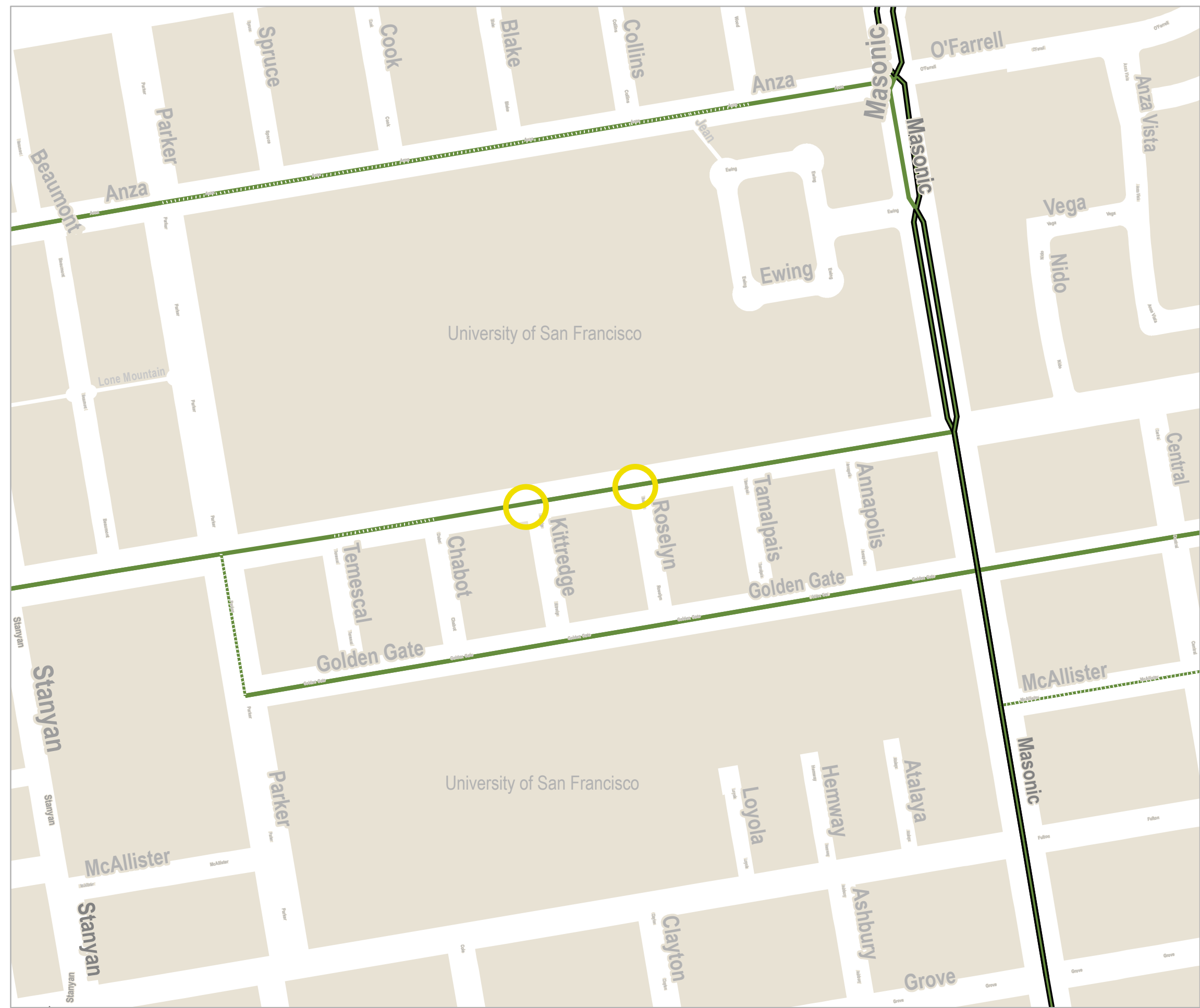

 0.055 miles

Scale 1:3,000

Date Saved: 2/14/2022

For reference contact: elliott.goodrich@sfmta.com

By downloading this map, you are agreeing to the following disclaimer: "The City and County of San Francisco ("City") provides the following data as a public record and no rights of any kind are granted to any person by the City's provision of this data. The City and County of San Francisco ("City") makes no representation regarding and does not guarantee or otherwise warrant the accuracy or completeness of this data. Anyone who uses this data for any purpose whatsoever does so entirely at their own risk. The City shall not be liable or otherwise responsible for any loss, harm, claim or action of any kind from any person arising from the use of this data. By accessing this data, the person accessing it acknowledges that she or he has read and does so under the condition that she or he agrees to the contents and terms of this disclaimer."



USF Complete Streets Improvements

12/13/2021

Attendees:

USF: Liz Miles, Dan Lawson

UTA: Niall Vignoles, Ann Marie Pierce, +1

SFMTA: Casey Hildreth, John Garzee, Shannon Hake, Soroush Roback

Related attachments:

- SFMTA PPT slide presentation (emailed 12/13)
- UTA-USF joint comment letter for Golden Gate Slow Street (emailed 12/13)

Meeting notes:

- USF/UTA reviewed and confirmed general support for SFMTA draft proposals including:
 - “Key connections” improvement concepts at the Chabot and Tam Terrace intersections with Golden Gate Ave (USF-UTA funded)
 - Traffic calming and back-in angled parking on Golden Gate Ave (USF-UTA funded)
 - Turk/Roslyn flashing beacon upgrade and bus stop relocation (west leg) and related crosswalk closure, east leg (SFMTA funded)
 - Golden Gate Ave Slow Street treatments including markings/wayfinding devices between Parker and Masonic, and potential eastbound traffic diversion on the east side of Masonic (SFMTA-funded)
- Discussion items / comments
 - Potential crosswalk closure (west leg) of Turk/Kitteridge
 - Group voiced general support for crosswalk removal if it doesn’t unduly affect USF occupancy permit approval timeline
 - USF just extended 3-month temporary approval, need to figure out schedule and level of effort for curb ramp changes
 - Potential left-turn restrictions / “right out only” treatments need further study and input from neighbors
 - Golden Gate / Tam Terrace
 - Group voiced support for potential STOP sign here with or without other traffic calming on Golden Gate Ave
 - Golden Gate/Roslyn load zone and east leg unmarked crosswalk
 - No need to add new crosswalk here (would affect eastbound load zone), but there should be a crosswalk nearby such as proposed at Tam Terrace (lots of midblock pedestrian activity here)

- Potential median islands with key connection improvements
 - Careful not to create undue blockage if there is double-parking and people need to drive/turn from side streets – painted islands today allow for flexibility
- Parker Ave
 - Comment of fast turning vehicles to/from Parker, request to consider traffic circle and/or other treatments
 - Agree to revisit potential improvements here after city develops cost estimates for existing scope of work
- Funding – SFMTA seeking to modify the USF-UTA project disbursement schedule to fund environmental/approvals phase, allow for additional ‘near-term’ implementation

Next steps

- SFMTA to meet with Public Works re: completion of survey and sidewalk/curb ramp design
 - UPDATE: Met with Public Works accessibility group later in day, will be coordinating on preliminary construction estimate and proposed fee for detailed design phase
 - Raised crosswalk not recommended for new Tam Terrace crosswalk (SFMTA to pursue STOP control and/or traffic calming as noted elsewhere)
- SFMTA-USF coordination re: curb ramps and street permit(s)
 - UPDATE: SFMTA internal meeting set with Norman Wong for 12/15
- SFMTA to keep group updated of next steps for Golden Gate Slow Street including outreach/engagement opportunities in early 2022
- Casey to coordinate with Liz on developing fund request details and scheduling future group meeting prior to any public hearings/outreach.

From: [Wong, Norman](#)
To: [Hildreth, Casey](#); [Velasco, Manito](#); [Roback, Soroush](#); [Shue, Kevin](#); [Goodrich, Elliot](#)
Cc: [Woo, Bryant](#)
Subject: FW: 2500 Turk Blvd USF Offsite Plans (BSM Permit 19IE-01104)
Date: Wednesday, February 16, 2022 6:48:32 PM
Attachments: [image001.png](#)
[image008.png](#)
[image012.png](#)
[2022-01-19_2500 Turk Blvd_DAC_Comments.pdf](#)
[RE 2500 Turk Blvd USF Offsite Plans \(BSM Permit 19IE-01104\).msg](#)
[image005.png](#)
[image007.png](#)
[image009.png](#)
[image010.png](#)
Importance: High

All - See below email thread and attached SFPW DAC comments. Looks like they concur with your crosswalk closure comments and they noted the requirement to install the ped barricades. The other attached email contains BUF comments and they only have one minor comment. Thus, please confirm that:

1. SFMTA (not UCSF) will be the responsible party to install the ped barricades on the south side of the Turk (at Kittridge and Roselyn Terrace)
2. LS or TE staff to conduct MTAB legislation for the requested crosswalk closures and to prepare directive to approve closure while it goes through the permanent legislation process.
3. LS or TE staff to prepare WO for removal of crosswalk striping, installation of ped barricades per comment #1, and to update official STRs

I will keep you updated on when construction starts and Item #3 may need to be implemented by the time the UCSF starts the sidewalk work by Roselyn Terrace since they will remove the curb ramp on the north side of Turk.

Thanks
Norman

From: Matt Oliver <Matt@olivermgmt.com>
Sent: Wednesday, February 16, 2022 6:15 PM
To: Justo, Liza Christine(DPW) <liza.justo@sfdpw.org>; Wong, Norman <Norman.Wong@sfmta.com>
Cc: Tang, Eleanor (DPW) <eleanor.tang@sfdpw.org>; Rivera, Javier (DPW) <Javier.Rivera@sfdpw.org>; Mike London <melondon@usfca.edu>; Lokelani Yee <lyee@bkf.com>; Saagar Ghai <sghai@bkf.com>; Elizabeth E. Miles <eeemiles@usfca.edu>
Subject: RE: 2500 Turk Blvd USF Offsite Plans (BSM Permit 19IE-01104)
Importance: High

EXT

Thanks Liza – Following Norman’s email from January 5th, none of the additional work described by Karina (DAC) is USF responsibility. For the final publishing of Permit Drawings, do you want the additional work shown on our plans (even though we are not installing any of that scope)?
Matt

From: Justo, Liza Christine(DPW) <liza.justo@sfdpw.org>
Sent: Wednesday, February 16, 2022 4:37 PM
To: Matt Oliver <Matt@olivermgmt.com>; Wong, Norman (MTA) <Norman.Wong@sfmta.com>
Cc: Tang, Eleanor (DPW) <eleanor.tang@sfdpw.org>; Rivera, Javier (DPW) <Javier.Rivera@sfdpw.org>; Mike London <melondon@usfca.edu>; Lokelani Yee <lyee@bkf.com>; Saagar Ghai <sghai@bkf.com>; Elizabeth E. Miles <eeemiles@usfca.edu>
Subject: RE: 2500 Turk Blvd USF Offsite Plans (BSM Permit 19IE-01104)

Hi Matt and Norman,

I apologize for getting back to you just now. DAC provided their comment last week and I got the time to get to your permit from my queue. Please see attached for DAC comments on SFMTA’s revision. Please let me know if you have any questions.

Best Regards,

Liza Justo
Junior Engineer

Bureau of Street-Use and Mapping | San Francisco Public Works | City and County of San Francisco
49 South Van Ness Avenue Suite 300 | San Francisco, CA 94103 | (628) 271-2541 | sfpublicworks.org

From: Matt Oliver <Matt@olivermgmt.com>

Sent: Wednesday, February 16, 2022 1:21 PM

To: Justo, Liza Christine(DPW) <liza.justo@sfdpw.org>

Cc: Tang, Eleanor (DPW) <eleanor.tang@sfdpw.org>; Rivera, Javier (DPW) <Javier.Rivera@sfdpw.org>; Wong, Norman (MTA) <Norman.Wong@sfmta.com>; Mike London <melondon@usfca.edu>; Lokelani Yee <lyee@bkf.com>; Saagar Ghai <sghai@bkf.com>; Elizabeth E. Miles <eemiles@usfca.edu>

Subject: RE: 2500 Turk Blvd USF Offsite Plans (BSM Permit 19IE-01104)

Importance: High

Liza – Over a week now since your last message. Have you received anything from DAC? If not, I would like to suggest you acknowledging DAC as being non-responsive; and for you to direct us to finalize the documents for the permit.

Please let me know as soon as you can.

Thanks.

Matt Oliver

From: Justo, Liza Christine(DPW) <liza.justo@sfdpw.org>

Sent: Monday, February 7, 2022 5:21 PM

To: Matt Oliver <Matt@olivermgmt.com>

Cc: Tang, Eleanor (DPW) <eleanor.tang@sfdpw.org>; Rivera, Javier (DPW) <Javier.Rivera@sfdpw.org>; Wong, Norman (MTA) <Norman.Wong@sfmta.com>; Mike London <melondon@usfca.edu>; Lokelani Yee <lyee@bkf.com>; Saagar Ghai <sghai@bkf.com>; Elizabeth E. Miles <eemiles@usfca.edu>

Subject: RE: 2500 Turk Blvd USF Offsite Plans (BSM Permit 19IE-01104)

Hi Matt,

DAC has not responded to me yet; however, I sent a check in email to the plan checker from DAC regarding the status of the review today. I will let you know once she gets back to me. Please let me know if you have more questions regarding the project. Thank you.

Best Regards,

Liza Justo

Junior Engineer

Bureau of Street-Use and Mapping | San Francisco Public Works | City and County of San Francisco
49 South Van Ness Avenue Suite 300 | San Francisco, CA 94103 | (628) 271-2541 | sfpublicworks.org

From: Matt Oliver <Matt@olivermgmt.com>

Sent: Monday, February 7, 2022 2:13 PM

To: Justo, Liza Christine(DPW) <liza.justo@sfdpw.org>

Cc: Tang, Eleanor (DPW) <eleanor.tang@sfdpw.org>; Rivera, Javier (DPW) <Javier.Rivera@sfdpw.org>; Wong, Norman (MTA) <Norman.Wong@sfmta.com>; Mike London <melondon@usfca.edu>; Lokelani Yee <lyee@bkf.com>; Saagar Ghai <sghai@bkf.com>; Elizabeth E. Miles <eemiles@usfca.edu>

Subject: RE: 2500 Turk Blvd USF Offsite Plans (BSM Permit 19IE-01104)

Importance: High

Liza – Just checking in to see if DAC had responded (Friday), as you indicated in your last email. Please let me know so we can make final drawing revisions for you to issue the permit.

Thanks.

Matt Oliver

415-515-6885

From: Justo, Liza Christine(DPW) <liza.justo@sfdpw.org>

Sent: Wednesday, February 2, 2022 9:28 AM

To: Matt Oliver <Matt@olivermgmt.com>

Cc: Tang, Eleanor (DPW) <eleanor.tang@sfdpw.org>; Rivera, Javier (DPW) <Javier.Rivera@sfdpw.org>; Wong, Norman (MTA) <Norman.Wong@sfmta.com>; Mike London <melondon@usfca.edu>; Lokelani Yee <lyee@bkf.com>; Saagar Ghai <sghai@bkf.com>; Elizabeth E. Miles <eemiles@usfca.edu>

Subject: RE: 2500 Turk Blvd USF Offsite Plans (BSM Permit 19IE-01104)

Hi Matt,

I apologize for getting back to you just now due to high amount of email received. Here's an update on your application:

1. DAC will be sending their comments to me by EOD Friday, 02/04/2022.
2. Planning has not provided any comments/concerns as of today, 02/02/2022.
3. BUF has no additional comment, except ensuring the tree is centered at least 25ft east of crosswalk shown below:

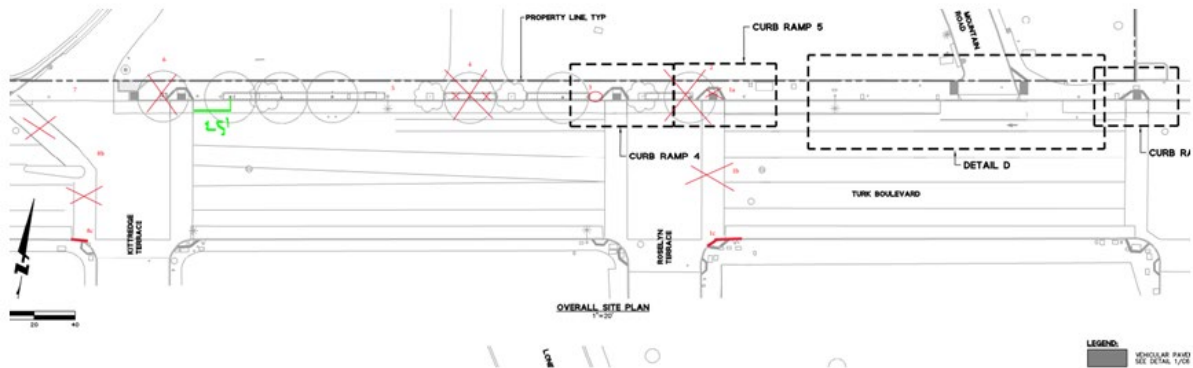

Please let me know if you have any questions.

Best Regards,

Liza Justo
Junior Engineer

Bureau of Street-Use and Mapping | San Francisco Public Works | City and County of San Francisco
49 South Van Ness Avenue Suite 300 | San Francisco, CA 94103 | (628) 271-2541 | sfpublicworks.org

From: Matt Oliver <Matt@olivermgmt.com>
Sent: Wednesday, February 2, 2022 7:38 AM
To: Justo, Liza Christine(DPW) <liza.justo@sfdpw.org>
Cc: Tang, Eleanor (DPW) <eleanor.tang@sfdpw.org>; Rivera, Javier (DPW) <Javier.Rivera@sfdpw.org>; Wong, Norman (MTA) <Norman.Wong@sfmta.com>; Mike London <melondon@usfca.edu>; Lokelani Yee <lyee@bkf.com>; Saagar Ghai <sghai@bkf.com>; Elizabeth E. Miles <emiles@usfca.edu>
Subject: RE: 2500 Turk Blvd USF Offsite Plans (BSM Permit 19IE-01104)
Importance: High

Liza – I haven't heard from you recently. Is there anything I can do to assist you to move this review to the finish line? The Turk St. improvements design/permit has been wavering for over a year because of departmental design revisions.
Please let me know your status.
Thanks.
Matt Oliver
415-515-6885

From: Matt Oliver
Sent: Thursday, January 27, 2022 12:50 PM
To: 'Justo, Liza Christine(DPW)' <liza.justo@sfdpw.org>
Cc: 'Tang, Eleanor (DPW)' <eleanor.tang@sfdpw.org>; 'Rivera, Javier (DPW)' <Javier.Rivera@sfdpw.org>; 'Wong, Norman (MTA)' <Norman.Wong@sfmta.com>; Mike London <melondon@usfca.edu>; Lokelani Yee <lyee@bkf.com>; 'Saagar Ghai' <sghai@bkf.com>; Elizabeth E. Miles <emiles@usfca.edu>
Subject: RE: 2500 Turk Blvd USF Offsite Plans (BSM Permit 19IE-01104)
Importance: High

Hi Liza – Checking in – hoping you have made progress with the other SF departments. Please let me know.
Also, for any additional information/conversations needed with departments, I can put together a ZOOM call (or calls) to help us move approvals along.
Thanks.
Matt

From: Matt Oliver
Sent: Thursday, January 20, 2022 9:35 AM
To: 'Justo, Liza Christine(DPW)' <liza.justo@sfdpw.org>
Cc: Tang, Eleanor (DPW) <eleanor.tang@sfdpw.org>; Rivera, Javier (DPW) <Javier.Rivera@sfdpw.org>; Wong, Norman (MTA)

<Norman.Wong@sfmta.com>; Mike London <melondon@usfca.edu>; Lokelani Yee <lyee@bkf.com>; Saagar Ghai <sghai@bkf.com>
Subject: RE: 2500 Turk Blvd USF Offsite Plans (BSM Permit 19IE-01104)

Thanks Liza – I'm hoping you can accelerate the review process – keeping in mind that engr/design revisions were all directed by city departments, in particular the most recent MTA proposed changes which were never considered when plan review was in the hands of MTA, BUF, DPW and DAC over a year ago.
Matt

From: Justo, Liza Christine(DPW) <liza.justo@sfdpw.org>
Sent: Wednesday, January 19, 2022 5:14 PM
To: Matt Oliver <Matt@olivermgmt.com>
Cc: Tang, Eleanor (DPW) <eleanor.tang@sfdpw.org>; Rivera, Javier (DPW) <javier.Rivera@sfdpw.org>; Wong, Norman (MTA) <Norman.Wong@sfmta.com>
Subject: RE: 2500 Turk Blvd USF Offsite Plans (BSM Permit 19IE-01104)

Hi Matt,

Thank you for your patience on this. I have requested a review for your project and still waiting for DAC and BUF approval. Please let me know if you have more questions.

Best Regards,

Liza Justo
Junior Engineer

Bureau of Street-Use and Mapping | San Francisco Public Works | City and County of San Francisco
49 South Van Ness Avenue Suite 300 | San Francisco, CA 94103 | (628) 271-2541 | sfpublicworks.org

From: Matt Oliver <Matt@olivermgmt.com>
Sent: Tuesday, January 11, 2022 4:26 PM
To: Wong, Norman (MTA) <Norman.Wong@sfmta.com>
Cc: Tang, Eleanor (DPW) <eleanor.tang@sfdpw.org>; Justo, Liza Christine(DPW) <liza.justo@sfdpw.org>; Rivera, Javier (DPW) <javier.Rivera@sfdpw.org>
Subject: RE: 2500 Turk Blvd USF Offsite Plans (BSM Permit 19IE-01104)
Importance: High

This message is from outside the City email system. Do not open links or attachments from untrusted sources.

Norman and Liza -- Would you please give me an update on your pursuits with other departments for their sign off? In particular, we are concerned with Planning and BUF.

Please get back to me as soon as you can.

Thank you.

Matt Oliver 415-515-6885

On Jan 6, 2022 3:46 PM, "Wong, Norman" <Norman.Wong@sfmta.com> wrote:

Thanks Eleanor

Hi Liza – several comments below require review by SFPW DAC and BUF. Please forward to them for review and confirmation of the requested changes. Also, I have copied the project contact onto this thread so he is aware you are overseeing this site.

Thanks

Norman

From: Tang, Eleanor (DPW) <eleanor.tang@sfdpw.org>
Sent: Thursday, January 6, 2022 1:45 PM
To: Wong, Norman <Norman.Wong@sfmta.com>
Cc: Justo, Liza Christine(DPW) <liza.justo@sfdpw.org>; Rivera, Javier (DPW) <javier.Rivera@sfdpw.org>
Subject: Fw: 2500 Turk Blvd USF Offsite Plans (BSM Permit 19IE-01104)

EXT

Hi Norman,

This project is reassigned to Liza Justo.

Liza,

Please note Norman's comment. Let Javier and I know if you have any question.

Thanks all.

Eleanor



Eleanor Tang,
Associate Engineer, Permits Division

Bureau of Street-Use and Mapping | San Francisco Public Works | City and County of San Francisco
49 South Van Ness Avenue, Suite 300 | San Francisco, CA 94103 | direct (628) 271-2028 | sfpublicworks.org · twitter.com/sfpublicworks

From: Wong, Norman <Norman.Wong@sfmta.com>
Sent: Thursday, January 6, 2022 1:33 PM
To: Tang, Eleanor (DPW) <eleanor.tang@sfdpw.org>
Subject: FW: 2500 Turk Blvd USF Offsite Plans (BSM Permit 19IE-01104)

Hi Eleanor - Here is the original email that you can forward to the new 2500 Turk SFPW-BSM contact. Note the below feedback requires follow up with SFPW DAC, BUF, and potentially Planning.

Thanks

Norman

From: Wong, Norman
Sent: Wednesday, January 5, 2022 4:07 PM
To: Matt Oliver <Matt@olivermngmt.com>
Cc: sghai@bkf.com; Lokelani Yee <lyee@bkf.com>; Elizabeth E. Miles <eeemiles@usfca.edu>; Velasco, Manito <Manito.Velasco@sfmta.com>; Roback, Soroush <Soroush.Roback@sfmta.com>; Hildreth, Casey <Casey.Hildreth@sfmta.com>; Stein, Gail <Gail.Stein@sfmta.com>; Shue, Kevin <Kevin.Shue@sfmta.com>; West, Matthew A. <Matthew.West@sfmta.com>; Gonzaga, Janalee (DPW) <janalee.gonzaga@sfdpw.org>
Subject: 2500 Turk Blvd USF Offsite Plans (BSM Permit 19IE-01104)

Hi Matt – Please refer to the attachments and below summary which corresponds to the numbering in the “2500 Turk” pdf. If you have no further comments/questions, the next steps would be for the team and/or Janalee (SFPW) to forward our feedback to other city depts (SFPW ADA, BUF, Planning).

Thanks

Norman

1. SFMTA to improve pedestrian crossing at Turk/Roselyn Terrace intersection
 - a. Delete curb ramp improvement at NE corner and construct standard curb/gutter
 - b. MTA to remove east crosswalk striping and legislate crosswalk closure
 - c. 2500 Market team to discuss with SFPW ADA whether curb ramp at opposite corner needs to be removed or installation of ped barricade (with R49 sign) is sufficient
 - d. SFMTA is proposing to install a Rectangular Rapid Flashing Beacon (RRFB) in approximately 6 months. Refer to attached draft plans and future crosswalk striping.

2. Delete proposed tree from stem of T-intersection
 - a. Not allowed per SFPW Street Tree Planting guidelines
 - b. Could impact visibility of future RRFB
 - c. Consider installing a replacement tree east of existing Roselyn crosswalk (at least 25+ ft from edge of existing crosswalk)
3. Future RRFB to be installed onto existing Muni OCS Pole. Pedestrian push button to be mounted onto pole which requires flat landing and accessible area. Thus, the area between the Muni pole (including base of Muni pole) and the new ADA curb ramp (see area circled in red) needs to be kept clear of ground landscaping and leave as standard concrete sidewalk.
4. Delete proposed tree and ground landscaping strip as this impacts operations of the future bus stop (the existing bus stop located east of Roselyn will be relocated to the west side of the intersection and after completion of 2500 Turk sidewalk improvements).
 - a. The existing bus shelter (also located east of Roselyn) will be relocated to this area. SFMTA to coordinate with Clear Channel to relocate shelter.
5. Power to the new bus shelter will be obtained from the adjacent streetlight pull box. SFMTA to coordinate with Clear Channel to implement.
6. Delete proposed tree as tree is in middle of intersection and impacts visibility of pedestrian at adjacent curb ramp
7. SFMTA to consider striping a crosswalk across USF driveway
8. SFMTA to improve pedestrian crossing at Turk/Kittredge Terrace intersection
 - a. MTA to remove west crosswalk striping and legislate crosswalk closure
 - b. 2500 Market team to discuss with SFPW ADA whether proposed 2500 Turk curb ramp at NW corner needs to be redesigned if pedestrian crossing is only across USF driveway and requirement for installation of ped barricade with sign.
 - c. 2500 Market team to discuss with SFPW ADA whether curb ramp at opposite corner needs to be reconstructed or whether installation of ped barricade with sign is sufficient
 - d. Refer to attached plans showing draft plans and future crosswalk striping.

From: Matt Oliver <Matt@olivermgmt.com>

Sent: Friday, December 31, 2021 12:53 PM

To: Wong, Norman <Norman.Wong@sfmta.com>

Cc: sghai@bkf.com; Lokelani Yee <lyee@bkf.com>; Elizabeth E. Miles <emiles@usfca.edu>

Subject: RE: SFMTA Review Needed: 2500 Turk Blvd USF Offsite Plans (BSM Permit 19IE-01104)

Importance: High

EXT

Norman – Happy New Year!

I just wanted to check in with you, as we end 2021 and enter 2022.

Would you please let us know what your recent conversations have been with the different SF departments, as we discussed?

Thank you.

Matt Oliver

415-515-6885

From: Matt Oliver

Sent: Sunday, December 12, 2021 9:37 AM

To: 'Wong, Norman' <Norman.Wong@sfmta.com>

Cc: sghai@bkf.com; Lokelani Yee <lyee@bkf.com>; Elizabeth E. Miles <emiles@usfca.edu>

Subject: RE: SFMTA Review Needed: 2500 Turk Blvd USF Offsite Plans (BSM Permit 19IE-01104)

Norman – Thank you for (meeting) with us on Friday, including Kevin (very helpful). It was a very constructive discussion, defining next steps for moving the SIP along. We look forward to hearing from you (the next few weeks) following your discussions with the different internal departments and Planning Department.

Thanks again.

Matt Oliver

415-515-6885

This message is from outside of the SFMTA email system. Please review the email carefully before responding, clicking links, or opening attachments.

This message is from outside of the SFMTA email system. Please review the email carefully before responding, clicking links, or opening attachments.

From: [Velasco, Manito](#)
To: [Hildreth, Casey](#); [Wong, Norman](#); [Roback, Soroush](#); [Shue, Kevin](#); [Goodrich, Elliot](#)
Subject: RE: 2500 Turk Blvd USF Offsite Plans (BSM Permit 19IE-01104)
Date: Monday, January 31, 2022 11:34:17 AM
Attachments: [image001.png](#)
[image002.png](#)

Actually going to PH this Friday – saw the posting on one of the poles. MTAB hopefully early March.

Proposals to improve bus operation on McAllister between Gough and Van Ness.

Turk Boulevard and Roselyn Terrace – Bus Zones

17(a). RESCIND – BUS ZONE

Turk Boulevard, north side, from Roselyn Terrace to 105 feet easterly
(Requires approval by the SFMTA Board)

17(b). ESTABLISH – BUS ZONE

Turk Boulevard, north side from Roselyn Terrace to 105 feet westerly
(Requires approval by the SFMTA Board)

17(c). ESTABLISH – NO PARKING ANYTIME

Turk Boulevard, north side, at Roselyn Terrace, from the western crosswalk to 35 feet easterly to the eastern crosswalk (Supervisor District 2) (Requires approval by the SFMTA Board) Kevin Shue, Kevin.Shue@sfmta.com

Proposal to relocate westbound bus zone far side of the intersection

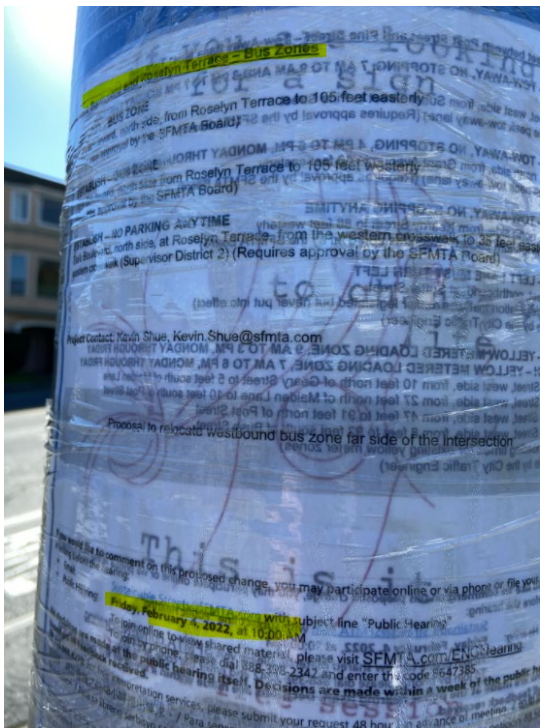

From: Hildreth, Casey <Casey.Hildreth@sfmta.com>

Sent: Monday, January 31, 2022 11:30 AM

To: Velasco, Manito <Manito.Velasco@sfmta.com>; Wong, Norman <Norman.Wong@sfmta.com>; Roback, Soroush <Soroush.Roback@sfmta.com>; Shue, Kevin <Kevin.Shue@sfmta.com>; Goodrich, Elliot <Elliot.Goodrich@sfmta.com>

Subject: Re: 2500 Turk Blvd USF Offsite Plans (BSM Permit 19IE-01104)

Thanks Manito -

FYI, Elliot Goodrich is a new planner on my team and will be working to bring the crosswalk closure(s) through to TASC/approval. We'll communicate out a schedule when we've got one but hoping in a cycle or two.

I think the answer is 'yes' but can you please remind us if the transit team already legislated the bus stop relocation?

Thanks!

CH

From: Velasco, Manito <Manito.Velasco@sfmta.com>
Sent: Monday, January 31, 2022 11:11 AM
To: Wong, Norman <Norman.Wong@sfmta.com>; Roback, Soroush <Soroush.Roback@sfmta.com>; Hildreth, Casey <Casey.Hildreth@sfmta.com>; Shue, Kevin <Kevin.Shue@sfmta.com>
Subject: Re: 2500 Turk Blvd USF Offsite Plans (BSM Permit 19IE-01104)

Happened to be by yesterday – some fresh photos. Even on a Sunday the Roselyn crosswalk is well-used.

Manito

From: Wong, Norman <Norman.Wong@sfmta.com>
Sent: Wednesday, January 5, 2022 4:06:45 PM
To: Matt Oliver <Matt@olivermgmt.com>
Cc: sghai@bkf.com <sghai@bkf.com>; Lokelani Yee <lyee@bkf.com>; Elizabeth E. Miles <eemiles@usfca.edu>; Velasco, Manito <Manito.Velasco@sfmta.com>; Roback, Soroush <Soroush.Roback@sfmta.com>; Hildreth, Casey <Casey.Hildreth@sfmta.com>; Stein, Gail <Gail.Stein@sfmta.com>; Shue, Kevin <Kevin.Shue@sfmta.com>; West, Matthew A. <Matthew.West@sfmta.com>; Gonzaga, Janalee (DPW) <janalee.gonzaga@sfdpw.org>
Subject: 2500 Turk Blvd USF Offsite Plans (BSM Permit 19IE-01104)

Hi Matt – Please refer to the attachments and below summary which corresponds to the numbering in the “2500 Turk” pdf. If you have no further comments/questions, the next steps would be for the team and/or Janalee (SFPW) to forward our feedback to other city depts (SFPW ADA, BUF, Planning).

Thanks

Norman

1. SFMTA to improve pedestrian crossing at Turk/Roselyn Terrace intersection
 - a. Delete curb ramp improvement at NE corner and construct standard curb/gutter
 - b. MTA to remove east crosswalk striping and legislate crosswalk closure
 - c. 2500 Market team to discuss with SFPW ADA whether curb ramp at opposite corner needs to be removed or installation of ped barricade (with R49 sign) is sufficient
 - d. SFMTA is proposing to install a Rectangular Rapid Flashing Beacon (RRFB) in approximately 6 months. Refer to attached draft plans and future crosswalk striping.
2. Delete proposed tree from stem of T-intersection
 - a. Not allowed per SFPW Street Tree Planting guidelines
 - b. Could impact visibility of future RRFB
 - c. Consider installing a replacement tree east of existing Roselyn crosswalk (at least 25+ ft from edge of existing crosswalk)
3. Future RRFB to be installed onto existing Muni OCS Pole. Pedestrian push button to be mounted onto pole which requires flat landing and accessible area. Thus, the area between the Muni pole (including base of Muni pole) and the new ADA curb ramp (see area circled in red) needs to be kept clear of ground landscaping and leave as standard concrete sidewalk.
4. Delete proposed tree and ground landscaping strip as this impacts operations of the future bus stop (the existing bus stop located east of Roselyn will be relocated to the west side of the intersection and after completion of 2500 Turk sidewalk improvements).
 - a. The existing bus shelter (also located east of Roselyn) will be relocated to this area. SFMTA to coordinate with Clear Channel to relocate shelter.
5. Power to the new bus shelter will be obtained from the adjacent streetlight pull box. SFMTA to coordinate with Clear Channel to implement.
6. Delete proposed tree as tree is in middle of intersection and impacts visibility of pedestrian at adjacent curb ramp
7. SFMTA to consider striping a crosswalk across USF driveway
8. SFMTA to improve pedestrian crossing at Turk/Kittredge Terrace intersection
 - a. MTA to remove west crosswalk striping and legislate crosswalk closure
 - b. 2500 Market team to discuss with SFPW ADA whether proposed 2500 Turk curb ramp at NW corner needs to be redesigned if pedestrian crossing is only across USF driveway and requirement for installation of ped barricade with sign.
 - c. 2500 Market team to discuss with SFPW ADA whether curb ramp at opposite corner needs to be reconstructed or whether installation of ped barricade with sign is sufficient
 - d. Refer to attached plans showing draft plans and future crosswalk striping.

From: Matt Oliver <Matt@olivermgmt.com>

Sent: Friday, December 31, 2021 12:53 PM

To: Wong, Norman <Norman.Wong@sfmta.com>

Cc: sghai@bkf.com; Lokelani Yee <lyee@bkf.com>; Elizabeth E. Miles <eemiles@usfca.edu>

Subject: RE: SFMTA Review Needed: 2500 Turk Blvd USF Offsite Plans (BSM Permit 19IE-01104)

Importance: High

EXT

Norman – Happy New Year!

I just wanted to check in with you, as we end 2021 and enter 2022.

Would you please let us know what your recent conversations have been with the different SF departments, as we discussed?

Thank you.

Matt Oliver

415-515-6885

From: Matt Oliver

Sent: Sunday, December 12, 2021 9:37 AM

To: 'Wong, Norman' <Norman.Wong@sfmta.com>

Cc: sghai@bkf.com; Lokelani Yee <lyee@bkf.com>; Elizabeth E. Miles <eemiles@usfca.edu>

Subject: RE: SFMTA Review Needed: 2500 Turk Blvd USF Offsite Plans (BSM Permit 19IE-01104)

Norman – Thank you for (meeting) with us on Friday, including Kevin (very helpful). It was a very constructive discussion, defining next steps for moving the SIP along. We look forward to hearing from you (the next few weeks) following your discussions with the different internal departments and Planning Department.

Thanks again.

Matt Oliver

415-515-6885

Turk St / Roselyn Terrace and Kittredge Terrace Crosswalk Consolidation

February 2022

Muni bus routes in the project vicinity.

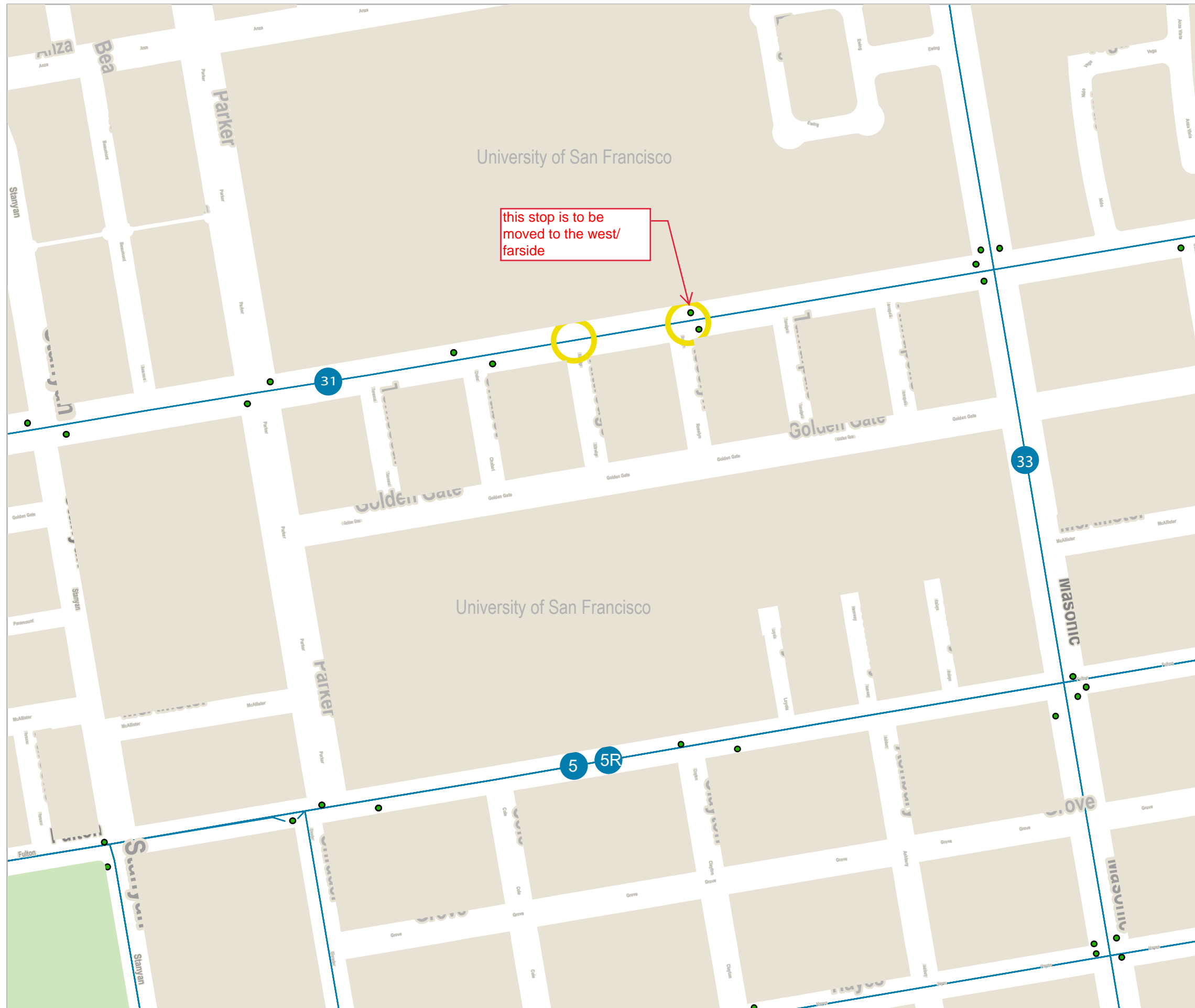

LEGEND

- Bus stops
- Muni routes
- Project locations



0.055 miles

Scale 1:3,000

Date Saved: 2/14/2022

For reference contact: elliot.goodrich@sfmta.com

By downloading this map, you are agreeing to the following disclaimer: "The City and County of San Francisco ("City") provides the following data as a public record and no rights of any kind are granted to any person by the City's provision of this data. The City and County of San Francisco ("City") makes no representation regarding and does not guarantee or otherwise warrant the accuracy or completeness of this data. Anyone who uses this data for any purpose whatsoever does so entirely at their own risk. The City shall not be liable or otherwise responsible for any loss, harm, claim or action of any kind from any person arising from the use of this data. By accessing this data, the person accessing it acknowledges that she or he has read and does so under the condition that she or he agrees to the contents and terms of this disclaimer."



Turk Blvd / Roseyln Terrace and Kittredge Terrace Crosswalk Consolidation Collision History

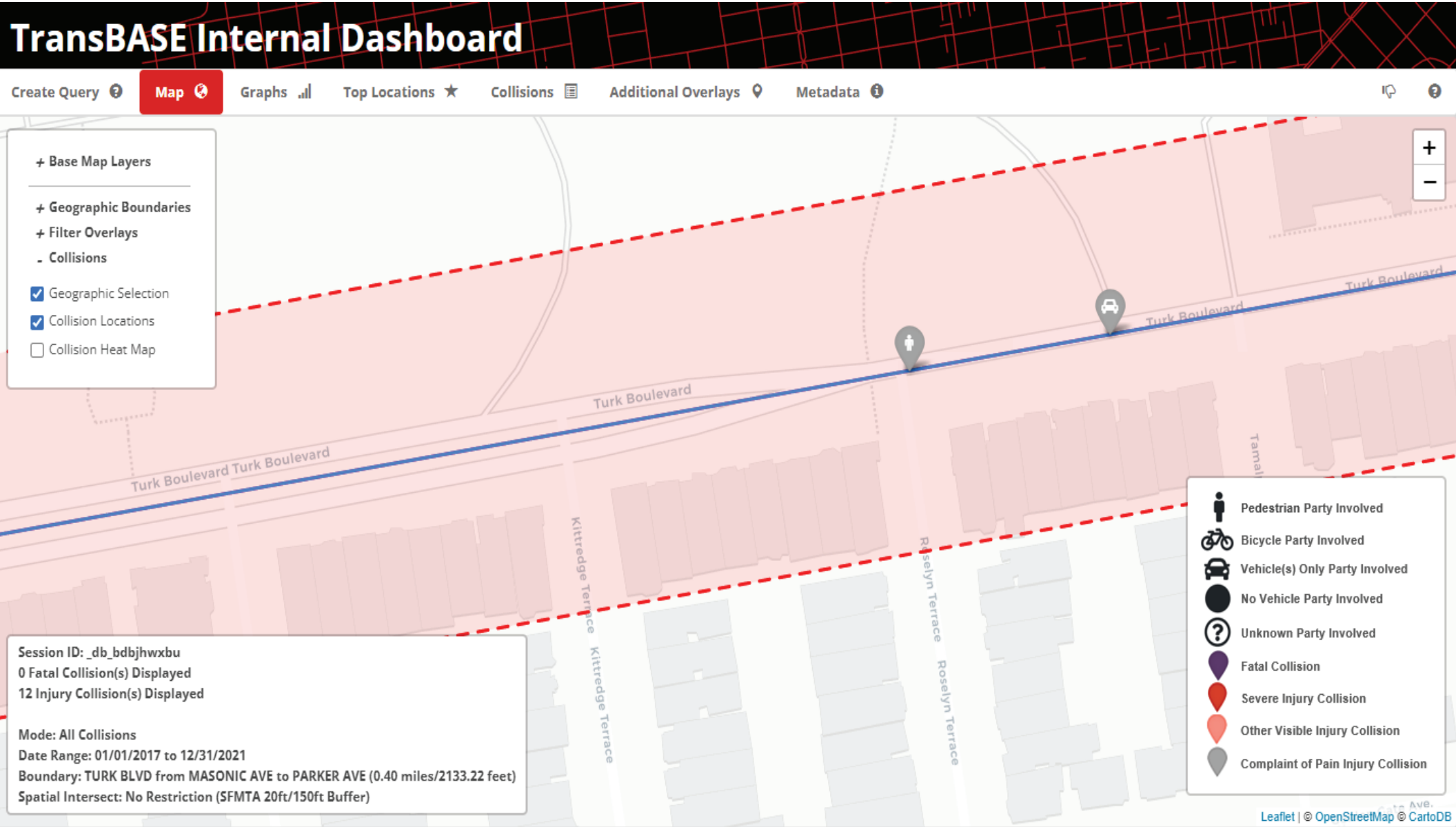

TransBASE Internal Dashboard

Geographic Extent: TURK BLVD from MASONIC AVE to PARKER AVE (0.40 miles/2133.22 feet)

Spatial Intersect: No Restriction (SFMTA 20ft/150ft Buffer)

Data Range: 01/01/2017 to 12/31/2021

Pull Date: 2/17/2022

Collision/Party/Victim Table

Showing 1 to 12 of 12 entries

Count of Fatal Collisions: 0

Count of Non-Fatal Injury Collisions: 12

Total Count of Fatal/Non-Fatal Injury Collisions: 12

Case ID	Collision Date	Collision Time	Day of Week	Primary Road	Secondary Road	Distance	Direction	Party 1 Type	Party 1 Direction of Travel	Party 1 Movement Preceding Crash	Party 2 Type	Party 2 Direction of Travel	Party 2 Movement Preceding Crash	Vehicle Code Violation	Highest Degree of Injury	Type of Collision	Motor Vehicle Involved With	Weather	Lighting
210065981	01/30/2021	01:50	Saturday	MASONIC AVE	TURK BLVD	0	Not Stated	Driver	South	Proceeding Straight				CVC 22350	Injury (Other Visible)	Head-On	Fixed Object	Clear	Dark - Street Lights
200334542	06/02/2020	14:21	Tuesday	TURK BLVD	PARKER AVE	0	Not Stated	Driver	East	Proceeding Straight	Driver	South	Proceeding Straight	CVC 21453(a)	Injury (Complaint of Pain)	Broadside	Other Motor Vehicle	Clear	Daylight
200304498	05/19/2020	12:00	Tuesday	TURK BLVD	PARKER AVE	0	Not Stated	Driver	West	Proceeding Straight	Driver	North	Proceeding Straight	CVC 21453(a)	Injury (Complaint of Pain)	Broadside	Other Motor Vehicle	Clear	Daylight
200245892	04/17/2020	19:59	Friday	MASONIC AVE	TURK BLVD	0	Not Stated	Driver	West	Making Right Turn	Driver	West	Proceeding Straight	CVC 22107	Injury (Other Visible)	Sideswipe	Other Motor Vehicle	Clear	Dark - Street Lights
200112144	02/14/2020	03:59	Friday	MASONIC AVE	TURK BLVD	0	Not Stated	Driver	East	Making Left Turn	Driver	South	Proceeding Straight	CVC 21453(a)	Injury (Complaint of Pain)	Broadside	Other Motor Vehicle	Clear	Dark - Street Lights
190426637	06/13/2019	18:15	Thursday	TURK BLVD	ANNAPOLIS TER	50	East	Driver	West	Not Stated	Driver	East	Not Stated	CVC 22350	Injury (Complaint of Pain)	Rear End	Other Motor Vehicle	Cloudy	Daylight
190343354	05/13/2019	16:55	Monday	ANNAPOLIS TER	TURK BLVD	0	Not Stated	Driver	West	Backing	Driver	North	Proceeding Straight	CVC 22106	Injury (Complaint of Pain)	Broadside	Other Motor Vehicle	Clear	Daylight
190245192	04/07/2019	00:15	Sunday	TURK BLVD	PARKER AVE	18	West	Driver	East	Proceeding Straight	Driver	East	Stopped	CVC 22350	Injury (Complaint of Pain)	Not Stated	Other Motor Vehicle	Clear	Dark - Street Lights
180885190	11/22/2018	18:11	Thursday	PARKER AVE	TURK BLVD	0	Not Stated	Driver	East	Making Left Turn	Pedestrian	South	Proceeding Straight	CVC 22107	Injury (Severe)	Vehicle/ Pedestrian	Pedestrian	Raining	Dark - Street Lights
180676375	09/07/2018	08:50	Friday	TURK BLVD	TAMALPAIS TER	105	West	Driver	East	Proceeding Straight	Driver	East	Proceeding Straight	CVC 21703	Injury (Complaint of Pain)	Sideswipe	Other Motor Vehicle	Clear	Daylight
180195284	03/14/2018	19:50	Wednesday	TURK BLVD	ROSELYN TER	0	Not Stated	Driver	West	Proceeding Straight	Pedestrian	Not Stated	Not Stated	CVC 21950(a)	Injury (Complaint of Pain)	Head-On	Pedestrian	Clear	Daylight
170231343	03/21/2017	09:08	Tuesday	TURK BLVD	PARKER AVE	0	Not Stated	Driver	West	Slowing/ Stopping	Driver	West	Slowing/ Stopping	CVC 22350	Injury (Other Visible)	Rear End	Other Motor Vehicle	Cloudy	Daylight

TransBASE Internal Dashboard

Geographic Extent: TURK BLVD from MASONIC AVE to PARKER AVE (0.40 miles/2133.22 feet)

Spatial Intersect: No Restriction (SFMTA 20ft/150ft Buffer)

Data Range: 01/01/2017 to 12/31/2021

Pull Date: 2/17/2022

Metadata Information

Collision Filters

Database Source: TransBASESF.org
Database Pull Date: 2/17/2022
Collision Level: Injury Collisions
Boundary: TURK BLVD from MASONIC AVE to PARKER AVE
(0.40 miles/2133.22 feet)
Collision Dates: 01/01/2017 to 12/31/2021
Collision Month Filter(s): No Restrictions
Collision Distance: Any Distance
Collision Severity Filter(s): No Restrictions
Primary Collision Factor Filter(s): No Restrictions
Collision Type Filter(s): No Restrictions
Intersection/Midblock: No Restriction (SFMTA 20ft/150ft Buffer)

Party Filters

Party Involved Type: No Restrictions
Party Involved Gender: No Restrictions
Party Involved at Fault: No Restrictions
Party Involved Age: No Restriction
Party Involved Sobriety: No Restrictions
Party Involved Condition: No Restrictions
Party Involved Direction of Travel: No Restrictions
Party Involved Safety Equipment 1: No Restrictions
Party Involved Safety Equipment 2: No Restrictions
Party Involved Insurance: No Restrictions
Party Involved Other Associated Factors : No Restrictions
Party Involved Movement Preceding Collision: No Restrictions
Party Involved Vehicle Type: No Restrictions
Party Involved Race: No Restrictions
Party Involved Special Info: No Restrictions

Victim Filters

Victim Involved Role: No Restrictions
Victim Involved Degree of Injury: No Restrictions
Victim Involved Age: No Restriction
Victim Involved Seating Position: No Restrictions
Victim Involved Safety Equipment: No Restrictions
Victim Involved Ejected: No Restrictions

Environmental Filters

Nearest Traffic Control: No Restriction
Intersecting Speed Limit: No Restriction
Intersecting Network: No Restriction
Intersecting Street Class: No Restriction
Weather Description: No Restrictions
Lighting Description: No Restrictions