

## SFMTA - TASC SUMMARY SHEET

<b>PreStaff_Date:</b> 9/23/2021 <b>Requested_by:</b> SFMTA <b>Handled:</b> Laura Stonehill (646-4320) <b>Section Head :</b> M. Sallaberry <i>MS</i>	<input type="checkbox"/> <b>Public Hearing Consent</b> <input checked="" type="checkbox"/> <b>Public Hearing Regular</b> <input type="checkbox"/> <b>Informational / Other</b> <small>PH - Regular</small>	<b>No objections:</b> _____ <b>Item Held:</b> _____ <b>Other:</b> _____
--	---	---

**Location:** 25th Avenue at Irving Street

**Subject:** Bike Share Station

**PROPOSAL / REQUEST:**  
 ESTABLISH - NO STOPPING EXCEPT BICYCLES  
 ESTABLISH - BIKE SHARE STATION  
 25th Avenue, east side, from Irving Street to 59 feet northerly (53-foot bike share station with red zones on each side of the station).  
 (Supervisor District 4)

Proposing a Bay Wheels bike share station in the parking lane on 25th Avenue at Irving Street, adjacent to SF Eyecare.

Laura Stonehill, [laura.stonehill@sfmta.com](mailto:laura.stonehill@sfmta.com)

**BACKGROUND INFORMATION / COMMENTS**

Stations with bicycles are 6 feet long and 4 feet tall with a kiosk 7.8 feet tall and map panel at the northern end of the station. Stations are solar powered via a panel system that extends vertically from the kiosk. No excavation is necessary.

- No bike facilities.
- no Muni
- Lyft conducted outreach to the adjacent with various community groups and got buy off from Supervisor Mar's office.

Grid M7  
 19-dock station

<b>HEARING NOTIFICATION AND PROCESSING NOTES:</b>	<b>ENVIRONMENTAL CLEARANCE BY:</b> <input type="checkbox"/> SFMTA <input checked="" type="checkbox"/> Attached <input type="checkbox"/> Pending
---	--

# Proposed Bay Wheels Stations in District 4

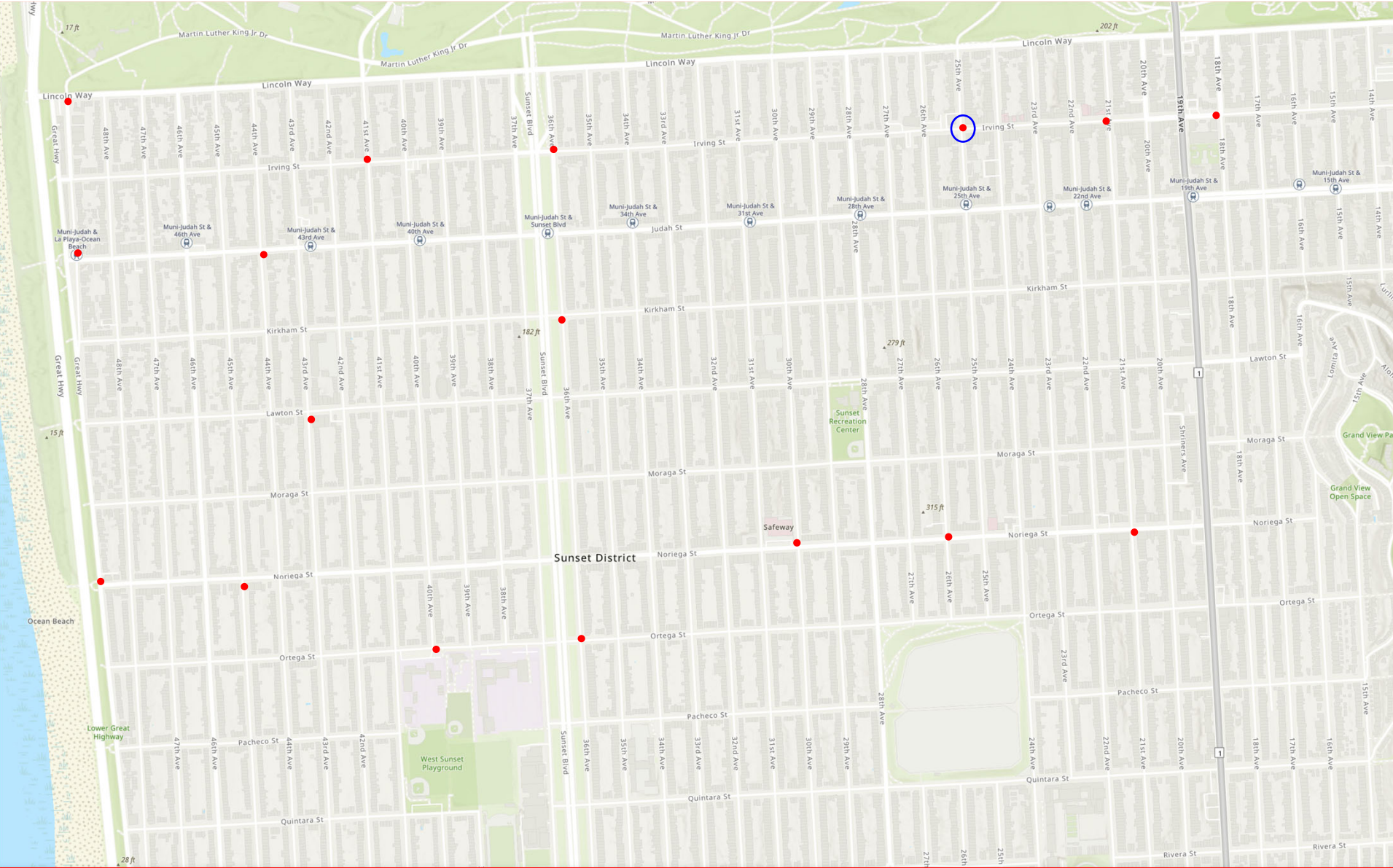





Stand Pipe		Parking Meters	
Fire Hydrants (High Pressure)		Tree With Grate/Well	
Fire Hydrants (Low Pressure)		Proposed Red Curb	
Street Light with Arm		Proposed Blue Curb	
Street Light		Proposed Yellow Curb	
Utility Pole		Proposed Green Curb	
Signal Pole		Proposed White Curb	

**ABBREVIATIONS**

BS = BUS SHELTER	TC = TRASH CAN
BR = BIKE RACK	TYP. = TYPICAL
CC = TRAFFIC SIGNAL CONTROLLER CABINET	UC = UTILITY CABINET
DI = DRAINAGE INLET	V = UTILITY VALVE
DW = DRIVEWAY	UV = UTILITY VAULT
LF = LINEAR FEET	R/C = EXISTING RED CURB
MB = MAIL BOX	B/C = EXISTING BLUE CURB
MH = MANHOLE	Y/C = EXISTING YELLOW CURB
NS = NEWSPAPER STAND	G/C = EXISTING GREEN CURB
PB = PULL BOX	W/C = EXISTING WHITE CURB
M/C = MOTORCYCLE	

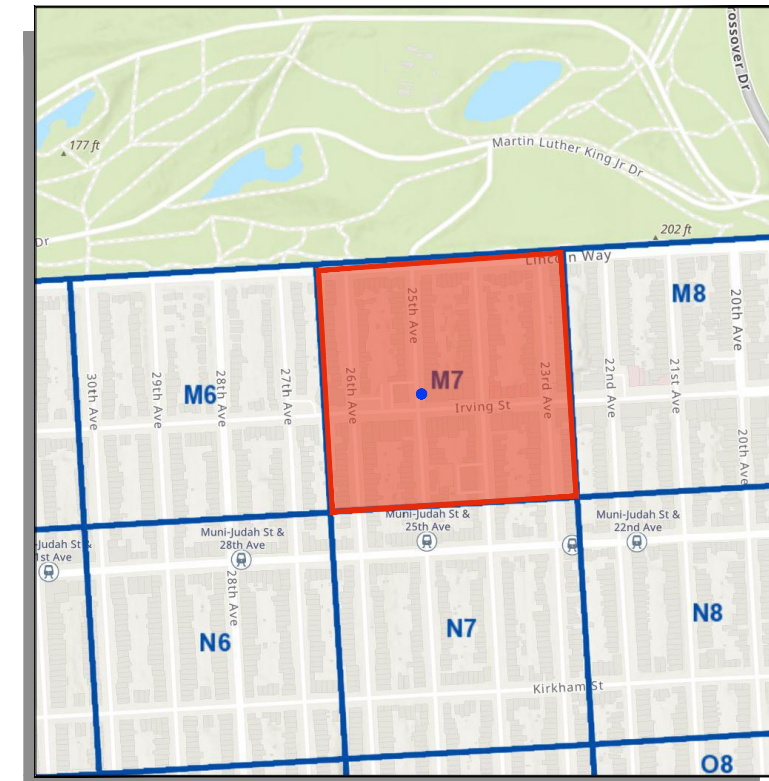

**SITE NOTES**

- ON-STREET SITE
- ADJACENT TO 3500 IRVING ST
- UNMETERED PARKING

= PLAN REFERENCE POINT  
**SITE LOCATION**  
 NOT TO SCALE

**VICINITY MAP**  
 NOT TO SCALE

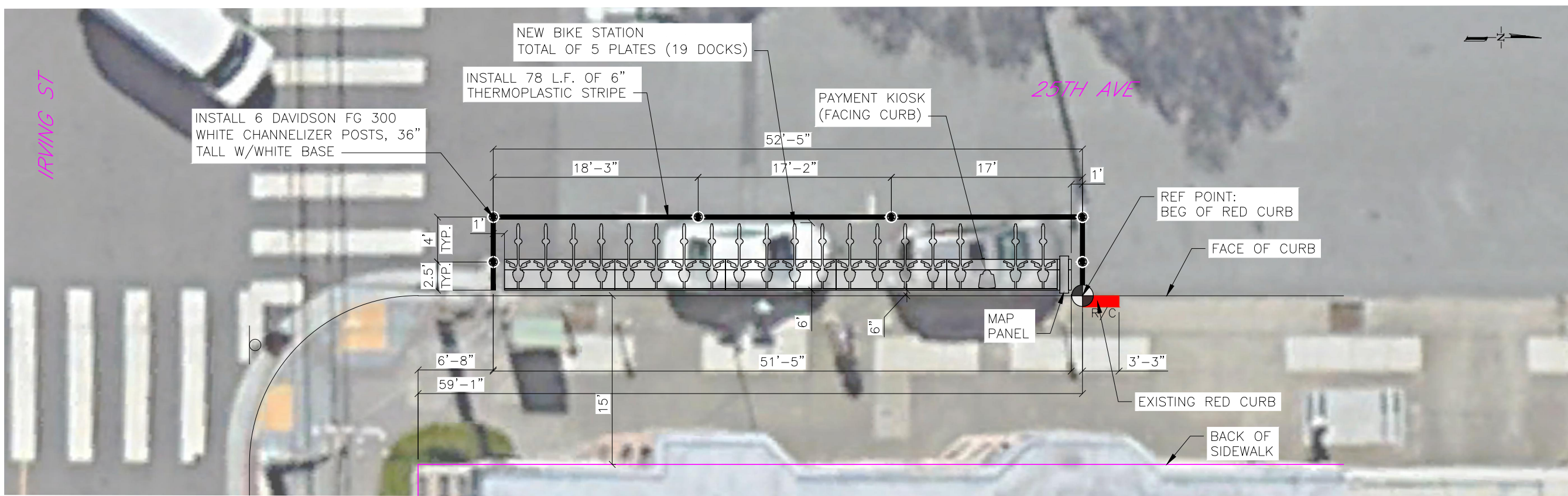

**SITE PLAN**

5 0 5 10  
 GIVEN DIMENSIONS TAKE PRECEDENCE OVER SCALED MEASUREMENTS

CADD FILE:

REVISIONS		
NO.	DATE	DESCRIPTION



DRAWN BY: CMV  
 DESIGNED BY: CMV  
 CHECKED BY: CMV  
 DATE: 7/29/21  
 PROJECT NO:



STATION TYPE:	Standard Off-Street
STATION ID:	SF-M 7
PLATES:	5
DOCKS:	19
KIOSKS:	1

**Station Site and Plan**  
**SF-M7**  
 25TH AVE AT IRVING ST



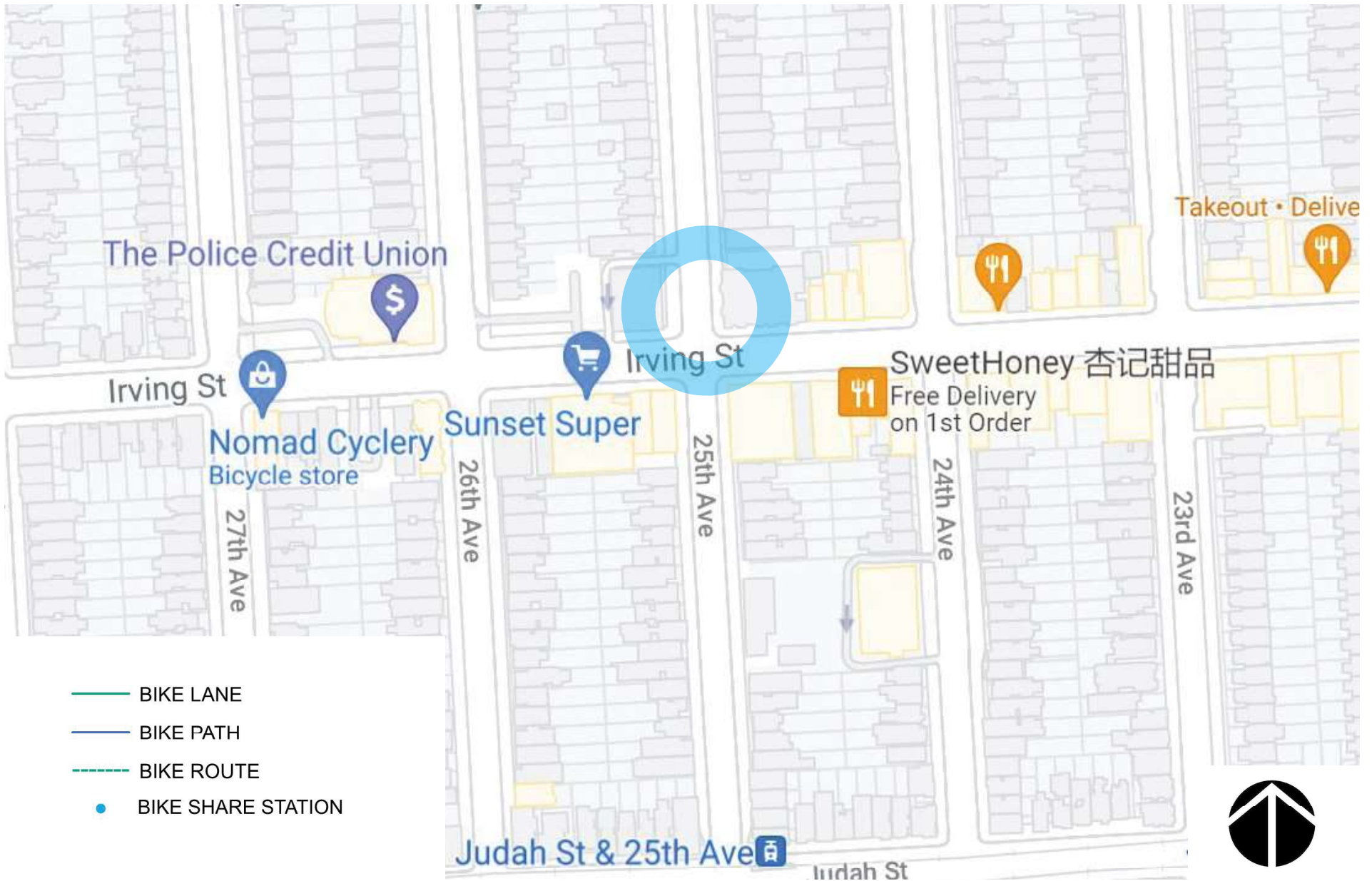

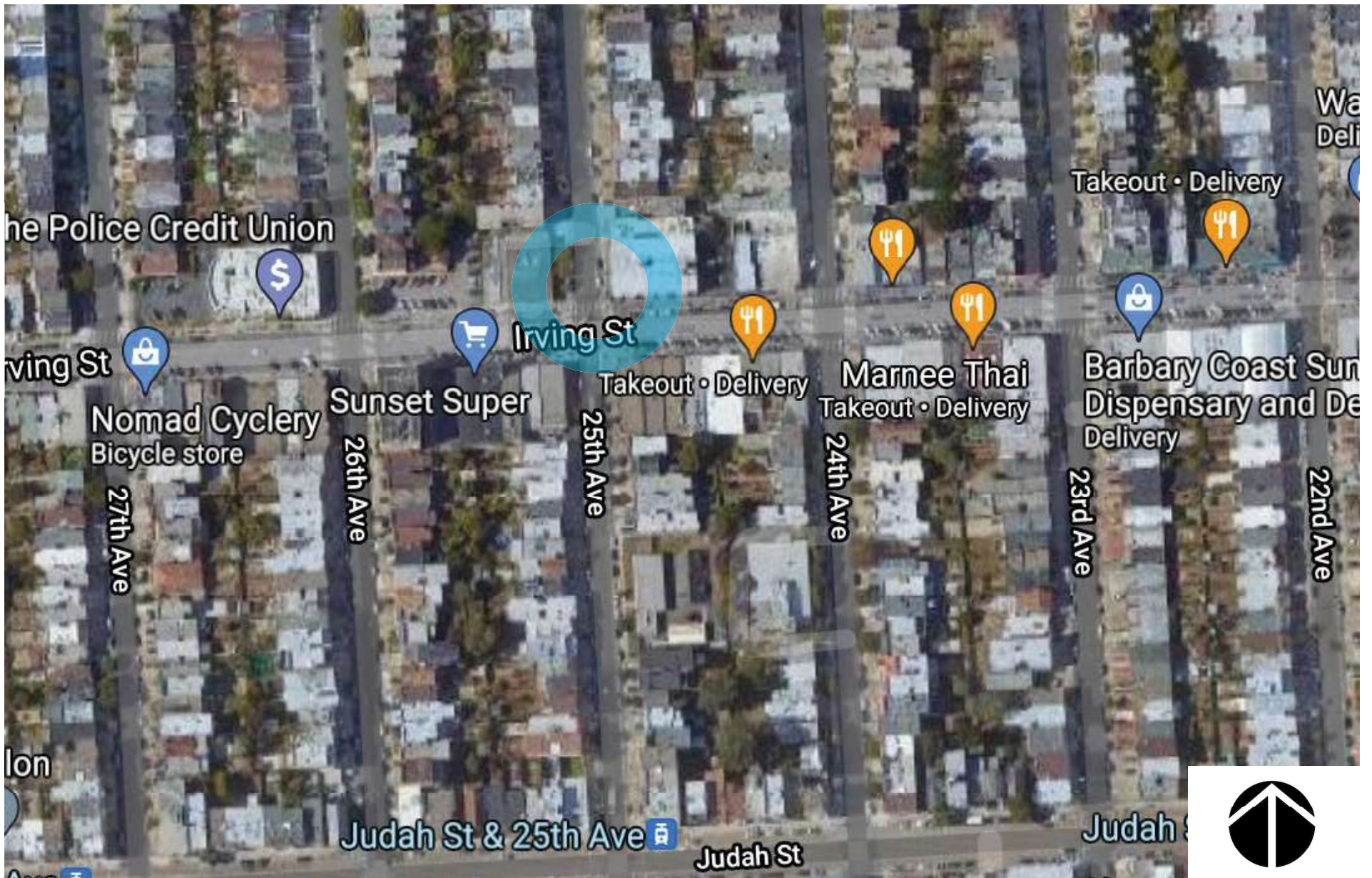

**bay**wheels

Bay Wheels  
Aerial Map



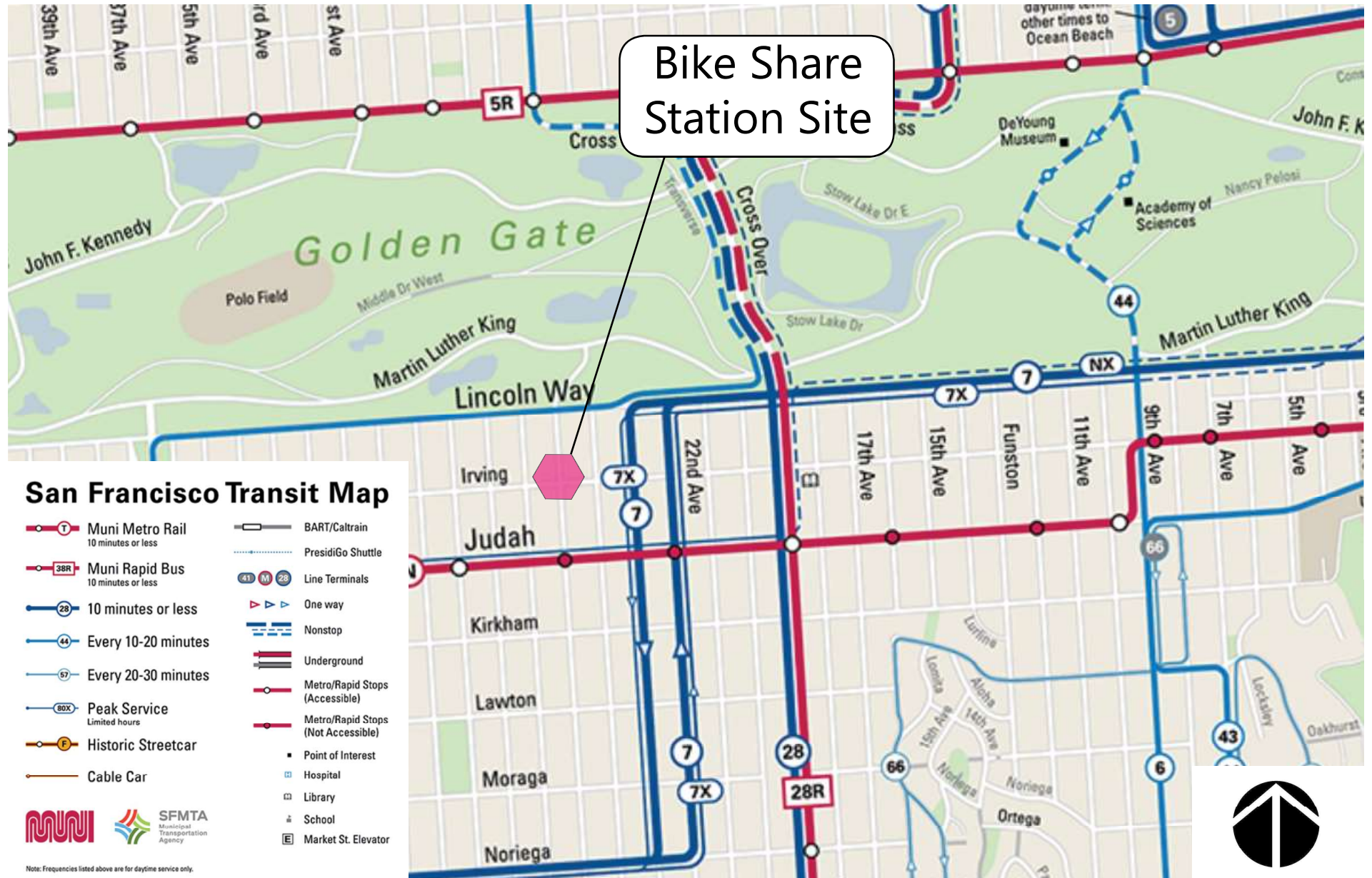

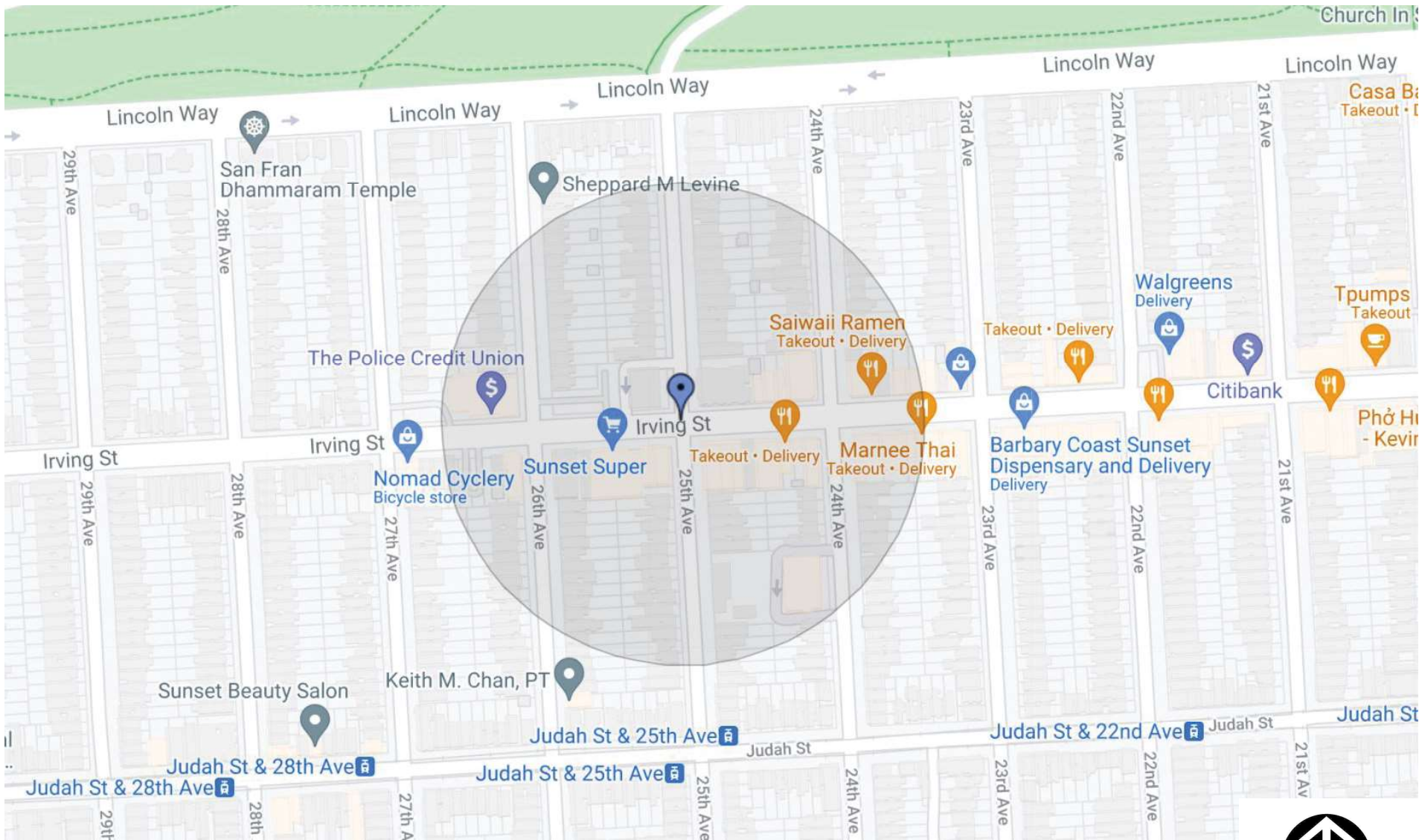



NORTH

EAST



SOUTH

WEST

**bay**wheels

Bay Wheels  
Photo Array



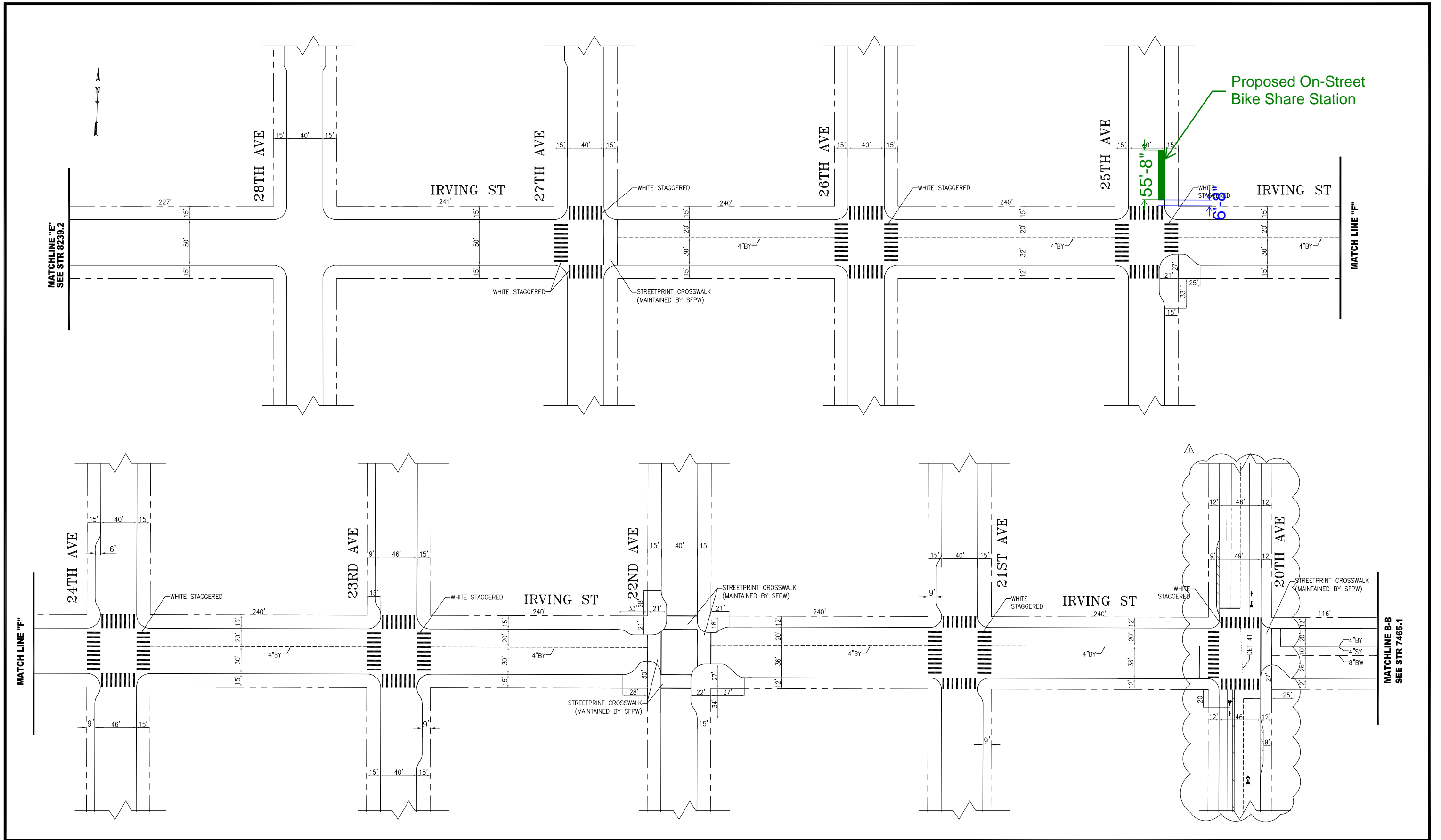

NO.	DATE	DESCRIPTION	BY	APP
1	06/11/17	REMOVE SHARROWS ON 20TH AVE. ADD BIKE LINES, SHARROW, CROSSHATCHING, 4"BY, DETAIL 41 ON 20TH AVE. ADD ADVANCED LIMIT LINES ON IRVING & 20TH AVE.	N.SMITH	M.SALLABERRY
2	06/11/17	WHITE STAGG. CONTL. (#21,23-27), DECORATIVE XWALK (#20,22,27), BULBS (20,22,25)	K.M. LEUNG	D. VALLE-SCHWENK

TABLE OF REVISIONS  
CHECK WITH TRACING TO SEE IF YOU HAVE LATEST REVISION



SUPERSEDES: STR-7465 REV1	APPROVED: BRIAN DUSSEAULT 6/1/17 SENIOR ENGINEER
DRAWN: K.M. LEUNG 05/01/17	DATE: 6/1/17
CHECKED: D. VALLE-SCHWENK 05/01/17	DATE: 6/1/17
	APPROVED: RICARDO OLEA 6/1/17 CITY TRAFFIC ENGINEER

SCALE: 1" = 50'
SHEET/SHEETS:

TRAFFIC STRIPING

IRVING STREET  
29TH AVENUE TO 19TH AVENUE

CONTRACT NO.
DRAWING NO. STR-8239.3
FILE NO.
REV. NO. 1

FILE NAME: --/--/---  
DATE: --/--/---

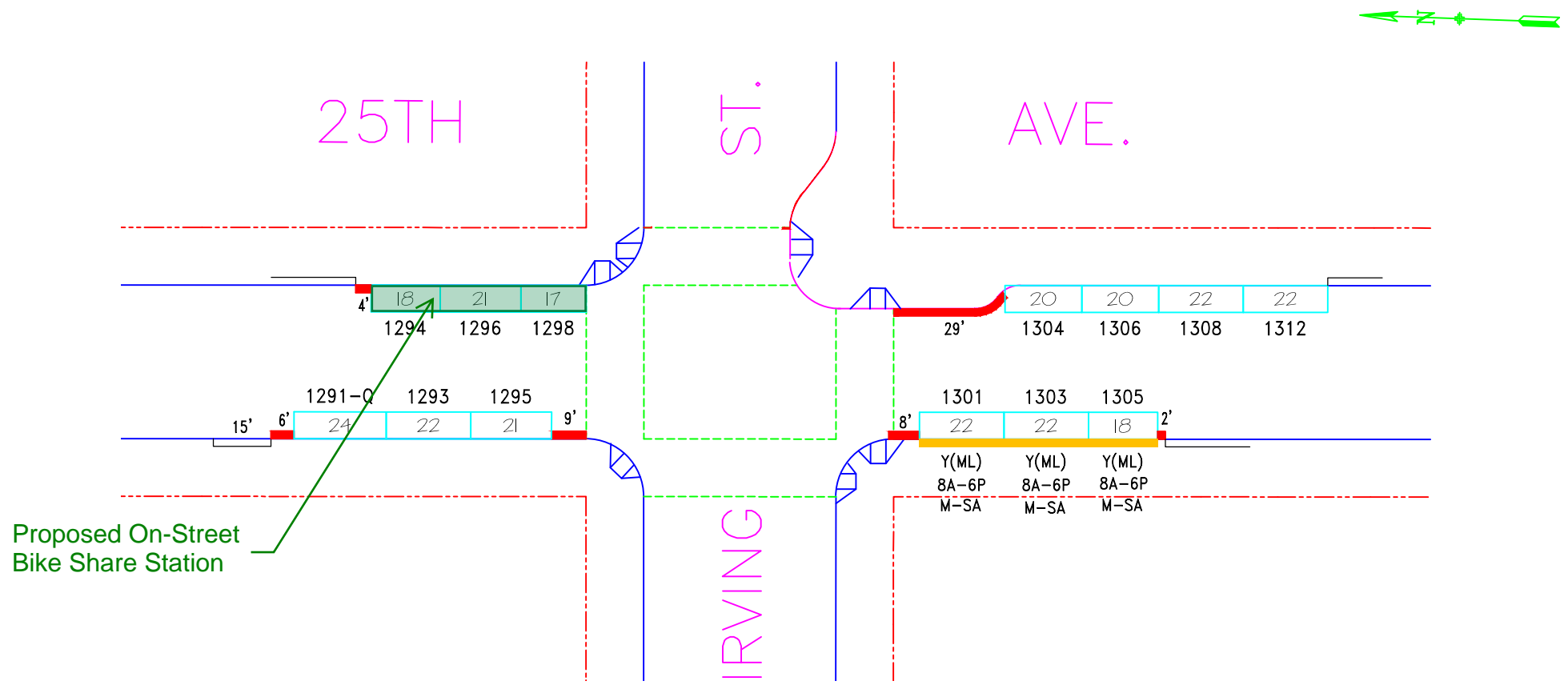

NO.	REVISION DESCRIPTION	BY	DATE	DIR/RES	3	Change #1291 to 15 min. green	JB	4/20/10	3746
1	Y(MTL) # 1301,1303,1305		4/22/04		4	New bulb out, MOS#1302 - E/S	JB	12/16/16	
2	#1305 revise to 18ft parking space	JB	9/15/09		5	Updated per field: Meter spaces-B/S	JB	4/1/17	



SAN FRANCISCO MUNICIPAL TRANSPORTATION AGENCY  
CITY AND COUNTY OF SAN FRANCISCO  
PARKING METER SPACES

SIDE	TOW-AWAY		METER CT.		GENERAL				LOADING			METERED SPACES						TOTAL
	AM	PM	SS	MS	GMP	MC	TIMES	DAYS	ML	MTL	6-W	15 MIN	30 MIN	1 HR	2 HR	10 HR		
ODD			6		3		9A-6P	M-SA		3		1	3		2		6	
EVEN			7		7		9A-6P	M-SA							7		7	

**25TH AVE. (25A, 125)**  
**(1200-1300) BLOCK**  
Meters # 125-12XXY  
**OFF IRVING ST.**

SCALE: 1"=40' DATE: 9/15/09 BY: JB

**AREA**  
**3**



## SF-M7 25th at Irving Documentation of Outreach

---

### Record of Meetings & Correspondence

- Summer/Fall 2020: NP discussed Sunset Expansion with Supervisor Mar's office and sent information about several community outreach events including the Open House and Farmer's Market Outreach
  - July 2020: SP emailed organizations about the Sunset Bikeshare Virtual Open House
    - MSNA, POPS, SNBC, GGP, Sunset Rec Center, SDA, OSPRA, SPEAK, OSMPA, West Side Best Side
  - September 2020: SP emailed organizations with a survey and expansion update
    - MSNA, POPS, SNBC, GGP, Sunset Rec Center, SDA, OSPRA, SPEAK, OSMPA, West Side Best Side
- 

### Attachments

- [Email thread with Supervisor Mar](#)
- [Additional Email thread with Supervisor Mar](#)



Neal Patel &lt;nealpatel@lyft.com&gt;

---

## Bay Wheels - Sunset District expansion update

---

**Neal Patel** <nealpatel@lyft.com>

Wed, Aug 26, 2020 at 4:40 PM

To: "Mar, Gordon (BOS)" <gordon.mar@sfgov.org>, Edward Wright <Edward.W.Wright@sfgov.org>, Bay Wheels Community <community@baywheels.com>, Alex Tourk <tourk@gfpublicaffairs.com>, Jannely Rodriguez <jannely@gfpublicaffairs.com>, Ajouah Grass <ajouah@gfpublicaffairs.com>  
Bcc: "Leung, Adrian" <Adrian.Leung@sfmta.com>

Hello Supervisor Mar and Edward.

Hope you both are doing well. Supervisor, I hope you're feeling well and in good spirits. I appreciate your transparency and your comments on your recent COVID diagnosis and wish you a speedy recovery.

We are sending out the following community update to our stakeholders on Friday morning and I wanted to give you all a heads up. We've been busy the last few months and will be sharing a summary of what we've heard and some proposed changes to the bikeshare network.

It would be great if you could include a quick blurb about our expansion efforts and link to the recorded Zoom workshops in your next newsletter.

Please let us know if you have any questions.

-----

### Community Update

I hope you're well! I wanted to share an update on expanding the bikeshare program to the Sunset District. Over the past few months, my team has been gathering a variety of input from the Sunset community to understand how to best bring bikeshare stations to the neighborhood. We've engaged with over 300 people through [neighborhood outreach](#) and virtual forums and are learning a lot from the community. Through this outreach, we've identified 10 locations for bikeshare stations that we believe will best serve the Sunset. Please see below for more details on the outreach to date and what we've learned so far.





We distributed an online survey to understand existing transportation patterns in the neighborhood, what the perceived benefits and areas for improvement are for the program, and where the community is interested in seeing bikeshare stations. A summary of the survey results is [available here](#).

We also hosted a series of [Open Houses](#) to educate about the program and collect feedback on a draft network based on initial survey results. The first open house was focused around understanding the needs of small businesses; the second was open to the wider neighborhood and community. If you were unable to attend, below are recordings of the open house presentation in English and Cantonese:

[Sunset Expansion Open House – ENGLISH](#) Password: HRS?9pn!

[Sunset Expansion 開放參觀日 – CANTONESE \(廣東話\)](#) Password: 7#?6HDnP

Attached is the [bikeshare station network](#) we are now proposing for the neighborhood, taking into account the feedback we've received through the survey and open houses. Specifically, common themes in feedback in designing this network were to have:

- Stations along Noriega
- More Great Hwy connections
- More than 7 stations
- Station that connects to the Outer Sunset Farmer's Market and Mercantile around 37th/Ortega
- Stations that minimize car parking conversion where possible

Next steps are to continue collecting feedback on this map, so please feel free to review the station locations, share with your networks, and let me know if there are any questions! I'd be happy to schedule some time to chat or join an upcoming virtual meeting if there's interest.

A special thanks to our partners for their efforts in supporting bikeshare and outreach in the Sunset, specifically:

- District 4 Supervisor Gordon Mar
- [SFMTA](#)
- [Great Highway Park](#)
- [Outer Sunset Farmers Market & Mercantile](#)
- West Side = Best Side!

--

**Neal Patel**

Community Affairs Manager  
Lyft Bikes and Scooters, SF Bay Area  
415-264-0840



---

**4 attachments**



**OpenHouse\_Sunset\_July2020\_2.PNG**  
740K



**SunsetMercantile\_August2020\_2.jpg**  
2336K

 **Sunset Bikeshare Survey Results.pdf**  
194K

 **D4 Proposed Network Map 8-20.pdf**  
9275K





Neal Patel &lt;nealpatel@lyft.com&gt;

## Next Steps for D4 Bikeshare Stations

Neal Patel &lt;nealpatel@lyft.com&gt;

Thu, Mar 4, 2021 at 1:12 PM

To: Edward Wright &lt;Edward.W.Wright@sfgov.org&gt;, "Mar, Gordon (BOS)" &lt;gordon.mar@sfgov.org&gt;

Cc: "Leung, Adrian" &lt;Adrian.Leung@sfmta.com&gt;, Bay Wheels Community &lt;community@baywheels.com&gt;

Hi Supervisor Mar and Edward

I hope you are doing well. I wanted to follow up with you all to discuss next steps for the Bay Wheels bikeshare expansion into D4. You may be aware that Stefania Pombo was laid off along with several others on our team late last year. I'll be your primary contact as we move forward. Before she left the group, Stefania engaged with business owners and neighbors directly adjacent to the draft list of bikeshare stations that came from the initial community outreach phase.

Before we proceed, we would like to check in with your office to see if you support the stations that we have listed as "On Track". Our intention would be to re-site those stations we've indicated as "Re-site" so we have a full, supported list of stations for the District to bring to SFMTA Public Hearing.

Please see below for notes - happy to schedule time for a call if you'd like to discuss this.

Station Intersection	Status	Notes & Feedback to Date
La Playa St at Lincoln Way	On track	Rodeway Inn & Suites shared support for the station by their hotel. Mailers were sent to residences across the street. No feedback to date.
44th Ave at Judah St	Possible resite - looking for feedback from Supervisor Mar	Owner of Maxwell Window Shades opposed to the sidewalk station location due to concerns of loitering and building/sidewalk maintenance. Option 1: Keep station in current proposed location to minimize parking conversion in the area. Option 2: Resite station to nearby on-street location to alleviate the owner's concerns.
43rd Ave at Lawton St	On track	Andytown supportive of station location to alleviate bikeshare use of their existing corral. Sunset Church concerned the station would cause further congestion and draw unwanted attention to the area. The bikeshare program recommends moving forward with this station and working with Sunset Church on any issues.
Great Hwy at Noriega St	On track	SFRPD shared support for the station by their property. Mailers were sent to residences across the street. 3 emails received with concerns around parking conversion and the potential effects of poor climate on the bikes.
45th Ave at Noriega St	On track	Lyft has sent mailers, called, and emailed the adjacent business Papa Mak's Burgers. No response received to date. Lyft recommends moving the site forward and continuing with outreach to surrounding neighbors.
Ortega St at 40th Ave	On track	Location pending review by SFPL Leadership team.
30th Ave at Noriega St	On track	Safeway manager is fine with the station location. Mailers were sent to residences across the street and nearby businesses at the intersection. One

		email received with concerns around the proposed station density and resulting parking conversion.
26th Ave at Noriega St	Resite	Adjacent orthodontist office/property owner is opposed to the station due to parking conversion and feelings that their clients would not be served by the bikes. Lyft recommends relocating the proposal across the street to the west side of 26th Ave, by Citibank, to alleviate concerns of adjacent parking conversion by the orthodontist.
21st Ave at Noriega St	Resite	Adjacent restaurant HD Yunnan Rice Noodle opposed to the station location. Lyft recommends relocating the proposal to the west side of 21st Ave, north of Noriega, adjacent to North East Medical Services.
Irving St at 18th Ave	On track	Location pending review by SFPL Leadership team.

--

**Neal Patel**

Community Affairs Manager  
Lyft Bikes and Scooters, SF Bay Area







# SAN FRANCISCO PLANNING DEPARTMENT

## Notice of Exemption

1650 Mission St.  
Suite 400  
San Francisco,  
CA 94103-2479

Reception:  
415.558.6378

Fax:  
415.558.6409

Planning  
Information:  
415.558.6377

DEC 22 2015  
POSTED TO

*Approval Date:* December 18, 2015  
*Case No.:* 2015-005492ENV, SFMTA Bay Area Bicycle Share Project  
*Project Title:* Citywide in San Francisco, primarily within the public right-of-way  
*Zoning:* Not applicable, primarily in the public right of way  
*Block/Lot:* Not applicable, primarily in the public right of way  
*Lot Size:* Not applicable, primarily in the public right of way  
*Lead Agency:* San Francisco Planning Department  
*Project Sponsor:* Heath Maddox, San Francisco Municipal Transportation Agency  
 415-701-4789  
 heath.maddox@sfmta.com  
*Staff Contact:* Debra Dwyer  
 415-575-9031  
 debra.dwyer@sfgov.org

2015-0600

ENDORSED  
FILED  
SAN FRANCISCO County Clerk

DEC 22, 2015

by: FANNY WONG  
Deputy County Clerk

To: County Clerk, City and County of San Francisco  
City Hall Room 168  
1 Dr. Carlton B. Goodlett Place  
San Francisco, CA 94102

Pursuant to the California Environmental Quality Act (CEQA), the Guidelines of the Secretary for Resources, and San Francisco requirements, this Notice of Exemption is transmitted to you for filing. At the end of the posting period, please return this Notice to the Staff Contact with a notation of the period it was posted.

Attached fee: \$60 filing fee

### PROJECT DESCRIPTION:

The San Francisco Municipal Transportation Agency (SFMTA) proposes to implement a city-wide bicycle sharing system in San Francisco as part of the regional Bay Area Bicycle Share (BABS) system described in detail below. The current regional bicycle share system in San Francisco is a pilot project managed by the Bay Area Air Quality Management District (BAAQMD). The regional BABS system will transfer to the Metropolitan Transportation Commission (MTC) for program oversight at the end of 2015. As part of a BABS pilot project initiated on August 29, 2013, the system operator installed approximately 35 bicycle share stations with input from the SFMTA, comprising 350 bicycles within the public right-of-way, located generally in the northeast section of the City. The proposed project would maintain and upgrade the existing 35 pilot bicycle share stations, and expand the BABS system within San Francisco to comprise a total of approximately 450 stations and 4,500 bicycles across the City and County of San Francisco (San Francisco).

**DETERMINATION:**

The City and County of San Francisco decided to carry out or approve the project on December 18, 2015. The San Francisco Board of Supervisors (BOS) approved a coordination agreement with the Metropolitan Transportation Commission (MTC), other local partners in the East and South Bay, and the bicycle share operator to carry out the Bay Area Bicycle Share Program, which would be overseen in San Francisco by the San Francisco Municipal Transportation Agency (SFMTA) on December 8, 2015. The agreement was provided to Mayor Lee for his signature and becomes effective upon signing or when ten days have passed. A copy of documents related to this action may be examined at the San Francisco Board of Supervisors, City Hall, 1 Carlton B. Goodlett Place Room 244, San Francisco, CA, 94102 in File Number 151144.

- 1. An Exemption from Environmental Review has been prepared pursuant to the provisions of CEQA under:

- Ministerial (Sec. 21080(b)(1); 15268)
- Declared Emergency (Sec. 21080(b)(3); 15269(a))
- Emergency Project (Sec. 21080(b)(4); 15269(b)(c))
- Categorical Exemption, Class 3, Section 15303
- Statutory Exemption, State code number: \_\_\_\_\_
- Community Plan Exemption (Sec. 21083.3; 15183)

- 2. This project in its approved form has been determined to be exempt from environmental review because it would result in the installation of up to 450 bicycle sharing stations throughout San Francisco, primarily within the public right-of-way and on some parcels. The proposed individual stations are portable, modular, and would be solar and battery powered, and would thus not involve excavation or utility connections. The bicycle sharing station equipment is small in scale and massing relative to surrounding buildings or sites. Bicycle facilities and infrastructure are common sights within the urban environment. There would be no potential for significant environmental impacts at either a project or cumulative level. Therefore, the proposed project would be exempt from environmental review under Class 3.

John Rahaim  
Planning Director

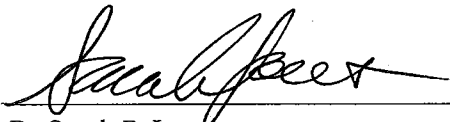
  
By Sarah B. Jones  
Environmental Review Officer

December 22, 2015  
Date

cc: Heath Maddox, SFMTA  
Interested parties