

SFMTA - TASC SUMMARY SHEET

<p>PreStaff_Date: 6/24/2021</p> <p>Requested_by: SFMTA</p> <p>Handled: Corbin Skerrit, 646-2450</p> <p>Section Head: BW </p>	<p><input type="checkbox"/> Public Hearing Consent</p> <p><input checked="" type="checkbox"/> Public Hearing Regular</p> <p><input type="checkbox"/> Informational / Other PH - Regular</p>	<p>No objections: _____</p> <p>Item Held: _____</p> <p>Other: _____</p>
<p>Location: Alemany Boulevard and Rousseau Street</p>		
<p>Subject: No U-Turns</p>		
<p>PROPOSAL / REQUEST: ESTABLISH - NO U-TURN Alemany Boulevard, southbound, at Rousseau Street</p> <p>(Supervisor Districts 8 and 11)</p> <p>Restricting southbound U-turns with proposed signal operation at new traffic signal.</p> <p>Corbin Skerrit, corbin.skerrit@sfmta.com</p>		
<p>BACKGROUND INFORMATION / COMMENTS</p> <p>New traffic signal already established as part of CT-65</p> <p>Alemany Blvd ADT = 22,000 veh Rousseau St ADT = 300 veh Collision Rate - 0.17</p> <p>Muni routes 44 O'Shaughnessy and 52 Excelsior travel through intersection.</p>		
<p>HEARING NOTIFICATION AND PROCESSING NOTES:</p>	<p>ENVIRONMENTAL CLEARANCE BY: <input checked="" type="checkbox"/> SFMTA <input type="checkbox"/> Attached <input type="checkbox"/> Pending</p>	

EXISTING CONDITIONS

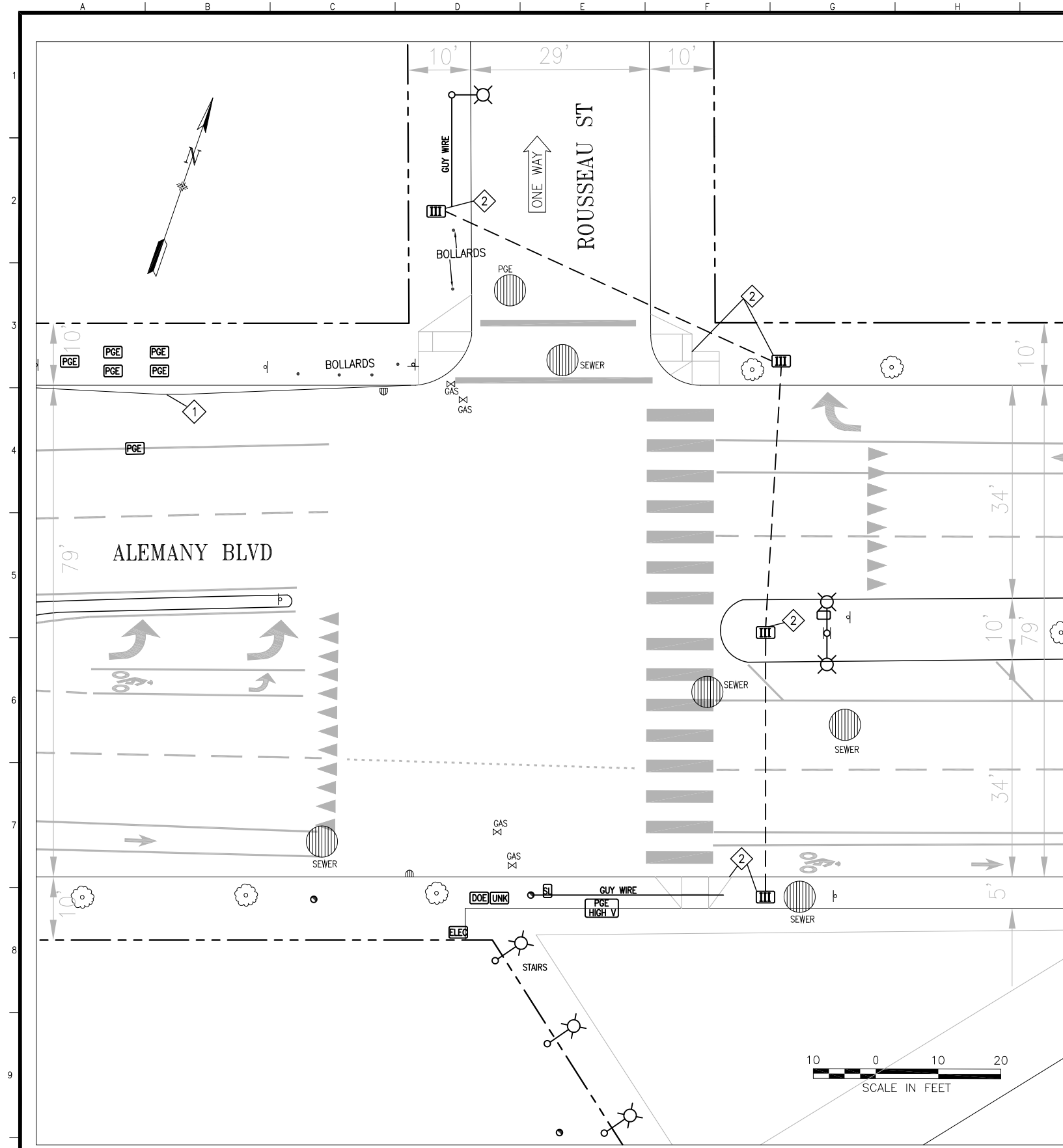

POLE No.	TYPE OF POLE	LUMINAIRE VOLTAGE/WATTAGE	VEHICLE SIGNAL					PEDESTRIAN SIGNAL			REMARKS
			No.	TYPE	MOUNTING	VISORS	LOUVERS	No.	TYPE	MOUNTING	
1											
2											
3											
4											
5											
6											
7											
8											
9											
10											
11											

SHEET NOTES:

- 1 SIDEWALK REPAVED 2017 - 11' AT WIDEST POINT
- 2 CURB RAMPS, PULL BOXES, & CONDUITS TO BE INSTALLED PER ALEMANY INFRASTRUCTURE PROJECT

PHASE DIAGRAM

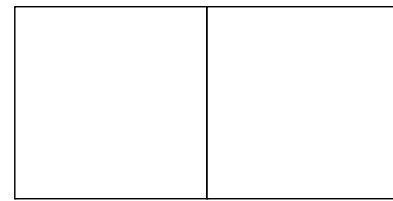

NO.	DATE	DESCRIPTION	BY	APP.
TABLE OF REVISIONS				
THIS DRAWING WAS LAST MODIFIED: 11/18/19 13:49, BY: CSkerrit				

REFERENCE INFORMATION & FILE NO. OF SURVEYS



DESIGN & ENGINEERING
 PUBLIC WORKS
 CITY & COUNTY OF SAN FRANCISCO
30 VAN NESS AVENUE, 5TH FLOOR
 SAN FRANCISCO, CA 94102 - 6028

Section Mgr:	Date:
Deputy Division Mgr:	DESIGNED: DATE: CS2/XX 4/2019
Division Mgr: PATRICK RIVERA	DRAWN: DATE: CS2/XX 4/2019
	CHECKED: DATE: GD/SL 4/2019

SCALE:	CONTRACT NO.
AS SHOWN	xxxxJ
SHEET OF SHEETS	DRAWING NO.
01 OF XX	E-3.0
	FILE NO.
	xxx.xxx
	REV. NO.
	X

CONTRACT 65
NEW TRAFFIC SIGNALS
ALEMANY BOULEVARD & ROUSSEAU STREET
BASEMAP

CONTRACT NO.	xxxxJ
DRAWING NO.	E-3.0
FILE NO.	xxx.xxx
REV. NO.	X

Drawing Path: T:_E_FILES\Special Projects & Street Use\Signal Projects\Active\CT 65 Base\Design\ACAD\Basesmaps\CT 65 Title Block.dwg
 Xrefs: T:_E_FILES\Special Projects & Street Use\Signal Projects\Active\CT 65 Base\Design\ACAD\Basesmaps\CT 65 Base\Design\ACAD\Basesmaps\CT 65 Title Block.dwg
 Model Units: Inches

POLE AND EQUIPMENT SCHEDULE																	
POLE No.	TYPE OF POLE	LUMINAIRE VOLTAGE/WATTAGE	VEHICLE SIGNAL				PEDESTRIAN SIGNAL			REMARKS							
			No.	TYPE	MOUNTING	VISORS	LOUVERS/BP	No.	TYPE		MOUNTING						
①	STEEL STREETLIGHT (28.5') WITH 6' LUMINAIRE ARM	C 72							88	1S-COUNT	SP-1	APS-2W					
②	STEEL STREETLIGHT (28.5') WITH 6' LUMINAIRE ARM	C 72	52	3S12"LA	SV-1-T	T			69	1S-COUNT	SP-1	APS-PPB					
③	1-A (10')		53	3S12"LA	TV-2-T-SFA	T			63	3S12"		APS-PPB					
④	17-2-100 w/ 20' MAST ARM AND 6' LUMINAIRE ARM	C 72	24	3S12"	MAC	T	HORIZONTAL LOUVERS ON GREEN (24) AND BP		21	3S12"							
⑤	1-A (10')								89	1S-COUNT	SP-1	APS-PPB					
⑥	1-A (10')		25	3S12"	TV-1-T	T											
⑦	19-3-100 w/ 30' MAST ARM AND 6' LUMINAIRE ARM	C 72	61	3S12"	SV-1-T	T		BP	67	3S12"	MAC	T	BP	68	1S-COUNT	SP-1	APS-2W
⑧	ORTHOGONAL CONCRETE STREETLIGHT WITH DUAL 6' LUMINAIRE ARMS	C 73															

SHEET NOTES:

① REFER TO PG&E CONSTRUCTION SKETCH PRIOR TO INSTALLATION. CITY SERVICE BOX SHALL BE WITHIN 5 FEET FROM PG&E SERVICE. PG&E SERVICE ESTIMATED 200 FEET FROM CONTROLLER TO CITY SERVICE BOX.

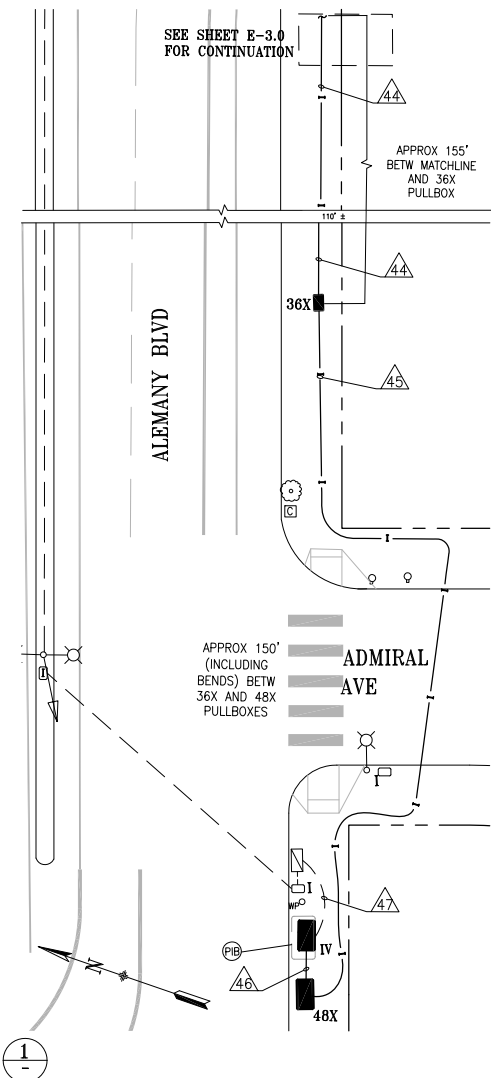

INTERCONNECT WIRING DETAIL
NOT TO SCALE

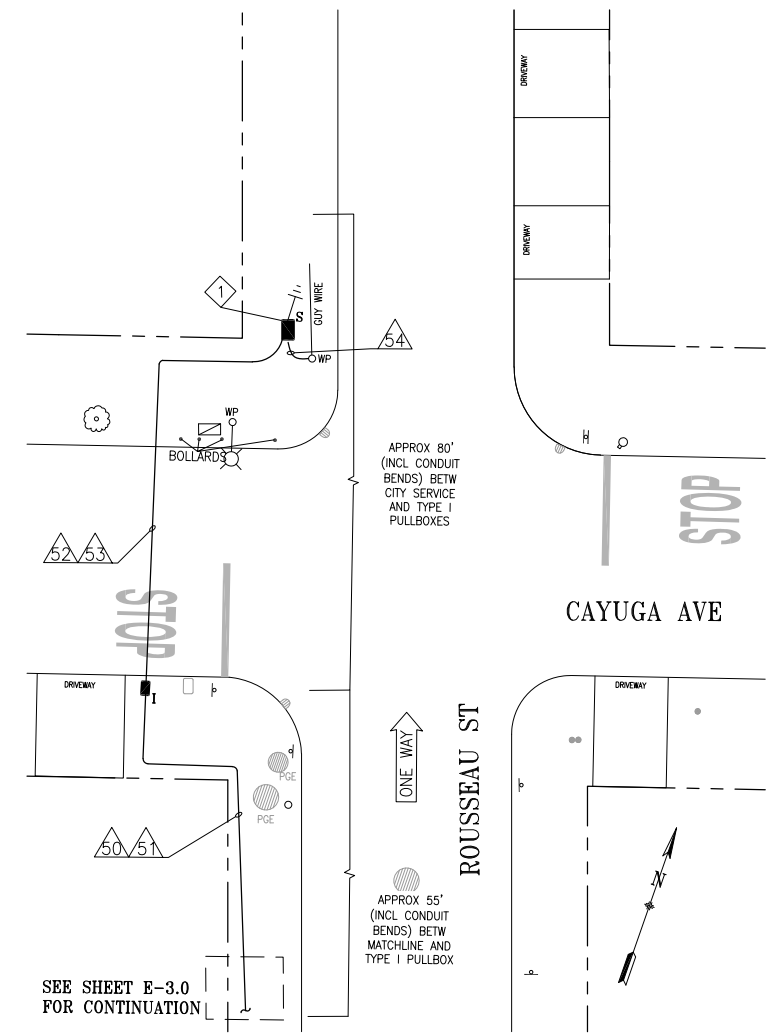

SERVICE POINT WIRING DETAIL
NOT TO SCALE

NO.	DATE	DESCRIPTION	BY	APP.
TABLE OF REVISIONS				
THIS DRAWING WAS LAST MODIFIED: 05/25/21 16:49, BY: CSkerrit				

REFERENCE INFORMATION & FILE NO. OF SURVEYS



DESIGN & ENGINEERING
PUBLIC WORKS
CITY & COUNTY OF SAN FRANCISCO
30 VAN NESS AVENUE, 5TH FLOOR
SAN FRANCISCO, CA 94102 - 6028

Section Mgr:	Date:
Deputy Division Mgr:	
Division Mgr: PATRICK RIVERA	

DESIGNED: CS2/XX	DATE: XX/XXXX
DRAWN: CS2/XX	DATE: XX/XXXX
CHECKED: 60/XX	DATE: XX/XXXX

SCALE:
AS SHOWN
SHEET OF SHEETS
01 OF XX

CONTRACT NO. 11841
DRAWING NO. E-3.1
FILE NO. XXX.XXX
REV. NO. X

CONTRACT 65
NEW TRAFFIC SIGNALS
ALEMANY BOULEVARD & ROUSSEAU STREET
75% DESIGN

Drawing Path: T:\E-FILES\Special Projects & Street Use\Signal Projects\Active\CT 65\1 DESIGN\ACAD\CT 65 Title Block.dwg
 Xrefs: T:\E-FILES\Special Projects & Street Use\Signal Projects\Active\CT 65\1 DESIGN\ACAD\CT 65 Title Block.dwg
 Design Scale: 1/8"=1'-0"
 Model Units: Undefined
 Units: English
 Plot Time: Tue, 25 May 2021 - 4:51pm

**City and County of San Francisco
San Francisco Municipal Transportation Agency**

COLLISIONS

From 1/1/2013 to 12/31/2017

**Total Collisions: 7
Injury Collisions: 6
Fatal Collisions: 0**

Collision Summary Report

3/25/19

ALEMANY BLVD & ROUSSEAU ST

Page 1 of 2

130631589	7/31/2013	17:19	Wednesday	ALEMANY BLVD & ROUSSEAU ST	0'	Direction: Not State	Daylight	Clear	Pty at Fault:1
	Vehicle - Pedestrian		Pedestrian	Ped R/W Violation	21950A	Hit & Run: No	Complaint of Pain	# Inj: 1	# Killed: 0
Party 1	Driver		West	Proceeding Straight	Female	Age: 36			
	Veh Type: Passenger Car		Sobriety: HNBD	Assoc Factor: None Apparent	Lap/Shoulder Harness Used		Cell Phone Not In Use		SBT veh struck WB ped. Adjacent veh was stopped and yielding
Party 2	Pedestrian		North	Not Stated	Female	Age: 61			
	Veh Type: Pedestrian		Sobriety: Not Stated	Assoc Factor: Not Stated	Not Required		Not Stated		
130925439	10/31/2013	17:56	Thursday	ALEMANY BLVD & ROUSSEAU ST	0'	Direction: Not State	Daylight	Clear	Pty at Fault:1
	Rear-End		Other Motor Vehicle	Unsafe Speed	22350	Hit & Run: Felony	Property Damage Only	# Inj: 0	# Killed: 0
Party 1	Driver		South	Proceeding Straight	Not State	Age:			SBT departure rear-end. Driven by stolen vehicle
	Veh Type: 8		Sobriety: Impairment Not Kno	Assoc Factor: Violation			Cell Phone Not In Use		
Party 2	Driver		South	Slowing/Stopping	Female	Age: 23			
	Veh Type: 1		Sobriety: HNBD	Assoc Factor: None Apparent	Lap/Shoulder Harness Used		Cell Phone Not In Use		
140533919	6/27/2014	20:56	Friday	ALEMANY BLVD & ROUSSEAU ST	0'	Direction: Not State	Dark - Street Light	Clear	Pty at Fault:1
	Sideswipe		Other Motor Vehicle	Unsafe Speed	22350	Hit & Run: No	Complaint of Pain	# Inj: 2	# Killed: 0
Party 1	Driver		South	Proceeding Straight	Male	Age: 35			SBT veh swerved to avoid a SBT rear-end and sideswiped instead
	Veh Type: Motorcycle		Sobriety: HNBD	Assoc Factor: Violation	None In Vehicle		Cell Phone Handsfree In Use		
Party 2	Driver		South	Proceeding Straight	Male	Age: 49			
	Veh Type: Motorcycle		Sobriety: HNBD	Assoc Factor: Violation	None In Vehicle		Cell Phone Handsfree In Use		
Party 3	Driver		South	Making Right Turn	Not State	Age:			
	Veh Type: Unknown Hit and Run		Sobriety: Not Stated	Assoc Factor: Not Stated			Cell Phone Handsfree In Use		
150165449	2/23/2015	08:37	Monday	ALEMANY BLVD & ROUSSEAU ST	0'	Direction: Not State	Daylight	Clear	Pty at Fault:1
	Broadside		Other Motor Vehicle	Auto R/W Violation	21801A	Hit & Run: No	Complaint of Pain	# Inj: 1	# Killed: 0
Party 1	Driver		North	Making Left Turn	Male	Age: 22			Permissive NBL turned in front of SBT.
	Veh Type: Motorcycle		Sobriety: HNBD	Assoc Factor: None Apparent	None In Vehicle		Cell Phone Not In Use		
Party 2	Driver		South	Proceeding Straight	Male	Age: 61			
	Veh Type: Passenger Car		Sobriety: HNBD	Assoc Factor: None Apparent	Lap/Shoulder Harness Used		Cell Phone Not In Use		

ALEMANY BLVD & ROUSSEAU ST

160577191	7/17/2016	17:42	Sunday	ALEMANY BLVD & ROUSSEAU ST	0'	Direction: Not State	Daylight	Cloudy	Pty at Fault:1
	Broadside		Other Motor Vehicle	Auto R/W Violation	21801A	Hit & Run: No	Severe Injury	# Inj: 2	# Killed: 0
Party 1	Driver		West	Making Left Turn	Male	Age: 80			Permissive NBL turned in front of SBT.
	Veh Type: Passenger Car		Sobriety: HNBD	Assoc Factor: None Apparent	Lap/Shoulder Harness Used		Not Stated		
Party 2	Driver		South	Proceeding Straight	Male	Age: 21			
	Veh Type: Passenger Car		Sobriety: HNBD	Assoc Factor: None Apparent	Lap/Shoulder Harness Used		Not Stated		
160929796	11/15/2016	09:25	Tuesday	ALEMANY BLVD & ROUSSEAU ST	0'	Direction: Not State	Daylight	Cloudy	Pty at Fault:0
	Rear-End		Other Motor Vehicle	Unsafe Speed	22350	Hit & Run: Felony	Complaint of Pain	# Inj: 1	# Killed: 0
Party 1	Driver		East	Proceeding Straight	Not State	Age:			
	Veh Type: Pickup Truck		Sobriety: Impairment Not Kno	Assoc Factor: Violation	Unknown		Not Stated		
Party 2	Driver		East	Stopped In Road	Female	Age: 57			
	Veh Type: Passenger Car		Sobriety: HNBD	Assoc Factor: Violation	Lap Belt Used		Cell Phone Not In Use		
Party 3	Driver		East	Proceeding Straight	Female	Age: 47			
	Veh Type: Passenger Car		Sobriety: HNBD	Assoc Factor: Not Stated	Lap Belt Used		Cell Phone Not In Use		
170809031	10/4/2017	10:04	Wednesday	ALEMANY BLVD & ROUSSEAU ST	42'	Direction: North	Daylight	Clear	Pty at Fault:
	Rear-End		Motor Vehicle on Othe	Not Stated	Unknown	Hit & Run: No	Complaint of Pain	# Inj: 2	# Killed: 0
Party 1	Driver		South	Changing Lanes	Male	Age: 65			SBR veh made last min lane change and rear-ended another SBR veh
	Veh Type: Passenger Car		Sobriety: HNBD	Assoc Factor: None Apparent	Lap/Shoulder Harness Used		Not Stated		
Party 2	Driver		South	Proceeding Straight	Female	Age: 57			
	Veh Type: Passenger Car		Sobriety: HNBD	Assoc Factor: None Apparent	Lap/Shoulder Harness Used		Cell Phone Not In Use		

Settings for Query:

Street: ALEMANY BLVD
Cross Street: ROUSSEAU ST
Intersection Related: True
Sorted By: Date and Time

Collision Diagram

Horizontal Street: ALEMANY BLVD

From: 1/1/2013 To: 12/31/2017

Vertical Street: ROUSSEAU ST

Date Prepared: 3/25/2019

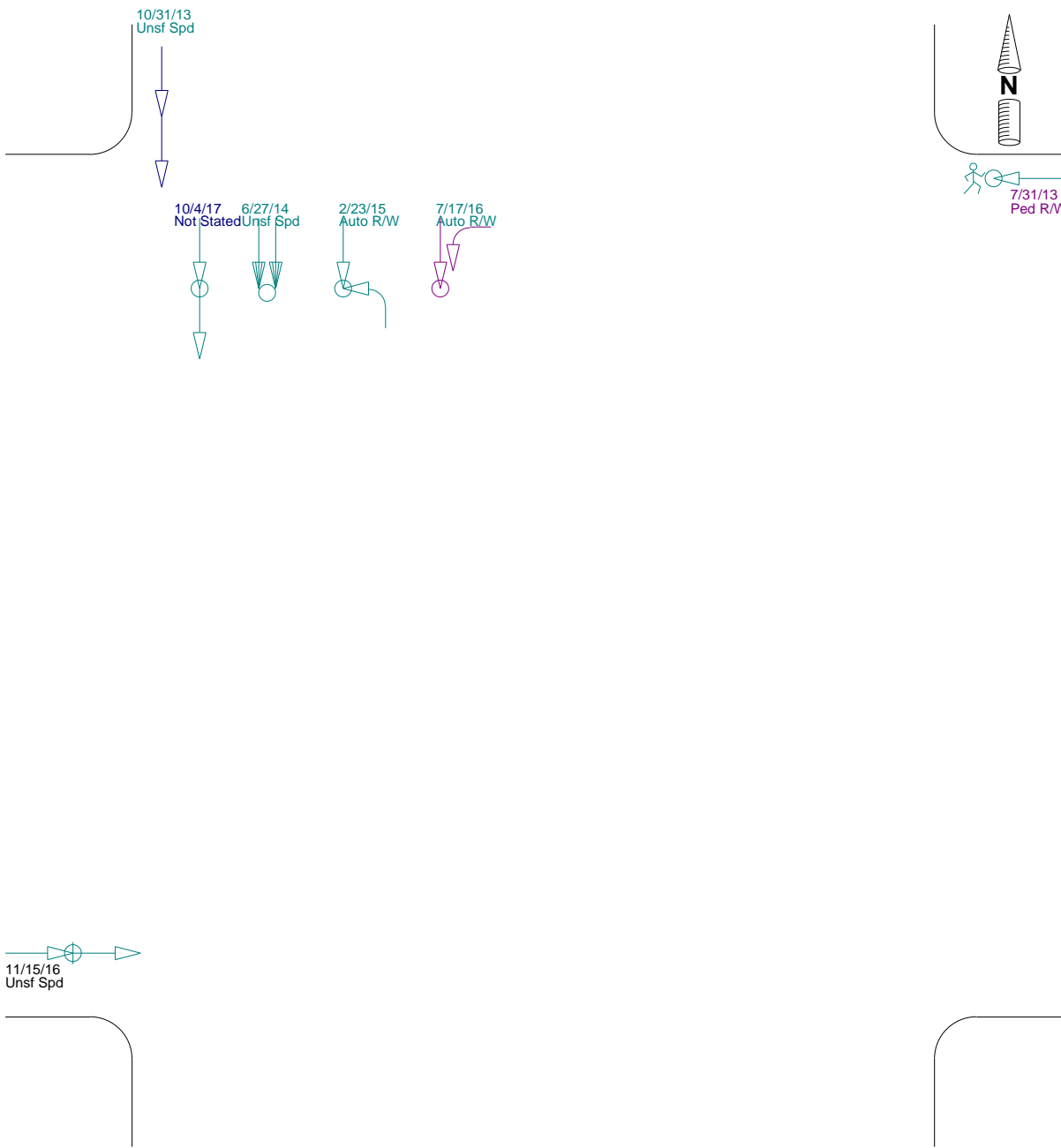

Number of Collisions

- 1 Property Damage Only
- 6 Injury Collisions
- 0 Fatal Collisions
- 7 Total Collisions

Legend

- ← Moving Vehicle
- ←| Stopped Vehicle
- ←→ Backing Vehicle
- ←~ Ran Off Road
- ←..... Movement Unknown

- ↘ Right Turn
- ↙ Left Turn
- ←← Sideswipe
- △ Day
- ◑ Night

- 🚶 Pedestrian
- 📦 Fixed Object
- 🚲 Bicycle
- 🍷 DUI
- Injury
- ⊙ Fatal

Color Legend - Highest Degree of Injury

Maroon = Fatal

Purple = Severe Injury

Green = Other Visible Injury

Teal = Complaint of Pain

Dark Blue = Property Damage Only

Alemany and Rousseau	DESCRIPTION: Activate new signal.					
CHANGE: 0	NOTES:				Page 1 of 2	
CNN #: XXXX	PHASE	STREET	EmerFlash	ProgFlash	Controller:	2070
ENGINEER: C.Skerrit	2	Alemany NB	R	--	Cabinet:	XXXX
Revision date: XXXX	5	Alemany NBLT	OFF	--	Oper. Date:	XXXX
Programmed by:	6	Alemany SB	R	--	System:	Alemany
Installed by:					Master:	TBC-GPS
Date Completed:						

Alemany and Rousseau

Actuation
 Transit Priority
 Preemption

Steady Demand Sequence

X = YES	-- = NO	S	M	T	W	T	F	S	CYCLE	SPLIT	OFFSET	FLASH
7:00 TO 9:00	16:00 TO 19:00	--	X	X	X	X	X	--	2	1	2	--
ALL OTHER TIMES		X	X	X	X	X	X	X	1	1	1	--

STREET	PHASE	1	2	3	4	5	6	7	8	9	10	11	12	13	14	15
Alemany NB	2	R	G	Y				R								
Alemany NBLT	5			R			G	Y	R							
Alemany SB	6	R	G	Y				R								
Peds Xing Rousseau WS	6P			FRH				RH								
Peds Xing Alemany NS	8P				RH			FRH	RH							

ws3.0

CSO	CYCLE (seconds)	OFFSET (seconds)	SIGNAL INTERVALS (seconds)														
			1	2	3	4	5	6	7	8	9	10	11	12	13	14	15
111	70.0	68	4.0	19.5	6.0	4.5	1.0	7.5	22.0	4.5	1.0						
212	80.0	62	4.0	29.5	6.0	4.5	1.0	7.5	22.0	4.5	1.0						
313	80.0	14	4.0	29.5	6.0	4.5	1.0	7.5	22.0	4.5	1.0						

CHANGE 0

PAGE 2: BASE TIMING, ACTUATION, COORDINATION SETTINGS

Alemanly and Rousseau

Change

0

Alemanly and Rousseau

PHASE DIAGRAM

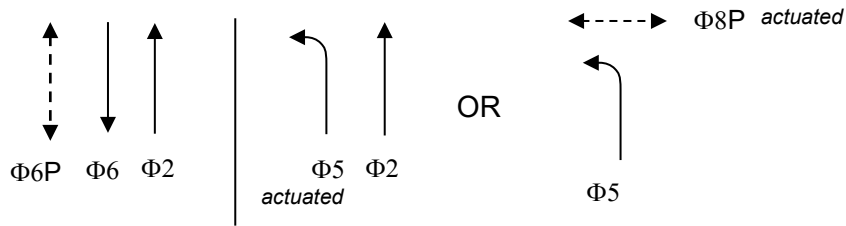

Alemanly

Alemanly

Are there conflicting protected left turn phases?

No

BASE TIMINGS:

Phase	1	2	3	4	5	6	7	8P
Movement		NB			NBLT	SB		--
Absolute Min Green (whole #)		26			29	26		--
Early Walk		--			--	4		--
Yellow		4.5			4.5	4.5		--
Red Clearance		1.0			1.0	1.0		1.0
Absolute Min Walk (whole #)		--			--	7		7
FRH (whole #)		--			--	6		22

ACTUATION: ** if Actuation setting vary by plan, use special comments.

Phase	1	2	3	4	5	6	7	8P
Vehicle Detection Type		NONE			Video	NONE		--
Ped Detection Type		--			--	NONE		PPB
Vehicle Recall (Max, Min, Soft or None)		MAX			NONE	MAX		--
Absolute Min Green (same as above)		26			29	26		--
Vehicle Extension (seconds)		--			--	--		--
Max Green (only used for FREE)		61			29	26		--
Pedestrian Recall (Yes or No)		--			--	YES		NO
Ped Recycle (Yes or No)		--			--	YES		NO
"WALK EXPAND" (Yes or No)		--			--	YES		YES

COORDINATION (phase splits = Max G + Y + R Clearance)

Phase	1-4 Cycle length	1	2	3	4	5	6	7	8P	Offset (from page 1)
	Dial 1 Splits	70		35			35	35		
Min Transition	70		35			35	35		35	
Max Transition	83		48			35	35		35	
Dial 2 Splits	80		45			35	35		35	62
Min Transition	70		35			35	35		35	
Max Transition	93		58			35	35		35	
Dial 3 Splits	80		45			35	35		35	14
Min Transition	70		35			35	35		35	
Max Transition	93		58			35	35		35	
Coordinated Phases			X				X			

Special Comments

startup all-red = 6 seconds