

New Transit Lanes
on southbound Mission from
11th St to 13th St

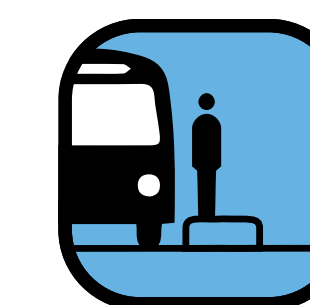

New Pedestrian Islands
at Mission and South Van Ness Ave



New Transit Island
on southbound Mission at South Van Ness Ave

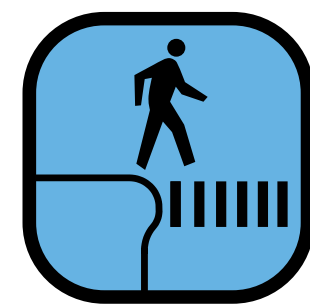

New Pedestrian Bulbs
at Mission and South Van Ness Ave

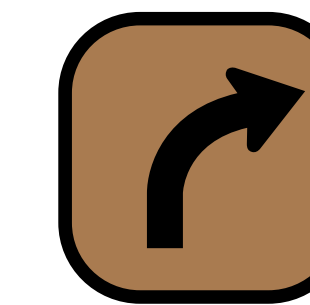

New Right Turn Pocket
on westbound Mission at South Van Ness Ave



New Bike Lane
on westbound Mission at South Van Ness Ave

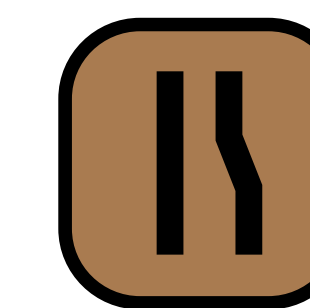

Remove Left Turn Lane
on westbound Mission at South Van Ness Ave

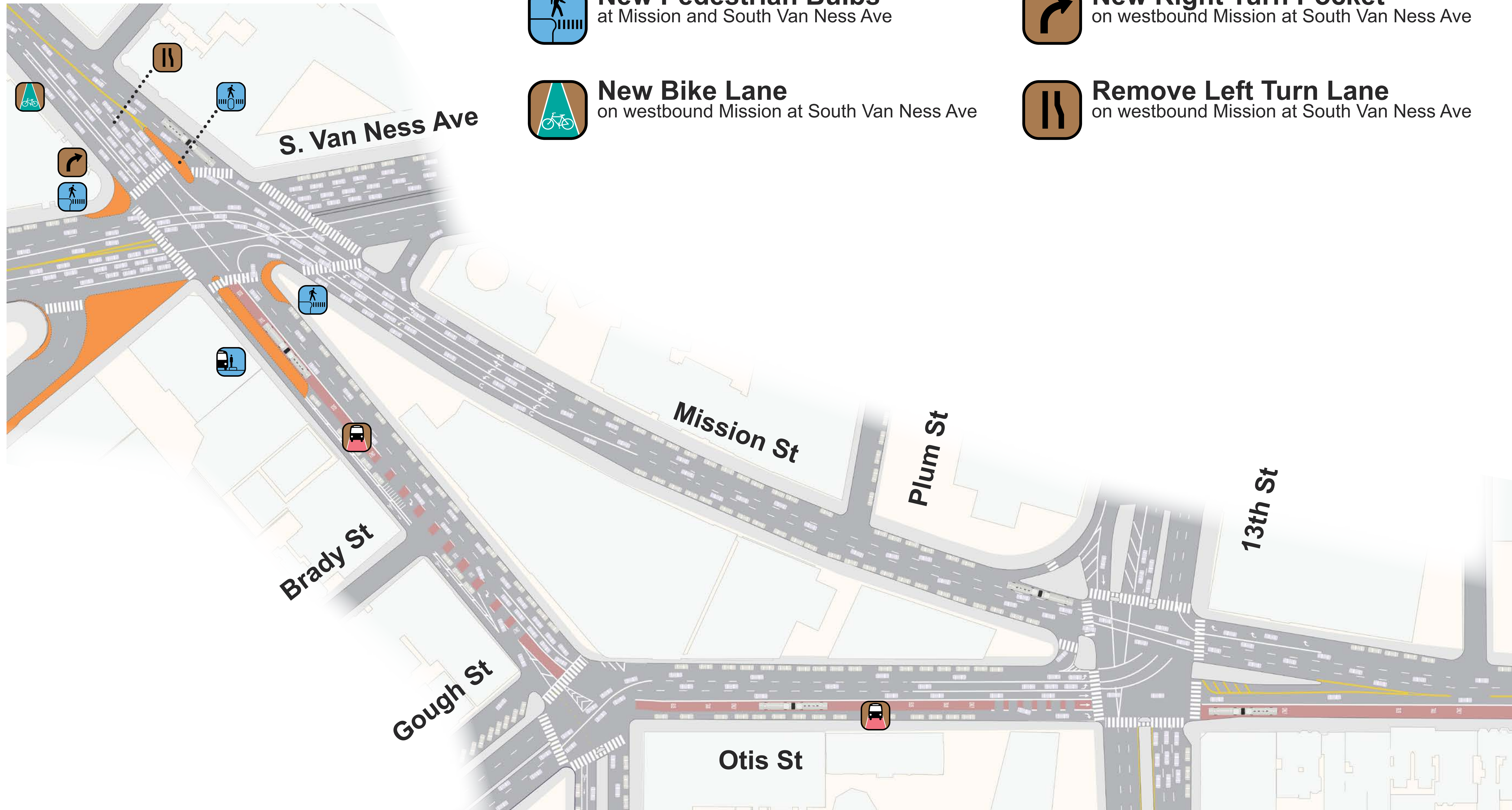

← North to Downtown

→ South to Daly City

Proposal Detail: 14th to 15th

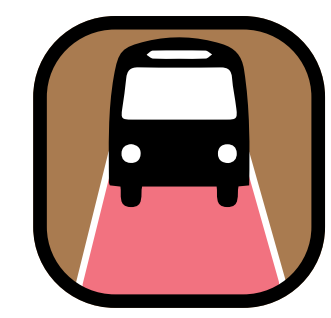

New Transit Lanes

ALTERNATIVE A
on southbound Mission from
13th St to César Chávez St

ALTERNATIVE B
on both sides of Mission from
13th St to César Chávez St

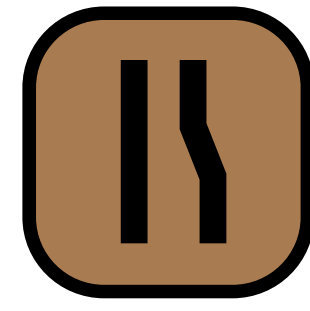

ALTERNATIVE A ONLY
Reconfigure Lanes
from 13th St to César Chávez St



ALTERNATIVE B ONLY
No Parking Anytime
on southbound Mission from 13th St
to 16th St



ALTERNATIVE A ONLY
Right Turn Only
at northbound Mission and 14th St



BOTH ALTERNATIVES
No Left Turn
from Mission onto 14th St and
from southbound Mission onto 15th St

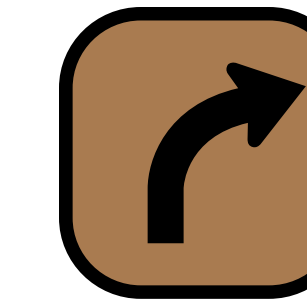

New Right Turn Pockets
on northbound Mission at 14th St and
on southbound Mission at 15th St



Remove Stops
at 15th St

ALTERNATIVE A

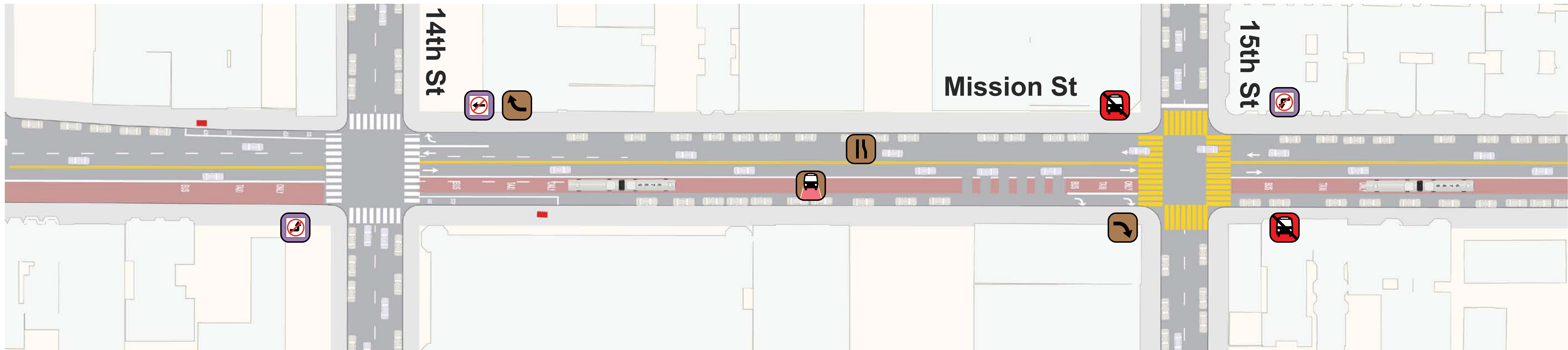

ALTERNATIVE B

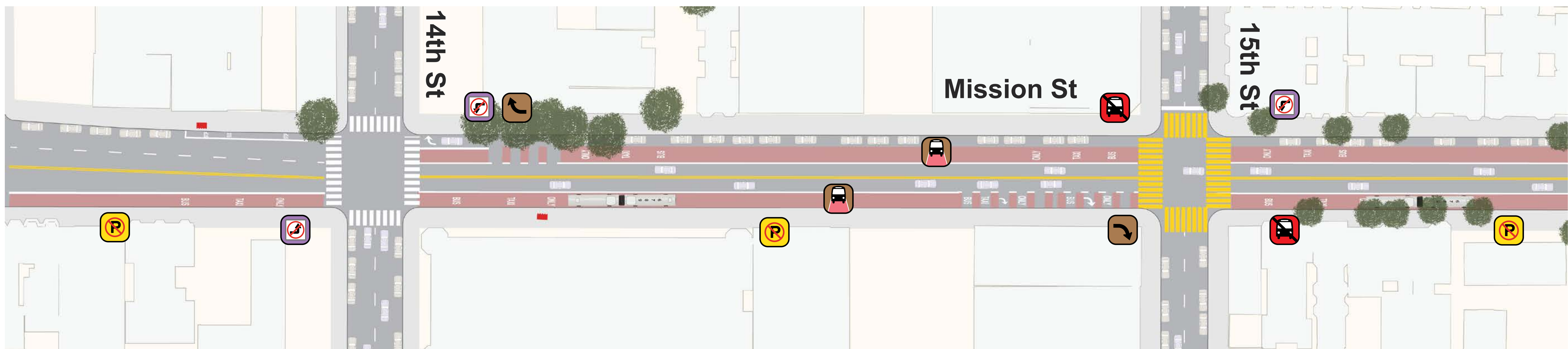

← North to Downtown

→ South to Daly City

Proposal Detail: 16th to 17th

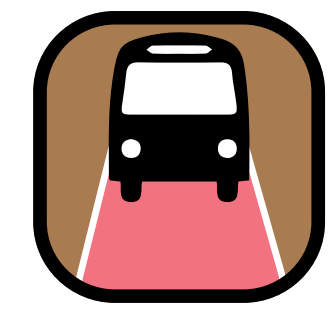

New Transit Lanes

ALTERNATIVE A
on southbound Mission from
13th St to César Chávez St

ALTERNATIVE B
on both sides of Mission from
13th St to César Chávez St

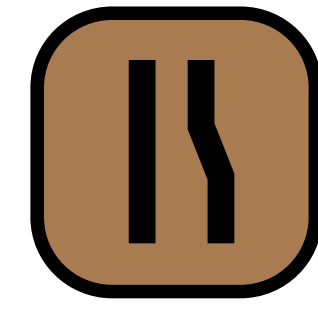

ALTERNATIVE A ONLY
Reconfigure Lanes
from 13th St to César Chávez St



ALTERNATIVE B ONLY
No Parking Anytime
on southbound Mission from 13th
St to 16th St and on northbound
Mission from 16th St to 18th St



ALTERNATIVE A ONLY
Right Turn Only
at northbound Mission and 16th St
and at northbound Mission and 17th St



BOTH ALTERNATIVES
No Left Turn
from Mission onto 17th St and
from northbound Mission onto 16th St

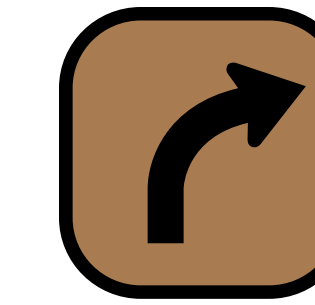

New Right Turn Pockets
on Mission at 16th St and at 17th St

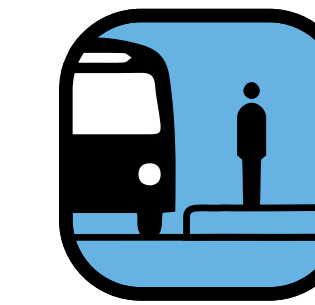

New Transit Bulb
on northbound Mission at 16th St

ALTERNATIVE A

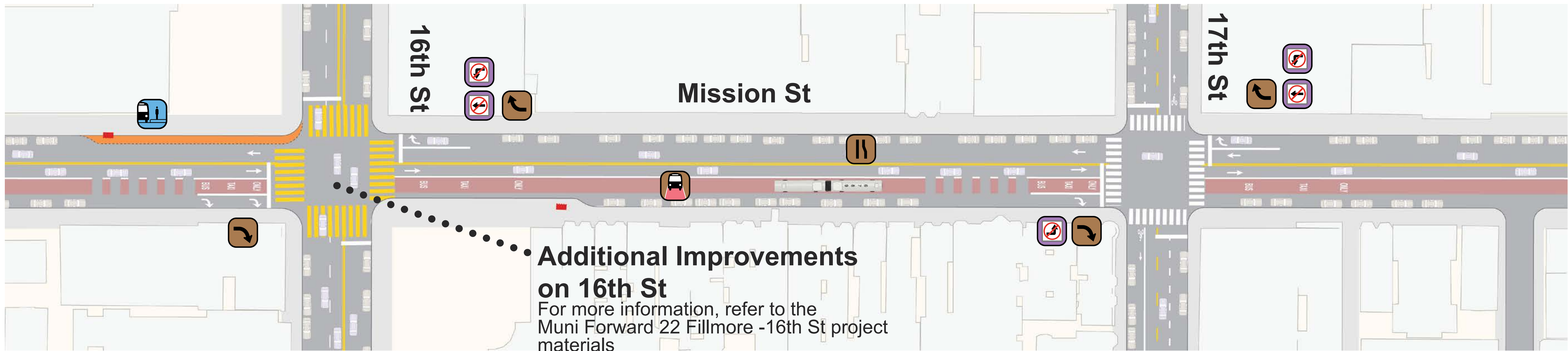

ALTERNATIVE B

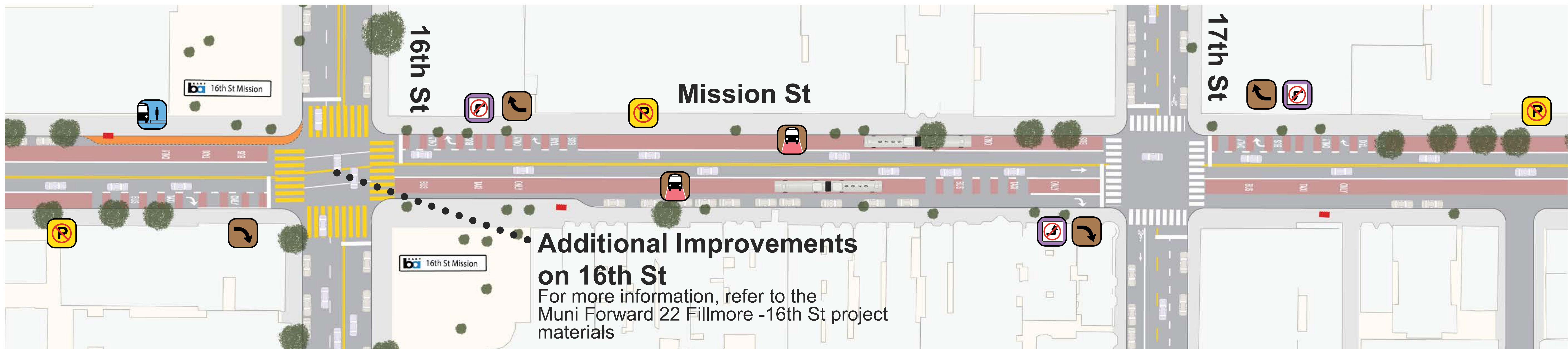

← North to Downtown

→ South to Daly City

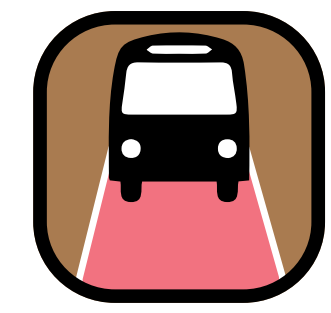

New Transit Lanes

ALTERNATIVE A
on southbound Mission from
13th St to César Chávez St

ALTERNATIVE B
on both sides of Mission from
13th St to César Chávez St

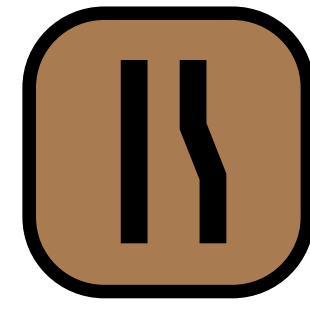

ALTERNATIVE A ONLY
Reconfigure Lanes
from 13th St to César Chávez St



ALTERNATIVE B ONLY
No Parking Anytime
on northbound Mission from 16th
St to 18th St and on southbound
Mission from 18th St to 20th St



ALTERNATIVE A ONLY
Right Turn Only
at northbound Mission and 19th St



BOTH ALTERNATIVES
No Left Turn
from Mission onto 18th St and
from Mission onto 19th St

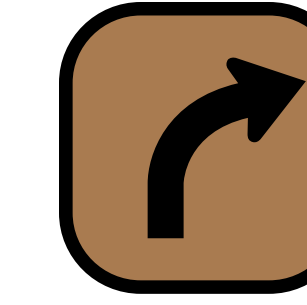

New Right Turn Pockets
on southbound Mission at 18th St and
on Mission at 19th St



Remove Stops
at 19th St



No Left Turn
from southbound Mission onto 18th
St and from southbound Mission onto
19th St

ALTERNATIVE A

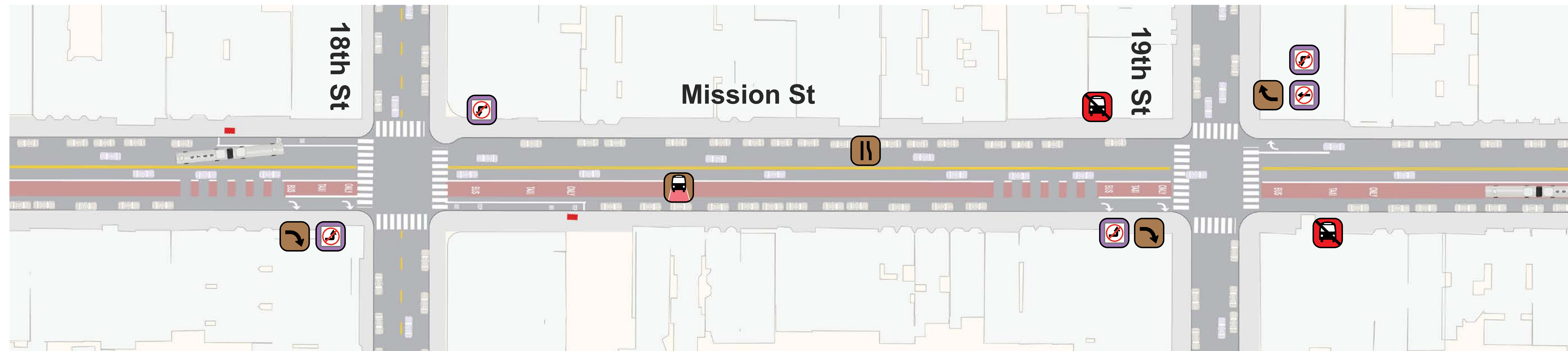

ALTERNATIVE B

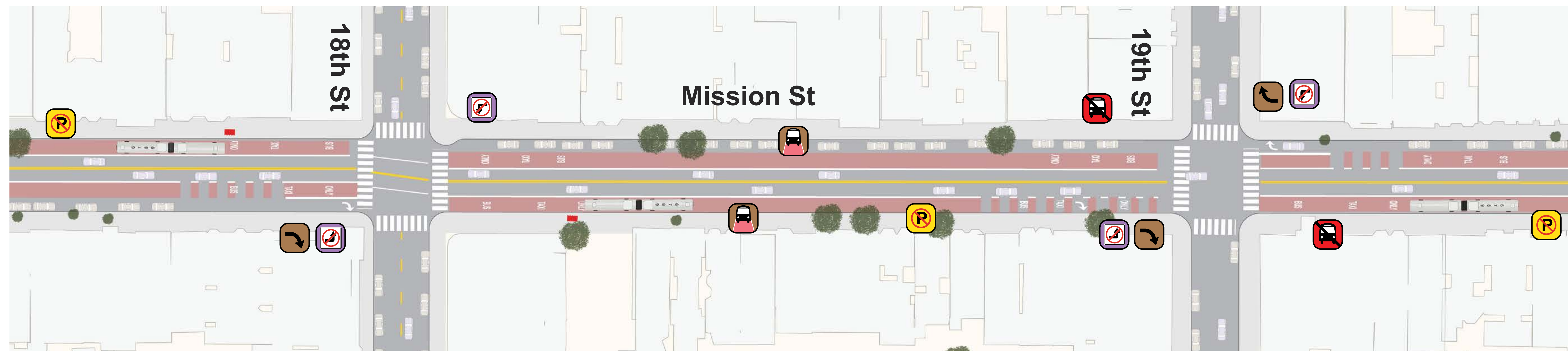

← North to Downtown

→ South to Daly City

Proposal Detail: 20th to 21st

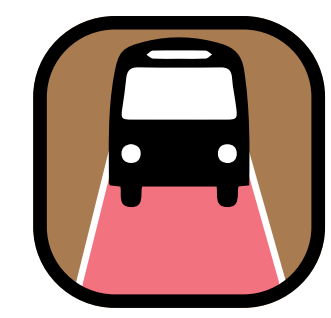

New Transit Lanes

ALTERNATIVE A
on southbound Mission from
13th St to César Chávez St

ALTERNATIVE B
on both sides of Mission from
13th St to César Chávez St

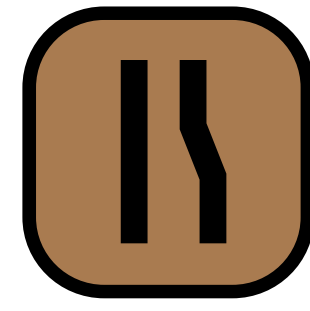

ALTERNATIVE A ONLY
Reconfigure Lanes
from 13th St to César Chávez St



ALTERNATIVE B ONLY
No Parking Anytime
on southbound Mission from 18th
St to 20th St and on northbound
Mission from 20th St to 23rd St



ALTERNATIVE A ONLY
Right Turn Only
at northbound Mission and 20th St and at
at northbound Mission and 21st St



BOTH ALTERNATIVES
No Left Turn
from Mission onto 20th St and
from Mission onto 21st St

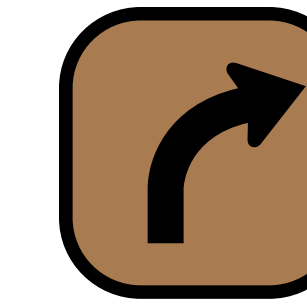

New Right Turn Pockets
on Mission at 20th St and at 21st St



Remove Stops
at 21st St

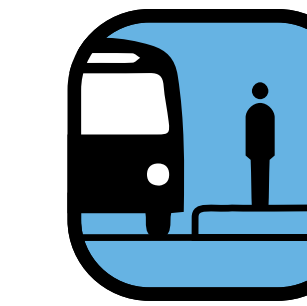

New Transit Bulbs
at 20th St

ALTERNATIVE A

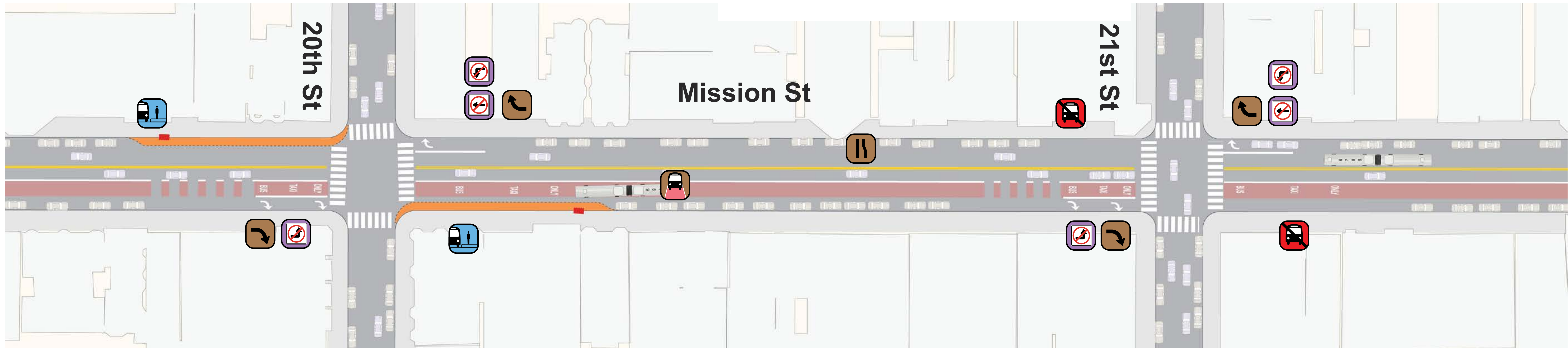

ALTERNATIVE B



← North to Downtown

→ South to Daly City