

\\mntanas\redirect\frables\Desktop\TEMP\DOCS AUGUST 8 WHILE T DRIVE GETS MORE SPACE\Palou - EXISTING.dwg frables Thu Aug 11, 2016 - 9:59 am
 \\mntanas\redirect\frables\Desktop\TEMP\DOCS AUGUST 8 WHILE T DRIVE GETS MORE SPACE\Palou - EXISTING.dwg frables Thu Aug 11, 2016 - 9:59 am
 \\mntanas\redirect\frables\Desktop\TEMP\DOCS AUGUST 8 WHILE T DRIVE GETS MORE SPACE\Palou - EXISTING.dwg frables Thu Aug 11, 2016 - 9:59 am

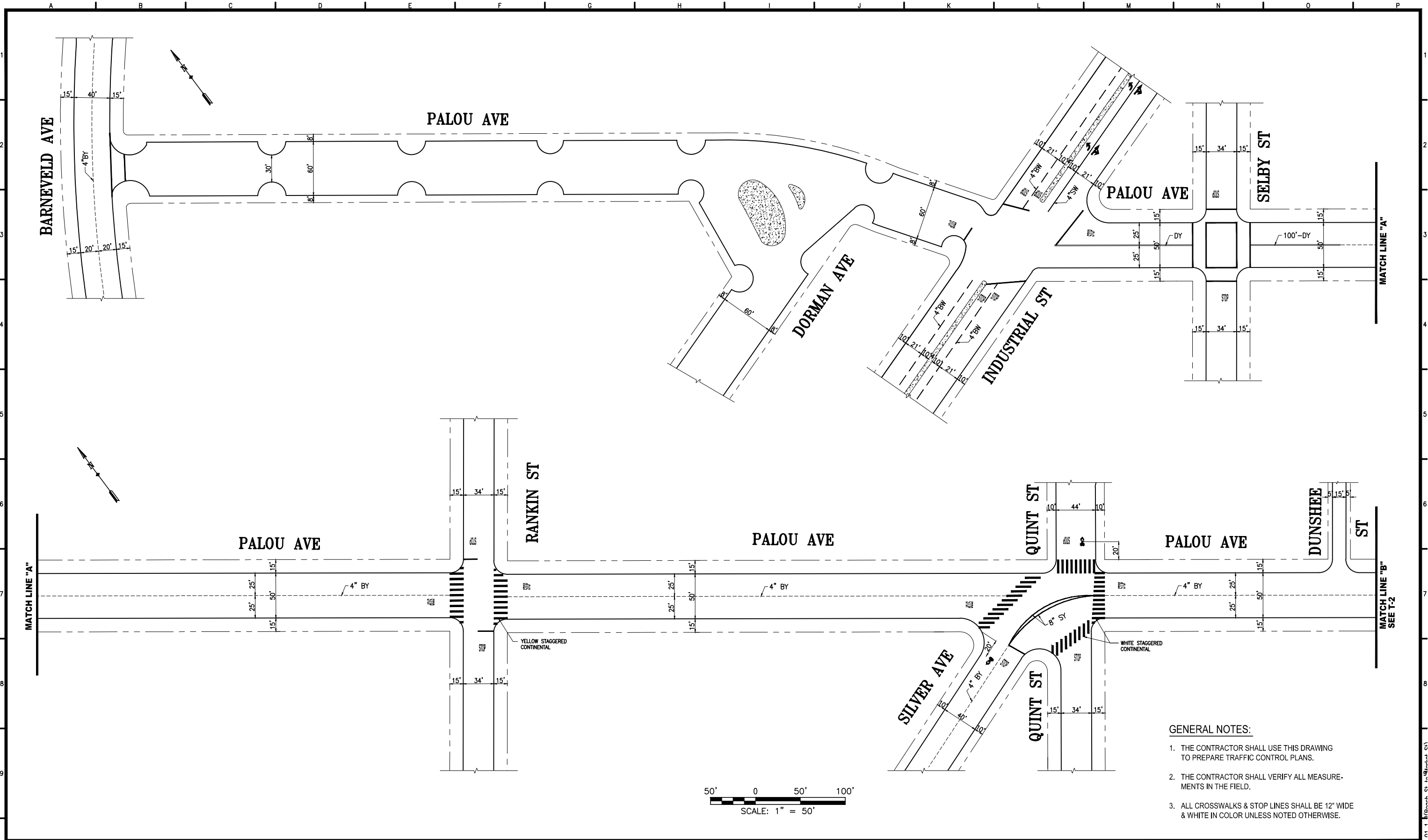

- GENERAL NOTES:**
1. THE CONTRACTOR SHALL USE THIS DRAWING TO PREPARE TRAFFIC CONTROL PLANS.
 2. THE CONTRACTOR SHALL VERIFY ALL MEASUREMENTS IN THE FIELD.
 3. ALL CROSSWALKS & STOP LINES SHALL BE 12" WIDE & WHITE IN COLOR UNLESS NOTED OTHERWISE.

NO.	DATE	DESCRIPTION	BY	APP.
TABLE OF REVISIONS				
CHECK WITH TRACING TO SEE IF YOU HAVE LATEST REVISION				



SAN FRANCISCO MUNICIPAL TRANSPORTATION AGENCY
 CITY AND COUNTY OF SAN FRANCISCO

DRAWN:	DATE:	4/2016
CHECKED:	DATE:	4/2016

APPROVED	
SENIOR ENGINEER	DATE:
CITY TRAFFIC ENGINEER	DATE:

SCALE:
 1" = 50'
 SHEET OF SHEETS
 1 OF 3

PALOU AVENUE COMPLETE STREET IMPROVEMENTS PROJECT
EXISTING TRAFFIC STRIPING
PALOU AVE, BARNEVELD AVE TO DUNSHEE ST

CONTRACT NO.	2291J
DRAWING NO.	T-1
FILE NO.	
REV. NO.	0

Date: 04/27/2016 11:46:00 AM

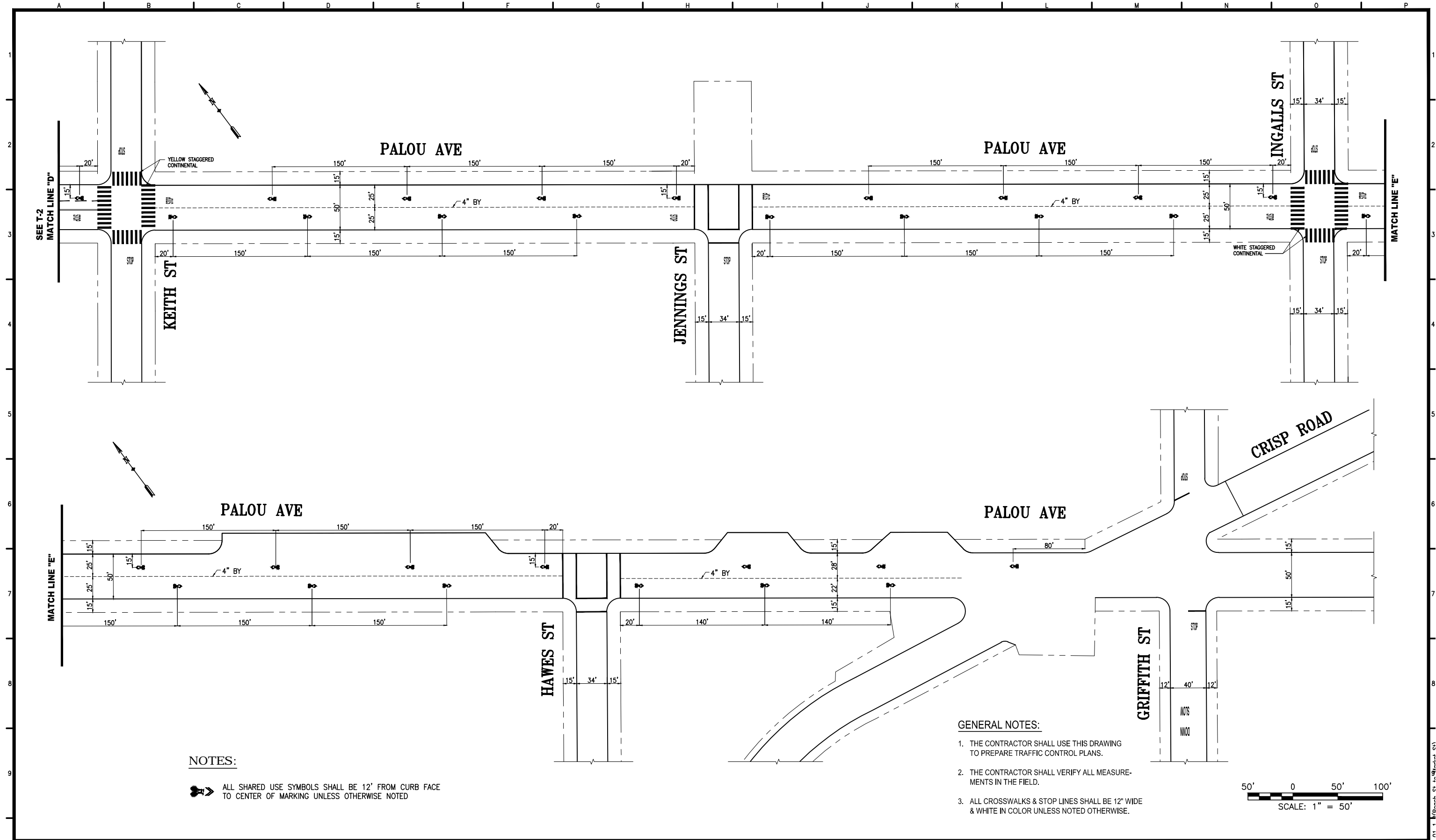

NOTES:

ALL SHARED USE SYMBOLS SHALL BE 12" FROM CURB FACE TO CENTER OF MARKING UNLESS OTHERWISE NOTED

GENERAL NOTES:

1. THE CONTRACTOR SHALL USE THIS DRAWING TO PREPARE TRAFFIC CONTROL PLANS.
2. THE CONTRACTOR SHALL VERIFY ALL MEASUREMENTS IN THE FIELD.
3. ALL CROSSWALKS & STOP LINES SHALL BE 12" WIDE & WHITE IN COLOR UNLESS NOTED OTHERWISE.

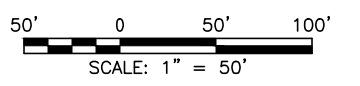

NO.	DATE	DESCRIPTION	BY	APP.
TABLE OF REVISIONS				
CHECK WITH TRACING TO SEE IF YOU HAVE LATEST REVISION				



SAN FRANCISCO MUNICIPAL TRANSPORTATION AGENCY
CITY AND COUNTY OF SAN FRANCISCO

DRAWN:	DATE:
P. YUEN	4/2016
CHECKED:	DATE:
J. KUNG	4/2016

APPROVED	
SENIOR ENGINEER	DATE:
CITY TRAFFIC ENGINEER	DATE:

SCALE:
1" = 50'
SHEET OF SHEETS
3 OF 3

PALOU AVENUE COMPLETE STREET IMPROVEMENTS PROJECT
EXISTING TRAFFIC STRIPING
PALOU AVE, KEITH ST TO GRIFFITH ST

CONTRACT NO.	2291J
DRAWING NO.	T-3
FILE NO.	
REV. NO.	0

DATE: 04/20/2016 11:49 AM