

SFMTA - TASC SUMMARY SHEET

<p>PreStaff_Date: 10-Jun-21</p> <p>Requested_by: SFMTA</p> <p>Handled: Mark Dreger</p> <p>Section Head : M. Sallaberry <i>MS</i></p>	<p><input type="checkbox"/> Public Hearing Consent</p> <p><input checked="" type="checkbox"/> Public Hearing Regular</p> <p><input type="checkbox"/> Informational / Other PH - Consent</p>	<p>Approved: _____</p> <p>Disapproved: _____</p> <p>Item Held: _____</p>
<p>Location: Various locations on Mission Street</p>		
<p>Subject: Bulb-Outs & No Right Turn On Red</p>		
<p>PROPOSAL / REQUEST: ESTABLISH – TOW-AWAY, NO STOPPING ANY TIME ESTABLISH – SIDEWALK WIDENING</p> <p>Italy Avenue, south side, from Mission Street to 20 feet easterly (for 4-foot wide bulb-out) A corner bulb-out is needed to fit new accessible curb ramps to be built with the Mission / Geneva Safety Project.</p> <p>Mission Street, west side, from 401 feet to 497 feet south of Onondaga Avenue (for 6-foot wide bulb-out) An extension of the previously-legislated bulb-out at this location (Mission St & France St) is needed to provide space for the existing driveway and new curb ramps. This removes meter 568-48440.</p> <p>ESTABLISH – NO RIGHT TURN ON RED</p> <p>Mission Street, northbound, at Admiral Avenue / Ney Street This change clarifies right-of-way at the intersection when a new traffic signal is installed with the Mission / Geneva Safety Project given the offset intersection geometry.</p> <p>(Supervisor District 11) Mark Dreger, mark.dreger@sfmta.com</p>		
<p>BACKGROUND INFORMATION / COMMENTS</p> <p>This is clean-up legislation for the Mission / Geneva Safety Project, currently in design by Public Works.</p> <ul style="list-style-type: none"> - A new corner bulb-out at Mission Street & Italy Avenue is necessary to build required accessible curb ramps. - An extension of the previously legislated bulb-out at Mission Street & France Street is necessary to provide sufficient space for the existing driveway and new curb ramps. - A new 'no right turn on red' restriction is necessary at Mission Street & Admiral Avenue / Ney Street to clarify right-of-way allocation at the intersection when a new traffic signal is installed. 		
<p>HEARING NOTIFICATION AND PROCESSING NOTES:</p>	<p>ENVIRONMENTAL CLEARANCE BY:</p> <p><input checked="" type="checkbox"/> SFMTA <input type="checkbox"/> Attached <input type="checkbox"/> Pending</p>	

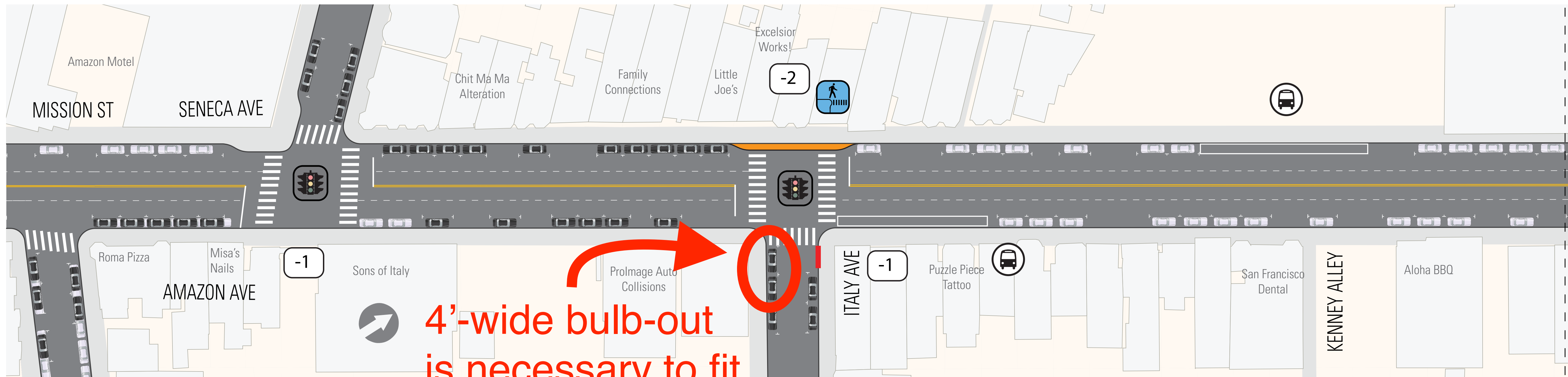

4'-wide bulb-out is necessary to fit new curb ramps at the SE corner

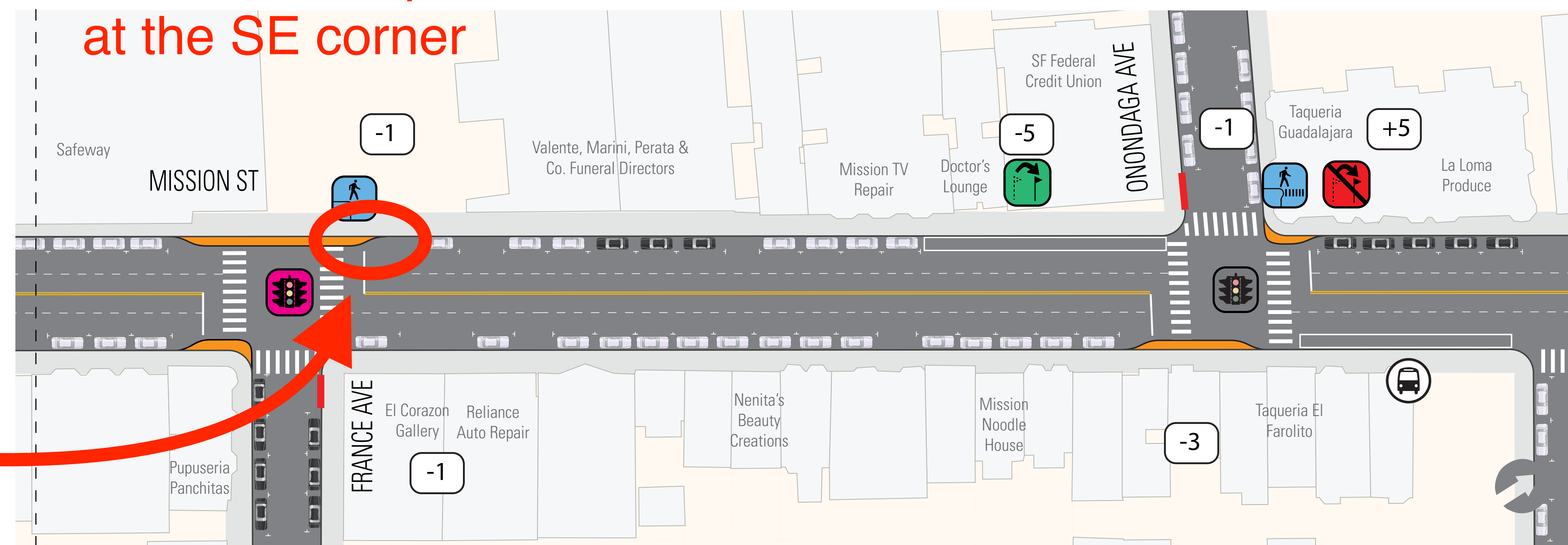

A short extension of the previously-legislated bulb-out is necessary to provide space for the existing driveway and new curb ramps

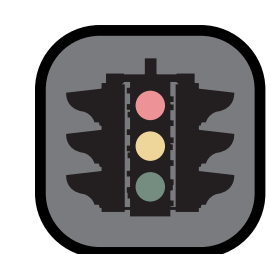

Existing Traffic Signals at Seneca Ave, Italy Ave, and Onondaga Ave



Existing Stop at Italy Ave and Onondaga Ave



Daylighting at Italy Ave, France Ave and Onondaga Ave

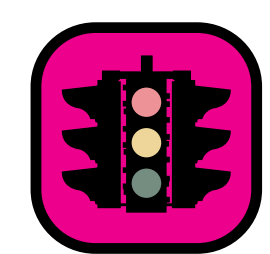

New Traffic Signals at France (Flashing Beacon during interim)

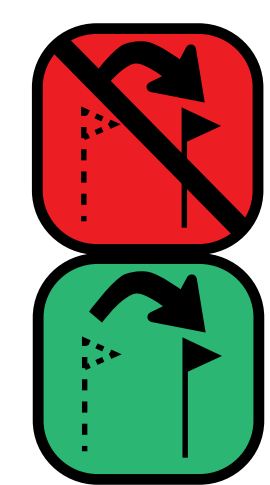

Relocate Stop at Onondaga Ave



New Pedestrian Bulbs at Italy St, France Ave, Amazon Ave, and Onondaga Ave



New Parking Meters

For general information 24/7/365, dial 311 (415.701.2311 outside SF).

311 Free language assistance / 免費語言協助 / Ayuda gratis con el idioma / Бесплатная помощь переводчиков / Trợ giúp Thông dịch Miễn phí / Assistance linguistique gratuite / 無料の言語支援 / 무료 언어 지원 / Libreng tulong para sa wikang Tagalog / ความช่วยเหลือทางภาษาไทยไม่เสียค่าใช้จ่าย

No right turn on red for NB Mission St necessary to clarify right-of-way given elongated intersection

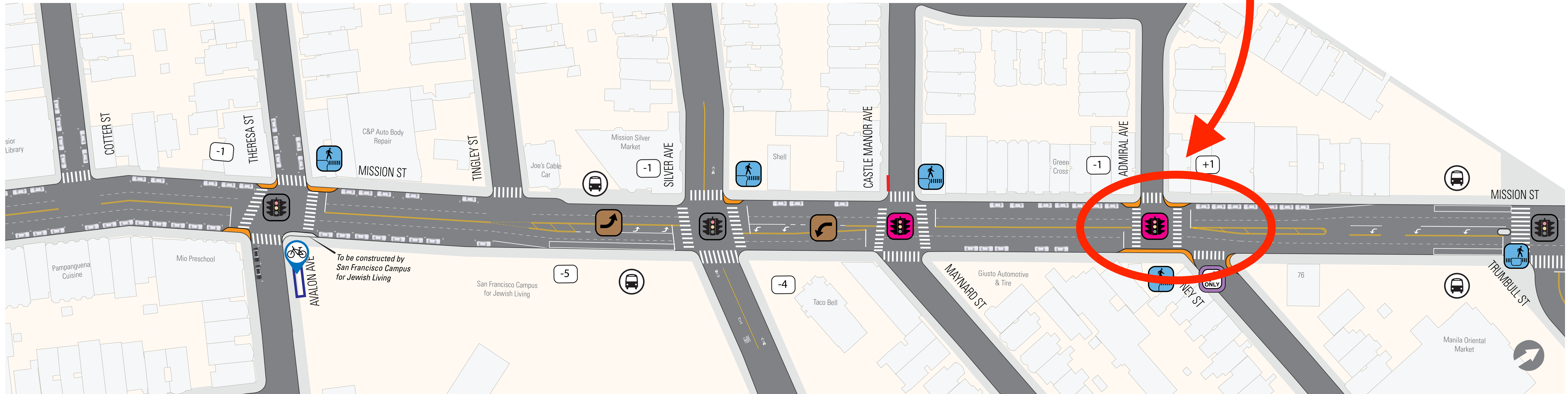

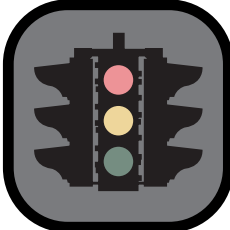
 Existing Traffic Signals at Theresa St, Silver Ave, and Trumbull St

 Existing Stop at Silver Ave and Trumbull St

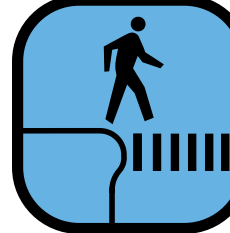
 New Pedestrian Bulbs at Theresa St, Silver Ave, Castle Manor Ave, and Admiral Ave

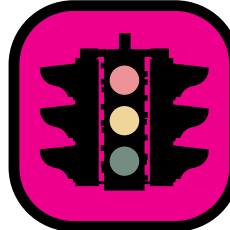
 New Traffic Signals at Admiral Ave and Castle Manor Ave/Maynard St

 New Left Turn Pocket on Mission St at Silver Ave

 Right Turn Only at Ney Street

 New Parking Meters

 New Median Island at Trumbull St

 Daylighting at Castle Manor Ave

MATCH LINE "A", SEE SHEET CR-3

MISSION STREET

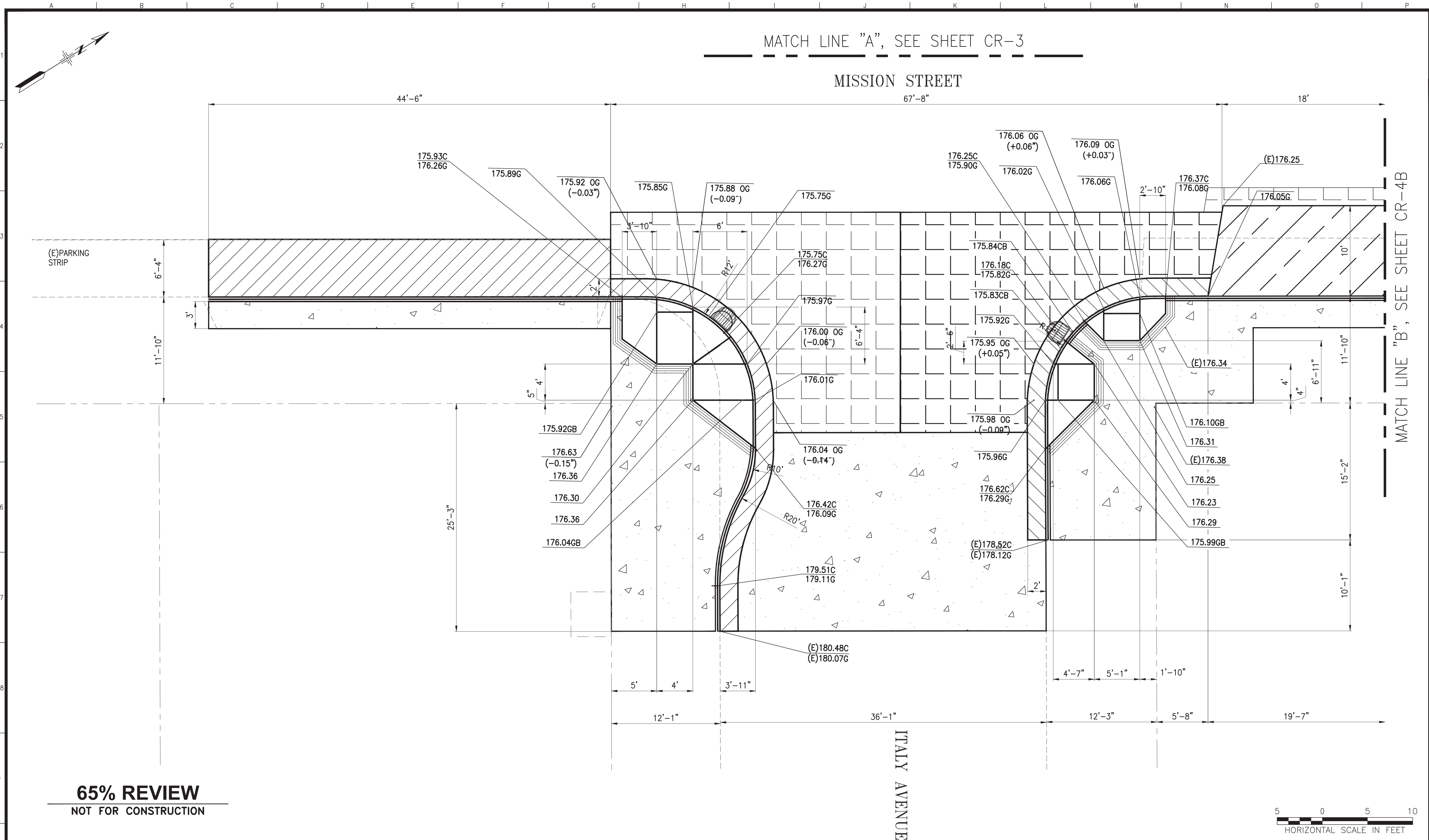

MATCH LINE "B", SEE SHEET CR-4B

65% REVIEW
NOT FOR CONSTRUCTION



NO.	DATE	DESCRIPTION	BY	APP.
TABLE OF REVISIONS				
THIS DRAWING WAS LAST MODIFIED: 04/29/21 22:41, BY: iliang				

REFERENCE INFORMATION
& FILE NO. OF SURVEYS



BUREAU OF ENGINEERING
CITY & COUNTY OF SAN FRANCISCO
SAN FRANCISCO PUBLIC WORKS
49 SOUTH VAN NESS AVENUE, SUITE 800
SAN FRANCISCO, CA 94103

Section Mgr:	Date:
Deputy Bureau Mgr:	
Bureau Mgr:	

DESIGNED:	DATE:
I.LIANG	4/2021
DRAWN:	DATE:
I.LIANG	4/2021
CHECKED:	DATE:

SCALE:
1" = 5'
SHEET OF SHEETS

**MISSION ST AND GENEVA AVE
IMPROVEMENT PROJECT**
**CURB RAMP DETAILS
MISSION STREET AND ITALY AVENUE**

CONTRACT NO.	10035213
DRAWING NO.	CR-4A
FILE NO.	XXX,XXX
REV. NO.	

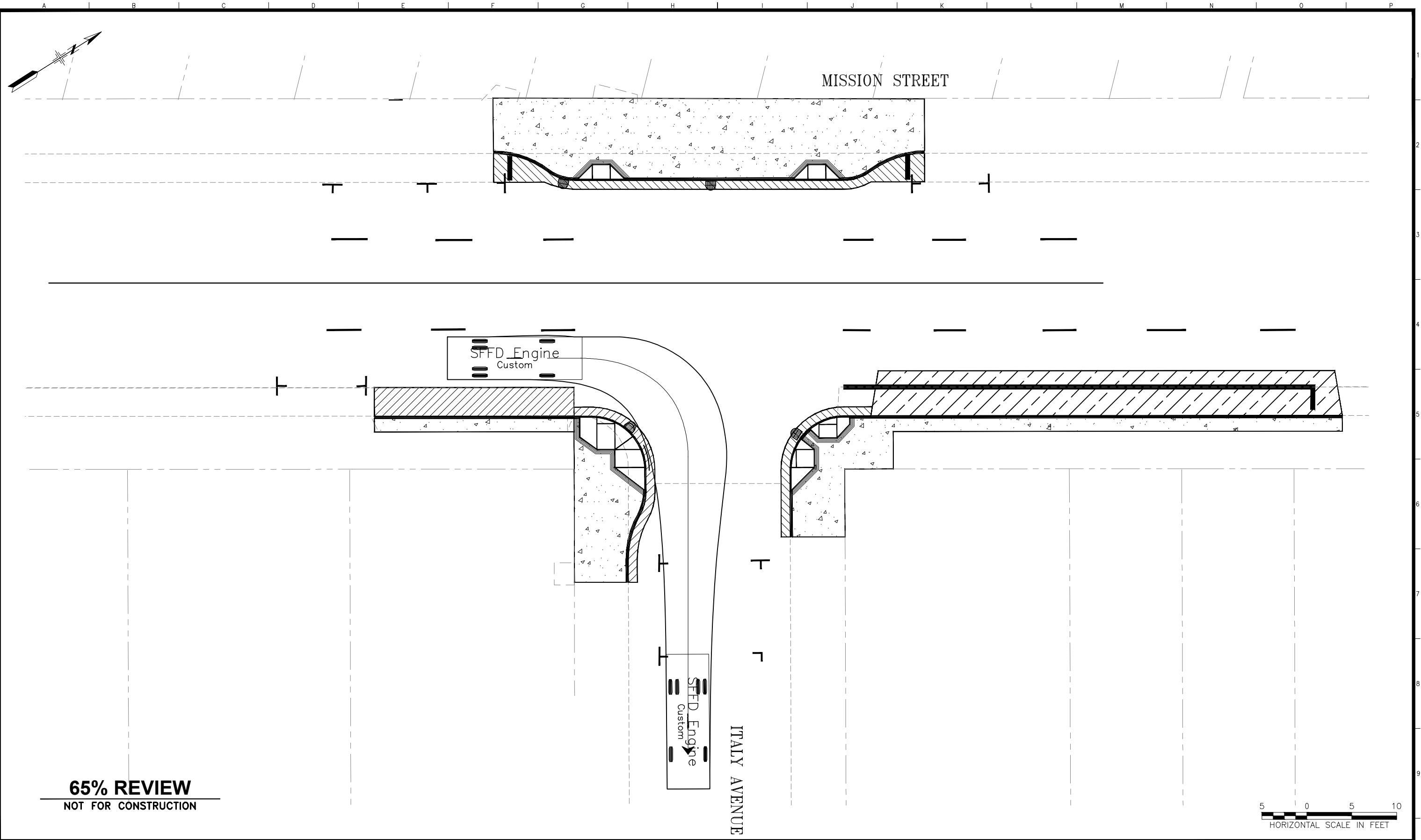

65% REVIEW
NOT FOR CONSTRUCTION

5 0 5 10
HORIZONTAL SCALE IN FEET

NO.	DATE	DESCRIPTION	BY	APP.
TABLE OF REVISIONS				
THIS DRAWING WAS LAST MODIFIED: 05/04/21 11:13, BY: jliang				

REFERENCE INFORMATION
& FILE NO. OF SURVEYS



BUREAU OF ENGINEERING
CITY & COUNTY OF SAN FRANCISCO
SAN FRANCISCO PUBLIC WORKS
49 SOUTH VAN NESS AVENUE, SUITE 800
SAN FRANCISCO, CA 94103

Section Mgr:	Date:
Deputy Bureau Mgr:	
Bureau Mgr:	

DESIGNED:	DATE:
I.LIANG	4/2021
DRAWN:	DATE:
I.LIANG	4/2021
CHECKED:	DATE:

SHEET OF SHEETS

SCALE:
1" = 10'

**MISSION ST AND GENEVA AVE
IMPROVEMENT PROJECT**

**TRUCK TURNING TEMPLATE
MISSION STREET AND ITALY AVENUE**

CONTRACT NO.	10035213
DRAWING NO.	CR-4
FILE NO.	XXX,XXX
REV. NO.	

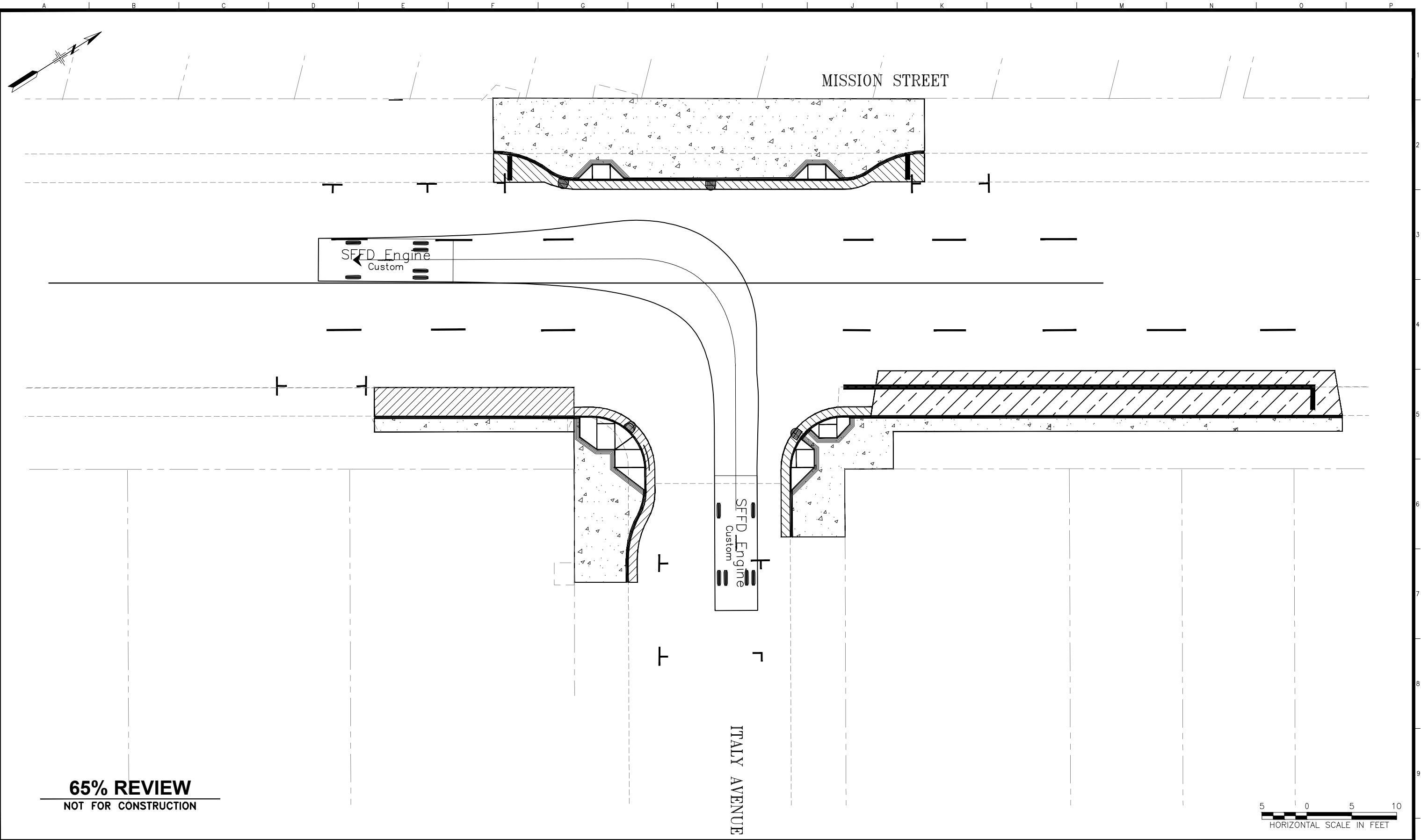

65% REVIEW
NOT FOR CONSTRUCTION

5 0 5 10
HORIZONTAL SCALE IN FEET

NO.	DATE	DESCRIPTION	BY	APP.
TABLE OF REVISIONS				
THIS DRAWING WAS LAST MODIFIED: 05/04/21 11:13, BY: jliang				

REFERENCE INFORMATION
& FILE NO. OF SURVEYS



BUREAU OF ENGINEERING
CITY & COUNTY OF SAN FRANCISCO
SAN FRANCISCO PUBLIC WORKS
49 SOUTH VAN NESS AVENUE, SUITE 800
SAN FRANCISCO, CA 94103

Section Mgr:	Date:
Deputy Bureau Mgr:	
Bureau Mgr:	

DESIGNED:	DATE:
I.LIANG	4/2021
DRAWN:	DATE:
I.LIANG	4/2021
CHECKED:	DATE:

SHEET OF SHEETS

SCALE:
1" = 10'

**MISSION ST AND GENEVA AVE
IMPROVEMENT PROJECT**

**TRUCK TURNING TEMPLATE
MISSION STREET AND ITALY AVENUE**

CONTRACT NO.	10035213
DRAWING NO.	CR-4
FILE NO.	XXX,XXX
REV. NO.	

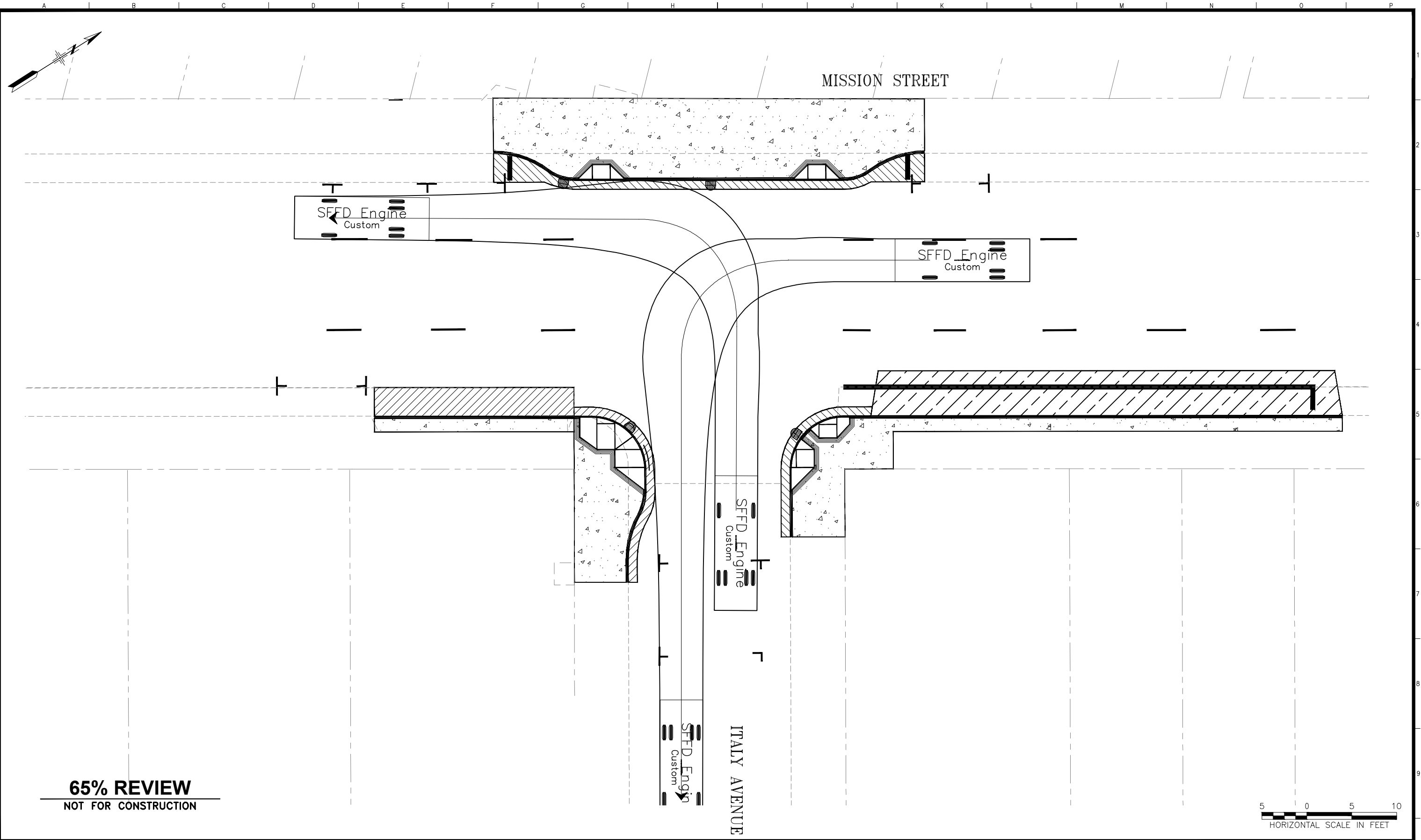

65% REVIEW
NOT FOR CONSTRUCTION

5 0 5 10
HORIZONTAL SCALE IN FEET

NO.	DATE	DESCRIPTION	BY	APP.
TABLE OF REVISIONS				
THIS DRAWING WAS LAST MODIFIED: 05/04/21 11:13, BY: jliang				

REFERENCE INFORMATION
& FILE NO. OF SURVEYS



BUREAU OF ENGINEERING
CITY & COUNTY OF SAN FRANCISCO
SAN FRANCISCO PUBLIC WORKS
49 SOUTH VAN NESS AVENUE, SUITE 800
SAN FRANCISCO, CA 94103

Section Mgr:	Date:
Deputy Bureau Mgr:	
Bureau Mgr:	

DESIGNED:	DATE:
I.LIANG	4/2021
DRAWN:	DATE:
I.LIANG	4/2021
CHECKED:	DATE:

SCALE:
1" = 10'
SHEET OF SHEETS

**MISSION ST AND GENEVA AVE
IMPROVEMENT PROJECT**
**TRUCK TURNING TEMPLATE
MISSION STREET AND ITALY AVENUE**

CONTRACT NO.	10035213
DRAWING NO.	CR-4
FILE NO.	XXX,XXX
REV. NO.	

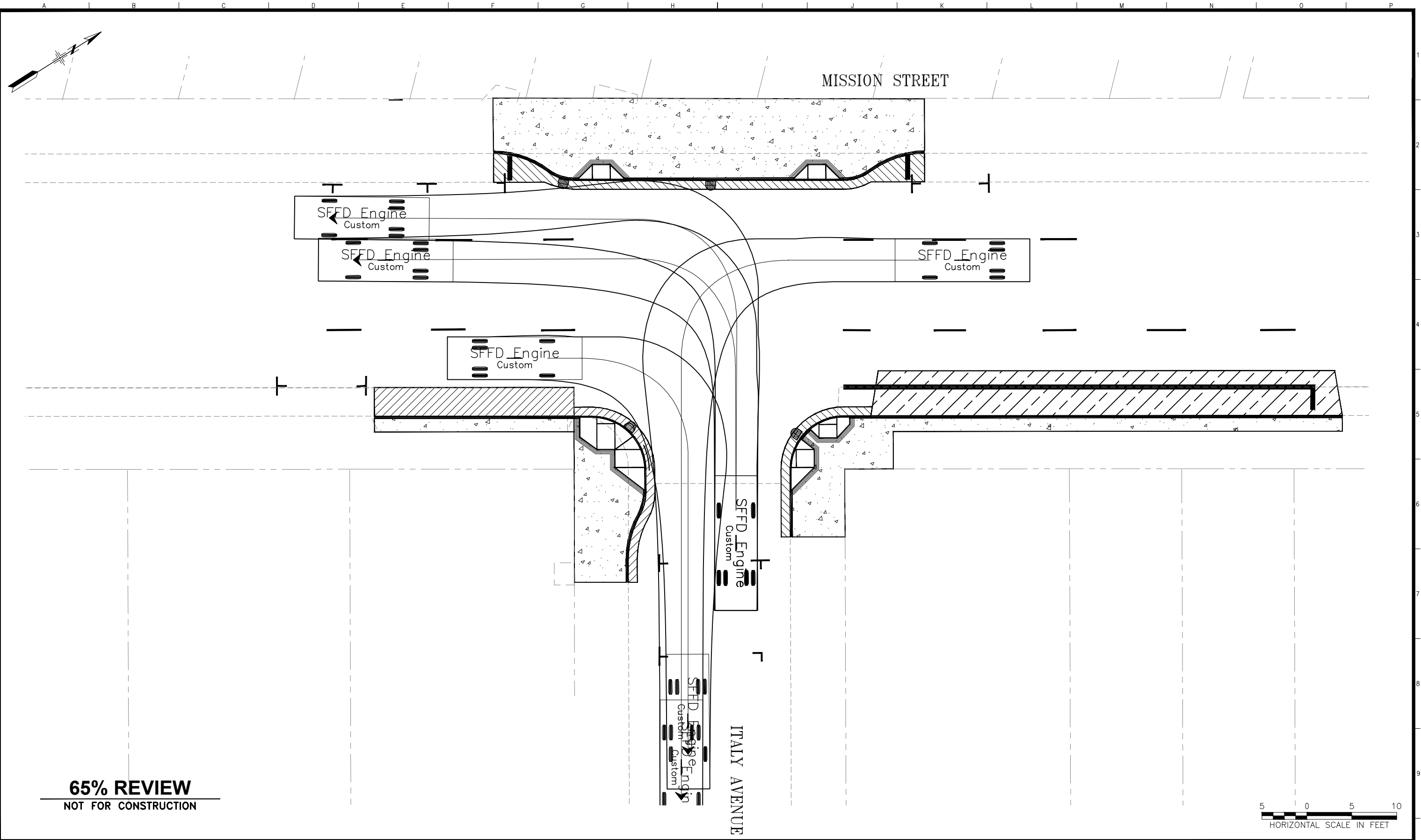

65% REVIEW
NOT FOR CONSTRUCTION

5 0 5 10
HORIZONTAL SCALE IN FEET

NO.	DATE	DESCRIPTION	BY	APP.
TABLE OF REVISIONS				
THIS DRAWING WAS LAST MODIFIED: 05/04/21 11:13, BY: jliang				

REFERENCE INFORMATION
& FILE NO. OF SURVEYS



BUREAU OF ENGINEERING
CITY & COUNTY OF SAN FRANCISCO
SAN FRANCISCO PUBLIC WORKS
49 SOUTH VAN NESS AVENUE, SUITE 800
SAN FRANCISCO, CA 94103

Date: _____
Section Mgr: _____
Deputy Bureau Mgr: _____
Bureau Mgr: _____

DESIGNED: DATE:
I.LIANG **4/2021**
DRAWN: DATE:
I.LIANG **4/2021**
CHECKED: DATE:

SCALE:
1" = 10'
SHEET OF SHEETS

**MISSION ST AND GENEVA AVE
IMPROVEMENT PROJECT**
**TRUCK TURNING TEMPLATE
MISSION STREET AND ITALY AVENUE**

CONTRACT NO.
10035213
DRAWING NO.
CR-4
FILE NO.
XXX,XXX
REV. NO.

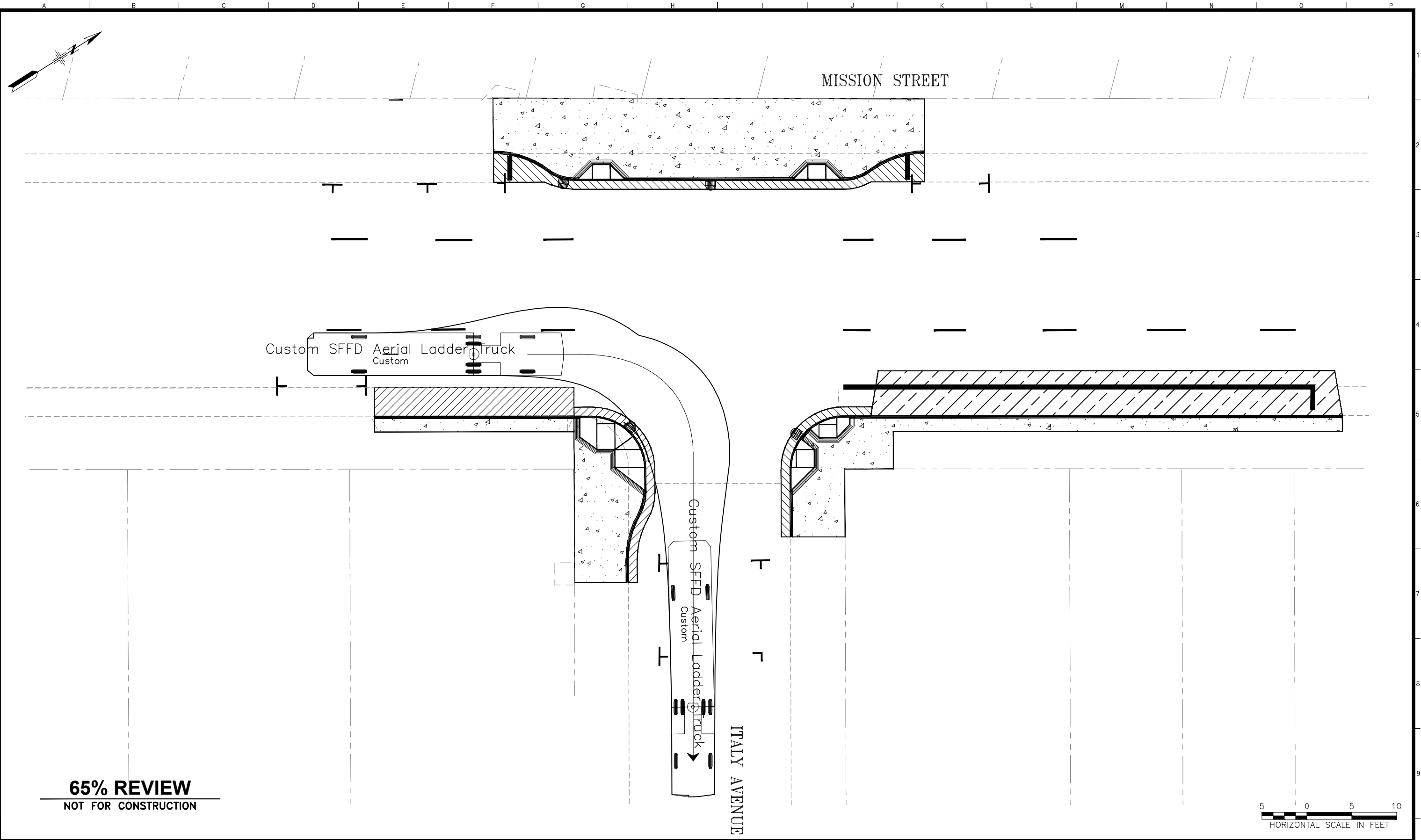

65% REVIEW
NOT FOR CONSTRUCTION

5 0 5 10
HORIZONTAL SCALE IN FEET

NO.	DATE	DESCRIPTION	BY	APP.
TABLE OF REVISIONS				
THIS DRAWING WAS LAST MODIFIED: 05/04/21 11:13, BY: jliang				

REFERENCE INFORMATION
& FILE NO. OF SURVEYS



BUREAU OF ENGINEERING
CITY & COUNTY OF SAN FRANCISCO
SAN FRANCISCO PUBLIC WORKS
49 SOUTH VAN NESS AVENUE, SUITE 800
SAN FRANCISCO, CA 94103

Section Mgr:	Date:
Deputy Bureau Mgr:	
Bureau Mgr:	

DESIGNED:	DATE:
I.LIANG	4/2021
DRAWN:	DATE:
I.LIANG	4/2021
CHECKED:	DATE:

SCALE:
1" = 10'
SHEET OF SHEETS

**MISSION ST AND GENEVA AVE
IMPROVEMENT PROJECT**
**TRUCK TURNING TEMPLATE
MISSION STREET AND ITALY AVENUE**

CONTRACT NO.	10035213
DRAWING NO.	CR-4
FILE NO.	XXX,XXX
REV. NO.	

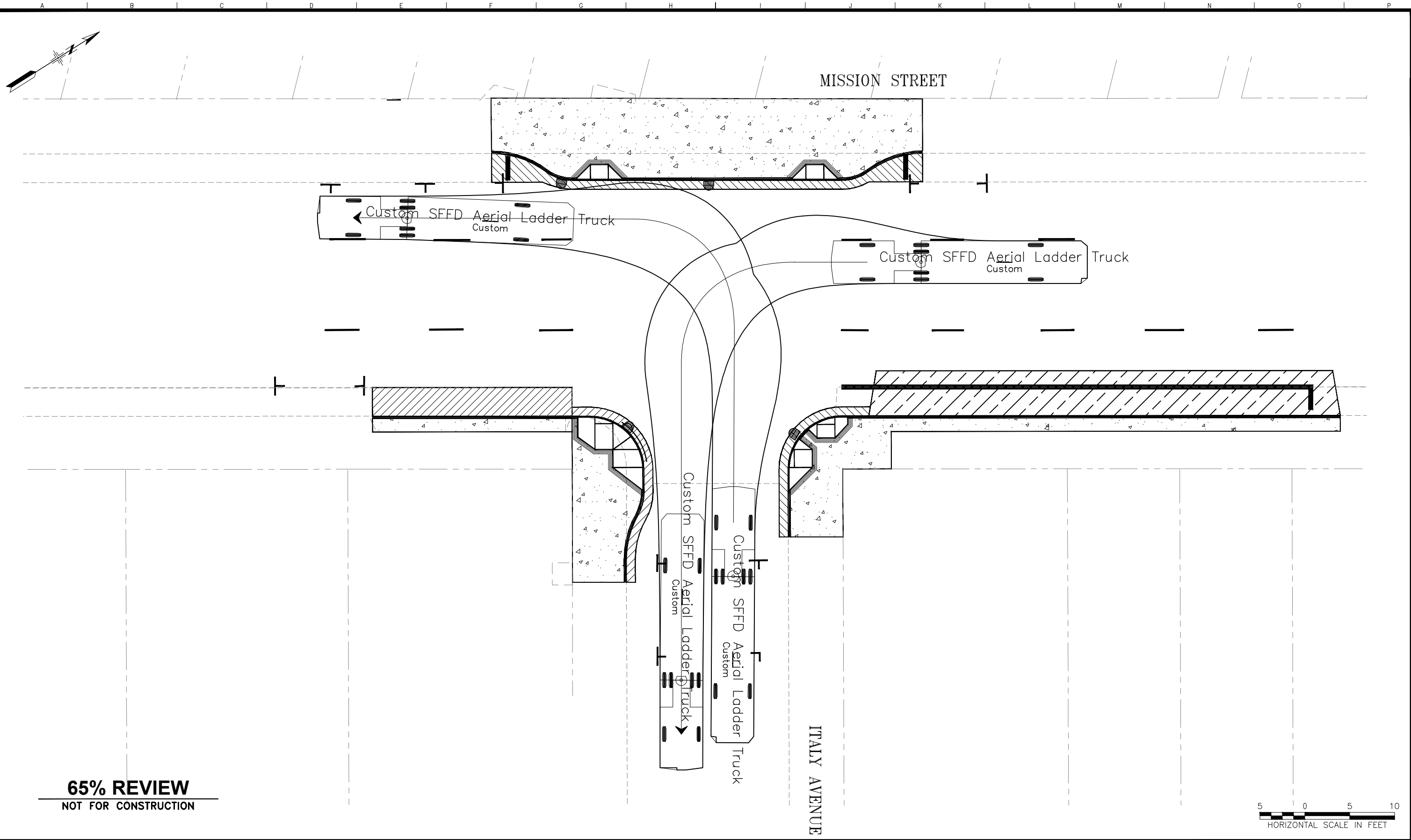

65% REVIEW
NOT FOR CONSTRUCTION



NO.	DATE	DESCRIPTION	BY	APP.
TABLE OF REVISIONS				
THIS DRAWING WAS LAST MODIFIED: 05/04/21 11:13, BY: jliang				

REFERENCE INFORMATION
& FILE NO. OF SURVEYS



BUREAU OF ENGINEERING
CITY & COUNTY OF SAN FRANCISCO
SAN FRANCISCO PUBLIC WORKS
49 SOUTH VAN NESS AVENUE, SUITE 800
SAN FRANCISCO, CA 94103

Section Mgr:	Date:
Deputy Bureau Mgr:	
Bureau Mgr:	

DESIGNED:	DATE:
I.LIANG	4/2021
DRAWN:	DATE:
I.LIANG	4/2021
CHECKED:	DATE:

SCALE:
1" = 10'
SHEET OF SHEETS

MISSION ST AND GENEVA AVE
IMPROVEMENT PROJECT

TRUCK TURNING TEMPLATE
MISSION STREET AND ITALY AVENUE

CONTRACT NO.	10035213
DRAWING NO.	CR-4
FILE NO.	XXX,XXX
REV. NO.	

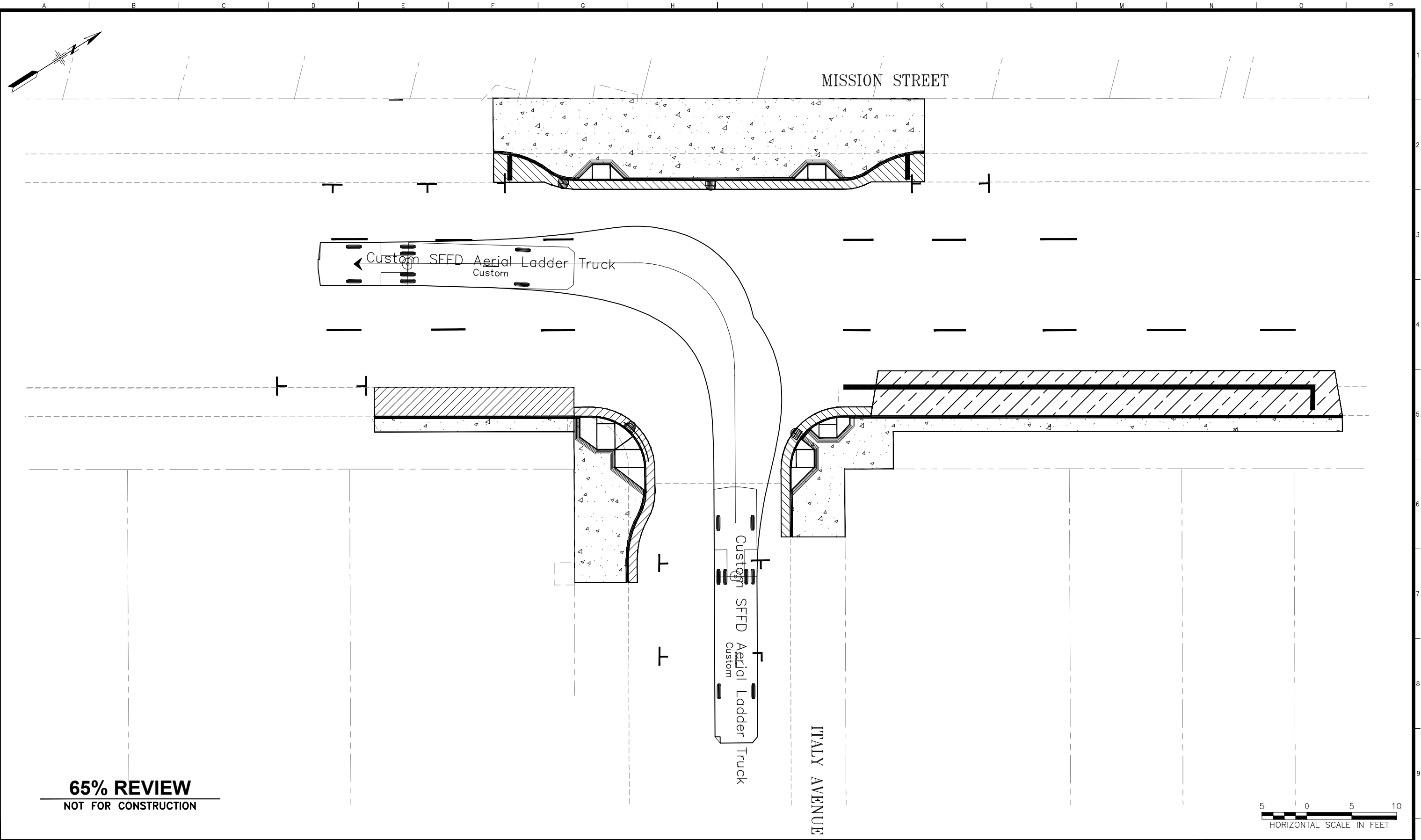

65% REVIEW
NOT FOR CONSTRUCTION

5 0 5 10
HORIZONTAL SCALE IN FEET

NO.	DATE	DESCRIPTION	BY	APP.
TABLE OF REVISIONS				
THIS DRAWING WAS LAST MODIFIED: 05/04/21 11:13, BY: jliang				

REFERENCE INFORMATION
& FILE NO. OF SURVEYS



BUREAU OF ENGINEERING
CITY & COUNTY OF SAN FRANCISCO
SAN FRANCISCO PUBLIC WORKS
49 SOUTH VAN NESS AVENUE, SUITE 800
SAN FRANCISCO, CA 94103

Section Mgr:	Date:
Deputy Bureau Mgr:	
Bureau Mgr:	

DESIGNED:	DATE:
I.LIANG	4/2021
DRAWN:	DATE:
I.LIANG	4/2021
CHECKED:	DATE:

SHEET OF SHEETS

SCALE:
1" = 10'

**MISSION ST AND GENEVA AVE
IMPROVEMENT PROJECT**

**TRUCK TURNING TEMPLATE
MISSION STREET AND ITALY AVENUE**

CONTRACT NO.	10035213
DRAWING NO.	CR-4
FILE NO.	XXX,XXX
REV. NO.	

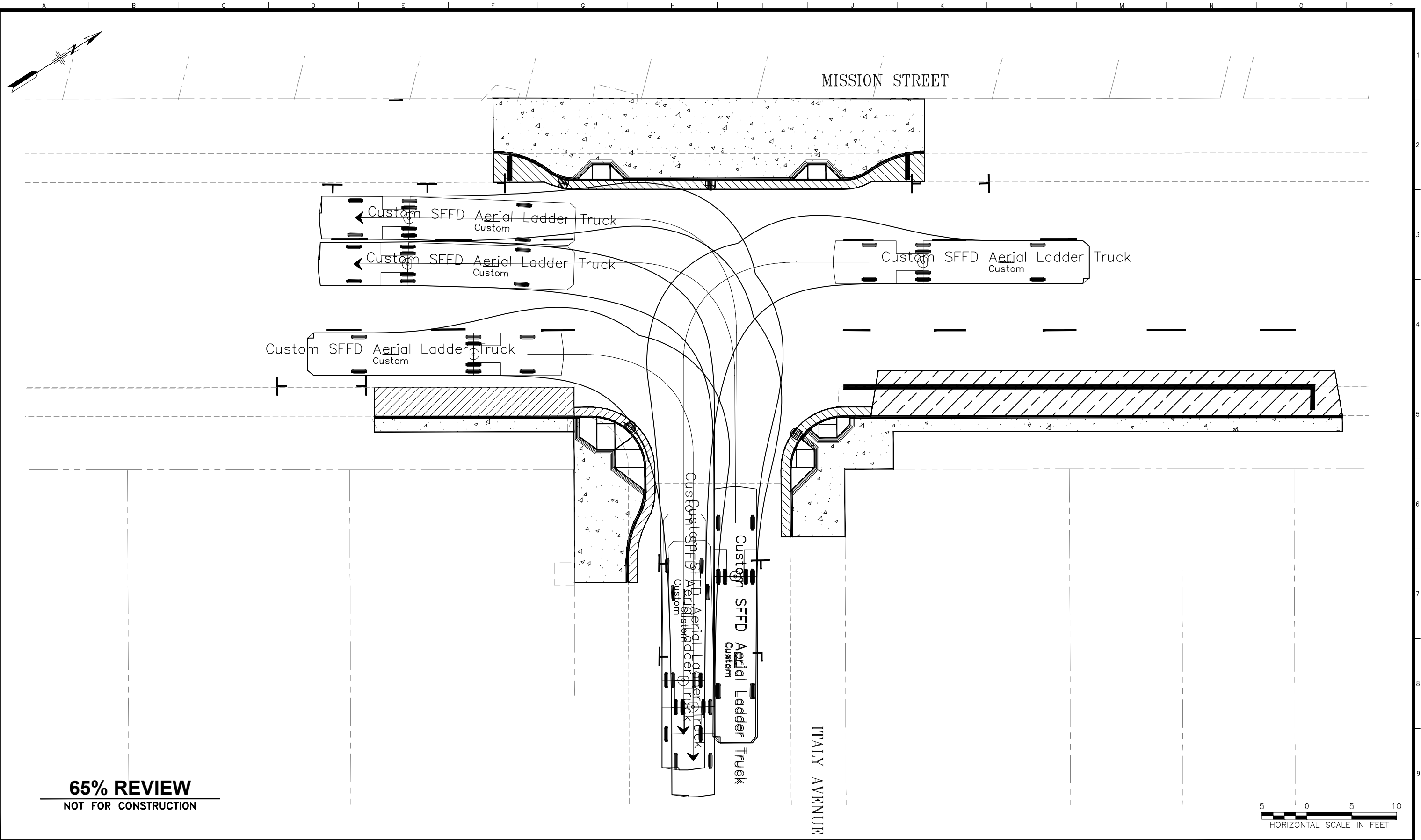

65% REVIEW
NOT FOR CONSTRUCTION

5 0 5 10
HORIZONTAL SCALE IN FEET

NO.	DATE	DESCRIPTION	BY	APP.
TABLE OF REVISIONS				
THIS DRAWING WAS LAST MODIFIED: 05/04/21 11:13, BY: jliang				

REFERENCE INFORMATION
& FILE NO. OF SURVEYS



BUREAU OF ENGINEERING
CITY & COUNTY OF SAN FRANCISCO
SAN FRANCISCO PUBLIC WORKS
49 SOUTH VAN NESS AVENUE, SUITE 800
SAN FRANCISCO, CA 94103

Date: _____
Section Mgr: _____
Deputy Bureau Mgr: _____
Bureau Mgr: _____

DESIGNED: DATE: **I.LIANG 4/2021**
DRAWN: DATE: **I.LIANG 4/2021**
CHECKED: DATE: _____

SCALE:
1" = 10'

SHEET OF SHEETS

**MISSION ST AND GENEVA AVE
IMPROVEMENT PROJECT**
**TRUCK TURNING TEMPLATE
MISSION STREET AND ITALY AVENUE**

CONTRACT NO. **10035213**
DRAWING NO. **CR-4**
FILE NO. **XXX,XXX**
REV. NO. _____

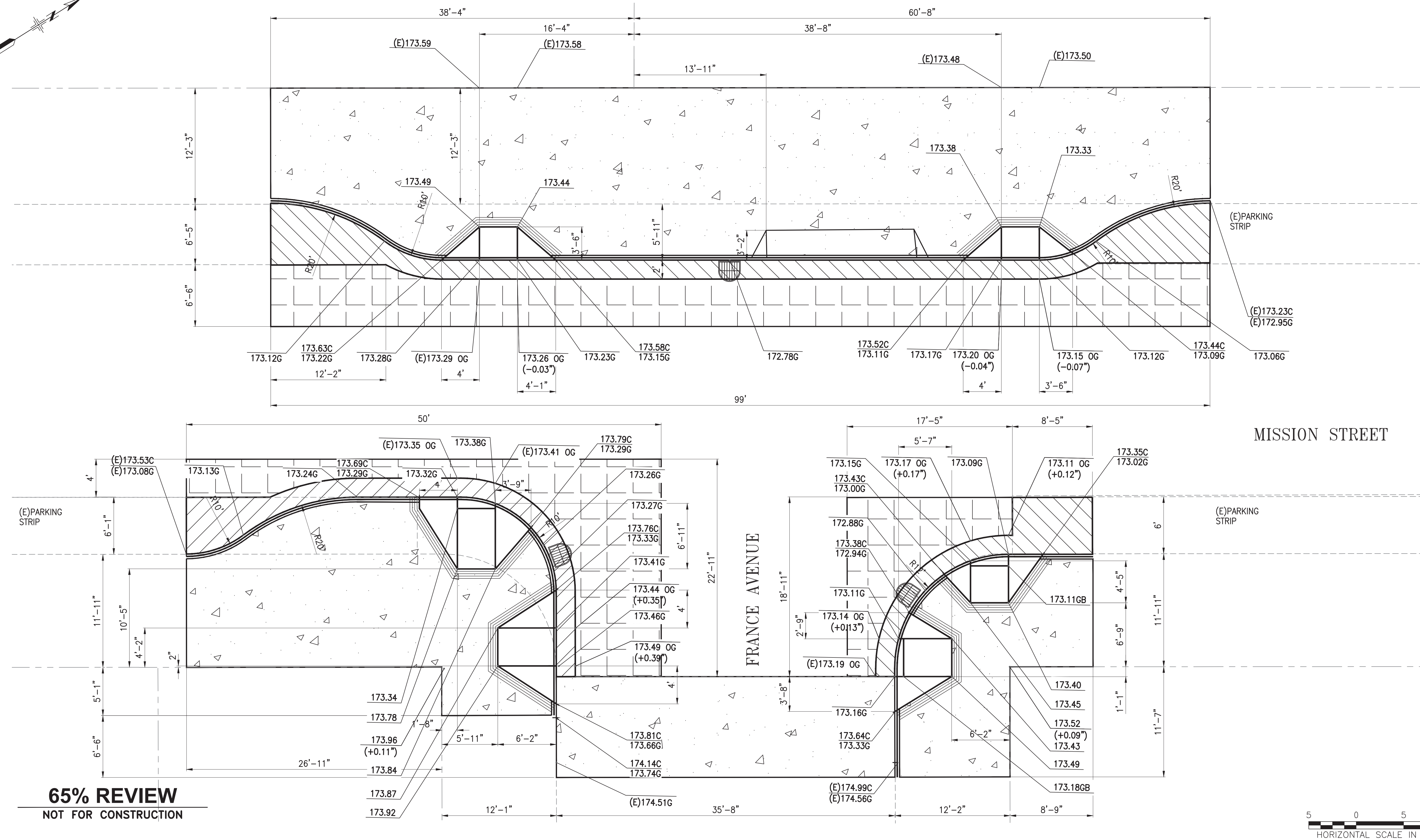
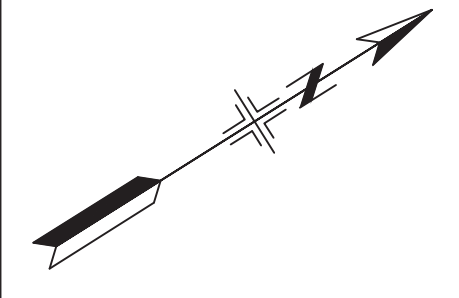

65% REVIEW
NOT FOR CONSTRUCTION



NO.	DATE	DESCRIPTION	BY	APP.
TABLE OF REVISIONS				
THIS DRAWING WAS LAST MODIFIED: 04/29/21 22:41, BY: iliang				

REFERENCE INFORMATION & FILE NO. OF SURVEYS



BUREAU OF ENGINEERING
CITY & COUNTY OF SAN FRANCISCO
SAN FRANCISCO PUBLIC WORKS
49 SOUTH VAN NESS AVENUE, SUITE 800
SAN FRANCISCO, CA 94103

Date:

Section Mgr:

Deputy Bureau Mgr:

Bureau Mgr:

DESIGNED: I.LIANG DATE: 4/2021

DRAWN: I.LIANG DATE: 4/2021

CHECKED: DATE:

SCALE: 1" = 5'

SHEET OF SHEETS

**MISSION ST AND GENEVA AVE
IMPROVEMENT PROJECT**

**CURB RAMP DETAILS
MISSION STREET & FRANCE AVENUE**

CONTRACT NO. 10035213
DRAWING NO. CR-5
FILE NO. XXX,XXX
REV. NO.

MATCH LINE "N", SEE SHEET CR-24

MISSION STREET

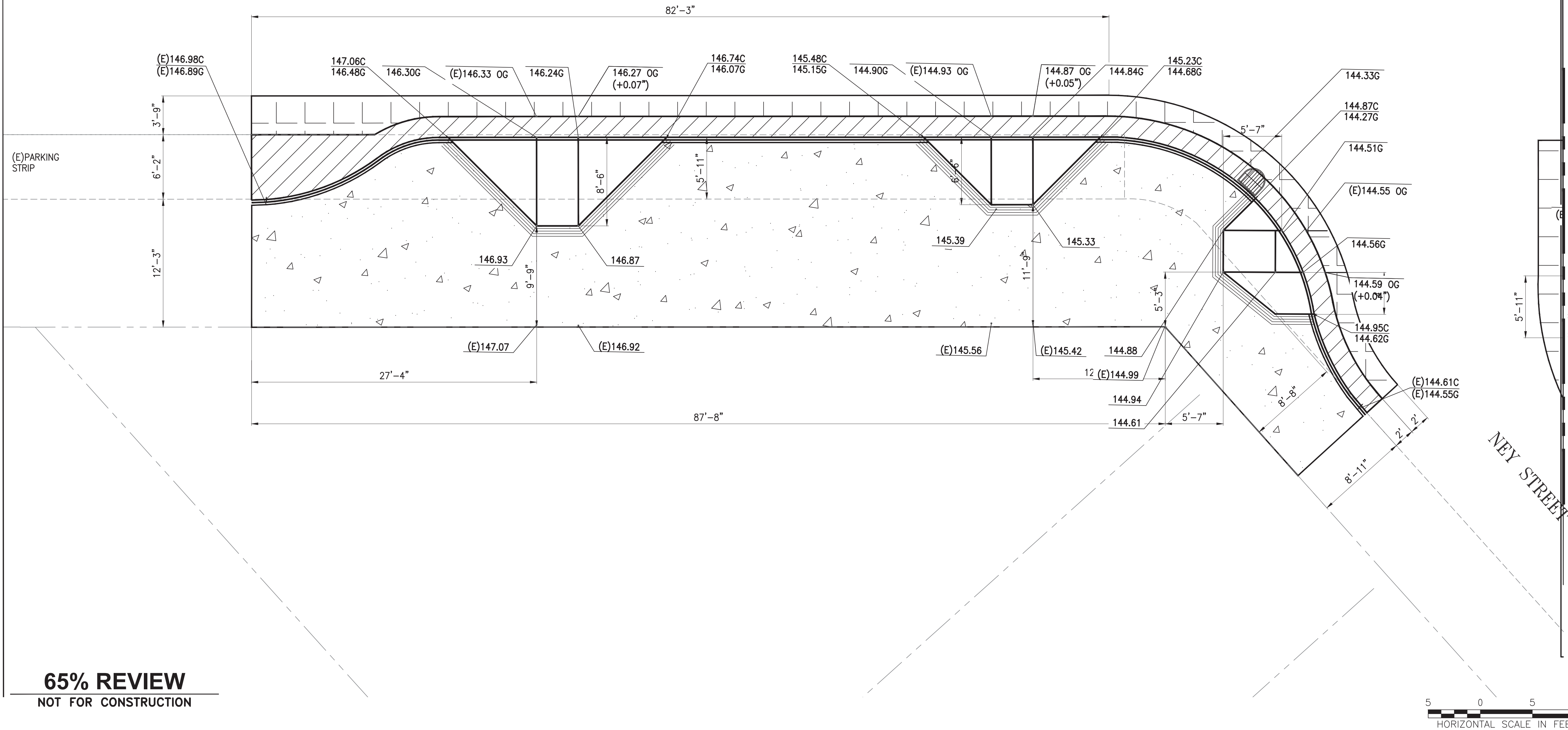

MATCH LINE "O", SEE SHEET CR-26

NEY STREET

65% REVIEW
NOT FOR CONSTRUCTION

HORIZONTAL SCALE IN FEET

NO.	DATE	DESCRIPTION	BY	APP.
TABLE OF REVISIONS				
THIS DRAWING WAS LAST MODIFIED: 04/29/21 22:41, BY: iliang				

REFERENCE INFORMATION
& FILE NO. OF SURVEYS



BUREAU OF ENGINEERING
CITY & COUNTY OF SAN FRANCISCO
SAN FRANCISCO PUBLIC WORKS
49 SOUTH VAN NESS AVENUE, SUITE 800
SAN FRANCISCO, CA 94103

Section Mgr:	Date:
Deputy Bureau Mgr:	
Bureau Mgr:	

DESIGNED:	DATE:
I.LIANG	4/2021
DRAWN:	DATE:
I.LIANG	4/2021
CHECKED:	DATE:

SCALE:
1" = 5'

SHEET OF SHEETS

**MISSION ST AND GENEVA AVE
IMPROVEMENT PROJECT**

**CURB RAMP DETAILS
MISSION STREET & NEY STREET**

CONTRACT NO.	10035213
DRAWING NO.	CR-25
FILE NO.	XXX,XXX
REV. NO.	

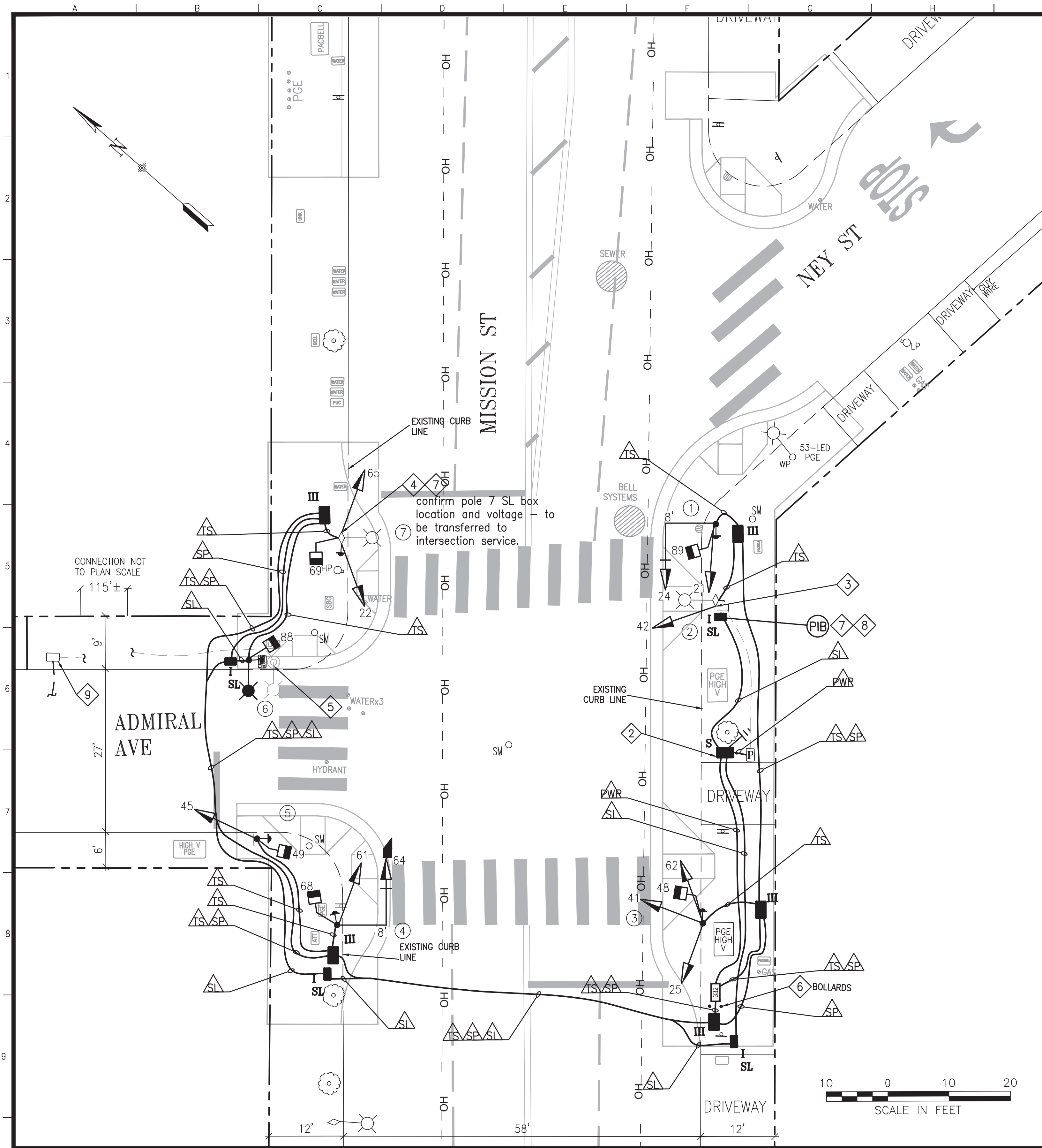

POLE AND EQUIPMENT SCHEDULE											
POLE No.	TYPE OF POLE	LUMINAIRE VOLTAGE/WATTAGE	VEHICLE SIGNAL				PEDESTRIAN SIGNAL			REMARKS	
			No.	TYPE	MOUNTING	VISORS	LOUVERS/BP	No.	TYPE		MOUNTING
①	16-2-100 w/ 8' MAST ARM		21	3S12"	SV-1-T	T	HORIZONTAL LOUVERS ON GREEN (24) AND BP	89	1S-COUNT	SP-1	APS-2W
			24	3S12"	MAC-SF	T					MOUNT 21 ON E/S OF POLE
②	EX MUNI POLE W/ STREETLIGHT	C 106	42	3S12"	SV-1-T	T					MOUNT 42 AT 15' LB CONDULET
③	1-A (15')		41	3S12"	TV-1-T	T		48	1S-COUNT	SP-1	MOUNT 62/25 AT 9' APS-2W
			62	3S12"	SV-2-TA	T					
④	16-2-100 w/ 8' MAST ARM		61	3S12"	SV-1-T	T	HORIZONTAL LOUVERS ON GREEN (64) AND BP	68	1S-COUNT	SP-1	APS-2W
			64	3S12"	MAC-SF	RA (18")					
⑤	1-A (10')		45	3S12"	TV-1-T	T		49	1S-COUNT	SP-1	APS-2W
⑥	STEEL STREETLIGHT (28.5') WITH 6' LUMINAIRE ARM	C 54						88	1S-COUNT	SP-1	APS-2W
⑦	EX MUNI POLE W/ STREETLIGHT	C 106	22	3S12"	SV-2-TA	T		69	1S-COUNT	SP-1	APS-2W
			65	3S12"		T	LB CONDULET				

GENERAL NOTES:

SHEET NOTES:

- ① INSTALL SIGNALS 62, AND 25 ON THE WEST SIDE OF POLE 3
- ② REFER TO PG&E CONSTRUCTION SKETCH PRIOR TO INSTALLATION. CITY SERVICE BOX SHALL BE WITHIN 5 FEET FROM PG&E SERVICE. PG&E SERVICE ESTIMATED 40 FEET FROM CONTROLLER TO CITY SERVICE BOX.
- ③ INSTALL "LB" CONDULET TO BE LOCATED ON SOUTH SIDE OF POLE.
- ④ INSTALL "LB" CONDULET TO BE LOCATED ON NORTH SIDE OF POLE.
- ⑤ R/C POLE AND WIRING.
- ⑥ PROVIDE BOLLARDS PER SFDPW STANDARD PLAN 87,178. CONTACT SFMTA 2 WEEKS PRIOR TO BOLLARD INSTALLATION TO PERFORM A LAYOUT CHECK.
- ⑦ CONVERT (E) STREETLIGHT CONNECTED TO (E) SERVICE POINT TO (N) INTERSECTION SERVICE POINT AT 120V.
- ⑧ PIB PULLBOX. ABANDON (E) WIRING AND CONDUIT TO (E) PG&E BOX. CUT ABANDONED CONDUIT BACK TO PULLBOX WALL.
- ⑨ CUT ABANDONED CONDUIT BACK TO PULLBOX WALL AND REPLACE PULLBOX LID WITH LID LABELED 'STREETLIGHT'.

PHASE DIAGRAM

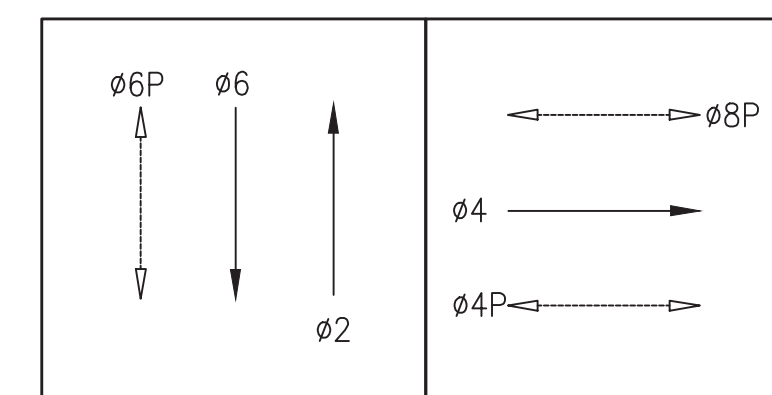

65% CONDUIT KEY:

- △ TS TRAFFIC SIGNAL CONDUIT (TYP. 2" PVC)
- △ SL STREETLIGHT CONDUIT (2" GRS)
- △ SP SPARE EMPTY CONDUIT (2" PVC)
- △ PWR INTERSECTION SERVICE CONDUIT (2" PVC)
- △ IC INTERCONNECT/BACKFEED/12C CONDUIT (VARIES)
- △ EX EXISTING CONDUIT (VARIES)

NO.	DATE	DESCRIPTION	BY	APP.
TABLE OF REVISIONS				
THIS DRAWING WAS LAST MODIFIED: 04/19/21 21:31, BY: BIKPAH				

REFERENCE INFORMATION & FILE NO. OF SURVEYS



BUREAU OF ENGINEERING
CITY & COUNTY OF SAN FRANCISCO
SAN FRANCISCO PUBLIC WORKS
49 SOUTH VAN NESS AVENUE, SUITE 800
SAN FRANCISCO, CA 94103

Section Mgr:	CHI IAO
Deputy Bureau Mgr:	LESLEY WONG
Bureau Mgr:	IQBAL DHAPA

DESIGNED:	DATE:
CS/BR	04/2021
DRAWN:	DATE:
CS/BR	04/2021
CHECKED:	DATE:
GD/DG	04/2021

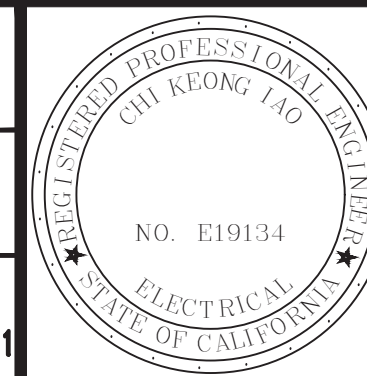

SCALE:
AS SHOWN
SHEET OF SHEETS

MISSION ST AND GENEVA AVE IMPROVEMENT PROJECT
MISSION STREET AND ADMIRAL AVENUE TRAFFIC SIGNAL WORK

CONTRACT NO.	10035213
DRAWING NO.	E-4.0
FILE NO.	
REV. NO.	

