

## SFMTA - TASC SUMMARY SHEET

<b>PreStaff_Date:</b> 10/13/2020 <b>Requested_by:</b> SFMTA <b>Handled:</b> Ashley Kim (646-2565) <b>Section Head :</b> M.Sallaberry <i>MS</i>	<input type="checkbox"/> <b>Public Hearing Consent</b> <input checked="" type="checkbox"/> <b>Public Hearing Regular</b> <input type="checkbox"/> <b>Informational / Other</b> <small>PH - Regular</small>	<b>No objections:</b> _____ <b>Item Held:</b> _____ <b>Other:</b> _____
---	---	---

**Location:** Howard Street at Beale Street

**Subject:** ESTABLISH TOW-AWAY, NO PARKING ANYTIME

**PROPOSAL / REQUEST:**

ESTABLISH – TOW-AWAY, NO PARKING ANYTIME

Howard Street, north side, from Beale Street to 51 feet westerly

(Supervisor District 6)

Ashley Kim, Ashley.kim@sfmta.com

Proposing a 51' tow-away, no parking zone on Howard Street, north side, from Beale Street to 51 feet westerly. The parking removal establishes tow-away no parking anytime and removes two proposed (but not yet installed) commercial loading spaces legislated near the northwest corner of Beale and Howard that would be in conflict with buses completing the southbound right turn from Beale Street to westbound Howard Street. Some buses making this southbound right turn utilize OCS, which restricts buses to use the north-most lane on Howard Street.

**BACKGROUND INFORMATION / COMMENTS**

This is cleanup legislation part of the Howard Quick Build Project.

This parking removal is in response to the buses utilizing the southbound right turn. Some buses making the southbound right turn from Beale Street to westbound Howard Street utilize OCS, which restricts buses to use the northern-most lane on Howard Street. The purpose of this clean up legislation is to establish tow-away no parking anytime and remove two proposed (but not yet installed) commercial loading spaces legislated near the northwest corner of Beale and Howard that would be in potential conflict with buses completing the southbound right turn from Beale to westbound Howard. Loading needs in the immediate area would still be met with the implementation of TANPAT.

<b>HEARING NOTIFICATION AND PROCESSING NOTES:</b>	<b>ENVIRONMENTAL CLEARANCE BY:</b> <input checked="" type="checkbox"/> SFMTA <input type="checkbox"/> Attached <input type="checkbox"/> Pending
---	--

# Aerial - Howard Quick-Build Project Limits



Howard Quick-Build Project Area (The Embarcadero to 3rd Street)

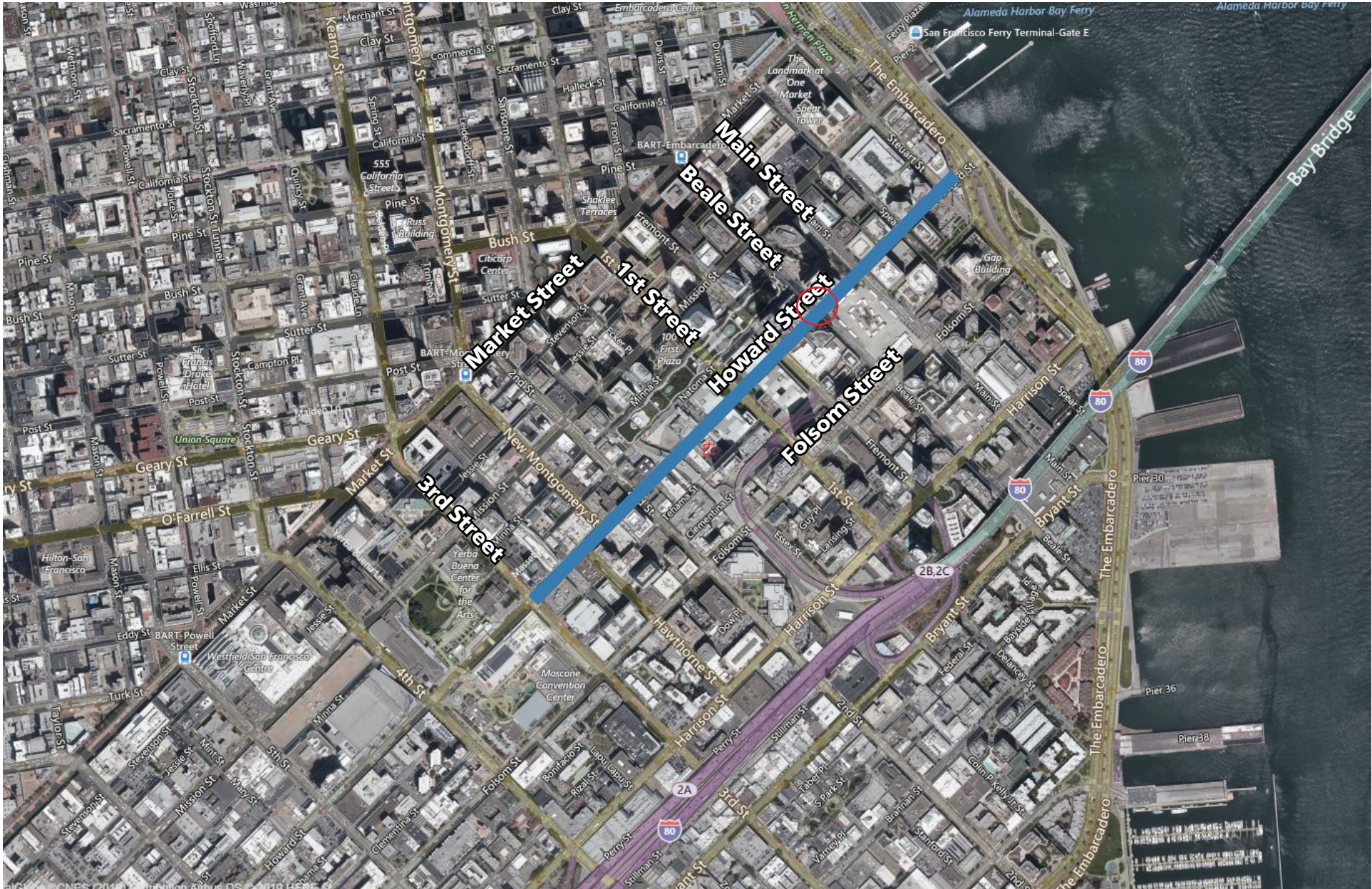

# Aerial - Howard Between 1st to Beale Streets

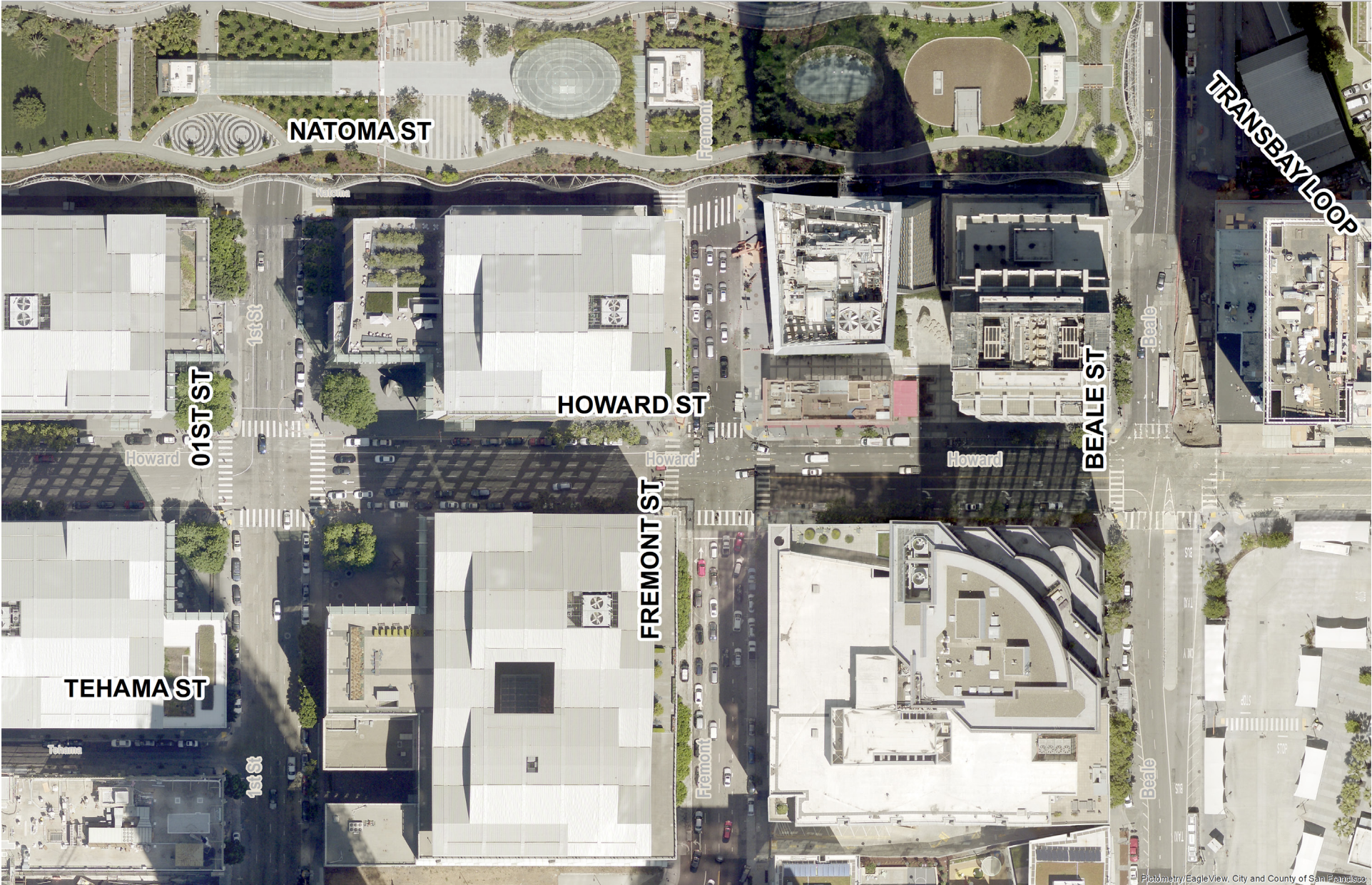

# Howard Street Quick-Build Project Limits



# Roadway Grades: Howard Street between The Embarcadero and 1st Street

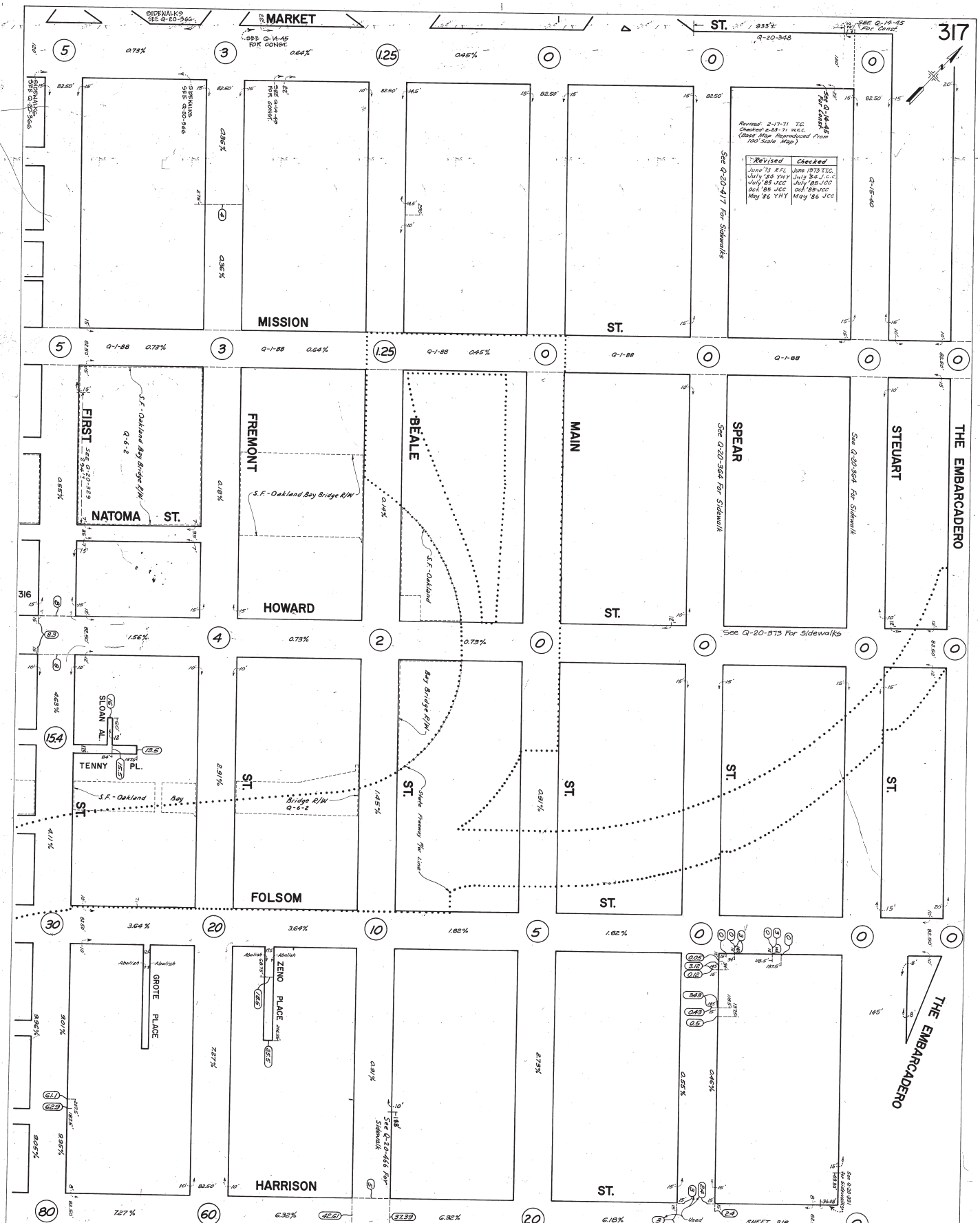

Howard Street at Beale Street, facing West



Howard Street at Beale Street, facing East

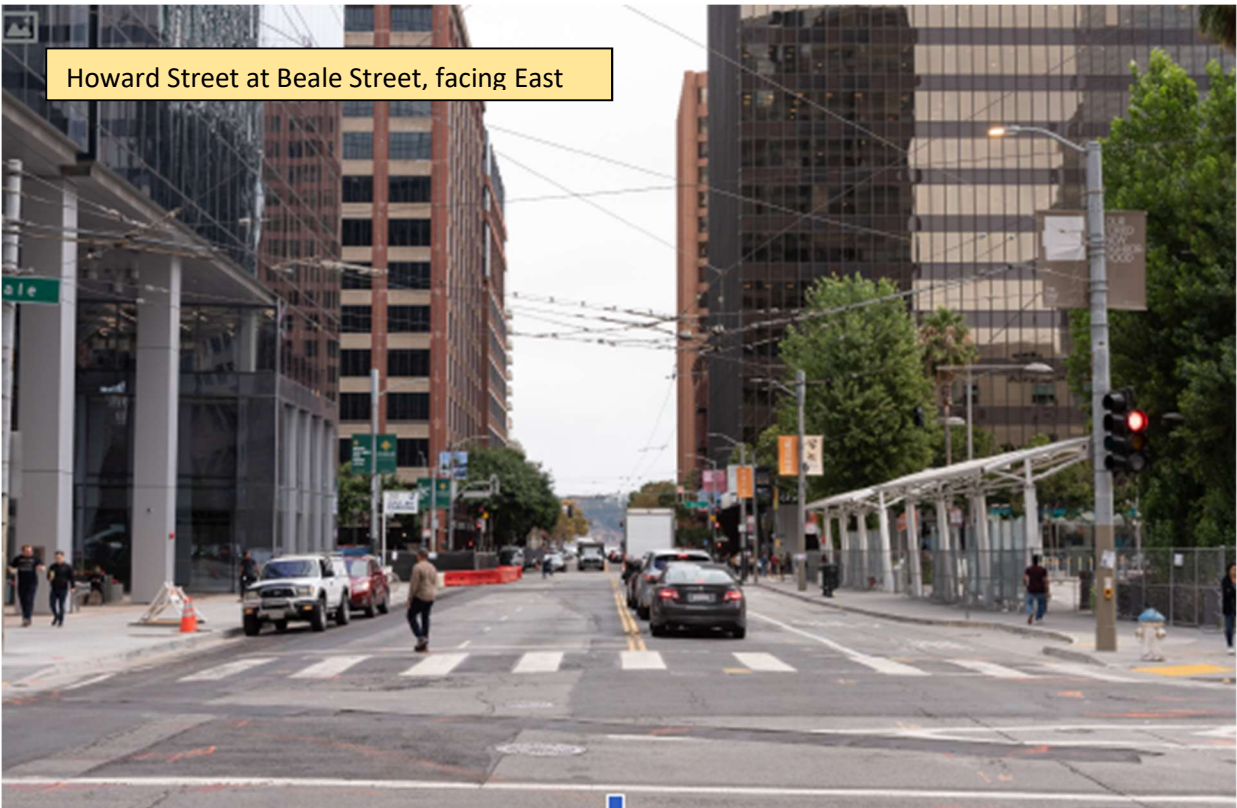

Proposing to replace existing Yellow Zones with TANPAT on Howard Street, north side, from Beale Street to 51 feet westerly.

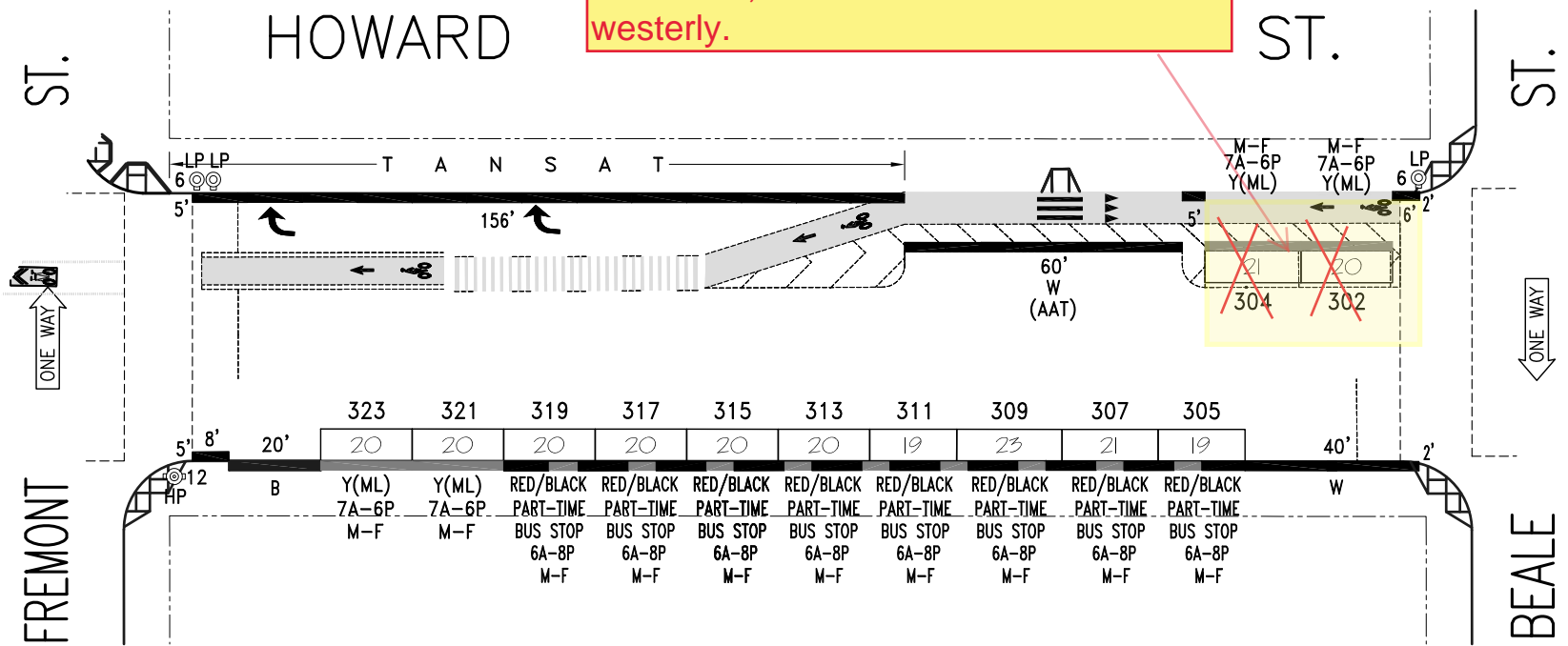

NOTE: FOR BIKEWAY STRIPING, REFER TO STR DWG. FOR COMPLETE DETAILS.

NO.	REVISION DESCRIPTION				BY	DATE	DIR/RES	6.c	Establish M/C#304,306,308-N/S				JB	12/6/17				
6.a	Extend BikeStn. MOS ML#304-N/S				JB	6/8/17	5857	7.a	Est.Bike,MOS MC#304,6,8,Est.ML302,4				JB	7/27/20	6189			
6.b	Establish ML on #320,322-N/S				JB	6/8/17		7.b	Est.Bikeway,MOS#316,18,20,22-N/S				JB	7/27/20	6189			
	TOW-AWAY		METER CT.		GENERAL				LOADING			METERED SPACES						
SIDE	AM	PM	SS	MS	GMP	MC	TIMES	DAYS	ML	MTL	6-W	15 MIN	30 MIN	1 HR	2 HR	10 HR	TOTAL	
ODD			10		8		7A-6P	M-SA	2					2	8		10	
EVEN			2				7A-6P	M-SA	2					2			2	



**SAN FRANCISCO MUNICIPAL TRANSPORTATION AGENCY**  
**CITY AND COUNTY OF SAN FRANCISCO**  
 PARKING METER SPACES

**HOWARD ST. (HOW, 470)**  
**(300) BLOCK**  
 Meters # 470-03XXY

**BEALE ST. TO FREMONT ST.**

SCALE: **1" = 40'**

DATE: **8/23/13**

BY: **JB**

AREA  
1

PLAN - EXISTING

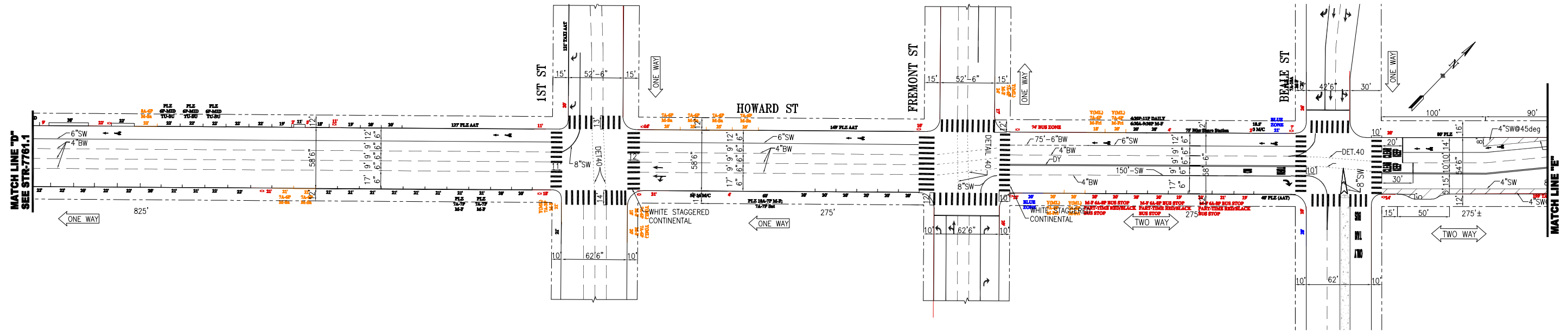

PLAN - PROPOSED

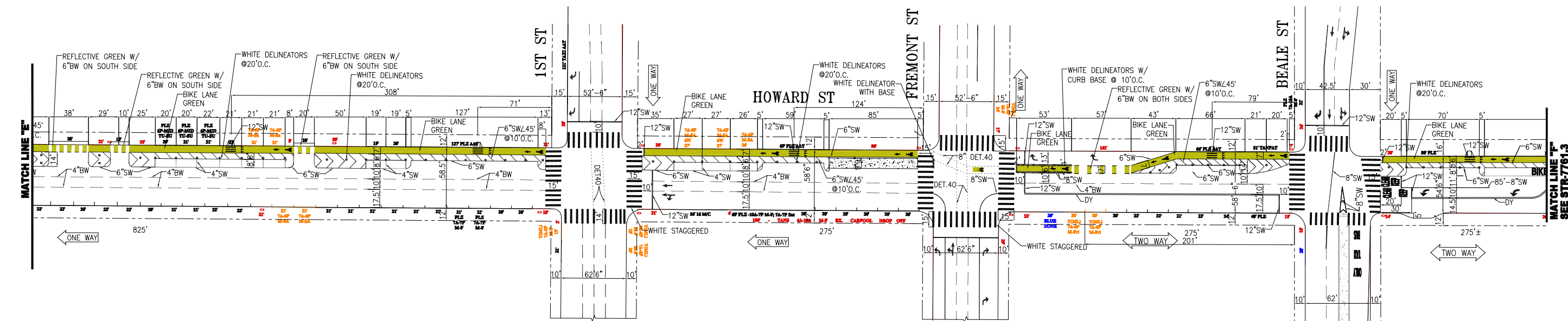

NO.	DATE	DESCRIPTION	BY	APP
TABLE OF REVISIONS				
CHECK WITH TRACING TO SEE IF YOU HAVE LATEST REVISION				



DRAWN:	DATE:	SENIOR ENGINEER	DATE:
CHECKED:	DATE:	CITY TRAFFIC ENGINEER	DATE:

APPROVED	SCALE:
	1"=50'
SHEET/SHEETS:	

TRAFFIC STRIPING	
HOWARD STREET 1ST STREET TO BEALE STREET	
CONTRACT NO.	
DRAWING NO.	
FILE NO.	
REV. NO.	

FILE NAME: \\sfs\city\info\eng\barcodero  
 ORIGIN: OPERATIONS  
 SCALE FACTOR:  
 PLOT SCALE:  
 EXTERNAL REFERENCES:  
 FONTS USED:



# PLAN - EXISTING

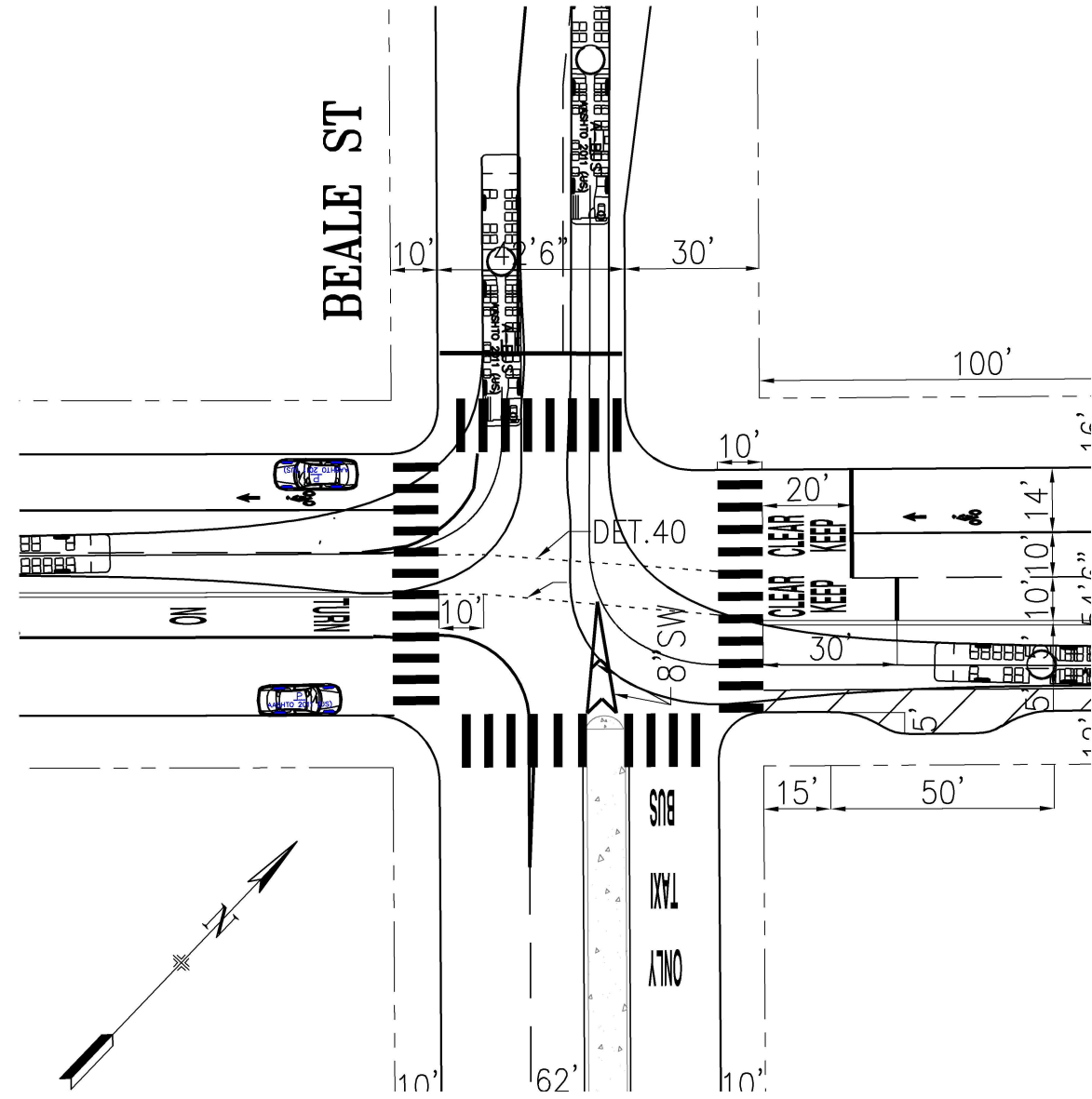

Given the proposal is for 51' of no parking, that dimension should be shown somewhere on the drawings. We're only talking about SB RTs onto Beale too so you can delete all the other turns to simplify the drawing. Lastly SFFD may want to see their templates though it can be argued that a WB-40 is larger than their engines and trucks

# PLAN - PROPOSED

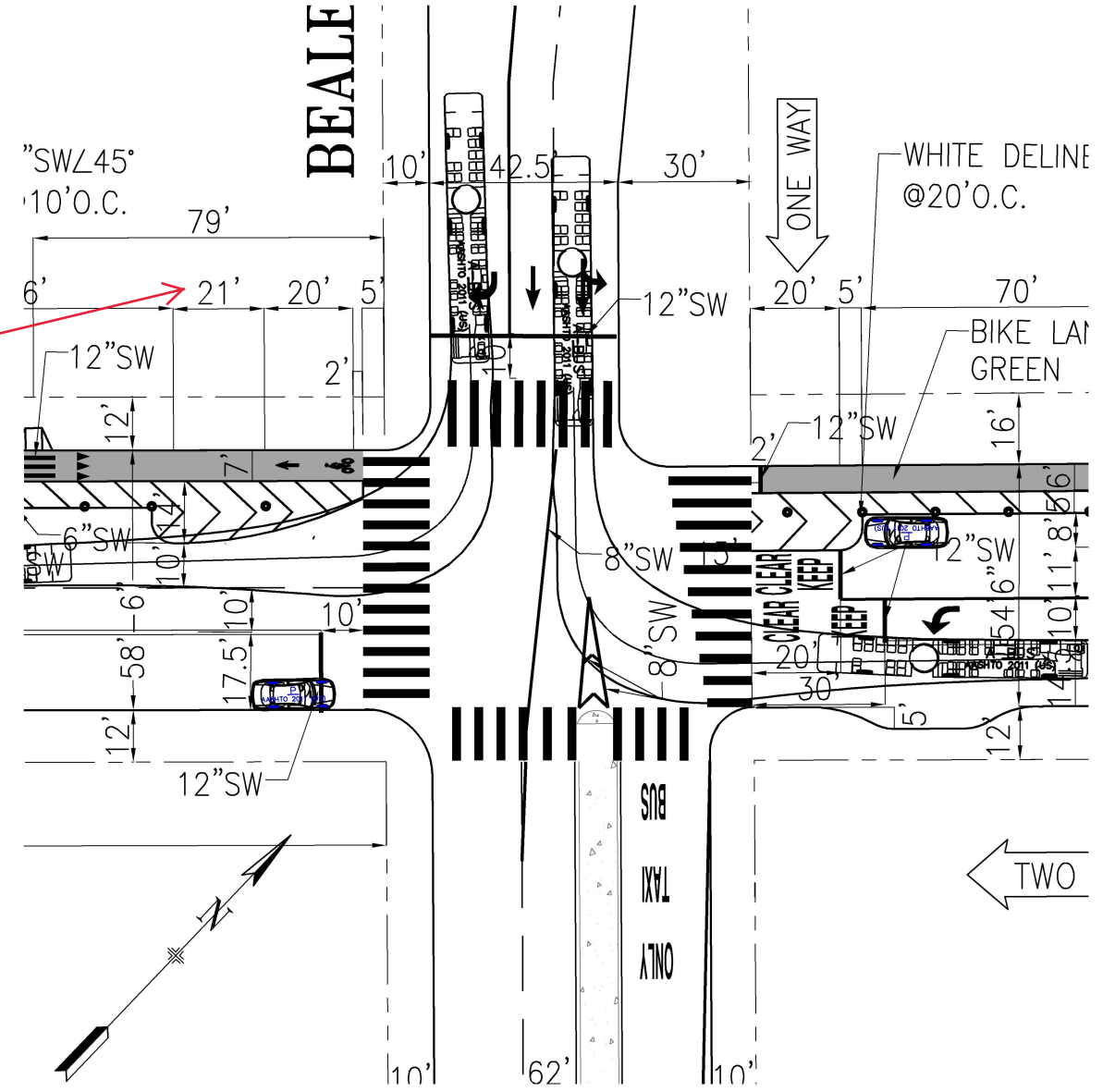

NO.	DATE	DESCRIPTION	BY	APP
TABLE OF REVISIONS				
CHECK WITH TRACING TO SEE IF YOU HAVE LATEST REVISION				



**SFMTA**



DRAWN:		DATE:		APPROVED		SCALE:	
A. KIM	2019.11.04	SENIOR ENGINEER	DATE:			1" = 20'	
CHECKED:	DATE:	CITY TRAFFIC ENGINEER	DATE:				
P. STANIS	2019.11.04			SHEET/SHEETS:		1 OF 2	

HOWARD STREET QUICKBUILD PROJECT  
 HOWARD STREET  
 DRAFT  
 EXISTING AND PROPOSED TURNING TEMPLATES  
 BUS-60 VEHICLES  
 BEALE STREET

CONTRACT NO.
DRAWING NO.
FILE NO.
REV. NO.

FILE NAME:  
DATE: --/--/---

**PLAN - EXISTING**

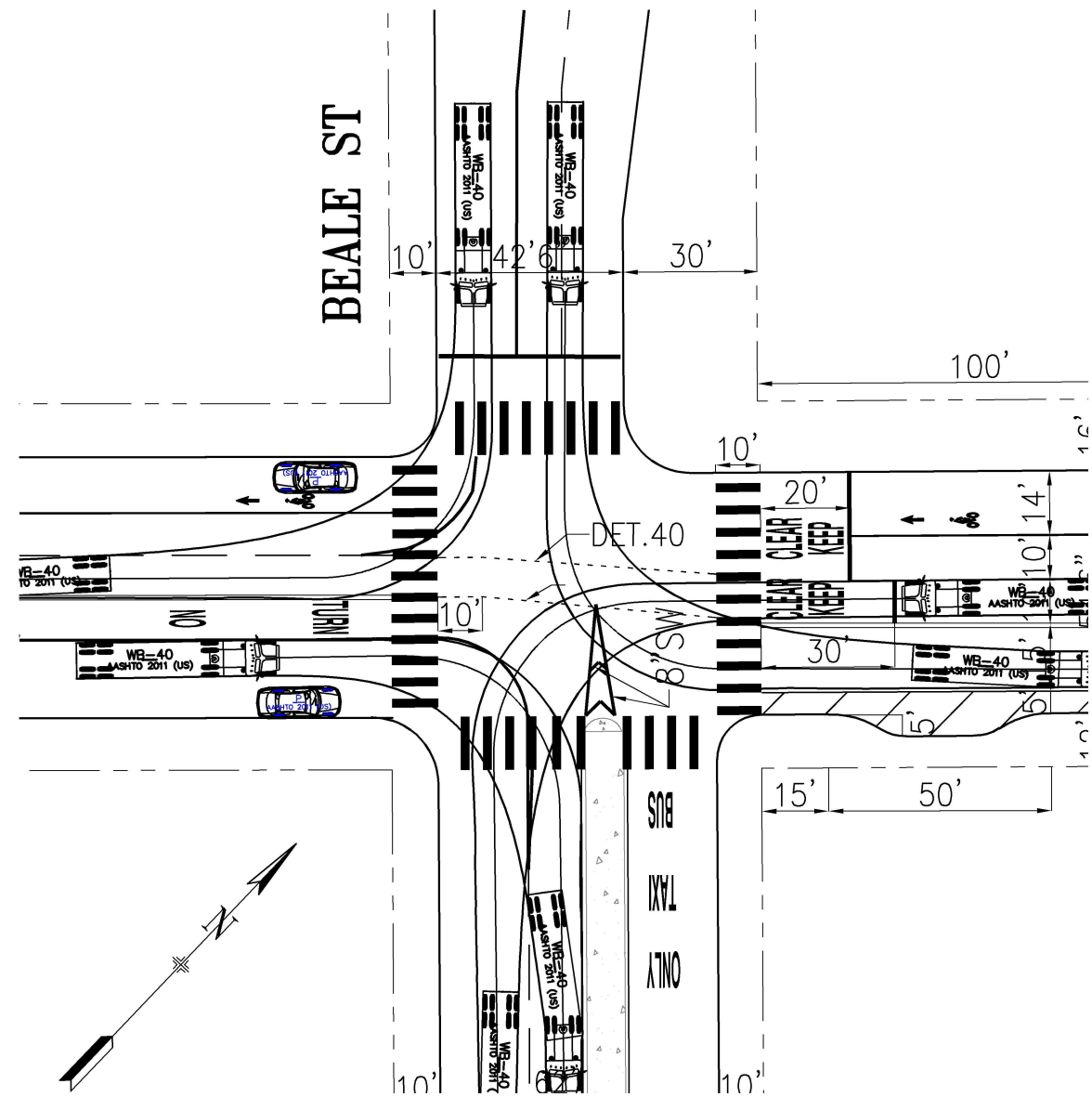

**PLAN - PROPOSED**

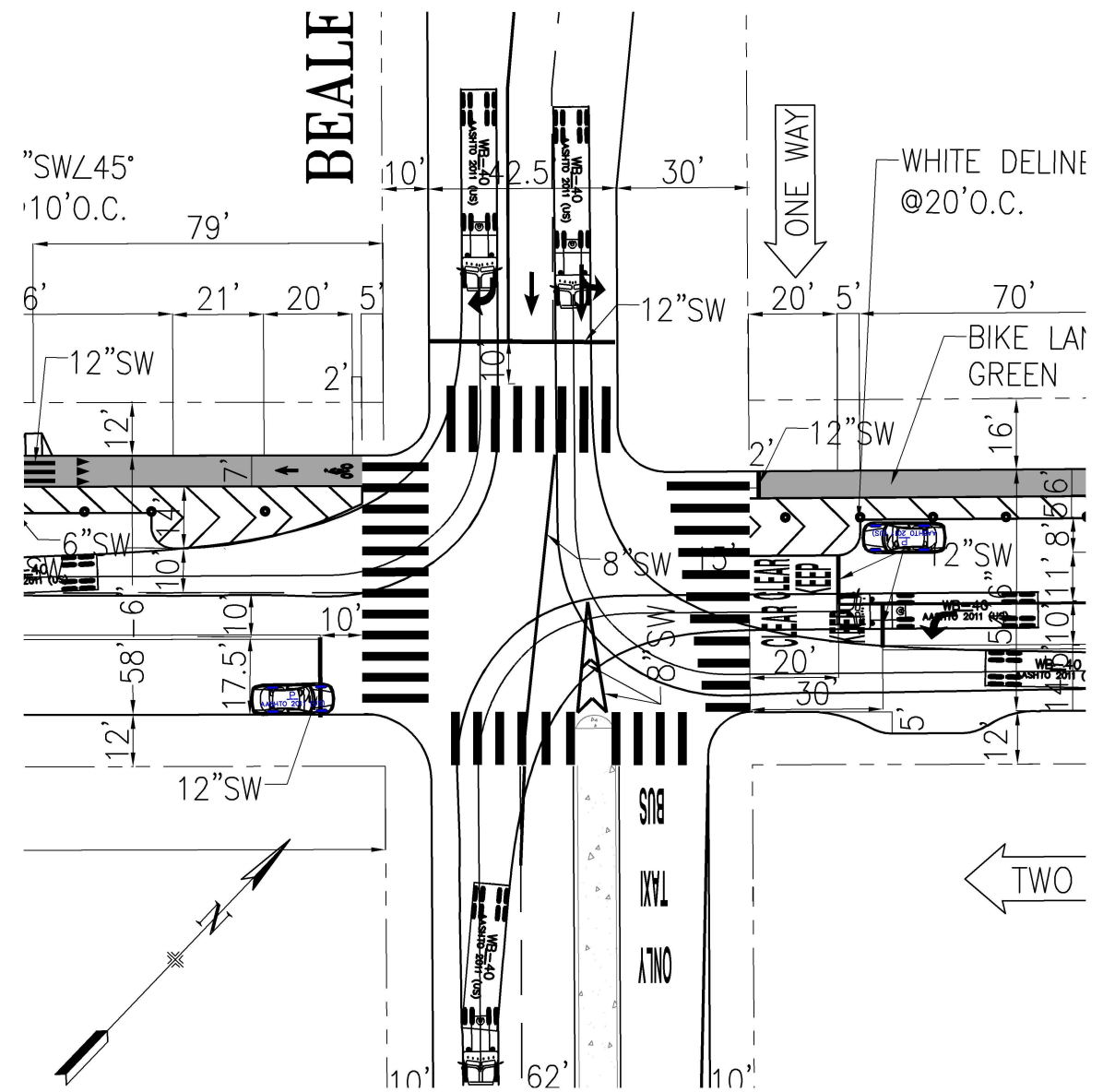

NO.	DATE	DESCRIPTION	BY	APP
TABLE OF REVISIONS				
CHECK WITH TRACING TO SEE IF YOU HAVE LATEST REVISION				



DRAWN:		DATE:		APPROVED		SCALE:	
A. KIM		2019.11.04		SENIOR ENGINEER		1" = 20'	
CHECKED:		DATE:		DATE:		SHEET/SHEETS:	
P. STANIS		2019.11.04		CITY TRAFFIC ENGINEER		2 OF 2	

**HOWARD QUICKBUILD PROJECT**  
**HOWARD STREET**  
**DRAFT**  
**EXISTING AND PROPOSED TURNING TEMPLATES**  
**WB-40**  
**BEALE STREET**

CONTRACT NO.
DRAWING NO.
FILE NO.
REV. NO.

FILE NAME: ---/---/---  
DATE: ---/---/---