

SFMTA - TASC SUMMARY SHEET

PreStaff_Date: 7/18/2023 Requested_by: SFMTA Handled: Ellen Robinson Section Head : MS <i>DRC</i> for MS 7/12/23	<input type="checkbox"/> Public Hearing Consent <input checked="" type="checkbox"/> Public Hearing Regular <input type="checkbox"/> Informational / Other <small>PH - Regular</small>	No objections: _____ Item Held: _____ Other: _____
Location: Minnesota Street, from Mariposa Street to 22nd Street		
Subject: Slow Streets Traffic Calming Treatments		
PROPOSAL / REQUEST: ESTABLISH - DO NOT ENTER, EXCEPT BIKES Minnesota Street, northbound at 19th Street ESTABLISH - NO LEFT TURN, EXCEPT BIKES 19th Street, eastbound, at Minnesota Street ESTABLISH - NO RIGHT TURN, EXCEPT BIKES 19th Street, westbound, at Minnesota Street ESTABLISH - TRAFFIC ISLAND Minnesota Street, midblock, between 20th Street and 22nd Street ESTABLISH - RED ZONE 414 feet to 449 feet Minnesota Street, west side, from 409 feet to 429 feet south of 20th Street Minnesota Street, east side, from 19th Street to 25 feet northerly (District 10) Adds vehicle diversion and traffic calming treatments to the existing Minnesota Slow Street to reduce traffic speeds and volumes on the corridor. Ellen Robinson ellen.robinson@sfmta.com		
BACKGROUND INFORMATION / COMMENTS This proposal adds vehicle diversion and traffic calming treatments to the Minnesota Slow Street, to reduce traffic volumes and speeds to the Slow Streets Program targets of 1000 vehicles per day and 15 mph median speed. Minnesota Street from Mariposa Street to 22nd Street is an existing Slow Street with Slow Streets delineators at the 18th, 19th, 20th and 22nd Street intersections. Do Not Enter northbound at 19th Street would be supplemented by concrete islands, paint and delineators. A new Painted Safety Zone would be installed in the existing red zones at the southwest corner of Minnesota and 19th Streets. A new traffic calming island would be installed midblock between 20th and 22nd streets, where neighbors had previously placed a planter box. Additionally, Slow Streets pavement markings, ID and wayfinding signs, and advisory 15 mph signs would be installed along the corridor. Speed limit: 25 mph Weekday Traffic Volumes: 1580 vehicles (18th to 19th St.), 510 vehicles (20th to 22nd street) Median Traffic Speeds: 19 mph (18th to 19th street), 12 mph (20th to 22nd St.) Grades: 0.6% to 5.4%		
HEARING NOTIFICATION AND PROCESSING NOTES:	ENVIRONMENTAL CLEARANCE BY: <input type="checkbox"/> SFMTA <input checked="" type="checkbox"/> Attached <input type="checkbox"/> Pending	
CHECK IF PREPARING SEPARATE SFMTA BOARD CALENDAR ITEM FOR PROPOSAL: <input type="checkbox"/>		

Existing Traffic Striping

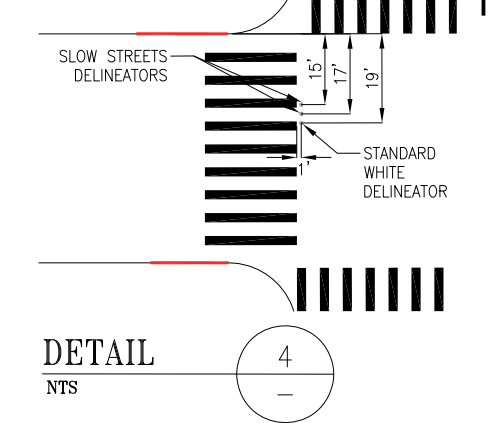
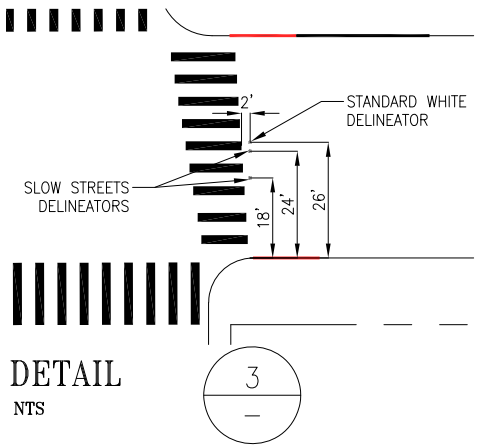
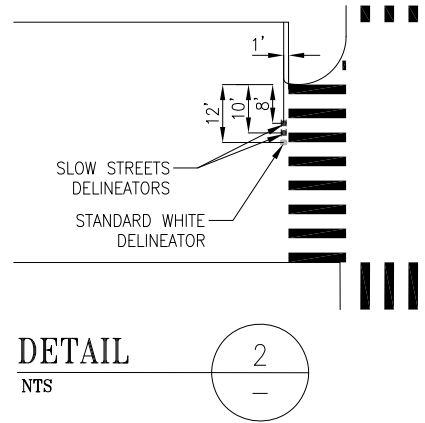
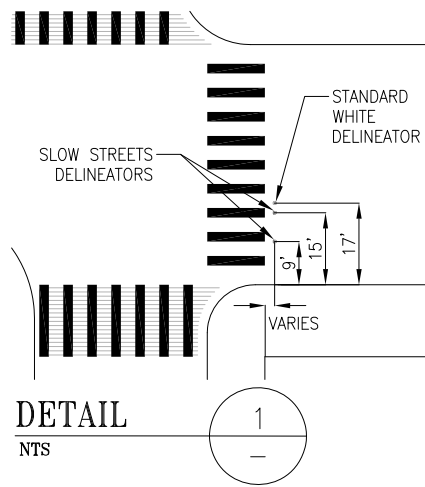
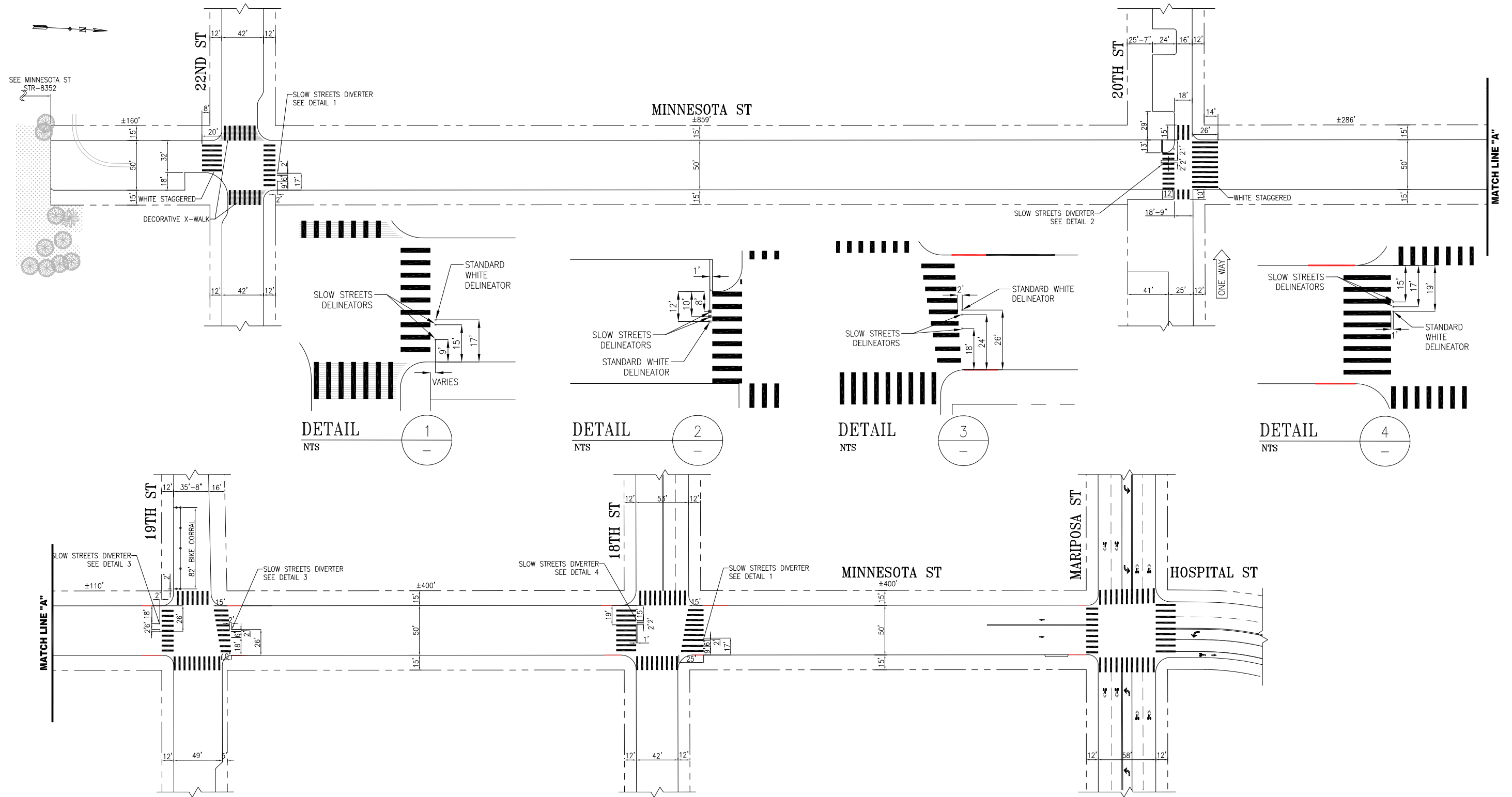

NO.	DATE	DESCRIPTION	BY	APP

TABLE OF REVISIONS
CHECK WITH TRACING TO SEE IF YOU HAVE LATEST REVISION



DRAWN: X.XXXXXX	DATE: XX/XX/XX	SENIOR ENGINEER	DATE:
CHECKED: X.XXXXXX	DATE: XX/XX/XX	CITY TRAFFIC ENGINEER	DATE:

APPROVED	SCALE: 1" = 50'
SHEET/SHEETS:	

TRAFFIC STRIPING
MINNESOTA STREET
22ND STREET TO MARIPOSA STREET

CONTRACT NO.	
DRAWING NO.	STR-8352.1
FILE NO.	
REV. NO.	0

FILE NAME:
DATE: --/--/---

Proposed Traffic Striping

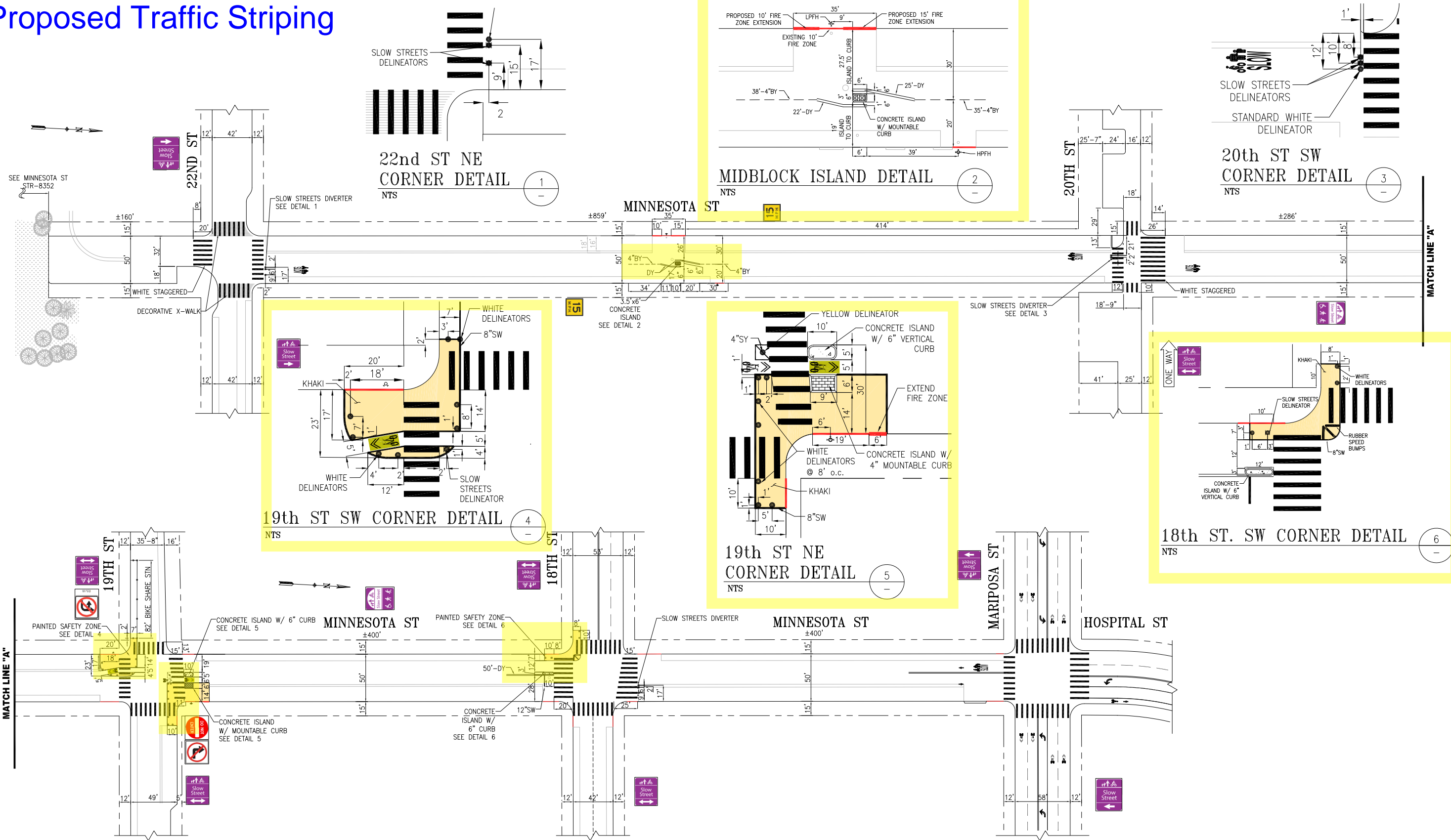

NO.	DATE	DESCRIPTION	BY	APP

TABLE OF REVISIONS
CHECK WITH TRACING TO SEE IF YOU HAVE LATEST REVISION



DRAWN: X.XXXXXXX	DATE: XX/XX/XX	APPROVED SENIOR ENGINEER	DATE:
CHECKED: X.XXXXXXX	DATE: XX/XX/XX	CITY TRAFFIC ENGINEER	DATE:

SCALE: 1" = 50'	CONTRACT NO.
SHEET/SHEETS:	DRAWING NO. STR-8352.1
TRAFFIC STRIPING	
MINNESOTA STREET 22ND STREET TO MARIPOSA STREET	
	FILE NO.
	REV. NO. 0

FILE NAME: ---
DATE: ---

Slow Streets

Adopted Network

May 2023

LEGEND

Existing Bike Network

Protected Bikeways

Adopted Slow Streets

Implemented Slow Streets

Planned Slow Streets

Other Related Projects

Proposed Sunset Neighborways

Bayview Multimodal Community Corridor

Tenderloin Traffic Safety Improvements

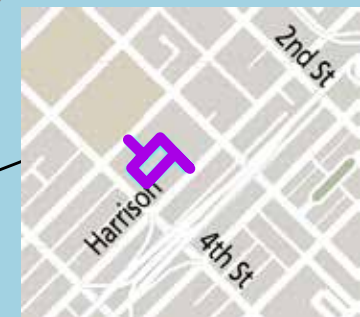

Lapu-Lapu, Rizal, Tandang Sora, Bonifacio, and Mabini streets

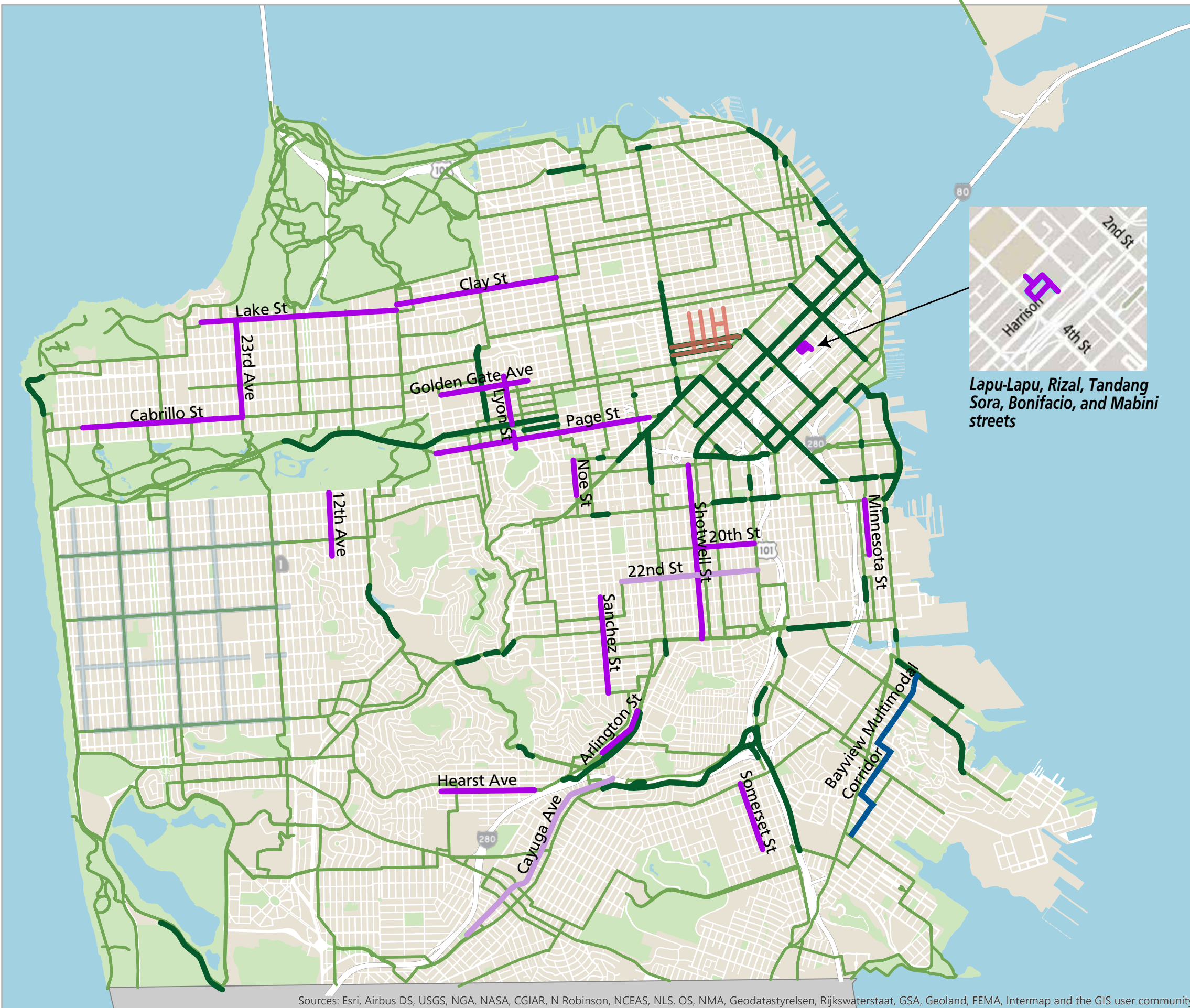

1 miles

Scale 1:51,315

By downloading this map, you are agreeing to the following disclaimer: "The City and County of San Francisco ("City") provides the following data as a public record and no rights of any kind are granted to any person by the City's provision of this data. The City and County of San Francisco ("City") makes no representation regarding and does not guarantee or otherwise warrant the accuracy or completeness of this data. Anyone who uses this data for any purpose whatsoever does so entirely at their own risk. The City shall not be liable or otherwise responsible for any loss, harm, claim or action of any kind from any person arising from the use of this data. By accessing this data, the person accessing it acknowledges that she or he has read and does so under the condition that she or he agrees to the contents and terms of this disclaimer."



Sources: Esri, Airbus DS, USGS, NGA, NASA, CGIAR, N Robinson, NCEAS, NLS, OS, NMA, Geodastystyrelsen, Rijkswaterstaat, GSA, Geoland, FEMA, Intermap and the GIS user community

SFFD Ladder Truck Left Turns

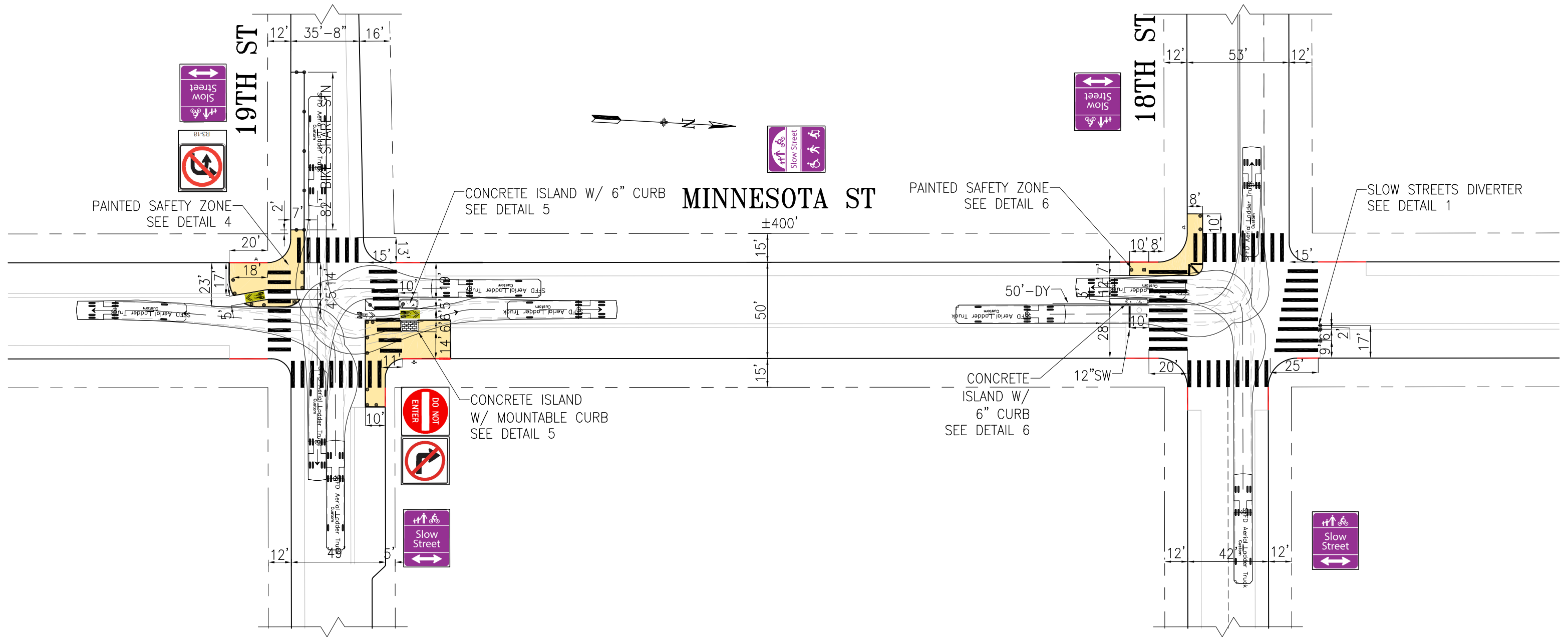

SFFD Ladder Truck Right Turns & Southbound Through

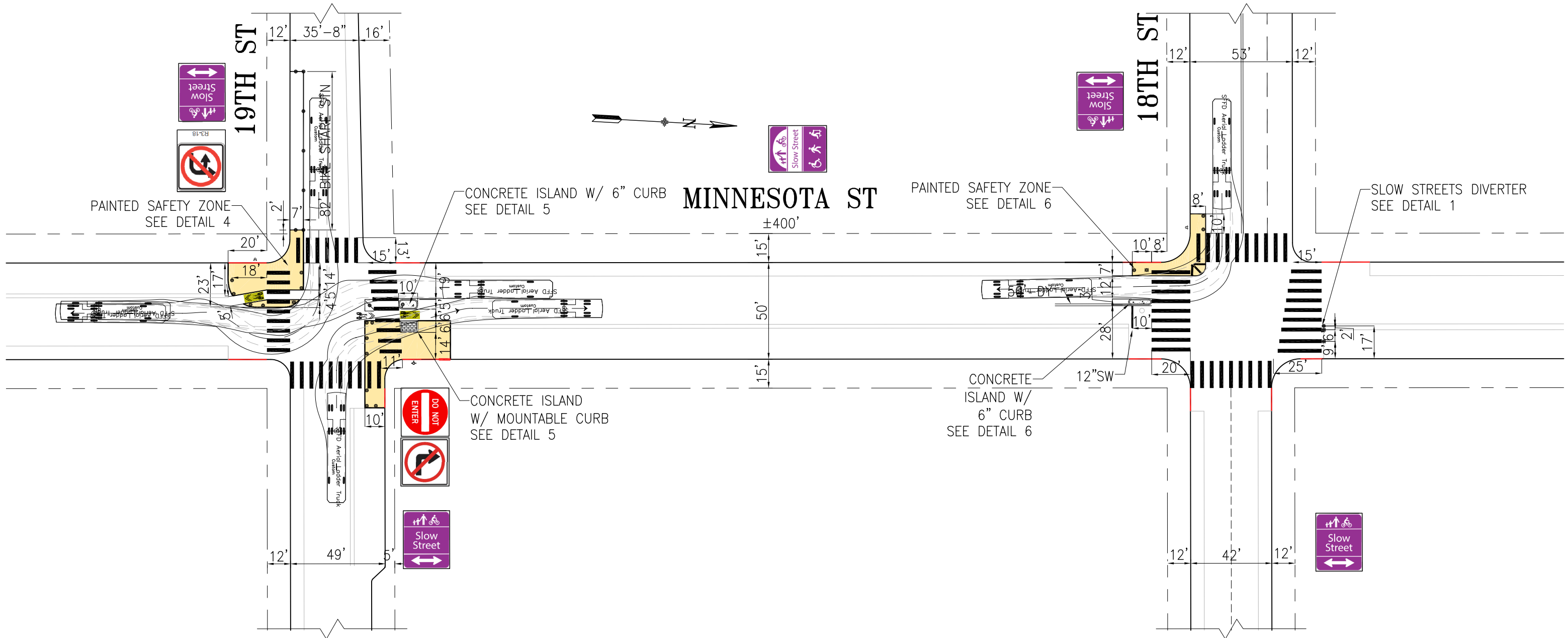

SFFD Engine at Proposed Midblock Island

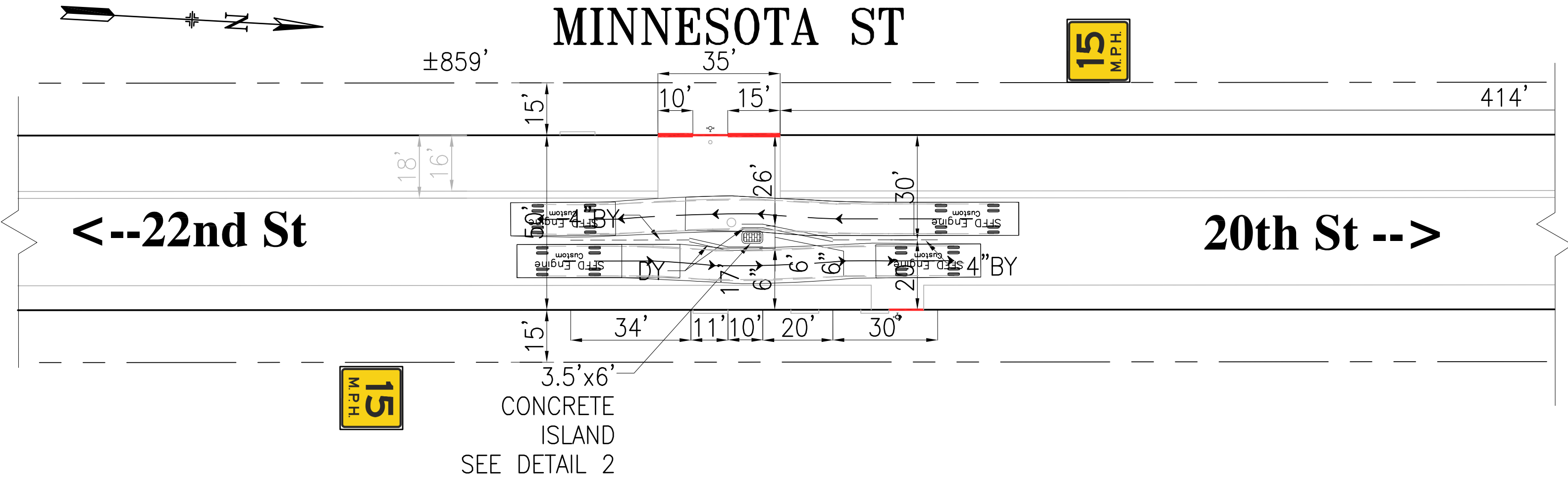

Photos (April 2023)



Minnesota Street at 18th Street, looking northeast



Minnesota Street at 19th Street, north side looking east



Minnesota Street at 19th Street, looking south

Location/Site: 16046209 - 4a Minnesota Street between 18th Street and 19th Street
 Data Collector (Name): Quality Counts

DATA COLLECTION INFORMATION

Site Characteristics		
FOR DATA COLLECTOR TO COMPLETE		
Location (primary street name)	Minnesota Street	
Between (minor street name)	18th Street	
And (minor street name)	19th Street	
Direction 1	Northbound	
Direction 2	Southbound	
CNN		
Time Period(s)	24 hrs	
Date Range (incl. days of week)		
Date Day 1 (date)	1/25/2023	Wednesday
Date Day 2 (date)	1/26/2023	Thursday
Date Day 3 (date)		

* Data wrapping present, see data page for details

Location Coordinates		
Latitude / Longitude Location of Tube	37.7623550000	37.762355, -122.390658

VEHICLE VOLUME AND SPEED SUMMARY

Select Time Group	
Time Group:	Total Day
<i>Use drop down menu</i>	

Traffic Direction - N/W

Volume and Speed Data										
Time Period		Vehicle Counts					Vehicle Speed			
Traffic Direction 1	Date	Volume	% Vol w/out Speed	% Vol Exceed 20 mph	% Vol Exceed 30 mph	% Vol Exceed 40 mph	Mean	1 STDev	Median Speed	85th Percentile
Northbound	1/25/2023	824	1.7%	40.4%	0.6%	0.0%	18	5	18	22
Northbound	1/26/2023	696	2.7%	45.9%	1.2%	0.0%	19	5	19	23
Northbound	1/0/1900	0	#DIV/0!	#DIV/0!	#DIV/0!	#DIV/0!	#DIV/0!	#DIV/0!	#DIV/0!	#DIV/0!
Summary (Average over # of days)		760	2%	43%	1%	0%	19	5	19	23

Traffic Direction - S/E

Volume and Speed Data										
Time Period		Vehicle Counts					Vehicle Speed			
Traffic Direction 2	Date	Volume	% Vol w/out Speed	% Vol Exceed 20 mph	% Vol Exceed 30 mph	% Vol Exceed 40 mph	Mean	1 STDev	Median Speed	85th Percentile
Southbound	1/25/2023	886	2.3%	45.5%	0.9%	0.0%	18	5	18	23
Southbound	1/26/2023	749	1.1%	47.4%	1.1%	0.1%	19	5	19	23
Southbound	1/0/1900	0	#DIV/0!	#DIV/0!	#DIV/0!	#DIV/0!	#DIV/0!	#DIV/0!	#DIV/0!	#DIV/0!
Summary (Average over # of days)		818	2%	46%	1%	0%	19	5	19	23

Location/Site: 16046210 - 4b Minnesota Street between 22nd Street and 20th Street
 Data Collector (Name): Quality Counts

DATA COLLECTION INFORMATION

Site Characteristics		
FOR DATA COLLECTOR TO COMPLETE		
Location (primary street name)	Minnesota St	
Between (minor street name)	22nd St	
And (minor street name)	20th St	
Direction 1	Northbound	
Direction 2	Southbound	
CNN		
Time Period(s)	48 hrs	
Date Range (incl. days of week)		
Date Day 1 (date)	1/11/2023	Wednesday
Date Day 2 (date)	1/12/2023	Thursday
Date Day 3 (date)		

Location Coordinates		
Latitude / Longitude Location of Tube	37.7592300000	-122.3903490000

VEHICLE VOLUME AND SPEED SUMMARY

Select Time Group	
Time Group:	Total Day
<i>Use drop down menu</i>	

Traffic Direction - N/W

Volume and Speed Data										
Time Period		Vehicle Counts					Vehicle Speed			
Traffic Direction 1	Date	Volume	% Vol w/out Speed	% Vol Exceed 20 mph	% Vol Exceed 30 mph	% Vol Exceed 40 mph	Mean	1 STDev	Median Speed	85th Percentile
Northbound	1/11/2023	298	8.7%	4.0%	0.4%	0.0%	12	4	12	16
Northbound	1/12/2023	277	7.2%	5.8%	0.0%	0.0%	12	4	11	16
Northbound	1/0/1900	0	#DIV/0!	#DIV/0!	#DIV/0!	#DIV/0!	#DIV/0!	#DIV/0!	#DIV/0!	#DIV/0!
Summary (Average over # of days)		288	8%	5%	0%	0%	12	4	12	16

Traffic Direction - S/E

Volume and Speed Data										
Time Period		Vehicle Counts					Vehicle Speed			
Traffic Direction 2	Date	ADT	% count w/out Speed	Exceed 20 mph	Exceed 30 mph	Exceed 40 mph	Mean Speed	1 STDev	Median Speed	85th Percentile
Southbound	1/11/2023	321	7.2%	3.7%	0.3%	0.0%	12	4	11	15
Southbound	1/12/2023	322	5.6%	7.2%	0.0%	0.0%	13	4	12	17
Southbound	1/0/1900	0	#DIV/0!	#DIV/0!	#DIV/0!	#DIV/0!	#DIV/0!	#DIV/0!	#DIV/0!	#DIV/0!
Summary (Average over # of days)		322	6%	5%	0%	0%	13	4	12	16

Redrawn & Revised, February 1967, S.J.

Checked: April, 1968, W.E.C.

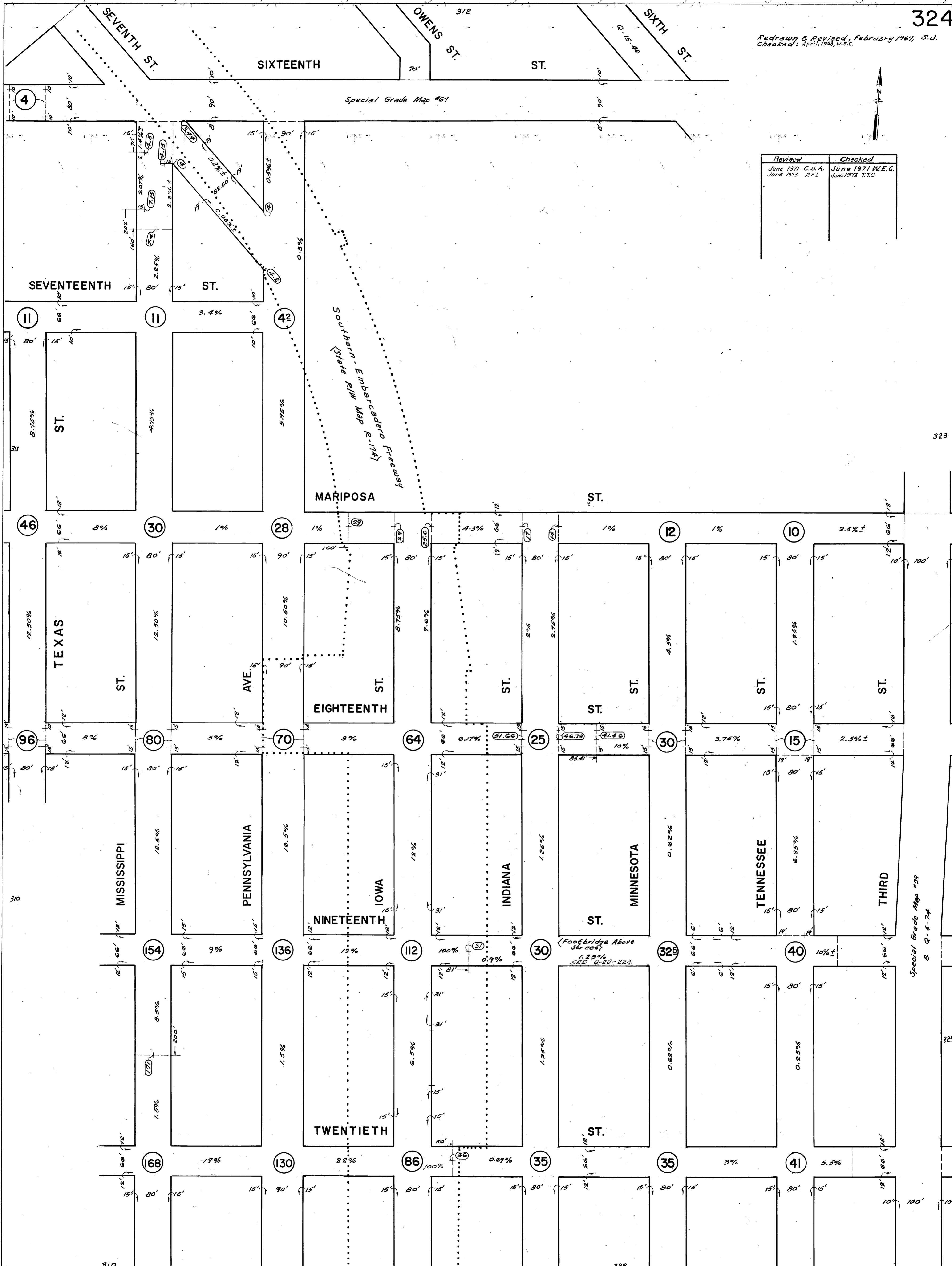
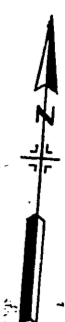

Special Grade Map #67

Southern Embarcadero Freeway
State R/W Map R-1747

Revised		Checked	
June 1971	C.D.A.	June 1971	W.E.C.
June 1973	R.F.L.	June 1973	T.T.C.

323

Special Grade Map #59
& G-5-74

325

310

326

TransBASE Internal Dashboard

Geographic Extent: MINNESOTA ST from 04TH ST/MARIPOSA ST to 22ND ST (0.44 miles/2327.86 feet)

Spatial Intersect: No Restriction (SFMTA 20ft/150ft Buffer)

Data Range: 04/01/2018 to 03/31/2023

Pull Date: 5/24/2023

Geographic Extent

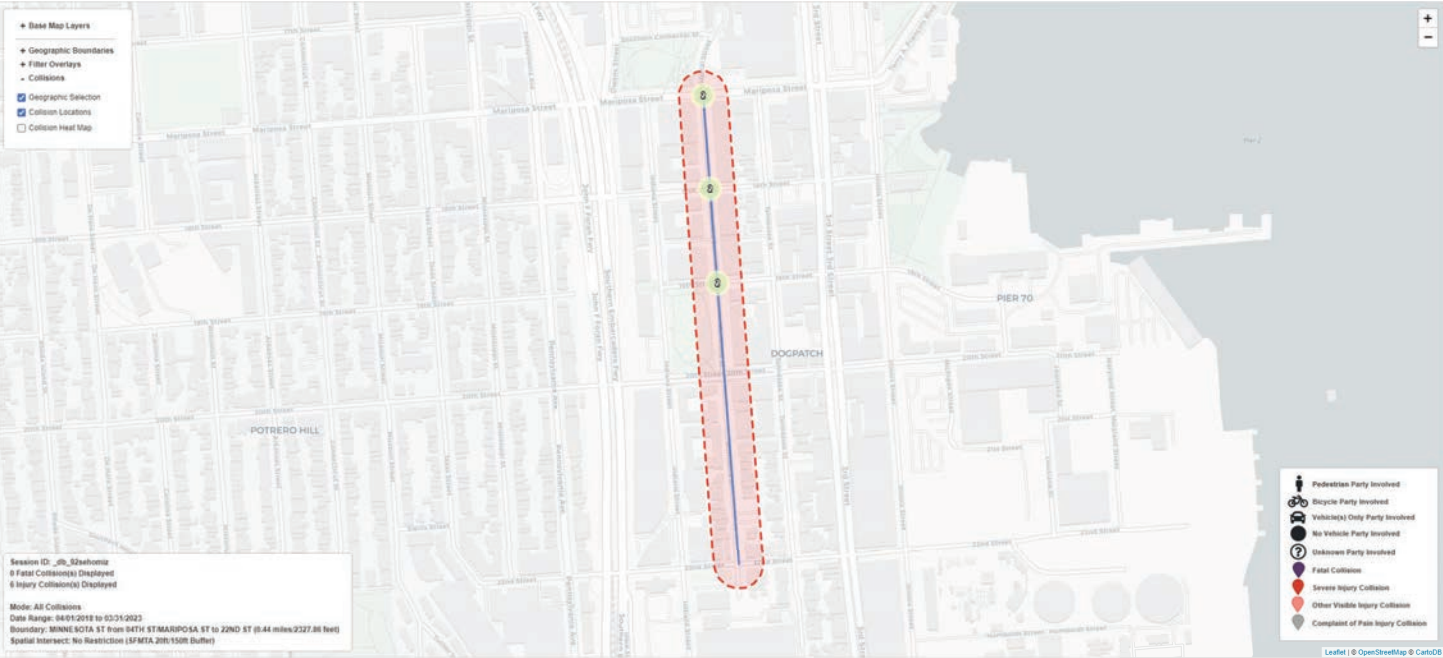

TransBASE Internal Dashboard

Geographic Extent: MINNESOTA ST from 04TH ST/MARIPOSA ST to 22ND ST (0.44 miles/2327.86 feet)

Spatial Intersect: No Restriction (SFMTA 20ft/150ft Buffer)

Data Range: 04/01/2018 to 03/31/2023

Pull Date: 5/24/2023

Collision/Party/Victim Table

Showing 1 to 6 of 6 entries

Count of Fatal Collisions: 0

Count of Non-Fatal Injury Collisions: 6

Total Count of Fatal/Non-Fatal Injury Collisions: 6

Case ID	Collision Date	Collision Time	Day of Week	Primary Road	Secondary Road	Distance	Direction	Party 1 Type	Party 1 Direction of Travel	Party 1 Movement Preceding Crash	Party 2 Type	Party 2 Direction of Travel	Party 2 Movement Preceding Crash	Vehicle Code Violation	Highest Degree of Injury	Type of Collision	Motor Vehicle Involved With	Hit and Run	Road Surface	Road Condition	Lighting
210556203	08/30/2021	10:29	Monday	MINNESOTA ST	19TH ST	0	Not Stated	Driver	South	Not Stated	Driver	South	Proceeding Straight	CVC Unknown	Injury (Complaint of Pain)	Rear End	Other Motor Vehicle	Felony	Dry	No Unusual Condition/ Not Stated	Daylight
200784254	12/29/2020	06:50	Tuesday	MARIPOSA ST	MINNESOTA ST	0	Not Stated	Driver	West	Making Left Turn	Pedestrian	North	Not Stated	CVC 21950(a)	Injury (Other Visible)	Vehicle/ Pedestrian	Pedestrian	No	Dry	No Unusual Condition/ Not Stated	Dark - Street Lights
190434793	06/17/2019	06:52	Monday	MINNESOTA ST	18TH ST	0	Not Stated	Other	South	Proceeding Straight	Driver	North	Making Left Turn	CVC 22450(a)	Injury (Other Visible)	Head-On	Other Motor Vehicle	No	Dry	No Unusual Condition/ Not Stated	Daylight
180953747	12/19/2018	11:00	Wednesday	MINNESOTA ST	MARIPOSA ST	0	Not Stated	Bicyclist	South	Proceeding Straight				CVC Other than driver	Injury (Complaint of Pain)	Not Stated	Not Stated	No	Dry	No Unusual Condition/ Not Stated	Daylight
180950414	12/18/2018	07:01	Tuesday	MINNESOTA ST	19TH ST	0	Not Stated	Driver	South	Making Left Turn	Pedestrian	East	Proceeding Straight	CVC 21950(a)	Injury (Complaint of Pain)	Vehicle/ Pedestrian	Pedestrian	No	Dry	No Unusual Condition/ Not Stated	Daylight
180478290	06/26/2018	19:00	Tuesday	18TH ST	MINNESOTA ST	0	Not Stated	Driver	West	Making Right Turn	Pedestrian	South	Proceeding Straight	CVC 22450(a)	Injury (Severe)	Vehicle/ Pedestrian	Pedestrian	No	Dry	No Unusual Condition/ Not Stated	Daylight

TransBASE Internal Dashboard

Geographic Extent: MINNESOTA ST from 04TH ST/MARIPOSA ST to 22ND ST (0.44 miles/2327.86 feet)

Spatial Intersect: No Restriction (SFMTA 20ft/150ft Buffer)

Data Range: 04/01/2018 to 03/31/2023

Pull Date: 5/24/2023

Metadata Information

Collision Filters

Database Source: TransBASESF.org
Database Pull Date: 5/24/2023
Collision Level: Injury Collisions
Boundary: MINNESOTA ST from 04TH ST/ MARIPOSA ST to 22ND ST (0.44 miles/2327.86 feet)
Collision Dates: 04/01/2018 to 03/31/2023
Collision Month Filter(s): No Restrictions
Collision Distance: Any Distance
Collision Severity Filter(s): No Restrictions
Primary Collision Factor Filter(s): No Restrictions
Collision Type Filter(s): No Restrictions
Intersection/Midblock: No Restriction (SFMTA 20ft/150ft Buffer)

Party Filters

Party Involved Type: No Restrictions
Party Involved Gender: No Restrictions
Party Involved at Fault: No Restrictions
Party Involved Age: No Restriction
Party Involved Sobriety: No Restrictions
Party Involved Condition: No Restrictions
Party Involved Direction of Travel: No Restrictions
Party Involved Safety Equipment 1: No Restrictions
Party Involved Safety Equipment 2: No Restrictions
Party Involved Insurance: No Restrictions
Party Involved Other Associated Factors : No Restrictions
Party Involved Movement Preceding Collision: No Restrictions
Party Involved Vehicle Type: No Restrictions
Party Involved Race: No Restrictions
Party Involved Special Info: No Restrictions
Party Involved Autonomous Vehicle: No Restrictions

Victim Filters

Victim Involved Role: No Restrictions
Victim Involved Degree of Injury: No Restrictions
Victim Involved Age: No Restriction
Victim Involved Seating Position: No Restrictions
Victim Involved Safety Equipment: No Restrictions
Victim Involved Ejected: No Restrictions

Environmental Filters

Nearest Traffic Control: No Restriction
Intersecting Speed Limit: No Restriction
Intersecting Network: No Restriction
Intersecting Street Class: No Restriction
Weather Description: No Restrictions
Lighting Description: No Restrictions