

## SFMTA - TASC SUMMARY SHEET

<b>PreStaff_Date:</b> 12/8/2020 <b>Requested_by:</b> SFMTA <b>Handled:</b> Shahram Shariati <i>WL</i> <b>Section Head :</b> M.Sallaberry <i>MS</i>	<input type="checkbox"/> <b>Public Hearing Consent</b> <input checked="" type="checkbox"/> <b>Public Hearing Regular</b> <input type="checkbox"/> <b>Informational / Other</b> <small>PH - Regular</small>	<b>No objections:</b> _____ <b>Item Held:</b> _____ <b>Other:</b> _____
---	---	---

**Location:** Divisadero/Fulton, Divisadero/Grove, Divisadero/Page & Divisadero/Hayes

**Subject:** Parking Meters & No Turn on Red

### PROPOSAL / REQUEST:

RESCIND - YELLOW METERED LOADING ZONE (30 MIN LIMIT 8AM-6PM, MON-SAT)  
 Divisadero Street, west side, from 5 feet to 25 feet north of Page Street (meter space #301).  
 RESCIND - YELLOW METERED LOADING ZONE (30 MIN LIMIT 7AM-1PM, MON-FRI)  
 Fulton Street, south side, from 2 feet to 40 feet west of Divisadero Street (meter space #1301 & 1303).

RESCIND - GREEN METERED PARKING SPACES (30 MIN LIMIT 9AM-6PM, MON-SAT)  
 Hayes Street, north side, from 6 feet to 26 feet east of Divisadero Street (meter space #1240-G).  
 Grove Street, south side, from 2 feet to 23 feet west of Divisadero Street (meter space #1301-G).

ESTABLISH - RED ZONES  
 Divisadero Street, west side, from 5 feet to 25 feet north of Page Street.  
 Fulton Street, south side, from 2 feet to 20 feet west of Divisadero Street.  
 Hayes Street, north side, from 6 feet to 26 feet east of Divisadero Street.  
 Grove Street, south side, from 2 feet to 23 feet west of Divisadero Street.

ESTABLISH - YELLOW METERED LOADING ZONE (30 MIN LIMIT 8AM-6PM, MON-SAT)  
 Divisadero Street, west side, from 25 feet to 47 feet north of Page Street (converts general meter space #303 into a yellow metered space).  
 ESTABLISH - YELLOW METERED LOADING ZONE (30 MIN LIMIT 7AM-6PM, MON-SAT)  
 Fulton Street, south side, from 20 feet to 60 feet west of Divisadero Street (converts general meter space #1305 into a yellow metered space).

ESTABLISH - GREEN METERED PARKING SPACES (30 MIN LIMIT 9AM-6PM, MON-SAT)  
 Hayes Street, north side, from 26 feet to 48 feet east of Divisadero Street (converts general meter space #1238 into a green metered space).  
 Grove Street, south side, from 23 feet to 45 feet west of Divisadero Street (converts general meter space #1305 into a green metered space).

ESTABLISH - NO TURNS ON RED EXCEPT BICYCLES  
 Fulton Street, westbound, at Divisadero Street.  
 Fulton Street, eastbound, at Divisadero Street.  
 Grove Street, eastbound, at Divisadero Street.

(Supervisor District 5)  
 This project is designed to improve vehicle, pedestrian and bicycle safety along Divisadero between Turk and Haight.

Shahram Shariati, Shahram.Shariati@sfmta.com

### BACKGROUND INFORMATION / COMMENTS

The District 5 Supervisor provided the SFMTA with funding to improve safety along the Divisadero corridor between Turk and Haight. SFMTA already implemented PSZs, traffic signal upgrades and daylighting along the corridor which did not require legislation. Now the SFMTA is attempting to implement the remaining portions of the project that require legislation. This legislation will allow the agency to daylight the remaining portions of the corridor along with the addition of three bike boxes.

**HEARING NOTIFICATION AND PROCESSING NOTES:**

**ENVIRONMENTAL CLEARANCE BY:**

SFMTA    Attached    Pending

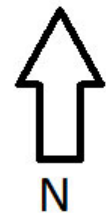
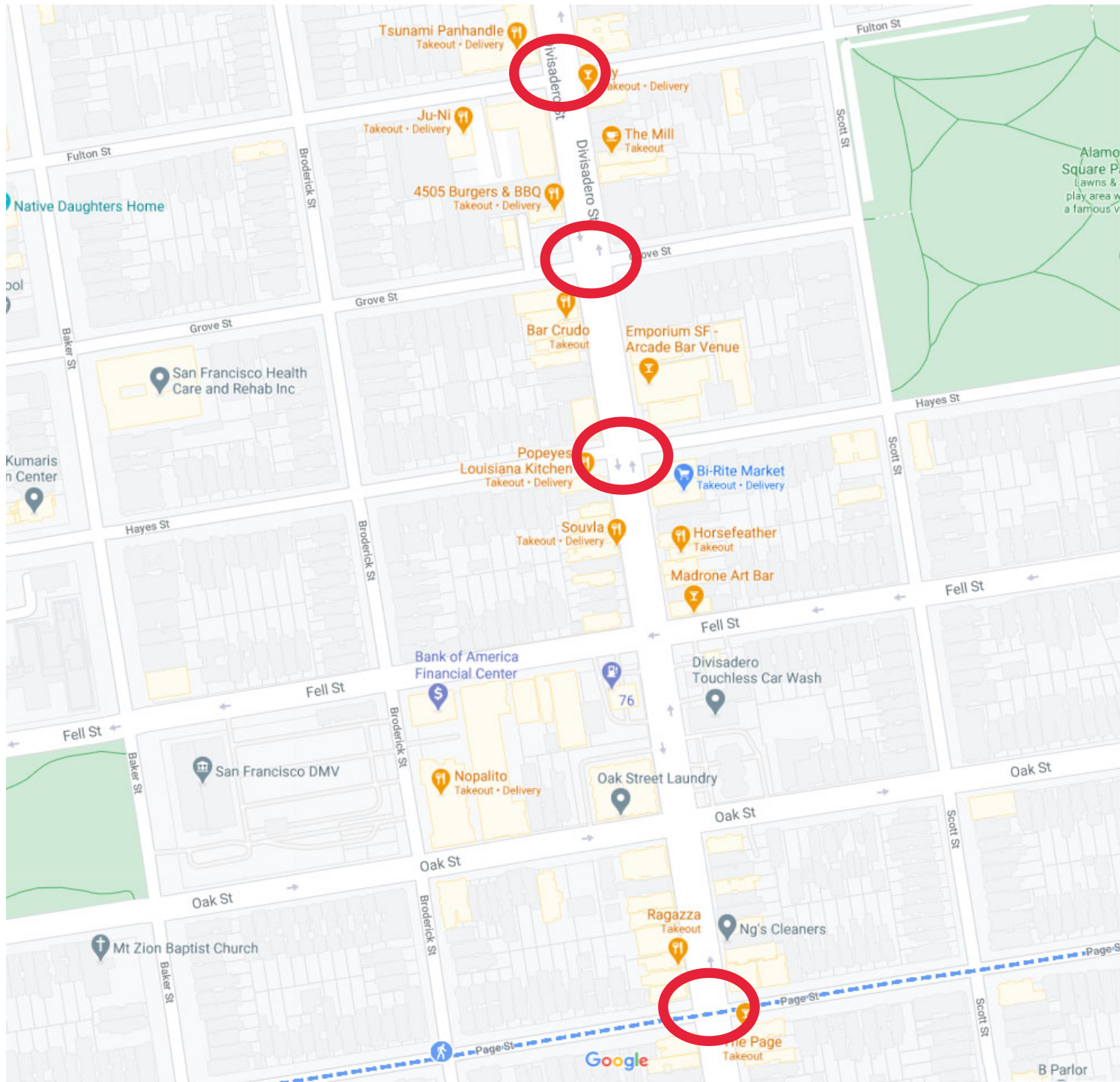

PROJECT  
LOCATION

CITY MAP



Street View - Divisadero/Fulton  
Existing Conditions





Street View - Divisadero/Fulton  
Existing Conditions



Street View - Divisadero/Grove  
Existing Conditions





Street View - Divisadero/Hayes  
Existing Conditions



Street View - Divisadero/Page  
Existing Conditions

# EXISTING CONDITIONS

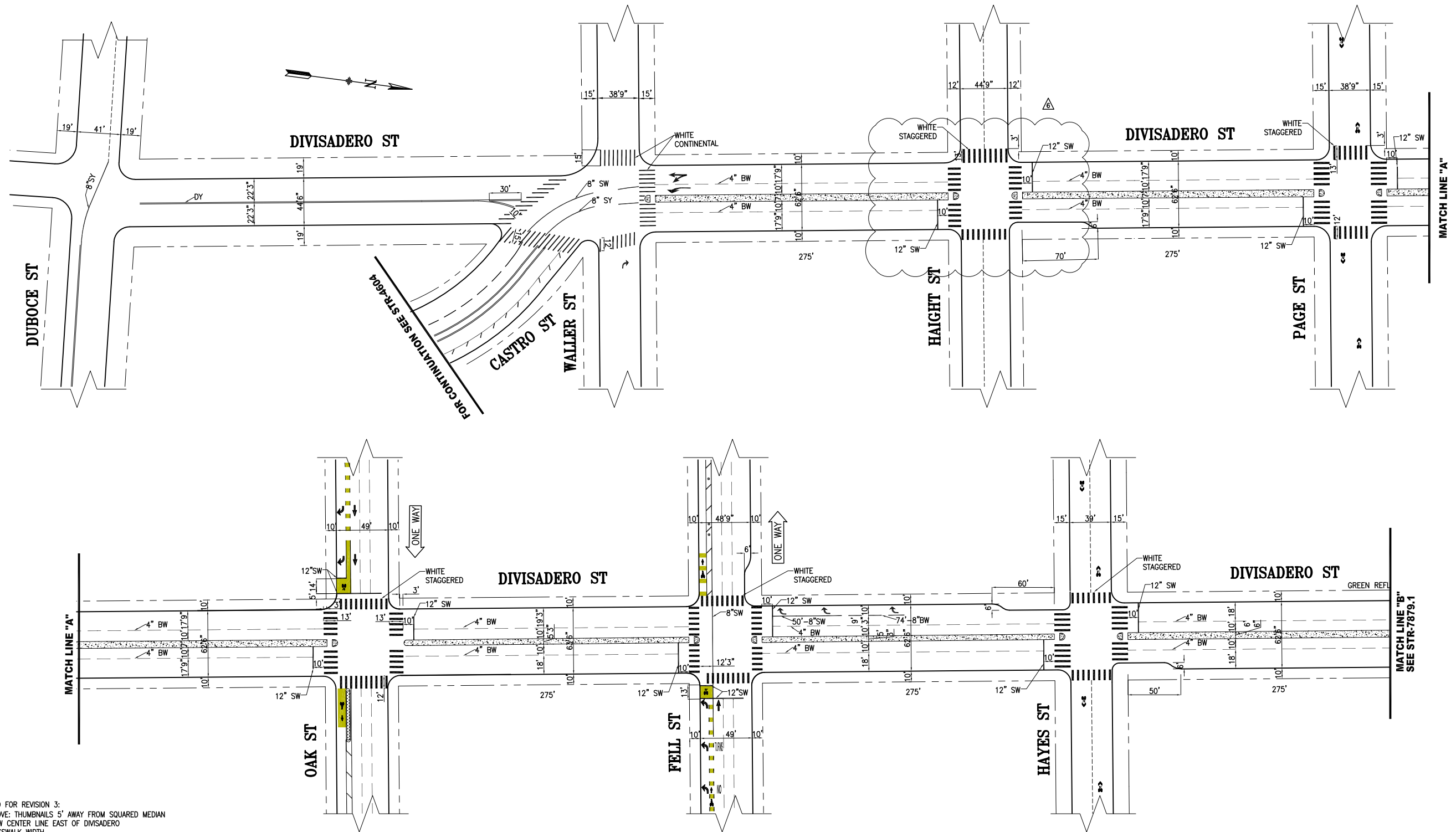

- LIST OF REVISIONS PER FIELD FOR REVISION 3:
- BETWEEN WALLER & GROVE: THUMBNAILS 5' AWAY FROM SQUARED MEDIAN
  - DUBOCE: DOUBLE YELLOW CENTER LINE EAST OF DIVISADERO
  - HAIGHT: WEST SIDE CROSSWALK WIDTH
  - PAGE: WEST AND EAST SIDE CROSSWALK WIDTHS
  - HAYES: SHARROWS

NO.	DATE	DESCRIPTION	BY	APP
1	05/17/19	ADDED ALL @ HAIGHT	S.SHARIATI	W.LEE
2	05/17/19	REDUCED LENGTH OF LEFT TURN LANE @ FELL	S.SHARIATI	M.GROWNEY
3	10/27/17	PER FIELD: UPDATED 8"SY AT DUBOCE	P.LOUIE	M.SALLABERRY
4	02/16/18	ADDED ADVANCED LANE LINES AT PAGE, OAK, & FELL	C.BECK	M.SALLABERRY
5	08/13/18	PER FIELD (10/23/17): SEE ALL CHANGES ABOVE		
6	08/13/18	FIELD CONDITION: UPDATED PER: PMGE, OAK, AND FELL ST. PROJECTS	T.ABDALLAH	B.WOO
7	09/11/12	UPDATE PER FIELD @ WALLER/DUBOCE: 8"SY, REMOVE NB ARROWS, DIM XWALK & DY	D.YEUNG	B.WOO



SUPERSEDES: STR-1567 REV17	APPROVED <b>MANITO VELASCO FOR THOMAS P. FOLKS</b> SENIOR ENGINEER DATE: 08/25/11	SCALE: 1" = 50'
DRAWN: T.ABDALLAH DATE: 06/30/11	CHECKED: M.VELASCO DATE: 06/30/11	SHEET/SHEETS: 01 OF 05

CONTRACT NO.	TRAFFIC STRIPING
DRAWING NO.	STR-7879
FILE NO.	
REV. NO.	6

FILE NAME: ---  
DATE: ---



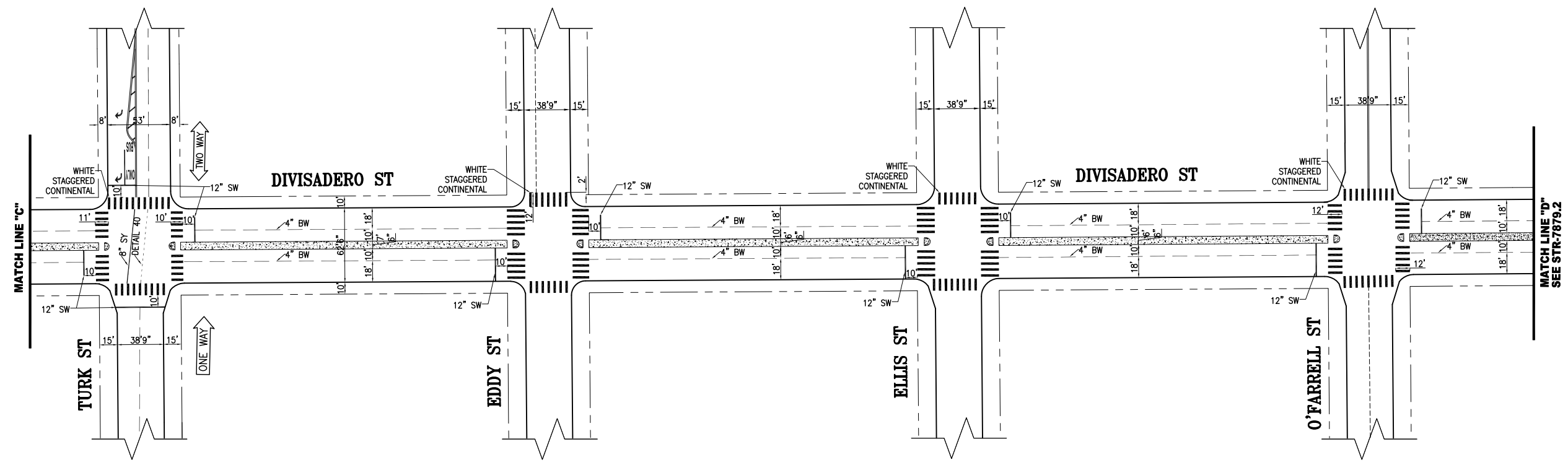
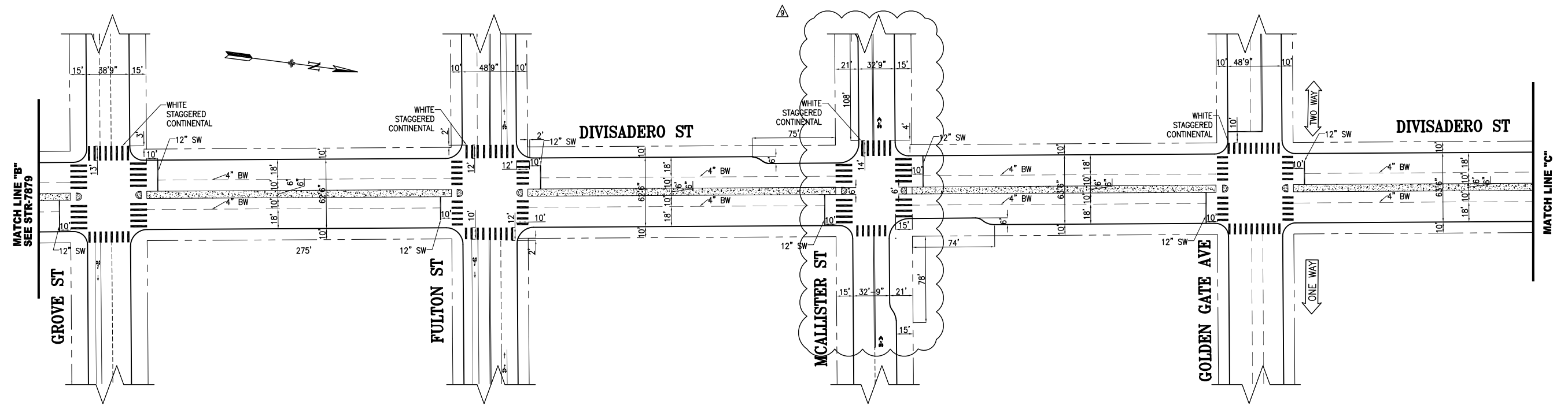

**EXISTING CONDITIONS**

- LIST OF REVISIONS PER FIELD FOR REVISION 5:
- FULTON: WEST SIDE CROSSWALK WIDTH
  - MCALLISTER: SHARROW ON WB LANE AT THE EAST SIDE OF INTERSECTION & WEST SIDE CROSSWALK WIDTH
  - EDDY: 4" BROKEN YELLOW WEST SIDE

NO.	DATE	DESCRIPTION	BY	APP
1	09/18/19	ADDED BY ON MCALLISTER EASTBOUND AND WESTBOUND	K.SHUE	M.VELASCO
2	10/16/17	PER FIELD CONDITIONS REMOVED 24" SW ADVANCED LIMIT LINE AT WB MCALLISTER	K.SHUE	M.VELASCO
3	10/16/17	ADDED EASTBOUND BULBOUT AT MCALLISTER	K.SHUE	M.VELASCO
4	04/17/18	PER FIELD CONDITIONS UPDATED BUS ONLY LANE ON TURK	K.SHUE	M.VELASCO
5	02/16/18	ADDED CONTINENTAL MARKINGS @ GROVE, EDDY, ELLIS & O'FARRELL AND ADVANCED LIMIT LINES ALONG DIVISADERO FROM GROVE TO O'FARRELL AND ON GOLDEN GATE AV AND ON TURK ST (WESTBOUND AND EASTBOUND). PER FIELD (03/23/17). SEE ALL CHANGES ABOVE	C.BECK	M.SALLABERRY

TABLE OF REVISIONS  
CHECK WITH TRACING TO SEE IF YOU HAVE LATEST REVISION



**SFMTA**



SUPERSEDES: STR-1567 REV17  
 SUPERSEDES: STR-1567.1 REV16  
 DRAWN: T.ABDALLAH  
 CHECKED: M.VELASCO  
 DATE: 06/30/11

APPROVED  
**MANITO VELASCO FOR THOMAS P. FOLKS**  
 SENIOR ENGINEER  
 DATE: 08/25/11  
 DATE: 08/26/11  
 CITY TRAFFIC ENGINEER

SCALE: 1" = 50'  
 SHEET/SHEETS: 02 OF 05

**TRAFFIC STRIPING**  
 DIVISADERO STREET  
 GROVE STREET TO O'FARRELL STREET

CONTRACT NO.  
 DRAWING NO. STR-7879.1  
 FILE NO.  
 REV. NO. 9

FILE NAME  
 DATE: --/--/---

# METER DRAWING - EXISTING CONDITIONS

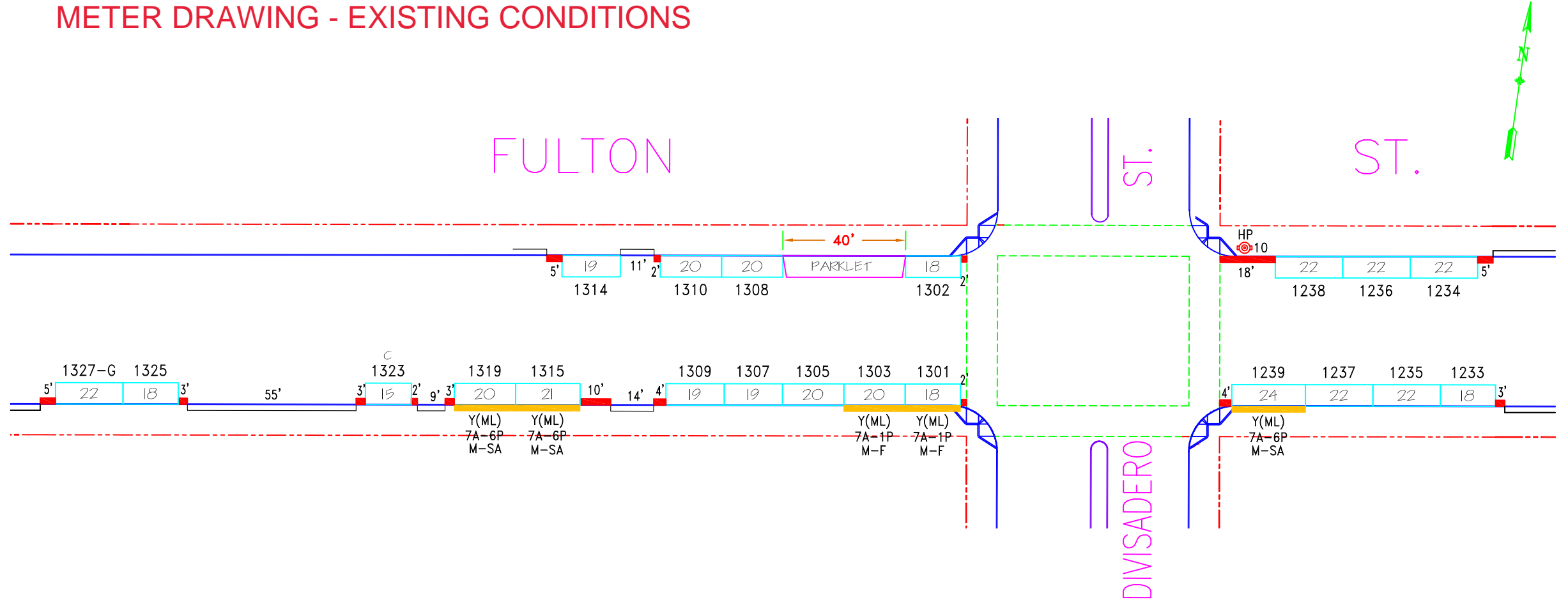

C - COMPACT CAR

NO.	REVISION DESCRIPTION	BY	DATE	DIR/RES	3	Update per field: add #1323 - S/S	JB	6/2/15
1	Per Field:MOS#1304,1306 for parklet	JB	12/13/11					
2	Change MTL to ML#1301 & #1303	JB	8/22/13					

**SAN FRANCISCO MUNICIPAL TRANSPORTATION AGENCY**  
**CITY AND COUNTY OF SAN FRANCISCO**  
 PARKING METER SPACES

SIDE	TOW-AWAY		METER CT.		GENERAL			LOADING		METERED SPACES							TOTAL
	AM	PM	SS	MS	GMP	MC	TIMES	DAYS	ML	MTL	6-W	15 MIN	30 MIN	1 HR	2 HR	10 HR	
ODD			14		9		9A-6P	M-SA	5				6		8		14
EVEN			7		7		9A-6P	M-SA							7		7

**FULTON ST. (FUL, 423)**  
**(1200-1300) BLOCK**  
 Meters #423-12XXY  
**OFF DIVISADERO ST.**

**AREA 3**

SCALE: **1"=40'**      DATE: **8/22/13**      BY: **JB**

# METER DRAWING - EXISTING CONDITIONS

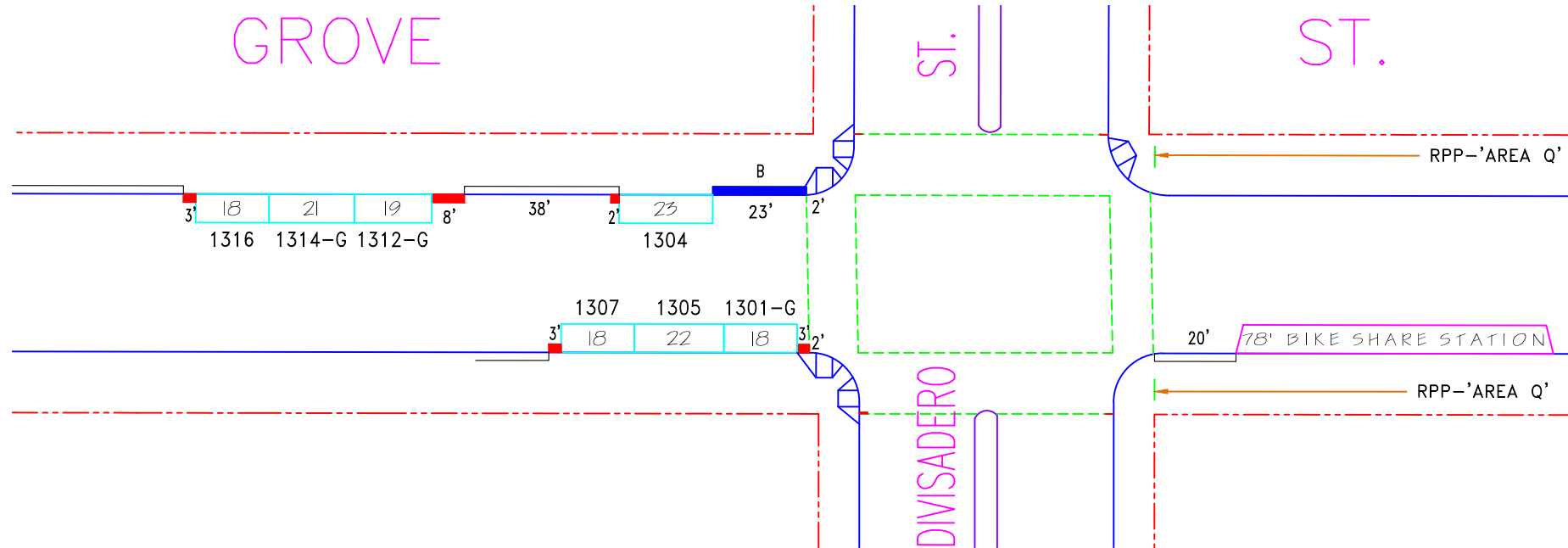

NO.	REVISION DESCRIPTION								BY	DATE	DIR/RES	METERED SPACES								
	TOW-AWAY	AM	PM	SS	MS	GMP	MC	TIMES				DAYS	ML	MTL	6-W	15 MIN	30 MIN	1 HR	2 HR	10 HR
1	Est. Green meter#1312,1314 - N/S								JB	12/8/16	5661									
2	Est. Bike Station-East of Divisadero								JB	8/26/17	5683									
SIDE	AM	PM	SS	MS	GMP	MC	TIMES	DAYS	ML	MTL	6-W	15 MIN	30 MIN	1 HR	2 HR	10 HR		TOTAL		
ODD			3		3		9A-6P	M-SA					1		2			3		
EVEN			4		4		9A-6P	M-SA					2		2			4		



SAN FRANCISCO MUNICIPAL TRANSPORTATION AGENCY  
 CITY AND COUNTY OF SAN FRANCISCO  
 PARKING METER SPACES

**GROVE ST. (GRO, 446)**  
**(1300) BLOCK**  
 Meters #446-13XXY

OFF DIVISADERO ST.

**AREA**  
**3**

SCALE: **1"=40'**      DATE: **12/8/16**      BY: **JB**



# METER DRAWING - EXISTING CONDITIONS

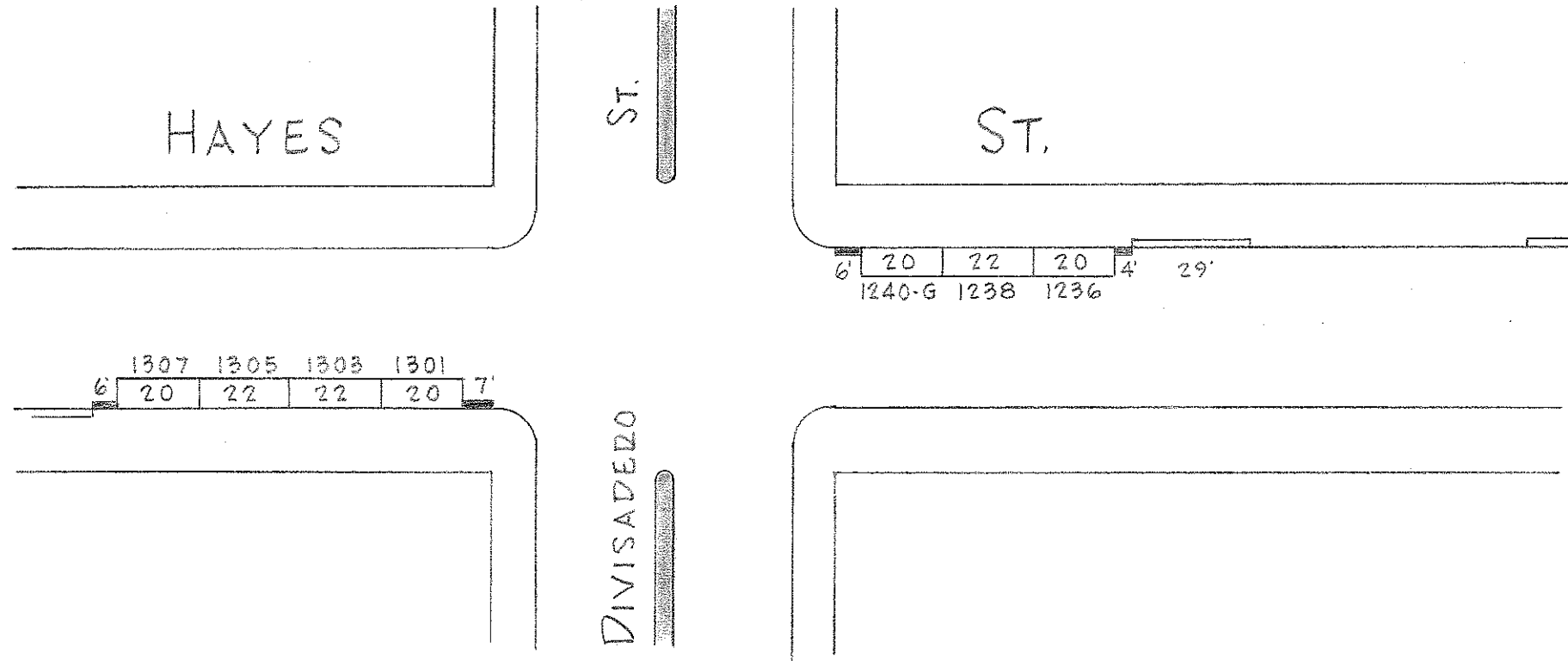

CITY AND COUNTY OF SAN FRANCISCO - D. P. W.  
**PARKING METER SPACES**

TOWAWAY ZONE				REGULAR					SPECIAL TRUCK LOAD			NUMBER OF METERED SPACES				
HOUR	7A-9A	4P-6P	7A-6P	7A-4P	7A-6P	9A-4P	9A-6P	TOTAL	1P-4P	1P-6P	TOTAL	15 Min.	30 Min.	1 Hour	2 Hour	TOTAL
SIDE							7	7					1	6		7

SCALE  
 40  
 HF  
 2-27-73

HAYES ST. (1200-1300)  
 OFF DIVISADERO ST.

AREA  
**3**

# METER DRAWING - EXISTING CONDITIONS

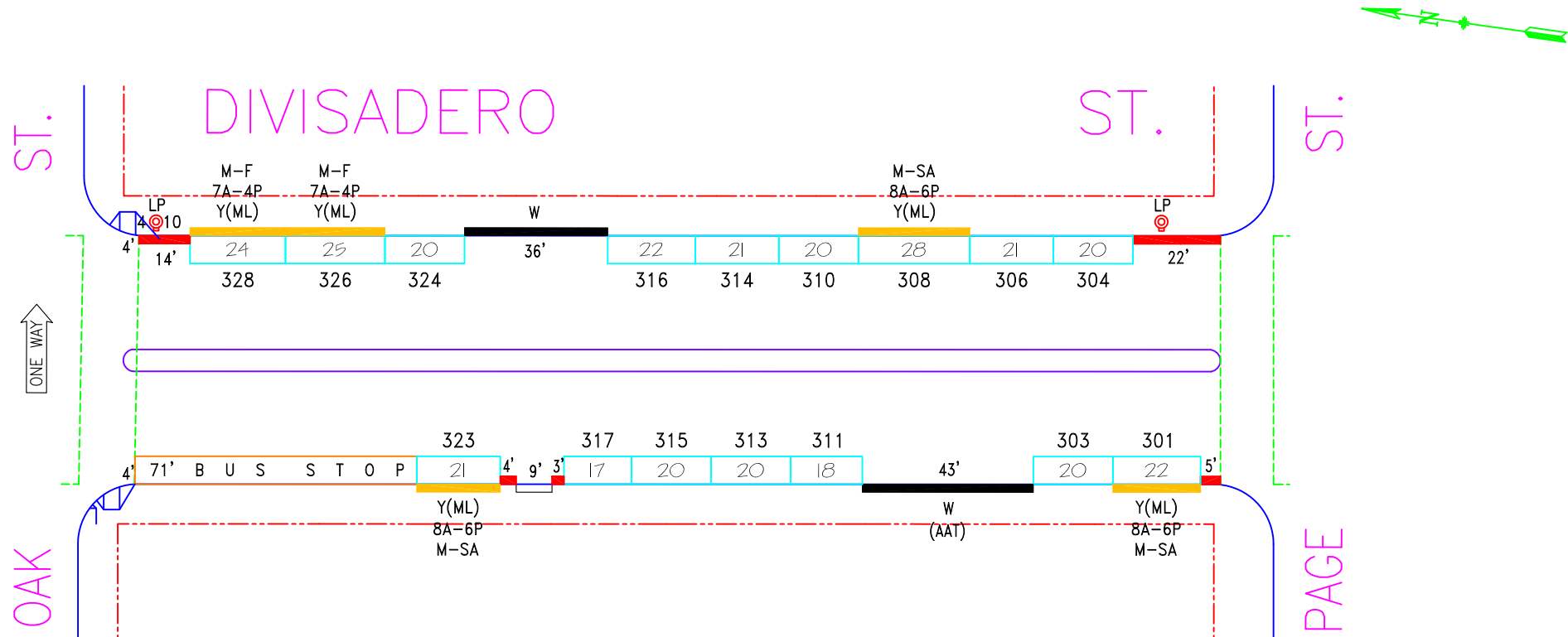

NO.	REVISION DESCRIPTION	BY	DATE	DIR/RES	3	4	5	6	7	8	9	10
					3	4	5	6	7	8	9	10
1	ML#328 revoke, ML #308 establish	JB	5/27/09	3810	4	5	6	7	8	9	10	11
2	Revk.BZ, install#310,MOS#304 for BZ	JB	10/14/11	11-104	5	6	7	8	9	10	11	12

**SAN FRANCISCO MUNICIPAL TRANSPORTATION AGENCY**  
**CITY AND COUNTY OF SAN FRANCISCO**  
 PARKING METER SPACES

SIDE	TOW-AWAY		METER CT.		GENERAL				LOADING			METERED SPACES						TOTAL
	AM	PM	SS	MS	GMP	MC	TIMES	DAYS	ML	MTL	6-W	15 MIN	30 MIN	1 HR	2 HR	10 HR		
ODD			7		5		9A-6P	M-SA	2				2		5		7	
EVEN			9		6		9A-6P	M-SA	3				3		6		9	

**DIVISADERO ST. (DIV, 384)**  
**(300) BLOCK**  
 Meters #384-03XXY  
**PAGE ST. TO OAK ST.**

**AREA 3**

SCALE: 1"=40'      DATE: 10/14/11      BY: JB

# TransBASE Internal Dashboard

Geographic Extent: 26057000: **FULTON ST at DIVISADERO ST**  
 Spatial Intersect: SFMTA Intersection Related (<=20ft or <=150ft if Rear End)  
 Data Range: 07/01/2015 to 06/30/2020  
 Pull Date: 11/6/2020

## Collision/Party/Victim Table Showing 1 to 11 of 11 entries

Count of Fatal Collisions: 0  
 Count of Non-Fatal Injury Collisions: 11  
 Total Count of Fatal/Non-Fatal Injury Collisions: 11

Case ID	Collision Date	Collision Time	Day of Week	Primary Road	Secondary Road	Distance	Direction	Party 1 Type	Party 1 Direction of Travel	Party 1 Movement Preceding Crash	Party 2 Type	Party 2 Direction of Travel	Party 2 Movement Preceding Crash	Vehicle Code Violation	Highest Degree of Injury	Type of Collision	Motor Vehicle Involved With	Weather	Lighting
200099815	02/09/2020	11:20	Sunday	FULTON ST	DIVISADERO ST	120	East	Driver	West	Proceeding Straight	Driver	West	Stopped	CVC 22350	Injury (Complaint of Pain)	Rear End	Other Motor Vehicle	Clear	Daylight
170982160	12/04/2017	16:00	Monday	FULTON ST	DIVISADERO ST	0	Not Stated	Driver	South	Proceeding Straight	Driver	West	Proceeding Straight	CVC 21453(a)	Injury (Complaint of Pain)	Broadside	Other Motor Vehicle	Clear	Daylight
170869029	10/24/2017	12:00	Tuesday	DIVISADERO ST	FULTON ST	0	Not Stated	Driver	South	Proceeding Straight	Driver	East	Proceeding Straight	CVC 21453(a)	Injury (Complaint of Pain)	Broadside	Other Motor Vehicle	Clear	Daylight
170781837	09/25/2017	06:41	Monday	DIVISADERO ST	FULTON ST	0	Not Stated	Driver	North	Proceeding Straight	Driver	North	Proceeding Straight	CVC Unknown	Injury (Other Visible)	Sideswipe	Other Motor Vehicle	Clear	Dusk - Dawn
170718078	09/03/2017	02:29	Sunday	DIVISADERO ST	FULTON ST	0	Not Stated	Pedestrian	East	Other	Driver	South	Proceeding Straight	CVC 21453(d)	Injury (Severe)	Vehicle/ Pedestrian	Pedestrian	Clear	Dark - Street Lights
170408508	05/18/2017	15:12	Thursday	DIVISADERO ST	FULTON ST	0	Not Stated	Driver	South	Parked	Driver	South	Proceeding Straight	CVC 22517	Injury (Other Visible)	Other	Other Motor Vehicle	Clear	Daylight
170037094	01/14/2017	15:13	Saturday	DIVISADERO ST	FULTON ST	0	Not Stated	Driver	East	Proceeding Straight	Driver	North	Proceeding Straight	CVC 21453(a)	Injury (Complaint of Pain)	Broadside	Other Motor Vehicle	Clear	Daylight
160714105	09/03/2016	00:50	Saturday	FULTON ST	DIVISADERO ST	0	Not Stated	Pedestrian	South	Proceeding Straight	Driver	East	Proceeding Straight	CVC 21453(d)	Injury (Other Visible)	Vehicle/ Pedestrian	Pedestrian	Clear	Dark - Street Lights
150919713	10/21/2015	09:14	Wednesday	DIVISADERO ST	FULTON ST	0	Not Stated	Driver	North	Making Left Turn	Pedestrian	West	Making Left Turn	CVC 21950(a)	Injury (Complaint of Pain)	Vehicle/ Pedestrian	Pedestrian	Clear	Daylight
150849922	09/28/2015	11:00	Monday	FULTON ST	DIVISADERO ST	0	Not Stated	Driver	East	Not Stated	Bicyclist	East	Not Stated	CVC 21750	Injury (Complaint of Pain)	Sideswipe	Bicycle	Clear	Daylight
150792644	09/09/2015	19:06	Wednesday	DIVISADERO ST	FULTON ST	0	Not Stated	Bicyclist	West	Proceeding Straight	Driver	West	Making Right Turn	CVC Unknown	Injury (Complaint of Pain)	Broadside	Bicycle	Clear	Daylight



# TransBASE Internal Dashboard

Geographic Extent: 26056000: GROVE ST at DIVISADERO ST

Spatial Intersect: SFMTA Intersection Related (<=20ft or <=150ft if Rear End)

Data Range: 07/01/2015 to 06/30/2020

Pull Date: 11/6/2020

## Collision/Party/Victim Table

Showing 1 to 4 of 4 entries

Count of Fatal Collisions: 1

Count of Non-Fatal Injury Collisions: 3

Total Count of Fatal/Non-Fatal Injury Collisions: 4

Case ID	Collision Date	Collision Time	Day of Week	Primary Road	Secondary Road	Distance	Direction	Party 1 Type	Party 1 Direction of Travel	Party 1 Movement Preceding Crash	Party 2 Type	Party 2 Direction of Travel	Party 2 Movement Preceding Crash	Vehicle Code Violation	Highest Degree of Injury	Type of Collision	Motor Vehicle Involved With	Weather	Lighting
190772474	10/13/2019	19:57	Sunday	DIVISADERO ST	GROVE ST	0	Not Stated	Driver	South	Proceeding Straight	Driver	East	Proceeding Straight	CVC 23152(a)	Fatal	Sideswipe	Other Motor Vehicle	Clear	Dark - Street Lights
190667740	09/07/2019	13:35	Saturday	DIVISADERO ST	GROVE ST	54	South	Driver	North	Proceeding Straight	Driver	North	Stopped	CVC 22350	Injury (Complaint of Pain)	Rear End	Other Motor Vehicle	Clear	Daylight
180515723	07/11/2018	22:54	Wednesday	DIVISADERO ST	GROVE ST	0	Not Stated	Driver	South	Making U Turn	Driver	South	Proceeding Straight	CVC 21801(a)	Injury (Complaint of Pain)	Broadside	Other Motor Vehicle	Clear	Dark - Street Lights
170878729	10/27/2017	07:40	Friday	GROVE ST	DIVISADERO ST	0	Not Stated	Bicyclist	East	Proceeding Straight	Driver	South	Making Right Turn	CVC 22350	Injury (Other Visible)	Other	Non-Collision	Clear	Daylight

# TransBASE Internal Dashboard

Geographic Extent: 26053000: HAYES ST at DIVISADERO ST

Spatial Intersect: SFMTA Intersection Related (<=20ft or <=150ft if Rear End)

Data Range: 07/01/2015 to 06/30/2020

Pull Date: 11/6/2020

## Collision/Party/Victim Table

Showing 1 to 6 of 6 entries

Count of Fatal Collisions: 0

Count of Non-Fatal Injury Collisions: 6

Total Count of Fatal/Non-Fatal Injury Collisions: 6

Case ID	Collision Date	Collision Time	Day of Week	Primary Road	Secondary Road	Distance	Direction	Party 1 Type	Party 1 Direction of Travel	Party 1 Movement Preceding Crash	Party 2 Type	Party 2 Direction of Travel	Party 2 Movement Preceding Crash	Vehicle Code Violation	Highest Degree of Injury	Type of Collision	Motor Vehicle Involved With	Weather	Lighting
190668908	09/07/2019	23:05	Saturday	HAYES ST	DIVISADERO ST	0	Not Stated	Driver	West	Making Left Turn	Driver	East	Proceeding Straight	CVC 22350	Injury (Complaint of Pain)	Broadside	Other Motor Vehicle	Clear	Dark - Street Lights
190419626	06/11/2019	13:09	Tuesday	DIVISADERO ST	HAYES ST	0	Not Stated	Driver	East	Making Left Turn	Driver	North	Not Stated	CVC 21801(a)	Injury (Complaint of Pain)	Broadside	Motor Vehicle on Other Roadway	Clear	Daylight
190081253	02/01/2019	18:35	Friday	DIVISADERO ST	HAYES ST	0	Not Stated	Driver	South	Other Unsafe Turning	Driver	South	Proceeding Straight	CVC 22107	Injury (Complaint of Pain)	Sideswipe	Other Motor Vehicle	Raining	Dark - Street Lights
180450373	06/07/2018	23:16	Thursday	DIVISADERO ST	HAYES ST	0	Not Stated	Driver	North	Proceeding Straight	Pedestrian	West	Proceeding Straight	CVC 22350	Injury (Severe)	Vehicle/ Pedestrian	Pedestrian	Clear	Dark - Street Lights
150896707	10/13/2015	15:33	Tuesday	DIVISADERO ST	HAYES ST	0	Not Stated	Driver	West	Proceeding Straight				CVC 22350	Injury (Other Visible)	Overtuned	Non-Collision	Clear	Daylight
150637090	07/22/2015	11:45	Wednesday	HAYES ST	DIVISADERO ST	5	East	Driver	East	Making Right Turn	Pedestrian	North	Proceeding Straight	CVC 21950(a)	Injury (Other Visible)	Vehicle/ Pedestrian	Pedestrian	Clear	Daylight

# TransBASE Internal Dashboard

Geographic Extent: 26029000: PAGE ST at DIVISADERO ST

Spatial Intersect: SFMTA Intersection Related (<=20ft or <=150ft if Rear End)

Data Range: 07/01/2015 to 06/30/2020

Pull Date: 11/6/2020

## Collision/Party/Victim Table

Showing 1 to 6 of 6 entries

Count of Fatal Collisions: 0

Count of Non-Fatal Injury Collisions: 6

Total Count of Fatal/Non-Fatal Injury Collisions: 6

Case ID	Collision Date	Collision Time	Day of Week	Primary Road	Secondary Road	Distance	Direction	Party 1 Type	Party 1 Direction of Travel	Party 1 Movement Preceding Crash	Party 2 Type	Party 2 Direction of Travel	Party 2 Movement Preceding Crash	Vehicle Code Violation	Highest Degree of Injury	Type of Collision	Motor Vehicle Involved With	Weather	Lighting
190796753	10/22/2019	10:31	Tuesday	DIVISADERO ST	PAGE ST	18	North	Pedestrian	West	Proceeding Straight	Driver	North	Proceeding Straight	CVC 21453(d)	Injury (Other Visible)	Not Stated	Pedestrian	Clear	Daylight
190511852	07/15/2019	09:10	Monday	PAGE ST	DIVISADERO ST	0	Not Stated	Bicyclist	East	Proceeding Straight				CVC Unknown	Injury (Severe)	Other	Not Stated	Clear	Daylight
190336503	05/10/2019	22:19	Friday	DIVISADERO ST	PAGE ST	4	North	Other	North	Proceeding Straight				CVC Unknown	Injury (Other Visible)	Hit Object	Fixed Object	Clear	Dark - Street Lights
170897525	11/03/2017	07:30	Friday	DIVISADERO ST	PAGE ST	0	Not Stated	Driver	South	Stopped In Road	Bicyclist	South	Proceeding Straight	CVC 22517	Injury (Other Visible)	Sideswipe	Bicycle	Clear	Daylight
160563689	07/12/2016	16:38	Tuesday	PAGE ST	DIVISADERO ST	6	East	Driver	East	Stopped In Road	Parked Vehicle	West	Parked	CVC Unknown	Injury (Complaint of Pain)	Head-On	Parked Motor Vehicle	Clear	Daylight
150604215	07/11/2015	14:57	Saturday	PAGE ST	DIVISADERO ST	0	Not Stated	Driver	East	Making Right Turn	Driver	East	Making Right Turn	CVC Unknown	Injury (Complaint of Pain)	Broadside	Other Motor Vehicle	Clear	Daylight



# PROPOSED DESIGN - BIKE BOXES

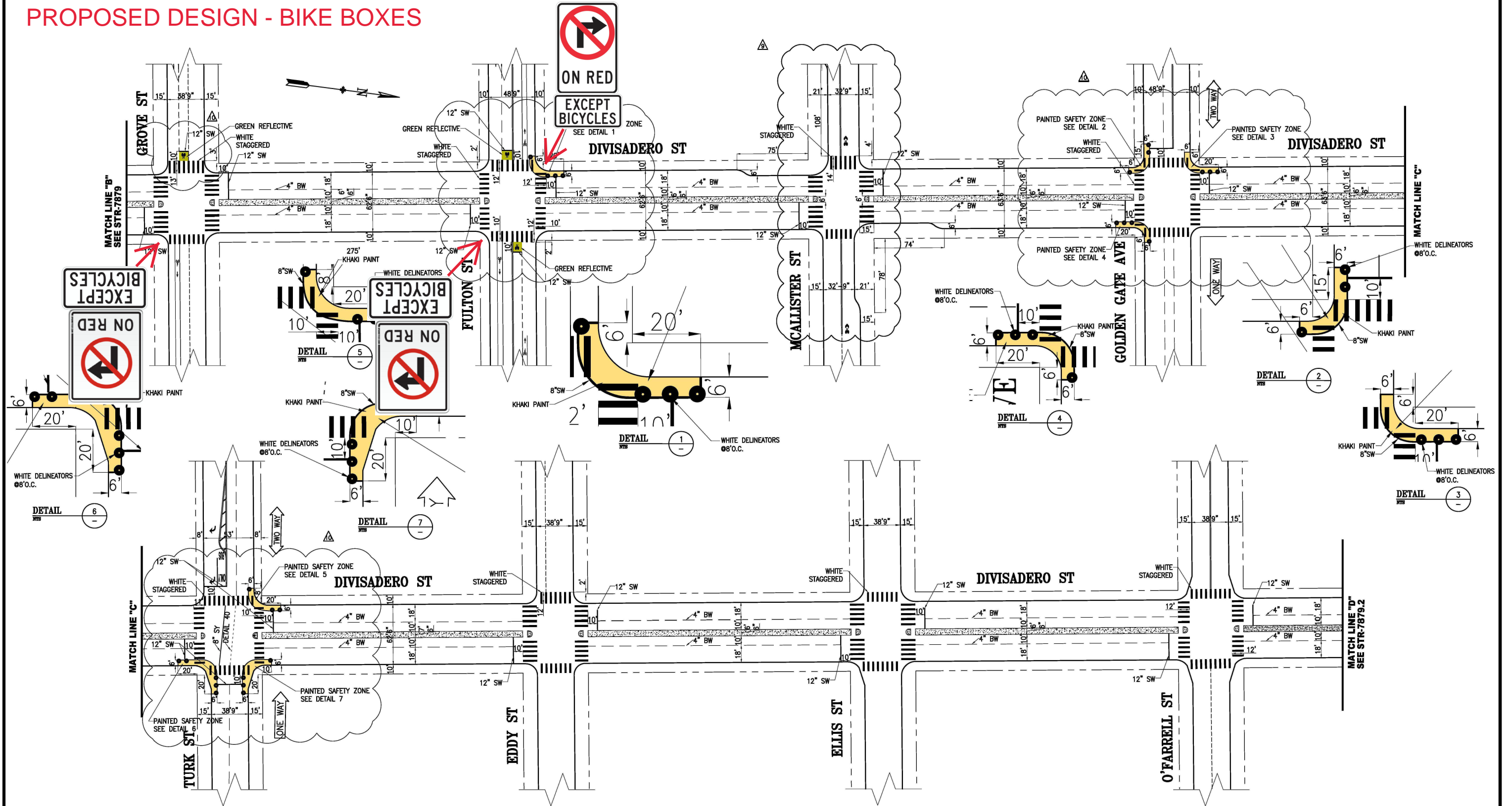

- LIST OF REVISIONS PER FIELD FOR REVISION 5:
- FULTON: WEST SIDE CROSSWALK WIDTH
  - MCALLISTER: SHARROW ON WB LANE AT THE EAST SIDE OF INTERSECTION & WEST SIDE CROSSWALK WIDTH
  - EDDY: 4" BROKEN YELLOW WEST SIDE

NO.	DATE	DESCRIPTION	BY	APP
1	09/18/19	ADDED PS2s @ FULTON, GOLDEN GATE & TURK. ADDED BIKE BOXES @ GROVE & FULTON	S.SHARIATI	W.LEE
2	10/16/17	ADDED BY ON MCALLISTER EASTBOUND AND WESTBOUND	K.SHUE	M.VELASCO
3	09/18/19	PER FIELD CONDITIONS REMOVED 24" SW ADVANCED LIMIT LINE AT WB MCALLISTER	K.SHUE	M.VELASCO
4	10/16/17	ADDED EASTBOUND BULBOUT AT MCALLISTER	K.SHUE	M.VELASCO
5	04/17/18	PER FIELD CONDITIONS UPDATED BUS ONLY LANE ON TURK	K.SHUE	M.VELASCO

TABLE OF REVISIONS  
CHECK WITH TRACING TO SEE IF YOU HAVE LATEST REVISION



SUPERSEDES:	STR-1567 REV17
SUPERSEDES:	STR-1567.1 REV16
DRAWN:	T.ABDALLAH
DATE:	06/30/11
CHECKED:	M.VELASCO
DATE:	06/30/11

APPROVED	MANITO VELASCO FOR THOMAS P. FOLKS	DATE:	08/25/11
SENIOR ENGINEER		DATE:	
APPROVED	RICARDO OLEA	DATE:	08/26/11
CITY TRAFFIC ENGINEER		DATE:	

SCALE: 1" = 50'

SHEET/SHEETS: 02 OF 05

TRAFFIC STRIPING

**DIVISADERO STREET**  
GROVE STREET TO O'FARRELL STREET

CONTRACT NO.	
DRAWING NO.	STR-7879.1
FILE NO.	
REV. NO.	10

# METER DRAWING - PROPOSED CONDITIONS

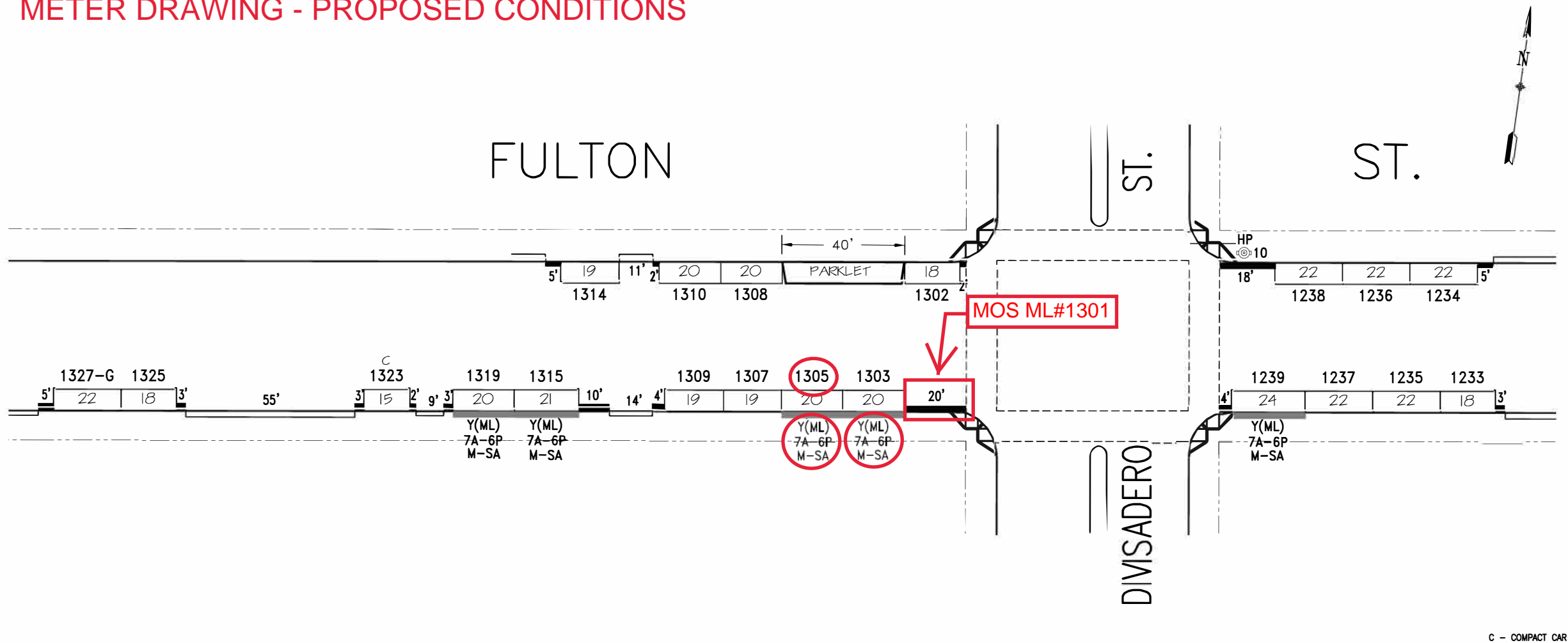

C - COMPACT CAR

NO.	REVISION DESCRIPTION	BY	DATE	DIR/RES
3	Update per field: add #1323 - S/S	JB	6/2/15	
1	Per Field:MOS#1304,1306 for parklet	JB	12/13/11	
4	AddRZ,MOS ML#1301, Chg.#1305toML	JB	10/15/20	
2	Change MTL to ML#1301 & #1303	JB	8/22/13	

**SAN FRANCISCO MUNICIPAL TRANSPORTATION AGENCY**  
 CITY AND COUNTY OF SAN FRANCISCO  
 PARKING METER SPACES

SIDE	TOW-AWAY		METER CT.		GENERAL				LOADING		METERED SPACES						TOTAL
	AM	PM	SS	MS	GMP	MC	TIMES	DAYS	ML	MTL	6-W	15 MIN	30 MIN	1 HR	2 HR	10 HR	
ODD			13		8		9A-6P	M-SA	5				6		7		13
EVEN			7		7		9A-6P	M-SA							7		7

**FULTON ST. (FUL, 423)**  
**(1200-1300) BLOCK**  
 Meters #423-12XXY  
**OFF DIVISADERO ST.**

SCALE: 1" = 40'      DATE: 8/22/13      BY: JB

AREA  
3

# METER DRAWING - PROPOSED CONDITIONS

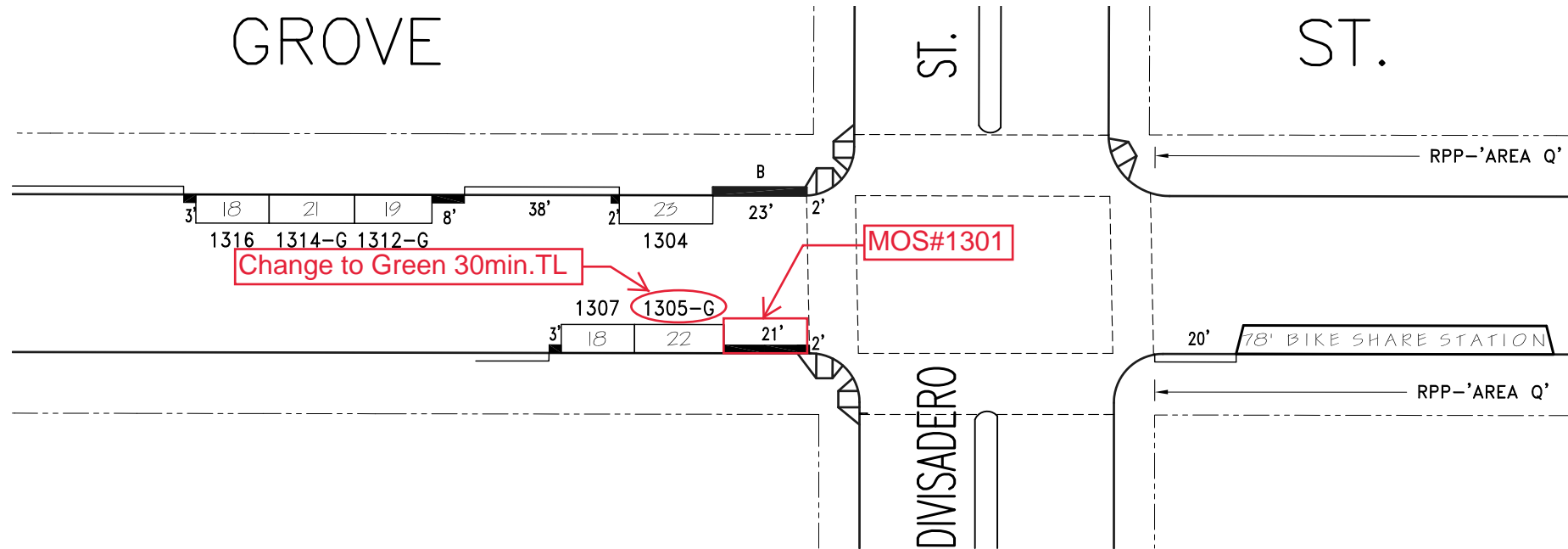

NO.	REVISION DESCRIPTION	BY	DATE	DIR/RES	3	AddRZ,MOS#1301,Change#1305toGreen	JB	10/15/20
1	Est. Green meter#1312,1314 - N/S	JB	12/8/16	5661				
2	Est. Bike Station-East of Divisadero	JB	8/26/17	5683				



**SAN FRANCISCO MUNICIPAL TRANSPORTATION AGENCY**  
**CITY AND COUNTY OF SAN FRANCISCO**  
 PARKING METER SPACES

SIDE	TOW-AWAY		METER CT.		GENERAL				LOADING		METERED SPACES							TOTAL
	AM	PM	SS	MS	GMP	MC	TIMES	DAYS	ML	MTL	6-W	15 MIN	30 MIN	1 HR	2 HR	10 HR		
ODD			2		2		9A-6P	M-SA					1		1		2	
EVEN			4		4		9A-6P	M-SA					2		2		4	

**GROVE ST. (GRO, 446)**  
**(1300) BLOCK**  
 Meters #446-13XXY  
**OFF DIVISADERO ST.**

SCALE: 1" = 40'      DATE: 12/8/16      BY: JB

**AREA 3**

Revised: 10/15/20 15:43:27  
 Filename: S:\7-1615\Operations Meter Drawing\Meter\_Pkg\_000\Area-3\Area-3.mxd



# METER DRAWING - PROPOSED CONDITIONS

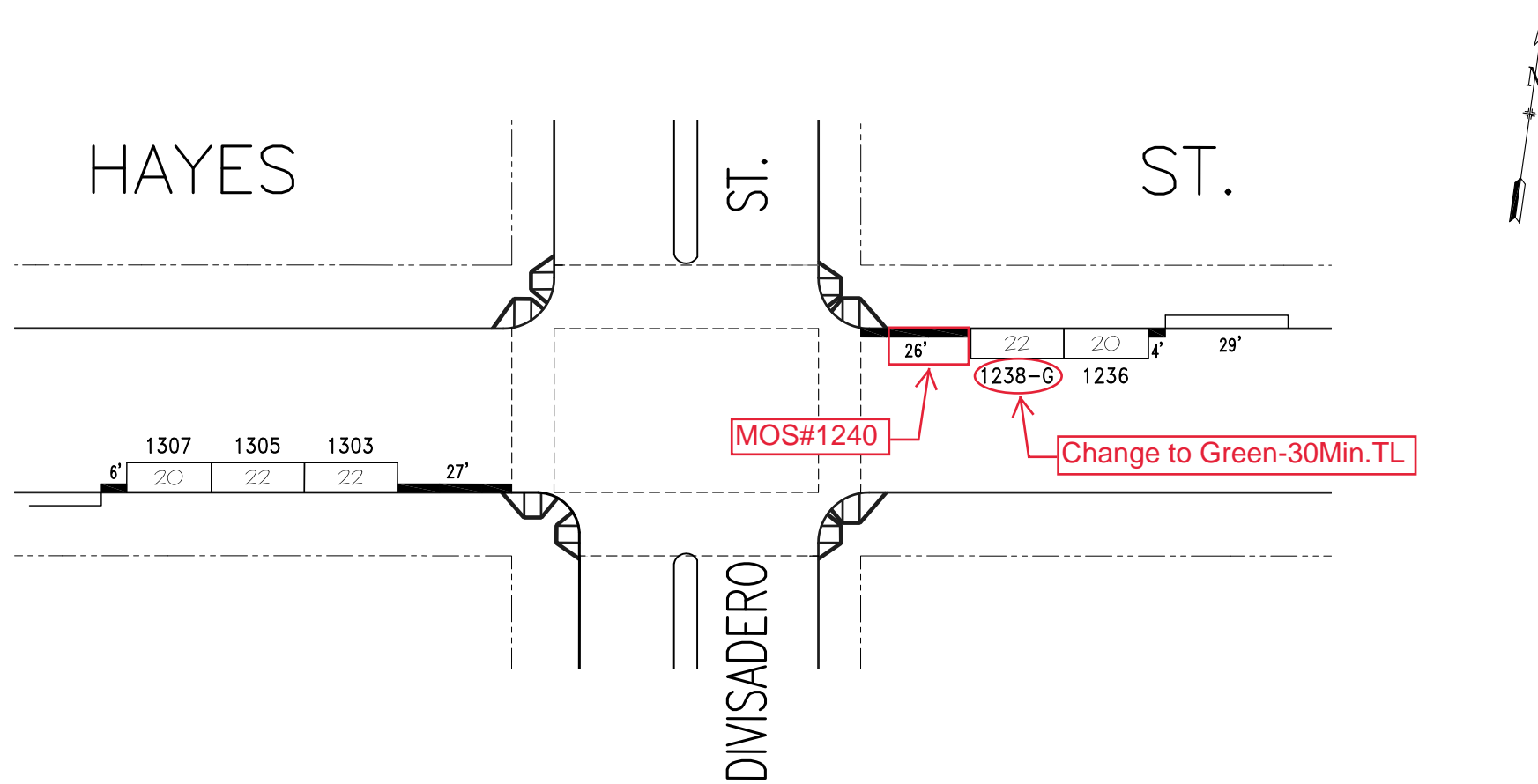

NO.	REVISION DESCRIPTION	BY	DATE	DIR/RES
1	Add RZ,MOS#1240,1301,Chg.#1238toG	JB	10/16/20	

**SAN FRANCISCO MUNICIPAL TRANSPORTATION AGENCY**  
 CITY AND COUNTY OF SAN FRANCISCO  
 PARKING METER SPACES

SIDE	TOW-AWAY		METER CT.		GENERAL				LOADING		METERED SPACES							TOTAL
	AM	PM	SS	MS	GMP	MC	TIMES	DAYS	ML	MTL	6-W	15 MIN	30 MIN	1 HR	2 HR	10 HR		
ODD			3		3		9A-6P	M-SA							3		3	
EVEN			2		2		9A-6P	M-SA					1		1		2	

**HAYES ST. (HAY, 464)**  
**(1200-1300) BLOCK**  
 Meters #464-12/13XXy  
**OFF DIVISADERO ST.**

SCALE: **1" = 40'**      DATE: **10/16/20**      BY: **JB**

**AREA 3**

# METER DRAWING - PROPOSED CONDITIONS

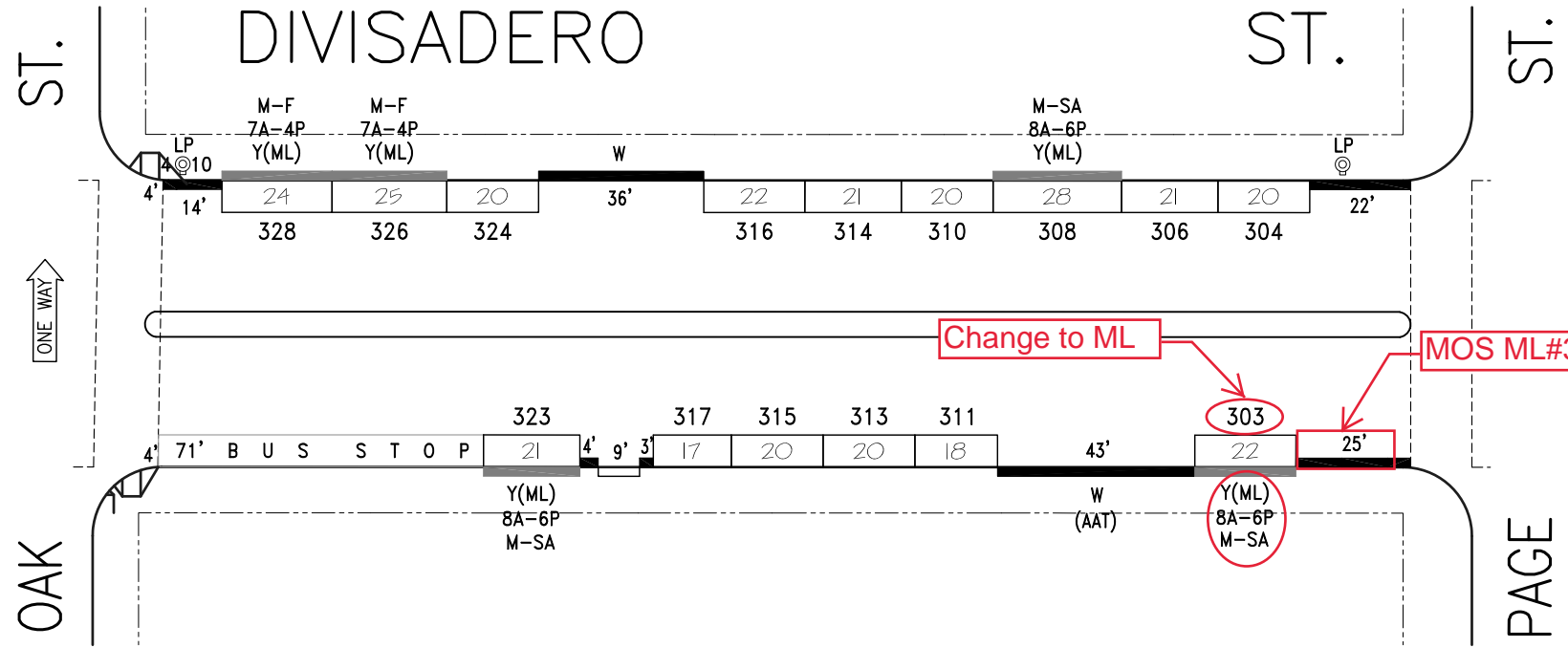

NO.	REVISION DESCRIPTION	BY	DATE	DIR/RES				
					3	Establish ML# 326,328	JB	8/09/13 5126
6	RZ-MOS ML#301, Change #303 to ML	JB	10/15/20		4	Revoke blue zone, Install #304-E/S	JB	9/20/16 16-116
					5	Reconfig.P.S.#317,323,Add RZon dwy.	JB	8/28/18

**SAN FRANCISCO MUNICIPAL TRANSPORTATION AGENCY**  
 CITY AND COUNTY OF SAN FRANCISCO  
 PARKING METER SPACES

SIDE	TOW-AWAY		METER CT.		GENERAL				LOADING			METERED SPACES						TOTAL
	AM	PM	SS	MS	GMP	MC	TIMES	DAYS	ML	MTL	6-W	15 MIN	30 MIN	1 HR	2 HR	10 HR		
ODD			6		4		9A-6P	M-SA	2				2		4		6	
EVEN			9		6		9A-6P	M-SA	3				3		6		9	

**DIVISADERO ST. (DIV, 384)**  
**(300) BLOCK**  
 Meters #384-03XXY  
 PAGE ST. TO OAK ST.

SCALE: 1" = 40'      DATE: 10/14/11      BY: JB

AREA  
3

Revised: 10/15/20 11:45 AM  
 File: RZ-MOS ML#301, Change #303 to ML.dwg (001)