

SFMTA - TASC SUMMARY SHEET

PreStaff_Date: 11/24/2020 Requested_by: SFMTA Handled: J.Chimento Section Head M.Sallaberry <i>MS</i>	<input type="checkbox"/> Public Hearing Consent <input checked="" type="checkbox"/> Public Hearing Regular <input type="checkbox"/> Informational / Other <small>PH - Consent</small>	No objections: _____ Item Held: _____ Other: _____
--	---	---

Location: Vicente Street from West Portal Avenue to Portola Avenue

Subject: Class II Bike Lane, Class III Bike Route and No Parking

PROPOSAL / REQUEST:
 ESTABLISH - CLASS II BIKEWAY (BIKE LANE)
 Vicente Street, southbound, from West Portal to Portola
 ESTABLISH - CLASS III BIKEWAY
 Vicente Street, northbound, from West Portal to Portola
 ESTABLISH - TOW AWAY NO PARKING ANY TIME
 Vicente Street, east side, from Portola 43 feet northerly (33 feet of additional no parking)

Clean up legislation to close a gap in the bike network, parking removal to accommodate 48 muni bus turn.
 Supervisor District 7
 Jonathan.Chimento@sfmta.com

BACKGROUND INFORMATION / COMMENTS

Clean up legislation as part of the L-Taraval improvement project.
 The Ulloa bike route is being moved to Vicente. The original plan for the Vicente route excluded the block from West Portal to Portola, this left a gap in the network connecting to Portola bike route and the Santa Clara bike route.

The 48 bus makes a right turn from Portola onto Vicente, to design for this turn we are recommending the removal of 33 feet of general use parking on the east side of Vicente, there is currently a 10 foot red zone for a fire hydrant.

HEARING NOTIFICATION AND PROCESSING NOTES:	ENVIRONMENTAL CLEARANCE BY: <input checked="" type="checkbox"/> SFMTA <input type="checkbox"/> Attached <input type="checkbox"/> Pending
---	--

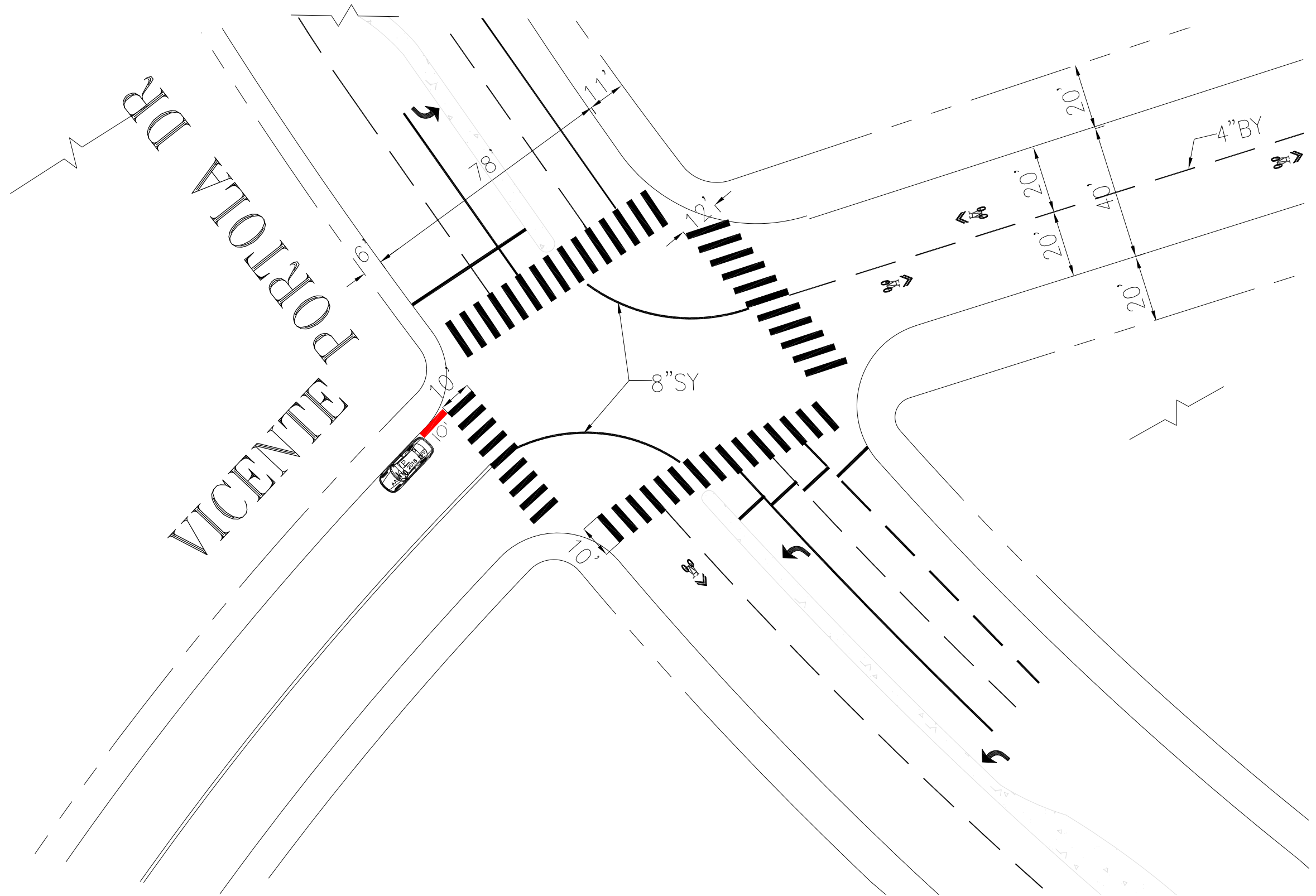

NO.	DATE	DESCRIPTION	BY	APP
TABLE OF REVISIONS				
CHECK WITH TRACING TO SEE IF YOU HAVE LATEST REVISION				

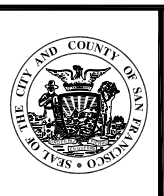

DRAWN:	DATE:
CHECKED:	DATE:

APPROVED	SCALE:
SENIOR ENGINEER	
CITY TRAFFIC ENGINEER	

DATE:	DATE:
DATE:	DATE:

SHEET/SHEETS:	CONTRACT NO.
	DRAWING NO.
	FILE NO.
	REV. NO.

CONTRACT NO.
DRAWING NO.
FILE NO.
REV. NO.

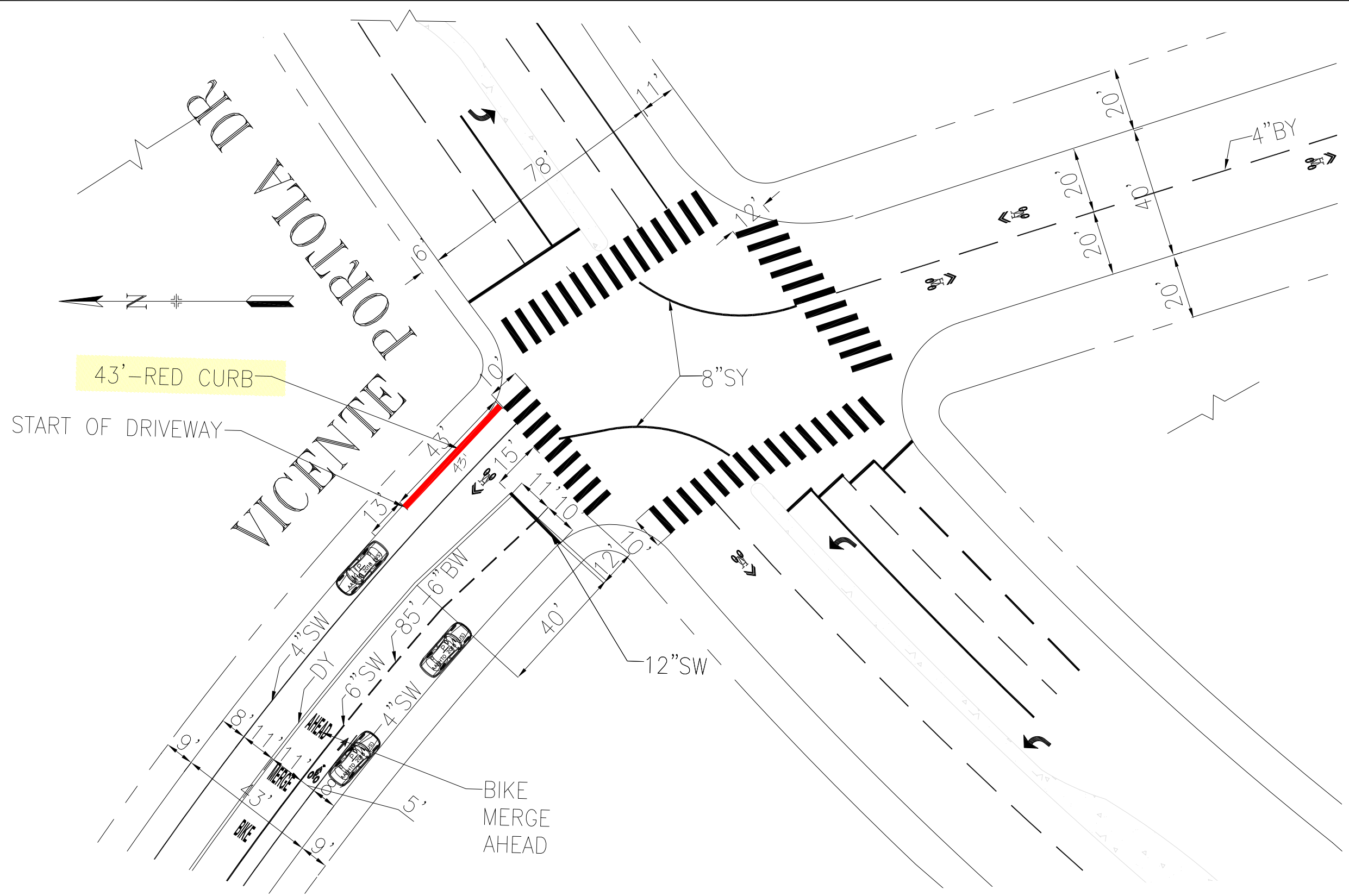

43'-RED CURB

START OF DRIVEWAY

BIKE MERGE AHEAD

NO.	DATE	DESCRIPTION	BY	APP
TABLE OF REVISIONS				
CHECK WITH TRACING TO SEE IF YOU HAVE LATEST REVISION				



DRAWN:	DATE:	APPROVED		SCALE:	CONTRACT NO.	
		SENIOR ENGINEER	DATE:			
CHECKED:	DATE:	CITY TRAFFIC ENGINEER		SHEET/SHEETS:		DRAWING NO.
		DATE:	DATE:			FILE NO.
						REV. NO.

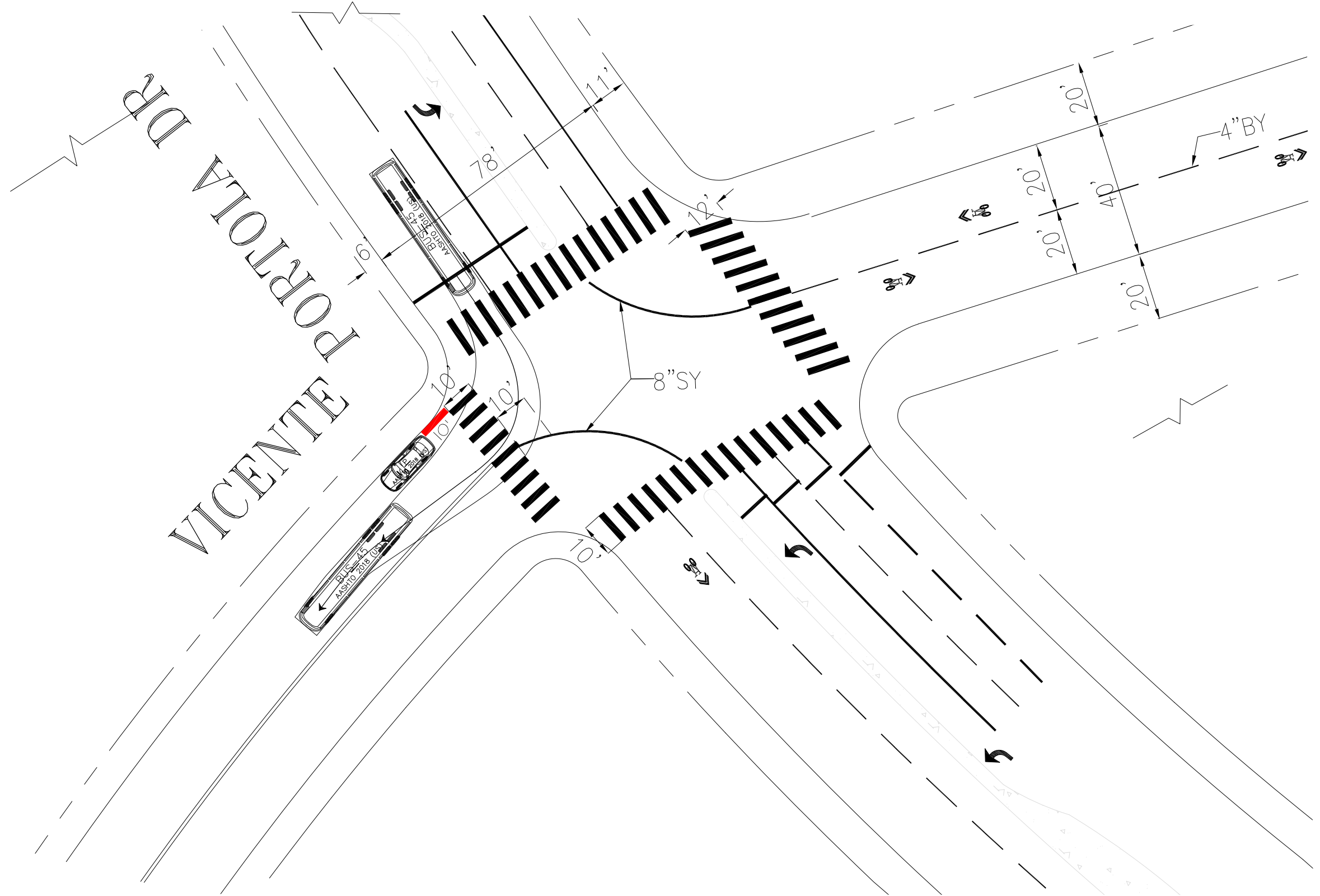

NO.	DATE	DESCRIPTION	BY	APP
TABLE OF REVISIONS				
CHECK WITH TRACING TO SEE IF YOU HAVE LATEST REVISION				



--	--

DRAWN:	DATE:
CHECKED:	DATE:

APPROVED	
SENIOR ENGINEER	DATE:
CITY TRAFFIC ENGINEER	DATE:

SCALE:
SHEET/SHEETS:

CONTRACT NO.
DRAWING NO.
FILE NO.
REV. NO.

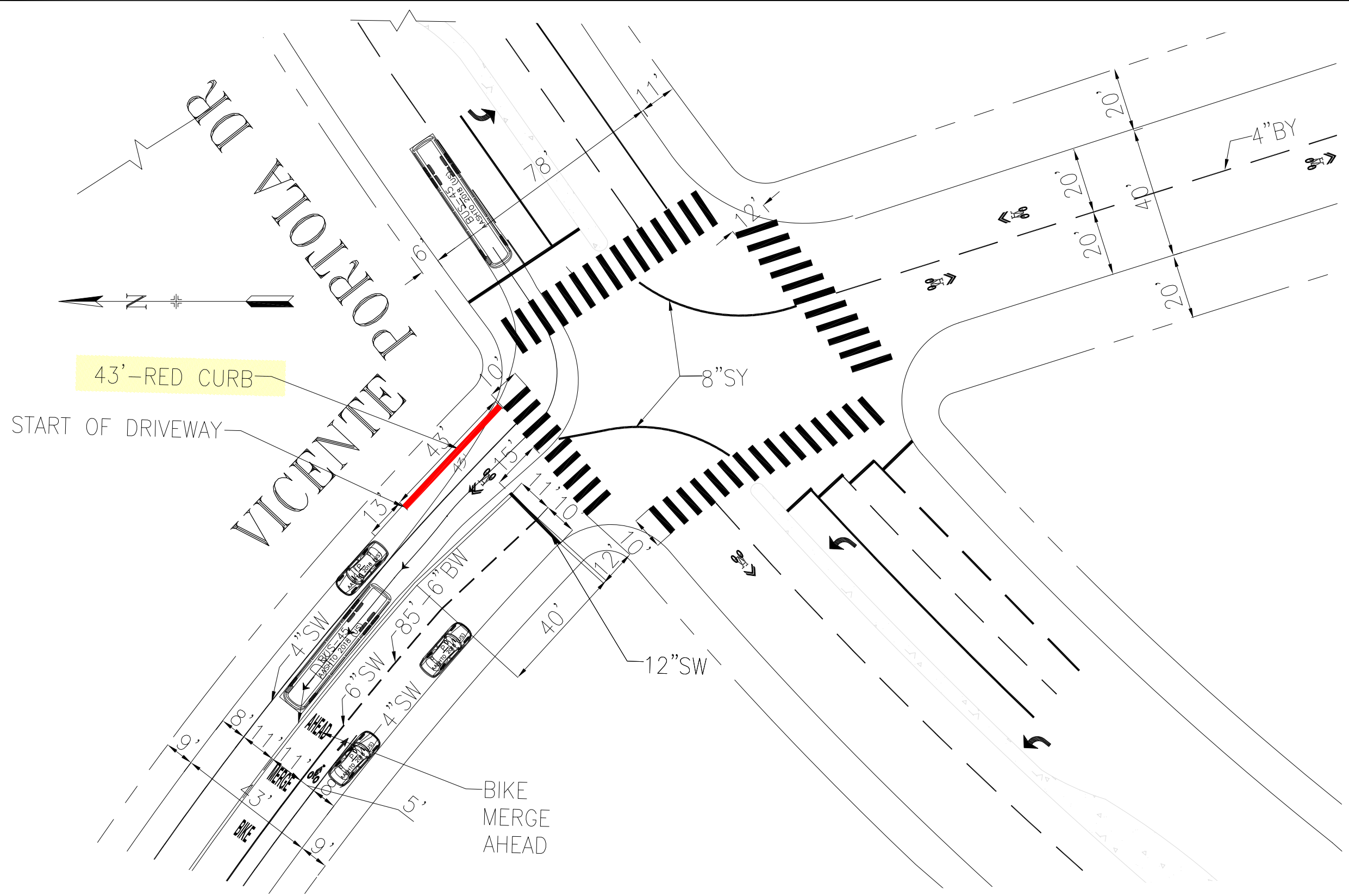

NO.	DATE	DESCRIPTION	BY	APP
TABLE OF REVISIONS				
CHECK WITH TRACING TO SEE IF YOU HAVE LATEST REVISION				



DRAWN:	DATE:	APPROVED	SCALE:
CHECKED:	DATE:	SENIOR ENGINEER	
		CITY TRAFFIC ENGINEER	

		SHEET/SHEETS:	

CONTRACT NO.
DRAWING NO.
FILE NO.
REV. NO.

Vicente Street from West Portal to Portola



SFMTA Bike Map, Vicente from West Portal to Portola



San Francisco Bike Map

-  **Protected Bikeway**
(striped, marked, or signed bicycle lanes separated from vehicle traffic)
-  **Bicycle Lane**
(striped, marked, or signed lanes for bicycle travel)
-  **Bicycle Route** (shared travel lane marked or signed for shared use)
-  **Off-Street Multi-Use Path**
-  **One-Way Street**
-  **Library**  **Hospital**  **School**
-  **Moderate Hill** (5-10% grade/arrow points uphill)
-  **Steep Hill** (more than 10% grade/arrow points uphill)



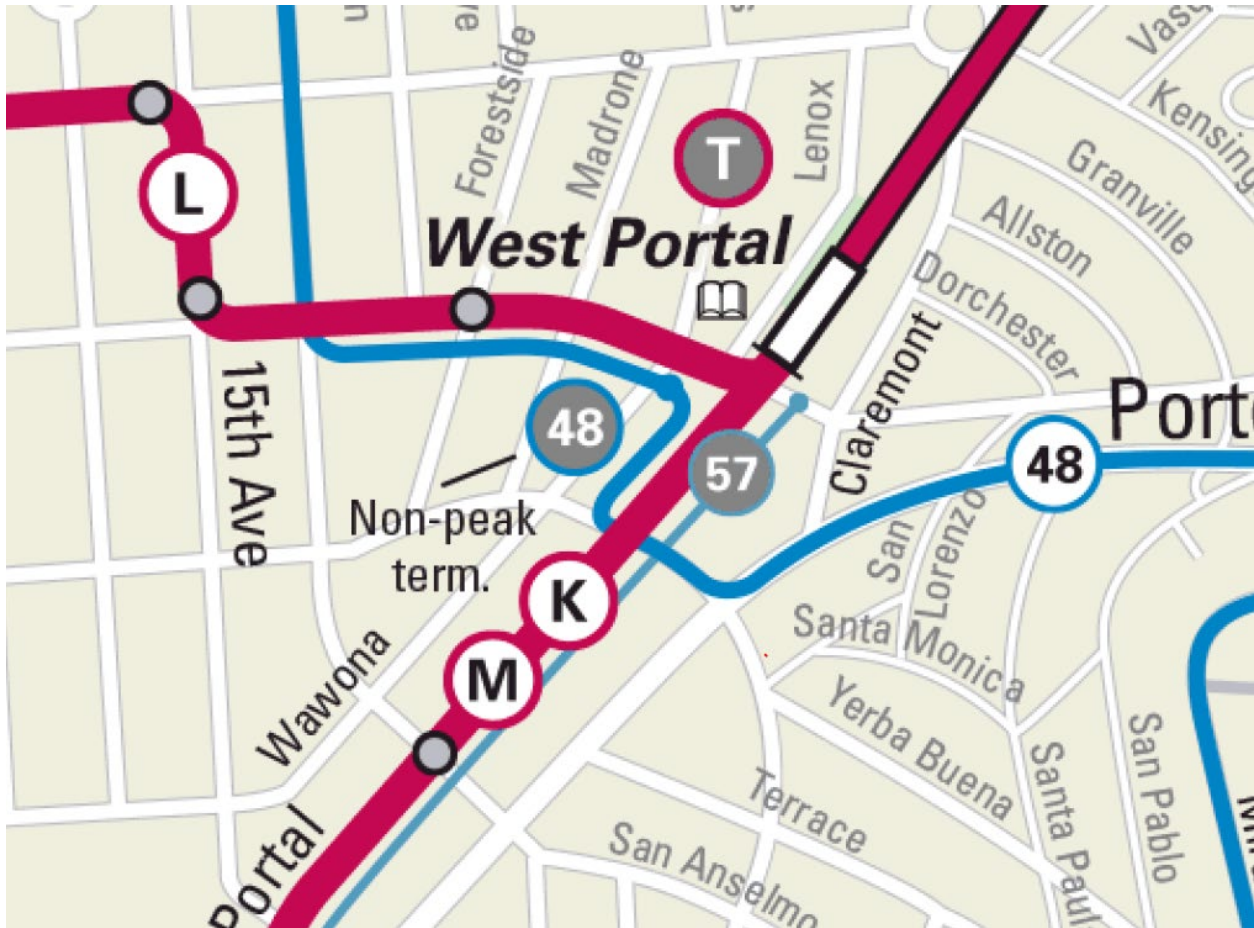

SFMTA Muni Transit Map Vicente from West Portal to Portola

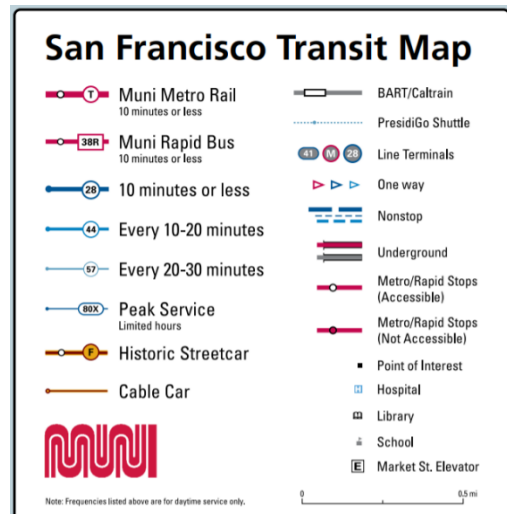

Affected transit service:

- 19/44 on Innes from Hunters Pt Blvd to Donohue
 - Change from four lanes (two in each direction) to two lanes (one in each direction)
- 19/44 on Evans Ave SE approach to Jennings
 - Change from two through lanes to one through, one right turn lane, and one left turn lane





42
125
126
127
128
129

1-100

14-114

352

N

West 10' Part of 316.55' AVE

B. A. Y. M. E. T. R. I. C. S.

INTERSECTION TURNING MOVEMENT SUMMARY

PROJECT:	19TH AVENUE CORRIDOR STUDY	SURVEY DATE:	2/3/2009	DAY:	TUESDAY
N-S Approach:	SANTA CLARA AVE / VICENTE STREET	SURVEY TIME:	7:00 AM	TO	9:00 AM
E-W Approach:	PORTOLA DRIVE	CITY:	SAN FRANCISCO	FILE:	2901007-26AM

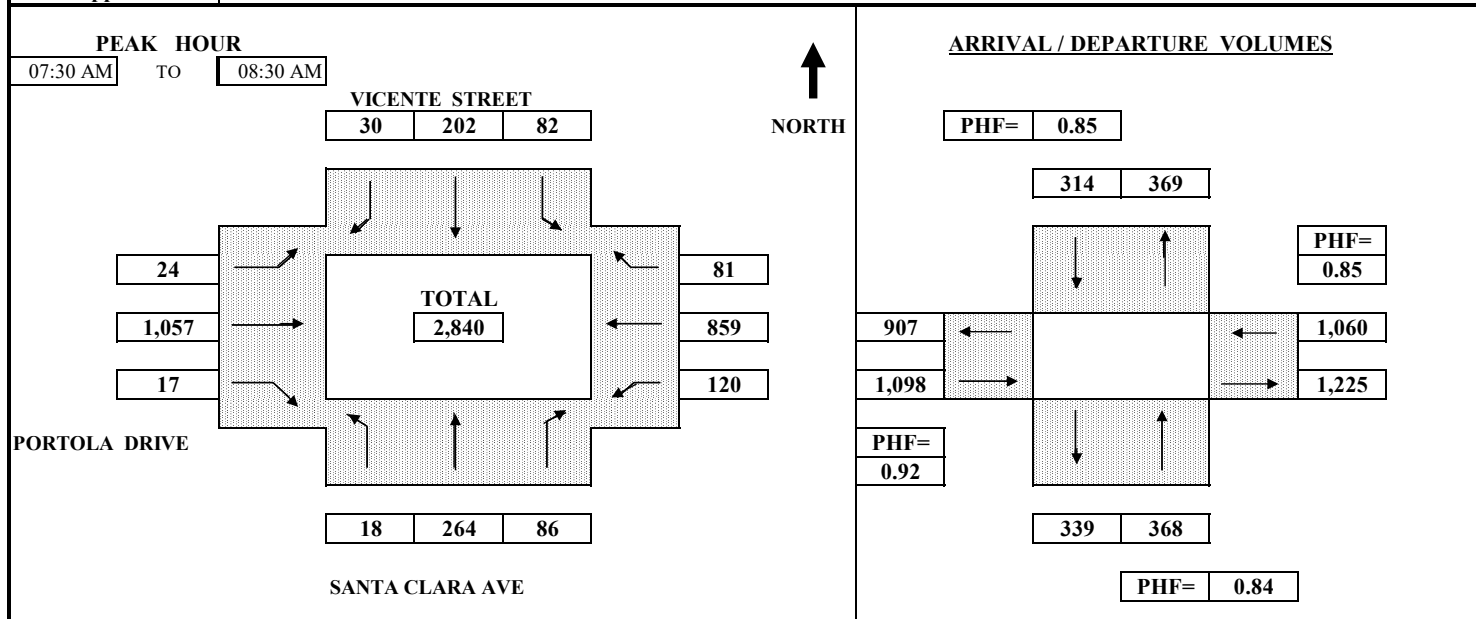

TIME PERIOD		NORTHBOUND			SOUTHBOUND			EASTBOUND			WESTBOUND			TOTAL	
From	To	Left	Thru	Right	Left	Thru	Right	Left	Thru	Right	Left	Thru	Right		
SURVEY DATA															
7:00 AM	---	7:15 AM	2	42	9	15	35	8	3	207	3	9	130	10	473
7:15 AM	---	7:30 AM	6	86	34	35	82	14	10	488	4	25	272	24	1,080
7:30 AM	---	7:45 AM	7	149	56	50	135	21	12	766	6	51	477	45	1,775
7:45 AM	---	8:00 AM	13	224	85	64	201	26	20	1,053	10	88	722	74	2,580
8:00 AM	---	8:15 AM	21	294	105	91	249	35	28	1,310	14	121	952	93	3,313
8:15 AM	---	8:30 AM	24	350	120	117	284	44	34	1,545	21	145	1,131	105	3,920
8:30 AM	---	8:45 AM	33	420	140	133	325	52	42	1,770	26	189	1,286	127	4,543
8:45 AM	---	9:00 AM	38	501	164	148	389	65	51	2,018	33	225	1,492	152	5,276
TOTAL BY PERIOD															
7:00 AM	---	7:15 AM	2	42	9	15	35	8	3	207	3	9	130	10	473
7:15 AM	---	7:30 AM	4	44	25	20	47	6	7	281	1	16	142	14	607
7:30 AM	---	7:45 AM	1	63	22	15	53	7	2	278	2	26	205	21	695
7:45 AM	---	8:00 AM	6	75	29	14	66	5	8	287	4	37	245	29	805
8:00 AM	---	8:15 AM	8	70	20	27	48	9	8	257	4	33	230	19	733
8:15 AM	---	8:30 AM	3	56	15	26	35	9	6	235	7	24	179	12	607
8:30 AM	---	8:45 AM	9	70	20	16	41	8	8	225	5	44	155	22	623
8:45 AM	---	9:00 AM	5	81	24	15	64	13	9	248	7	36	206	25	733
HOURLY TOTALS															
7:00 AM	---	8:00 AM	13	224	85	64	201	26	20	1,053	10	88	722	74	2,580
7:15 AM	---	8:15 AM	19	252	96	76	214	27	25	1,103	11	112	822	83	2,840
7:30 AM	---	8:30 AM	18	264	86	82	202	30	24	1,057	17	120	859	81	2,840
7:45 AM	---	8:45 AM	26	271	84	83	190	31	30	1,004	20	138	809	82	2,768
8:00 AM	---	9:00 AM	25	277	79	84	188	39	31	965	23	137	770	78	2,696

Telephone: (510)232-1271

Fax: (510)232-1272

B. A. Y. M. E. T. R. I. C. S.

INTERSECTION TURNING MOVEMENT SUMMARY

PROJECT:	19TH AVENUE CORRIDOR STUDY	SURVEY DATE:	2/3/2009	DAY:	TUESDAY
N-S Approach:	SANTA CLARA AVE / VICENTE STREET	SURVEY TIME:	4:30 PM	TO	6:30 PM
E-W Approach:	PORTOLA DRIVE	CITY:	SAN FRANCISCO	FILE:	2901007-26PM

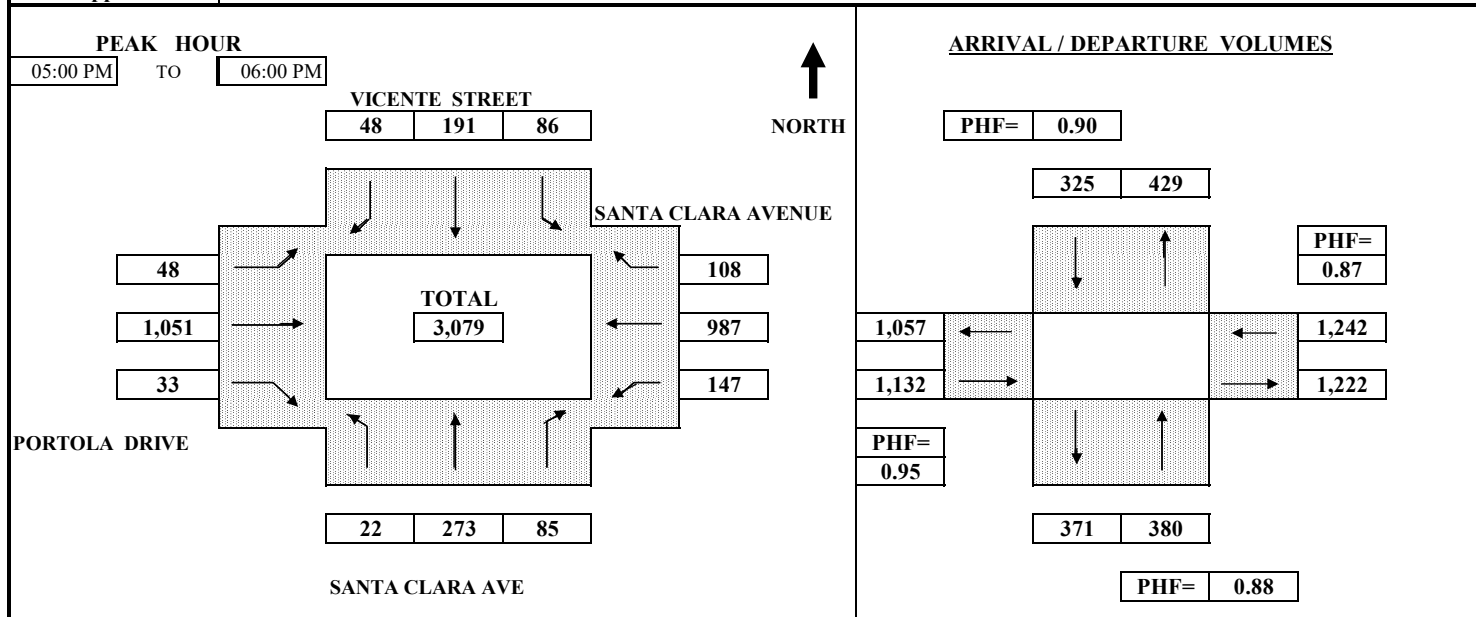

TIME PERIOD		NORTHBOUND			SOUTHBOUND			EASTBOUND			WESTBOUND			TOTAL
From	To	Left	Thru	Right	Left	Thru	Right	Left	Thru	Right	Left	Thru	Right	

SURVEY DATA															
4:30 PM	---	4:45 PM	5	51	22	17	30	11	9	225	5	21	246	20	662
4:45 PM	---	5:00 PM	10	113	36	33	75	21	14	495	9	53	496	41	1,396
5:00 PM	---	5:15 PM	15	176	54	52	119	35	24	734	17	89	754	62	2,131
5:15 PM	---	5:30 PM	24	246	77	78	162	49	39	1,000	23	125	1,040	95	2,958
5:30 PM	---	5:45 PM	28	311	92	96	209	59	49	1,278	32	156	1,280	112	3,702
5:45 PM	---	6:00 PM	32	386	121	119	266	69	62	1,546	42	200	1,483	149	4,475
6:00 PM	---	6:15 PM	39	439	135	133	318	78	78	1,779	45	265	1,710	180	5,199
6:15 PM	---	6:30 PM	45	507	157	147	367	90	90	2,002	55	301	1,951	205	5,917

TOTAL BY PERIOD															
4:30 PM	---	4:45 PM	5	51	22	17	30	11	9	225	5	21	246	20	662
4:45 PM	---	5:00 PM	5	62	14	16	45	10	5	270	4	32	250	21	734
5:00 PM	---	5:15 PM	5	63	18	19	44	14	10	239	8	36	258	21	735
5:15 PM	---	5:30 PM	9	70	23	26	43	14	15	266	6	36	286	33	827
5:30 PM	---	5:45 PM	4	65	15	18	47	10	10	278	9	31	240	17	744
5:45 PM	---	6:00 PM	4	75	29	23	57	10	13	268	10	44	203	37	773
6:00 PM	---	6:15 PM	7	53	14	14	52	9	16	233	3	65	227	31	724
6:15 PM	---	6:30 PM	6	68	22	14	49	12	12	223	10	36	241	25	718

HOURLY TOTALS															
4:30 PM	---	5:30 PM	24	246	77	78	162	49	39	1,000	23	125	1,040	95	2,958
4:45 PM	---	5:45 PM	23	260	70	79	179	48	40	1,053	27	135	1,034	92	3,040
5:00 PM	---	6:00 PM	22	273	85	86	191	48	48	1,051	33	147	987	108	3,079
5:15 PM	---	6:15 PM	24	263	81	81	199	43	54	1,045	28	176	956	118	3,068
5:30 PM	---	6:30 PM	21	261	80	69	205	41	51	1,002	32	176	911	110	2,959

Telephone: (510)232-1271

Fax: (510)232-1272