

SFMTA - TASC SUMMARY SHEET

PreStaff_Date: 10/1/2024 Requested_by: SFMTA Handled: Mark Manalo Section Head : MS <i>MS</i>	<input type="checkbox"/> Public Hearing Consent <input checked="" type="checkbox"/> Public Hearing Regular <input type="checkbox"/> Informational / Other <small>PH - Regular</small>	No objections: _____ Item Held: _____ Other: _____
--	---	---

Location: Valencia Street, between 15th Street to 23rd Street

Subject: Mid-Valencia Curbside Protected Bikeway Project

PROPOSAL / REQUEST:

ESTABLISH – CLASS IV BIKEWAY (PARKING PROTECTED BIKEWAY)
 Valencia Street, northbound and southbound, between 15th street and 23rd Street
 Valencia Street, east side, from 23rd Street to 58 feet southerly
 ESTABLISH – TOW-AWAY NO STOPPING ANY TIME
 Valencia Street, east side, from 23rd Street to 58 feet southerly
 ESTABLISH – NO LEFT TURN, NO U-TURNS, EXCEPT BICYCLES
 Valencia Street, northbound, at 15th Street
 Valencia Street, northbound and southbound, at 17th Street
 Valencia Street, northbound and southbound, at 18th Street
 Valencia Street, northbound and southbound, at 19th Street
 Valencia Street, northbound and southbound, at 20th Street
 Valencia Street, northbound and southbound, at 21st Street
 Valencia Street, northbound and southbound, at 22nd Street
 Valencia Street, northbound and southbound, at 23rd Street
 ESTABLISH – NO LEFT TURN, NO U-TURNS, EXCEPT MUNI and BICYCLES
 Valencia Street, northbound and southbound, at 16th Street
 ESTABLISH – RIGHT TURN ONLY
 Sparrow Street, westbound, at Valencia Street

**EXCERPT
FOR PH 2/7/25**

BACKGROUND INFORMATION / COMMENTS

Valencia Street, between 15th and 23rd streets, is currently part of the city's bike network and high injury network. The proposed project would remove the existing Class IV two-way center running bikeway pilot on Valencia Street and convert it to a parking protected bikeway and modify existing color curb mix and parklet locations in coordination with curb management and the Shared Spaces parklet program. The curb plan will also modify the color curb mix on side streets to improve parking and loading in the neighborhood.

Project proposal also includes:

- Removal of the center running bikeway between 15th and 23rd Streets
- Maintain existing pilot left-turn prohibitions along Valencia Street between 15th and 23rd Streets
- Signal modifications at 15th and 23rd streets to accommodate the new bikeway design
- New general loading zones, commercial loading zones, general meter parking, blue zones and red zones

Existing Parking/Loading Total = 227 vehicle spaces, 28 m/c spaces

Proposed Parking/Loading Total (with M/C parking) = 150 vehicles spaces, 42 m/c spaces

Existing Parklet Total = 26

Proposed Parklet Total = 24

HEARING NOTIFICATION AND PROCESSING NOTES:	ENVIRONMENTAL CLEARANCE BY: <input checked="" type="checkbox"/> SFMTA <input type="checkbox"/> Attached <input type="checkbox"/> Pending
---	--

CHECK IF PREPARING SEPARATE SFMTA BOARD CALENDAR ITEM FOR PROPOSAL:

Valencia Curbside Protected Bikeway Legislation

Bird Street, south side from 2 feet to 22 feet east of Dearborn Street
18th Street, north side from 14 feet to 34 feet west of Lexington Street
Lexington Street, west side from 0 feet to 20 feet south of 18th Street
Guerrero Street, east side from 20 feet to 40 feet south of Liberty Street

ESTABLISH – NO STOPPING ANY TIME, EXCEPT BICYCLES

ESTABLISH – BIKE SHARE STATION

15th Street, north side, from 10 feet to 75 feet east of Valencia Street (65-foot bike share station)
17th Street at Valencia Street - Bike Share Station
17th Street, north side, from 50 feet to 105 feet west of Valencia Street (55-foot bike share

station)

~~Valencia Street at 17th Street - Bike Share Station~~

~~Valencia Street, east side, from 30 feet to 56 feet north of 17th Street (26-foot bike share station)~~

~~Valencia Street at 18th Street - Bike Share Station~~

~~Valencia Street, west side, from 90 feet to 149 feet west of Valencia Street (59-foot bike share station)~~

~~Valencia Street at 20th Street (Mission Playground) - Bike Share Station~~

~~21st Street at Valencia Street - Bike Share Station~~

~~21st Street, south side, from 15 feet to 77 feet west of Valencia Street (62-foot bike share station)~~

22nd Street at Valencia Street - Bike Share Station

22nd Street, south side, from 10 feet to 62 feet west of Valencia Street (52-foot bike share station)

ESTABLISH – NO STOPPING ANY TIME, EXCEPT BICYCLES

ESTABLISH – BIKE SHARE STATION

Valencia Street, west side, from 90 feet to 149 feet south of 18th Street (59-foot bike share station)

Valencia Street, west side, from 88 feet to 150 feet north of 20th Street (62-foot bike share station)

21st Street, south side, from 15 feet to 77 feet east of Valencia Street (62-foot bike share station)

Valencia Street, west side, from 14 feet to 31 feet north of Hill Street
ESTABLISH – GREEN METER, 30-MINUTE LIMIT, 9AM to 6PM, MONDAY THROUGH SATURDAY

Valencia Street, east side, from 44 feet to 67 feet south of 17th Street

18th Street, south side, from 20 feet to 52 feet west of Valencia Street

Valencia Street, west side, from 23 feet to 59 feet north of 22nd Street

ESTABLISH – METERED MOTORCYCLE PARKING, 9 AM TO 6 PM, MONDAY THROUGH SATURDAY

Valencia Street, west side, from 44 feet to 62 feet south of 15th Street

Valencia Street, west side, from 93 feet to 114 feet south of 15th Street

Valencia Street, west side, from 120 feet to 123 feet north of 16th Street

Valencia Street, east side, from 11 feet to 21 feet north of Sparrow Street

Valencia Street, east side from 94 feet to 105 feet south of 15th Street

Valencia Street, west side, from 38 feet to 41 feet south of 16th Street

Valencia Street, west side, from 191 feet to 197 feet south of 16th Street

Valencia Street, east side, from 189 feet to 195 feet north of 17th Street

Valencia Street, east side, from 261 feet to 268 feet south of 16th Street

Valencia Street, east side, from 38 feet to 41 feet south of 16th Street

Valencia Street, west side, from 203 feet to 209 feet north of 19th Street

Valencia Street, west side, from 249 feet to 261 feet north of 19th Street

Valencia Street, east side from 260 feet to 269 feet south of 18th Street

Valencia Street, east side, from 383 feet to 392 feet north of 20th Street

Valencia Street, east side from 69 feet to 75 feet south of 19th Street

PROPOSED STRIPING DRAWING

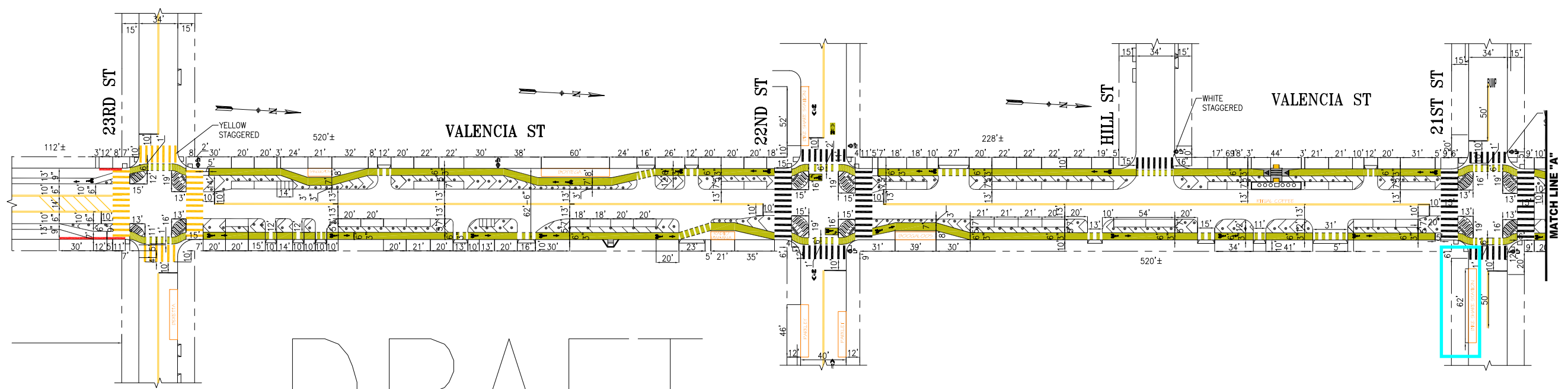

DRAFT

09/26/2024

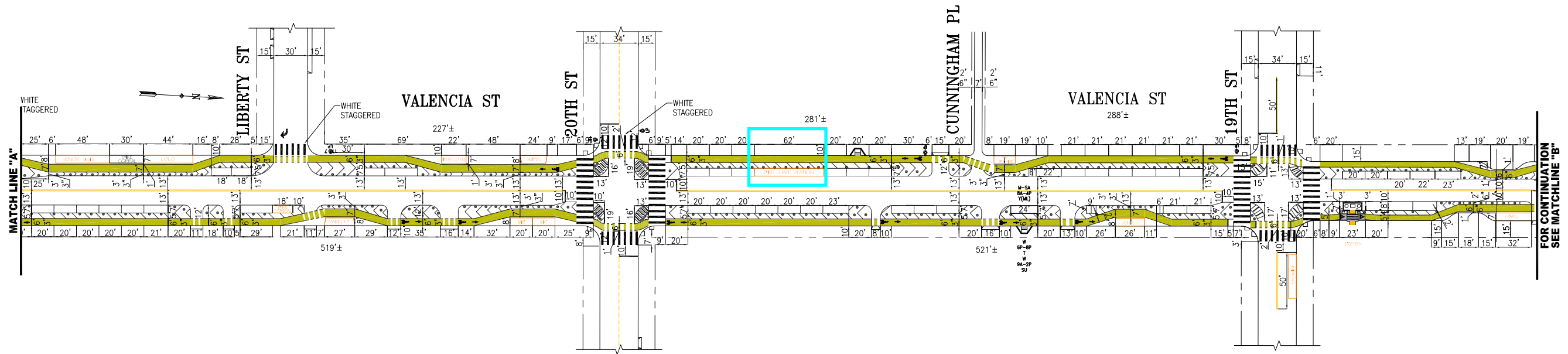

PARKING AND LOADING ON BOTH SIDES BETWEEN 15TH - 23RD STREETS

NO.	DATE	DESCRIPTION	BY	APP
TABLE OF REVISIONS CHECK WITH TRACING TO SEE IF YOU HAVE LATEST REVISION				

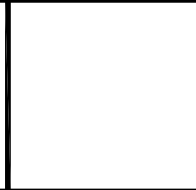

SUPERSEDES: STR-7468.2 REV4	
DRAWN: M.MANALO	DATE:
CHECKED:	DATE:

APPROVED	
SENIOR ENGINEER	DATE:
CITY TRAFFIC ENGINEER	DATE:

SCALE: 1" = 50'
SHEET/SHEETS: 01 OF 02

TRAFFIC STRIPING
VALENCIA STREET 23RD STREET TO 19TH STREET

CONTRACT NO.
DRAWING NO. DRAFT
FILE NO.
REV. NO. DRAFT

FILE NAME:
DATE:

PROPOSED STRIPING DRAWING

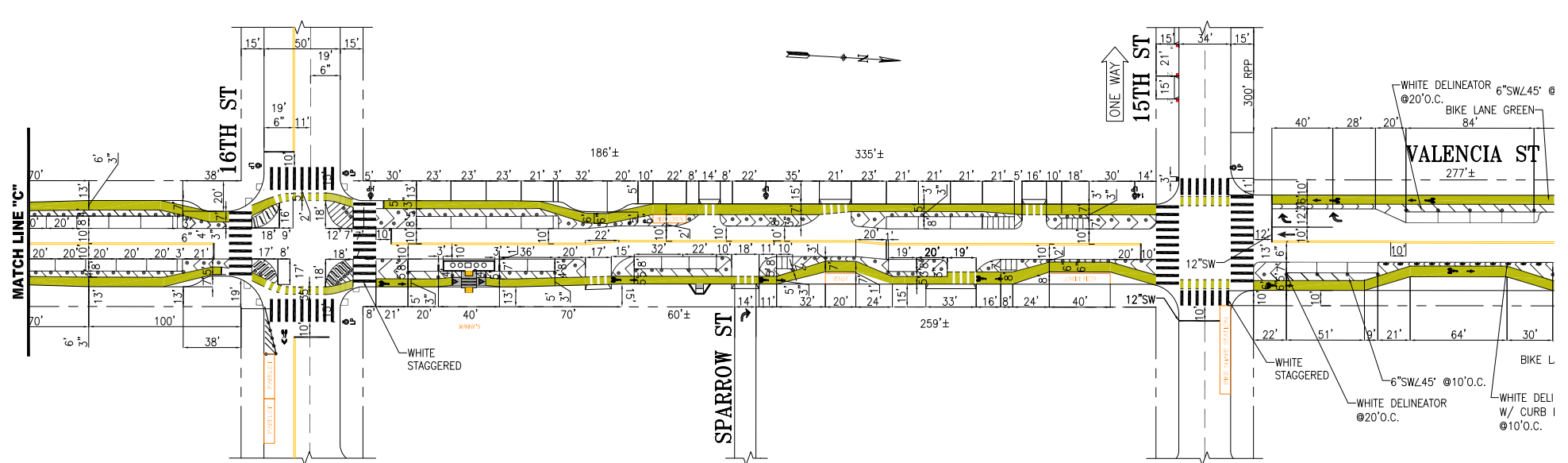
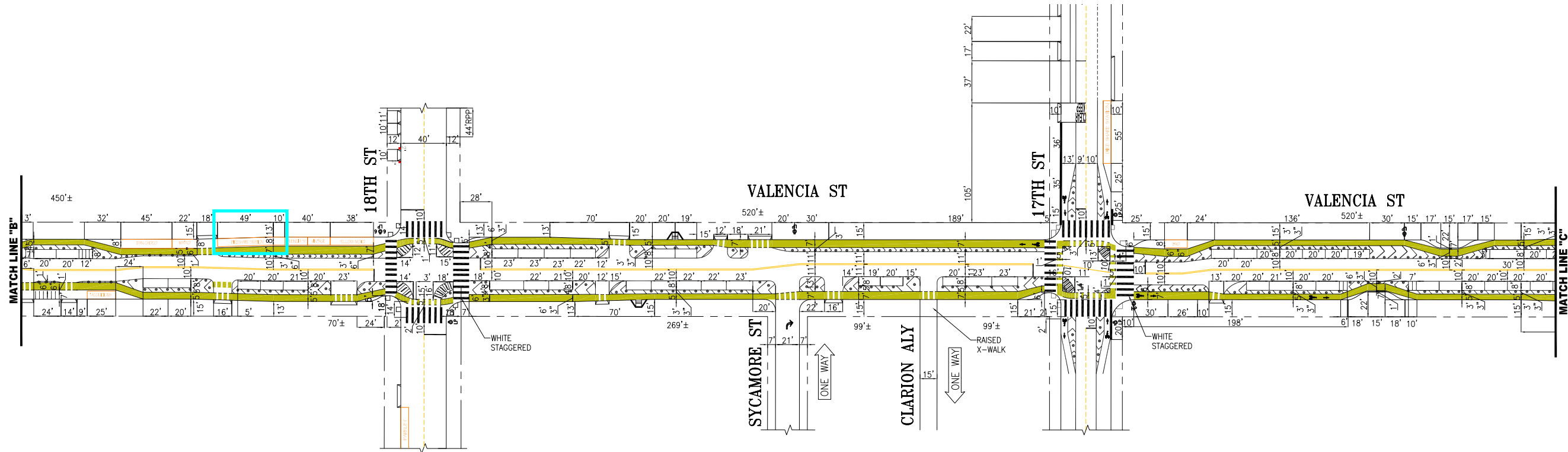

DRAFT

09/26/2024

PARKING AND LOADING ON BOTH SIDES BETWEEN 15TH – 23RD STREETS

			SUPERSEDES: STR-7468.2 REV4	APPROVED SENIOR ENGINEER	SCALE: 1" = 50'	CONTRACT NO. DRAWING NO. DRAFT
NO. DATE DESCRIPTION TABLE OF REVISIONS CHECK WITH TRACING TO SEE IF YOU HAVE LATEST REVISION			DRAWN: M.MANALO	DATE: CITY TRAFFIC ENGINEER	SHEET/SHEETS: 02 OF 02	TRAFFIC STRIPING VALENCIA STREET 19TH STREET TO 15TH STREET
			CHECKED:	DATE:		REV. NO. DRAFT

FILE NAME:
DATE: