

SFMTA - TASC SUMMARY SHEET

PreStaff_Date: 9/17/2024 Requested_by: SFMTA Handled: Grant Brokl <i>LS</i> Section Head : M Sallaberry <i>MS</i>	<input type="checkbox"/> Public Hearing Consent <input checked="" type="checkbox"/> Public Hearing Regular <input type="checkbox"/> Informational / Other <small>PH - Regular</small>	No objections: _____ Item Held: _____ Other: _____
--	---	---

Location: Bartlett Street at 22nd Street

Subject: On Street Bicycle Parking

PROPOSAL / REQUEST:

ESTABLISH – NO PARKING ANYTIME EXCEPT BICYCLES

Bartlett Street, east side, from 22nd Street to 10 feet south.

(Supervisor District 9)

This proposal would establish an on-street bicycle corral in an existing general unmetered parking space at 101 Bartlett Street.

Grant Brokl, Grant.Brokl@sfmta.com

BACKGROUND INFORMATION / COMMENTS

This proposal establishes a bike corral on the east side of Bartlett Street replacing a general unmetered parking space at the request of the Mayor's office and OEWD. This space will become daylighting on January 1st 2025 under AB 413; the proposed corral occupies this planned daylighting zone.

HEARING NOTIFICATION AND PROCESSING NOTES:

ENVIRONMENTAL CLEARANCE BY:

SFMTA Attached Pending

CHECK IF PREPARING SEPARATE SFMTA BOARD CALENDAR ITEM FOR PROPOSAL:

TASC Packet – Bike Corral
Bartlett Street at 22nd Street

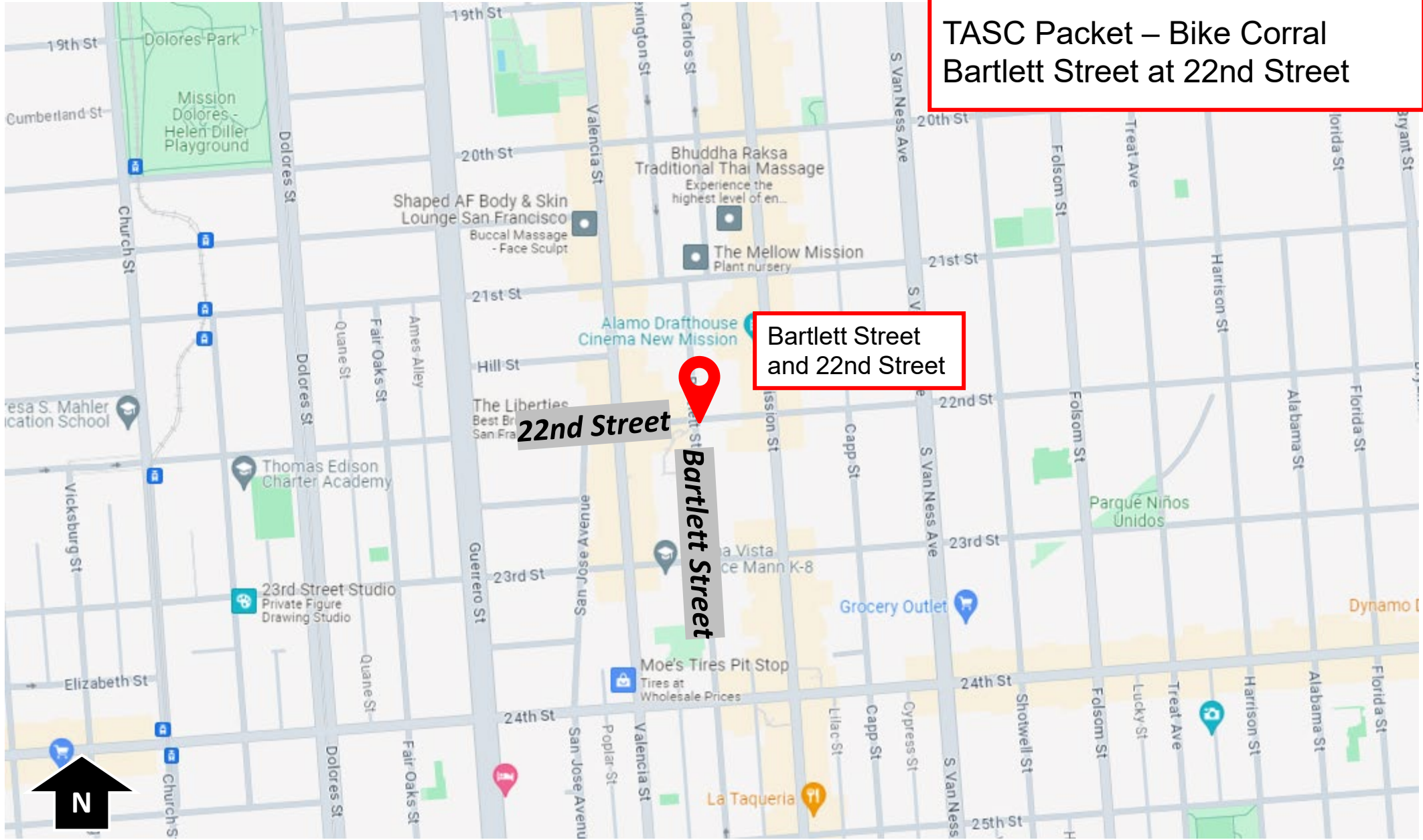

Bartlett Street
and 22nd Street

22nd Street

Bartlett Street



TASC Packet – Bike Corral
Bartlett Street at 22nd Street



Bartlett Street

22nd Street

Proposed 10'
red zone

Proposed 10'
Bike Corral



Bartlett Street, east side, from 22nd Street to 10 feet south

TASC Packet – Bike Corral
Bartlett Street at 22nd Street



22nd Street

Proposed 10'
red zone

Proposed 10'
Bike Corral

10'

Bartlett Street



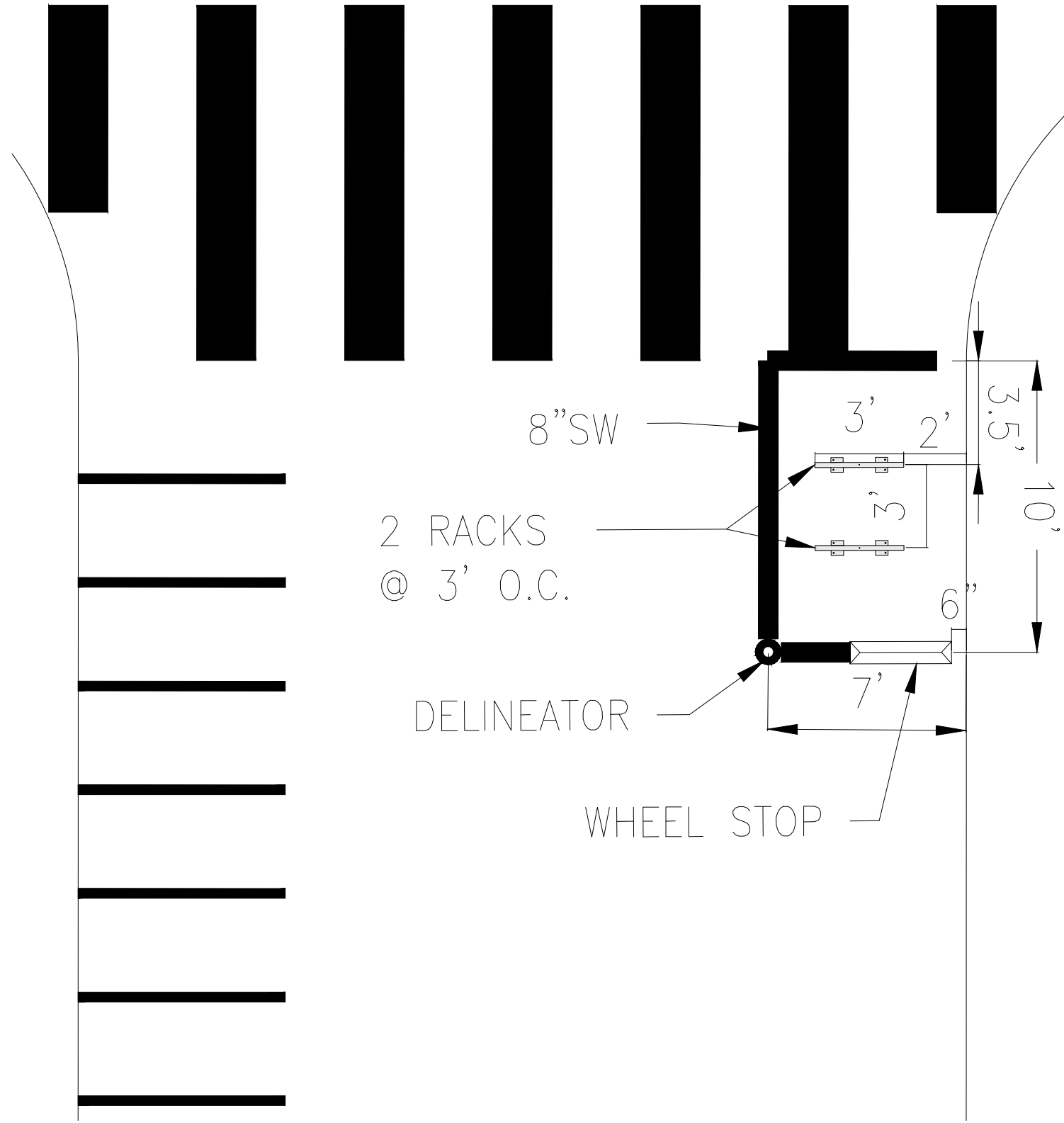

8"SW
 2 RACKS
 @ 3' O.C.

DELINEATOR

WHEEL STOP

22ND ST

BARTLETT ST



SFMTA



		APPROVED		SCALE:			CONTRACT NO.
DRAWN:	DATE:	SENIOR ENGINEER	DATE:				DRAWING NO.
CHECKED:	DATE:	CITY TRAFFIC ENGINEER	DATE:	SHEET/SHEETS:			FILE NO.
							REV. NO.

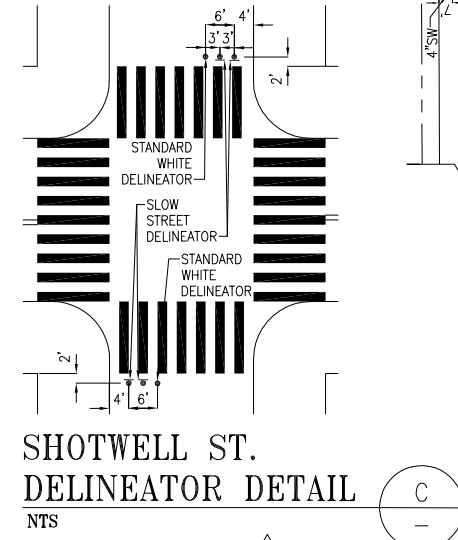
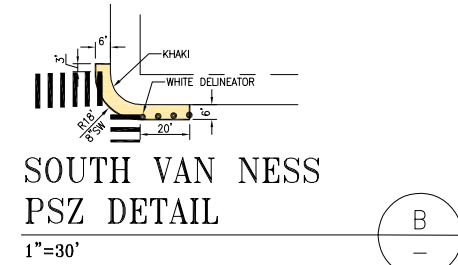
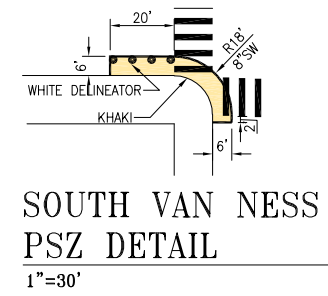
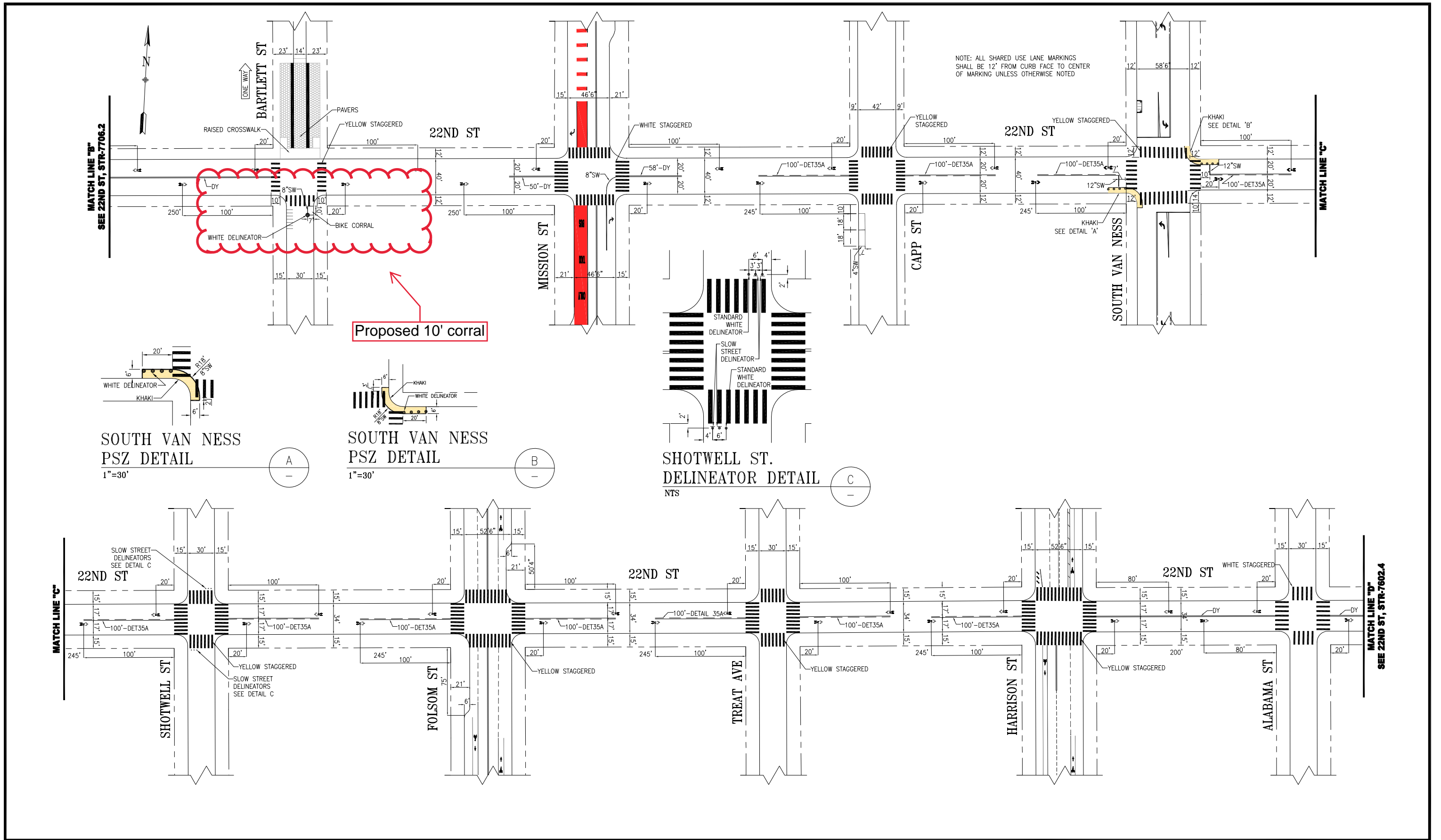

NO.	DATE	DESCRIPTION	BY	APP
1	08/03/23	WHITE STAGGERED CONTIS AT ALABAMA, PER FIELD: DY BETWEEN ALABAMA AND FLORIDA	J.SUHAIMI	A.UY
2	05/02/22	ADDED (1) CAR SHARE, & (1) TRUQIT ON CAPP ST.	T.ABDALLAH	A.R.WRIGHT
3	01/26/22	SOUTH VAN NESS AVE REDESIGNED BY SOUTH VAN NESS QUICK-BUILD	A.MATHEWS	M.SALLABERRY
4	11/23/21	PER FIELD CHECK @SVN-ADJUST XWALK WIDTHS & ADV LIM LINE LOCATIONS.	D.YEUNG	G.de Leon
5	10/15/21	ADDED SLOW STREET DELINEATORS ON SHOTWELL	E.ROBINSON	M.SALLABERRY
6	10/05/21	WIDEN XWALKS AT SVN. ADJUST PSZ	D.YEUNG	B.WOO

TABLE OF REVISIONS
CHECK WITH TRACING TO SEE IF YOU HAVE LATEST REVISION



SUPERSEDES: STR-2326.1 REV "4"	APPROVED THOMAS P. FOLKS 10/05/05 SENIOR ENGINEER	SCALE: 1" = 50'
DRAWN: T.ABDALLAH 2005	DATE: 2005	SHEET/SHEETS:
CHECKED: R.OLEA 2005	DATE: 2005	
	APPROVED JACK L FLECK 10/05/05 CITY TRAFFIC ENGINEER	

CONTRACT NO.	TRAFFIC STRIPING
DRAWING NO. STR-7706.3	
FILE NO.	
REV. NO.	
14	

22ND STREET
BARTLETT STREET TO ALABAMA STREET

FILE NAME: ---
DATE: ---

FIRE LADDER TRUCK TURN TEMPLATE



ONE WAY

BARTLETT ST

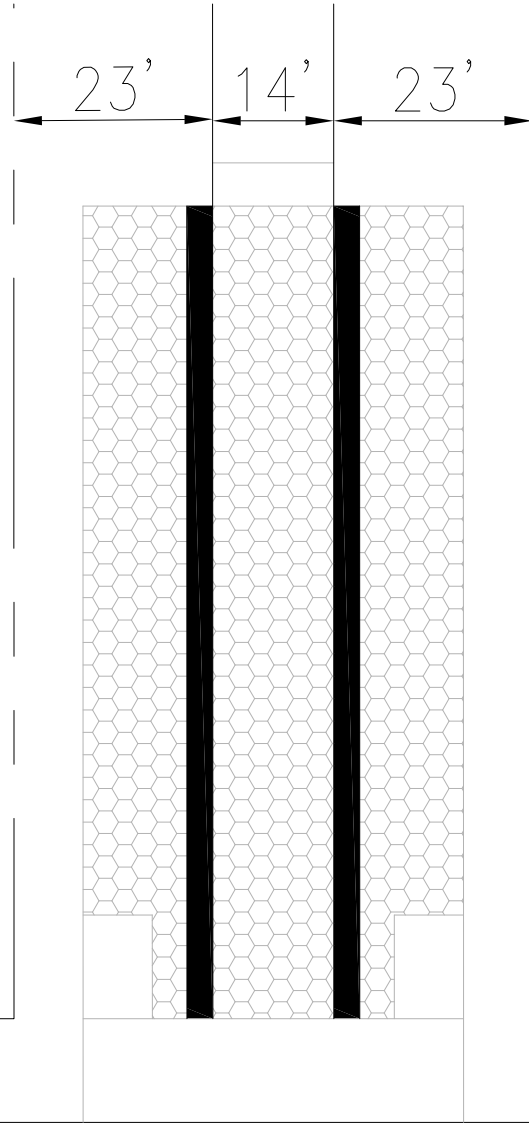

22ND ST

12'

40'

12'

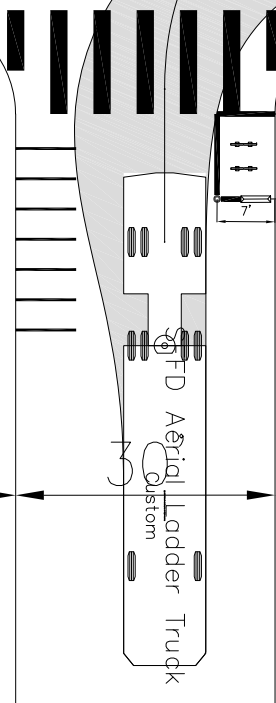
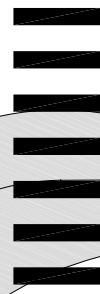
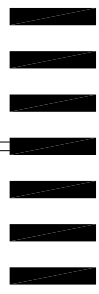

15'

30'

15'

SFFD Aerial Ladder Truck Custom



SU30 TURN TEMPLATE

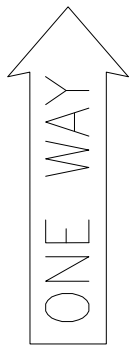

BARTLETT ST

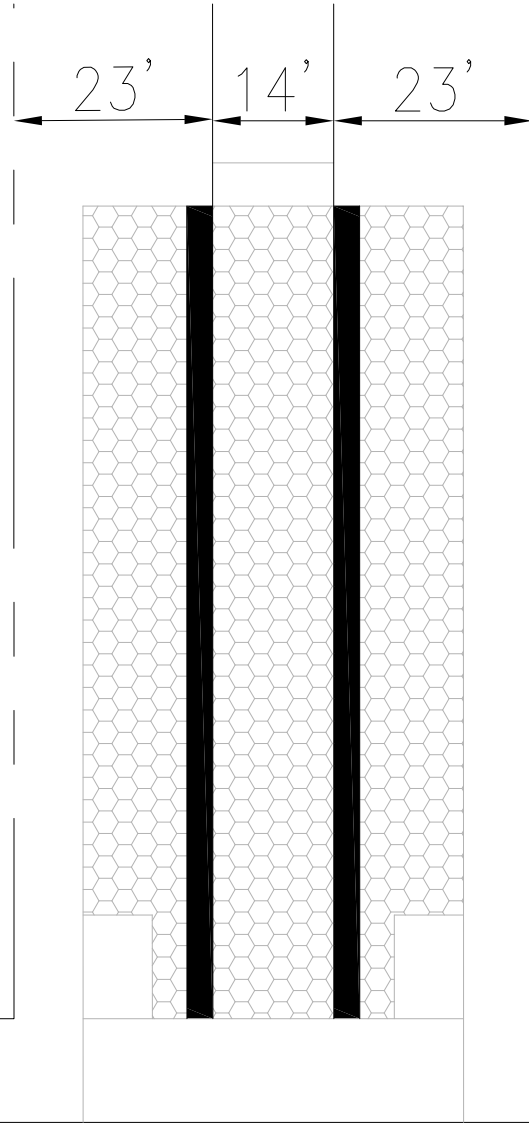

22ND ST

12'

12'

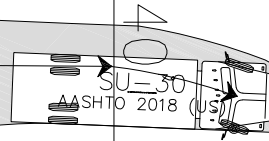
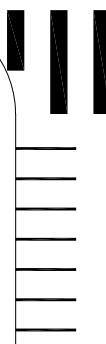

15'

30'

15'