

SFMTA - TASC SUMMARY SHEET

<p>PreStaff_Date: 2/13/2024</p> <p>Requested_by: SFMTA</p> <p>Handled: Laura Stonehill (646-4320)</p> <p>Section Head : M. Sallaberry <i>MS</i></p>	<p><input type="checkbox"/> Public Hearing Consent</p> <p><input checked="" type="checkbox"/> Public Hearing Regular</p> <p><input type="checkbox"/> Informational / Other PH - Regular</p>	<p>No objections: _____</p> <p>Item Held: _____</p> <p>Other: _____</p>
<p>Location: Vicente Street at West Portal Avenue</p>		
<p>Subject: Bike Share Station</p>		
<p>PROPOSAL / REQUEST: ESTABLISH – NO STOPPING EXCEPT BICYCLES ESTABLISH – BIKE SHARE STATION Vicente Street, south side, from 20 feet to 68 feet west of West Portal Avenue (48-foot bike share station) (Supervisor District 7)</p> <p>Proposing a Bay Wheels bike share station in the parking lane on the south side of Vicente, west of West Portal, adjacent to Starbucks.</p> <p>Laura Stonehill, laura.stonehill@sfmta.com</p>		
<p>BACKGROUND INFORMATION / COMMENTS Stations with bicycles are 6 feet long and 4 feet tall with a kiosk 7.8 feet tall and map panel at the western end of the station. Stations are solar powered via a panel system that extends vertically from the kiosk. No excavation is necessary.</p> <ul style="list-style-type: none"> - bike lane on Vicente - Muni 57-Parkmerced - 15 dock station 		
<p>HEARING NOTIFICATION AND PROCESSING NOTES:</p>	<p>ENVIRONMENTAL CLEARANCE BY: <input type="checkbox"/> SFMTA <input checked="" type="checkbox"/> Attached <input type="checkbox"/> Pending</p>	
<p>CHECK IF PREPARING SEPARATE SFMTA BOARD CALENDAR ITEM FOR PROPOSAL: <input type="checkbox"/></p>		

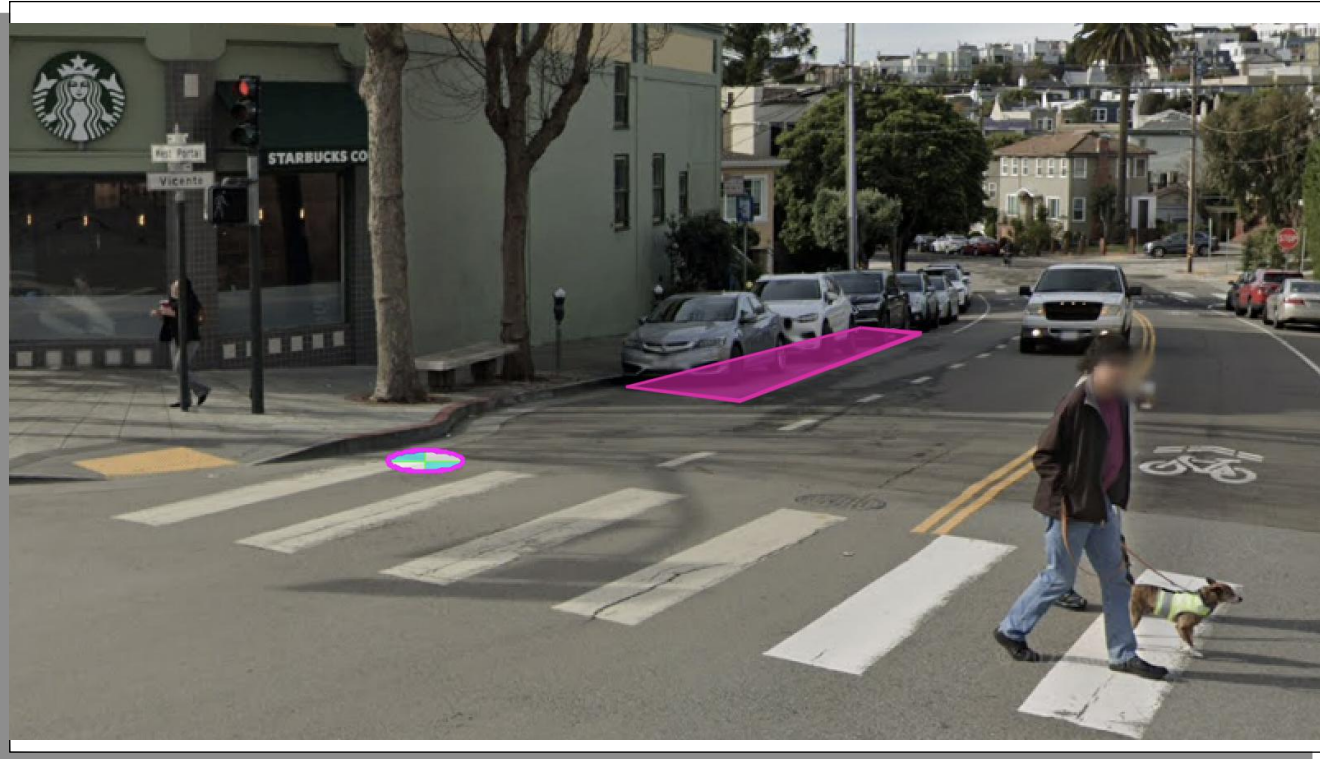

= PLAN REFERENCE POINT

SITE LOCATION
NOT TO SCALE

Stand Pipe		Parking Meters	
Fire Hydrants (High Pressure)		Tree With Grate/Well	
Fire Hydrants (Low Pressure)		Proposed Red Curb	
Street Light with Arm		Proposed Blue Curb	
Street Light		Proposed Yellow Curb	
Utility Pole		Proposed Green Curb	
Signal Pole		Proposed White Curb	

ABBREVIATIONS

BS = BUS SHELTER	TC = TRASH CAN
BR = BIKE RACK	TYP. = TYPICAL
CC = TRAFFIC SIGNAL CONTROLLER CABINET	UC = UTILITY CABINET
DI = DRAINAGE INLET	V = UTILITY VALVE
DW = DRIVEWAY	UV = UTILITY VAULT
LF = LINEAR FEET	R/C = EXISTING RED CURB
MB = MAIL BOX	B/C = EXISTING BLUE CURB
MH = MANHOLE	Y/C = EXISTING YELLOW CURB
NS = NEWSPAPER STAND	G/C = EXISTING GREEN CURB
PB = PULL BOX	W/C = EXISTING WHITE CURB
M/C = MOTORCYCLE	



VICINITY MAP
NOT TO SCALE

5 0 10
GIVEN DIMENSIONS TAKE PRECEDENCE
OVER SCALED MEASUREMENTS



West Portal Ave

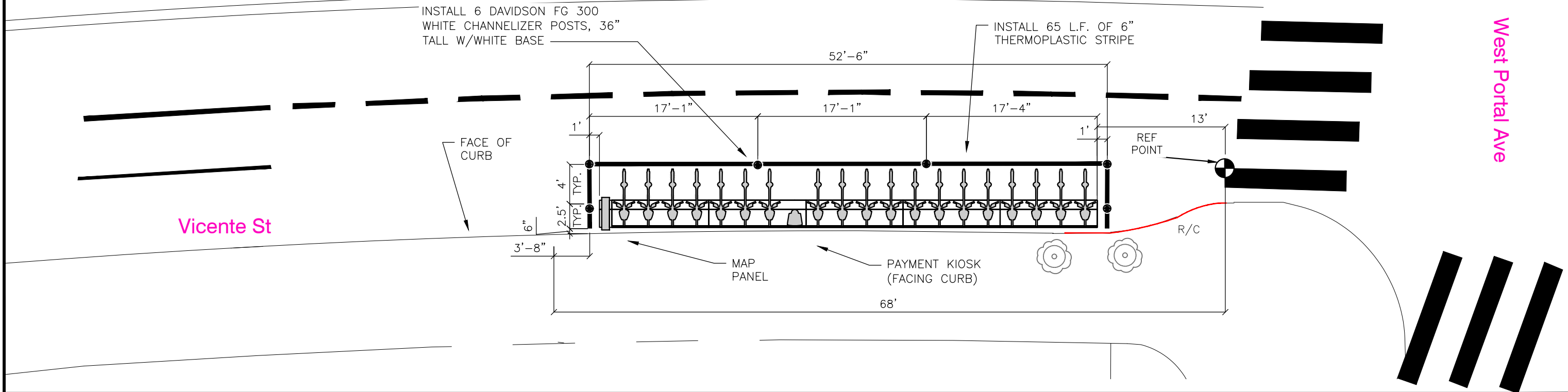
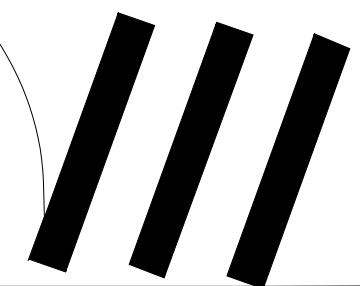

Mar. 04, 2024 CADD FILE: \\users\christophercruickshank\Desktop\site_plans\SF-U10\U10_site.dwg

REVISIONS			
NO.	DATE	DESCRIPTION	BY



DRAWN BY: CBC
DESIGNED BY: CBC
CHECKED BY: CBC
DATE: 1/8/2024
PROJECT NO:



STATION TYPE: Standard On-Street
STATION ID: SF-U10
PLATES: 5
DOCKS: 19
KIOSKS: 1

Station Site & Plan
SF-U10
Vicente Street at West Portal Avenue

Proposed bike share station on the south side of Vicente, west of West Portal



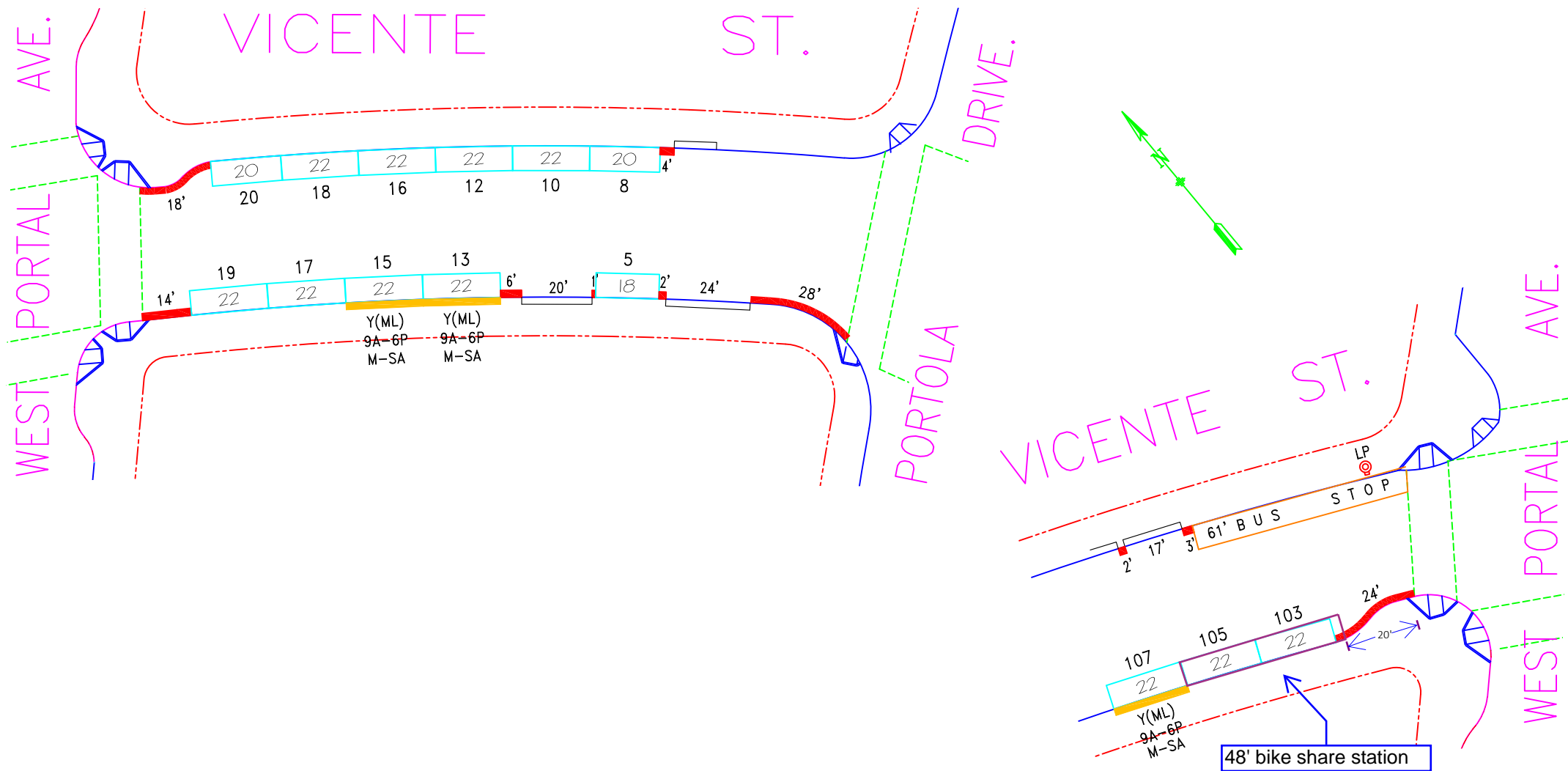

NO.	REVISION DESCRIPTION	BY	DATE	DIR/RES	4	Restore#5thru#20 & #103-#107,B/S	JB	8/24/18
2	TOS#5-#19 & #103-#107, B/S	JB	6/13/18		5	Establish BusZone,MOS#104,106-N/S	JB	8/14/20 6281
3	TOS#18, #20 for Temp.GZ, N/S	JB	7/17/18					



SAN FRANCISCO MUNICIPAL TRANSPORTATION AGENCY
 CITY AND COUNTY OF SAN FRANCISCO
 PARKING METER SPACES

SIDE	TOW-AWAY		METER CT.		GENERAL				LOADING			METERED SPACES						TOTAL
	AM	PM	SS	MS	GMP	MC	TIMES	DAYS	ML	MTL	6-W	15 MIN	30 MIN	1 HR	2 HR	10 HR		
ODD			8		5		9A-6P	M-SA	3				3		5		8	
EVEN			6		6		9A-6P	M-SA							6		6	

VICENTE ST. (VIC, 703)
(UNIT-100) BLOCK
 Meters #703-00/01XXY
EAST & WEST OF WEST PORTAL AVE.

SCALE: **1" = 40'** DATE: **9/1/18** BY: **JB**

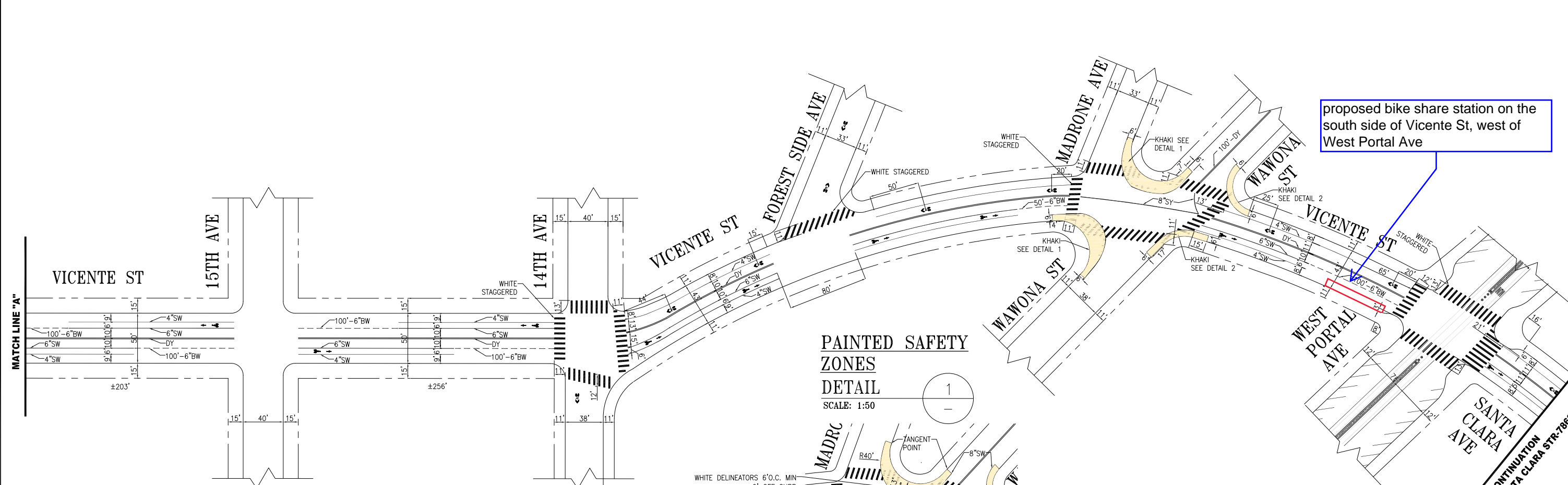
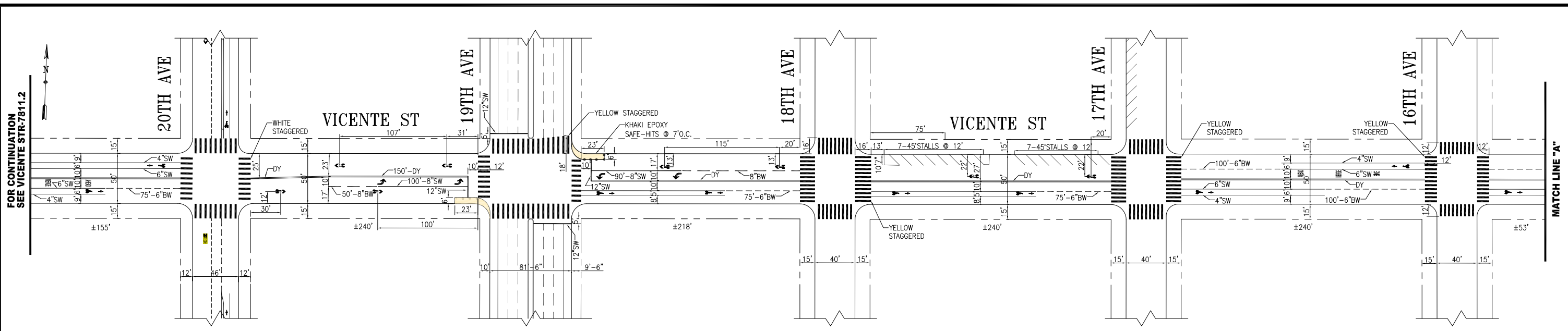
AREA 3



**PAINTED SAFETY ZONES
DETAIL**
SCALE: 1:50

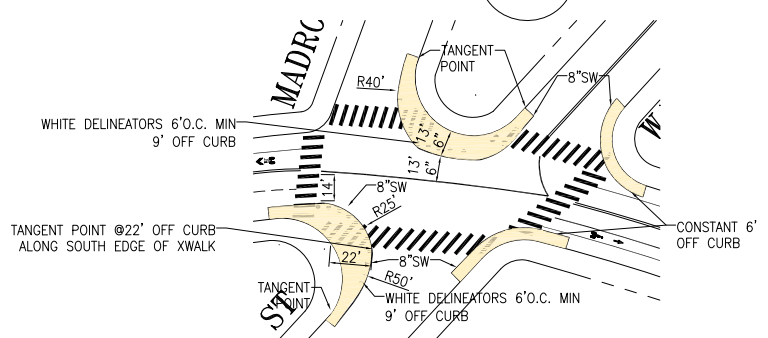

CHANGE & PER FIELD UPDATES:
 - ADJUSTED PLACEMENT OF MESSAGES, SHARROW DIM AT 20TH
 - ADDED BIKE LANES ON 20TH AVE
 - ADDED ADV. LIMIT LINE, CONTIS & SHARROWS DIMS ON 19TH
 - CONTIS DIMS @ 18TH, 14TH, WEST PORTAL
 - ADDED SHARROWS ON FOREST SIDE AVE
 - PAVEMENT MESSAGES @ WEST PORTAL

NO.	DATE	DESCRIPTION	BY	APP
09/23/17		ADD BIKE LANE AND SHARROWS ON VICENTE 14TH TO PORTAL	J.CHIMENTO	E.ROBINSON
08/28/20		PER FIELD PSZ DIMS @ WAWONA	D.CARR	P.STANIS
2020		PER FIELD UPDATES, SEE LIST ABOVE	P.LOUIE	P.STANIS
		PER FIELD: SHARROW ON 14TH AVE, WIDTH OF 14TH AVE.	P.LOUIE	P.STANIS

TABLE OF REVISIONS
CHECK WITH TRACING TO SEE IF YOU HAVE LATEST REVISION



SUPERSEDES STR-1333 REV8		APPROVED	SCALE:
DRAWN: T.ABDALLAH	DATE: 10/2009	THOMAS P FOLKS 08/16/11 SENIOR ENGINEER	1" = 50'
CHECKED: M.VELASCO	DATE: 10/2009	RICARDO OLEA 08/22/11 CITY TRAFFIC ENGINEER	SHEET/SHEETS: 04 OF 04

CONTRACT NO.
DRAWING NO.
STR-7811.3
FILE NO.
REV. NO.
9

STRIPING DRAWING
VICENTE STREET
20TH AVENUE TO WEST PORTAL AVENUE

FILE NAME
DATE: --/--

Proposed bike share station at Vicente/West Portal

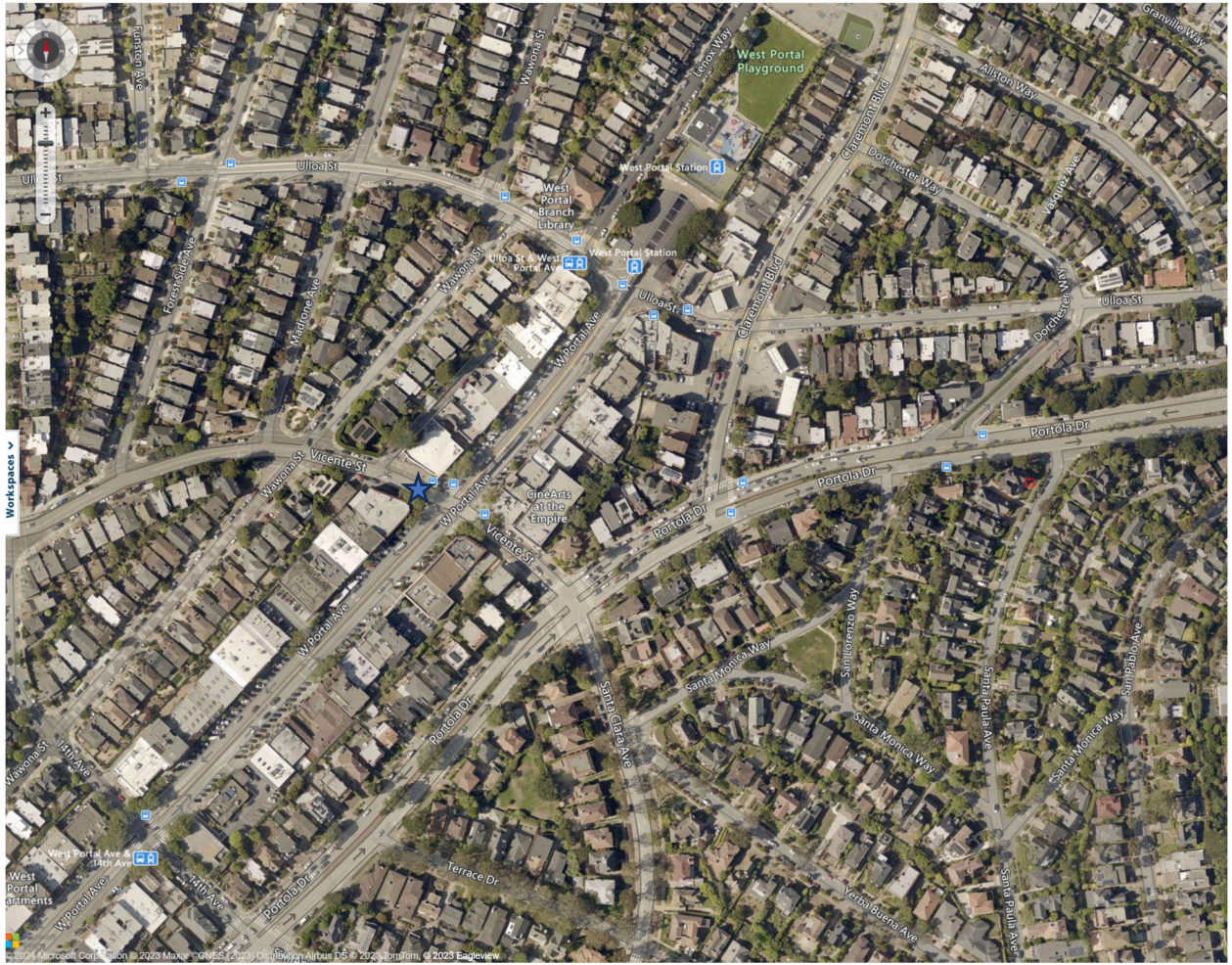

Existing bike share stations in Green

Proposed bike share stations in Blue

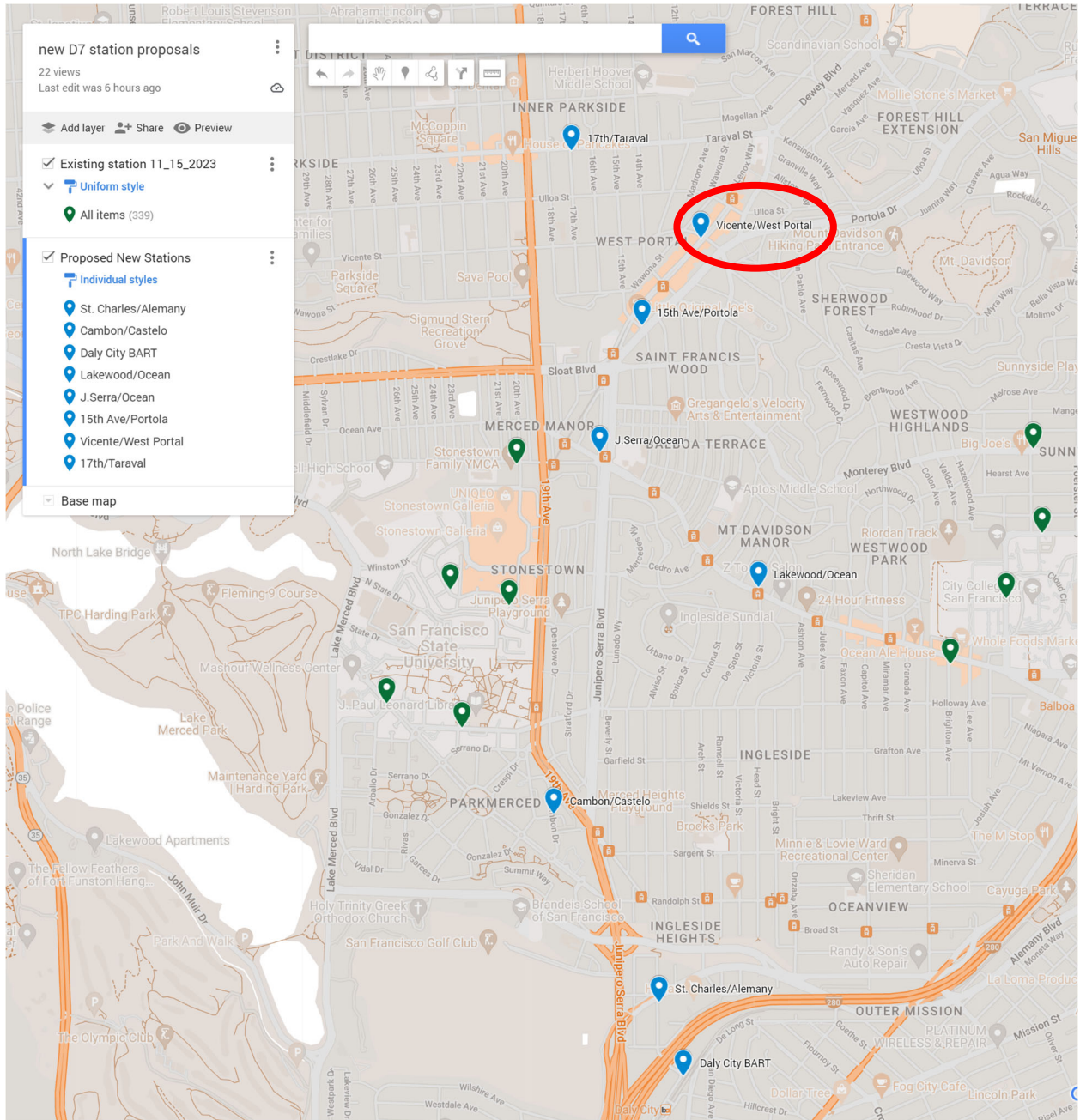

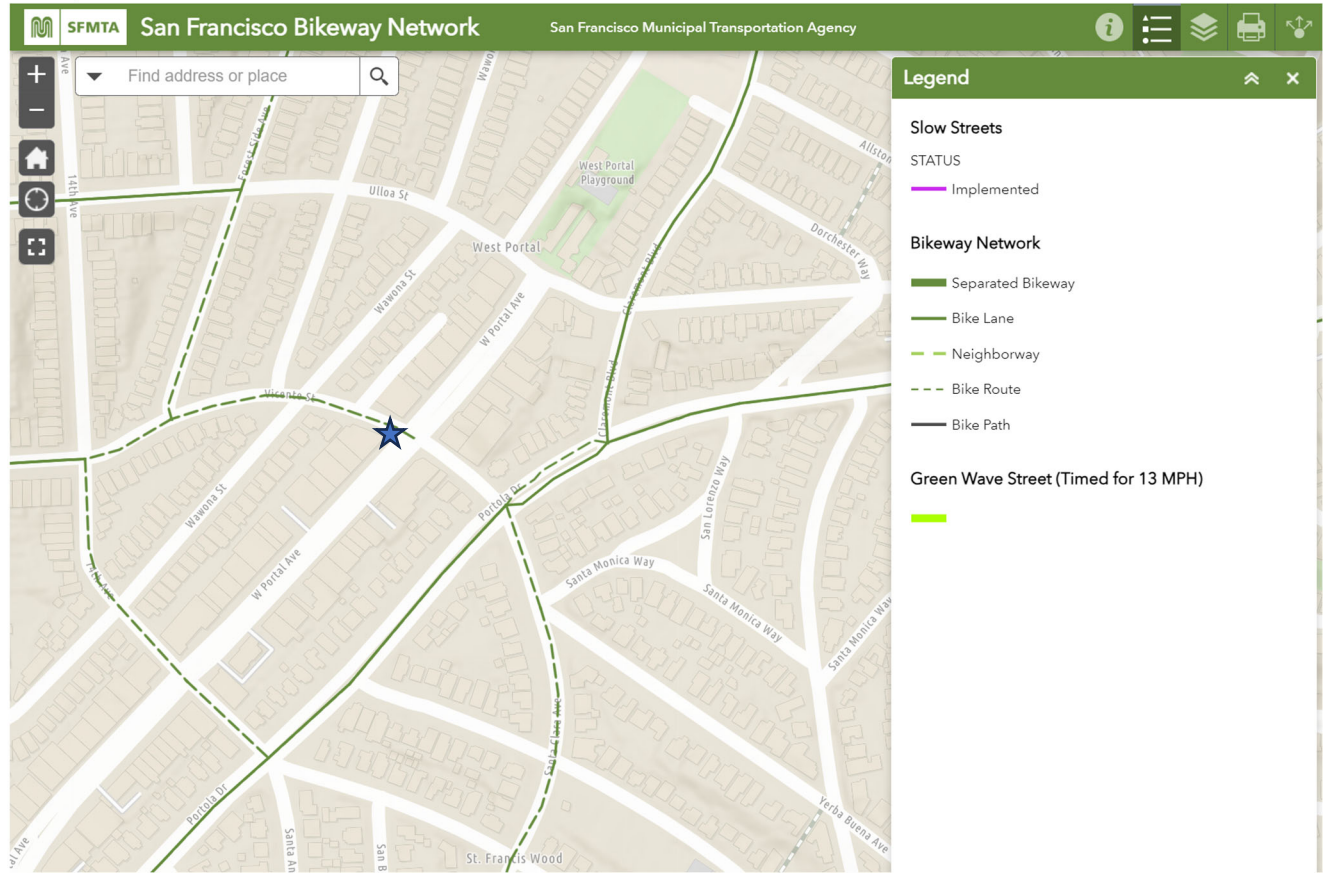

Muni Map

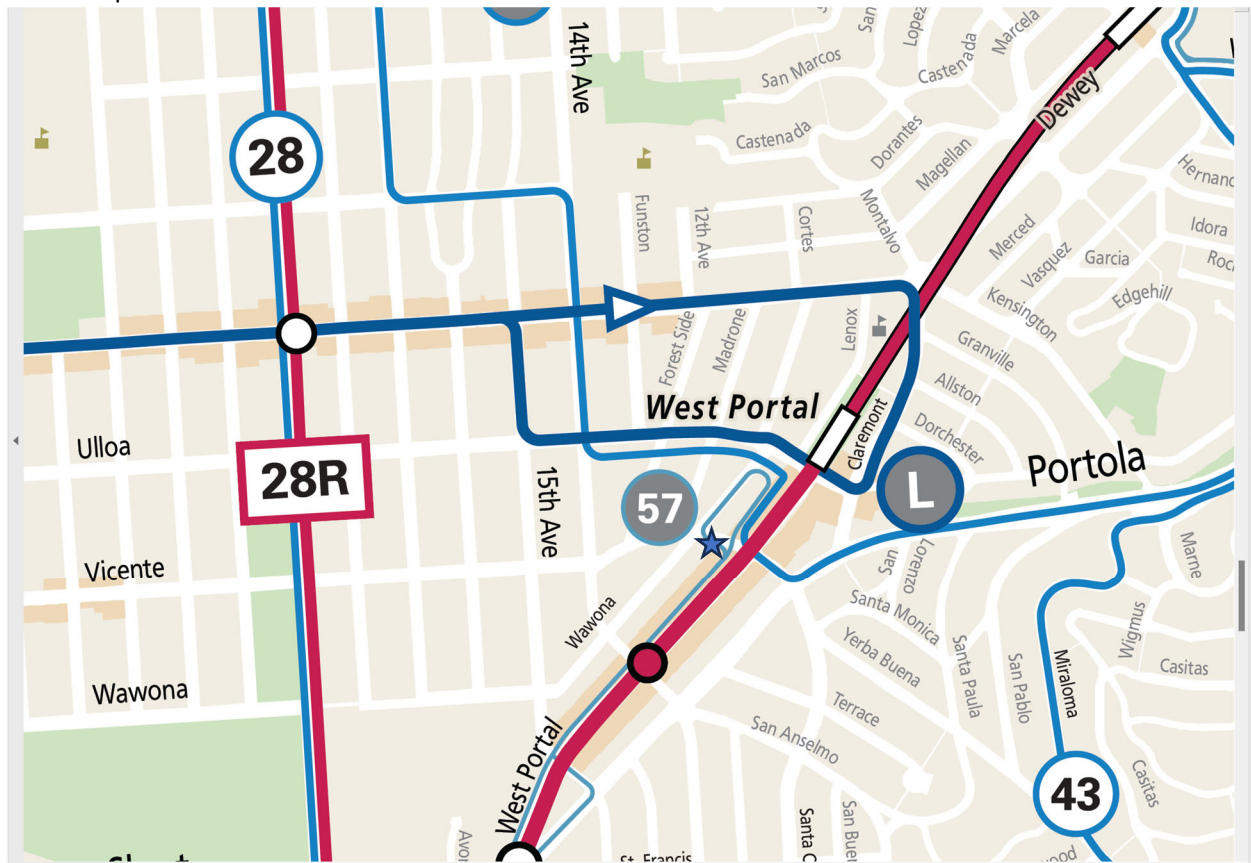



SAN FRANCISCO PLANNING DEPARTMENT

Notice of Exemption

1650 Mission St.
Suite 400
San Francisco,
CA 94103-2479

Reception:
415.558.6378

Fax:
415.558.6409

Planning
Information:
415.558.6377

DEC 22 2015
POSTED TO

Approval Date: December 18, 2015
Case No.: 2015-005492ENV, SFMTA Bay Area Bicycle Share Project
Project Title: Citywide in San Francisco, primarily within the public right-of-way
Zoning: Not applicable, primarily in the public right of way
Block/Lot: Not applicable, primarily in the public right of way
Lot Size: Not applicable, primarily in the public right of way
Lead Agency: San Francisco Planning Department
Project Sponsor: Heath Maddox, San Francisco Municipal Transportation Agency
 415-701-4789
 heath.maddox@sfmta.com
Staff Contact: Debra Dwyer
 415-575-9031
 debra.dwyer@sfgov.org

2015-0600

ENDORSED
FILED
SAN FRANCISCO County Clerk

DEC 22, 2015

by: FANNY WONG
Deputy County Clerk

To: County Clerk, City and County of San Francisco
City Hall Room 168
1 Dr. Carlton B. Goodlett Place
San Francisco, CA 94102

Pursuant to the California Environmental Quality Act (CEQA), the Guidelines of the Secretary for Resources, and San Francisco requirements, this Notice of Exemption is transmitted to you for filing. At the end of the posting period, please return this Notice to the Staff Contact with a notation of the period it was posted.

Attached fee: \$60 filing fee

PROJECT DESCRIPTION:

The San Francisco Municipal Transportation Agency (SFMTA) proposes to implement a city-wide bicycle sharing system in San Francisco as part of the regional Bay Area Bicycle Share (BABS) system described in detail below. The current regional bicycle share system in San Francisco is a pilot project managed by the Bay Area Air Quality Management District (BAAQMD). The regional BABS system will transfer to the Metropolitan Transportation Commission (MTC) for program oversight at the end of 2015. As part of a BABS pilot project initiated on August 29, 2013, the system operator installed approximately 35 bicycle share stations with input from the SFMTA, comprising 350 bicycles within the public right-of-way, located generally in the northeast section of the City. The proposed project would maintain and upgrade the existing 35 pilot bicycle share stations, and expand the BABS system within San Francisco to comprise a total of approximately 450 stations and 4,500 bicycles across the City and County of San Francisco (San Francisco).

DETERMINATION:

The City and County of San Francisco decided to carry out or approve the project on December 18, 2015. The San Francisco Board of Supervisors (BOS) approved a coordination agreement with the Metropolitan Transportation Commission (MTC), other local partners in the East and South Bay, and the bicycle share operator to carry out the Bay Area Bicycle Share Program, which would be overseen in San Francisco by the San Francisco Municipal Transportation Agency (SFMTA) on December 8, 2015. The agreement was provided to Mayor Lee for his signature and becomes effective upon signing or when ten days have passed. A copy of documents related to this action may be examined at the San Francisco Board of Supervisors, City Hall, 1 Carlton B. Goodlett Place Room 244, San Francisco, CA, 94102 in File Number 151144.

- 1. An Exemption from Environmental Review has been prepared pursuant to the provisions of CEQA under:

- Ministerial (Sec. 21080(b)(1); 15268)
- Declared Emergency (Sec. 21080(b)(3); 15269(a))
- Emergency Project (Sec. 21080(b)(4); 15269(b)(c))
- Categorical Exemption, Class 3, Section 15303
- Statutory Exemption, State code number: _____
- Community Plan Exemption (Sec. 21083.3; 15183)

- 2. This project in its approved form has been determined to be exempt from environmental review because it would result in the installation of up to 450 bicycle sharing stations throughout San Francisco, primarily within the public right-of-way and on some parcels. The proposed individual stations are portable, modular, and would be solar and battery powered, and would thus not involve excavation or utility connections. The bicycle sharing station equipment is small in scale and massing relative to surrounding buildings or sites. Bicycle facilities and infrastructure are common sights within the urban environment. There would be no potential for significant environmental impacts at either a project or cumulative level. Therefore, the proposed project would be exempt from environmental review under Class 3.

John Rahaim
Planning Director

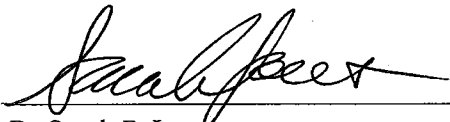
By Sarah B. Jones
Environmental Review Officer

December 22, 2015
Date

cc: Heath Maddox, SFMTA
Interested parties