

SFMTA - TASC SUMMARY SHEET

PreStaff_Date: 6/13/2023 Requested_by: SFMTA Handled: Laura Stonehill (646-4320) Section Head : M. Sallaberry <i>MS</i>	<input type="checkbox"/> Public Hearing Consent <input checked="" type="checkbox"/> Public Hearing Regular <input type="checkbox"/> Informational / Other <small>PH - Regular</small>	No objections: _____ Item Held: _____ Other: _____
Location: Waller Street at Shrader Street		
Subject: Bike Share Station		
PROPOSAL / REQUEST: ESTABLISH - NO STOPPING EXCEPT BICYCLES ESTABLISH - BIKE SHARE STATION Waller Street, south side, from Shrader Street to 80 feet westerly (72-foot station with red zones on either side) (Supervisor District 5) Legislation for the bike share station that has already been shifted from the parking lane on the north side of Waller Street, east of Stanyan, to the parking lane on the south side of Waller Street, west of Shrader, adjacent to Shrader Quality Cleaners. The previous station was relocated in June 2023 due to construction at the adjacent parcel, which is expected to take a couple years. Laura Stonehill, laura.stonehill@sfmta.com		
BACKGROUND INFORMATION / COMMENTS The Bay Wheels station on the north side of Waller, east of Stanyan was installed in Feb 2022. The adjacent parcel, formerly a McDonalds, is being redeveloped as housing with a childcare facility. The current bike share station footprint will not be available during construction, nor after construction, as there will be a loading zone for the childcare facility in this spot. The station was moved in early June 2023 and this is follow up legislation after that emergency move. This legislation relocates the bike share station to the parking lane across the street and at the other end of the block, adjacent to Shrader Quality Cleaners, replacing unmetered gray curb. The original station was 17 docks because of driveways and limited length available. This new station is for 27 docks which will better meet the demand here. - This site is located on a street with no bike facilities - This site is located on a street with no MUNI lines. Grid L15 27-dock station		
HEARING NOTIFICATION AND PROCESSING NOTES:	ENVIRONMENTAL CLEARANCE BY: <input type="checkbox"/> SFMTA <input checked="" type="checkbox"/> Attached <input type="checkbox"/> Pending	
CHECK IF PREPARING SEPARATE SFMTA BOARD CALENDAR ITEM FOR PROPOSAL: <input type="checkbox"/>		



Stand Pipe
 Fire Hydrants (High Pressure)
 Fire Hydrants (Low Pressure)
 Street Light with Arm
 Street Light
 Utility Pole
 Signal Pole

Parking Meters
 Tree With Grate/Well
 Proposed Red Curb
 Proposed Blue Curb
 Proposed Yellow Curb
 Proposed Green Curb
 Proposed White Curb

PM
 R/C
 B/C
 Y/C
 G/C
 W/C

ABBREVIATIONS

BS = BUS SHELTER
 BR = BIKE RACK
 CC = TRAFFIC SIGNAL CONTROLLER CABINET
 DI = DRAINAGE INLET
 DW = DRIVEWAY
 LF = LINEAR FEET
 MB = MAIL BOX
 MH = MANHOLE
 NS = NEWSPAPER STAND
 PB = PULL BOX
 M/C = MOTORCYCLE

TC = TRASH CAN
 TYP. = TYPICAL
 UC = UTILITY CABINET
 V = UTILITY VALVE
 UV = UTILITY VAULT
 R/C = EXISTING RED CURB
 B/C = EXISTING BLUE CURB
 Y/C = EXISTING YELLOW CURB
 G/C = EXISTING GREEN CURB
 W/C = EXISTING WHITE CURB

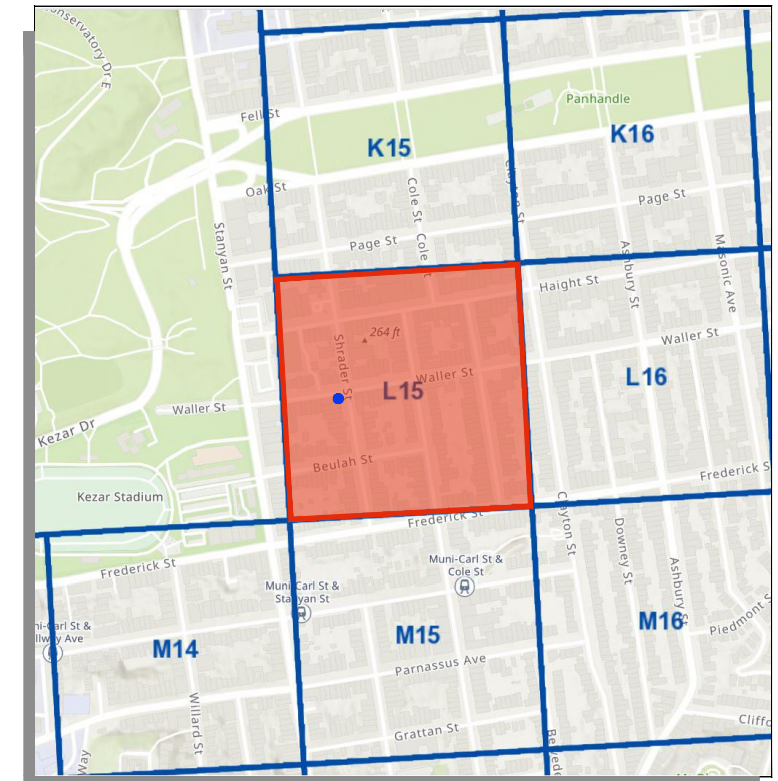

SITE NOTES

- ON-STREET SITE
- ADJACENT TO SHRADER CLEARERS (701 SHRADER ST)
- UNMETERED PARKING

⊕ = PLAN REFERENCE POINT

SITE LOCATION
NOT TO SCALE

VICINITY MAP
NOT TO SCALE

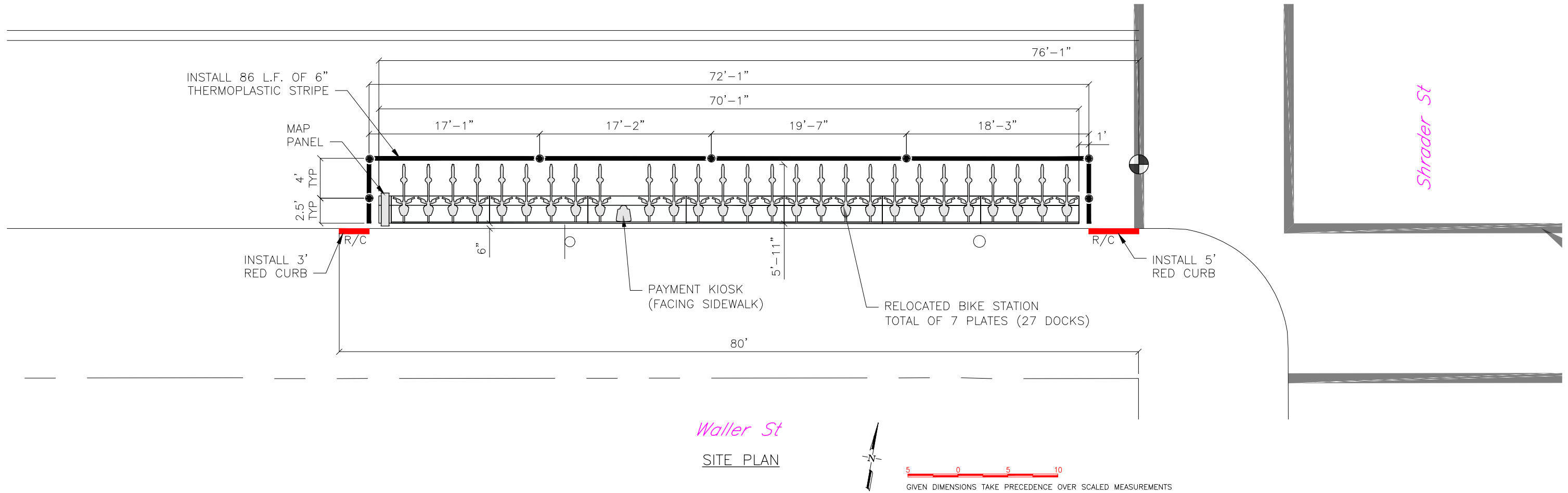

Waller St
SITE PLAN

Shrader St

REVISIONS			
NO.	DATE	DESCRIPTION	BY



DRAWN BY: **CMV**
 DESIGNED BY: **CMV**
 CHECKED BY: **CMV**
 DATE: **5/11/2023**
 PROJECT NO:



STATION TYPE:	Standard On-Street
STATION ID:	SF-L15
PLATES:	7
DOCKS:	27
KIOSKS:	1

Station Site and Plan
 SF-L15_Relocation
 WALLER ST AT SHRADER ST

Bay Wheels Network Map

Green pins = stations

Black pins = ebikes parked outside of stations

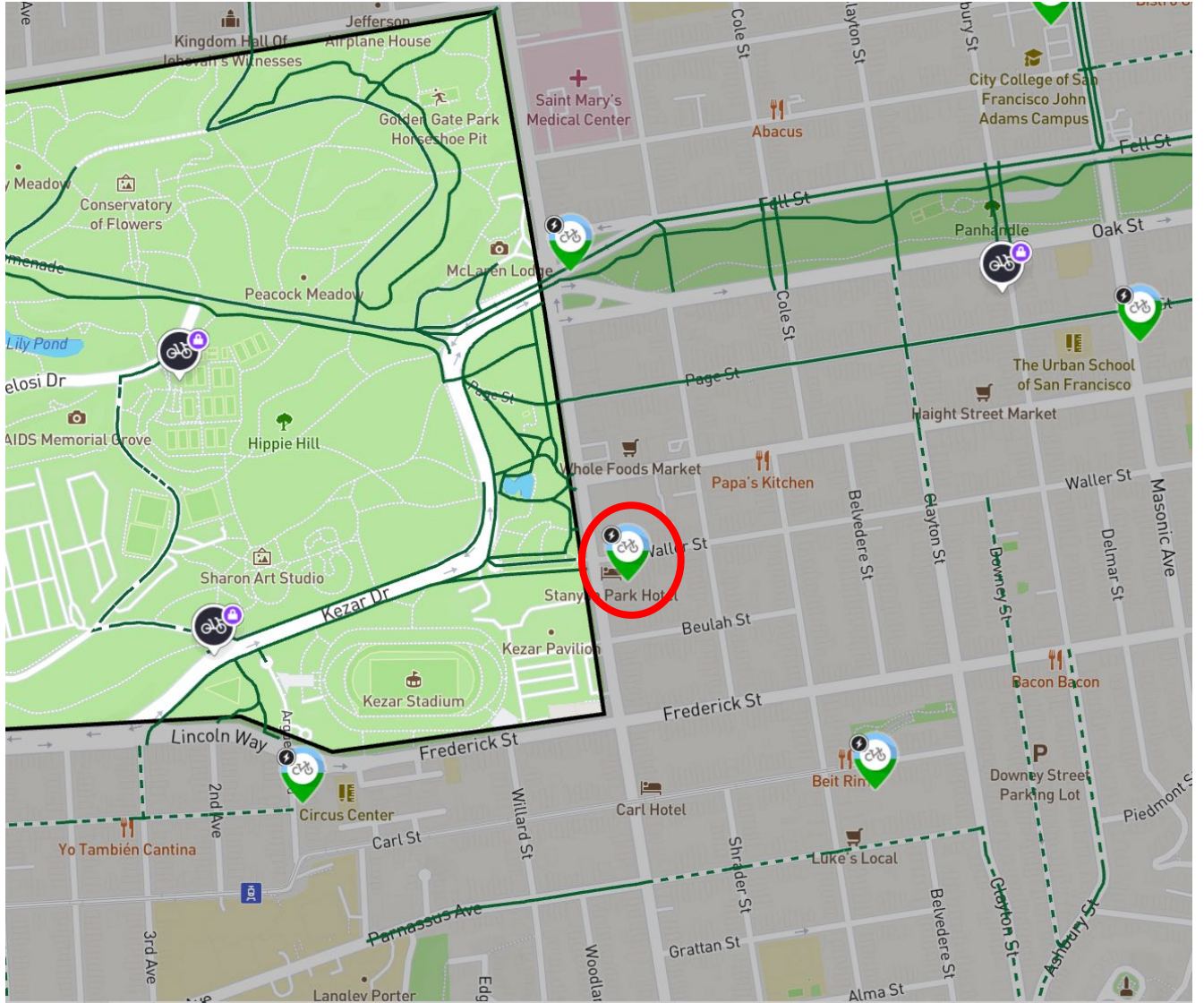

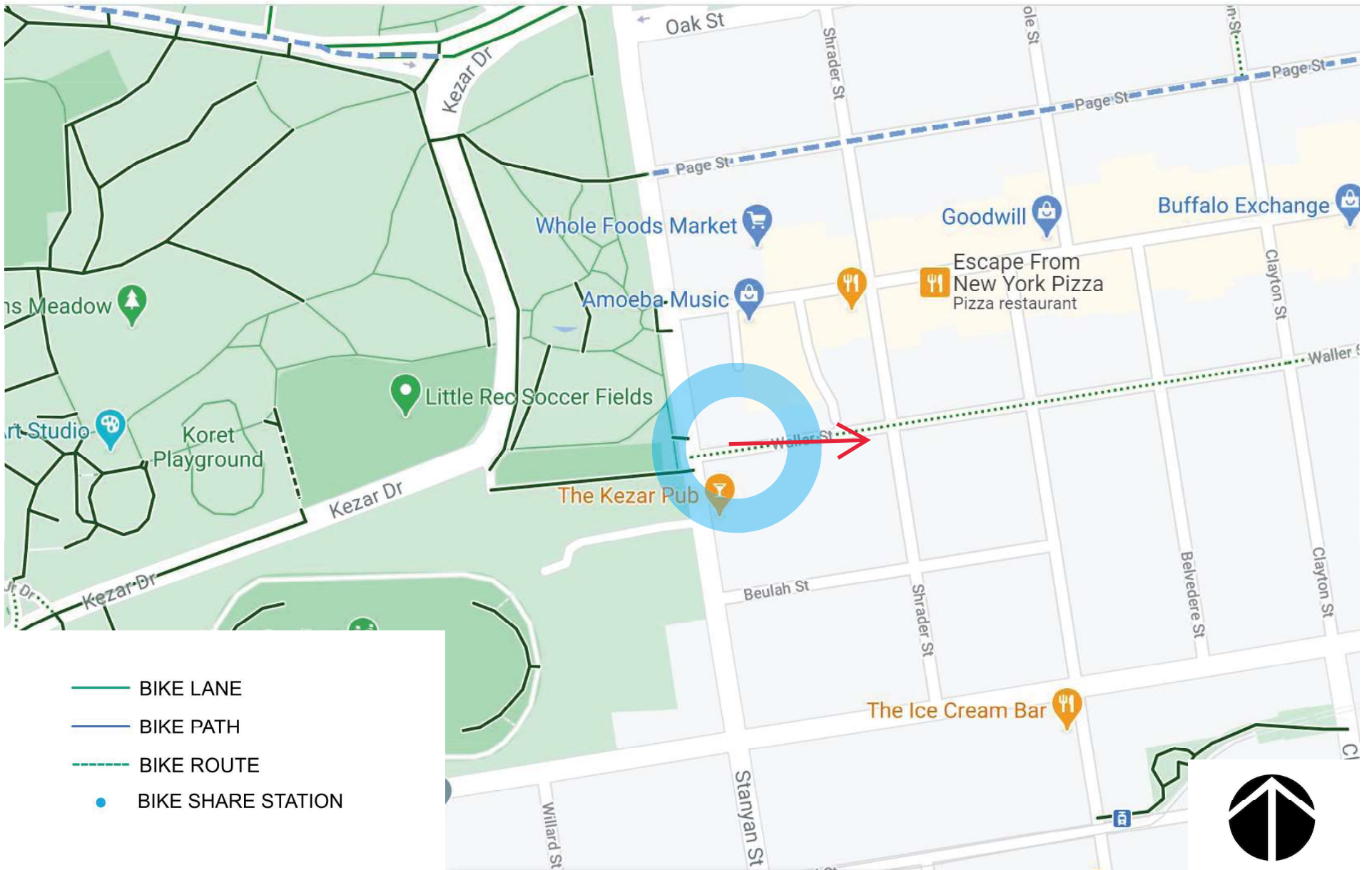

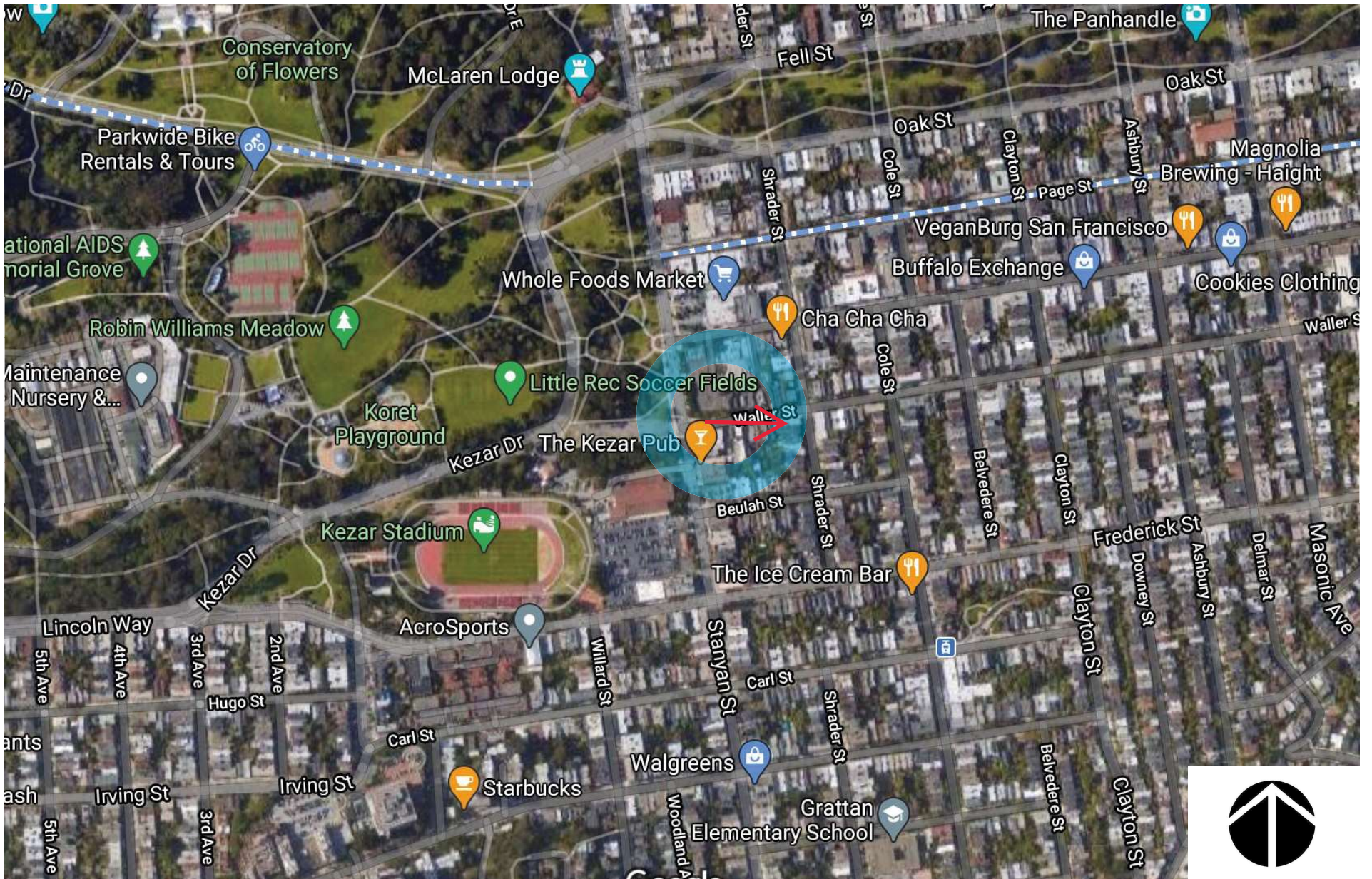

baywheels

Bay Wheels
Aerial Map

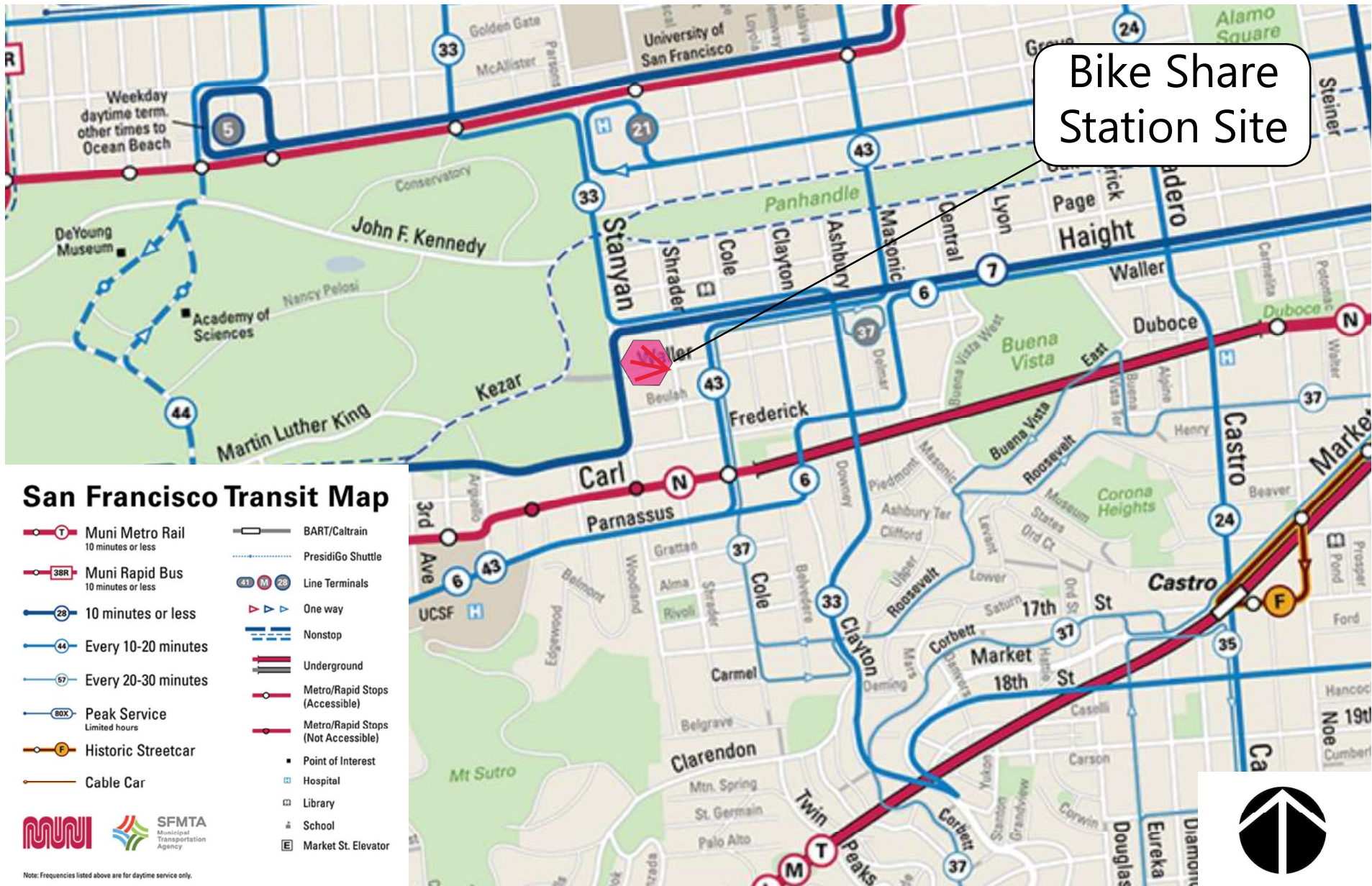

Bike Share Station Site



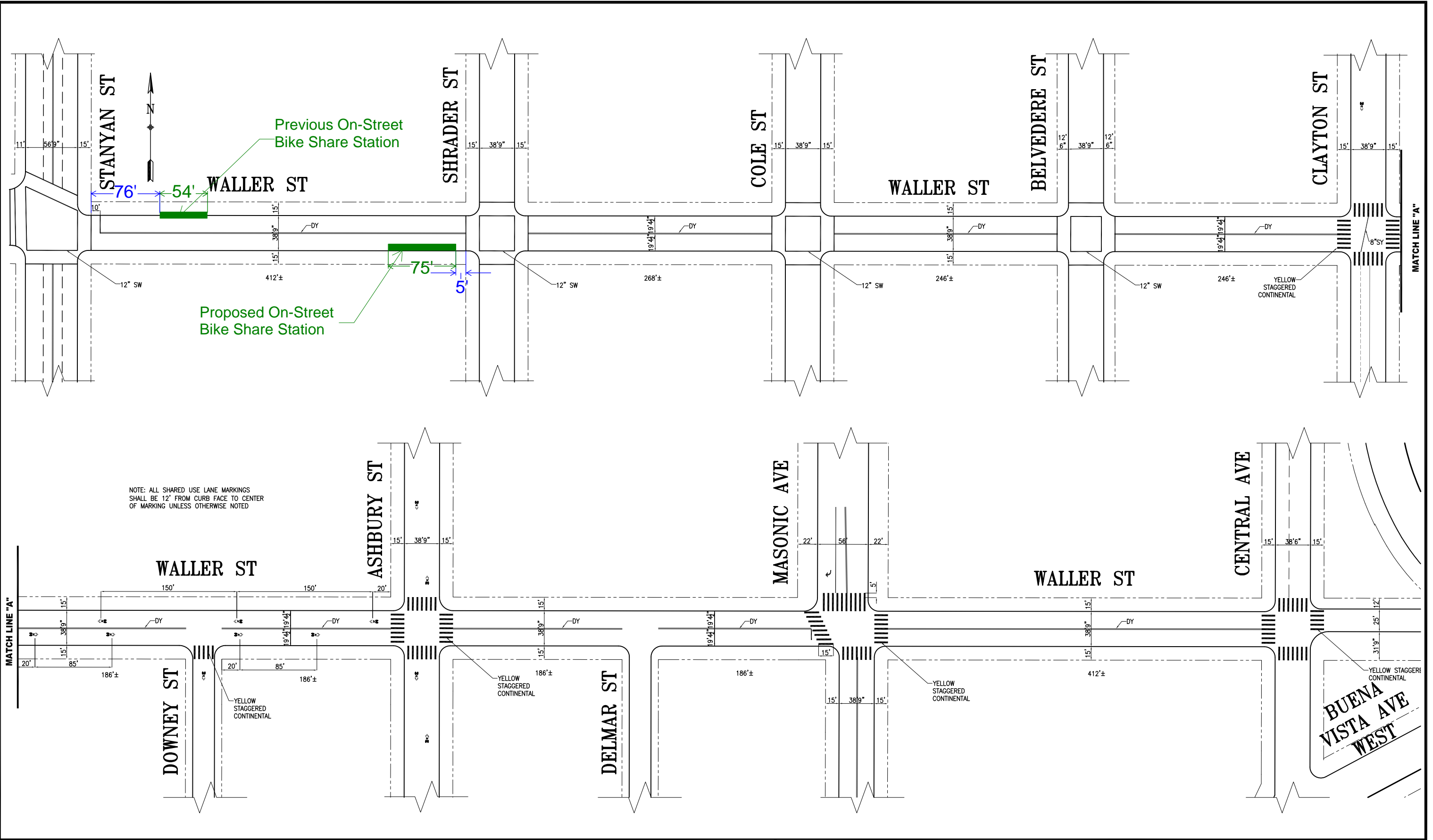

NOTE: ALL SHARED USE LANE MARKINGS SHALL BE 12" FROM CURB FACE TO CENTER OF MARKING UNLESS OTHERWISE NOTED

NO.	DATE	DESCRIPTION	BY	APP
1	11/14/18	ADVANCE LIMIT LINE AT STANYAN; EB STOP BAR AT MASONIC PER FIELD	C. WONG	B. TANNER
2	01/08/16	4" SW EDGELINE ON CLAYTON	P. LOUIE	G. DE LEON
3	10/29/15	SHARROWS BTWN/ON CLAYTON & ASHBURY PER FIELD CONDITION	P. LOUIE	G. DE LEON
4	03/07/13	PAINTED DOUBLE YELLOW-LOG 11-3331; PER FIELD CONDITION	T. ABDALLAH	B. WOO
5		WALLER ST BTWN. STANYAN & KEZAR IS CLOSED TO TRAFFIC	T. ABDALLAH	B. WOO

TABLE OF REVISIONS
CHECK WITH TRACING TO SEE IF YOU HAVE LATEST REVISION



SUPERCEDES STR-4322 REV 8

DRAWN:	T. ABDALLAH	DATE:	10/23/12
CHECKED:	B. WOO	DATE:	10/23/2012

APPROVED	
THOMAS FOLKS	10/30/12
SENIOR ENGINEER	DATE:
RICARDO OLEA	10/31/12
CITY TRAFFIC ENGINEER	DATE:

SCALE: 1" = 50'
SHEET/SHEETS: XX OF XX

TRAFFIC STRIPING
WALLER STREET
STANYAN STREET TO CENTRAL STREET

CONTRACT NO.	XXXXX
DRAWING NO.	STR-7979
FILE NO.	XXXXX
REV. NO.	4

EXTERNAL REFERENCES: XREFS
 FONTS USED: FONTS
 SCALE FACTOR: XX
 PLOT SCALE: 1"=1'
 ORIGIN: SECTION
 FILE NAME: BOC-STD2.DWG
 DATE: --/--/--



SAN FRANCISCO PLANNING DEPARTMENT

Notice of Exemption

1650 Mission St.
Suite 400
San Francisco,
CA 94103-2479

Reception:
415.558.6378

Fax:
415.558.6409

Planning
Information:
415.558.6377

DEC 22 2015
POSTED TO

Approval Date: December 18, 2015
Case No.: 2015-005492ENV, SFMTA Bay Area Bicycle Share Project
Project Title: Citywide in San Francisco, primarily within the public right-of-way
Zoning: Not applicable, primarily in the public right of way
Block/Lot: Not applicable, primarily in the public right of way
Lot Size: Not applicable, primarily in the public right of way
Lead Agency: San Francisco Planning Department
Project Sponsor: Heath Maddox, San Francisco Municipal Transportation Agency
 415-701-4789
 heath.maddox@sfmta.com
Staff Contact: Debra Dwyer
 415-575-9031
 debra.dwyer@sfgov.org

2015-0600

ENDORSED
FILED
SAN FRANCISCO County Clerk

DEC 22, 2015

by: FANNY WONG
Deputy County Clerk

To: County Clerk, City and County of San Francisco
City Hall Room 168
1 Dr. Carlton B. Goodlett Place
San Francisco, CA 94102

Pursuant to the California Environmental Quality Act (CEQA), the Guidelines of the Secretary for Resources, and San Francisco requirements, this Notice of Exemption is transmitted to you for filing. At the end of the posting period, please return this Notice to the Staff Contact with a notation of the period it was posted.

Attached fee: \$60 filing fee

PROJECT DESCRIPTION:

The San Francisco Municipal Transportation Agency (SFMTA) proposes to implement a city-wide bicycle sharing system in San Francisco as part of the regional Bay Area Bicycle Share (BABS) system described in detail below. The current regional bicycle share system in San Francisco is a pilot project managed by the Bay Area Air Quality Management District (BAAQMD). The regional BABS system will transfer to the Metropolitan Transportation Commission (MTC) for program oversight at the end of 2015. As part of a BABS pilot project initiated on August 29, 2013, the system operator installed approximately 35 bicycle share stations with input from the SFMTA, comprising 350 bicycles within the public right-of-way, located generally in the northeast section of the City. The proposed project would maintain and upgrade the existing 35 pilot bicycle share stations, and expand the BABS system within San Francisco to comprise a total of approximately 450 stations and 4,500 bicycles across the City and County of San Francisco (San Francisco).

DETERMINATION:

The City and County of San Francisco decided to carry out or approve the project on December 18, 2015. The San Francisco Board of Supervisors (BOS) approved a coordination agreement with the Metropolitan Transportation Commission (MTC), other local partners in the East and South Bay, and the bicycle share operator to carry out the Bay Area Bicycle Share Program, which would be overseen in San Francisco by the San Francisco Municipal Transportation Agency (SFMTA) on December 8, 2015. The agreement was provided to Mayor Lee for his signature and becomes effective upon signing or when ten days have passed. A copy of documents related to this action may be examined at the San Francisco Board of Supervisors, City Hall, 1 Carlton B. Goodlett Place Room 244, San Francisco, CA, 94102 in File Number 151144.

- 1. An Exemption from Environmental Review has been prepared pursuant to the provisions of CEQA under:

- Ministerial (Sec. 21080(b)(1); 15268)
- Declared Emergency (Sec. 21080(b)(3); 15269(a))
- Emergency Project (Sec. 21080(b)(4); 15269(b)(c))
- Categorical Exemption, Class 3, Section 15303
- Statutory Exemption, State code number: _____
- Community Plan Exemption (Sec. 21083.3; 15183)

- 2. This project in its approved form has been determined to be exempt from environmental review because it would result in the installation of up to 450 bicycle sharing stations throughout San Francisco, primarily within the public right-of-way and on some parcels. The proposed individual stations are portable, modular, and would be solar and battery powered, and would thus not involve excavation or utility connections. The bicycle sharing station equipment is small in scale and massing relative to surrounding buildings or sites. Bicycle facilities and infrastructure are common sights within the urban environment. There would be no potential for significant environmental impacts at either a project or cumulative level. Therefore, the proposed project would be exempt from environmental review under Class 3.

John Rahaim
Planning Director

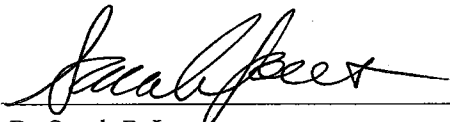
By Sarah B. Jones
Environmental Review Officer

December 22, 2015
Date

cc: Heath Maddox, SFMTA
Interested parties