

SFMTA - TASC SUMMARY SHEET

PreStaff_Date: 10/4/2022 Requested_by: SFMTA Handled: Kevin Shue <i>KS ADB</i> Section Head : CL / MV <i>DA</i>	<input type="checkbox"/> Public Hearing Consent <input checked="" type="checkbox"/> Public Hearing Regular <input type="checkbox"/> Informational / Other <small>PH - Regular</small>	No objections: _____ Item Held: _____ Other: _____
--	---	---

Location: 3rd Street and Howard St

Subject: Tow-Away, No Stopping

PROPOSAL / REQUEST:

ESTABLISH - TOW-AWAY, NO STOPPING 7AM TO 10AM AND 3PM TO 7PM MONDAY THROUGH FRIDAY
3rd Street, east side, from 26 feet to 125 feet south of Howard Street
3rd Street, east side, from 17 feet to 197 feet north of Howard Street (extends existing tow by 1 hour in AM and PM peak)

(Supervisor District 6)

Kevin Shue, kevin.shue@sfmta.com

Proposal to add and adjust tow-away no stopping hours to match the remainder of the corridor.

BACKGROUND INFORMATION / COMMENTS

Proposal to add tow-away no stopping hours to match the remainder of the corridor. This change will affect 5 metered parking spaces south of Howard Street, and 5 metered parking spaces + 68' of white curb north of Howard Street. Tow-away no stopping hours in this section are to reduce friction during peak commute hours, and this modification will standardize tow-away no stopping hours along this travel corridor. These restrictions currently exist on 3rd Street parking spaces, on the east side, on the blocks south of Folsom St and Harrison St.

8 Bayshore
Frequency: 5 (Weekday Morning/Evening) - 12 (Late Night)
8 AX Bayshore A, 8 BX Bayshore B Express
Scheduled for peak only, frequency approximately 8-12 each
15 Bayshore Hunters Point Express
Frequency: 10 (Weekday Daytime) - 20 (Weekend Morning)
30 Stockton
Frequency: 12 (Weekday Daytime) - 17 (Weekend Late Night)
45 Union/Stockton
Frequency: 11 (Weekday Morning) - 17 (Weekend Late Night)

HEARING NOTIFICATION AND PROCESSING NOTES:

ENVIRONMENTAL CLEARANCE BY:

SFMTA Attached Pending

CHECK IF PREPARING SEPARATE SFMTA BOARD CALENDAR ITEM FOR PROPOSAL:

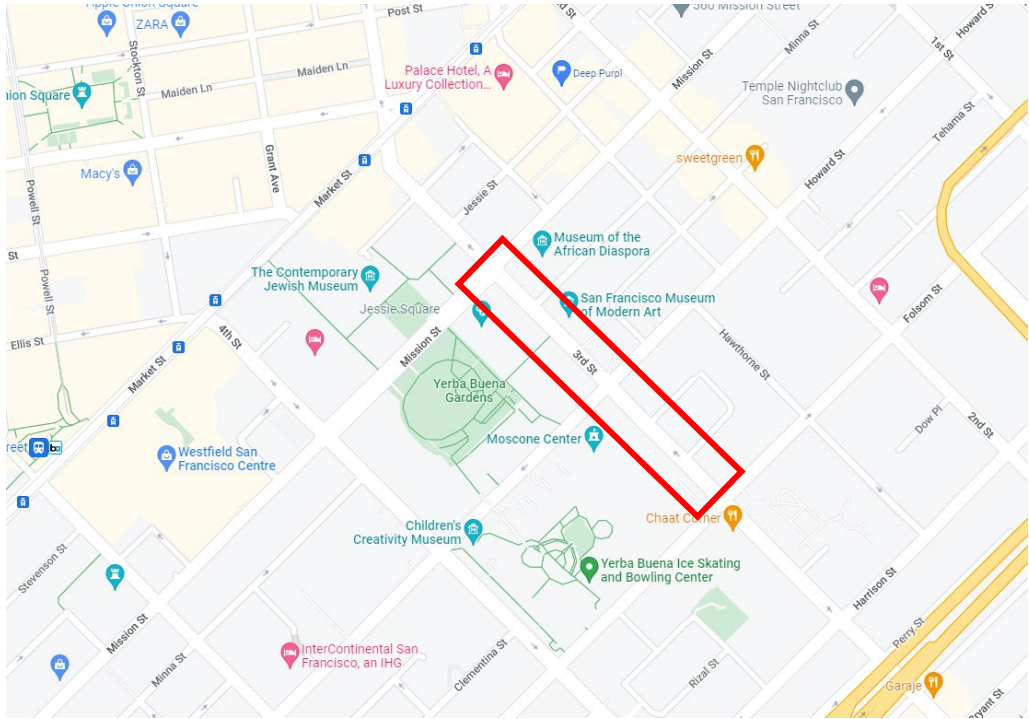
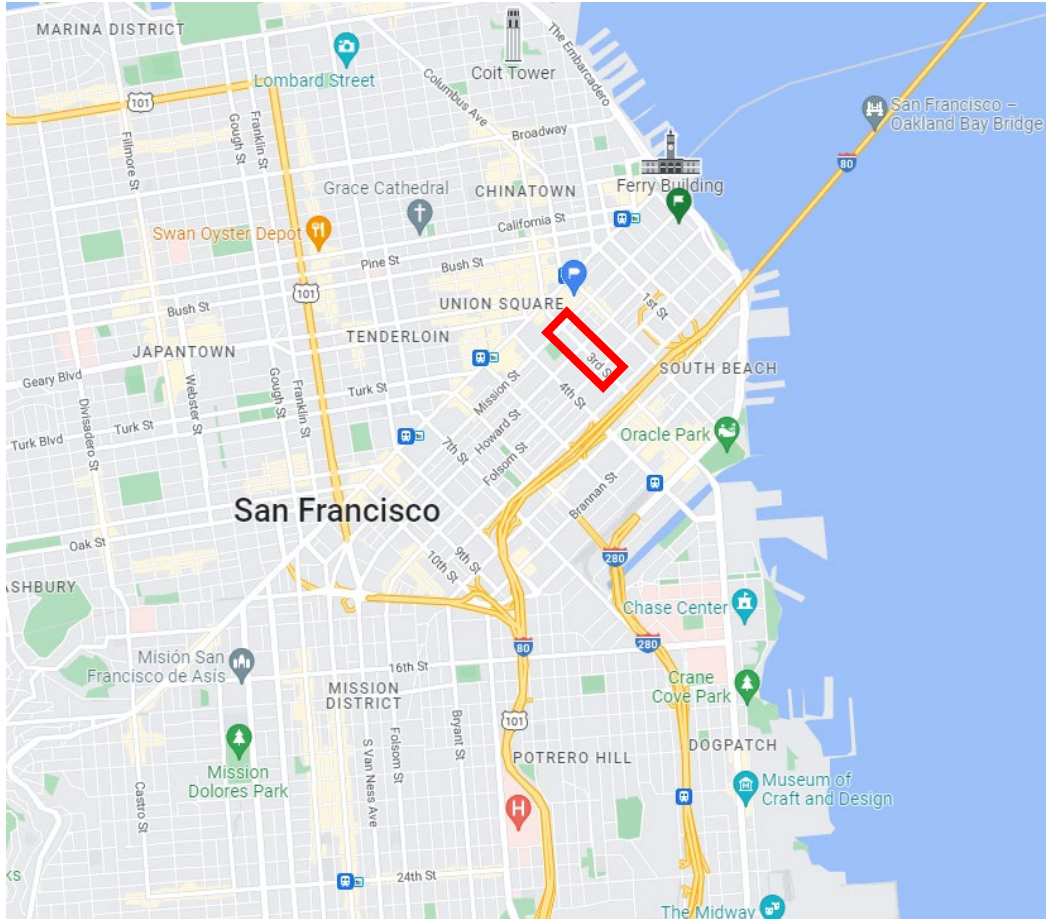

Location of 3rd Street (East Side) associated with the tow-away time changes

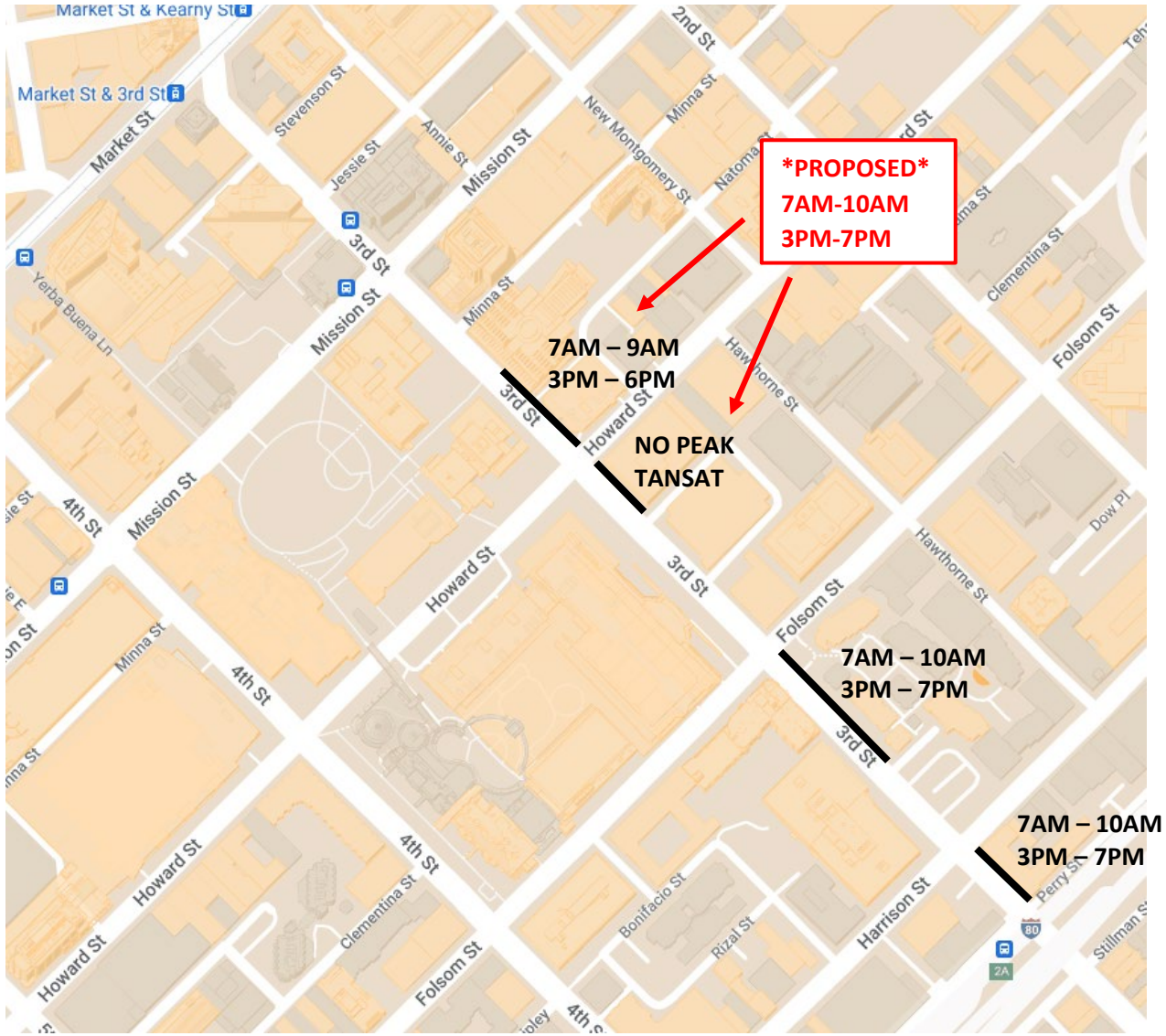

Current parking restrictions with location of proposed changes.





Looking east on 3rd Street, with the parking (5 metered spaces) on the east side, south of Howard, associated with the proposed changes. Howard Street is to the left of the image.

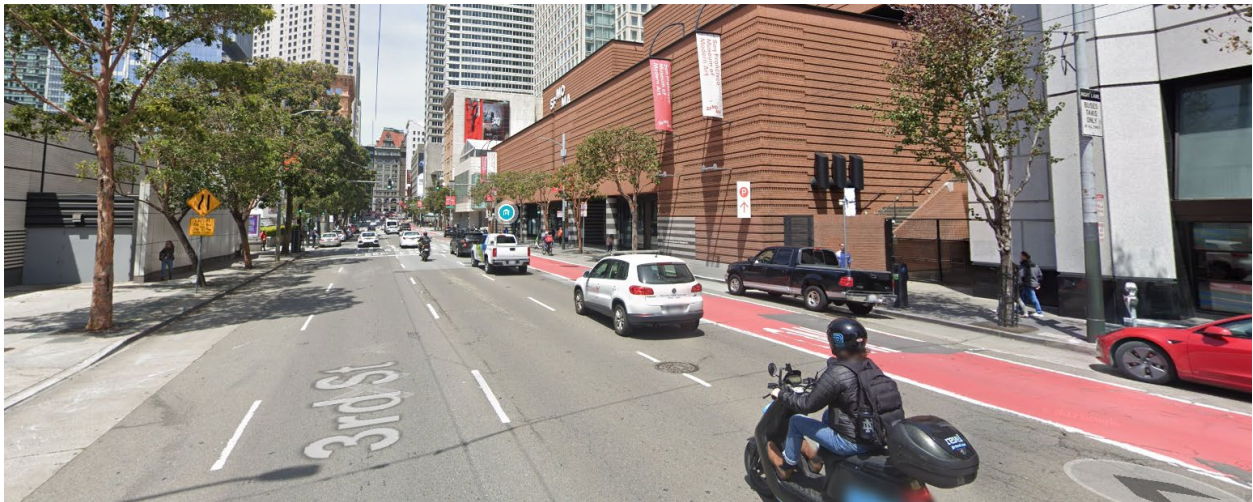
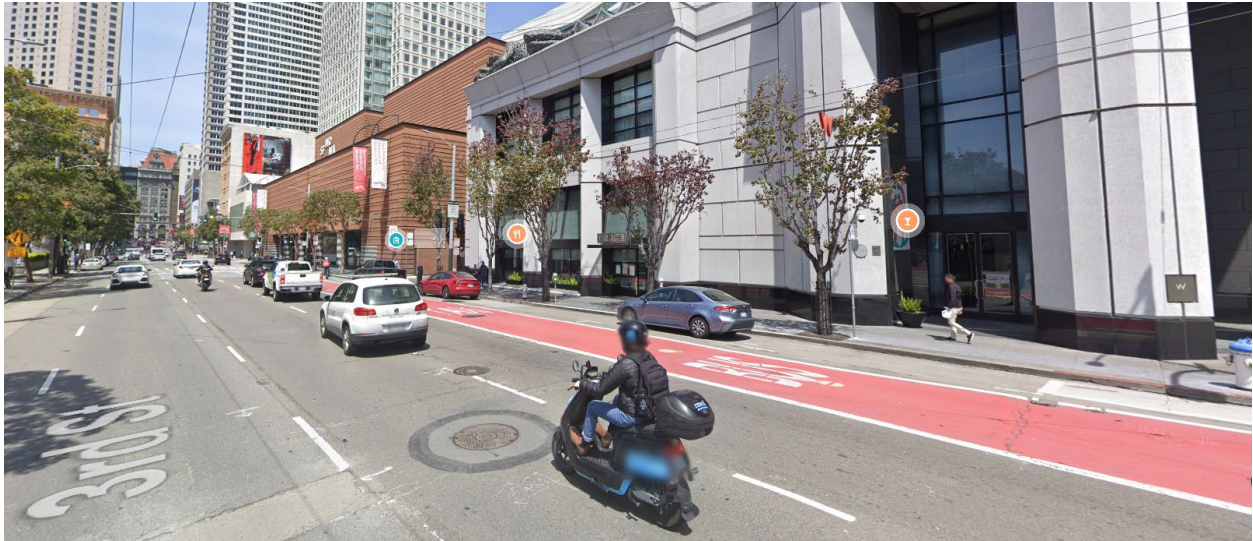

Looking northeast on 3rd Street, with the parking (5 metered spaces + white curb) north of Howard, associated with the proposed changes. Howard Street is to the right/behind of the image.

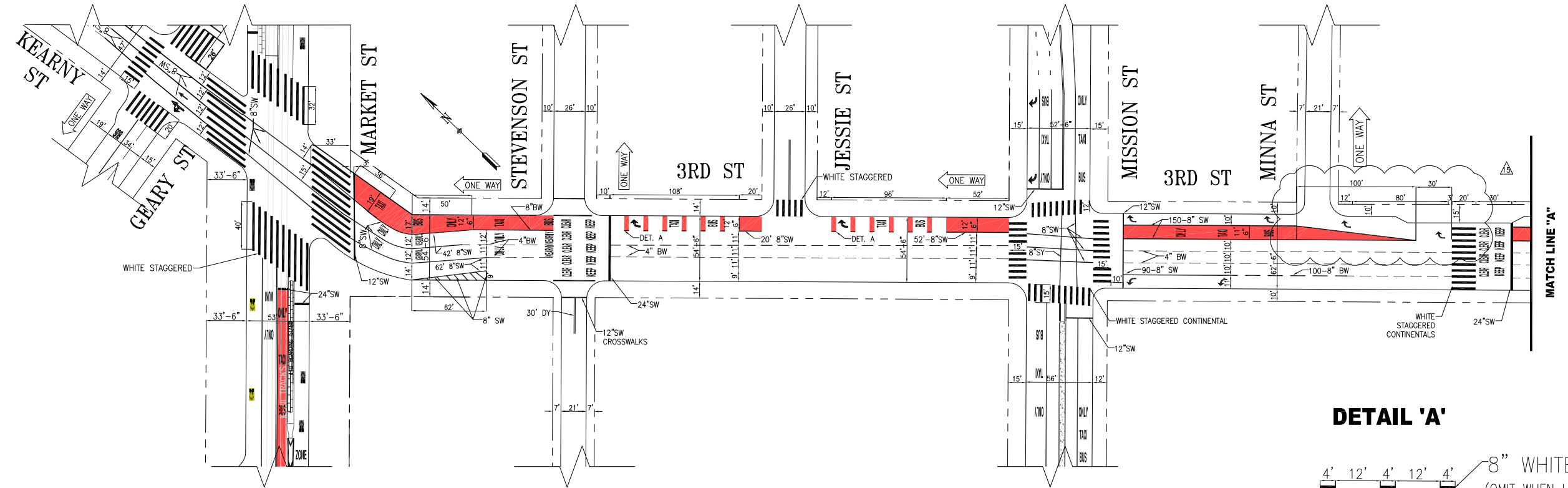

DETAIL 'A'

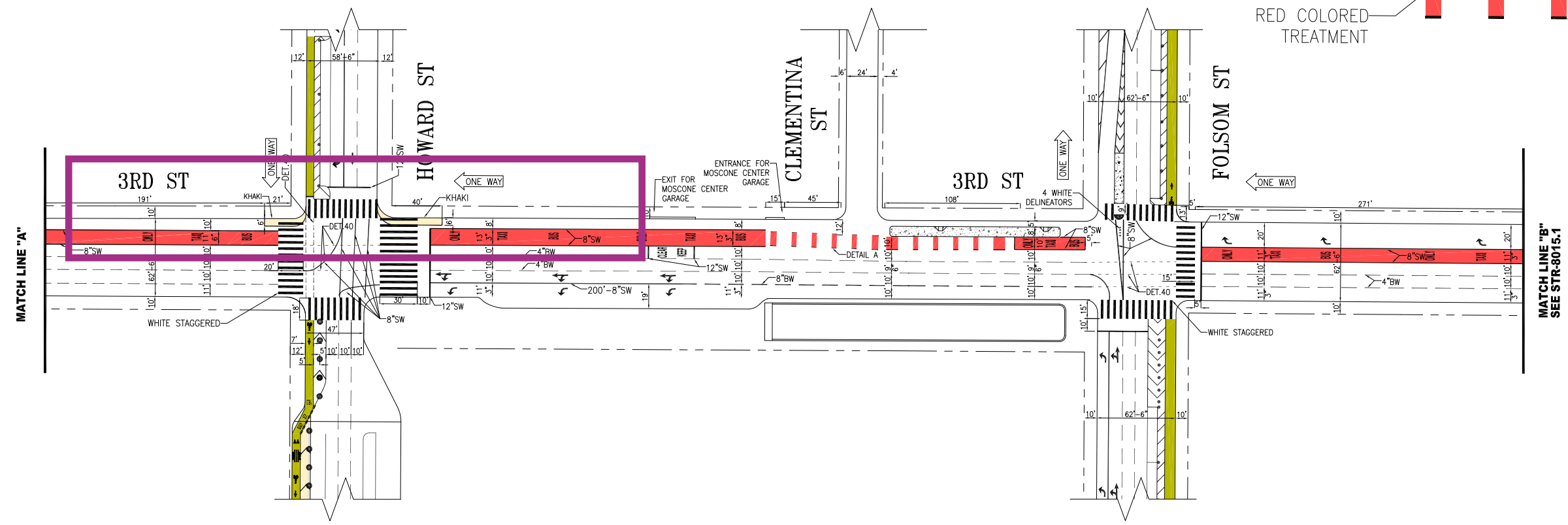
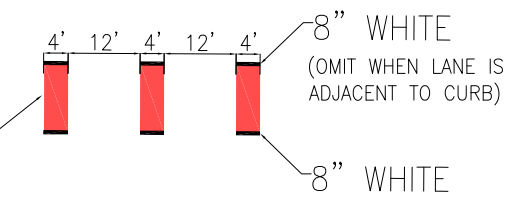

MATCH LINE "A"

MATCH LINE "B"
SEE STR-8015.1

NO.	DATE	DESCRIPTION	BY	APP
1	05/27/22	CHANGED TRANSIT ONLY LANE TRANSITION APPROACHING MISSION	K.SHUE	M.VELASCO
2	12/21/21	ADDED ADVANCE LIMIT LINE, NORTHBOUND AT MISSION	K.SHUE	M.VELASCO
3	07/02/21	ADDED WHITE STAGGERED CONTIS AT MISSION	L.YEE	B.WOO
4	07/02/21	ADDED CLASS IV BIKE LANE ON FOLSOM ST., PER FIELD; UPDATED ROADWAY STRIPING ON MISSION STREET	M.MANALO	M.SALLABERRY

TABLE OF REVISIONS
CHECK WITH TRACING TO SEE IF YOU HAVE LATEST REVISION



SUPERSEDES: STR-6143 REV20	DATE:	APPROVED CHERYL LIU 03/10/2014	DATE:
DRAWN: J.KUNG	DATE: 03/2014	SENIOR ENGINEER	DATE:
CHECKED: B.THOMAS	DATE: 03/2014	RICARDO OLEA 03/10/2014	DATE:
		CITY TRAFFIC ENGINEER	DATE:

SCALE: 1" = 50'
SHEET/SHEETS: 1 OF 2

TRAFFIC STRIPING

THIRD STREET
MARKET STREET TO FOLSOM STREET

CONTRACT NO.
DRAWING NO. STR-8015
FILE NO.
REV. NO. 15

EXTERNAL REFERENCES:
FONTS USED:
SCALE FACTOR: 1"=1'
PLOT SCALE:
ORIGIN: TRANSIT ENGINEERING
FILE NAME:
DATE: --/--/--

EXISTING

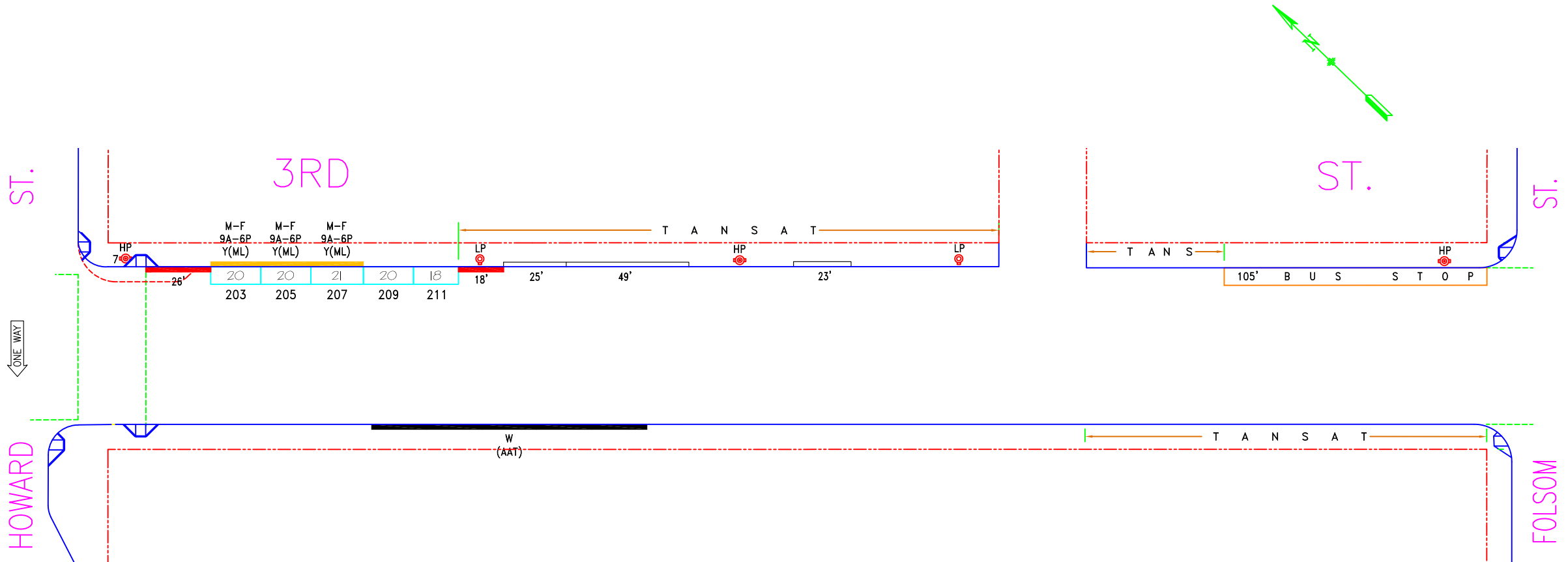

NO.	REVISION DESCRIPTION								BY	DATE	DIR/RES								
	Install ML##203,5,7,/GMP#209,11,E/S											JB	9/24/19	190219.021					
SIDE	TOW-AWAY		METER CT.		GENERAL				LOADING			METERED SPACES							
	AM	PM	SS	MS	GMP	MC	TIMES	DAYS	ML	MTL	6-W	15 MIN	30 MIN	1 HR	2 HR	10 HR	NO LIMIT	TOTAL	
ODD			3		2		7A-6P	M-SA	3					3	2			5	
EVEN																			



SAN FRANCISCO MUNICIPAL TRANSPORTATION AGENCY
CITY AND COUNTY OF SAN FRANCISCO
 PARKING METER SPACES

3RD ST. (03S, 203)
(200) BLOCK
 Meters #203-02XXy

HOWARD ST. TO FOLSOM ST.

AREA 1

SCALE: **1" = 50'** DATE: **9/24/19** BY: **JB**

PROPOSED

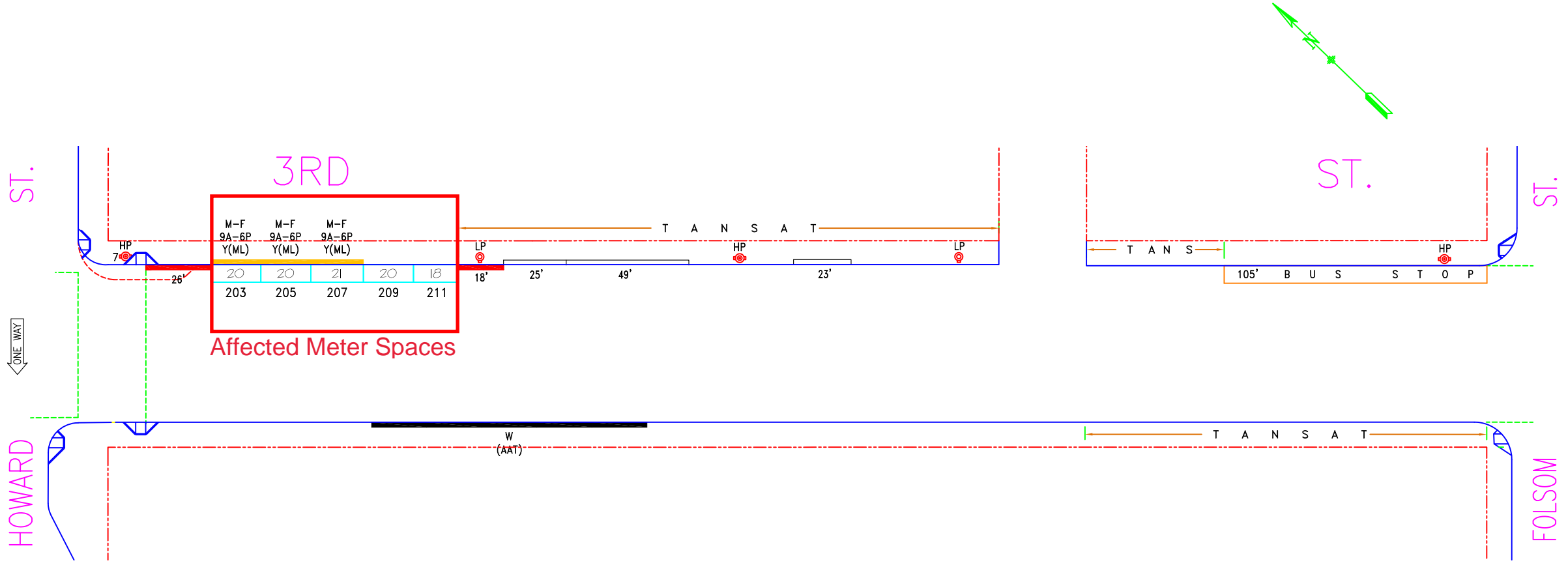

NO.	REVISION DESCRIPTION	BY	DATE	DIR/RES
1	Install ML##203,5,7,/GMP#209,11,E/S	JB	9/24/19	190219.021

SAN FRANCISCO MUNICIPAL TRANSPORTATION AGENCY
CITY AND COUNTY OF SAN FRANCISCO
 PARKING METER SPACES

SIDE	TOW-AWAY		METER CT.		GENERAL				LOADING		METERED SPACES							TOTAL
	AM	PM	SS	MS	GMP	MC	TIMES	DAYS	ML	MTL	6-W	15 MIN	30 MIN	1 HR	2 HR	10 HR	NO LIMIT	
ODD	7A-10A	3P-7P	3		2		7A-6P	M-SA	3					3	2			5
EVEN							10A-3P 7A-6P	M-F SA										

3RD ST. (03S, 203)
(200) BLOCK
 Meters #203-02XXy
HOWARD ST. TO FOLSOM ST.

SCALE: **1" = 50'** DATE: **9/24/19** BY: **JB**

AREA 1

EXISTING

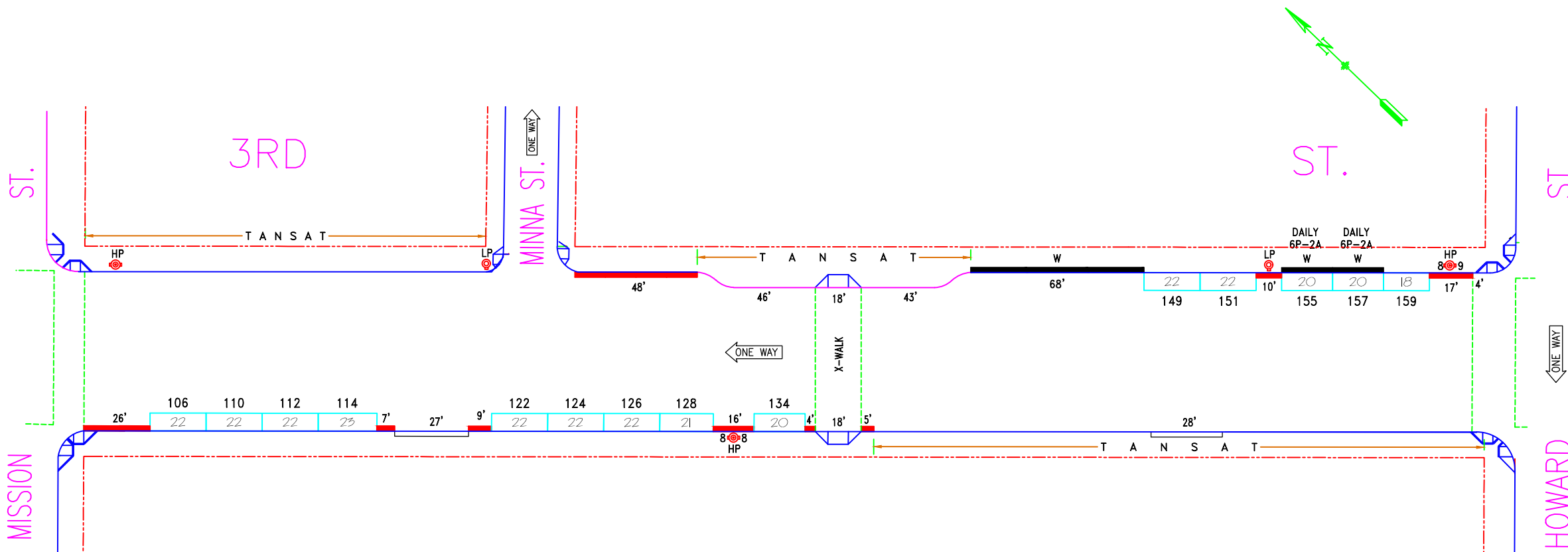

NO.	REVISION DESCRIPTION	BY	DATE	DIR/RES	5	Per field:new bulbout,MOS#125-147	JB	9/22/16
3	MOS#446, Establish RZ - E/S	DY	4/18/12	12-041	6	Establish Redzone, MOS#104-W/S	JB	2/1/20 200107.003
4	Establish Y(ML) meters#143 & #145	JB	6/25/13	5116				



SAN FRANCISCO MUNICIPAL TRANSPORTATION AGENCY
CITY AND COUNTY OF SAN FRANCISCO
 PARKING METER SPACES

SIDE	TOW-AWAY		METER CT.		GENERAL				LOADING		METERED SPACES							
	AM	PM	SS	MS	GMP	MC	TIMES	DAYS	ML	MTL	6-W	15 MIN	30 MIN	1 HR	2 HR	10 HR	NO LIMIT	TOTAL
ODD	7A-9A	3P-6P	5		5		9A-3P 7A-6P	M-F SA							5			5
EVEN	7A-9A	3P-7P	9		9		9A-3P 7A-6P	M-F SA							9			9

3RD ST. (03S, 203)
(100) BLOCK
 Meters #203-01XXY

MISSION ST. TO HOWARD ST.

SCALE: **1" = 50'** DATE: **6/26/13** BY: **JB**

AREA 1

PROPOSED

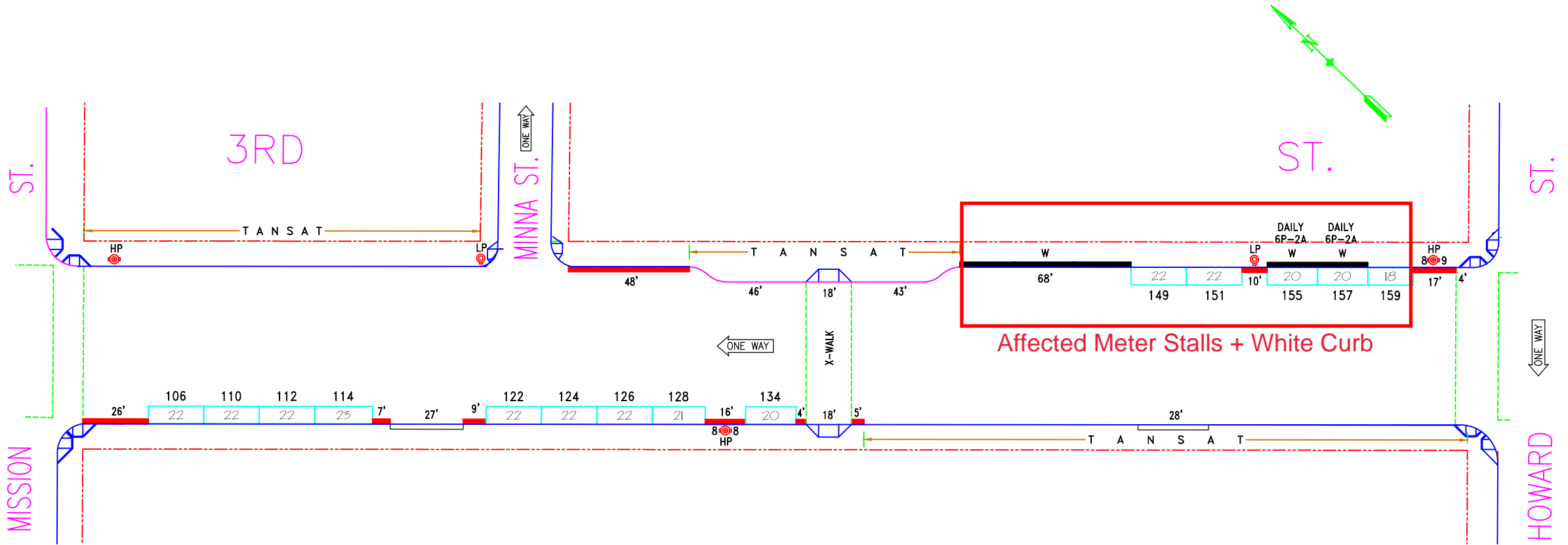

NO.	REVISION DESCRIPTION	BY	DATE	DIR/RES	5	Per field:new bulbout,MOS#125-147	JB	9/22/16
3	MOS#446, Establish RZ - E/S	DY	4/18/12	12-041	6	Establish Redzone, MOS#104-W/S	JB	2/1/20 200107.003
4	Establish Y(ML) meters#143 & #145	JB	6/25/13	5116				



SAN FRANCISCO MUNICIPAL TRANSPORTATION AGENCY
CITY AND COUNTY OF SAN FRANCISCO
 PARKING METER SPACES

SIDE	TOW-AWAY		METER CT.		GENERAL			LOADING		METERED SPACES								
	AM	PM	SS	MS	GMP	MC	TIMES	DAYS	ML	MTL	6-W	15 MIN	30 MIN	1 HR	2 HR	10 HR	NO LIMIT	TOTAL
ODD	7A-10A	3P-7P	5		5		10A-3P 7A-6P	M-F SA							5			5
EVEN	7A-9A	3P-7P	9		9		9A-3P 7A-6P	M-F SA							9			9

3RD ST. (03S, 203)
(100) BLOCK
 Meters #203-01XXY
 MISSION ST. TO HOWARD ST.

SCALE: **1" = 50'** DATE: **6/26/13** BY: **JB**

AREA 1



8 Bayshore & 8AX/8BX Expresses

effective 7/9/22

Downtown, Chinatown & North Terminals

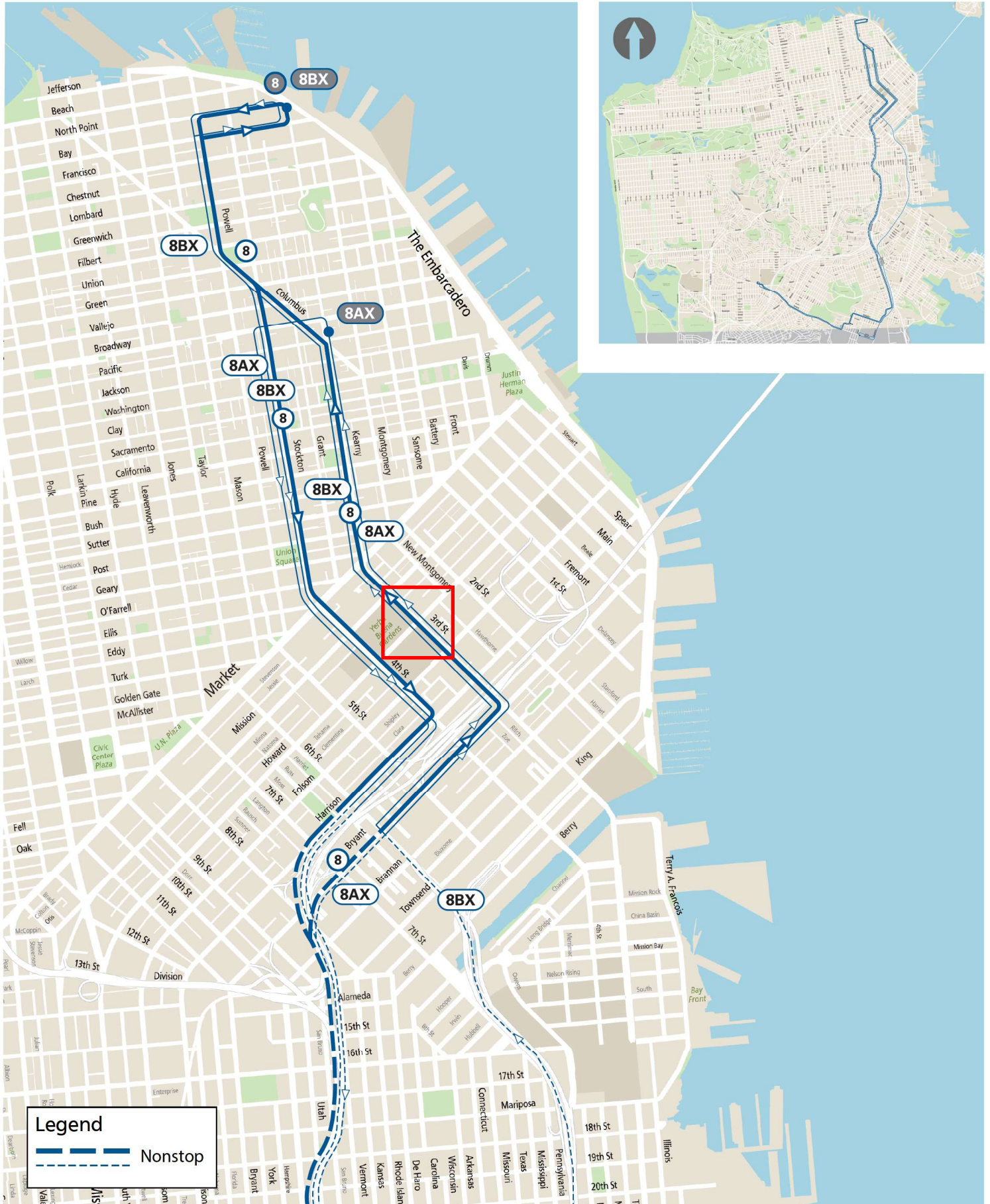



8 Bayshore & 8AX/8BX Expresses

Effective 7/9/22

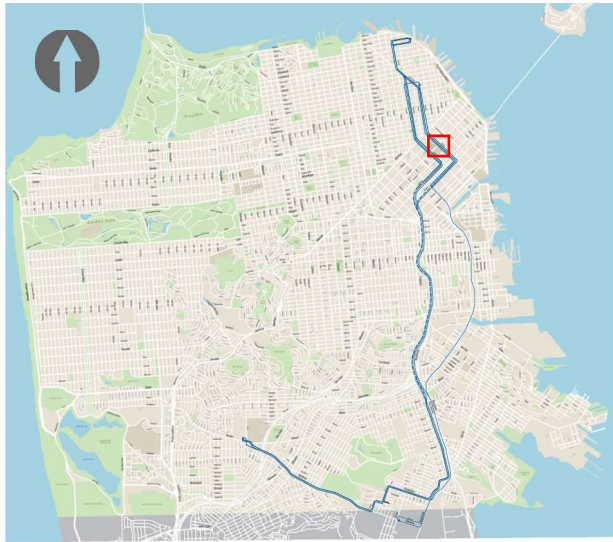

101 & 280 Freeways

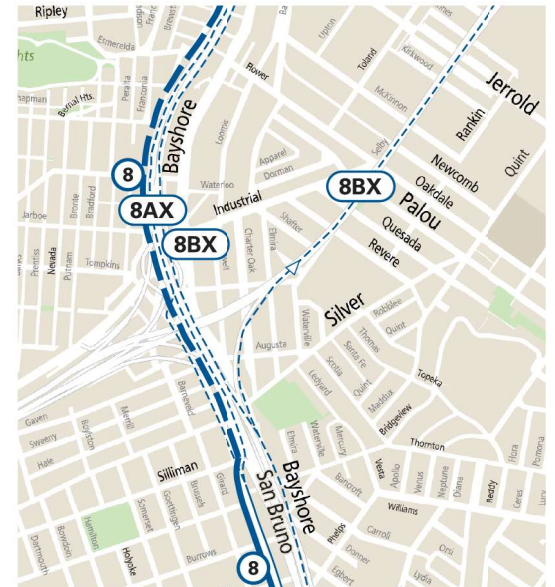
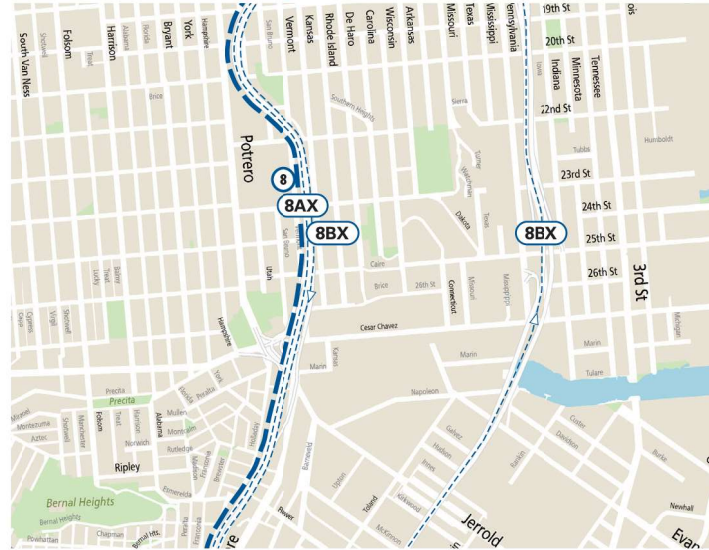

Visitation Valley, San Bruno Ave, Bayshore Blvd, & Southern Terminals

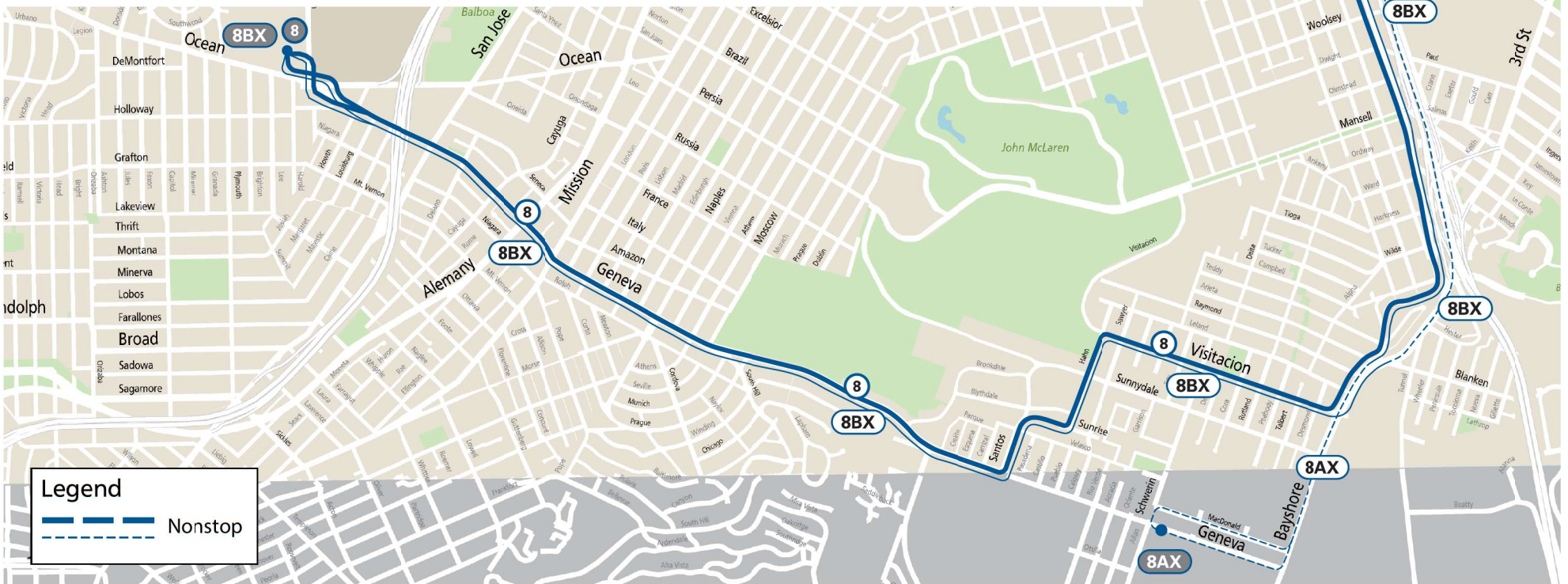



15 Bayview Hunters Point Express

effective 07/09/2022



Financial District to Bayview via Hunters Point

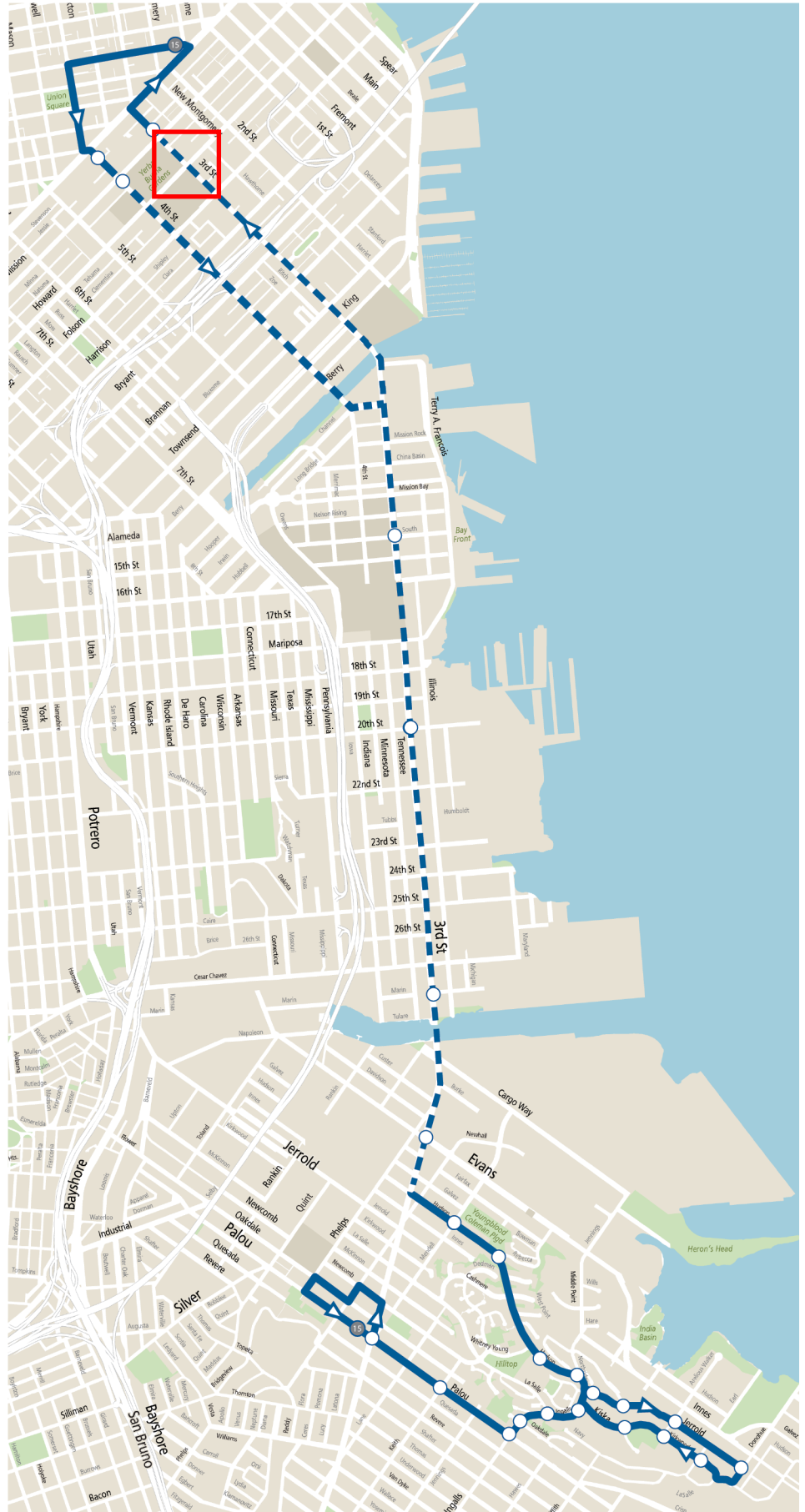

Northern Terminal



Southern Terminal

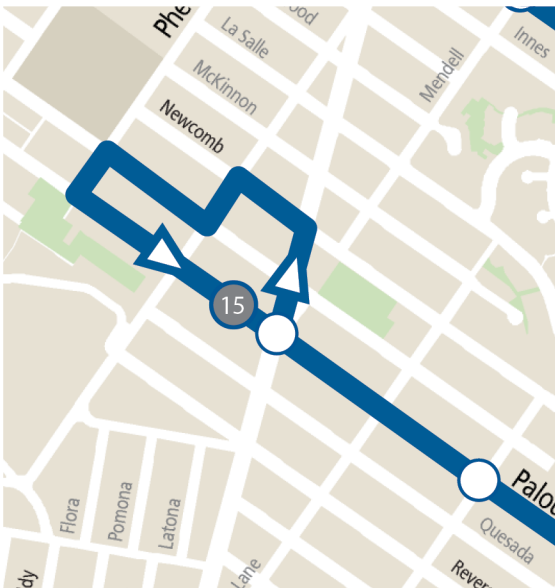



30 Stockton

Effective 7/9/2022

Presidio, Cow Hollow, Downtown, & South of Market

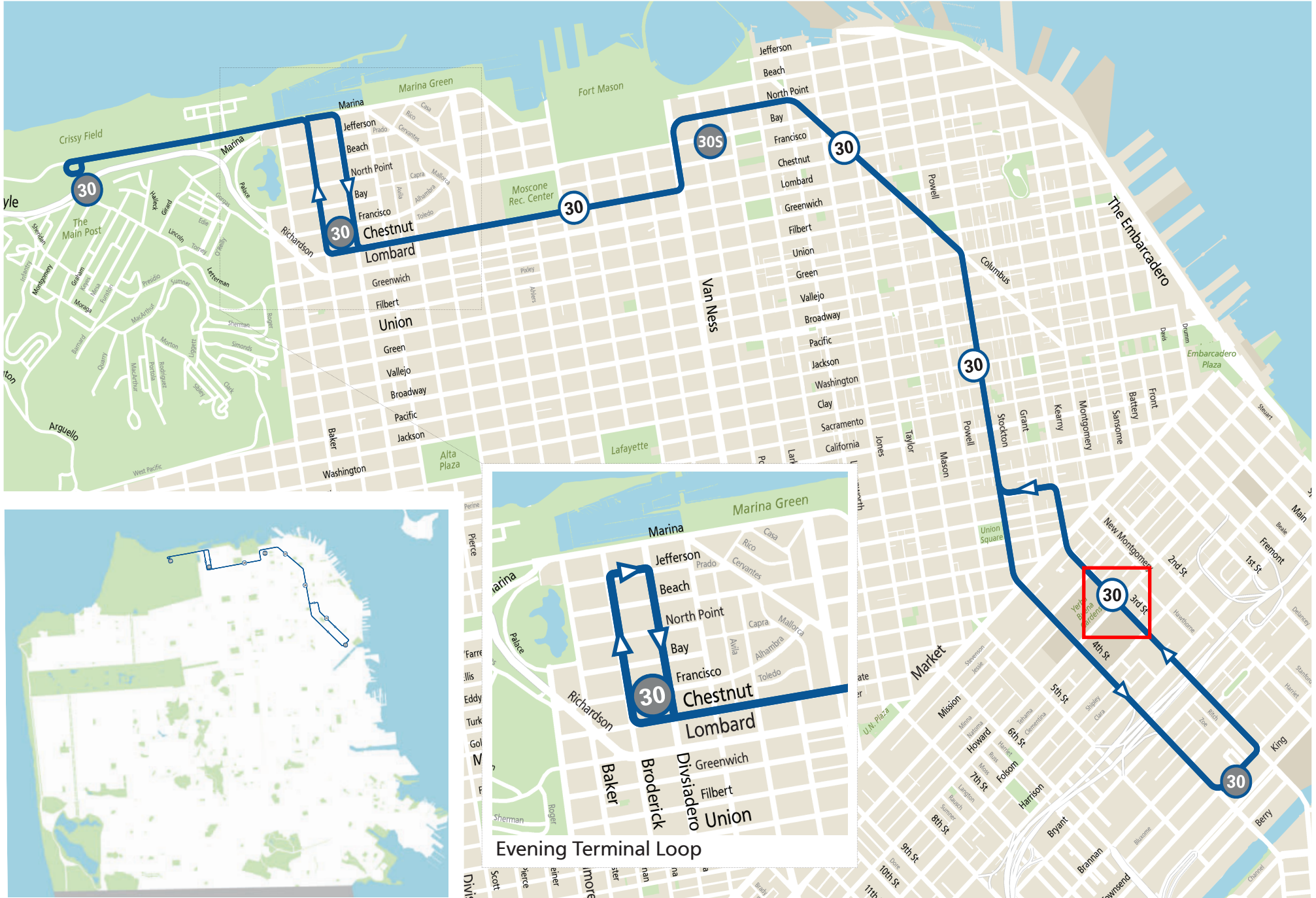

Cow Hollow, Downtown, & South of Market

